

**Boundary Correction - City of Newark CO942**  
**August 2018**

City: Newark  
 Mayor: Jim Cunningham

Arkansas Code 14-40-101.

Before an entity undertakes an annexation, consolidation, or detachment proceeding under this chapter, the entity shall coordinate with the Arkansas Geographic Information Systems Office for preparation of legal descriptions and digital mapping for the relevant annexation, consolidation, and detachment areas.

The map contained herein, is evidence, the entity has met requirements of Act 914 of 2015

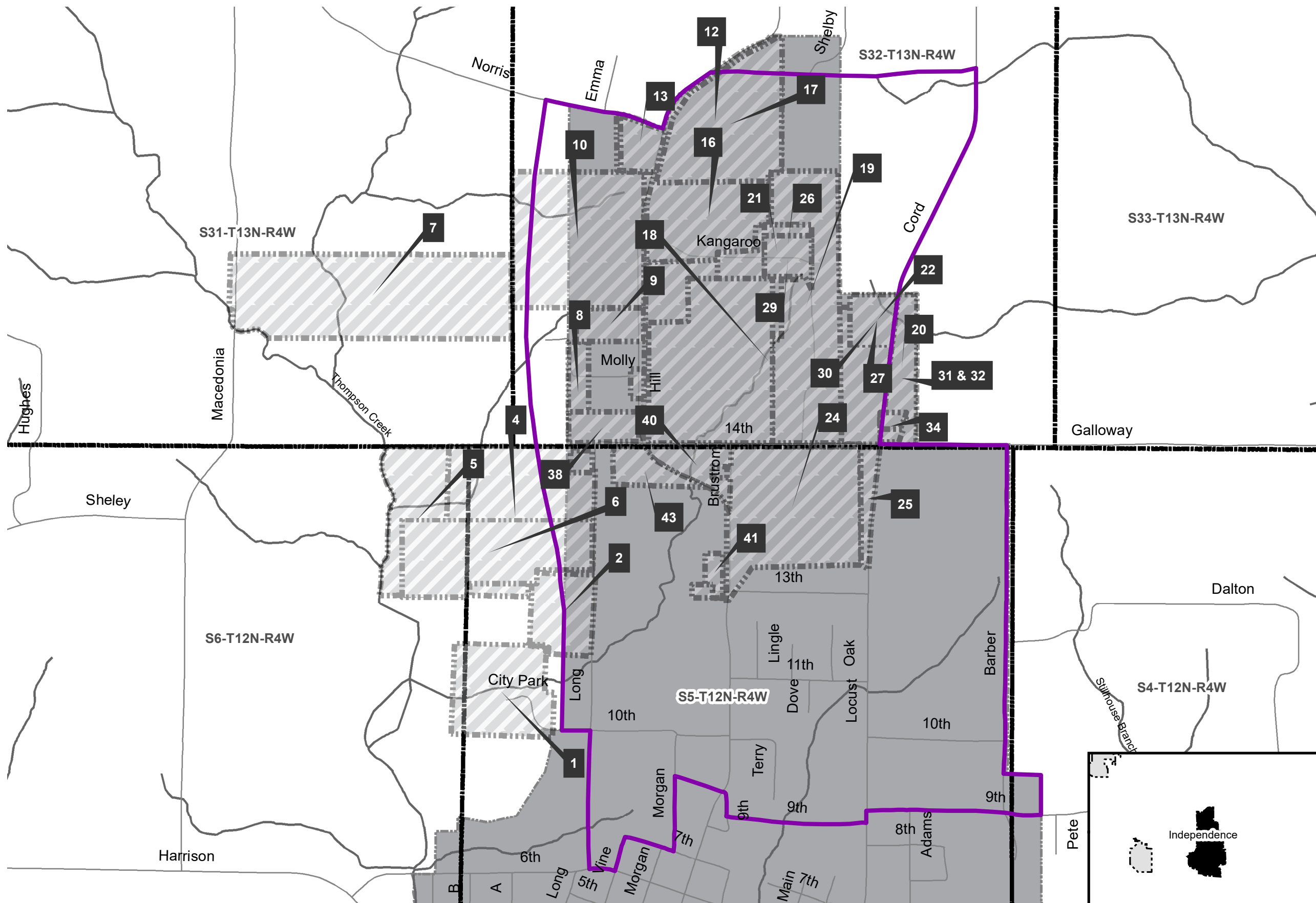

- Voting District (should match city)
- Needs Research (annexations don't match expected city shape)
- Sections
- Minor Road
- River Flowline
- Existing City
- County Boundary

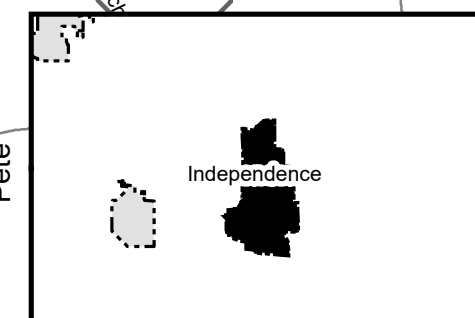
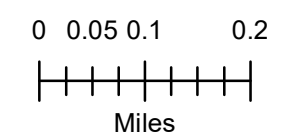

IN THE COUNTY COURT OF INDEPENDENCE COUNTY, ARKANSAS

IN THE MATTER OF ANNEXING TO  
THE CITY OF NEWARK, ARKANSAS  
CERTAIN TERRITORY CONTIGUOUS TO THE  
SAID CITY OF NEWARK, ARKANSAS

C0942

ORDER OF ANNEXATION

On this 11th day of July, 1994, the Petitioners herein presented its petition to annex certain lands, hereinafter described, to the City of Newark, Arkansas. Based upon the testimony, evidence, and the things and matters presented to the Court, the Court hereby finds, orders, and adjudges:

1. That this court has jurisdiction of this matter.
2. That proper notice of this action has been given.
3. That the requirements for signatures required by Ark. Code Ann. Sec. 14-40-601 have been complied with.
4. That the limits of the territory to be annexed have been accurately described and an accurate map thereof has been made and filed with the Court.
5. That the prayer of the petitioner is right and proper.
6. That the following lands located in Independence County, Arkansas are hereby annexed into the City of Newark, Arkansas:

A part of the West Half of Lot 4 of the Northwest Quarter of Section 5, Township 12, North, Range 4, West of the Fifth Principal Meridian of Arkansas, describe thus:

Beginning at a metal stake, the the Southwest corner of the West Half of Lot 4 of the Northwest Half of the Northwest Quarter of said Section, Township and Range, thence North 02 degrees 13' 44" East 887.0 feet to a point., thence South 88 degrees 15' East 894.0 feet to a metal stake, thence South 02 degrees 13' 44" West 451.0 feet to metal stake, thence South 88 degrees 15' East 96.0 feet to a metal stake, thence South 02 degrees 13'

2.2  
355-368 1

FILED

JUL 11 1994

MARGARET BOOTHBY  
COUNTY & PROBATE CLERK  
D.C.

44" West 436.0 feet to a metal stake in a dirt roadway, thence North 88 degrees 15' West 990.0 feet to a point of beginning, containing 19.16 acres more or less.

TRACT ONE DESCRIPTION

2

A tract of land being a part of the W 1/2 of Lot 4 and a part of the W 1/2 of Lot 5 of the NW 1/4 of Section 5, T12N, R4W in Independence County, Arkansas, more particularly described as follows: commencing at the Southwest corner of said W 1/2, Lot 4, NW 1/4; thence N 02 degrees 13' 44" E a distance of 887.00 feet; thence S 88 degrees 15' 00" E a distance of 894.00 feet; thence S 02 degrees 13' 48" W a distance of 55.61 feet; thence S 87 degrees 06' 08" E a distance of 12.15 feet to the point of beginning; thence N 01 degrees 53' 26" E along a fence a distance of 68.27 feet; thence N 87 degrees 44' 10" W along a fence a distance of 185.63 feet; thence N 02 degrees 17' 29" E along a fence a distance of 719.96 feet; thence S 88 degrees 10' 08" E along a fence a distance of 614.38 feet to the West right of way line of Long Street; thence S 03 degrees 21' 43" W along said right of way line a distance of 797.59 feet; thence N 87 degrees 06' 08" W along a fence a distance of 413.37 feet to the point of beginning. Containing 10.75 acres, more or less.

TRACT TWO DESCRIPTION

3

A tract of land being a part of the W 1/2 of Lot 4 of the NW 1/4 of Section 5, T12N, R4W in Independence County, Arkansas, more particularly described as follows: commencing at the Southwest corner of said W 1/2, Lot 4, NW 1/4: thence N 02 degrees 13' 44" E a distance of 887.00 feet; thence S 88 degrees 15' 00" E a distance of 720.09 feet to the point of beginning; thence continue S 88 degrees 15' 00" E along a fence a distance of 173.91 feet; thence S 02 degrees 13' 48" W along a fence a distance of 55.61 feet; thence S 87 degrees 06' 08" E a distance of 12.15 feet; thence N 01 degrees 53' 26" E along a fence a distance of 68.27 feet; thence N 87 degrees 44' 10" W along a fence a distance of 185.63 feet; thence S 02 degrees 17' 29" W a distance of 14.18 feet to the point of beginning. Containing 3,145.72 square feet, more or less.

4

All of the West Half of Lot 5 of the Northwest Quarter of Section 5, Township 12 North, Range 4 West, except one acre in the Northeast corner of said tract in the form of a square; and also

approximately three and one-half acres in the Southeast corner of said tract used as a cemetery and described as follows: Beginning at the Southeast corner of said West Half of Lot 5 of the Northwest Quarter of Section 5, run thence West 946 links; thence North 370 links; thence East 446 links; thence North 30 links; thence East 500 links; thence South 400 links to the place of beginning.

5

Also, all that part of the East Half of Lot 5 of the Northeast Quarter of Section 6, Township 12 North, Range 4 west, lying East of the middle of Thomas Creek, containing 20 acres more or less, and all of the above described lands containing in the aggregate 58 1/2 acres, more or less.

This is the same land conveyed by Herman F. Wichman, et ux, to B.C. Young and Lottie Young by deed dated June 27, 1955, and recorded in Book Z-6, page 417-418 of the deed records of Independence County, Arkansas, the tract being covered by this contract being described as follows:

6

Beginning at the Northeast corner of the Blue Springs Cemetery as now located; run thence due North 462 feet to a point; run thence West 1861 feet to the center of Thomas Creek; run thence in a Southerly direction along Thomas Creek a distance of 758 feet to the Southwest corner of the tract herein described; run thence East 660 feet; run thence North 132 feet; run thence East 660 feet; run thence North 132 feet; run thence East 660 feet to the point of beginning, containing 25 acres, more or less.

#### TRACT ONE

All of the West Half of Lot 5 of the Northwest Quarter of Section 5, Township 12 North, Range 4 West, except one acre in the Northeast corner of said tract in the form of a square; and also approximately three and one-half acres in the Southeast corner of said tract used as a cemetery and described as follows: Beginning at the Southeast corner of said West Half of Lot 5 of the Northwest Quarter of Section 5, run thence West 946 links; thence North 370 links; thence East 446 links; thence North 30 links; thence East 500 links; South 400 links to the place of beginning. Also, all that part of the East Half of Lot 5 of the Northeast Quarter of Section 6, Township 12 North, Range 4 West, lying East of the middle of Thomas Creek, containing 20 acres more or less, and all of the above described lands containing in the aggregate 58 1/2 acres, more or less.

This is the same land conveyed by Herman F. Wichman, et ux, to B.C. Young and Lottie Young,

Duplicate of 1

by deed dated June 27, 1955, and recorded in Book Z-6, page 417-418 of the deed records of Independence County, Arkansas.

7

TRACT TWO

The South Half of the North Half of the Southeast Quarter and the North Half of the North Half of the South Half of the Southeast Quarter, all of the above excepting however, that lying West of Thomas Creek heretofore sold to A.K. Gibson and this conveyance containing 40 acres, more or less, all being situated in Section 31, Township 13 North, Range 4 West.

8

A part of the W 1/2 of the SW 1/4 of SW 1/4 of Section 32, Township 13 North, Range 4 West, described thus: Commence at the SE corner of said W1/2 SW1/4 SW1/4 and run thence North for 60 rods to a point; thence West for 200 feet to a point; thence South for 60 rods to a point; thence East for 200 feet to the Point of Beginning.

9

(a) Five (5) acres of uniform width off of the entire North side of the East Half of the Southwest Quarter of the Southwest Quarter. (5 acres).

10

(b) The Northwest Quarter of the Southwest Quarter. (40 acres).

11

(c) A part of the Northeast Quarter of the Southwest Quarter described thus. Commence at the NW corner of said NE 1/4 SW 1/4 and run East for 1875 links; thence run South for 1333.1/3 links; thence run West for 1875 links; thence run North for 1333.1/3 links to the Place of Beginning. (25 acres).

12

(d) A part of the South Half of the Northwest Quarter, described as follows:  
Commence at the Northeast corner of said South Half of the Northwest Quarter for the PLACE OF BEGINNING.  
Thence run Westerly and Southwesterly with the meanders of the Newark Mt. Carmel (WPA) road to the Southeast corner of the junction of said Newark Mr. Carmel Road with the Sulphur Rock Road.  
Thence Run Westerly with the Sulphur Rock for a distance of 528 feet;  
Thence run South for a distance of 875 links to the South line of the said Northwest Quarter.  
Thence run East on the South line of said NW Quarter to the Southeast corner of the said

Northwest Quarter;  
Thence run North on the East line of said  
Northwest Quarter to the Place of  
Beginning. (30 acres).

All of the above and foregoing lands lying in  
Section Thirty Two (32), Township Thirteen (13)  
North, Range Four (4) West, and containing in the  
aggregate 100 acres, more or less.

13

A tract of land being a part of the West  
Half of Section 32 in Township 13 North, Range  
4 West in Independence County, Arkansas, more  
particularly described as follows: Beginning  
at the point that is 783.60 feet South and  
1049.50 feet East of the Northwest corner of the  
Southwest Quarter of the Northwest Quarter of  
said Section 32, said point being a twenty-  
four inch Oak tree; thence S 71 degrees 34'  
23" E along an existing fence a distance of  
472.17 feet to the West right of way line of Arkansas  
State Highway no. 233; thence S 13 degrees 37'  
43" W along said West right of way line a  
distance of 414.50 feet to an existing fence corner  
post; thence N 87 degrees 05' 14" W along an  
existing fence a distance of 343.53 feet to an  
existing fence corner post; thence N 00 degrees  
46' 02" along an existing fence a distance of 534.67  
feet to the point of beginning.

14

A part of the Southwest Quarter of the  
Southeast Quarter of Section 32, Township 13 North,  
Range 4 West, described as follows: Begin at a point  
3,125 links West of the Southeast corner of  
Section 32, Township 13 North, Range 4 West,  
thence run North 105 yards for a beginning  
corner, thence East 607 links, thence North  
with the road 195 1/2 links, thence West 626  
links, thence South 195 1/2 links to the place  
of beginning, containing 1 1/2 acres, more  
or less.

15

Also, a part of the Southwest Quarter of  
the Southeast Quarter of Section 32, Township  
13 North, Range 4 West, described as follows:  
Beginning at the Northwest corner of the above  
piece of land, the L.P. Bruck place, 1 1/2 acre  
piece, thence run North 65 1/6 links; thence  
East 607 links, thence South with the road  
65 1/6 links, thence West 607 links to the  
place of beginning, and containing one-half  
of an acre.

Part of the Northeast Quarter of Southwest  
Quarter of Section 32, Township 13 North, Range

16  
(overlaps 11  
except for road)

4 West, Independence County, Arkansas, to-wit:  
From the Northeast corner of Section 5, Township  
12 North, Range 4 West, run North 89 degrees 44'  
West along the South line of said Section 32,  
Township 13 North, Range 4 West, and along a  
gravel road 2,364.63 feet; then run North,  
along a fence 1612.80 feet to a fence corner  
and the Point of Beginning; then continue North  
934.50 feet; then run South 89 degrees 10' West  
1109.81 feet to the East right-of-way line of  
Arkansas Highway 233; then run South 14 degrees  
06' West along said East highway right-of-way  
line 354.41 feet to a point of curvature;  
then run South along said East highway right-  
of-way line and along a curve to the left,  
central angle 14 degrees and radius 786.75 feet;  
a distance of 192.00 feet to a Point of Tangency;  
then run South 00 degrees 06' West along said East  
highway right-of-way 374.56 feet; then run South  
89 degrees 31' East along a fence 1209.58 feet to  
the Point of Beginning being 25.00 acres.

17  
(overlaps 12  
except for road)

All that part of the S 1/2 of NW 1/4 of  
Section 32, Township 13 North, Range 4 West,  
which is located South and East of the  
Easterly R/W of Ark. Hwy #233 (formerly known  
as the Newark-Mt. Carmel Road), and all that  
part of the North 88 feet of the West 1237.50  
feet of the NE 1/4 of SW 1/4 of said Section  
32, Township 13 North, Range 4 West, located  
East of the East R/W of said Ark. Hwy #233,  
more particularly described as follows:  
Begin at the center of said Section 32;  
run North 00 degrees 12' 10" East 1331.30 feet  
to an iron marker for the NE corner of said  
S 1/2 NW 1/4; thence run South 89 degrees 10'  
West 36.44 feet to the Easterly R/W line of Ark.  
Hwy #233; thence run Southwesterly along said  
Easterly Highway R/W line as follows: along  
a curve to the right central angle 71 degrees 53',  
centerline tangent 188.83 feet to the chord of  
which bears South 57 degrees 41' 10" West  
152.13 feet; thence South 72 degrees 44'  
00" West 5.42 feet to a point of curvature;  
thence run along a curve to the left central  
angle 17 degrees 33', centerline tangent 118.80  
feet the chord of which bears South 63 degrees 21'  
10" West 221.97 feet; thence South 55 degrees  
11' 00" West 637.47 feet to a point of curvature;  
thence along a curve to the left, central angle  
40 degrees 28', centerline tangent 178.44 feet,  
the chord of which bears South 34 degrees 48' 15"  
West 307.50 feet thence South 14 degrees 42' 45"  
West 543.22 feet; thence South 14 degrees 06' 00"

West 116.07 feet to an iron pin at the NW corner of a tract of land heretofore deeded to Newark School by McDoniel; thence run North 89 degrees 10' East 1098.81 feet to an iron pin; thence run North 88.00 feet; thence run North 88 degrees 10' East 130.42 feet to the Point of Beginning, being 28.02 acres.

18

Part of the E 1/2 of SW 1/4 of Section 32, Twp. 13 North, Range 4 West, described by the County Surveyor (Dolph Hill) Commencing at a stake which is 160 links West of the 1/4 Section corner on South side of Sec. 32 from which B.O. 1/3 in. in dia., bears North 71 E. 43 links, thence West 1840 links to a stake from which B.O. 18 in. in dia. bears 9 E. 3 links B.O. 12 in. in dia. bears S. 20 1/2 W. 26 links, thence 2445 links to a stake from which B.O. 24 in. in dia. bears S. 15 W. 21 links, W.O. 15 in. in dia. bears S. 30 E. 29 links, thence E. 1840 links to a stake in a string of fence from a Ash 6 in. in dia., bears N. 32 W. 3 links to B. O. 8 in. in dia., bears N. 48 1/2 E. 11 links, thence S. 2445 links to place of beginning, containing 45 acres more or less, (Except 5 acres sold to J. H. Moran, out of the Northwest corner of said land). Also the West part of the SE 1/4 of Section 32, containing 40 acres, also 5 acres off the East part of the SW 1/4 of said Section, all in Township 13 North, Range 4 West.

19

The West one-half of the West one-half of the Southeast Quarter (W 1/2 W 1/2/ SE 1/4 ) and the East Half of the East Half of the East Half of the East Half of the Southwest Quarter (E 1/2 E 1/2 E 1/2 E 1/2 SW 1/4) of Section 32, Township 13 North, Range 4 West, described more particularly by metes and bounds as follows: Beginning at the Southeast Corner of the SW 1/4 SW 1/4 SE 1/4 of Section 32, Township 13 North, Range 4 West; run thence West along the Southern boundary line of Section 32, a distance of 733 feet; run thence North parallel with the Eastern boundary line of the Southwest Quarter (SW 1/4) of Section 32, a distance of 26.32 feet to the Northern boundary line of the SW 1/4 of Section 32; run thence East along the Northern boundary line of the S 1/2 of Section 32, a distance of 734 feet; run thence South along the Eastern boundary of the W 1/2 W 1/2 of the SE 1/4 a distance of 2654 feet to the point of beginning, containing 45 acres, more or less.

20

Beginning at a point on line Twps. 12 and 13 North, 3125 links West of the S.E. Corner to Sec. 32 in T. 13, N.R. 4 West, thence East 900 links,



thence N. 20 deg. E. 947 links to corner, witnessed by the N. W. Corner of J. W. Edlin's house, bearing S. 10 deg. E. 166 links, thence N. 10 deg. W. 50 links, thence N. 46 deg. W. along the center of road. 580 links, thence N. 1 1/2 deg. W. 329 links, this is the beginning corner of this survey. Thence N. 74 deg. W. 368 links, thence N. 62 3/4 deg. W. 526 links, thence South 445 links, thence East 818 links, thence N. 1 1/2 deg. W. 90 links to the place of beginning, and containing Two (2) acres, more or less. It being a part of the S.E. 1/4 of the S. W. 1/4, and a part of the S. W. 1/4 of the S. E. 1/4 of Sec. 32 in T. 13, N. R. 4 West.

21

Beginning at a point 2000 links South of the N. E. corner of the SW 1/4 of Section 32, Twp. 13, N.R. 4 West, thence South on line 370 links, thence North 74 degrees West 494 links, thence North 63 degrees West, thence North 925 links, thence the Hypotenuse line to the point of beginning, containing 5.57 acres, more or less.  
Beginning at a point 3125 links West of the SE. corner of Sec. 32, Twp 13, N.R. 4 West, thence East 900 links, thence North 20 degrees East 900 to corner, witness by NW. corner of J.W. Edlin's house, bearing 10 deg. E. 166 links, thence North 10 degs. West 50 links, thence North, West along the center of the road, 580 links, thence North 10 degrees West 329 links, this is the beginning corner of this survey.  
Thence N. 74 degs. W. 368 links, thence N. 62 3/4 W. 526 links, thence South 445 links, thence East 818 links, Thence N. 1 1/2 degs. West 90 links to the place of beginning, containing 2 acres more or less. It being a part of the SE. 1/4 of the SW. 1/4 and a part of the SW. 1/4 of the SE. 1/4 of Section 32, Twp. 13, N.R. 4 West.  
Containing in the aggregate 7.57 acres more or less.

22

A parcel of land located in the West Half of the Southeast Quarter of Section 32, Township 13 N, Range 4 West, Described by metes and bounds as follows:  
Beginning at a point 2006 feet West and 960 feet North of the Southeast corner of Section 32, Township 13 North, Range 4 West; Thence East 507 feet to centerline of State Road #122; Thence North 7 degrees East along center line of Road 520 feet, more or less;  
Thence West 570 feet to a property line fence;  
Thence South along said property fence 505 feet to the Place of Beginning. This parcel of land contains 6.2 acres, more or less.

23

Beginning at a point 2000 links, South on line of the North East corner of the S.W. Quarter of Section 32, Township 13, N.R. 4 West, Thence South on line 370 links, Thence North 74 degrees West. 494 links, Thence North 63 degrees West 536 links, Thence North 925 links, Thence Hypotenuse line to the point of beginning, Containing (5) and Eighty Seven one hundredth acres, more or less.

24

All of the West Half of Lot Five (5) of the Northeast Quarter of Section Five (5) in Township Twelve (12) North, Range 4 (4) West, excepting, however, ten acres lying on the South side of said tract in the form of a parallelogram and extending along the entire South side, leaving in the tract thereby conveyed 36.73 acres, more or less.

25

A part of the East Half of Lot Five (5) in the Northeast Quarter of Section Five (5), Township Twelve (12) North, Range Four (4) West, described as follows: Beginning at the Northeast Corner of the East Half of Lot Five (5) of the Northeast Quarter of said Section, Township and Range and run thence West along the North line of the said East Half of Lot Five (5) of the Northeast Quarter a distance of 1352 feet to the beginning point of this conveyance tract; thence South to a point on the West right of way line of State Highway #122 as presently located; thence in a Northeasterly direction along the West right of way line of State Highway #122 to its intersection with the North line of the East Half of Lot Five (5) of the Northeast Quarter; thence West along the North line for 111 feet to the point of beginning, containing 1.04 acres, more or less.

26

A part of the Southeast Quarter of Section 32, Township 13 North, Range 4 West, lying North and West of the road leading from old wire road, described by metes and bounds as follows: Commencing at the Northeast Corner of Pearl Bruce's two acre piece of land; thence North 8 chains; thence West 7 chains and 37 links; thence South 6 chains; thence East 6 1/2 chains and 29 links (6.79 chains) to the place of beginning, containing 5 acres, more or less.

27

A parcel of land located in the West Half of the Southeast Quarter of Section 32, Township

13 North, Range 4 West, described by metes and bounds as follows: Beginning at a point 2006 feet West and 960 feet North of the Southeast corner of Section 32, Township 13 North, Range 4 West; thence East 507 feet to center line of State Road No. 122; thence North 7 degrees East along center line of road 520 feet, more or less, thence West 570 feet to a property line fence; thence South along said property line fence 505 feet to the place of beginning; containing 6.2 acres, more or less.

28

Part of the East Half (1/2) of the Southwest Quarter (1/4) of Section 32, Township 13 North, Range 4 West, described as follows: Commencing at a point which is 160 links West of the Quarter Section corner on South side of Section 32, thence run West 1840 links; thence North 2445 links; thence East 1840 links, thence South 2445 links to the place of beginning, containing 45 acres more or less, excepting five (5) acres owned by the Moran family out of the Northwest corner of said land. This conveyance contains 40 acres more or less.

TRACT 1

29

possible duplicate  
of 27

Commencing at the Northeast Corner of Pearl Bruce's two acre piece of land thence North, (8) chains, thence West (7) chains and 37 links, thence South (6) chains, thence East (6 1/2) chains and 29 links to place of beginning. This being a part of the Southeast Quarter (1/4) of Section (32) Township Thirteen (13) North Range (4) West, and lying North and West of road leading from old wire road.

TRACT 2

30

duplicate of 27

A parcel of land located in the West Half of the Southeast Quarter (SE 1/4) of Section 32, Township 13 North, Range 4 West. Described by metes and bounds as follows: Beginning at a point 2006 feet West and 960 feet North of the Southeast corner of Section 32, Township 13 North, Range 4 West; thence East 507 feet to centerline of State Road #122; thence North 7 degrees East along center line of Road 520 feet, more or less; thence West 570 feet to a property line fence; thence South along said property fence 505 feet to the Place of Beginning. This parcel of land contains 6.2 acres, more or less.

31

Begin 325 links West from the Southeast Corner of Section 32, Township 13 North, Range 4 West, then run East 900 links; thence North

May be bad legal. Mapped based on best  
guess.

20 degrees East along the East side of the old Newark to Cord Road 947 links; thence in a Northwesterly direction along the middle of said road to the intersection of a tract of land heretofore sold to Bud Martin (now owned by Rutledge), thence West along the South line of said tract to a point due North of the beginning point; thence South to the place of beginning; EXCEPTING, however, the lands in these boundaries belonging to Marie Nash and Pearlle Bruce.

32

Begin 3125 links West from the SE corner of Section 32, thence East 900 links, thence North 20 degrees East along the East side of the old Newark to Cord Road 947 links, thence in a Northwesterly direction along the middle of said road to the intersection of Highway No. 122, thence South along the East side of said highway to the line between township 12 and 13, excepting however, the South side of this tract belonging to G.A. Mayhan a leaving herein 4 acres on the North side of the said tract, being part of the SE 1/4 of Section 32, township 13 North, Range 4 West.

same note as 31

33

A part of the South Half (S 1/2) of the Southeast quarter (SE 1/4) of Section Thirty-Two (32), Township Thirteen (13) North, Range Four (4) West, described thus:  
Beginning at the intersection of the East right of way line of State Highway #122 and the township line between Townships 12 and 13 North;  
Thence North along the East right of way line of Highway #122 for 185 feet to the place of beginning of this conveyance;  
thence East 226 feet to the Southeast corner of said parcel being conveyed; thence North 20 1/2 degrees East (more or less) along an old fence line 77 feet to the Northeast corner of the parcel being conveyed;  
thence Westerly along an old fence line 255 feet to the East right of way line of Highway #122;  
thence South along said right of way line for 126 feet to the place of beginning.  
Containing 23,418 square feet, more or less.

34

A part of the South Half of Southeast Quarter of Section 32, Township 13 North, Range 4 West, described thus: Beginning at the intersection of the East right of way line of State Highway #122 and the township line between Townships 12 and 13 North; thence North along the East R/W line Highway #122 for 311 feet to a point; thence Easterly along

an old fence line 255 feet to a point; thence South 20 1/2 degrees West along an old fence line to the South line of S 1/2 of SE 1/4; thence West with said South line to the Point of Beginning.

35

A part of the South Half of the Southeast Quarter of Section 32, Township 13 North, Range 4 West, described thus: Beginning at the intersection of the East right of way line of State Highway #122 and the township line between Townships 12 and 13 North; thence North along the East right of way line of Highway #122 for 185 feet to a point; thence East 226 feet to a point; thence South 20 1/2 degrees West for 139 feet to the South line of Southeast Quarter; thence West with said South line to the point of beginning.

36

A part of the West Half of Lot 5 of the Northwest Quarter of Section 5, Township 12 North, Range 4 West, described as follows: Beginning at the Northeast corner of the Blue Springs Cemetery as now located; run thence due North 462 feet to the point of beginning; run thence due North 210 feet to a point; thence run due West 210 feet to a point; run thence due South 210 feet to a point; thence due East 210 feet to the point of beginning, containing one (1) acre, more or less.

37

A part of the West Half of Lot 5 of the Northwest Quarter of Section 5, Township 12 North, Range 4 West, described as follows: Beginning at the Northeast corner of the Blue Springs Cemetery as now located; run thence due North 672 feet to the point of beginning; run thence due North 210 feet to a point; run thence due West 210 feet to a point; run thence due South 210 feet to a point; run thence due East 210 feet to the point of beginning, containing one (1) acre, more or less.

duplicate of 36

38

The South Half of the Southeast Quarter of the Southwest Quarter of the Southwest Quarter of Section 32, Township 13 North, Range 4 West, containing 5 acres.

39

A part of the North Half of the Southeast Quarter of the Southwest Quarter of the Southwest Quarter, Section 32, Township 13 North, Range 4 West, described as follows: Beginning at

the Southeast corner of the N 1/2 of the SE 1/4 of the SW 1/4 of the SW 1/4, thence North 294 feet; thence West 131 feet; thence South 294 feet; thence East 131 feet to the Point of Beginning, containing .88 acres, more or less.

40

A part of the East Half of Lot 5 of Northwest Quarter of Section 5, Township 12 North, Range 4 West, described thus: Commence at the Northeast Corner of said E 1/2 of Lot 5 of NW 1/4 and run thence South with East line thereof to the North R/W of Newark-Mt. Carmel Road; thence Northwesterly and with North R/W of said Road to its intersection with the North line of E 1/2 of Lot 5 of NW 1/4; thence East with North line of E 1/2 of Lot 5 of NW 1/4 to the place of beginning, LESS AND EXCEPT, However, the following tract:

A part of the E 1/2 of Lot 5 of NW 1/4 of Section 5, Township 12 North, Range 4 West, described thus: Commencing at the NE corner of the E 1/2 of Lot 5 NW 1/4 thence South along East line thereof for 193 feet to the point of beginning; thence West perpendicular to the East line of Lot 5 for 184 feet; thence South parallel to the East line of Lot 5 and 114 feet; thence East perpendicular to the East line of Lot 5 for 184 feet to the East line of Lot 5; thence North along said East line for 114 feet to the point of beginning.

Two tracts of land being part of the E 1/2 of Lot 5 of the NW 1/4 of Section 32, in Township 12 North, Range 4 West of the 5th Principal Meridian in the City of Newark, Independence County, Arkansas, each tract being more particularly described as follows:

41

TRACT "A" Commencing at the Southeast corner of said E 1/2, Lot 5, NW 1/4, thence run N 81 degrees 37' 44" W, a distance of 56.34 feet to the Point of Beginning on the West R/W Line of Arkansas Highway 233 and the North Line of a Dirt Lane, thence run N 89 degrees 51' 45" W along said lane, a distance of 103.33 feet; thence run N 05 degrees 04' 08" E, a distance of 127.76 feet; thence run N 89 degrees 41' 13" W, a distance of 78.84 feet; thence run N 00 degrees 40' 15" E, a distance of 306.73 feet; thence run S 89 degrees 41' 13" E, a distance of 172.26 feet to the West R/W Line of Arkansas Highway 233; thence run S 00 degrees 40' 15" W along said West R/W Line, a distance of 433.74 feet to the Point of Beginning. Containing 1.50 acres, more or less.

42

TRACT "B" Commencing at the Southeast corner of said E 1/2, of Lot 5, NW 1/4; thence run N 81

degrees 37' 44" W, a distance of 56.34 feet to the intersection of West R/W Line of Arkansas Highway 233 and the North Line of a Dirt Lane; thence run N 89 degrees 51' 45" W along said lane, a distance of 103.22 feet to the Point of Beginning; thence run N 89 degrees 51' 45" W along said lane, a distance of 195.60 feet; thence run N 00 degrees 58' 45" E, a distance of 127.93 feet; thence S 89 degrees 41' 13" E, a distance of 204.71 feet; thence run S 05 degrees 04' 08" W, a distance of 127.76 feet to the Point of Beginning. Containing 0.586 acres, more or less.

43

Part of the East Half of Lot Five of the Northwest Quarter of Section 5, Township 12 North, Range 4 West, described as follows: Beginning at a point on the North line of said Lot Five of Northwest Quarter 200 feet East of the Northwest Corner of the East Half of said Lot Five, run thence South 330 feet; thence East to W.P.A. Road, thence in a Northeasterly direction with said W.P.A. Road to the North line of said Lot Five, thence West with said North Line of Lot Five to the point of beginning estimated to contain 2 acres, more or less, and being all that part of a certain tract described in deed from Walter Chinn to J. R. Prince dated March 9, 1921 lying and being West of W.P.A. Road as same is now located.

IT IS SO ORDERED.

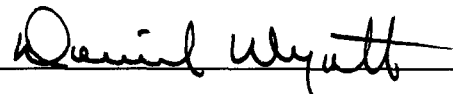

Honorable Judge David Wyatt  
Independence County Judge

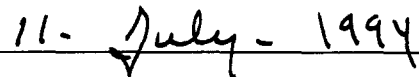

Date

## Jennifer Wheeler

---

**From:** Cynthia Fisher <cynthia.fisher@sos.arkansas.gov>  
**Sent:** Wednesday, May 16, 2018 3:24 PM  
**To:** Jennifer Wheeler  
**Subject:** RE: Independence County: Batesville, Newark and Southside  
**Attachments:** newark city boundaries.jpg

Jennifer,

Attached Newark municipal boundaries from a recent professional survey. This does not match the boundaries on the State map for Newark. Also the Big Bottom precinct show on this survey does not match what the precinct shown below.

**From:** Jennifer Wheeler <Jennifer.Wheeler@arkansas.gov>  
**Sent:** Tuesday, May 15, 2018 11:04 AM  
**To:** Cynthia Fisher <cynthia.fisher@sos.arkansas.gov>  
**Subject:** FW: Independence County: Batesville, Newark and Southside

Cynthia—you have anything for S32-T13N-R4W for Newark? The purple line is supposedly their election precincts and the purple polygon is the city limits. Thinking the city limits and precincts should match there, we're trying to see if we missed an annexation.



S29-T13N-R4W

S32-T13N-R4W

Big Bottom  
Ward 3

Big  
Bottom-Wycot  
Voting Di:

**Jennifer Wheeler – GIS Analyst**

Arkansas GIS Office  
1 Capitol Mall Ste 6D  
Little Rock, AR 72201  
501.682.2929 Office  
501.454.9524 Mobile  
501.407.0790 Fax  
[jennifer.wheeler@arkansas.gov](mailto:jennifer.wheeler@arkansas.gov) Email  
<http://www.gis.arkansas.gov> Web

**From:** Lara Wood  
**Sent:** Friday, March 09, 2018 8:09 AM  
**To:** Jennifer Wheeler <[Jennifer.Wheeler@arkansas.gov](mailto:Jennifer.Wheeler@arkansas.gov)>  
**Cc:** Shelby Johnson <[shelby.johnson@arkansas.gov](mailto:shelby.johnson@arkansas.gov)>; Maria Owen <[Maria.Owen@arkansas.gov](mailto:Maria.Owen@arkansas.gov)>  
**Subject:** Independence County: Batesville, Newark and Southside

Good morning, Jennifer.

I've been having a heck of a time with Independence County. The Clerk sent maps of the cities of Batesville, Newark and Southside, showing their Ward boundaries. I'll spare you the details on Batesville and Southside. But Newark is something you should take a look at. Attached is a screenshot of Newark's Wards (blue) underlying our MUNI

Boundaries (purple). The outline of the wards reflects what the clerk has as the Newark City Limits. As you can see, there's a big discrepancy with our data.

Shelby, if you haven't yet, I'm going to call the Clerk this morning and see if I can get my questions answered.

Is there any chance the Newark muni boundary is on a list to be updated, or is this the official boundary we have from the SoS?

**Lara M. Wood - Senior GIS Analyst**

Arkansas GIS Office

1 Capitol Mall, Ste 6D

Little Rock, AR 72201

501.682.3285 Office

501.551.3292 Cell

501.407.0790 Fax

[Lara.Wood@arkansas.gov](mailto:Lara.Wood@arkansas.gov) Email

<http://www.gis.arkansas.gov> Web

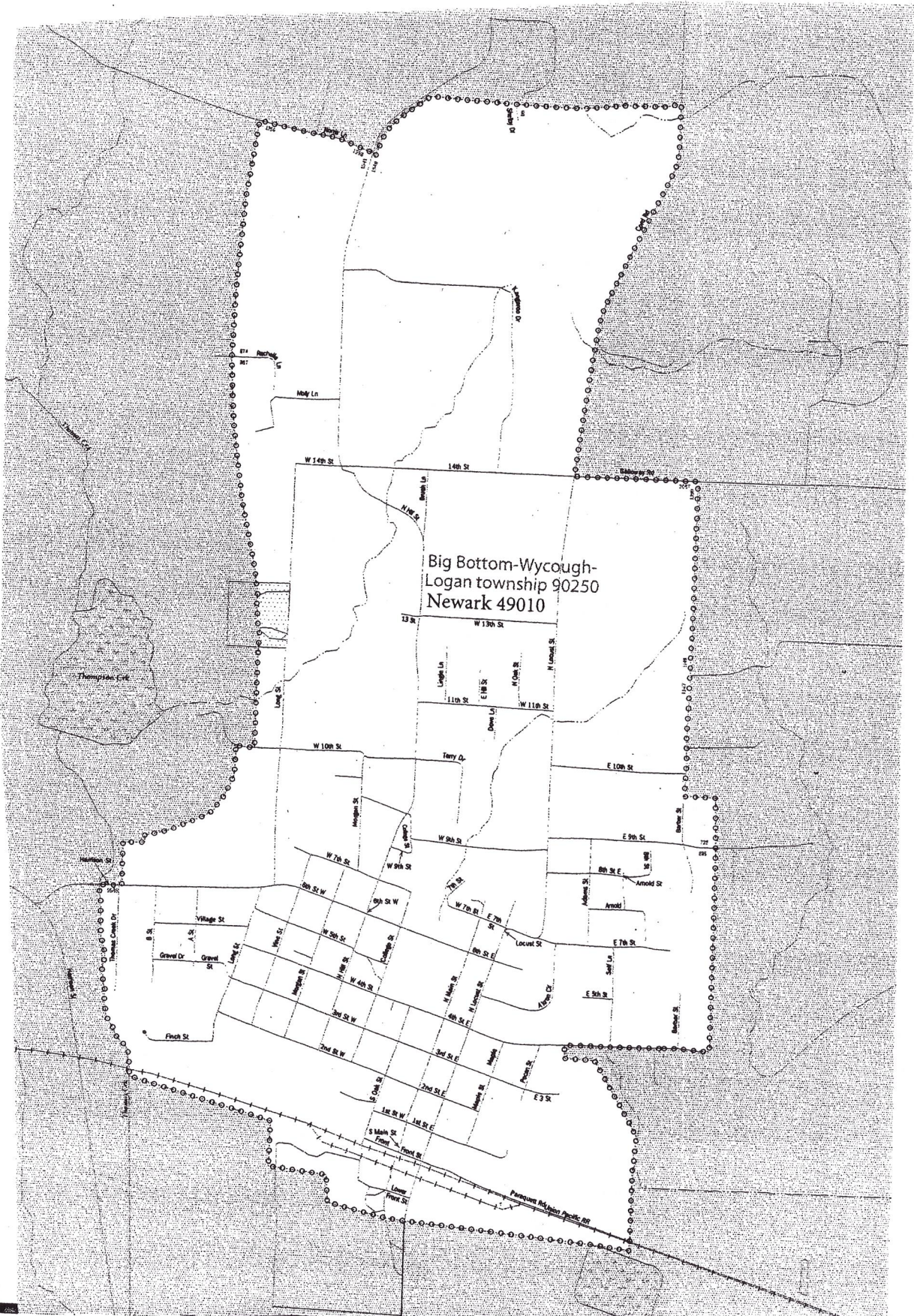

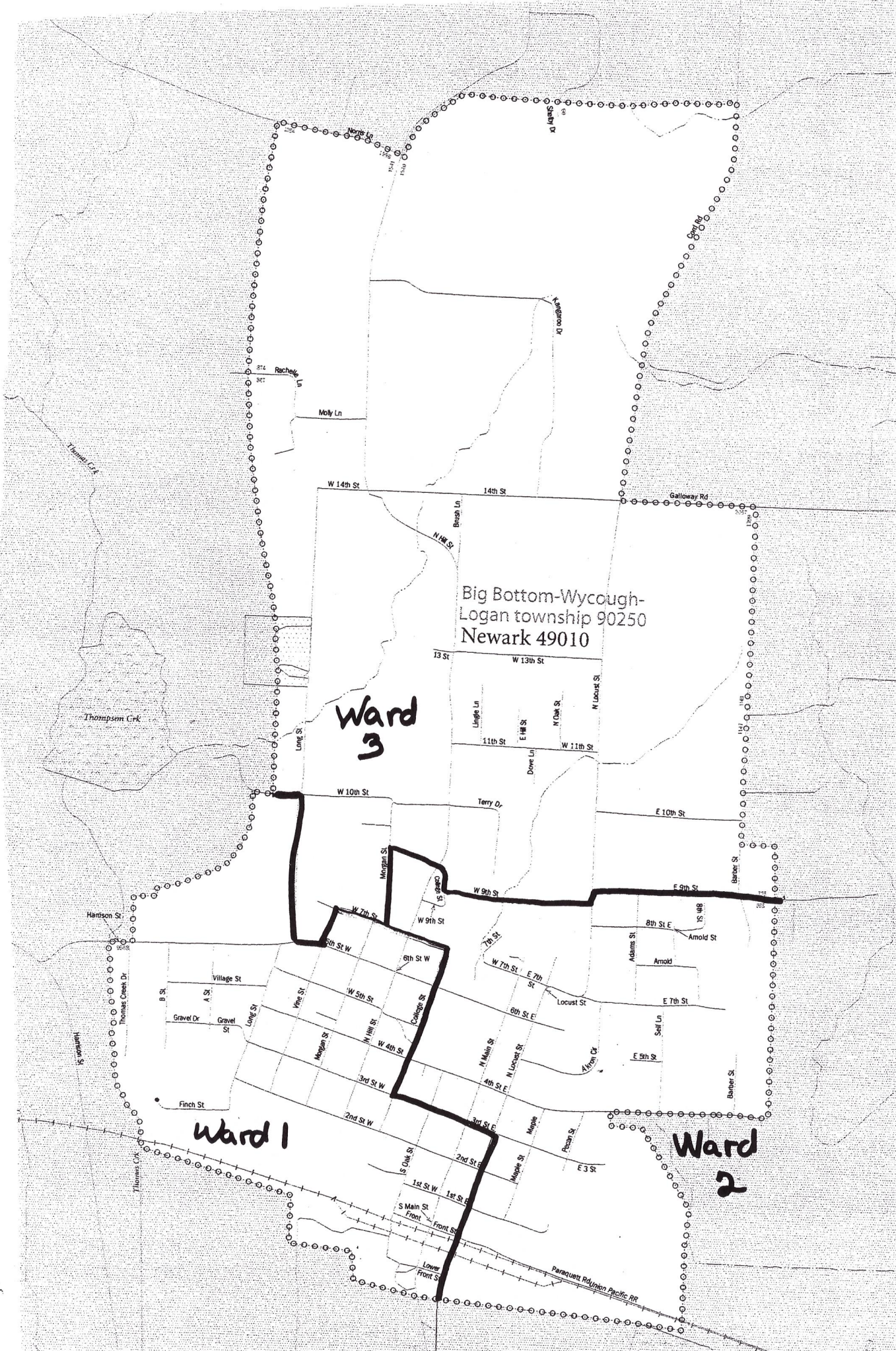

Big Bottom-Wycough-  
Logan township 90250  
Newark 49010

Ward  
3

Ward  
1

Ward  
2

Thompson Crk

Thompson Crk

Harrison St

Thompson Crk

Keokuk St

Rachel Ln

Molly Ln

W 14th St

14th St

Galloway Rd

N.W. St

13 St

W 13th St

Long Ln

11th St

E.W. St

N Oak St

N Locust St

Dove Ln

W 11th St

W 10th St

Terry Dr

E 10th St

W 9th St

W 9th St

E 9th St

W 7th St

W 7th St

E 7th St

W 6th St

W 6th St

E 6th St

W 5th St

W 5th St

E 5th St

W 4th St

W 4th St

E 4th St

W 3rd St

W 3rd St

E 3rd St

W 2nd St

W 2nd St

E 2nd St

W 1st St

W 1st St

E 1st St

S Main St Front

Front St

Lower Front St

Parquetts Rd/Union Pacific RR

Village St

A St

Gravel Dr

Gravel St

Long St

Vine St

Morgan St

College St

W 7th St

W 6th St

W 5th St

W 4th St

W 3rd St

W 2nd St

W 1st St

E 7th St

E 6th St

E 5th St

E 4th St

E 3rd St

Locust St

W 7th St

E 7th St

Arnold St

Arnold

Seal Ln

Barber St

W 7th St

E 7th St

W 7th St

E 7th St

W 7th St

E 7th St

W 7th St

E 7th St

W 7th St

E 7th St

W 7th St

E 7th St

W 7th St

E 7th St

N Main St

N Locust St

N Locust St

N Locust St

N Locust St

N Locust St

N Locust St

N Locust St

N Locust St

N Locust St

N Locust St

N Locust St

N Locust St

N Main St

N Locust St

N Locust St

N Locust St

N Locust St

N Locust St

N Locust St

N Locust St

N Locust St

N Locust St

N Locust St

N Locust St

N Locust St

N Main St

N Locust St

N Locust St

N Locust St

N Locust St

N Locust St

N Locust St

N Locust St

N Locust St

N Locust St

N Locust St

N Locust St

N Locust St

N Main St

N Locust St

N Locust St

N Locust St

N Locust St

N Locust St

N Locust St

N Locust St

N Locust St

N Locust St

N Locust St

N Locust St

N Locust St

N Main St

N Locust St

N Locust St

N Locust St

N Locust St

N Locust St

N Locust St

N Locust St

N Locust St

N Locust St

N Locust St

N Locust St

N Locust St

N Main St

N Locust St

N Locust St

N Locust St

N Locust St

N Locust St

N Locust St

N Locust St

N Locust St

N Locust St

N Locust St

N Locust St

N Locust St

N Main St

N Locust St

N Locust St

N Locust St

N Locust St

N Locust St

N Locust St

N Locust St

N Locust St

N Locust St

N Locust St

N Locust St

N Locust St

N Main St

N Locust St

N Locust St

N Locust St

N Locust St

N Locust St

N Locust St

N Locust St

N Locust St

N Locust St

N Locust St

N Locust St

N Locust St

N Main St

N Locust St

N Locust St

N Locust St

N Locust St

N Locust St

N Locust St

N Locust St

N Locust St

N Locust St

N Locust St

N Locust St

N Locust St

N Main St

N Locust St

N Locust St

N Locust St

N Locust St

N Locust St

N Locust St

N Locust St

N Locust St

N Locust St

N Locust St

N Locust St

N Locust St

N Main St

N Locust St

N Locust St

N Locust St

N Locust St

N Locust St

N Locust St

N Locust St

N Locust St

N Locust St

N Locust St

N Locust St

N Locust St

N Main St

N Locust St

N Locust St

N Locust St

N Locust St

N Locust St

N Locust St

N Locust St

N Locust St

N Locust St

N Locust St

N Locust St

N Locust St