

BAS Correction Part of Historic Annex C-2009-242: City of Austin
 *for Census only - was already in state map

City: Austin
 Mayor: Bernadette Chamberlain

Arkansas Code 14-40-101.

Before an entity undertakes an annexation, consolidation, or detachment proceeding under this chapter, the entity shall coordinate with the Arkansas Geographic Information Systems Office for preparation of legal descriptions and digital mapping for the relevant annexation, consolidation, and detachment areas.

The map contained herein, is evidence, the entity has met requirements of Act 914 of 2015

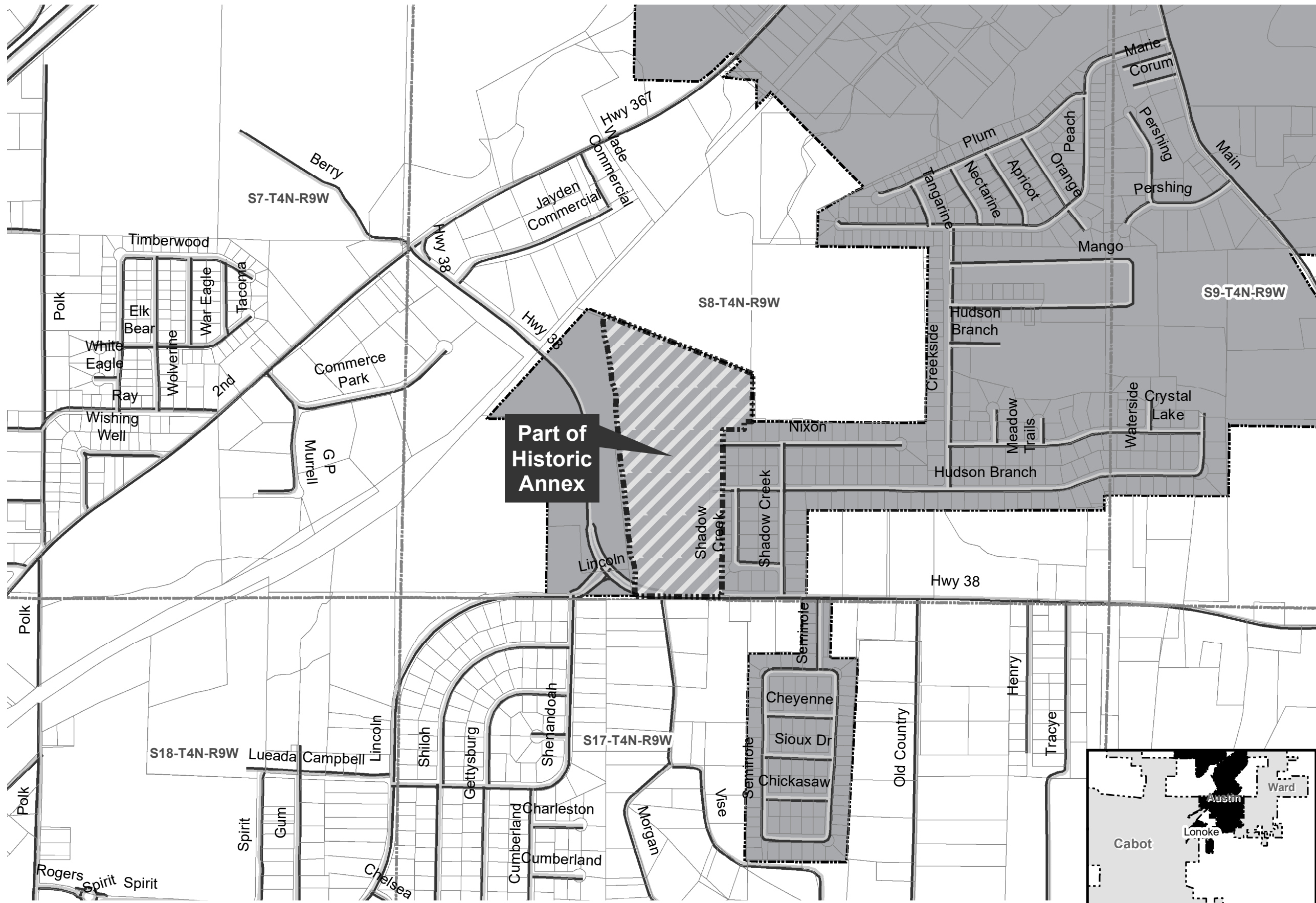

- Proposed Annex
- Sections
- Parcels
- Minor Road
- Existing City
- County Boundary

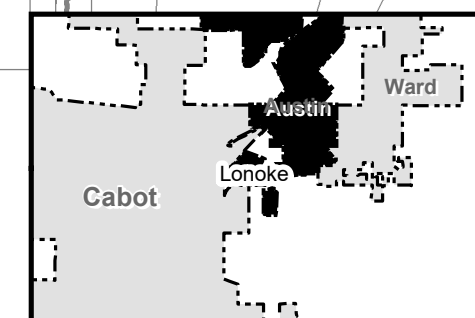
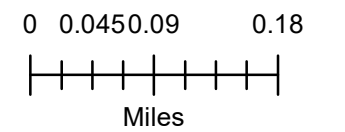



State of Arkansas Secretary of State

Charlie Daniels
Secretary of State

Business & Commercial Services	682-3409
Elections	682-5070
Building & Grounds	682-3407
Communications & Education	683-0057
State Capitol Police	682-5173
Business Office	682-8032
Information Technology	682-3411

January 13, 2010

The Honorable Dawn Porterfield
Lonoke County Clerk
301 North Center
Lonoke, AR 72086

Dear Ms. Porterfield,

The Following Information has been recorded and filed in the Office of the Secretary of State:

Date: December 23, 2009 **County:** Lonoke **City:** Austin

Annexation:	Ordinance No.	~	C-2009-242
	County Order No	~	
	Plat	~	XX—Taylor Made
	Election	-	
	Island	-	
Incorporation:	Ordinance No.	~	
	Co. Order No.	~	
	Plat	~	
	Election	-	

Census Information: The following City or Town has been upgraded or reduced to:

1st Class City -
2nd Class City -
Incorporated Town ~

I have forwarded this information to the Arkansas Municipal League and the Arkansas Highway and Transportation Department and the Arkansas State Data Center. If you have any further questions please do not hesitate to contact me at 1-800-482-1127 or (501) 682-3451.

Sincerely,

Nancy Crockett
Election Services Representative
Arkansas Secretary of State

IN LONOKE COUNTY, ARKANSAS

C-2179-242

TAYLOR MADE DEVELOPMENT, LLC

PETITIONERS

FILED
2009 DEC 23 11:10 AM

ORDER TO ANNEX CERTAIN PROPERTIES INTO THE CITY LIMITS OF AUSTIN, ARKANSAS

NOW on this 3rd day of December, 2009 appears Petitioners, by and through their attorney, Tim Blair. The Court after hearing testimony and reviewing evidence in the above referenced matter does hereby grant the annexation of said properties, filed herein on 12th day of November, 2009, into the city limits of Austin, Arkansas.

IT IS THEREFORE ORDERED ADJUDGED AND DECREED that the said properties filed herein are made part of the City of Austin, Arkansas.

IT IS SO ORDERED.

DATED this 23 day of December, 2009.

Charlie Troutman
JUDGE CHARLIE TROUTMAN

FILED

JAN 13 2010

CHARLIE DANIELS
SECRETARY OF STATE

BY _____

CERTIFIED COPY
STATE OF ARKANSAS, COUNTY OF LONOKE
I, Dawn Porterfield, County Clerk within and to the County and State aforesaid, do hereby certify that the annexed and foregoing instrument of writing is a true and correct copy of Order to Annex Recorded on this 23 day of December 2009 Recorded Book Vol. 13 Page 199
IN TESTIMONY WHEREOF I have hereunto set my hand and affixed the seal of said Court on the 1 day of January 2010
By *[Signature]* Deputy Clerk

Prepared by:
Tim Blair, P.A.
P.O. Box 1386
Cabot, AR 72086
501-628-5000

RECORDED
BOOK 13 PAGE 199

PROOF OF PUBLICATION AND INVOICE FOR LEGAL ADVERTISING

Bill to: Tim Blair Attorney at Law P.O. Box 1386 Cabot, AR 72023



MAIL PAYMENT TO: Central Arkansas Newspapers P. O. Box 428 North Little Rock, AR 72115

Refer to invoice #

AD COPY: NOTICE

Notice is hereby given that there has been filed in the County Court of Lonoke, Arkansas, the petition of Taylor Made Development, LLC and others, asking for the annexation to the City of Austin of the following described lands situated in Lonoke County, Arkansas, and contiguous to said city, to-wit:

PART OF THE SOUTHWEST QUARTER OF SECTION 8, T-4-N, R-9-W, LONOKE COUNTY, ARKANSAS, BEING MORE PARTICULARLY DESCRIBED AS FOLLOWS: COMMENCING AT THE SOUTHEAST CORNER OF THE SOUTHWEST QUARTER OF SECTION 8, T-4-N, R-9-W; THENCE N 89°25'28"W, 269.68 FEET TO THE POINT OF THE BEGINNING; THENCE CONTINUING N 89°25'28"W, 1241.41 FEET; THENCE N 00°41'22"E, 1329.33 FEET; THENCE N 89°33'42"W, 464.66 FEET TO THE SOUTHERLY RIGHT-OF-WAY LINE OF THE UNION PACIFIC RAILROAD; THENCE N43°29'58"E ALONG SAID RIGHT-OF-WAY LINE 105.33 FEET; THENCE CONTINUING ALONG SAID RIGHT-OF-WAY LINE N 42°57'36"E, 1003.62 FEET; THENCE LEAVING SAID RIGHT-OF-WAY LINE S 69°36'22"E, 1311.08 FEET; THENCE S 00°51'53"W, 350.00 FEET; THENCE S 89°58'45"W, 292.99 FEET; THENCE S 00°13'49.18 FEET TO THE POINT OF BEGINNING, CONTAINING 61.30 ACRES, LESS AND EXCEPT THE FOLLOWING:

A plat of said land proposed for annexation is on file with said petition in the office of the Clerk of said Court, and the undersigned has been named by the petitioners as the person authorized to act for them.

The court has fixed the 7th day of December at 10:00 a.m. as the date for a hearing on said petition, and all interested persons are now notified to be present at said Court at the time and date so fixed.

Given this 12th day of November, 2009.

County Clerk

The legal advertising ran on the following dates:

11-18-09 12-02-09 11-25-09

Ad Total: \$ 159.00 Proof of Publication Fee: \$ 5.00 Total Charges: \$ 164.00

FILED JAN 13 2010

PROOF OF PUBLICATION STATE OF ARKANSAS BY [X] COUNTY OF LONOKE [] COUNTY OF PULASKI

CHARLIE DANIELS SECRETARY OF STATE

I do solemnly swear that I am an employee of Stephens Media LLC, owner of said weekly newspaper printed and published in said County, State of Arkansas: That I was an employee of Stephens Media LLC at and during the publication of the annexed legal advertising in the case of:

Notice - Taylor Made Development Annexation to City of Austin

pending in the Court, in said County and at the dates of the several publications of said advertisement stated above, and that during said periods and at said dates said newspaper was printed and has a bona fide circulation in said County, and had a bona fide circulation therein for the period of more than one month before the date of the first publication of said advertisement, and that said advertisement was published in the regular weekly issue of said newspaper as stated above.

Subscribed and sworn to before me this 3rd day of Dec. 20 09 Notary Public Jamie M. Shong My commission expires 7-28-10



RECORDED BOOK 13 PAGE 198

FILED

SEP 28 2009

LONOKE CO. CLERK DAWN PORTERFIELD
BY *[Signature]*

C-2009-242

IN THE LONOKE COUNTY COURT

IN THE MATTER OF ANNEXING TO THE CITY OF AUSTIN, ARKANSAS,
CERTAIN TERRITORY CONTIGUOUS TO THE SAID CITY OF AUSTIN,
ARKANSAS

PETITION

We, Taylor Made Development, LLC, as property owner of the following described area, do hereby petition the County Court of Lonoke County, Arkansas, to annex the following lands to the City of Austin, Arkansas. We further state that the petition is signed by a majority of the real estate owners owning more than one half of the acreage in said area, and do further by our petition appoint J. D. Buffalo to act on behalf of the petitioner in presenting this matter to the court.

Description of the area to be annexed to the City of Austin, Arkansas:

**PART OF THE SOUTHWEST QUARTER OF SECTION 8, T-4-N, R-9-W,
LONOKE COUNTY, ARKANSAS, BEING MORE PARTICULARLY
DESCRIBED AS FOLLOWS:**

**COMMENCING AT THE SOUTHEAST CORNER OF THE SOUTHWEST
QUARTER OF SECTION 8, T-4-N, R-9-W; THENCE N89°25'28"W, 269.68 FEET
TO THE POINT OF BEGINNING; THENCE CONTINUING N89°25'28"W,
1241.41 FEET; THENCE N00°41'22"E, 1329.33 FEET; THENCE N89°33'42"W,
464.66 FEET TO THE SOUTHERLY RIGHT-OF-WAY LINE OF THE UNION
PACIFIC RAILROAD; THENCE N43°29'58"E ALONG SAID RIGHT-OF-WAY
LINE 105.33 FEET; THENCE CONTINUING ALONG SAID RIGHT-OF-WAY
LINE N42°57'36"E, 1003.62 FEET; THENCE LEAVING SAID RIGHT-OF-WAY
LINE S69°36'22"E, 1311.08 FEET; THENCE S00°51'53"W, 350.00 FEET;
THENCE S89°58'45"W, 292.99 FEET; THENCE S00°1349.18 FEET TO THE
POINT OF BEGINNING, CONTAINING 61.30 ACRES, LESS AND EXCEPT
THE FOLLOWING:**

NAME:

ADDRESS:

Taylor Made Development, LLC

11 Shenandoah Cove, Cabot, AR 72023

[Signature]

J.D. Buffalo
Taylor Made Development, LLC Member

FILED

JAN 13 2010

CHARLIE DANIELS
SECRETARY OF STATE

BY _____

RECORDED

BOOK 13 PAGE 197

CERTIFIED COPY

STATE OF ARKANSAS, COUNTY OF LONOKE

I, Dawn Porterfield, County Clerk within and to the County and State aforesaid, do hereby certify that the annexed and foregoing instrument of writing is a true and correct copy of Map Recorded on this 11 day of January, 2010 Recorded Book Vol. 13 Page 222

IN TESTIMONY WHEREOF I have hereunto set my hand and affixed the seal of said Court on the 11 day of January, 2010
By Dawn Porterfield Clerk
John W. ... Deputy Clerk

FILED

JAN 07 2010

LONOKE, CLERK DAWN PORTERFIELD
BY [Signature]

Map 38

ANNEXED AREA
TO AUSTIN

FILED

JAN 13 2010

CHARLIE DANIELS
SECRETARY OF STATE

BY

RECORDED

BOOK 13 PAGE 222

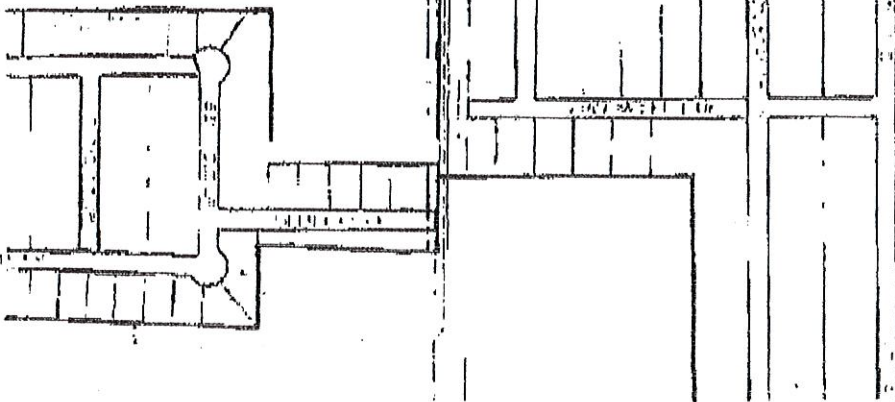

7201
/ 11/12/09 11:13 AM

NOTICE

Notice is hereby given that there has been filed in the County Court of Lonoke, Arkansas, the petition of Taylor Made Development, LLC and others, asking for the annexation to the City of Austin of the following described lands situated in Lonoke County, Arkansas, and contiguous to said city, to-wit:

PART OF THE SOUTHWEST QUARTER OF SECTION 8, T-4-N, R-9-W, LONOKE COUNTY, ARKANSAS, BEING MORE PARTICULARLY DESCRIBED AS FOLLOWS:
COMMENCING AT THE SOUTHEAST CORNER OF THE SOUTHWEST QUARTER OF SECTION 8, T-4-N, R-9-W; THENCE N 89°25'28"W, 269.68 FEET TO THE POINT OF THE BEGINNING; THENCE CONTINUING N 89°25'28"W, 1241.41 FEET; THENCE N 00°41'22"E, 1329.33 FEET; THENCE N 89°33'42"W, 464.66 FEET TO THE SOUTHERLY RIGHT-OF-WAY LINE OF THE UNION PACIFIC RAILROAD; THENCE N43°29'58"E ALONG SAID RIGHT-OF-WAY LINE 105.33 FEET; THENCE CONTINUING ALONG SAID RIGHT-OF-WAY LINE N 42°57'36"E, 1003.62 FEET; THENCE LEAVING SAID RIGHT-OF-WAY LINE S 69°36'22"E, 1311.08 FEET; THENCE S 00°51'53"W, 350.00 FEET; THENCE S 89°58'45"W, 292.99 FEET; THENCE S 00°13'49.18 FEET TO THE POINT OF BEGINNING, CONTAINING 61.30 ACRES, LESS AND EXCEPT THE FOLLOWING:

A plat of said land proposed for annexation is on file with said petition in the office of the Clerk of said Court, and the undersigned has been named by the petitioners as the person authorized to act for them.

The court has fixed the 7th day of December at 10:00 a.m. as the date for a hearing on said petition, and all interested persons are now notified to be present at said Court at the time and date so fixed.

Given this 12th day of November, 2009.

Dawn Porterfield
County Clerk

RECORDED
BOOK 13 PAGE 203