

BAS Correction - Part of Historic Annex Incorporation of 1898: City of Pocahontas
 *for Census only - was already in state map

City: Pocahontas
 Mayor: Kary Story

Arkansas Code 14-40-101.

Before an entity undertakes an annexation, consolidation, or detachment proceeding under this chapter, the entity shall coordinate with the Arkansas Geographic Information Systems Office for preparation of legal descriptions and digital mapping for the relevant annexation, consolidation, and detachment areas.

The map contained herein, is evidence, the entity has met requirements of Act 914 of 2015

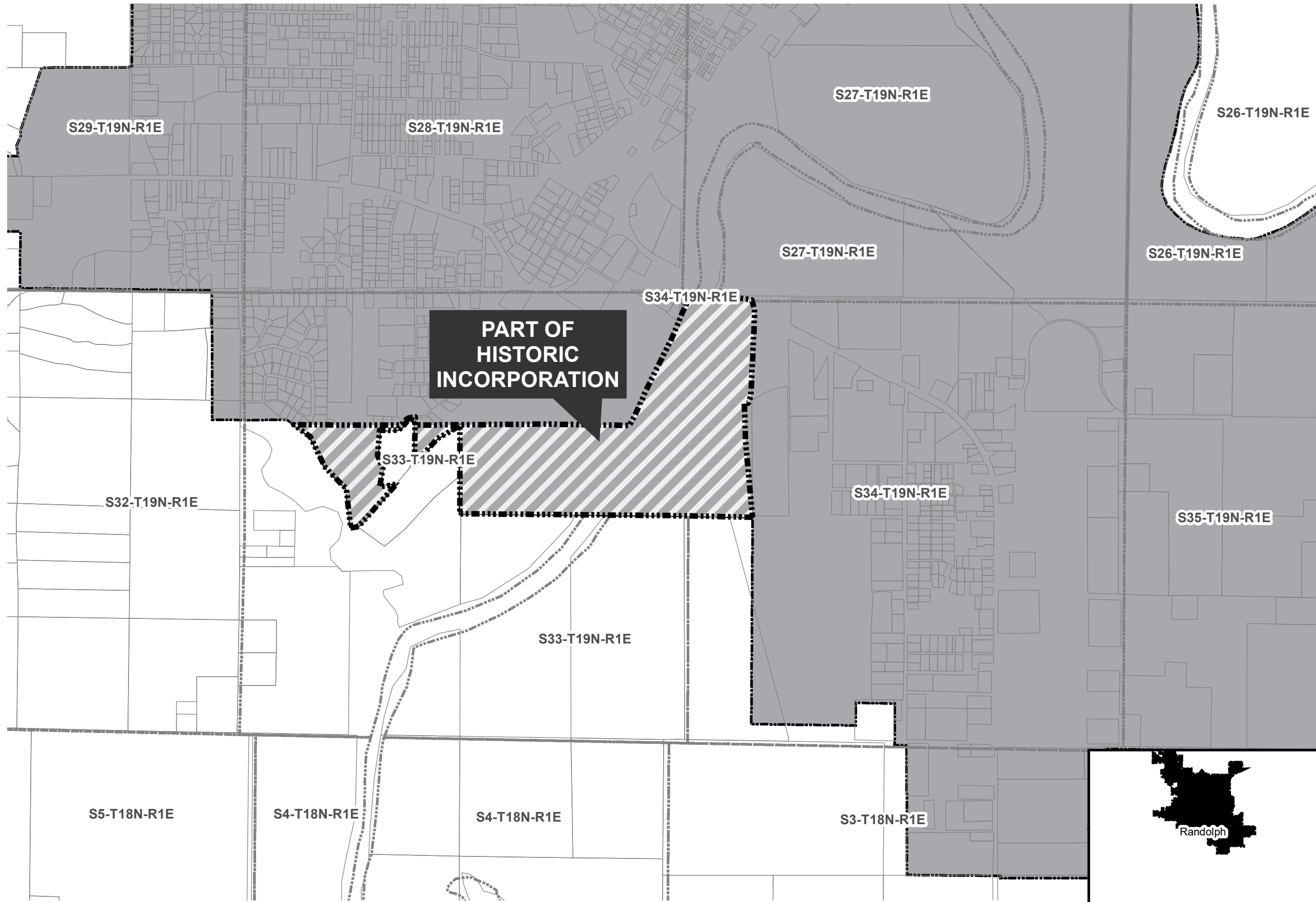

-  Proposed Annex
-  Sections
-  Parcels
-  Existing City
-  Neighboring City
-  County Boundary

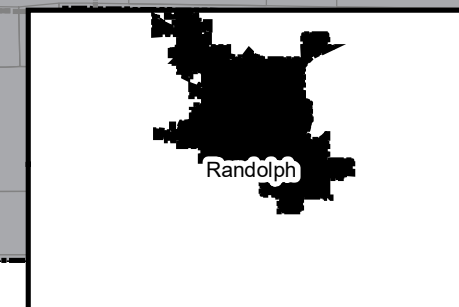
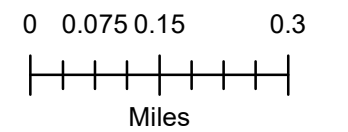

Randolph County Court Record

April adj. term May 16" 1898 first day of term,

Monday morning
May 16" 1898

Court met pursuant
to adjournment present and presiding
Honorable Keith Conner Judge of said
County Court

In the manner of the annexation
of certain territory to the incor-
porated town of Pechonora

Now on
this day this cause coming on to
be heard and it being the day fixed by
the order of this Court for the hearing
of the Petition herein, comes the Peti-
tioner the Incorporated Town of
Pechonora by its agent and attor-
ney Geo. S. Black and it appearing
to the Court that due notice of the
hearing of the Petition herein had
been given by publication in the Rand-
olph Herald a weekly newspaper in
Randolph County Arkansas having a
bona fide circulation therein for three
consecutive weeks next before this date
and further appearing to the Court
that no remonstrance has been filed
to said petition and the Court being
fully advised in the premises is of

opinion that the prayer of said petition should be granted and that the following Territory town: all that part of the North half of section Twenty one (21) not now included in the corporate limits of said incorporated town also all that part of the North half of section Twenty two (22) not now included in the corporate limits of said town, also all that part of section Twenty seven (27) lying on both sides of Black river and not now included in the corporate limits of said incorporated town, also all of section Twenty eight (28) except the west half of the Southwest quarter, not now included in the corporate limits of said incorporated town, also the Northeast quarter of section thirty three (33) both sides of Black river not now included in the corporate limits of said town, also the North half of section thirty four (34), all of said above described territory being in township Nineteen (19), North of the Base line in range one east of the 3rd principal meridian and in Randolph County Arkansas and contiguous to the present corporate limits of said incorporated town should be annexed to include in and become a part of the Municipal Corporation of the incorporated

all of sec 28 except the W² of SW⁴
 S² Sec 21, S² Sec 22, Sec 27
 N² Sec 34, NE⁴ of Sec 33
 Township 19 North Range One (1) East
 5 P.M. Red spot in SW corner of SW⁴
 Sec 29 denotes Court house.
 Red circular line denotes present
 bar peramb limits and it is proposed
 to annex all the territory above described
 except that contained in said circular
 line up to the west Bank of Black river.
Scale two inches to the mile.

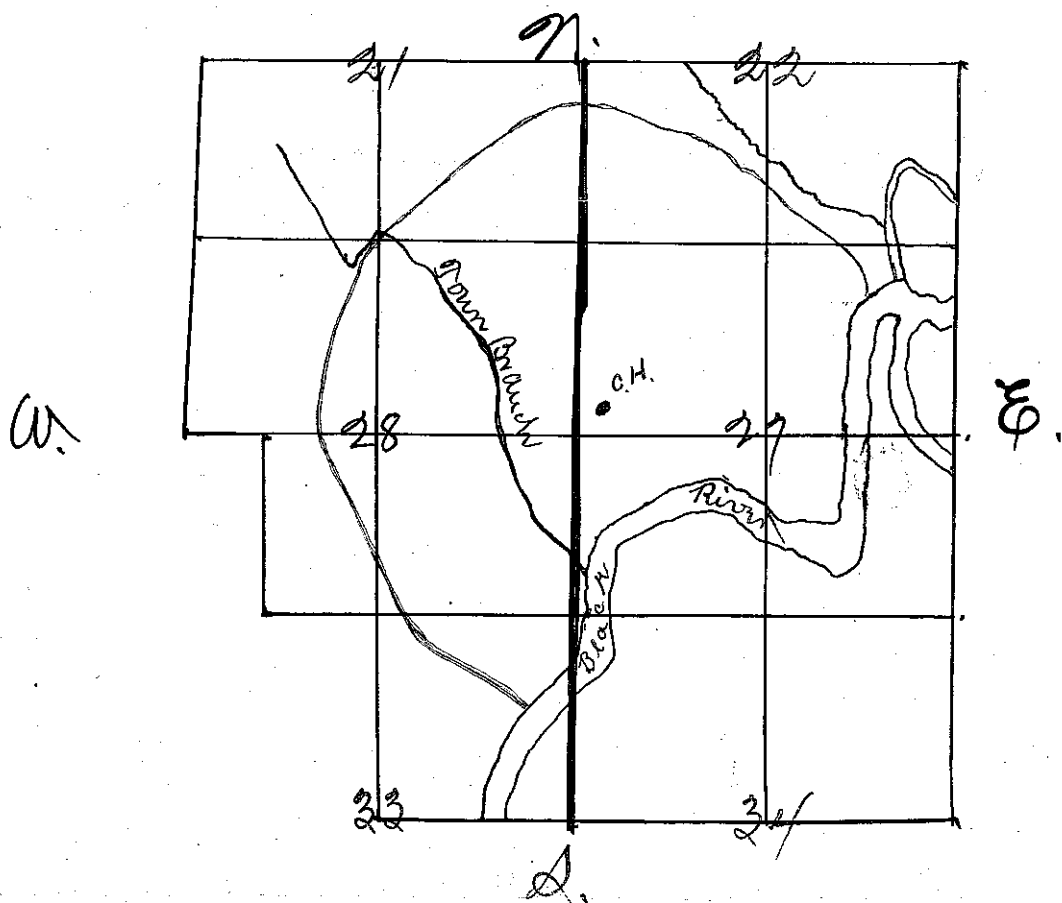

Incorporated Town of Pocahontas
 Randolph County Ark and proposed
 Territory to be annexed thereto.

town of Peckahontas. It is therefore
by the court ordered considered and
adjudged that all of the Territory here
in before described not now included
within the corporate limits of the
Incorporated town of Peckahontas be
and the same is hereby declared to be
a part of and included in the corpo-
rate limits of said Incorporated town
and it is further ordered that the
Clerk of this court make out two
certified transcripts of the proceedings
herein, one of which he shall trans-
mit to the secretary of state and the
other to the town council of said
Incorporated town. Further that said
Incorporated town shall pay all the
costs of this proceeding.

State of Arkansas }
County of Raudolph } ss.

I, Ben A Brown
Clerk of the Circuit Court and Ex Offi-
cio County Clerk of the above named
County and State do hereby certify that
the above and within pages of writing
are a true correct and complete copy
of an order of the County Court as it
now appears on Raudolph County
Court Records^{78, 79} at Pages 78 and 79,
together with a map on plat showing
Territory embraced in the annexation.

to said incorporated town of Peckham.
In witness whereof I have hereunto
set my hand and affixed ~~my~~ ~~offi-~~
~~cial~~ my official seal on this the
13th day of June A.D. 1898

Ben A Brown Clerk

By Tom Biggins