

BAS Correction Part of Historic Annex Res 45 : City of Viola
***for Census only - was already in state map**

City: Viola
 Mayor: Lowell "Jackie" Estes, Jr.

Arkansas Code 14-40-101.

Before an entity undertakes an annexation, consolidation, or detachment proceeding under this chapter, the entity shall coordinate with the Arkansas Geographic Information Systems Office for preparation of legal descriptions and digital mapping for the relevant annexation, consolidation, and detachment areas.

The map contained herein, is evidence, the entity has met requirements of Act 914 of 2015

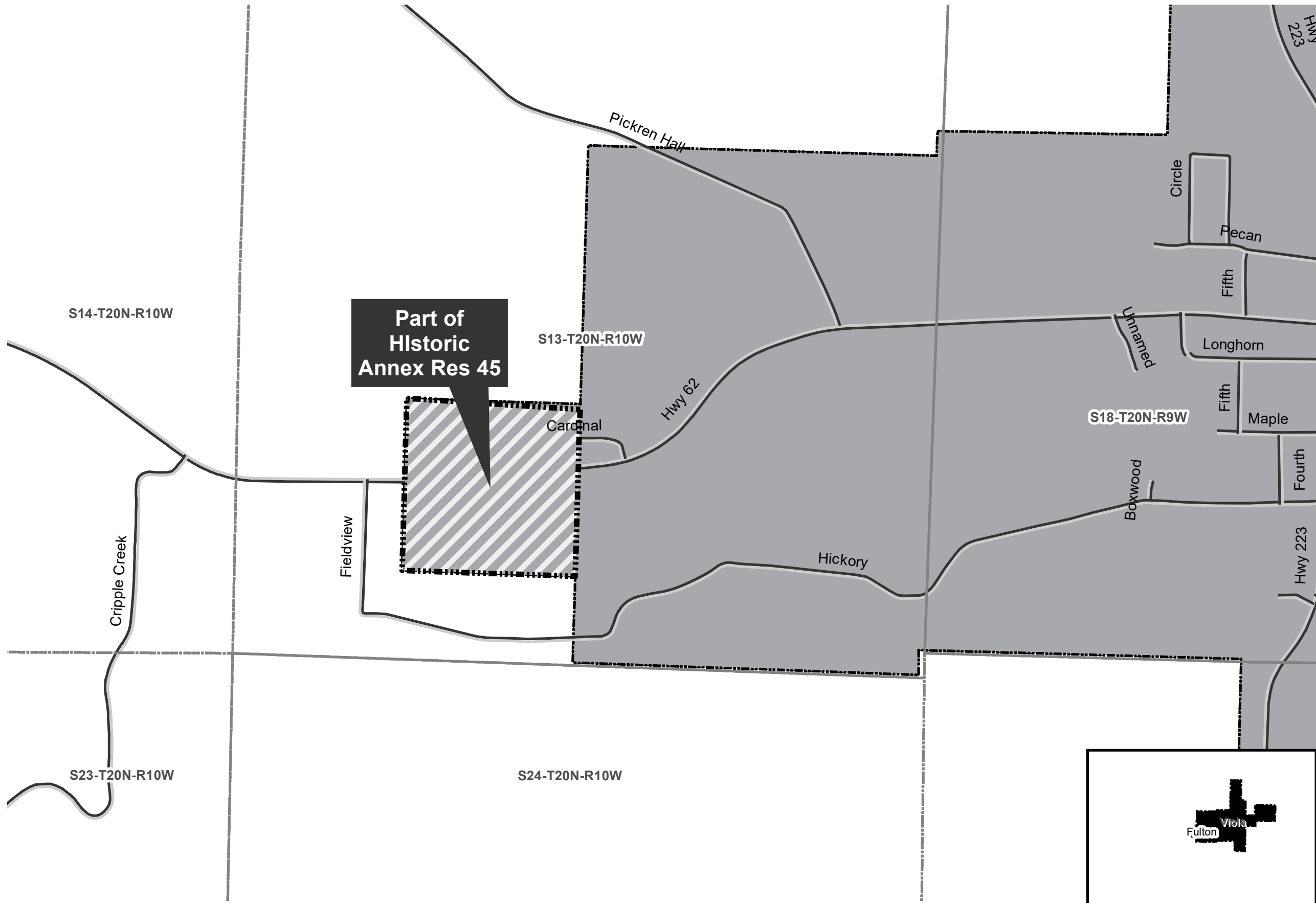

- Proposed Annex
- Sections
- Parcels
- Minor Road
- Existing City
- Neighboring City
- County Boundary

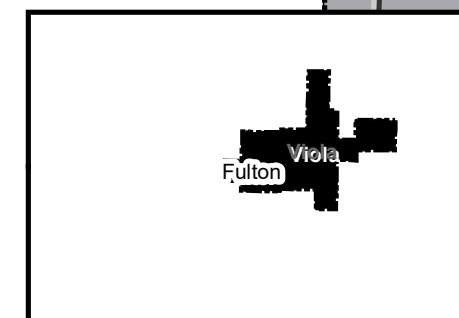
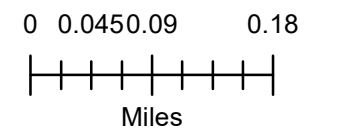

E. H. LAMORE

ATTORNEY AT LAW
Office on Elm Street
P. O. Box No. 8
SALEM, ARKANSAS

May 12, 1964

Hon. Kelly Bryant,
Secretary of State
Little Rock, Arkansas

Dear Sir:

In compliance with Section 15-305 of Cumulative Pocket Supplement of Annotated Arkansas Statutes of Volume 2-B,

The County Clerk, L. W. Love, and myself are mailing to you enclosed a transcript of the proceedings of Annexation of Territory to the Town of Viola, Fulton County, Arkansas.

(By James Montgomery and others, Petitioners.)

Very sincerely yours,

L. W. Love

COUNTY CLERK OF FULTON COUNTY, ARKANSAS

E. H. Lamore

ATTORNEY FOR PETITIONERS FOR ANNEXATION

FILED

MAY 13 1964

KELLY BRYANT
SECRETARY OF STATE

BY _____

TRANSCRIPT
O F
P R O C E E D I N G S O F A N N E X A T I O N O F T E R R I T O R Y
T O
T H E T O W N O F V I O L A , F U L T O N C O U N T Y , A R K A N S A S
(B Y J A M E S M O N T G O M E R Y A N D O T H E R S)

Copy to Town Recorder, Viola, Arkansas
Copy to Secretary of State, Little Rock, Arkansas, and
Copy to Director of the Tax Division
Arkansas Public Service Commission
Justice Building
Little Rock, Arkansas

CERTIFICATE OF PUBLICATION

LEGAL NOTICE

IN THE COUNTY COURT OF FULTON COUNTY, ARKANSAS James Montgomery, Roy T. Richmond, and others, Petitioners

NO. 12 NOTICE OF PETITION FOR ANNEXATION

Notice is hereby given that there has been filed in the Clerk's Office of the County Court of Fulton County, Arkansas, a petition containing the signatures of a majority of the owners of the following property touching and contiguous to the Town of Viola, Fulton County, Arkansas:

Part of the NE 1/4 and part of the NW 1/4 in Section 18; Twp. 20 N. R. 9 West of the 5th P.M. in Arkansas, Also Part of SE 1/4 and part of SW 1/4 in Section 7, Twp. 20 N R 9 West of 5th P.M. Also Part of the NE 1/4 and part of SW 1/4, Section 13, Twp. 20 N R 9 W, 5th P.M., Also Part of the NW 1/4 of NE 1/4 of Section 19, Twp. 20 N. R 9 W. 5th P.M. All of said property in Fulton County, Arkansas and more particularly described in said petition

Said Pefition will come up for hearing on the 2 Day of May, 1964 in the County Judge's Office in the Courthouse in Salem, Fulton County, Arkansas between the hours of 8 a.m. and 6 p.m.

L. W. Love, Clerk of the County Court.

E. H. LaMore, Attorney and Agent for Petitioners, Address P.O. Box 8, Salem, Arkansas. Telephones TW 5-3491 and TW 5-3488 33-3z

I, Don Baugett do solemnly swear that I am editor of The Salem Headlight; that said newspaper is printed and published in Salem, Fulton County, Arkansas, and has a bona-fide circulation in said county, and that the annexed advertisement was published in said newspaper for 3 consecutive issues, as follows:

- The first insertion on the 2 day of April 1964
Second insertion on the 7 day of April 1964
Third insertion on the 16 day of April 1964
Fourth insertion on the _____ day of _____ 19__
Fifth insertion on the _____ day of _____ 19__
Sixth insertion on the _____ day of _____ 19__

Don Baugett

Subscribed and sworn to before me this 20 day

of April, 1964

L. W. Love

PRICE \$ 17.08

NOTE: Full cost of Publication of Notices on all Court cases is due and must be paid on or before delivery of this Certificate of Publication.

The cost of this Publication is computed in accordance with the charges duly set by State Law.

On Notices by Publication for Municipalities, School Districts, Counties, the State, or other branches of government, the cost of publication is to be paid in regular procedure.

IN THE FULTON COUNTY COURT
FULTON COUNTY, ARKANSAS

James Montgomery,
Tommy Richmond
Myrtle (Orr) Smith
E. R. Carroll
Fred Newberry
W. M. Dawson
Forest Beaver
Hayden Smith
T. T. Smith
Henry Stephens
Elmer Upton
Will Batterton
Frank Batterton
Jim Felts
Ray Faulkenberry
Mrs. G. R. Lancaster
Donald Collins, and
John Sherman

-----Petitioners

PETITION FOR ANNEXATION

Comes James Montgomery, Tommy Richmond, Myrtle (Orr) Smith, E. R. Carroll, Fred Newberry, W. M. Dawson, Forest Beaver, Hayden Smith, T. T. Smith, Henry Stephens, Elmer Upton, Will Batterton, Frank Batterton, Jim Felts, Ray Faulkenberry, Mrs. G. R. Lancaster, Donald Collins, and John Sherman, petitioners herein, and for their petition would state and show to the Court:

That the undersigned petitioners are a majority in value and are all the property owners and the only property owners, and own the entire acreage of the following described property, to-wit:

$\frac{1}{2}$ OF $\frac{1}{4}$ OF $\frac{1}{4}$ OF NE $\frac{1}{4}$; -E $\frac{1}{2}$ OF NE $\frac{1}{4}$ OF NW $\frac{1}{4}$; -AND NW $\frac{1}{4}$ OF NE $\frac{1}{4}$, ALL IN SECTION 18, TWP. 20 N. R. 9 W. 5th. P. M., ALSO
W $\frac{1}{2}$ OF NW $\frac{1}{4}$ OF SE $\frac{1}{4}$; -E $\frac{1}{2}$ OF SE $\frac{1}{4}$ OF SW $\frac{1}{4}$; - W $\frac{1}{2}$ OF SW $\frac{1}{4}$ OF SE $\frac{1}{4}$; AND E $\frac{1}{2}$ OF SE $\frac{1}{4}$ OF SW $\frac{1}{4}$, ALL IN SECTION 7 TWP 20 N. R. 9 W. 5th. P. M., ALSO
S $\frac{1}{2}$ OF NE $\frac{1}{4}$ OF SW $\frac{1}{4}$; -N $\frac{1}{2}$ OF SE $\frac{1}{4}$ OF SW $\frac{1}{4}$; - AND SE $\frac{1}{4}$ OF NE $\frac{1}{4}$; ALL IN SECTION 13, TWP 20 N. R. 10 W. 5th. P. M., ALSO
NW $\frac{1}{4}$ OF NE $\frac{1}{4}$ IN SECTION 19 TWP. 20 N. R. 9 W. 5th. P. M.
ALL OF SAID PROPERTY IN FULTON COUNTY, ARKANSAS.

Which property touches and is contiguous to the Town of Viola in the County of Fulton and State of Arkansas. An accurate map of said territory is marked "EXHIBIT A", and attached to this petition and made a part thereof as the law requires.

That said property owners in value desire that said property be annexed and become a part of the Town of Viola and they herewith name Attorney, E. H. LaMore of Salem, Arkansas, as being the authorized agent and attorney for these petitioners to act in their behalf with regard to said annexation.

Wherefore, the premises being seen and understood by the Court, Petitioners would pray and ask that the Court make and enter its order annexing the above described property and that it be added to and included within the boundaries of the Town of Viola.

RESPECTFULLY SUBMITTED

T. T. Smith
Roy T. Richmond
Fred Newberry
Forest Beaver
Ray Faulkenberry
James Montgomery
Jim Felts
W. M. Dawson

Henry H. Stephens
Elmer Upton
Mrs. G. R. Lancaster
Frank Batterton
W. R. Batterton
Erby Carroll
Myrtle Orr Smith by E. R. Carroll
Donald D. Collins

SHEET NUMBER TWO

(Continuation of Signatures to Petition to Annex)

Hayden Smith
John Sherman

James Montgomery, Tommy Richmond, Myrtle (Orr) Smith, E. R. Carroll, Fred Newberry, W. M. Dawson, Forest Beaver, Hayden Smith, T. T. Smith, Henry Stephens, Elmer Upton, Will Batterton, Frank Batterton, Jim Felts, Ray Faulkenberry, Mrs. G. R. Lancaster, Donald Collins, and John Sherman, being duly sworn say:

That they are the petitioners above named, and that they have read the foregoing petition and know the contents thereof and that the facts therein and set forth are true as they verily believe.

Subscribed and sworn to before me this the 2 Day of April 1964.

(Seal)

L. W. Love
County Clerk.

Filed 2nd day of Apr, 1964.

L. W. Love
L. W. Love, Clerk

6985 H

6064

PROPOSED ANNEXATION TO THE TOWN OF VIOLA
 FULTON COUNTY, ARKANSAS
 (MAP)

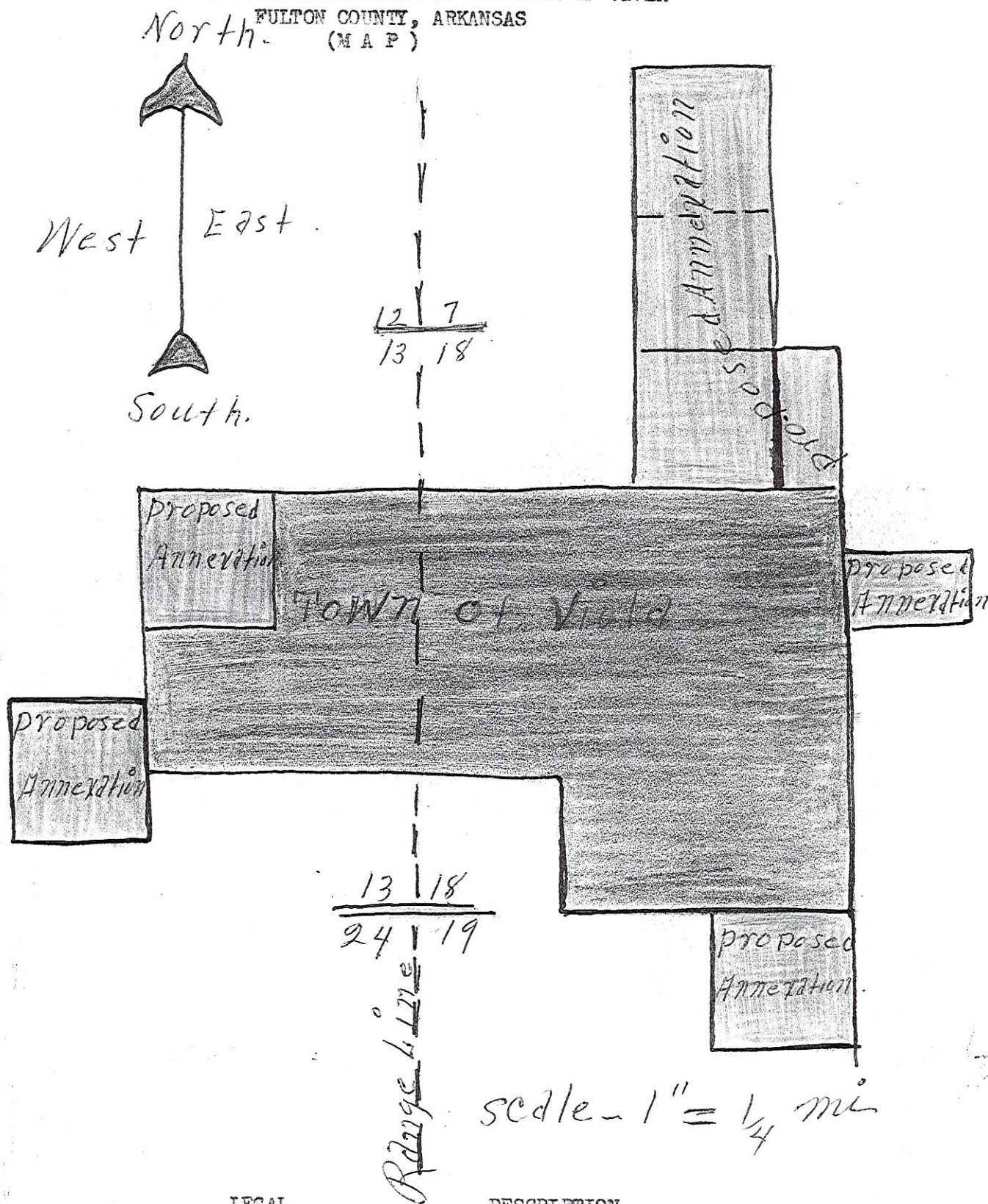

LEGAL DESCRIPTION
 $W\frac{1}{2}$ NW $\frac{1}{4}$ SE $\frac{1}{4}$; E $\frac{1}{2}$ of SE $\frac{1}{4}$ of SW $\frac{1}{4}$; W $\frac{1}{2}$ of SW $\frac{1}{4}$ of SE $\frac{1}{4}$ and E $\frac{1}{2}$ and NE $\frac{1}{4}$ of SW $\frac{1}{4}$ all in Section 7 Township 20 N. Range 9 West of the 5th. P. M. Also, E

E $\frac{1}{2}$ of NE $\frac{1}{4}$ of NW $\frac{1}{4}$; NW $\frac{1}{4}$ of NE $\frac{1}{4}$ all in Section 18, Township 20 N. Range 9 West of the 5th. P. M., also S $\frac{1}{2}$ of SE $\frac{1}{4}$ of NE $\frac{1}{4}$ in Sec. 18, Twp. 20 N. R. 9 W. of 5th. P. M. in Ark. Also S $\frac{1}{2}$ of NE $\frac{1}{4}$ of SW $\frac{1}{4}$ in Section 13, Township 29 N. Range 10 West of the 5th. P. M., also SE $\frac{1}{4}$ of NE $\frac{1}{4}$ in Sec. 13, Township 20 N. Range 10 West of the 5th. P. M., also N $\frac{1}{2}$ of SE $\frac{1}{4}$ of SW $\frac{1}{4}$ Sec. 13, Twp. 20 N. Range 10 West of the 5th. P. M., also NW $\frac{1}{4}$ of NE $\frac{1}{4}$ in Section 19, Township 28 N. Range 9 West of the 5th. P. M. in Arkansas

Exhibit "A"

IN THE COUNTY COURT
OF
FULTON COUNTY, ARKANSAS

James Montgomery,
Tommy Richmond
Myrtle (Orr) Smith
E. R. Carroll
Fred Newberry
W. M. Dawson
Forest Beaver
Hayden Smith
T. T. Smith
Henry Stephens
Elmer Upton
Will Batteredton
Frank Batteredton
Jim Felts
Ray Faulkenberry
Mrs. G. R. Lancaster
Donald Collins, and
John Sherman-----Petitioners

C O U R T O R D E R

On this the 2nd Day of May, 1964, the above entitled cause of action coming on to be heard and having been submitted to the Court upon the verified petition of the Petitioners, with their sworn statements thereto, notice of Petition for Annexation with the Proof of Publication thereof in the Salem Headlight, a weekly newspaper having a bonafide circulation for and within Fulton County, Arkansas for the time required by law, the statements of E. H. LaMore, Attorney and Agent for the Petitioners, the Court finds:

That the Petitioners are a majority in value and are all the property owners and the only property owners in said tract sought to be annexed and that they own the entire acreage of the said tract which is described as follows:

S $\frac{1}{2}$ OF SE $\frac{1}{4}$ OF NE $\frac{1}{4}$; E $\frac{1}{2}$ OF NE $\frac{1}{4}$ OF NW $\frac{1}{4}$; NWD NW $\frac{1}{4}$ OF NE $\frac{1}{4}$, ALL IN SECTION 18, TWP. 20 N. R. 9 W. 5th. P. M., ALSO,
W $\frac{1}{2}$ OF NW $\frac{1}{4}$ OF SE $\frac{1}{4}$; E $\frac{1}{2}$ OF SE $\frac{1}{4}$ OF SW $\frac{1}{4}$; W $\frac{1}{2}$ OF SW $\frac{1}{4}$ OF SE $\frac{1}{4}$; AND E $\frac{1}{2}$ OF SE $\frac{1}{4}$ OF SW $\frac{1}{4}$ ALL IN SECTION 7 TWP. 20 N. R. 9 W. 5th. P. M., ALSO
S $\frac{1}{2}$ OF NE $\frac{1}{4}$ OF SW $\frac{1}{4}$; N $\frac{1}{2}$ OF SE $\frac{1}{4}$ OF SW $\frac{1}{4}$; AND SE $\frac{1}{4}$ OF NE $\frac{1}{4}$; ALL IN SECTION 13, TWP. 20 N. R. 10 W. 5th. P. M., ALSO
NW $\frac{1}{4}$ OF NE $\frac{1}{4}$ IN SECTION 19 TWP. 20 N. R. 9 W. 5th. P. M.
ALL OF SAID PROPERTY IN FULTON COUNTY, ARKANSAS.

Which property touches and is contiguous to the Town of Viola in the County of Fulton and State of Arkansas and that an accurate map of said territory is marked "MINUT A", and has been attached to the petition of the petitioners and filed in the Clerk's Office as required by law and that said territory should be annexed and become a part of the Incorporated Town of Viola.

It is therefore, considered, ordered, and adjudged by the Court, that said property be annexed and made a part of the Town of Viola and included within its boundaries provided the Incorporated Town of Viola, by Ordinance or by Resolution accept said territory and the annexation thereof to the Town of Viola.

It is further ordered and directed that in accordance with Section 19-303 and 19-304 of the Arkansas Statutes, that unless notice is given of the filing of objections to the Court's action herein that at the expiration of the period of Thirty days (30) from the date of this order, the proceedings herein before this Court and the order herein shall in all things be confirmed; and after the expiration of said thirty days, the Clerk of this Court is ordered and directed to prepare three (3) copies of the entire proceedings before this Court including said plat and a copy of the Town's Resolution accepting the Territory herein which copies shall be certified by said Clerk; and he shall forward one copy of said proceedings to the Secretary of State at Little Rock, Arkansas, one copy to the Director of the Tax Division of Arkansas Public Service Commission, Little Rock, Arkansas, and one copy to the Town Recorder, Town of Viola, Arkansas provided the Town of Viola has accepted the annexation as above stated.

RESOLUTION NUMBER 45
(Of the Town of Viola by the Town Council)

Whereas the County Court of Fulton County, Arkansas, on the 2nd Day of May, 1961, did find that James Montgomery, Tommy Richmond, Myrtle (O) Smith, E. M. Carroll, Fred Newberry, W. M. Dawson, Forest Beaver, Hayden Smith, Henry Stephens, Elmer Upton, Will Batterton, Frank Batterton, Jim Felts, Ray Faulkenberry, Mrs. G. R. Lancaster, Donald Collins, and John Sherman, are a majority in value of all property owners in a tract of land hereinafter described and sought to be annexed to the Town of Viola, and that said tract of land is contiguous and touches the Town of Viola.

And whereas the said County Court on the said 2nd Day of May, 1961 did order said tract to be annexed, made a part of and included within the boundaries of the Town of Viola, provided that the Town of Viola should by Ordinance or Resolution accept said territory and the annexation thereof, and which territory sought to be annexed is described as follows, to-wit:

SE $\frac{1}{4}$ OF SE $\frac{1}{4}$ OF NE $\frac{1}{4}$; E $\frac{1}{2}$ OF NE $\frac{1}{4}$ OF NE $\frac{1}{4}$; AND NW $\frac{1}{4}$ OF NE $\frac{1}{4}$, ALL IN SECTION 18
TWP. 29 N. R. 9 W. 5th. P. M., ALSO,
W $\frac{1}{2}$ OF NW $\frac{1}{4}$ OF SE $\frac{1}{4}$; E $\frac{1}{2}$ OF SE $\frac{1}{4}$ OF SW $\frac{1}{4}$; W $\frac{1}{2}$ OF SW $\frac{1}{4}$ OF SE $\frac{1}{4}$; AND E $\frac{1}{2}$ OF SE $\frac{1}{4}$ OF SW $\frac{1}{4}$,
ALL IN SECTION 7 TWP. 29 N. R. 9 W. 5th. P. M., ALSO,
S $\frac{1}{2}$ OF NE $\frac{1}{4}$ OF SW $\frac{1}{4}$; N $\frac{1}{2}$ OF SE $\frac{1}{4}$ OF SW $\frac{1}{4}$; AND SE $\frac{1}{4}$ OF NE $\frac{1}{4}$; ALL IN SECTION 13
TWP. 29 N. R. 10 W. 5th. P. M., ALSO,
NW $\frac{1}{4}$ OF NE $\frac{1}{4}$ IN SECTION 19 TWP. 29 N. R. 9 W. 5th. P. M.
ALL OF SAID PROPERTY IN FULTON COUNTY, ARKANSAS.

Now therefore be it resolved by the Town Council of Viola, Fulton County, Arkansas, that said County Court's Order of Annexation made on the 2nd Day of May, 1961, to the above and foregoing described tract of land be accepted by the said Town of Viola; and by and through this Resolution of its Town Council at one of its regular meetings, do in fact, herewith accept said annexation of Territory as herein and heretofore described.

And the Town Recorder is directed to attach a map or plat of said territory to the Resolution, together with a copy of the County Court's Order herein and file and make them a permanent record of the Town of Viola for the inspection of interested parties.

The Recorder is further directed to mail a copy of this Resolution to E. M. LeMore, Salem, Arkansas, the Agent of the Petitioners, so that he may complete three transcripts of the whole proceedings herein and mail one transcript to the Secretary of State, one to the Public Service Commission and one to the Recorder of the Town of Viola, as a permanent record of the proceedings hereto.

Approved this the 2nd Day of May, 1961.

Attest:

James P. DeShazo
RECORDER OF THE TOWN OF VIOLA

Erby Carroll
MAYOR

PROPOSED ANNEXATION TO THE TOWN OF VIOLA
 FULTON COUNTY, ARKANSAS
 (MAP)

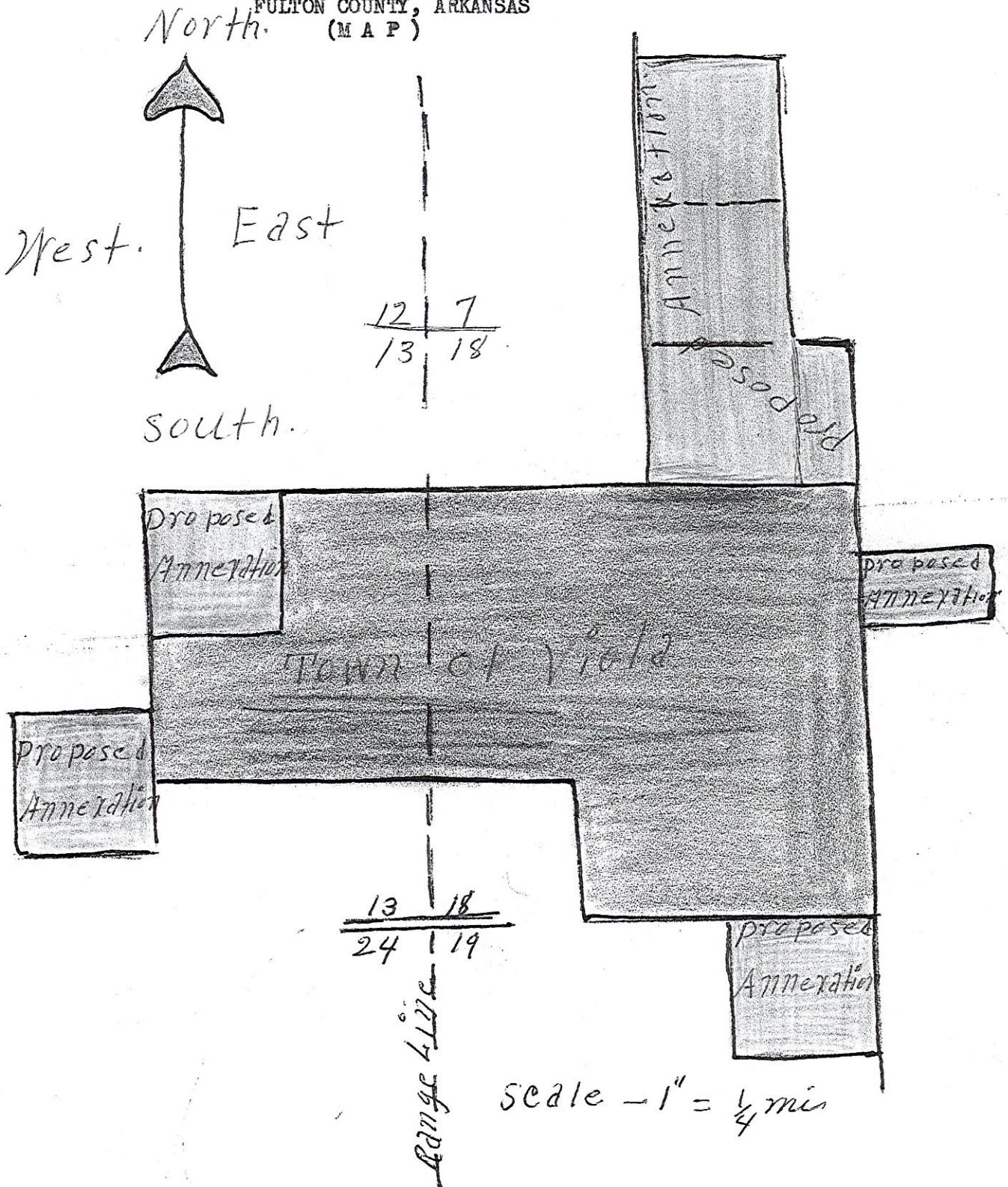

LEGAL DESCRIPTION
 $W\frac{1}{2}$ $NW\frac{1}{4}$ $SE\frac{1}{4}$; $E\frac{1}{2}$ of $SE\frac{1}{4}$ of $SW\frac{1}{4}$; $W\frac{1}{2}$ of $SW\frac{1}{4}$ of $SE\frac{1}{4}$ and $E\frac{1}{2}$ and $NE\frac{1}{4}$ of $SW\frac{1}{4}$ all in Section 7 Township 20 N. Range 9 West of the 5th. P. M. Also, $\frac{1}{4}$

$E\frac{1}{2}$ of $NE\frac{1}{4}$ of $NW\frac{1}{4}$; $NW\frac{1}{4}$ of $NE\frac{1}{4}$ all in Section 18, Township 20 N. Range 9 West of the 5th. P. M., also $S\frac{1}{2}$ of $SE\frac{1}{4}$ of $NE\frac{1}{4}$ in Sec. 18, Twp. 20 N. R. 9 W. of 5th. P. M. in Ark. $S\frac{1}{2}$ of $NE\frac{1}{4}$ of $SW\frac{1}{4}$ in Section 13, Township 29 N. Range 10 West of the 5th. P. M., also $SE\frac{1}{4}$ of $NE\frac{1}{4}$ in Sec. 13, Township 20 N. Range 10 West of the 5th. P. M., also $N\frac{1}{2}$ of $SE\frac{1}{4}$ of $SW\frac{1}{4}$ Sec. 13, Twp. 20 N. Range 10 West of the 5th. P. M., also $NW\frac{1}{4}$ of $NE\frac{1}{4}$ in Section 19, Township 28 N. Range 9 West of the 5th. P. M. in Arkansas

Exhibit "A"

IN THE MATTER OF THE PROCEEDINGS
OF ANNEXATION OF TERRITORY TO THE TOWN OF VIOLA
FULTON COUNTY, ARKANSAS
(By James Montgomery and Others)

I, L. W. Love, Clerk of the County Court of Fulton County
Arkansas, do certify that the foregoing Instrument of Writing
consisting of 9 Pages, is a true and correct transcript of
the proceedings had and done in the matter of the Annexation
of the Territory described therein to the Town of Viola in
Fulton County, Arkansas.

Witness my hand as such Clerk and the Seal of said Court on
the 12 Day of May, 1964.

(Seal)

L. W. Love

CLERK OF THE COUNTY COURT
FULTON COUNTY, ARKANSAS

Government Appeal Agent
Mrs. E. H. LaMore -- Income Tax

Office Telephone No. 895-3491
Residence Telephone No. 895-3488

E. H. LAMORE
ATTORNEY AT LAW
Office on Elm Street
P. O. Box No. 8
SALEM, ARKANSAS 72576
December 16, 1969

Hon. Kelly Bryant
Secretary of State
Little Rock, Arkansas

Dear Sir:

In compliance with Section 19-305 of Annotated Arkansas Statutes of Volume 2-B,

The County Clerk, L. W. Love, and myself are mailing to you enclosed a transcript of the Proceedings had and done in the Annexation of Territory by Erby Carroll and others to the Town of Viels, Fulton County, Arkansas.

Very Sincerely Yours,

L. W. Love

COUNTY CLERK OF FULTON COUNTY, ARKANSAS

E. H. LaMore

ATTORNEY FOR PETITIONERS FOR ANNEXATION