

Historic Annex Ord 508 & 667 : City of Wynne
October 2018

City: Wynne
Mayor: Bob Stacy

Arkansas Code 14-40-101.

Before an entity undertakes an annexation, consolidation, or detachment proceeding under this chapter, the entity shall coordinate with the Arkansas Geographic Information Systems Office for preparation of legal descriptions and digital mapping for the relevant annexation, consolidation, and detachment areas.

The map contained herein, is evidence, the entity has met requirements of Act 914 of 2015

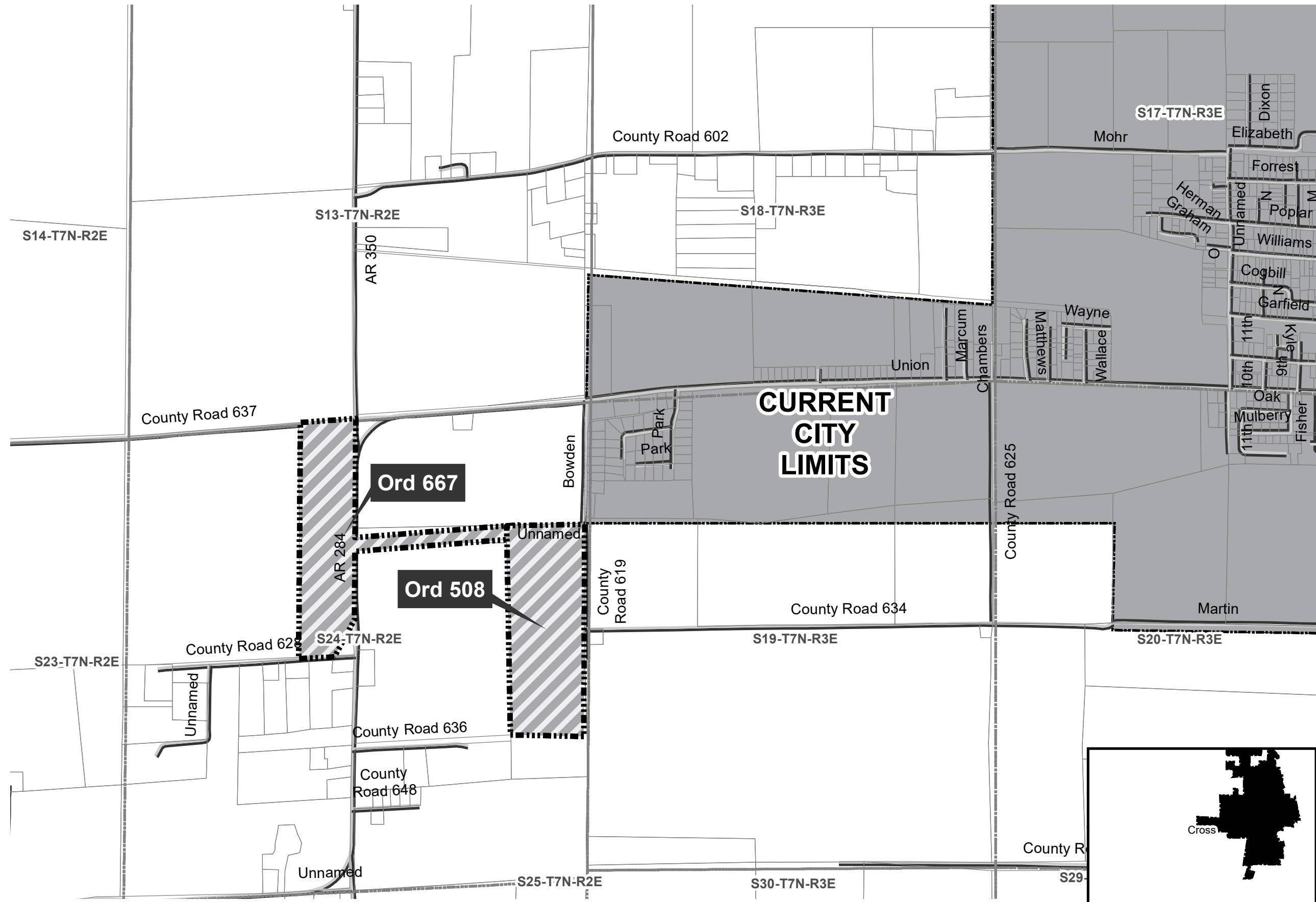

- Proposed Annex
- Sections
- Parcels
- Minor Road
- Existing City
- Neighboring City
- County Boundary

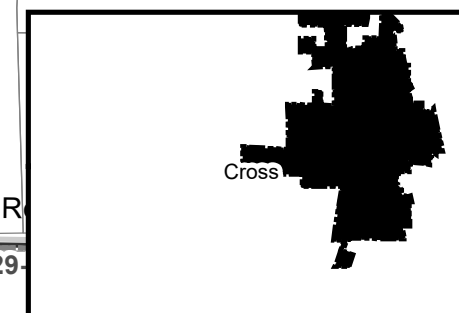
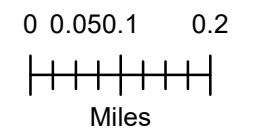

FILED
8.27.86

IN THE COUNTY COURT OF CROSS COUNTY, ARKANSAS

Joline Norris
COUNTY & PROBATE CLERK
CROSS COUNTY, ARK.

IN THE MATTER OF THE ANNEXATION
OF CERTAIN TERRITORY THAT IS
CONTIGUOUS TO AND ADJOINING THE
CITY OF WYNNE, ARKANSAS

SEP 10 1986
W. J. "BILL" MCCUEN
SECRETARY OF STATE
By _____

ORDER OF CONFIRMATION

ON THIS DAY, same being the 27th day of August,
1986, this cause came on for hearing, and the Court, after
being fully advised, finds:

1. By Order of the Court dated the 25th day
of July, 1986, certain lands described in said Order
were annexed to and made a part of the City of Wynne, Arkansas.

2. More than thirty (30) days have passed since
the rendering of said Order, and no Notice of objections
to prevent the annexation of said territory has been given
as required by law, and the City Council of Wynne, Arkansas,
has duly accepted said territory by a proper Ordinance as
a part and parcel of the incorporated city limits of Wynne,
Arkansas, and annexed same thereto.

IT IS THEREFORE, ORDERED, ADJUDGED AND DECREED
that the Order of Annexation heretofore made of the above
referred to land to the City of Wynne, Arkansas, and proceedings
had in relation therewith, are in all things ratified and
confirmed, and said territory and the inhabitants and owners
thereof shall have and enjoy all the rights and privileges
of the inhabitants and owners of property within the original
limits of said City.

W. J. Wood
COUNTY JUDGE

RECORDED
9-15 1986

FILED
8-27-86

Joline Norris
COUNTY & PROBATE CLERK
CROSS COUNTY, ARK.

Joline Norris
COUNTY & PROBATE CLERK
CROSS COUNTY, ARK.

FILED FOR RECORD
8-27-86 at _____
Recorded in book _____ BY _____
Page _____

CERTIFICATE OF RECORD } SS
BY *Norma Jean Hill* DC

I, Joline Norris, Clerk of the County and Probate Court for the County
aforesaid, do hereby certify that the annexed and foregoing instrument
of writing is a true, correct and complete copy of the original which was
filed for record in my office on the 22 day of August, 1986
and as the same appears in Record 45
of Cross County, Arkansas, page no. 45
I have hereunto set my hand and seal
this 16 day of Sept, 1986

Joline Norris
COUNTY & PROBATE CLERK
CROSS COUNTY, ARK.

M K

IN THE COUNTY COURT OF CROSS COUNTY, ARKANSAS

IN THE MATTER OF THE ANNEXATION
OF CERTAIN TERRITORY THAT IS
CONTIGUOUS TO AND ADJOINING THE
CITY OF WYNNE, ARKANSAS

NO. _____

ORDER OF ANNEXATION

ON THIS DAY, same being 2nd day of July ,
1986, this cause came on for hearing upon the Petition of
Tammy Hawkins, asking that the hereinafter described lands
be annexed to the City of Wynne, Arkansas, and the Court
after being fully advised, finds:

1. Said Petition was filed more than thirty (30) days prior to this date, and notice thereof, together with notice of this hearing, has been published in the time, form and manner required by law, proof of publication of which has been filed herein.
2. Petitioner appointed Joseph Boeckmann, City Attorney, to act on here behalf in the filing and presentation of this Petition.
3. A majority of the total number of real estate owners in the area affected by this Petition have signed said Petition, and such majority owns more than one-half ($\frac{1}{2}$) of the acreage therein.
4. The territory sought to be annexed was accurately described in said Petition, is contiguous to the boundaries of the City of Wynne, Arkansas, and the map attached to said Petition is an accurate map of the territory sought to be annexed.
5. The prayer of Petition is right and proper, and said territory should be annexed to the City of Wynne, Arkansas.

IT IS THEREFORE, ORDERED, ADJUDGED AND DECREED
that the following described lands be annexed to and made
a part of the City of Wynne, Arkansas, to-wit:

B-1 42-44

Beginning at the common corner of Sec. 4, 5, 8, and 9, T7N, R3E, thence North along the line between Sec. 4 & 5 a distance of 1,320 feet more or less to the NE corner of the $SE\frac{1}{4}$ $SE\frac{1}{4}$ of Sec. 5, thence West along the North line of the $SE\frac{1}{4}$ $SE\frac{1}{4}$ a distance of 1,320 feet more or less to the NW corner of the $SE\frac{1}{4}$, $SE\frac{1}{4}$ of Sec. 5, thence South along the West line of Sec. 5 a distance of 1,320 feet more or less to the South right of way line of Highway 64, thence West along the South right of way line of Highway 64 1,320 feet more or less to the North-South quarter section line of Section 8, thence South along said quarter section line 1,320 feet more or less to the SW corner of the $NW\frac{1}{4}$, $NE\frac{1}{4}$ of Sec. 8, thence East along the South line of the $N\frac{1}{2}$ of the $NE\frac{1}{4}$ of Sec. 8 a distance of 1,980 feet, more or less, to the West line of the $E\frac{1}{2}$ of the $E\frac{1}{4}$ of Sec. 8, thence South along the West line of the $E\frac{1}{2}$ of the $E\frac{1}{4}$ of Sec. 8, a distance of 3,960 feet more or less, to the North line of Sec. 17, thence West along the North line of Sec. 17 to the North South $\frac{1}{4}$ Section line of Sec. 17; thence South on said line to the NE corner of the $S\frac{1}{2}$ of the $NW\frac{1}{4}$, Sec. 17; thence West along the North line of the $S\frac{1}{2}$ of $NW\frac{1}{4}$, Sec. 17 to the NW corner of the $E\frac{3}{4}$ of $S\frac{1}{2}$ of $NW\frac{1}{4}$, Sec. 17; thence South to the North line of the $SW\frac{1}{4}$ of Sec. 17; thence West to the West line of Sec. 17; thence South along the common line between Sections 17 and 18 to the South right of way line of the Missouri Pacific RR thence Northwesterly along the South right of way of the Missouri Pacific RR a distance of 5,400 feet, more or less, to the West line of Sec. 18, said line being the boundary between Range 2E and Range 3E, thence South along said range line to the NW corner of Sec. 24, T7N, R2E, thence continue South along said range line 1,539 feet, thence West a distance of 764 feet along a line parallel to the North line of Sec. 24 to a point, thence South 19 degrees 25 minutes West a distance of 220 feet to a point, thence South 3 degrees 49 minutes East a distance of 1,155 feet to a point, thence South 5 degrees 34 minutes East a distance of 1,043 feet to a point, thence East a distance of 780 feet along a line parallel to the North line of Sec. 24 to the range line, thence North along the range line a distance of 2,439 feet more or less, to the center of the drainage canal running along the South line of the $N\frac{1}{2}$ $N\frac{1}{2}$ of Sec. 19, T7N, R3E, thence East along the center of the drainage canal 5,280 feet more or less to the common boundary between Sec. 19 & 20, thence continue eastward along the drainage canal to the center of the $NW\frac{1}{4}$ of Sec. 20, thence South along the west line of the $E\frac{1}{2}$ of the $NW\frac{1}{4}$ of Sec. 20 a distance of 1,320 feet, more or less, to the SW corner of the $E\frac{1}{2}$ of the $NW\frac{1}{4}$ of Sec. 20, thence East along the South line of the $NW\frac{1}{4}$ of Sec. 20 a distance of 1,320 feet more or less to the center of Sec 20, said center of Sec. 20 being a point on the existing City Limits, thence North along the West City Limit approximately one (1) mile to the center of Sec. 17, thence eastwardly and northwardly with the existing City Limit to the common boundary between Sec. 16 & 17, thence North along the common boundary of Sec 16 & 17, 8 and 9, and 4 and 5 to the point of beginning, containing 1,044 acres, more or less.

and that the original papers in this cause be delivered to the Clerk of Cross County, Arkansas, to be properly recorded upon the records of Cross County, Arkansas, and after the acceptance of said territory by the City of Wynne, Arkansas, and confirmation of this annexation, said Clerk shall duly certify one copy of the plat of such annexed territory, one copy of this order and the ordinance of the City of Wynne accepting said annexation, and forward a copy of each to the Secretary of State, who shall file and preserve the same, and forward one copy of the plat of such annexed territory and one copy of this order to the Director of the Tax Division of the Arkansas Public Service Commission, notify all utility companies having property in the municipality of such annexation, and forward a certified copy of this Order to the City Council of Wynne, Arkansas.

[Signature]
 COUNTY JUDGE

FILED
 7-28-86
Joline Morris
 COUNTY & PROBATE CLERK
 CROSS COUNTY, ARK.
 BY *Norma Jean Rich* D.C.

RECORDED
 9-15-1986
Joline Morris
 COUNTY & PROBATE CLERK
 CROSS COUNTY, ARK.
 BY *Norma Jean Rich*

CERTIFICATE OF RECORD
 STATE OF ARKANSAS }
 County of Cross } SS
 I, Joline Morris, Clerk of the County and Probate Court for the County of Cross, do hereby certify that the annexed and foregoing instrument or writing is a true, correct and complete copy of the original which was filed for record in my office on the 28 day of July 1986 and as the same appears in Record of Cross County, Arkansas, page no. 42-44
 IN TESTIMONY WHEREOF, I have hereunto set my hand and affixed the seal of said Court this the 16 day of Sept 1986
 By A. J. Reel D.C.

ORDINANCE NO. #508

AN ORDINANCE ACCEPTING CERTAIN TERRITORIES AS
A PART OF THE CITY OF WYNNE, ARKANSAS, AND
ASSIGNING THE SAME TO AN EXISTING WARD.

BE IT ORDAINED BY THE CITY COUNCIL OF THE CITY OF WYNNE, ARKANSAS:

SECTION ONE: WHEREAS, pursuant to law, the owners
of the following described properties contiguous to and
adjoining the City of Wynne , Arkansas, to-wit:

Beginning at the common corner of Sec. 4,5,8,
and 9, T7N, R3E, thence North along the line
between Sec. 4 & 5 a distance of 1,320 feet
more or less to the NE corner of the SE $\frac{1}{4}$ SE $\frac{1}{4}$
of Sec. 5, thence West along the North line
of the SE $\frac{1}{4}$ SE $\frac{1}{4}$ a distance of 1,320 feet more
or less to the NW corner of the SE $\frac{1}{4}$, SE $\frac{1}{4}$ of
Sec. 5, thence South along the West line of
Sec. 5 a distance of 1,320 feet more or less
to the South right of way line of Highway 64,
thence West along the South right of way line
of Highway 64 1,320 feet more or less to the
North-South quarter section line of Section
8, thence South along said quarter section
line 1,320 feet more or less to the SW corner
of the NW $\frac{1}{4}$, NE $\frac{1}{4}$ of Sec. 8, thence East along
the South line of the N $\frac{1}{2}$ of the NE $\frac{1}{4}$ of Sec. 8
a distance of 1,980 feet, more or less, to the
West line of the E $\frac{1}{2}$ of the E $\frac{1}{4}$ of Sec. 8,
thence South along the West line of the E $\frac{1}{2}$
of the E $\frac{1}{4}$ of Sec. 8, a distance of 3,960 feet
more or less, to the North line of Sec. 17,
thence West along the North line of Sec. 17
to the North South $\frac{1}{4}$ Section line of Sec. 17;
thence South on said line to the NE corner of
the S $\frac{1}{2}$ of the NW $\frac{1}{4}$, Sec. 17; thence West along
the North line of the S $\frac{1}{2}$ of NW $\frac{1}{4}$, Sec. 17 to
the NW corner of the E $\frac{3}{4}$ of S $\frac{1}{2}$ of NW $\frac{1}{4}$,
Sec. 17; thence South to the North line of
the SW $\frac{1}{4}$ of SEC. 17; thence West to the West
line of Sec. 17; thence South along the common
line between Sections 17 and 18 to the South
right of way line of the Missouri Pacific RR
thence Northwesterly along the South right of
way of the Missouri Pacific RR a distance of
5,400 feet, more or less, to the West line of
Sec.18, said line being the boundary between
Range 2E and Range 3E, thence South along said
range line to the NW corner of Sec. 24, T7N,
R2E, thence continue South along said range
line 1,539 feet, thence West a distance of 764
feet along a line parallel to the North line of
Sec. 24 to a point, thence South 19 degrees
25 minutes West a distance of 220 feet to a
point, thence South 3 degrees 49 minutes East
a distance of 1,155 feet to a point, thence
South 5 degrees 34 minutes East a distance of
1,043 feet to a point, thence East a distance
of 780 feet along a line parallel to the North
line of Sec. 24 to the range line, thence North
along the range line a distance of 2,439 feet
more or less, to the center of the drainage canal

running along the South line of the N $\frac{1}{2}$ N $\frac{1}{2}$ of Sec. 19, T7N, R3E, thence East along the center of the drainage canal 5,280 feet more or less to the common boundary between Sec. 19 & 20, thence continue eastward along the drainage canal to the center of the NW $\frac{1}{4}$ of Sec. 20, thence South along the west line of the E $\frac{1}{2}$ of the NW $\frac{1}{4}$ of Sec. 20 a distance of 1,320 feet, more or less, to the SW corner of the E $\frac{1}{2}$ of the NW $\frac{1}{4}$ of Sec. 20, thence East along the South line of the NW $\frac{1}{4}$ of Sec. 20 a distance of 1,320 feet more or less to the center of Sec 20, said center of Sec. 20 being a point on the existing City Limits, thence North along the West City Limit approximately one (1) mile to the center of Sec. 17, thence eastwardly and northwardly with the existing City Limit to the common boundary between Sec. 16 & 17, thence North along the common boundary of Sec 16 & 17, 8 and 9, and 4 and 5 to the point of beginning, containing 1,044 acres, more or less.

have petitioned the County Court for the annexation of said properties to the City of Wynne, Arkansas. And whereas, the County Court, pursuant to law, has granted said Petition and confirmed same, the City of Wynne, through its City Council, hereby accepts the above described properties to be a part of the City of Wynne, Arkansas, and hereby extends the boundaries of the City of Wynne, Arkansas, to include the above described properties.

SECTION TWO: The above described properties, having been accepted as a part of the City of Wynne, Arkansas, the boundaries of the Wards of the City of Wynne are hereby amended as follows:

a. WARD I: There is hereby added to Ward I the area described as all that part of Sections 4,5,8, and 9 lying West of North-South line of the Missouri Pacific Railroad and within the boundary of the City of Wynne.

b. WARD IV: There is hereby added to Ward IV the area described as all of Section 17 lying North of the East-West line of the Missouri-Pacific Railroad and not presently within the City of Wynne.

c. WARD III: There is hereby added to Ward III the area described as all that part of Sections 17 and 18 lying South of the East-West line of the Missouri-Pacific

Railroad and all of Sections 17, 18, 19, 20 and 24 lying South of the East-West line of the Missouri-Pacific Railroad and not presently within the City of Wynne.

SECTION THREE: Because of the need to immediately extend city police and fire protection to the area hereby annexed, an emergency is hereby declared and this Ordinance being necessary for the preservation of the public peace, health and safety shall be in force and take effect immediately upon its passage and approval.

PASSED this 9th day of September 1986.

APPROVED:

[Signature]
MAYOR

ATTEST:

[Signature]
CITY CLERK & RECORDER

CERTIFICATE OF RECORD

STATE OF ARKANSAS]
]]
COUNTY OF CROSS]

I, Olive Bock, City Clerk and Recorder for the City of Wynne, Arkansas, duly qualified and acting, do hereby certify that the annexed and foregoing instrument of writing, containing three pages, is a true and complete copy of the original which is on file in my office.

IN TESTIMONY WHEREOF, I have set my hand and affixed the seal of the City of Wynne, this 9th day of September, 1986.

[Signature]
OLIVE BOCK
CITY CLERK AND RECORDER

CERTIFICATE OF RECORD

STATE OF ARKANSAS } SS
County of Cross }

I, Joline Morris, Clerk of the County and Probate Court for the County aforesaid, do hereby certify that the annexed and foregoing instrument of writing is a true, correct and complete copy of the original which was filed for record in my office on the 15 day of Sept, 1986 and as the same appears in an file of Cross County, Arkansas.

IN TESTIMONY WHEREOF, I have hereunto set my hand and the seal of said Court for the 16 day of Sept, 1986.

JOLINE MORRIS, Clerk
By [Signature] S.C.

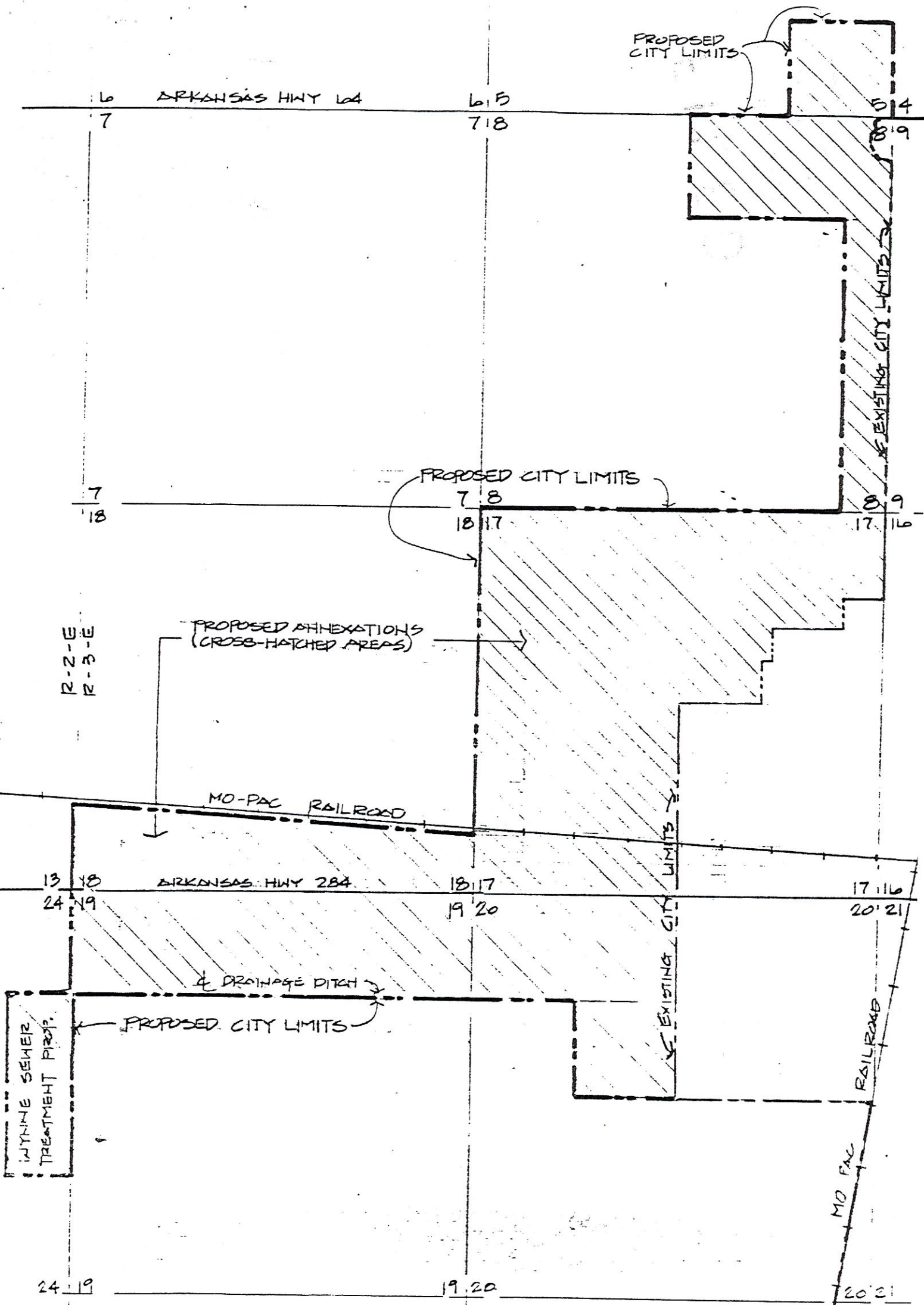

CERTIFICATE OF RECORD
 STATE OF ARKANSAS }
 County of Cross } SS
 I, John Norris, Clerk of the County and Probate Court for the County of Cross, do hereby certify that the annexed and foregoing instrument of writing is a true, correct and complete copy of the original which is on file for record in my office on the 24 day of June 1986 and as the same appears in Record of Cross County, Arkansas, page no. _____
 IN TESTIMONY WHEREOF, I have hereunto set my hand and affixed the seal of said Court this the 16 day of Sept 1986
 JOHN NORRIS, Clerk
 By A.O. R...

ORDINANCE NUMBER 667

AN ORDINANCE ACCEPTING THE ANNEXATION OF CERTAIN TERRITORY TO THE CITY OF WYNNE, ARKANSAS AND MAKING SAME A PART OF THE CITY OF WYNNE AND ASSIGNING SAME TO WARDS.

WHEREAS, petition was filed with the County Clerk of Cross County, Arkansas, by the owners of hereinafter described territory praying that said territory be annexed to, and made a part of the City of Wynne, Arkansas; and,

WHEREAS, on August 5, 2004 the County Court of Cross County, Arkansas found that the petition was signed by owners of said territory; that said territory was contiguous and adjoining the present corporate limits of the City of Wynne, Arkansas; that an accurate plat or map of said territory had been filed with and made a part of said petition; that proper notice had been given for the time and manner prescribed by law, and that said lands and territory should be annexed to and made a part of the City of Wynne, Arkansas subject to the acceptance of same by the City Council of said City at the proper time, as provided by law; and

WHEREAS, the time fixed by law for appealing from said order of annexation made by County Court has expired and no appeal has been taken from said order.

NOW, THEREFORE, BE IT ORDAINED BY THE CITY COUNCIL OF THE CITY OF WYNNE, ARKANSAS:

SECTION 1: That the following described lands and territory contiguous and adjoining the City of Wynne, Arkansas, be and the same is hereby accepted as part of and annexed the City of Wynne:

A 47.04 tract of land lying in the East Half (E ½) of the Northwest Quarter (NW ¼) and the South Half (S ½) of the Northeast Quarter (NE ¼) of Section 24, Township Seven North (T7N), Range Two East (R2E), Cross County, Arkansas and being more particularly described as:

Beginning at the center of Section 24, T7N, R2E, thence along the South line of the NW ¼ of said Section 24 South 87 degrees 16 minutes 26 seconds West 640.39 feet to a point, thence North 00 degrees 24 minutes 05 seconds East 2719.82 feet to a point lying on the North line of said NW ¼ of Section 24, thence along said North line of Section 24 North 85 degrees 49 minutes 43 seconds East 640.39 feet to the Northeast corner of the NW ¼ of Section 24, thence along the East line of said NW ¼ of Section 24 South 00 degrees 22 minutes 44 seconds West 1372.39 feet to the Northwest corner of the S ½ of the NE ¼ of Section 24, thence along the North line of the S ½ of said NE ¼ of Section 24 North 85 degrees 32 minutes 26 seconds East 1885.52 feet to a fence being the West boundary of the Wynne Water Treatment Facility, thence along the facility boundary South 00 degrees 22 minutes 44 seconds West 160.00 feet to a point, thence South 85 degrees 32 minutes 36 seconds West 1885.52 feet to a point lying on the East line of the NW ¼ of Section 24, thence along said East line of said NW ¼ of Section 24 South 00 degrees 22 minutes 44

Page two, Ordinance Number 667

seconds West a distance of 1203.55 feet to the Point of beginning, containing 47.04 acres more or less, LESS AND EXCEPT a cemetery lying in the E ½ of the NW ¼ of Section 24, T7N, R2E, being more particularly described as: Commencing at the center of Section 24, T7N, R2E, thence South 87 degrees 16 minutes 26 seconds West 245.23 feet to a point, thence North 24 degrees 58 minutes 40 seconds East 588.25 feet to a point, thence South 00 degrees 22 minutes 24 seconds West 521.58 feet to the point of beginning, containing 1.47 acres more or less and containing 45.57 acres after exception, and being subject to all easements, rights of way and restrictions of record.

SECTION 2: That the above described territory shall be annexed to and made a part of Ward Three, zoned Residential 1 (R1), of the City of Wynne, and the same shall henceforth be part of said ward as fully as existing parts of said ward.

Passed and approved this 10th day of August 2004.

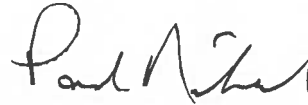

Paul Nichols, Mayor

ATTEST:



City Clerk