

BAS Correction Historic Annex Ordinance 199, 200: City of Murfreesboro
 *for Census only - was already in state map

City: Murfreesboro
 Mayor: Rodney Fagan

Arkansas Code 14-40-101.

Before an entity undertakes an annexation, consolidation, or detachment proceeding under this chapter, the entity shall coordinate with the Arkansas Geographic Information Systems Office for preparation of legal descriptions and digital mapping for the relevant annexation, consolidation, and detachment areas.

The map contained herein, is evidence, the entity has met requirements of Act 914 of 2015



-  Proposed Annex
-  Sections or Parcels
-  Parcels
-  Minor Road
-  Existing City
-  Neighboring City

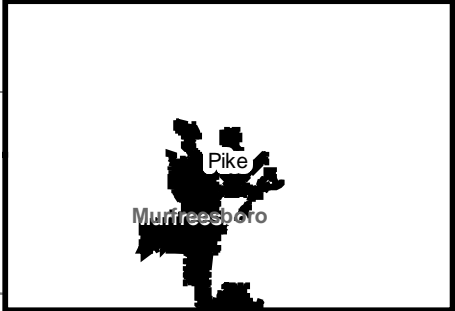
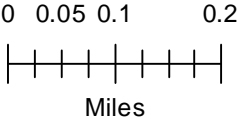

AN ORDINANCE ACCEPTING THE ANNEXATION
OF CERTAIN TERRITORY TO THE CITY OF
MURFREESBORO, ARKANSAS, AND MAKING
SAME A PART OF THE CITY OF MURFREESBORO,
AND ASSIGNING SAME TO WARDS

)
)
) ORDINANCE
) NO. 199
)

WHEREAS, petition was filed with the County Clerk of Pike County, Arkansas, by the majority of the real estate owners of the hereinafter described territory praying that said territory be annexed to, and made a part of the City of Murfreesboro, Arkansas, and,

WHEREAS, on the 29th day of July, 1996, the County Court of Pike County, Arkansas, found that the petition was signed by a majority of the real estate owners in said territory; that said territory was contiguous and adjoining the present corporate limits of the City of Murfreesboro, Arkansas; that an accurate plat or map of said territory had been filed with, and made a part of said petition; that proper notice has been given for the time and in the manner prescribed by law, and that all things pertaining thereto had been done in the manner prescribed by law, and that said lands and territory should be annexed to and made a part of Murfreesboro, Arkansas, subject to the acceptance of same by the City Council of said City at the proper time, as provided by law; and

WHEREAS, the time fixed by law for appealing from said order of annexation made by the County Court has expired and no appeal has been taken from said order.

NOW, THEREFORE, BE IT ORDAINED BY THE CITY COUNCIL OF THE CITY OF MURFREESBORO, ARKANSAS.

Section 1. That the following described lands and territory contiguous and adjoining the City of Murfreesboro, Arkansas, be and the same is hereby accepted as part of and annexed to and made a part of the City of Murfreesboro:

LEATHERSTON & FEATHERSTON

Attorneys at Law

P. O. Box 298

Murfreesboro, AR 71958

501/285-3122

All that part of the West Half of the Southwest Quarter (W $\frac{1}{2}$ SW $\frac{1}{4}$) of Section Four (4), lying West of Prairie Creek, containing 2 acres, more or less, All that part of the East Half of the Southeast Quarter (E $\frac{1}{2}$ SE $\frac{1}{4}$) of Section Five (5), lying West of Prairie Creek, containing 78 acres, more or less, and All that part of the Southwest Quarter of the Southeast Quarter (SW $\frac{1}{4}$ SE $\frac{1}{4}$) of Section Five (5) which lies between the Right of Way of the abandoned M.D.&G Railroad and the East and South lines of the said described land, containing 1 $\frac{1}{4}$ acres, more or less. All in Township Eight (8) South of the Base Line in Range Twenty-five (25) West of the Fifth Principal Meridian in Arkansas, and containing in the aggregate 81 $\frac{1}{4}$ acres, more or less.

Section 2. That the above described territory shall be annexed to and made a part of the North Ward of the City of Murfreesboro, and the same shall henceforth be a part of said ward as fully as existing parts of said Ward.

Section 3. This Ordinance being necessary for the protection and preservation of public health and safety, an emergency is hereby declared to exist and this Ordinance shall be in force and shall take effect upon passage and publication.

Passed and approved this 12th day of August, 1996.

Thelma F. Simon
THELMA F. SIMON, MAYOR

ATTEST: Susan O'Neal
CLERK AND RECORDER

WITNESS my hand and official seal this 12 day of

August A.D., 1996

State of ARKANSAS
County of PIKE

I hereby certify that this instrument
FILED FOR RECORD and is RECORDED on the
DATE and TIME and in the BOOK and PAGE as
stamped hereon.

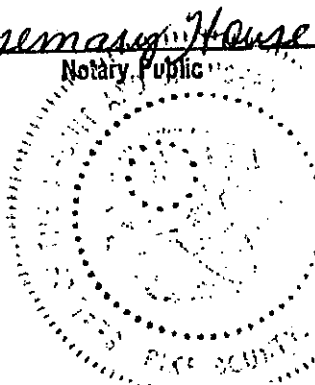
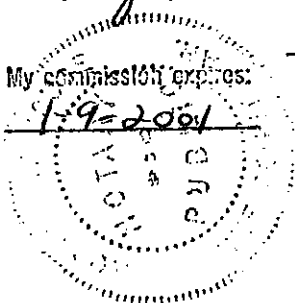

DATE: 8-13-96 TIME: 1:15 PM
BOOK: MS28 PAGE: 438-439

DIAN HENDERSON
Recorder of Pike County

By: D. Hall
Deputy Clerk

IN THE COUNTY COURT OF PIKE COUNTY, ARKANSAS

IN THE MATTER OF THE ANNEXING TO THE CITY OF MURFREESBORO, ARKANSAS, CERTAIN TERRITORY CONTIGUOUS TO THE SAID CITY OF MURFREESBORO ARKANSAS, BY PETITION OF ADJOINING LANDOWNERS

FILED

) No. CO-96-2

OCT 14 1996

ORDER

SHARON PRIEST
SECRETARY OF STATE

Now on this 29th day of July, 1996, there is ~~presented to the Court~~ ^{BY} by Howard G. Laurent and wife, Marian J. Laurent a petition for annexation of certain territory, herein after more particularly described, to the City of Murfreesboro, Arkansas, and the Court being fully advised of the facts and of the law, doth hereby find, adjudge, and decree as follows:

1. The Court finds that the petition was filed more than 30 days prior to this date and that in said petition the said Howard G. Laurent and wife, Marian J. Laurent was selected by the petitioners to act on their behalf in filing and presenting the petition.

2. The Court finds that majority of the total number of real estate owners in the area affected by this petition have signed said petition and that such majority owns more than one-half of the acreage affected.

3. The Court further finds that the territory sought to be annexed was accurate described in said petition and that said territory is contiguous to the boundaries of the City of Murfreesboro, Arkansas.

4. The Court further finds that attached to and made a part of said petition is an accurate map of the territory sought to be annexed to the City of Murfreesboro.

5. The Court further finds that the prayer of the petition is right and proper.

IT IS THEREFORE BY THE COURT ORDERED, ADJUDGED AND DECREED that the following described territory be and the same is hereby annexed to and made a part of the City of Murfreesboro, Arkansas, to-wit:

STATE OF ARKANSAS
COUNTY OF PIKE

I, Dian Henderson, Clerk, do hereby certify that this is a true and correct copy of the

original Order

Dated 8-8-96

Dian Henderson, Clerk

Dian Henderson, Clerk
by Ballard

FILED

TIME _____

JUL 29 1996

DIAN HENDERSON
COUNTY & CIRCUIT CLERK

FEATHERSTON & FEATHERSTON
Attorneys at Law
P. O. Box 298
Murfreesboro, AR 71958
501/285-3122

All that part of the West Half of the Southwest Quarter ($W\frac{1}{2} SW\frac{1}{4}$) of Section Four (4), lying West of Prairie Creek, containing 2 acres, more or less. All that part of the East Half of the Southeast Quarter ($E\frac{1}{2} SE\frac{1}{4}$) of Section Five (5), lying West of Prairie Creek, containing 78 acres, more or less. All that part of the Southwest Quarter of the Southeast Quarter ($SW\frac{1}{4} SE\frac{1}{4}$) of Section Five (5) which lies between the Right of Way of the abandoned M.D.&G Railroad and the East and South lines of the said described land, containing $1\frac{1}{4}$ acres, more or less; All in Township Eight (8) South of the Base Line in Range Twenty-five (25) West of the Fifth Principal Meridian in Arkansas, and containing in the aggregate $81\frac{1}{4}$ acres, more or less.

The Court doth further order that the original papers in this cause be delivered to the Clerk of Pike County, Arkansas, and the Clerk after properly recording and filing the original prepare transcripts of same; that one of the certified transcripts be delivered to the City of Murfreesboro, Arkansas; one copy to the Secretary of State and one copy to the Director of the Tax Division of the Arkansas Public Service Commission.

CURTIS TURNER, SR.
COUNTY JUDGE, PIKE
COUNTY, ARKANSAS

TOWNSHIP 8 SOUTH RANGE 25 WEST

SEE PAGE 12

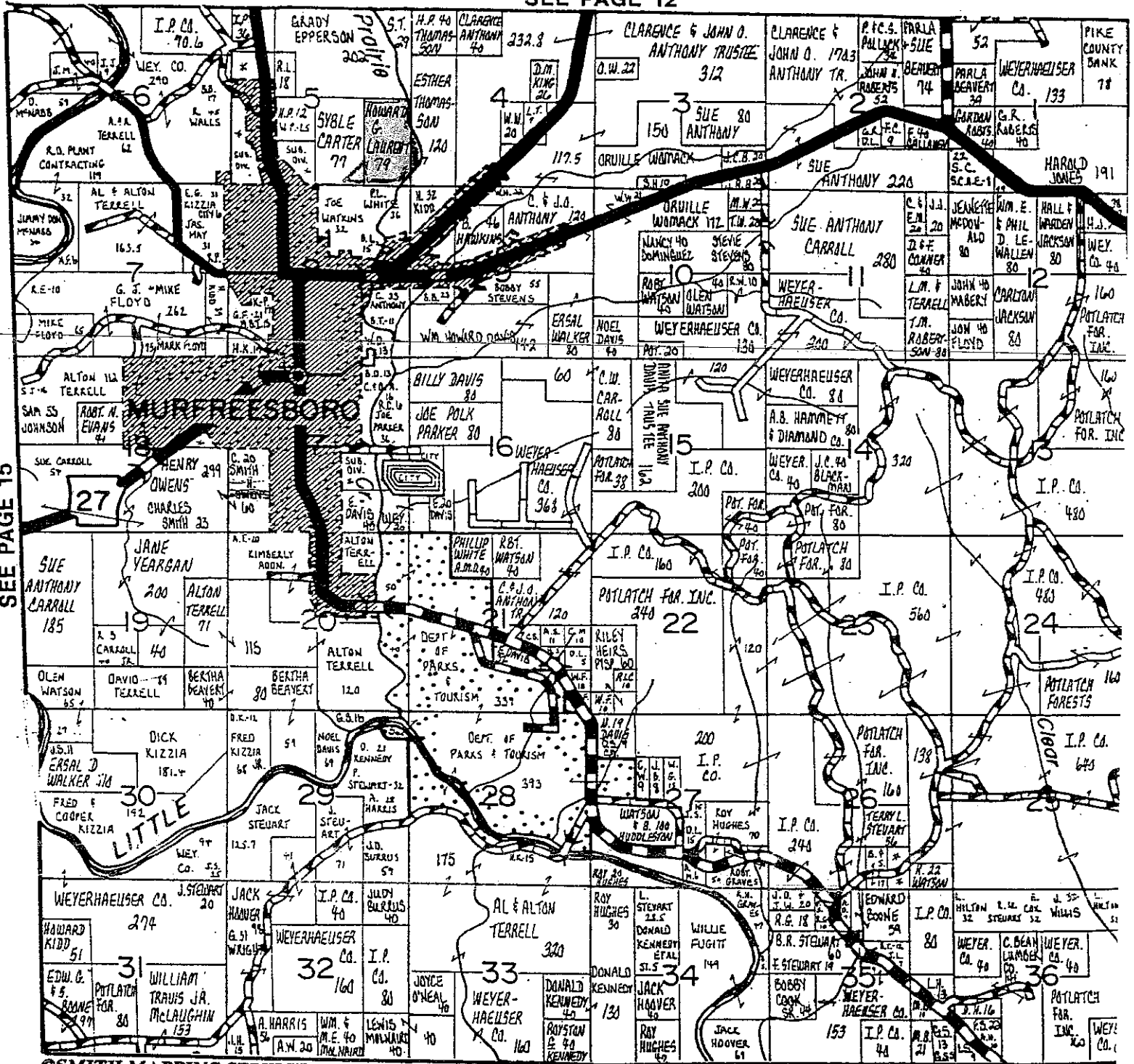

SEE PAGE 15

SEE PAGE 19

©SMITH MAPPING SERVICE

Guaranty Abstract & Title Co.

ABSTRACTS ★ TITLE INSURANCE

Jimmy L. Featherston

285-3122

Betty M. Featherston

107 N. WASHINGTON ST.

FAX 285-3895

MURFREESBORO, AR.