

Geometry Correction Ord 4462: City of Springdale  
June 2019

City: Springdale  
Mayor: Doug Sprouse

Arkansas Code 14-40-101.

Before an entity undertakes an annexation, consolidation, or detachment proceeding under this chapter, the entity shall coordinate with the Arkansas Geographic Information Systems Office for preparation of legal descriptions and digital mapping for the relevant annexation, consolidation, and detachment areas.

The map contained herein, is evidence, the entity has met requirements of Act 914 of 2015

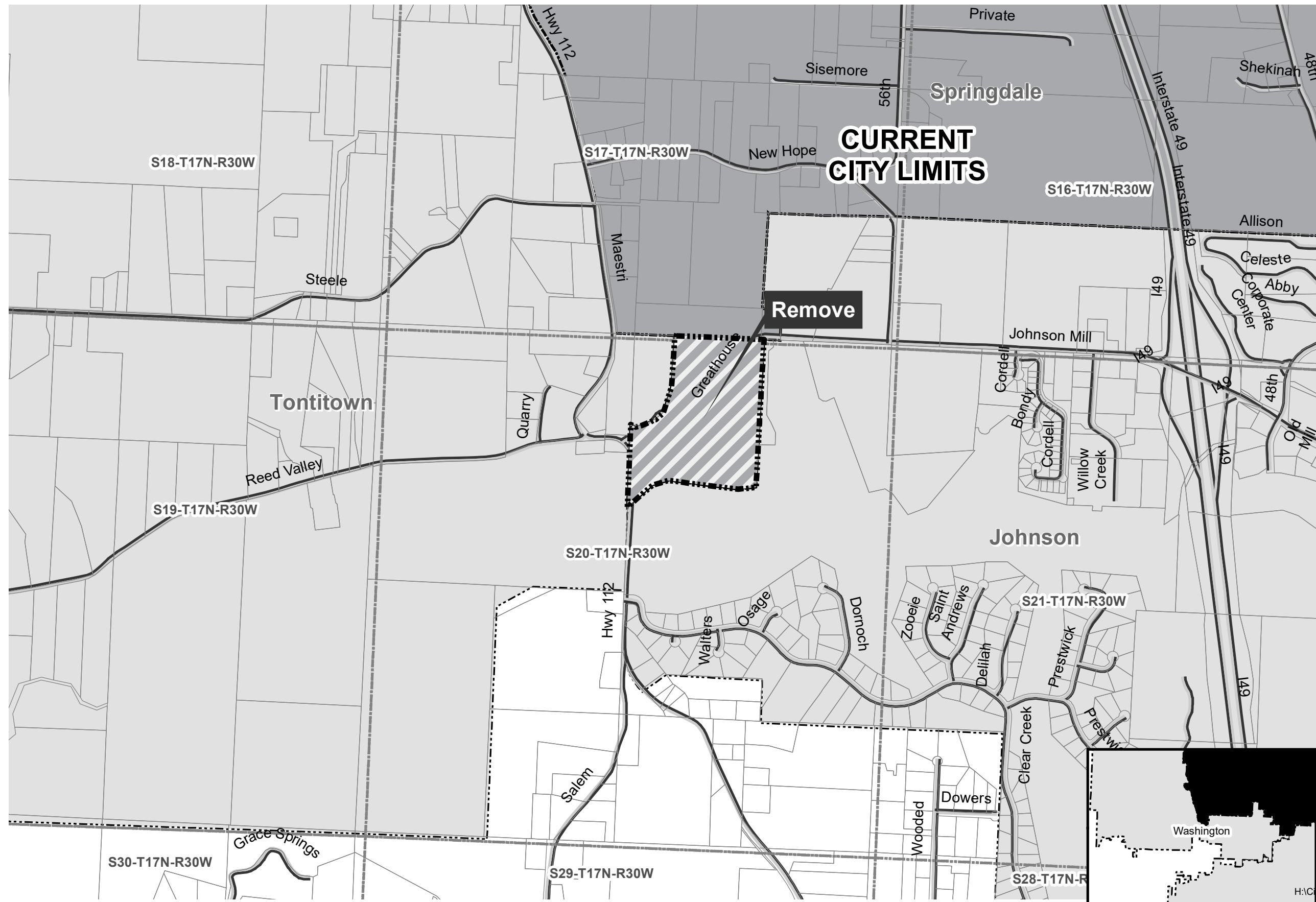

- Geometry Correction
- Sections
- Parcels
- Minor Road
- Existing City
- Neighboring City
- County Boundary

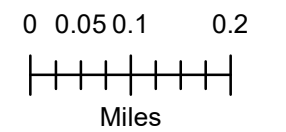

**ORDINANCE NO. 4462**

**AN ORDINANCE ANNEXING CERTAIN  
LAND LOCATED IN WASHINGTON  
COUNTY, ARKANSAS, PURSUANT TO  
ARK. CODE ANN. §14-40-501, *et. seq.*;  
DECLARING AN EMERGENCY;  
AND FOR OTHER PURPOSES.**



Doc ID: 013723500004 Type: REL  
Kind: ORDINANCE  
Recorded: 11/01/2010 at 11:31:06 AM  
Fee Amt: \$30.00 Page 1 of 4  
Washington Countv. AR  
Bette Stamps Circuit Clerk  
File **2010-00032213**

**WHEREAS**, the boundaries of the city limits of the City of Springdale have changed over time, causing certain unincorporated areas of land in Washington County, Arkansas, which are not in the City of Springdale to become completely surrounded by two (2) or more municipalities;

**WHEREAS**, it would be in the public interest for the City of Springdale to provide municipal services, such as police protection, fire protection, etc., to the lands in these surrounded unincorporated areas, and these lands represent the actual growth of the City of Springdale beyond its legal boundary;

**WHEREAS**, Ark. Code Ann. §14-40-501(a)(1)(B) provides that the governing body of the municipality with the greater distance of city limits adjoining the surrounded unincorporated area's perimeter may propose an ordinance calling for annexation of the land in the surrounded unincorporated area;

**WHEREAS**, the City of Springdale is the municipality with the greater distance of city limits adjoining the perimeter of several surrounded unincorporated areas in Washington County, Arkansas;

**WHEREAS**, it is in the best interest of the City of Springdale that the lands in these surrounded unincorporated areas in Washington County, Arkansas, be annexed into and be made a part of the City of Springdale, and the legal descriptions of the land to be annexed, as well as a map of the land to be annexed, are attached hereto as Exhibit "A" and made a part hereof; and

**WHEREAS**, a public hearing was held on October 26, 2010, after publishing notice and notifying property owners as required by law; and

CITY OF SPRINGDALE  
201 SPRING ST., ROOM 203  
SPRINGDALE, AR 72764

**NOW THEREFORE, BE IT ORDAINED BY THE CITY COUNCIL FOR THE CITY OF SPRINGDALE, ARKANSAS:**

**Section 1:** That the surrounded unincorporated areas in Washington County, Arkansas, contained in Exhibit "A" be and hereby are annexed into the City of Springdale, Arkansas in accordance with Ark. Code Ann. §14-40-501, *et. seq.*

**Section 2: Emergency Clause.** Ark. Code Ann. §14-40-503(a)(2) requires the City of Springdale, Arkansas, to begin rendering services to the annexed area immediately upon the passage of this Ordinance. As such, it is hereby declared that an emergency exists and this ordinance, being necessary for the preservation of the health, safety and welfare of the citizens of Springdale, Arkansas, and to ensure compliance with the provisions of Arkansas law, shall be in effect immediately upon its passage and approval.

**PASSED AND APPROVED** this 26 day of October, 2010.

  
\_\_\_\_\_  
Doug Sprouse, Mayor

ATTEST  
  
  
\_\_\_\_\_  
Denise Pearce, CITY CLERK

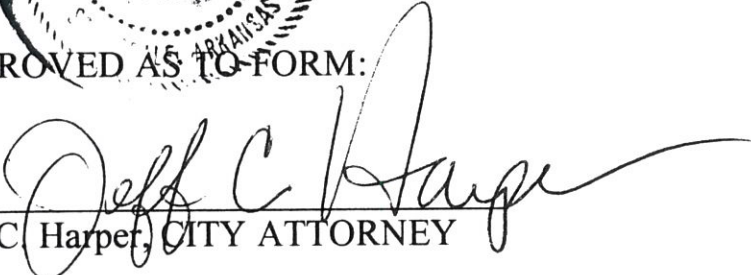
APPROVED AS TO FORM:  
  
\_\_\_\_\_  
Jeff C. Harper, CITY ATTORNEY

CITY OF SPRINGDALE  
201 SPRING ST., ROOM 203  
SPRINGDALE, AR 72764

Washington County  
Island Descriptions

Shared Island #1

All of Section 31, Township 18 North, Range 30 West; and all of the NW ¼ of Section 32, Township 18 North, Range 30 West; and all of the S ½ of Section 30, Township 18 North, Range 30 West; and all of the East ½ of Section 36, Township 18 North, Range 31 West, Washington County, Arkansas. Less and except any portion currently within the corporate limits of the City of Springdale, City of Elm Springs, or City of Tontitown, Arkansas.

Shared Island #7

All of the NW ¼ of the SE ¼ of Section 13, Township 17 North, Range 30 West, Washington County, Arkansas. Less and except any portion currently within the corporate limits of the City of Springdale or City of Fayetteville, Arkansas.

Shared Island #8

All of the South ½ of Section 17, Township 17 North, Range 30 West, Washington County Arkansas. Less and except any portion currently within the corporate limits of the City of Springdale, City of Johnson, or City of Tontitown, Arkansas.

Shared Island #9

All of the North ½ of Section 17, Township 17 North, Range 30 West lying East of Arkansas Highway 112, and all of the South ½ of Section 8, Township 17 North, Range 30 West, Washington County, Arkansas. Less and except any portion currently within the corporate limits of the City of Springdale or the City of Tontitown, Arkansas.

Shared Island #10

All of the South ½ of the NW ¼ of Section 8, Township 17 North, Range 30 West lying East of Arkansas Highway 112, Washington County, Arkansas. Less and except any portion currently within the corporate limits of the City of Springdale, Arkansas.

CITY OF SPRINGDALE  
201 SPRING ST., ROOM 203  
SPRINGDALE, AR 72764

CITY OF SPRINGDALE  
201 SPRING ST., ROOM 203  
SPRINGDALE, AR 72764

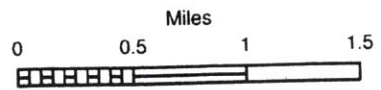
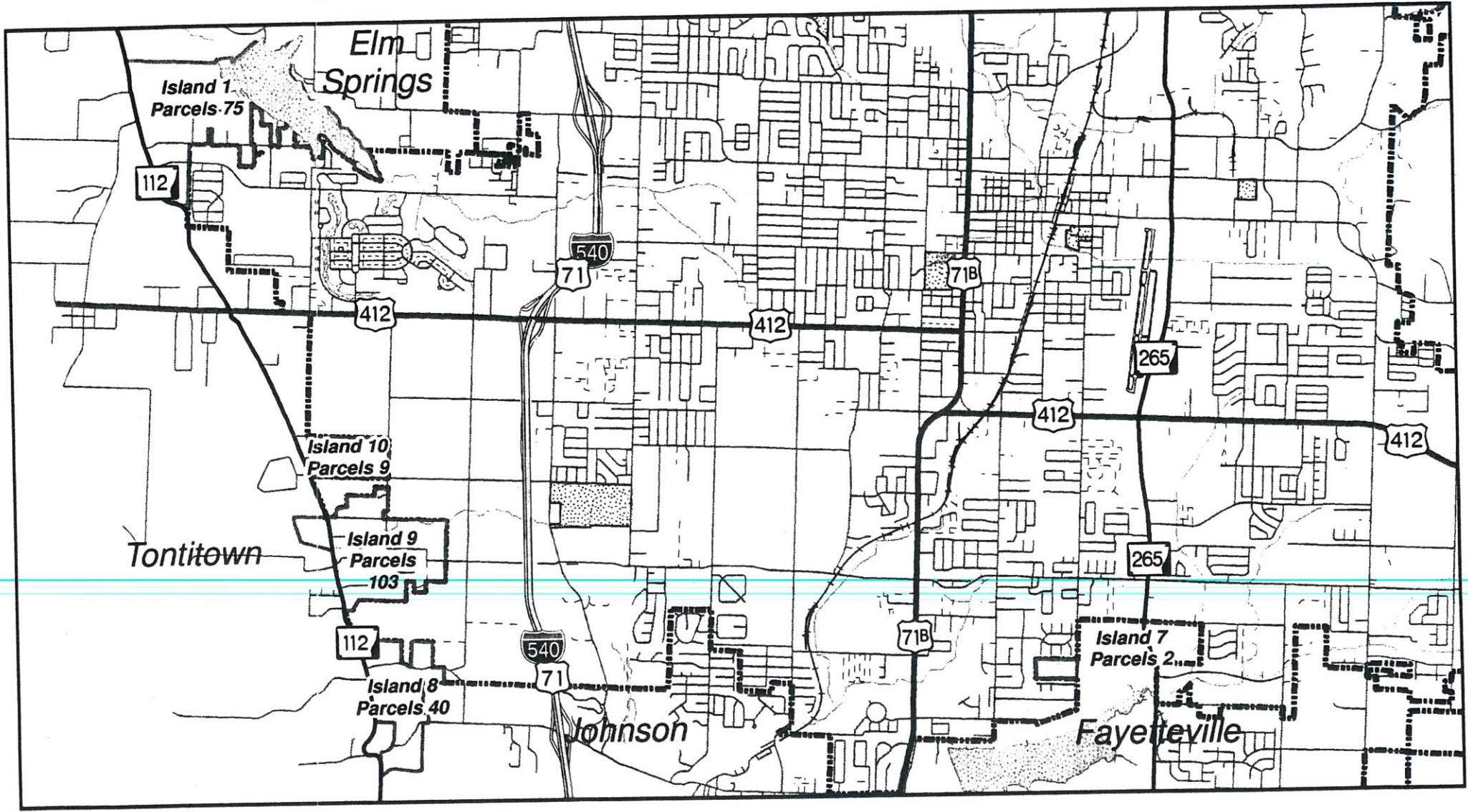

**City of Springdale, Arkansas**  
**Shared Island Annexation**  
**WASHINGTON COUNTY ISLANDS**



## Jennifer Wheeler

---

**From:** Clayton Sedberry <cstedberry@springdalear.gov>  
**Sent:** Tuesday, June 25, 2019 2:12 PM  
**To:** Jennifer Wheeler  
**Subject:** RE: Springdale City Limits

Yes please make any necessary corrections.

Thank you,  
Clayton



---

**From:** Jennifer Wheeler [mailto:Jennifer.Wheeler@arkansas.gov]  
**Sent:** Tuesday, June 25, 2019 11:03 AM  
**To:** Clayton Sedberry  
**Subject:** RE: Springdale City Limits

When I spoke with Jennifer at the City, she said I should work with you on getting approval to make corrections. Does the City wish that we remove this area from the state map?

### Jennifer Wheeler – GIS Analyst

Arkansas GIS Office  
1 Capitol Mall Ste 6D  
Little Rock, AR 72201  
501.682.2929 Office  
501.454.9524 Mobile  
501.407.0790 Fax  
[jennifer.wheeler@arkansas.gov](mailto:jennifer.wheeler@arkansas.gov) Email  
<http://www.gis.arkansas.gov> Web

---

**From:** Clayton Sedberry <cstedberry@springdalear.gov>  
**Sent:** Tuesday, June 25, 2019 10:35 AM  
**To:** Jennifer Wheeler <Jennifer.Wheeler@arkansas.gov>  
**Subject:** RE: Springdale City Limits

Yes. Attached.

**Clayton Sedberry**  
GIS Manager  
Information Technology  
479.756.7708  
Mobile 479.283.9307  
csedberry@springdalear.gov  
201 Spring Street  
Springdale, Arkansas 72764  
[www.SpringdaleAR.gov](http://www.SpringdaleAR.gov)



---

**From:** Jennifer Wheeler [<mailto:Jennifer.Wheeler@arkansas.gov>]  
**Sent:** Tuesday, June 25, 2019 10:04 AM  
**To:** Clayton Sedberry  
**Subject:** RE: Springdale City Limits

Hey—actually. Do you have a copy of the annexation docs you can send?

---

**From:** Clayton Sedberry <[csedberry@springdalear.gov](mailto:csedberry@springdalear.gov)>  
**Sent:** Tuesday, June 25, 2019 9:55 AM  
**To:** Jennifer Wheeler <[Jennifer.Wheeler@arkansas.gov](mailto:Jennifer.Wheeler@arkansas.gov)>  
**Subject:** RE: Springdale City Limits

Jennifer,

Long story short. The map for the annexation included this area but the annexation ordinance does not include this area. I do not show this as being in the city limits since I base my data on the ordinance. Let me know if you need anything else.

Clayton

**Clayton Sedberry**  
GIS Manager  
Information Technology  
479.756.7708  
Mobile 479.283.9307  
csedberry@springdalear.gov  
201 Spring Street  
Springdale, Arkansas 72764  
[www.SpringdaleAR.gov](http://www.SpringdaleAR.gov)



---

**From:** Jennifer Wheeler [<mailto:Jennifer.Wheeler@arkansas.gov>]  
**Sent:** Thursday, June 20, 2019 12:58 PM  
**To:** Clayton Sedberry  
**Subject:** FW: Springdale City Limits

Clayton,

Stephanie reached out to let us know we may have an error on the state map for Springdale. Do you show the below area inside the city limits in your data? It looks like the parcel data for this area supports the idea that it is indeed not in the city but rather is county.

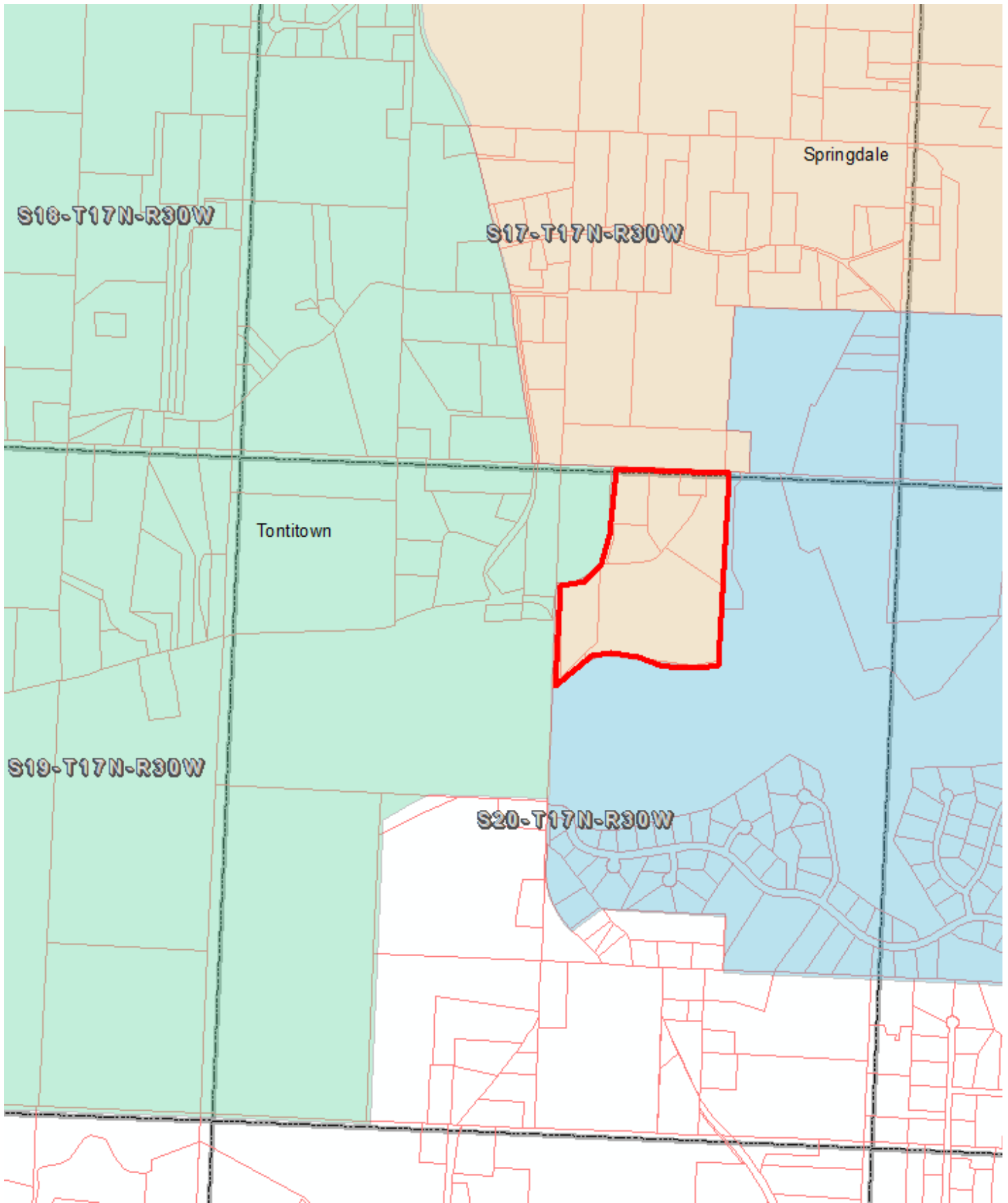

**Jennifer Wheeler – GIS Analyst**  
Arkansas GIS Office  
1 Capitol Mall Ste 6D



Little Rock, AR 72201  
501.682.2929 Office  
501.454.9524 Mobile  
501.407.0790 Fax  
[jennifer.wheeler@arkansas.gov](mailto:jennifer.wheeler@arkansas.gov) Email  
<http://www.gis.arkansas.gov> Web

**From:** Stephanie Shaw <[sshaw@nwarpc.org](mailto:sshaw@nwarpc.org)>  
**Sent:** Thursday, June 20, 2019 9:17 AM  
**To:** Jennifer Wheeler <[Jennifer.Wheeler@arkansas.gov](mailto:Jennifer.Wheeler@arkansas.gov)>  
**Subject:** Springdale City Limits

Good Morning Jennifer!

Happy Friday Eve! I was reviewing city limits and I found that you (the state) have an unincorporated area between Tontitown, Springdale, and Johnson (Washington Co) as being inside Springdale (see the bright green area below). I have no evidence that this is in Springdale and I also checked "My Springdale" which is Springdale's interactive web map service and it show this area out also.

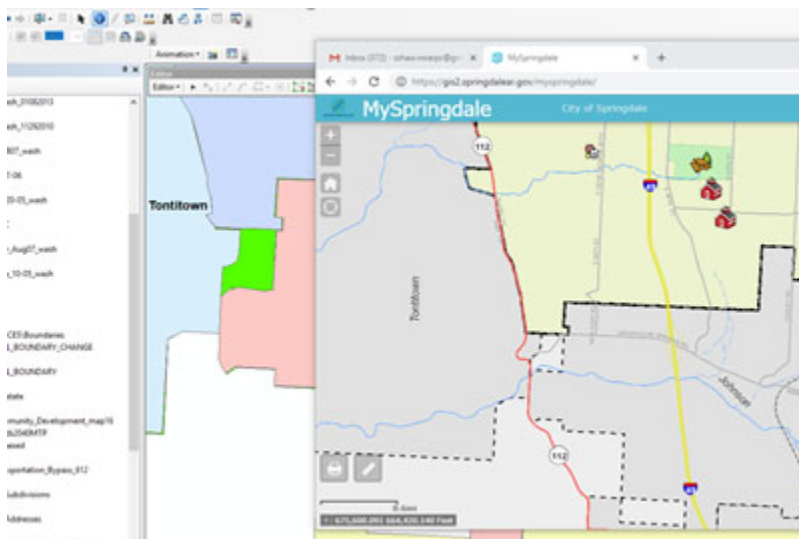

## Stephanie J. Shaw

Transportation/GIS Analyst  
NW Arkansas Regional Planning Commission  
1311 Clayton St.  
Springdale, AR 72762  
479.751.7125 x 107 (office)  
[sshaw@nwarpc.org](mailto:sshaw@nwarpc.org)  
<http://nwarpc.org/>