

**BAS Correction Historic Annex 2007-09: City of Higginson**  
**\*for Census only - was already on state map**

City: Higginson  
 Mayor: Randell Homsley

Arkansas Code 14-40-101.

Before an entity undertakes an annexation, consolidation, or detachment proceeding under this chapter, the entity shall coordinate with the Arkansas Geographic Information Systems Office for preparation of legal descriptions and digital mapping for the relevant annexation, consolidation, and detachment areas.

The map contained herein, is evidence, the entity has met requirements of Act 914 of 2015

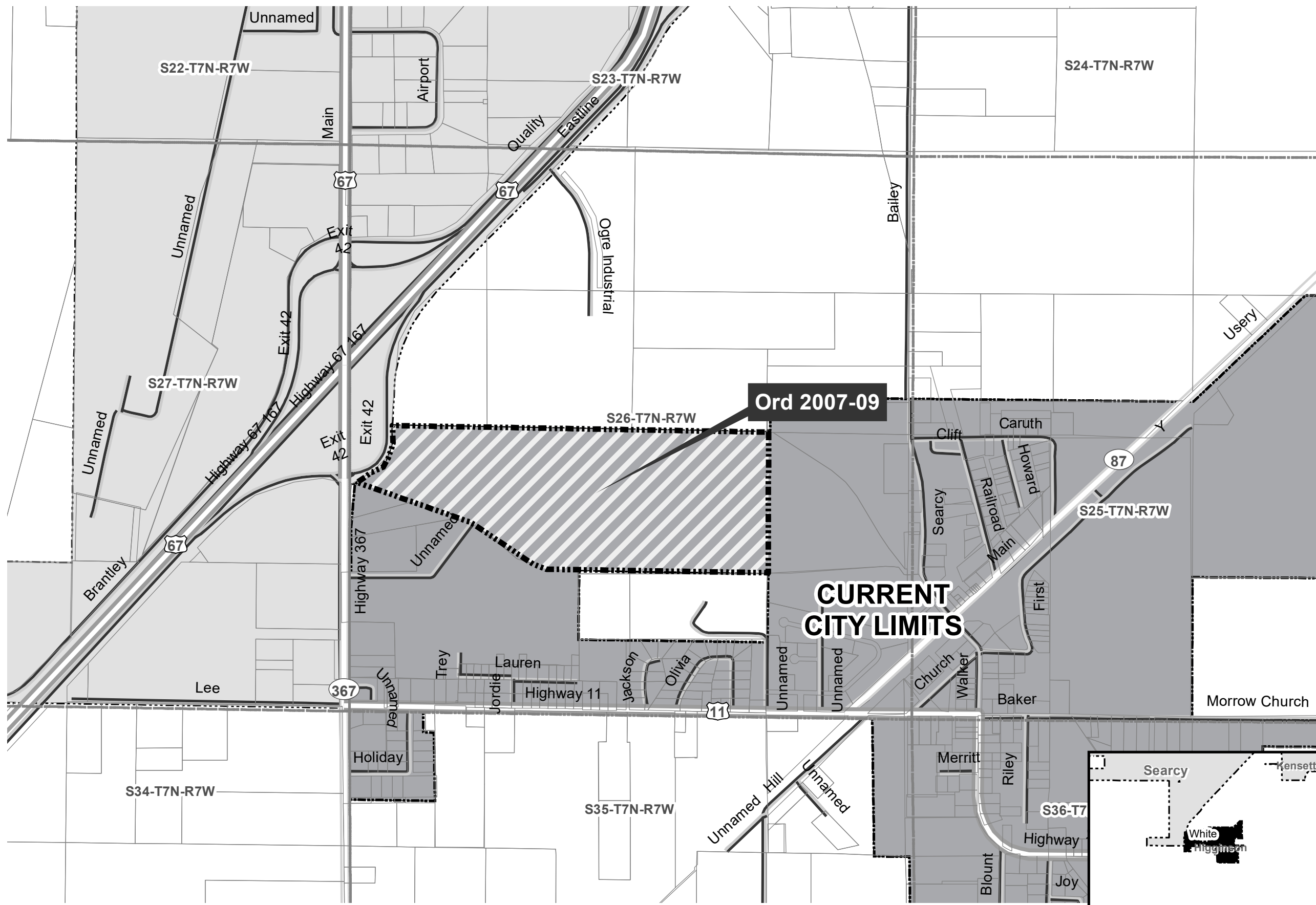

- Historic Annex
- Sections
- Parcels
- Highway
- Minor Road
- Existing City
- Neighboring City

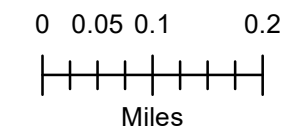



# State of Arkansas Secretary of State

Business & Commercial Services	682-3409
Elections	682-5070
Building & Grounds	682-3407
Communications & Education	683-0057
State Capitol Police	682-5173
Business Office	682-8052
Information Technology	682-3411

**Charlie Daniels**  
Secretary of State

June 26, 2008

The Honorable Tanya Burleson  
White County Clerk  
300 North Spruce  
Searcy, AR 72143

Dear Ms. Burleson:

The Following Information has been recorded and filed in the Office of the Secretary of State:

Date: June 23, 2008                      County: White                      City: Higginson

Annexation:	Ordinance No.	~~	2007-09
	County Order No		
	Plat	-	
	Election	-	XXX
Incorporation:	Island	-	
	Ordinance No.	-	
	Co. Order No.	-	
	Plat	-	
	Election	-	

Census Information: The following City or Town has been upgraded or reduced to:

- 1st Class City -
- 2nd Class City -
- Incorporated Town -

I have forwarded this information to the Arkansas Municipal League and the Arkansas Highway and Transportation Department and the Arkansas State Data Center. If you have any further questions please do not hesitate to contact me at 1-800-482-1127 or 682-3451

Sincerely,

Nancy Crockett  
Election Services Representative  
Arkansas Secretary of State

A TRUE COPY, I CERTIFY  
TANYA BURLESON  
WHITE COUNTY CLERK

this 23<sup>rd</sup> day of June 2008

*Tanya Burleson*  
ORDINANCE NO. 2007- 097

**FILED**

JUN 26 2008

CHARLIE DANIELS  
SECRETARY OF STATE

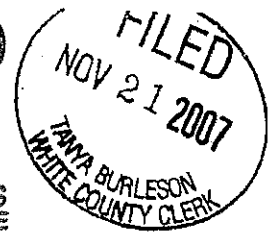

AN ORDINANCE SUBMITTING TO THE VOTERS OF THE TOWN OF HIGGINSON, ARKANSAS, AND OTHER AFFECTED PERSONS, THE QUESTION OF ANNEXATION TO SAID TOWN OF HIGGINSON, ARKANSAS, OF CERTAIN CONTIGUOUS TERRITORY; DECLARING AN EMERGENCY; AND FOR OTHER PURPOSES

WHEREAS, the Mayor of the Town of Higginson, Arkansas, and the Town Council in and for the Town of Higginson have, after due considerations, determined that certain hereinafter described territory contiguous to the Town of Higginson, Arkansas, is necessary for the orderly growth of said City; and

WHEREAS, a portion of the lands are platted and held for sale or use as municipal lots or, whether platted or not, a portion of the lands are held to be sold as suburban property; and

WHEREAS, the lands furnish the abode for a densely settled community or represent the actual growth of the Town of Higginson, Arkansas, beyond its now existing legal boundary; and

WHEREAS, the lands are needed for proper municipal purposes such as for the extension of needed municipal services; and

WHEREAS, the lands are valuable by reason of their adaptability for prospective municipal uses, as residences and commercial property; and

NOW THEREFORE, be it ordained by the Town Council of the Town of Higginson, Arkansas:

**Section 1.** That there shall be submitted to the qualified electors of the Town of Higginson and of the area described in Exhibit No. 1, the question of the annexation of the above described territory to the Town of Higginson, Arkansas. (A map outlining the area proposed for annexation is attached hereto as Exhibit No. 2 and is incorporated herein by reference as though set forth word for word.)

**Section 2.** The question of annexation of the territory described above in Section 1 shall be submitted to the electors qualified to vote on February 5, 2008. The Clerk for the Town Council Higginson shall immediately notify the White County Election Commission by forwarding a certified copy of this ordinance.

**Section 3.** If at such election a majority of the qualified electors voting in such election shall vote for such annexation, the municipality shall proceed to file a description and a map of the annexed area with the County Clerk of White County and with the Secretary of State. The annexation shall be included within the corporate limits of the annexing city thirty (30) days following the filing of the description and map with the County Clerk, or in the event an action is filed with the Circuit Court, on the date the judgment of said Court becomes final. If a majority of the qualified electors voting on the issue at the February 5, 2008, election vote against the

annexation, the annexation ordinance shall be null and void.

**Section 4.** The ballots used at the February 5, 2008, election on the question of annexation shall be marked as follows:

\_\_\_\_\_ FOR annexation of the territory described in Town of Higginson, Arkansas, Ordinance No. 2007- 09 .

\_\_\_\_\_ AGAINST annexation of the territory described in Town of Higginson, Arkansas, Ordinance No. 2007- 09 .

**Section 5.** If the annexation into the Town of Higginson is approved and becomes final, the following services shall be extended to the area within three (3) years:

<u>Service</u>	<u>Date</u>
Police Protection	Immediately
Fire Protection	Immediately
Sewer Service	Immediately

**Section 6.** The Mayor and Clerk are authorized to take all steps necessary for placing this measure on the ballot at the February 5, 2008, general election.

**Section 7. Emergency Clause.** The Town Council for the Town of Higginson, Arkansas, finds that the immediate implementation of this ordinance is necessary to give the Town of Higginson, The White County Clerk and the White County Election Commission sufficient time to prepare to the election contemplated herein to be held at the general election on February 5, 2008, in accordance with the provisions of Ark. Code Ann. § 14-40-303, and that because of the limited time that an emergency exists and that it is, therefore declared that this ordinance is necessary for the preservation of the public peace, health, safety and welfare and shall be in full force and effect from and after is passage.

Dated this 16th day of November, 2007.

**FILED**

JUN 26 2008

CHARLIE DANIELS  
SECRETARY OF STATE

BY \_\_\_\_\_

Approved:

Randall Homsey  
Mayor

Attest:

Imogene Stone  
Clerk

CERTIFICATE

I, Imogene Stone, Recorder/Treasurer of the Town of Higginson, hereby certify that this ordinance was duly passed and approved by a two-thirds vote of the total number of the governing body of the Town of Higginson, this 16<sup>th</sup> day of November, 2007

Seal

**FILED**

JUN 26 2008

CHARLIE DANIELS  
SECRETARY OF STATE

BY \_\_\_\_\_

EXHIBIT 1

A part of the Southwest Quarter (SW¼) of Section Twenty-Six (26), Township Seven North, Range Seven West (T-7-N, R-7-W), being more particularly described as follows: Beginning at the Southeast corner of the SW¼ of Section 26, T-7-N, R-7-W, as monumented with a nail and bottle cap; thence with the South line of said SW¼ being also the centerline of Arkansas Highway 11, N 88° 58' 41" W, 2642.32 feet to the centerline of Arkansas Highway 367; thence with said centerline, N 00° 24' 21" W, 786.04 feet to a point; thence leaving the centerline and with the South line of the Chesapeake Energy Nomac Training Camp line the following courses: S 88° 58' 08" E, a distance of 490.12'; thence S 00° 33' 05" E, a distance of 521.47'; thence S 88° 59' 18" E, a distance of 452.31'; thence N 00° 48' 29" E, a distance of 100.03'; thence S 89° 56' 45" E, a distance of 140.30'; thence N 01° 11' 28" E, a distance of 41.87'; thence 88° 56' 32" E, a distance of 350.66'; thence N 00° 59' 38" E, a distance of 100.00'; thence S 88° 56' 32" E, a distance of 70.00'; thence S 00° 59' 38" W, a distance of 100.00'; thence S 89° 01' 36" E, a distance of 139.98'; thence N 01° 00' 17" E, a distance of 100.0'; thence S 88° 55' 53" E, a distance of 69.97'; thence S 01° 00' 17" W, a distance of 100.00'; thence S 88° 52' 48" E, a distance of 490.04'; thence N 00° 21' 53" E, a distance of 256.53'; thence S 89° 03' 26" E, a distance of 440.16'; thence S 00° 23' 44" W, a distance of 662.47'; containing 30.2315+ acres, according to a survey performed November 8, 2007, under the supervision of Michael Petty, Arkansas professional Surveyor #1394. Subject to all existing easements and right of ways for roads, utilities, or other purposes.

**FILED**

JUN 26 2008

CHARLIE DANIELS  
SECRETARY OF STATE

BY \_\_\_\_\_

Exhibit # 2 2

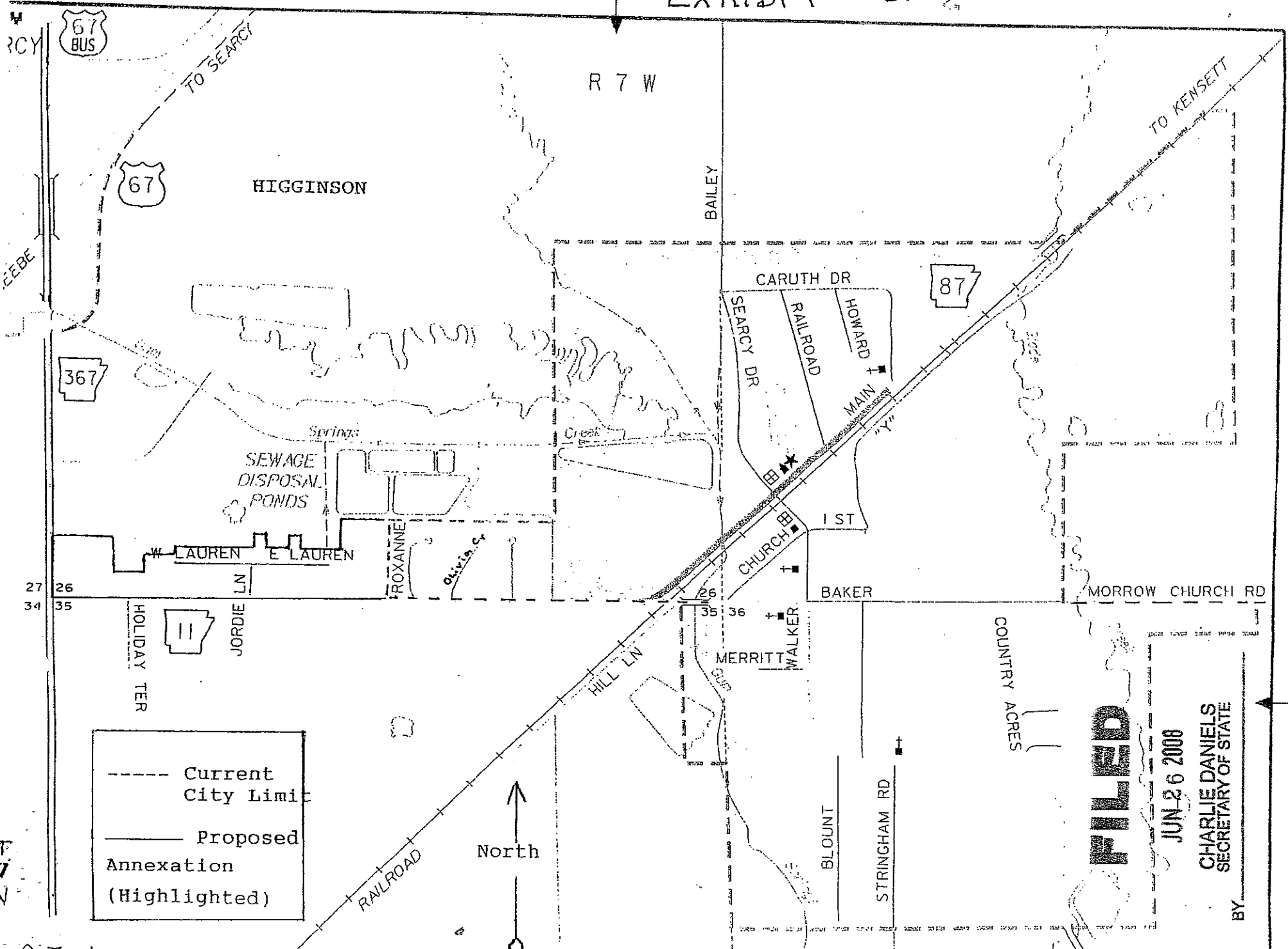

**FILED**

JUN 26 2008

CHARLIE DANIELS  
SECRETARY OF STATE

BY

Page 1 of **FILED**  
FEB 13 2008  
TANYA BURLESON  
WHITE COUNTY CLERK

# Abstract of Ballots Cast at the 2008 Presidential Preferential Primary Election held in White County, Arkansas on the 5th of February, 2008

We hereby certify that the attached is a true and correct abstract of ballots for the candidates named herein at the 2008 Presidential Preferential Primary Election held in White County, Arkansas on the 5th of February, 2008, as shown by the attached returns.

Witness our hands as Members of the White County Board of Election Commissioners this 13th day of February 2008.

Democratic Chairman:

Diane Thomas

Republican Chairman:

Arthur E. Baker

Third Member:

Judy Webb

\* This abstract is to be mailed to the Secretary of State Election Division, State Capitol, Room 026, Little Rock, Arkansas 72201, no later than the tenth calendar day after the election.

**FILED**

JUN 26 2008

CHARLIE DANIELS  
SECRETARY OF STATE

BY \_\_\_\_\_

A TRUE COPY, I CERTIFY  
TANYA BURLESON  
WHITE COUNTY CLERK

this 23rd day of June, 2008

Tanya Burleson

A18/171



	TOTAL VOTES	%	ELECTION DAY	EARLY VOTING	ABSENTEE	PROVISIONAL
Higginson Annexation						
Vote for 1						
FOR ANNEXATION . . . . .	79	56.03	71	5	3	0
AGAINST ANNEXATION . . . . .	62	43.97	58	4	0	0

**FILED**  
 JUN 26 2008  
 CHARLIE DANIELS  
 SECRETARY OF STATE  
 BY \_\_\_\_\_

A18/180

OFFICIAL BALLOT NON PARTISAN ELECTION FEBRUARY 5, 2008

A Typ:04 Seq:0007 Spl:01 B C

INSTRUCTIONS TO VOTERS

Vote by placing an appropriate mark (blacken the oval) opposite the person for whom you wish to vote. Vote on the amendment, acts and measures by placing the appropriate mark (blacken the oval) beside the measure either for or against. If you vote for more than one candidate in a race you vote will not count. If you vote for and against your vote will not count. If you make a mistake on your ballots contact your election official for a replacement. You may replace up to two (2) ballots.

SPECIAL ELECTION ON HIGGINSON ANNEXATION

FOR annexation of the territory described in Town of Higginson, Arkansas, Ordinance No. 2007-09.

AGAINST annexation of the territory described in Town of Higginson, Arkansas, Ordinance No. 2007-09.

- FOR ANNEXATION
- AGAINST ANNEXATION

FILED

JUN 26 2008

CHARLIE DANIELS  
SECRETARY OF STATE

BY \_\_\_\_\_

A TRUE COPY, I CERTIFY  
TANYA BURLESON  
WHITE COUNTY CLERK  
this 23<sup>rd</sup> day of June, 2008

*Tanya Burleson*

A18/181



11  
14  
21  
40  
41  
42  
44  
53