

**BAS Correction Historic Annex: City of Kensett**  
 \*for Census only - was already in state map

City: Kensett  
 Mayor: Alan Edge

Arkansas Code 14-40-101.

Before an entity undertakes an annexation, consolidation, or detachment proceeding under this chapter, the entity shall coordinate with the Arkansas Geographic Information Systems Office for preparation of legal descriptions and digital mapping for the relevant annexation, consolidation, and detachment areas.

The map contained herein, is evidence, the entity has met requirements of Act 914 of 2015

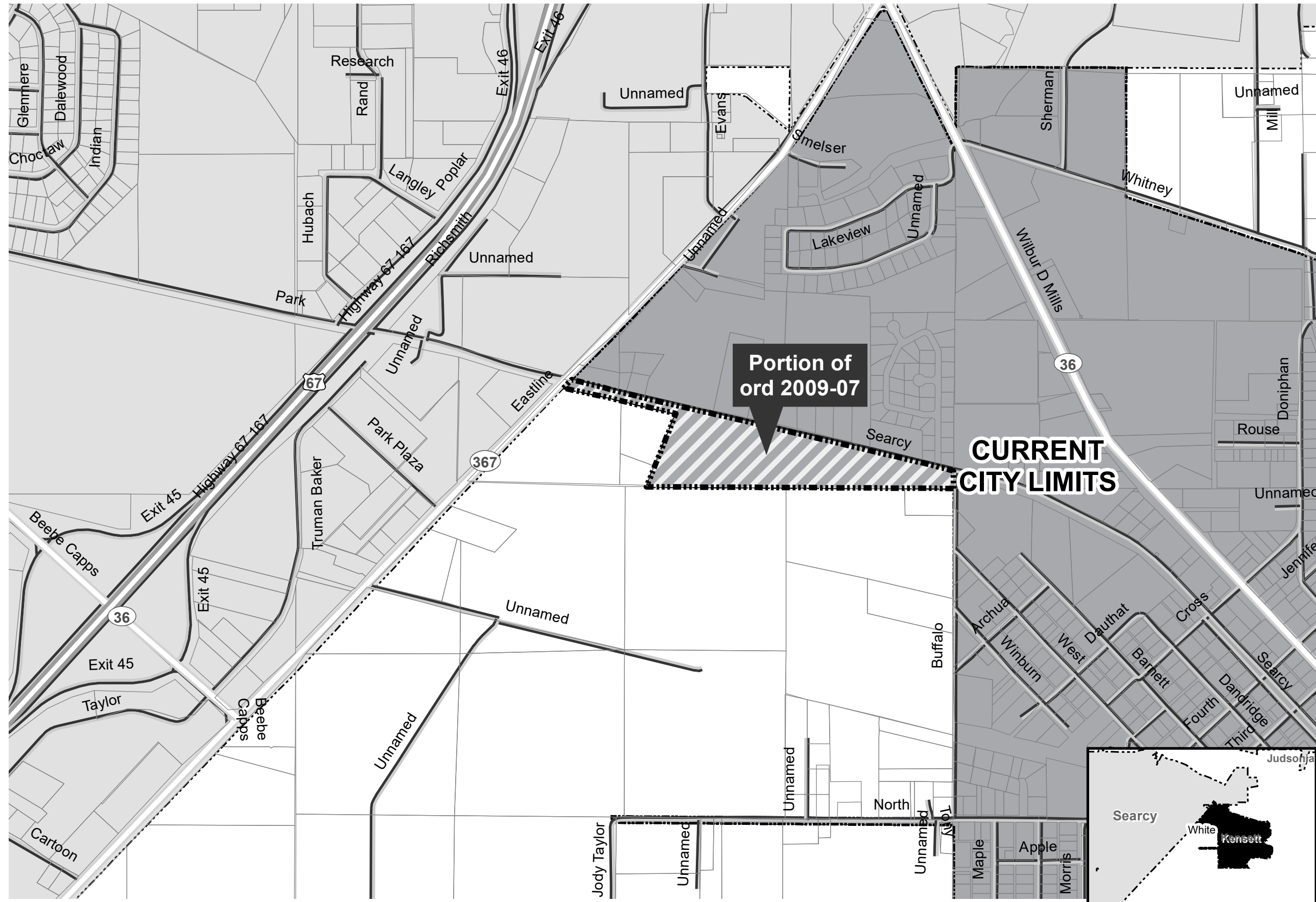

- Historic Annex
- Parcels
- Highway
- Minor Road
- Existing City
- Neighboring City
- County Boundary

Portion of Ord 2009-07

**CURRENT CITY LIMITS**

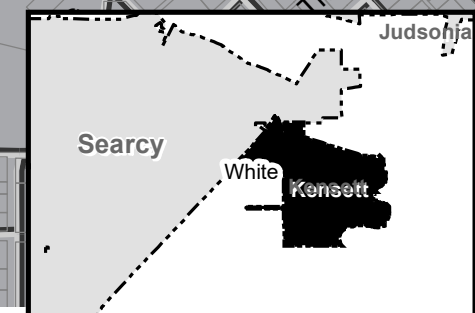
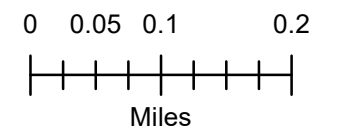



# State of Arkansas Secretary of State

**Charlie Daniels**  
Secretary of State

Business & Commercial Services	682-3409
Elections	682-5070
Building & Grounds	682-3407
Communications & Education	683-0057
State Capitol Police	682-5173
Business Office	682-8032
Information Technology	682-3411

June 2, 2010

The Honorable Tanya Burleson  
White County Clerk  
White County Courthouse  
Searcy, AR 72143

Dear Ms. Burleson:

The Following Information has been recorded and filed in the Office of the Secretary of State:

Date: June 25, 2010      County: White      Town: Kensett

<b>Annexation:</b>	Ordinance No: 2009-07
	County Order No.— CC2009-19
	Plat                    -    x
	Election               -
	Island                 -
<b>Incorporation:</b>	Ordinance No.       -
	Co. Order No.       -
	Plat                    -
	Election               -

**Census Information:** The following City or Town has been upgraded or reduced to:

- 1st Class City -
- 2nd Class City -
- Incorporated Town -

I have forwarded this information to the Arkansas Municipal League and the Arkansas Highway and Transportation Department and the Arkansas State Data Center. If you have any further questions please do not hesitate to contact me at 1-800-482-1127 or 682-3451

Sincerely,

Pam Ratliff  
Election Services Representative  
Arkansas Secretary of State

# TANYA BURLESON

## WHITE COUNTY CLERK

### COUNTY/PROBATE/MARRIAGE LICENSE:

Dani Smith, Deputy Clerk  
Stephenie Eason, Deputy Clerk  
Carla Ervin, Deputy Clerk  
Phone: 501-279-6204

### VOTER REGISTRATION:

Tara McKnight, Deputy Clerk  
T.J. Higgs, Deputy Clerk  
Paula Wadley, Deputy Clerk  
Phone: 501-279-6207



315 N. SPRUCE  
SEARCY, AR 72143  
PHONE: 501-279-6204  
Fax: 501-279-6260

### ACCOUNTING/PAYROLL:

Jean Sellers, Chief Deputy Clerk  
Marquita Teague, Deputy Clerk  
Brittney Hawkins, Deputy Clerk  
Phone: 501-279-6262

### E-MAIL:

[whitecountyclerk@cablelynx.com](mailto:whitecountyclerk@cablelynx.com)

### WEBSITE:

[www.whitecountyar.org/white\\_county\\_clerk.php](http://www.whitecountyar.org/white_county_clerk.php)

June 23, 2010

Honorable Charlie Daniels  
Secretary of State  
State Capitol Building  
Little Rock, AR 72201

Re: CO-2009-19 Annexation of the City of Kensett

Dear Mr. Daniels:

Enclosed, please find certified copies of the following instruments in connection with the above referenced case.

1. Order of Confirmation of Annexation
2. Ordinance No. 2009-7: An Ordinance Accepting Certain Territory Annexed to the City of Kensett, Arkansas.
3. Plat of property Annexed

I have mailed copies to the Arkansas Public Service Commission.

If you have any questions, please do not hesitate to contact me.

Sincerely,

Tanya Burlison  
White County Clerk

**FILED**

JUN 28 2010

CHARLIE DANIELS  
SECRETARY OF STATE

BY \_\_\_\_\_

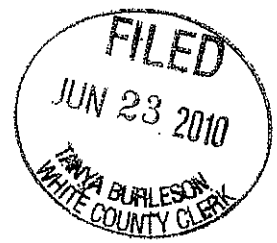

**IN THE COUNTY COURT OF WHITE COUNTY, ARKANSAS**

**NO. 2009-19**

**IN THE MATTER OF THE ANNEXATION  
OF CERTAIN LANDS TO THE CITY OF  
KENSETT, WHITE COUNTY, ARKANSAS**

**ORDER OF CONFIRMATION OF ANNEXATION**

Comes on for hearing the above-styled proceeding before the County Court of White County, Arkansas. The said Court being well and sufficiently advised in the premises finds:

1. That this Court entered its Order for Annexation of certain territory as subscribed in the Petition of Annexation on July 20, 2009.
2. That pursuant to Arkansas Code Annotated Section 14-40-604, more than 30 days from and after the entry of the said Order of Annexation passed and no notice objecting to the said annexation or any other proceeding to prevent the said annexation was given or filed.
3. That the City Council for the City of Kensett, Arkansas has, by ordinance No. 2009-07 accepted the said territory pursuant to the requirements of Arkansas Code Annotated Section 14-40-605 (a).
4. That the City of Kensett referred the annexation to the electorate of the City of Kensett on April 13<sup>th</sup>, 2010. The results of said election were 191 in favor of annexation and 170 opposed to the annexation.

**NOW THEREFORE IT IS CONSIDERED, ORDERED AND ADJUDGED that**

*[Faint, illegible text]*

BEFORE THE CITY COUNCIL OF KENSETT, ARKANSAS

ORDINANCE No: 2009- 07

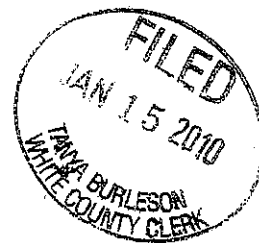

**AN ORDINANCE TO ACCEPT INTO THE CITY LIMITS OF THE CITY OF KENSETT, ARKANSAS, CERTAIN TERRITORY ANNEXED INTO THE KENSETT CITY LIMITS BY ORDER OF THE COUNTY COURT OF WHITE COUNTY, DECLARING AN EMERGENCY AND FOR OTHER PURPOSES:**

Whereas, the City of Kensett, Arkansas petitioned the County Court of White County, Arkansas, to annex certain properties into the Kensett city limits, and

Whereas, the County Court of White County, Arkansas, on July 20, 2009, entered an order annexing certain properties into the Kensett city limits, and

Whereas, the City Council of the City of Kensett, Arkansas, desires to accept said properties and territory into the city limits of Kensett.

**NOW THEREFORE BE IT ORDAINED**, by the City Council for the City of Kensett, to-wit:

Section 1. The City Council of Kensett, Arkansas, hereby accepts into the city limits of Kensett, Arkansas, the following described territory:

**The South 25 feet of the NE ¼ of Section 18, Township 7 North, Range 6 West lying East of the West line of Jody Taylor Road and the North 25 feet of the SE ¼ of Section 18, Township 7 North, Range 6 West lying East of the West line of Jody Taylor Road.**

Section 2. That the Clerk of the County Court of White County, Arkansas, is hereby requested pursuant to A. C. A. § 14-40-605 to certify a copy of the plat of the annexed territory and one copy of the order of the County Court and to forward said certified copies along with a certified copy of this Ordinance to the Office of the Secretary of State for the State of Arkansas, and the Director of the Tax Division of the Arkansas Public Service Commission.

Section 3. It being hereby ascertained and declared that in as much as there is an immediate need to include the above described properties and territory into the city limits of the City of Kensett, Arkansas, for the purpose of providing city services to said properties and allow the orderly development of said properties under the applicable city codes that an emergency exists and this ordinance being necessary for the preservation of the public health, safety and welfare shall take effect from and after the date of its passage.

**FILED**

JUN 28 2010

CHARLIE DANIELS  
SECRETARY OF STATE

BY \_\_\_\_\_

A TRUE COPY, I CERTIFY  
TANYA BURLESON  
WHITE COUNTY CLERK

this 20th day of June, 2010  
*Tanya Burleson by Stephanie Conner, DC*

Passed and Adopted this 15 day of December 2009.

CITY OF KENSETT, ARKANSAS

  
\_\_\_\_\_  
Max McDonald, Mayor

Attest:

  
Linda Fuller, City Recorder



Jody Taylor Road

18-7-6

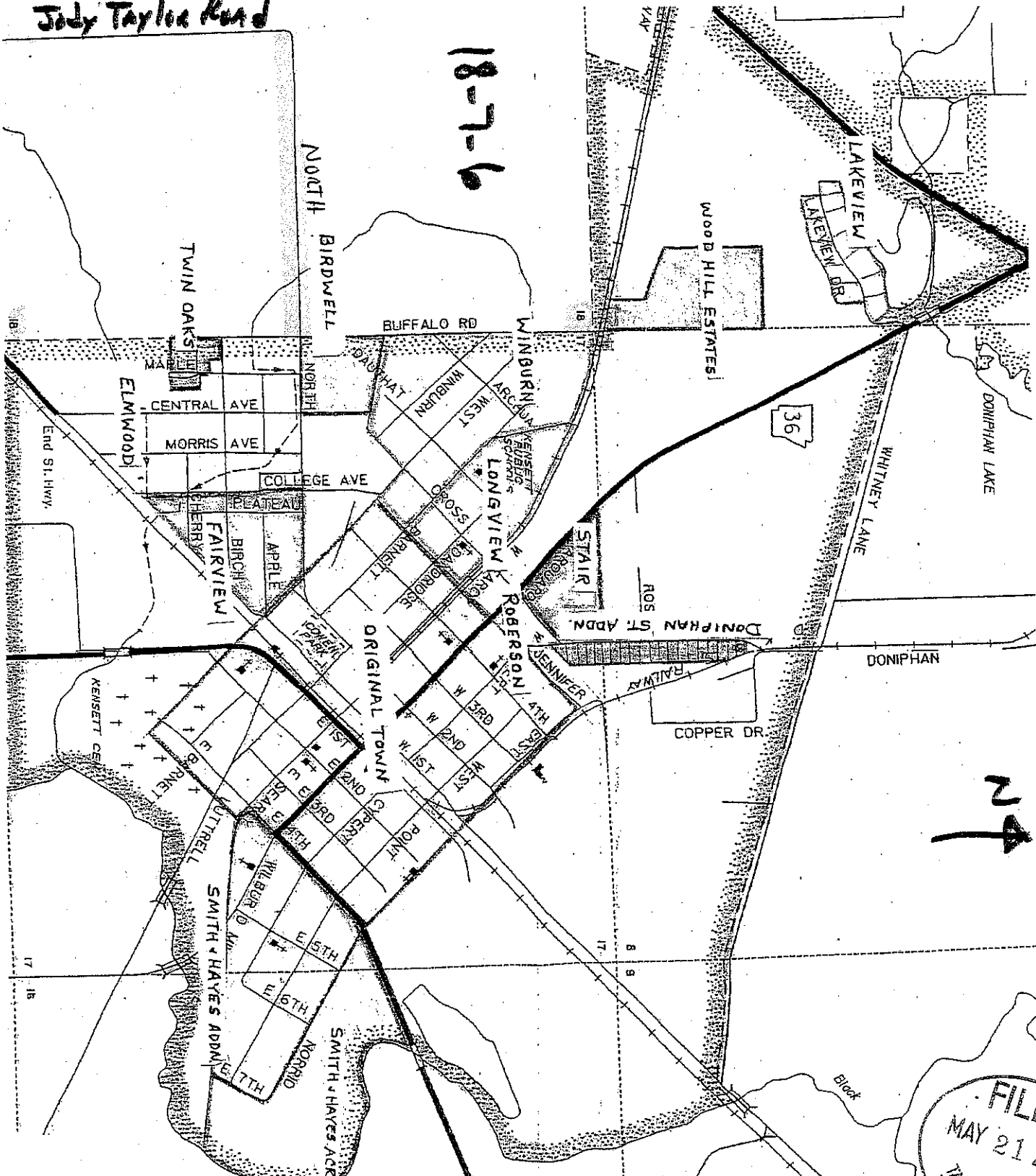

36

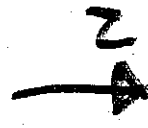

**FILED**

JUN 28 2010

CHARLIE DANIELS  
SECRETARY OF STATE

BY

A TRUE COPY, I CERTIFY  
TANYA BURLESON  
WHITE COUNTY CLERK

this 24th day of June 2010

Tanya Burleson by Stephen Coonine

FILED  
MAY 21 2009  
TANYA BURLESON  
WHITE COUNTY CLERK

Co-2009-1

**KEN**  
MA

31

CG-2009-19

FILED  
MAY 27 2009  
FBI - NEW YORK  
CLERK

1/24/09  
10-10-09

SEARCHED

INDEXED

10/1/09

10-31-09

North Street

SEARCHED

001-03772-000

Case Filed

10/1/09