

Historic Annex Ord 561: City of Wynne
*for Census only - was already in state map

City: Wynne
Mayor: Jennifer Hobbs

Arkansas Code 14-40-101.

Before an entity undertakes an annexation, consolidation, or detachment proceeding under this chapter, the entity shall coordinate with the Arkansas Geographic Information Systems Office for preparation of legal descriptions and digital mapping for the relevant annexation, consolidation, and detachment areas.

The map contained herein, is evidence, the entity has met requirements of Act 914 of 2015

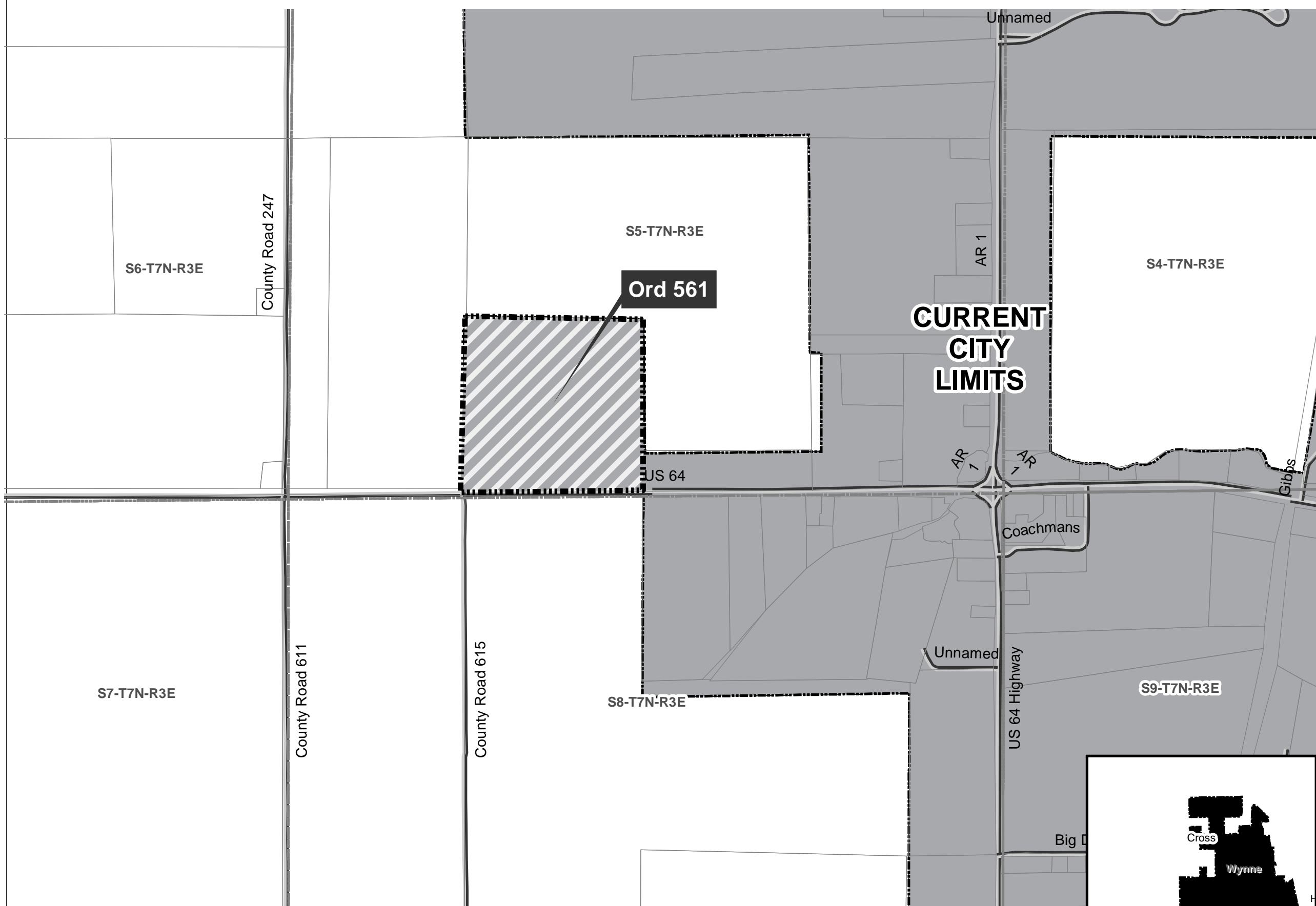

- Annex
- Sections
- Parcels
- Minor Road
- Existing City
- Neighboring City
- County Boundary

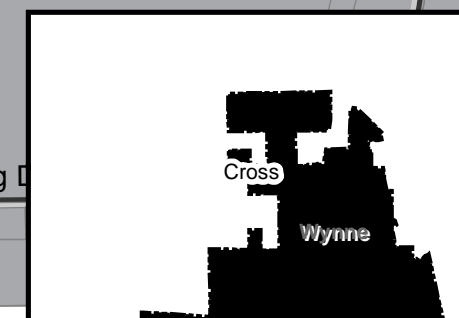
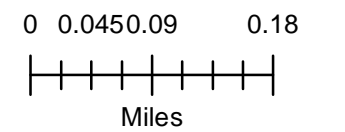



State of Arkansas
SECRETARY OF STATE

Sharon Priest
SECRETARY OF STATE

plotted

February 23, 1996

The Honorable Peggy T. Jones
Cross County and Probate Clerk
Cross County Courthouse
705 Union, Room #8
Wynne, AR 72396

Dear Ms. Jones:

This office has received the Decree of Annexation, Ordinance No. 561, the County Order of Confirmation, and the plat from the City of Wynne, Cross County, Arkansas. This annexation has been recorded and filed as of February 23, 1996.

If we may be of further service, please contact our office at 682-5070 or 800-482-1127.

Sincerely,

A handwritten signature in cursive script that reads "Judy Steelman".

Judy Steelman
Elections Assistant

cc: The Honorable Doris Holland
Wynne City Clerk
P. O. Box 499
Wynne, AR 72396

Mr. Don Zimmerman, Director
Arkansas Municipal League
P. O. Box 38
North Little Rock, AR 72115-0038

✓ DESCRIPTION:

Crosslawn Cemetery

Twenty (20) acres of land more particularly described as follows:

A part of the NW $\frac{1}{4}$, Section 4, Township 7-N, Range 3-E, Cross County, Arkansas and more particularly described as follows: From the SE corner Section 32, T-~~8~~-N, R-3-E, Cross County, Arkansas and on the North line of Section No. 4; thence N 89 degrees 30' E, 34.3 feet to the intersection of the East R/W line of Highway No. 1 and the Section line and the point of beginning. ✓

From the point of beginning N 89 degrees 30' E, 1360.0 feet to a point; ✓ thence S 0 degrees 37' E, 611.3 feet to a point; ✓ thence S 89 degrees 30' W, 1507.9 feet to a point on the East R/W line of Highway No. 1; ✓ thence N 17 degrees 35' E, 80.00 feet to the point of curvature; ✓ thence North Easterly along said R/W line and parallel to the center line of Highway No. 1 same being on a 2 degrees 00' curve, 550.0 feet to the point of beginning. ✓

Containing: 20.00 acres more or less.

ALSO

✓ A parcel of land in the Southwest Quarter (SW $\frac{1}{4}$) of Section 33, Township 8 North, Range 3 East, Cross County, Arkansas, and more particularly described as follows:

From the Southwest Corner of above Section 33, thence North 89 degrees 30' East 34.3 feet to a point on the East right-of-way line of State Highway 1 for a point of beginning; ✓ thence north 89 degrees 30' East 1360.0 feet; ✓ thence North 0 degrees 37' west 70.0 feet to a point in the center of a creek; ✓ thence westerly along the center of said creek approximately 1361.5 feet to a point of intersection with the east right-of-way line of State Highway 1; ✓ thence southerly along said right-of-way line along a 2 degrees 00' curve 25.0 feet to the point of beginning and containing 1.48 acres, more or less. ✓

DESCRIPTION:

✓ The Southeast quarter of the Southwest quarter of Section 5, T-7-N, R-3-E, Cross County, Arkansas.

DESCRIPTION:

A 300.0 Ft strip of land adjacent to and parallel with the right of way line of Arkansas Highway 64 of the Southwest Quarter of the Southeast Quarter of Section 5, T 7 N, R 3 E, Cross County, Arkansas

DESCRIPTION:

The Northwest Quarter (NW $\frac{1}{4}$) of Section Four (4), Township Seven (7) North, Range Three (3) East, Cross County, Arkansas;

was taken in by earlier desc.

LESS AND EXCEPT: From the Southeast corner of Section Thirty-Two (32), and on the North line of Section Four (4); thence North 89 degrees 30 minutes East 34.3 feet to the intersection of the East right of way line of Highway No. 1 and the Section line and the point of beginning; thence from the point of beginning, North 89 degrees 30 minutes East, 1360 feet to a point; thence South 0 degrees 37 minutes East, 611.3 feet to a point; thence South 89 degrees 30 minutes West, 1507.9 feet to a point on the East right of way line of Highway No. 1; thence North 17 degrees 35 minutes East 80.0 feet to the point of curvature; thence Northeastarly along said right of way line and parallel to the center line of Highway No. 1, same being on a 2 degree 00 minute curve, 550.0 feet to the point of beginning, and containing 20.00 acres, all in Township Seven (7) North, Range Three (3) East;

LESS AND EXCEPT: All that part of the Northwest Quarter (NW $\frac{1}{4}$) of the Northwest Quarter (NW $\frac{1}{4}$) of Section Four (4), Township Seven (7) North, Range Three (3) East, which lies North and West of Arkansas State Highway No. 1, Cross County, Arkansas;

was taken in by earlier desc.

LESS AND EXCEPT: A 31.6 acre tract of land lying in the Northwest Quarter (NW $\frac{1}{4}$) of Section Four (4), Township Seven (7) North, Range Three (3) East, Cross County, Arkansas, and being more particularly described as: Commencing at the Northwest Corner of Section Four (4), Township Seven (7) North, Range Three (3) East; thence North 89 degrees 30 minutes East 1750.7 feet along the North line of said Section Four (4) to the point of beginning; thence South 00 degrees 37 minutes East 611.30 feet along the East line of the Crosslawn Cemetery Property; thence South 89 degrees 30 minutes West 1501.34 feet along the South line of the Crosslawn Cemetery Property to a point on the East right-of-way line of U.S. Highway Number One (1); thence South 17 degrees 21 minutes 26 seconds West 315.18 feet along the East right-of-way line of U.S. Highway Number One (1); thence North 89 degrees 30 minutes East 2598.12 feet to a point on the East line of the Northwest Quarter (NW $\frac{1}{4}$) of said Section Four (4); thence North 00 degrees 32 minutes 41 seconds West 911.30 feet along the East line of the Northwest Quarter (NW $\frac{1}{4}$) of said Section Four (4) (Old Fence Line) to the Northeast Corner of the Northwest Quarter (NW $\frac{1}{4}$) of Section Four (4); thence South 89 degrees 30 minutes West 1000.67 feet along the North line of said Section Four (4) to the point of beginning, containing 31.6 acres, more or less;

And leaving a balance of 92.6 acres, more or less.

Well 243T

Well 247T

BR 259T

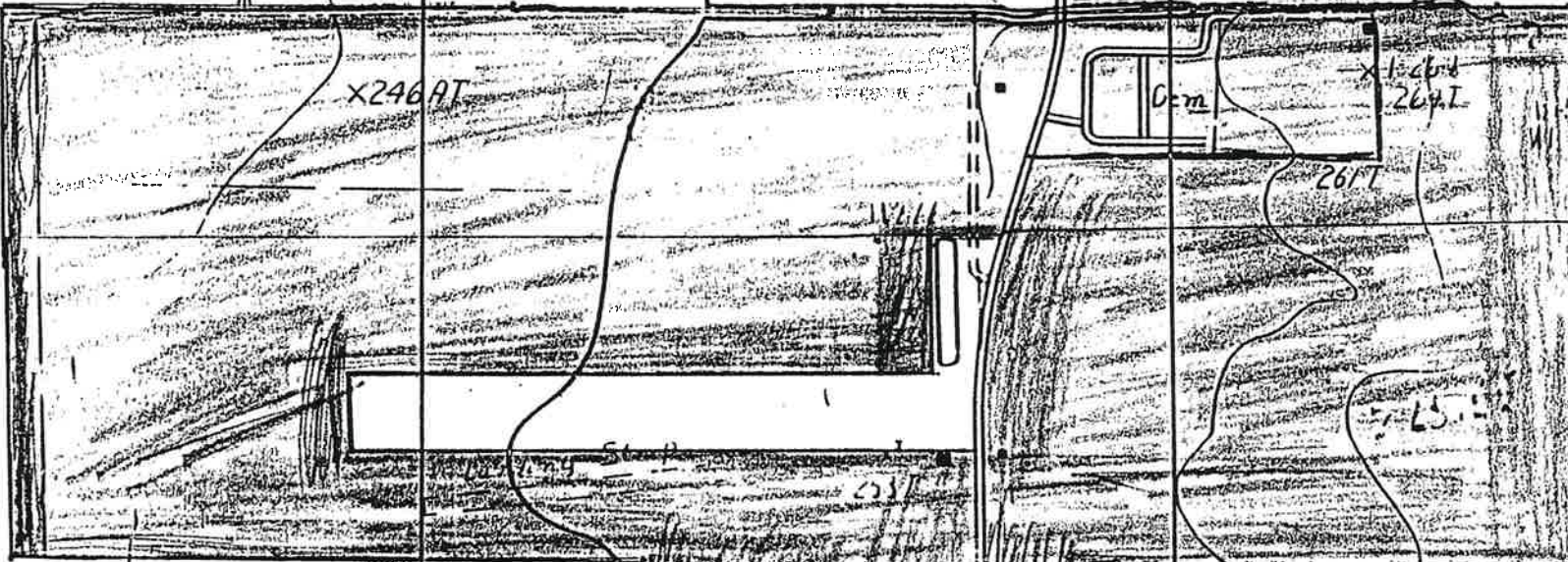

5

WELL 253T

X251AT

Well 267T

400' E of Hwy 1 OF SWM

Ord # 561

Well 242T

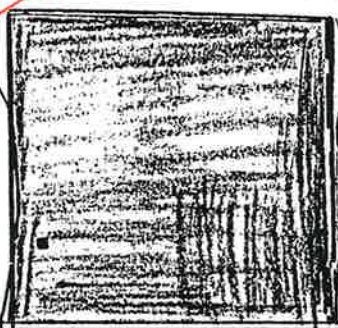

WATER TOWER IN CITY NOW

Turkey

HIWAY OFFICE

HARRELL'S CORNER

WELL CORNER

WYNNE

240T

243T

243

2461

1-265 2461