

Historic Detachment CO-87-4: City of Franklin
February 2020

City: Franklin
Mayor: Barbara Dustov

Arkansas Code 14-40-101.

Before an entity undertakes an annexation, consolidation, or detachment proceeding under this chapter, the entity shall coordinate with the Arkansas Geographic Information Systems Office for preparation of legal descriptions and digital mapping for the relevant annexation, consolidation, and detachment areas.

The map contained herein, is evidence, the entity has met requirements of Act 914 of 2015

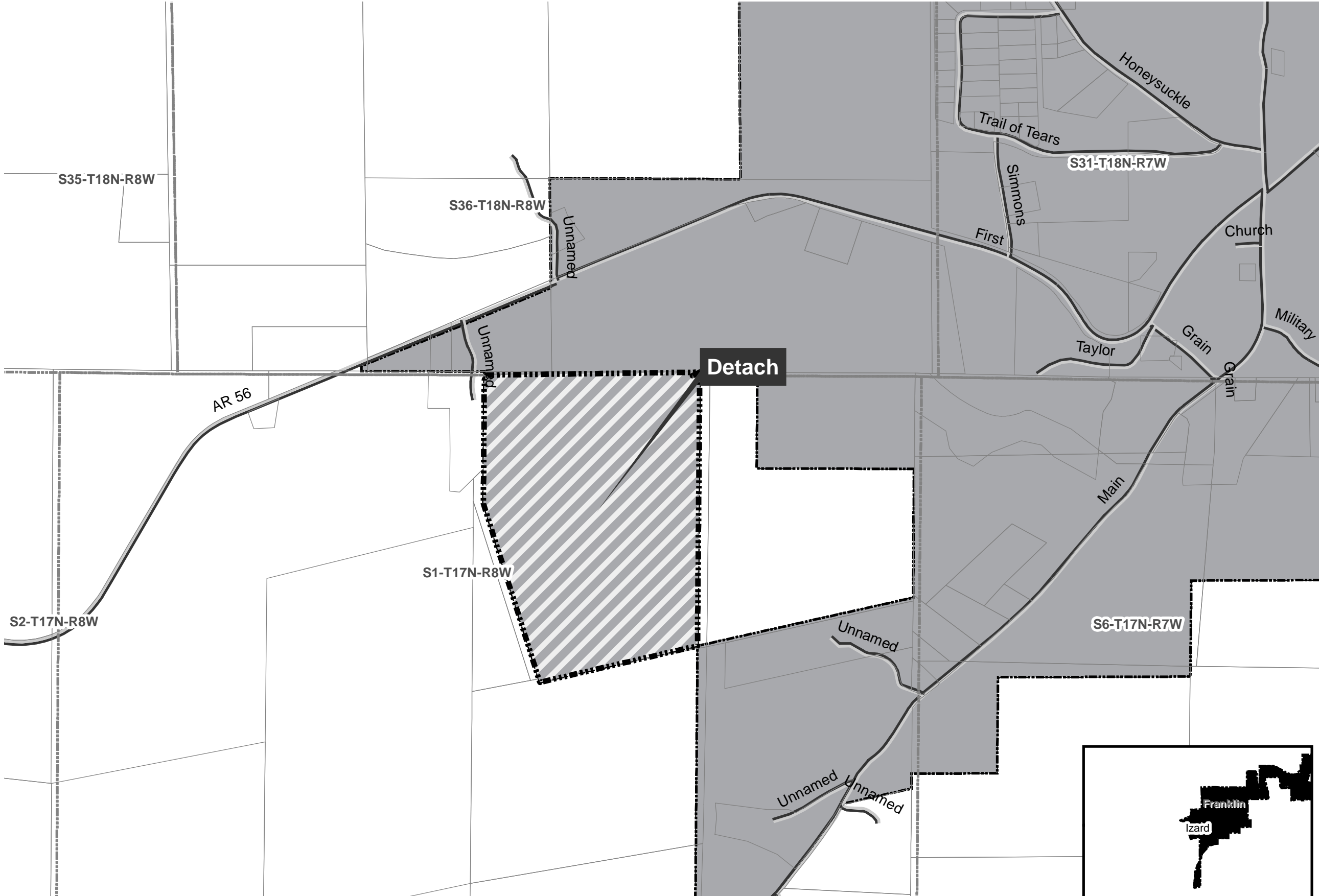

- Historic Detachment
- Sections
- Parcels
- Minor Road
- Existing City
- Neighboring City
- County Boundary

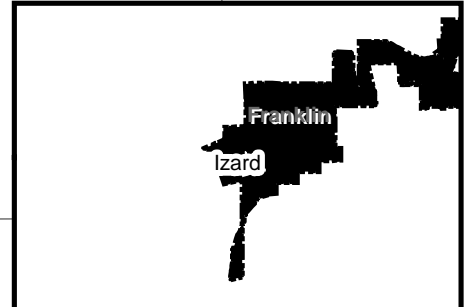
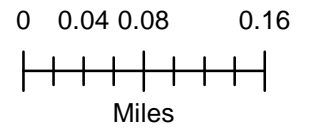

IN THE COUNTY COURT OF IZARD COUNTY, ARKANSAS

IN THE MATTER OF THE DETACHMENT OF
LANDS FROM THE CITY OF FRANKLIN,
IZARD COUNTY, ARKANSAS

NO. CO-87-4

HARRY McCLAIN

EX PARTE PETITIONER

ORDER

Now on this 13th day of November, 1987, the same being the day scheduled for hearing in the above case and matter, comes on to be heard the above cause, and from the Petition filed herein, the Proof of Publication filed, the notice of hearing published in the time and manner required by law, the plat designating the lands affected, the testimony of the petitioner, and from all of which and other matters and things before the Court, this Court finds:

1. That this Court has jurisdiction over the subject matter as provided by Ark. Stat. Ann. 19-325, et. seq.
2. That on October 20, 1987, the petitioner, Harry McClain, acting through his designated agent and attorney, L. Gray Dellinger, filed herein his Petition seeking the deannexation of lands from the boundaries comprising the incorporated city limits of the City of Franklin, IZARD County, Arkansas and that notice of the filing of such petition, together with the notice of the hearing to be held thereon, was published in The Times, a newspaper having a bona fide and general circulation in IZARD County, Arkansas in the time and manner required by Ark. Stat. Ann. 19-326.
3. That on the day scheduled for hearing, Friday, November 13, 1987 at 10:00 o'clock a.m. in the IZARD County Courthouse, no one appeared in opposition of the relief sought in said petition and no one objected at the hearing, or filed herein written objection, of the proposed deannexation of the lands described in the notice and Petition from the present boundaries of the City of Franklin, IZARD County, Arkansas.

1720

4. That the lands hereinafter described and which are the lands being annexed from the present city limits of the City of Franklin, Izard County, Arkansas, are unsuitable for urban development in the foreseeable future, are lands that are no longer necessary for corporate purposes, and are lands which were included, for more than ten (10) years past, in an area or territory that has not been recognized by city officials and assessed for taxation as part of said city during such period.

5. That the city council for the City of Franklin, Izard County, Arkansas has properly passed City of Franklin Resolution Number 87-6 which declares and resolves that the following described lands be detached and removed from the present incorporated city limits of the City of Franklin, Izard County, Arkansas.

6. That the welfare of the inhabitants and property owners of both the City of Franklin and of the area or territory being deannexed are best served by an order from this Court which orders the detachment of the lands hereinafter described.

WHEREFORE, IT IS CONSIDERED, ORDERED, DECREED, AND ADJUDGED that the following described real property situated in Izard County, Arkansas, to-wit:

The North 10 chains of Lots 1 & 2 of the NE $\frac{1}{4}$ of Section 1, Township 17 North, Range 8 West.

All that part of the SE $\frac{1}{4}$ of SW $\frac{1}{4}$ of Section 36, Township 18 North, Range 8 West that lies South of the State Highway #56 containing 10 acres, more or less. All Lot Two NE $\frac{1}{4}$ of Section 1, Township 17 North, Range 8 West except a triangle in the SW corner, run North 80 rods on the West line Lot 2; thence begin at the same SW corner run east twenty-four and seven-tenths rods, thence Northwest to 80 rods to 80 rods North of beginning corner. Also 6 acres in NW corner of Lot 1 NE $\frac{1}{4}$ of Section 1, Township 17 North, Range 8 West same being 40 rods North and 24 rods East and West, containing 80 acres, more or less.

be, and by the same is hereby, declared to be excluded from the present, existing city limits of the City of Franklin, Izard County, Arkansas and said lands above described are hereby declared to be detached and no longer a part of the lands which comprise the City of Franklin, Izard County, Arkansas.

IT IS FURTHER ORDERED and adjudged that the remaining lands which comprise the present and existing corporate city limits of the City of Franklin, IZARD County, Arkansas not hereinabove specifically described are not affected and the boundaries remain unchanged except for the exclusion of the above lands described.

IT IS SO ORDERED.

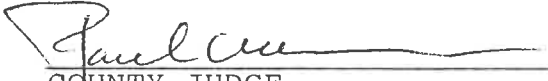
COUNTY JUDGE

FILED
IN MY OFFICE

NOV 25 1987

COUNTY & CIRCUIT CLERK
CHARLES CHEATHAM
BY _____ D.G.

722
IN THE COUNTY COURT OF IZARD COUNTY, ARKANSAS

IN THE MATTER OF THE DETACHMENT OF
LANDS FROM THE CITY OF FRANKLIN,
IZARD COUNTY, ARKANSAS

NO. CO-87-4

HARRY McCLAIN

EX PARTE PETITIONER

ORDER

Now on this 13th day of November, 1987, the same being the day scheduled for hearing in the above case and matter, comes on to be heard the above cause, and from the Petition filed herein, the Proof of Publication filed, the notice of hearing published in the time and manner required by law, the plat designating the lands affected, the testimony of the petitioner, and from all of which and other matters and things before the Court, this Court finds:

1. That this Court has jurisdiction over the subject matter as provided by Ark. Stat. Ann. 19-325, et. seq.

2. That on October 20, 1987, the petitioner, Harry McClain, acting through his designated agent and attorney, L. Gray Dellinger, filed herein his Petition seeking the deannexation of lands from the boundaries comprising the incorporated city limits of the City of Franklin, Izard County, Arkansas and that notice of the filing of such petition, together with the notice of the hearing to be held thereon, was published in The Times, a newspaper having a bona fide and general circulation in Izard County, Arkansas in the time and manner required by Ark. Stat. Ann. 19-326.

3. That on the day scheduled for hearing, Friday, November 13, 1987 at 10:00 o'clock a.m. in the Izard County Courthouse, no one appeared in opposition of the relief sought in said petition and no one objected at the hearing, or filed herein written objection, of the proposed deannexation of the lands described in the notice and Petition from the present boundaries of the City of Franklin, Izard County, Arkansas.

4. That the lands hereinafter described and which are the lands being annexed from the present city limits of the City of Franklin, IZARD COUNTY, ARKANSAS, are unsuitable for urban development in the foreseeable future, are lands that are no longer necessary for corporate purposes, and are lands which were included, for more than ten (10) years past, in an area or territory that has not been recognized by city officials and assessed for taxation as part of said city during such period.

5. That the city council for the City of Franklin, IZARD COUNTY, ARKANSAS has properly passed City of Franklin Resolution Number 87-6 which declares and resolves that the following described lands be detached and removed from the present incorporated city limits of the City of Franklin, IZARD COUNTY, ARKANSAS.

6. That the welfare of the inhabitants and property owners of both the City of Franklin and of the area or territory being deannexed are best served by an order from this Court which orders the detachment of the lands hereinafter described.

WHEREFORE, IT IS CONSIDERED, ORDERED, DECREED, AND ADJUDGED that the following described real property situated in IZARD COUNTY, ARKANSAS, to-wit:

The North 10 chains of Lots 1 & 2 of the NE $\frac{1}{4}$ of Section 1, Township 17 North, Range 8 West.

All that part of the SE $\frac{1}{4}$ of SW $\frac{1}{4}$ of Section 36, Township 18 North, Range 8 West that lies South of the State Highway #56 containing 10 acres, more or less. All Lot Two NE $\frac{1}{4}$ of Section 1, Township 17 North, Range 8 West except a triangle in the SW corner, run North 80 rods on the West line Lot 2; thence begin at the same SW corner run east twenty-four and seven-tenths rods, thence Northwest to 80 rods to 80 rods North of beginning corner. Also 6 acres in NW corner of Lot 1 NE $\frac{1}{4}$ of Section 1, Township 17 North, Range 8 West same being 40 rods North and 24 rods East and West, containing 80 acres, more or less.

be, and by the same is hereby, declared to be excluded from the present, existing city limits of the City of Franklin, IZARD COUNTY, ARKANSAS and said lands above described are hereby declared to be detached and no longer a part of the lands which comprise the City of Franklin, IZARD COUNTY, ARKANSAS.

IT IS FURTHER ORDERED and adjudged that the remaining lands which comprise the present and existing corporate city limits of the City of Franklin, IZARD County, Arkansas not hereinabove specifically described are not affected and the boundaries remain unchanged except for the exclusion of the above lands described.

IT IS SO ORDERED.

COUNTY JUDGE

FILED
IN MY OFFICE

NOV 25 1987

COUNTY & CIRCUIT CLERK
CHARLES CHEATHAM
BY _____ D.C.

Council, to detach said lands.

NOW, THEREFORE, be it enacted and ordained by the City Council of th City of Franklin, IZARD County, Arkansas as follows:

RESOLVED, that the following described lands which are presently situated within the established and existing corporate city limits of the City of Franklin, IZARD County, Arkansas, to-wit:

FRANKLIN
IZARD

Platt
30 Jan 95
MS

✓ The North 10 chains of Lots 1 & 2 of the NE $\frac{1}{4}$ of Section 1, Township 17 North, Range 8 West.

All that part of the SE $\frac{1}{4}$ of SW $\frac{1}{4}$ of Section 36, Township 18 North, Range 8 West that lies South of the State Highway #56 containing 10 acres, more or less. ✓ All Lot Two NE $\frac{1}{4}$ of Section 1, Township 17 North, Range 8 West except a triangle in the SW corner, run North 80 rods on the West line Lot 2; thence begin at the same SW corner run east ^{487.55 ft} twenty-four and seven-tenths rods, thence Northwest to 80 rods to ^{1320 ft} 80 rods North of begining corner. Also 6 acres in NW corner of Lot 1 NE $\frac{1}{4}$ of Section 1, Township 17 North, Range 8 West same being ^{40 rods} 40 rods North and ^{40 396 ft} 24 rods East and West, containing 80 acres, more or less.

16.5'
40
660
24
396'

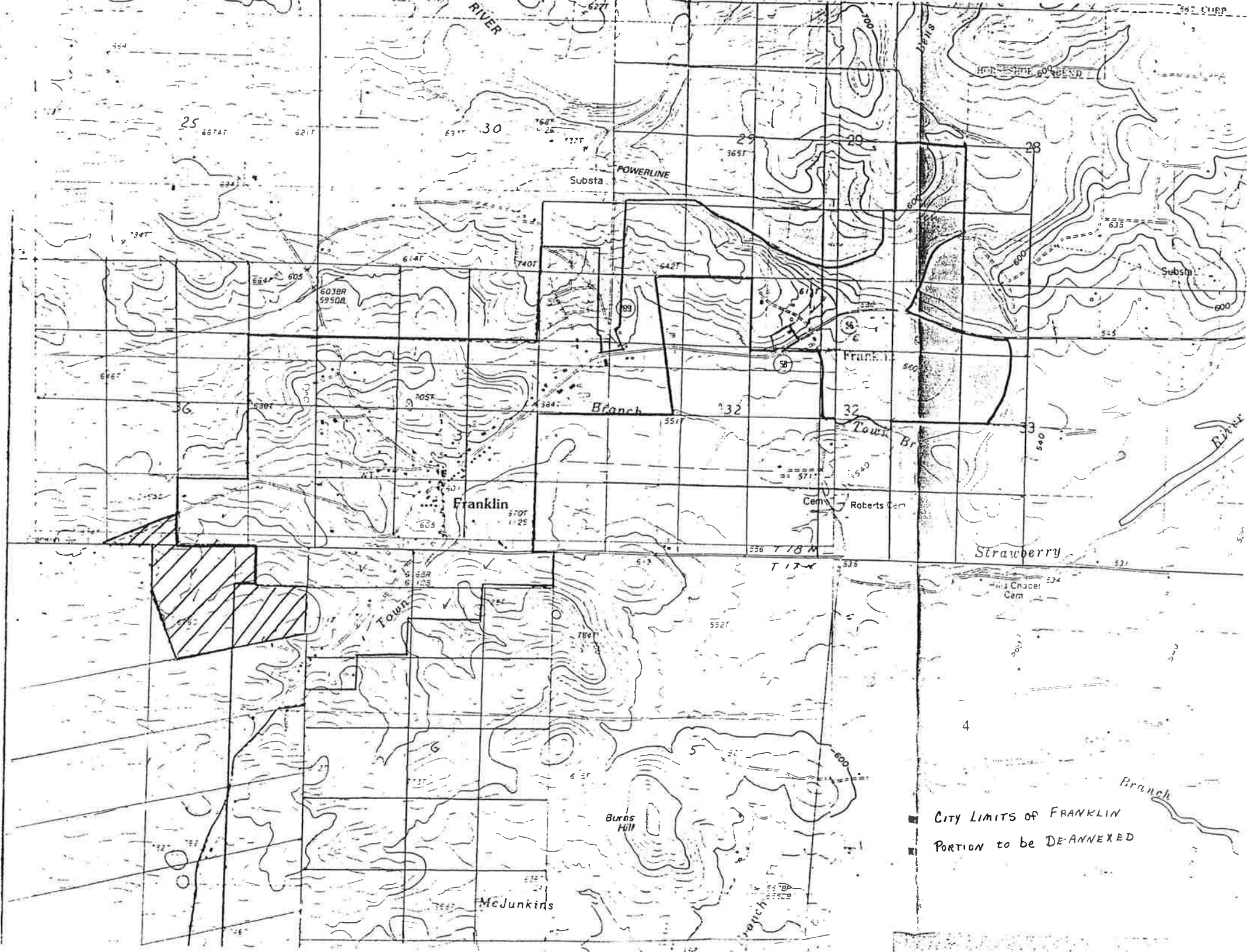

■ City Limits of FRANKLIN
■ PORTION to be DEANNEXED

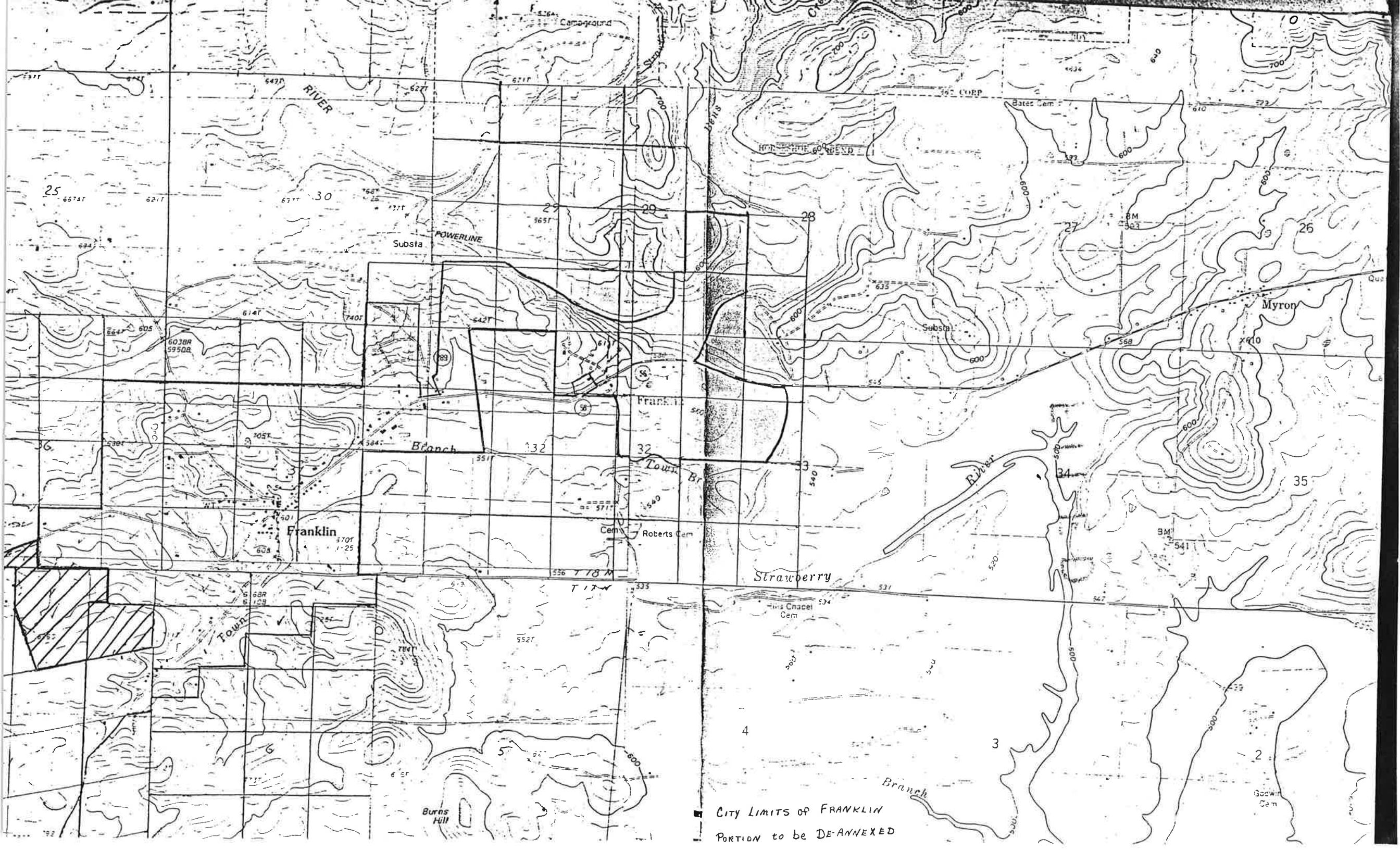

CITY LIMITS OF FRANKLIN
PORTION to be DE-ANNEXED