

Boundary Correction 1894 Incorporation: City of Sedgwick
 February 2020

City: Sedgwick
 Mayor: Stanley Debow

Arkansas Code 14-40-101.

Before an entity undertakes an annexation, consolidation, or detachment proceeding under this chapter, the entity shall coordinate with the Arkansas Geographic Information Systems Office for preparation of legal descriptions and digital mapping for the relevant annexation, consolidation, and detachment areas.

The map contained herein, is evidence, the entity has met requirements of Act 914 of 2015

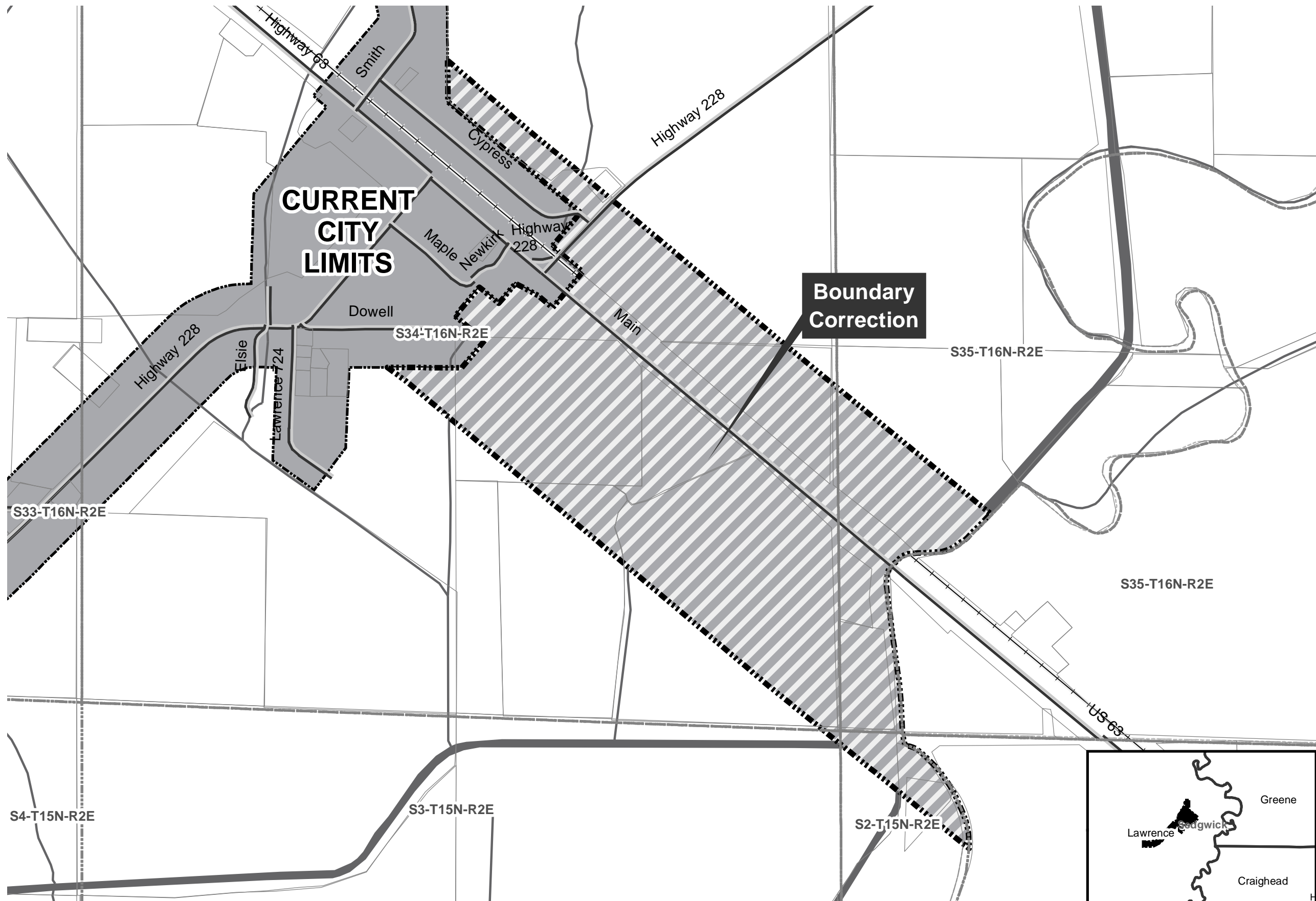

- Boundary Correction - 1894 Incorporation
- Sections
- Parcels
- Minor Road
- Railroad
- River Flowline
- River
- Smaller Rivers
- Smaller Water Bodies
- Existing City
- County Boundary

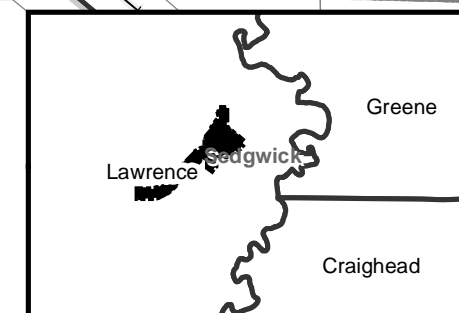
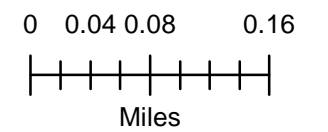

J. B. Coeberger
Jacob Parsons
J. M. Clavinger
C. H. Sexton
Joe Davis

W. Brenard,

Section 34 & W $\frac{1}{2}$ W $\frac{1}{2}$ 35 TOWN 16 N. R. 2 E

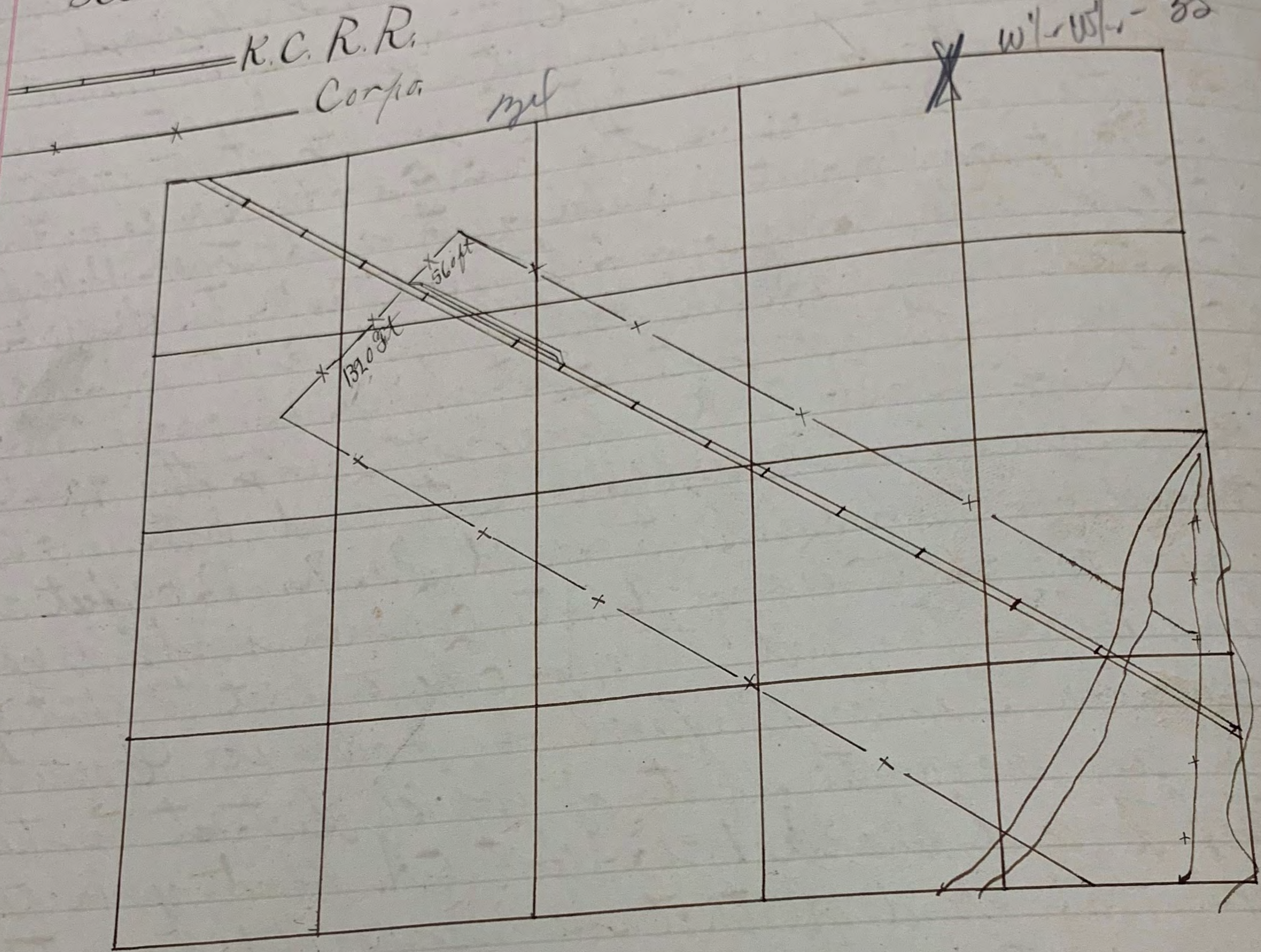

Filed Octo 9th 1893

J. H. Sloan
Clerk.

10.0.10

Corpa ml

W/W/W

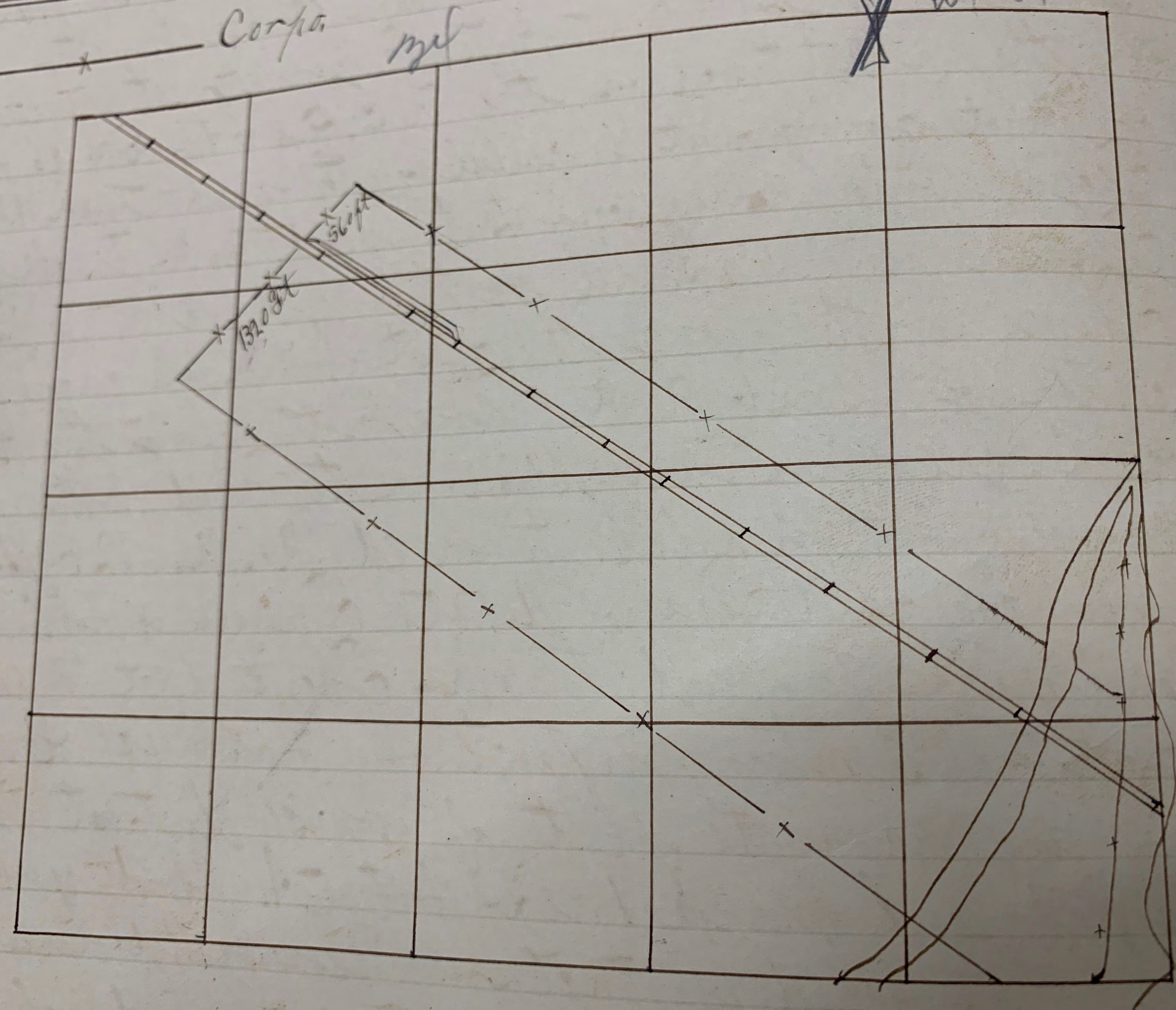

G. E. Foster.
 J. C. Dymun.
 Jacob Cotheberger.
 F. M. Parsons.
 J. H. Clouinger.
 C. A. Sexton.
 Joe Davis.

J. J. Clouinger.
 W. F. Dixon.
 J. W. Cavenaugh.
 L. Jones.
 F. Brenard.
 W. Brenard.

Sections 34 & W $\frac{1}{2}$ W $\frac{1}{2}$ 35 TOWN. 16 N, R. 2 E

— K.C.R.R.
 — Corpo

ml

~~X~~ W $\frac{1}{2}$ W $\frac{1}{2}$ - 35

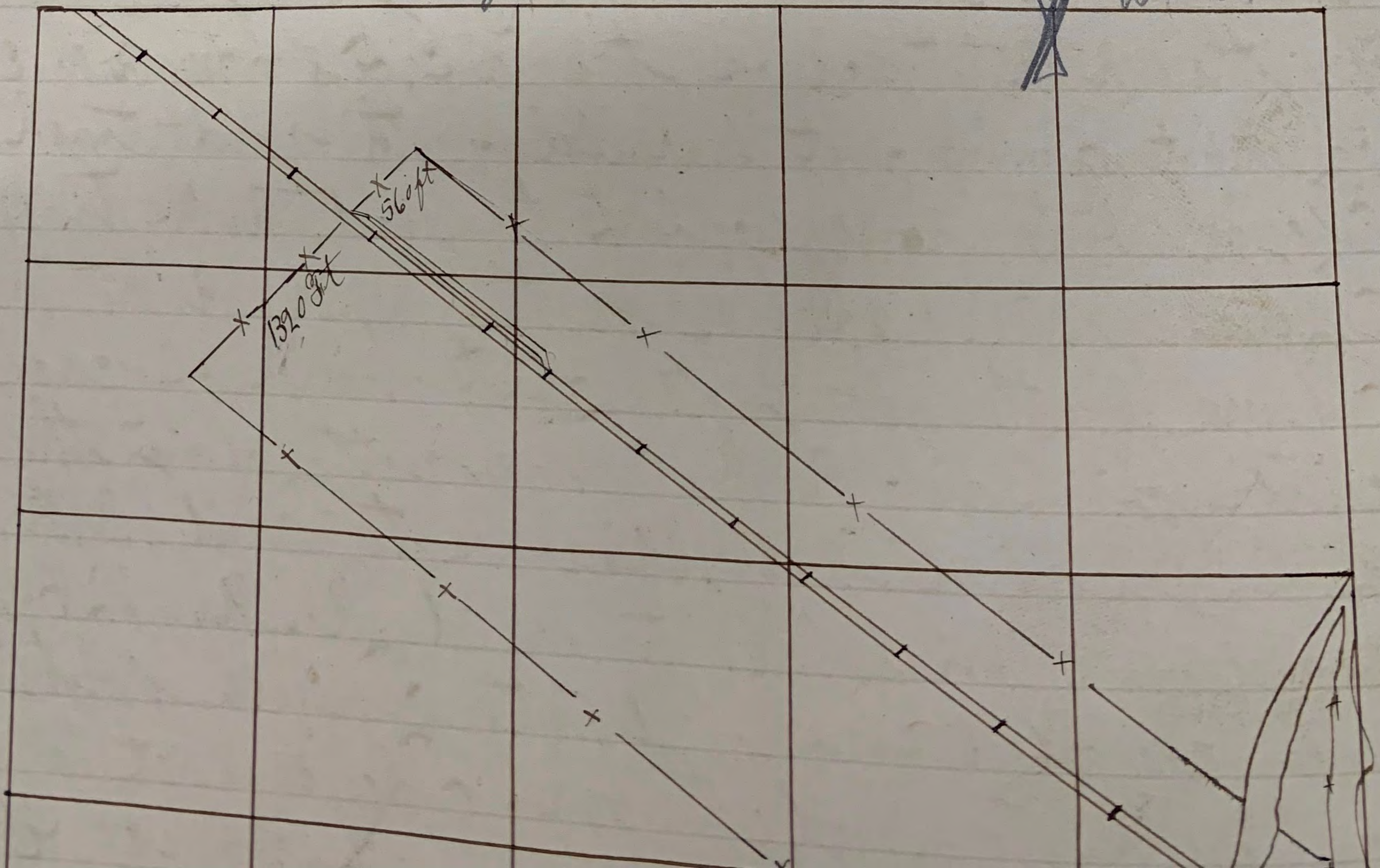

In the Matter of the Incorporation
of the
Town of Sedgwick

Lawrence County Court.

To the Hon J. M. Dwyall County Judge:

Your petitioners residents citizens
and legal voters within the hereinafter described District
would respectfully represent that said district is not within
the limits of any incorporated town or city and is
described as follows to-wit: Beginning at a center point
on the R. R. track of the K. C. F. S. & M. R. R. Co on west end
of depot running west parallel with said track 1240 feet,
Thence south perpendicular to said R. R. track 1320 feet,
Thence east parallel with said R. R. to Cache river
Thence north along the west bank of Cache river to
center of said R. R. Thence north along the west bank
of Cache river perpendicular to said R. R. 560 feet,
Thence west parallel to said R. R. 1240 feet west of
said Co's west line of depot, Thence south 560 feet per-
pendicular to said track. Thence east to point of begin-

In the Eastern District of Lawrence County ar-
sas, an accurate plat of which district is hereto at-
tached and marked exhibit A. And your petitioners
ask that said district be incorporated as a town and
and John K. Gibson + +

Lawrence County Judge;

and legal voters within the hereinafter described District
would respectfully represent that said district is not within
the limits of any incorporated town or city and is
described as follows to-wit: Beginning at a center point
on the R.R. track of the K.C. F.S. & M. R.R. Co on west end
of depot running west parallel with said track 1240 feet,
Thence south perpendicular to said R.R. track 1320 feet,
Thence east parallel with said R.R. to Cache river to
center of said R.R. Thence north along the west bank
of Cache river perpendicular to said R.R. 560 feet,
Thence west parallel to said R.R. 1240 feet west of
said Co's west line of depot, Thence south 560 feet per-
pendicular to said track. Thence east to point of begin-

In the Eastern District of Lawrence County ar-
sas, an accurate plat of which district is hereto at-
tached and marked exhibit A. And your petitioners
ask that said district be incorporated as a town under
and by the name of Sedgwick and John K. Gibson
and E. W. Culver, ^{are hereby} appointed agents to prosecute the
petition and to act in behalf of these petitioners
in all matters in connection with the same.

Wm Miller.
Noah Poor.
J. A. Hill.
D. F. Sul m. P.
G. R. Wyatt.
A. J. Scott.
James Foster.

D. H. Hines.
J. L. Berry.
J. W. W. Cook.
J. A. Culver.
J. A. J. J. J.
J. W. Poor.
J. H. Killgore.

In the Matter of the Incorporation

of the

Town of Sedgwick

Larson County Court.

To the Hon. J. M. Dwyall County Judge:

Your petitioners residents citizens
and legal voters within the hereinafter described District
would respectfully represent that said district is not within
the limits of any incorporated town or city and is
described as follows to-wit: Beginning at a center point
on the R.R. track of the K. C., F. S. & M. R.R. Co on west end
of depot running west parallel with said track 1240 feet,
thence south perpendicular to said R.R. track 1320 feet,
thence east parallel with said R.R. to Cache river to

SEDGWICK
LAWRENCE COUNTY
Incorporated Jan. 23, 1894
County Court Record Book K, Pages 418, 419, & 420
Description

OK
15 FEB 95
MS

POSITIVE ID
ON LOCATION
NEEDS TO BE
MADE.

Begin at a point in the center of the St. L. & S.F. R.R. track at a right-angle to the west end of the R.R. station in Section 34, T16N, R2E, thence northwesterly along center of said R.R. track for a distance of 1,240 ft. to the point of beginning; thence southwesterly at right angles and perpendicular to said R.R. track a distance of 1,320 ft.; thence southeasterly and parallel to said R.R. track to the west bank of Cache River in the NW 1/4 of Section 2, T15N, R2E; thence north along the west bank of said river to the center of R.R. track; thence northeasterly along the west riverbank to a point that is 560 ft. at right angles and perpendicular to said St. L. & S.F. R.R.; thence northwesterly and 560 ft. parallel to said R.R. track to a point that is 1,240 ft. northwest of a line 560 ft. from center of track and perpendicular with west line of said R.R. station; thence southwest 560 ft. and perpendicular to said R.R. track to the point of beginning. ✓

5-28-68 WCC

CIRCUIT CLERK'S OFFICE

- ① Amended plat 9-20-1894 Book 7 Page 49
- ② Corrected plat + Culver's Addn - 8-16-07 Book 21 Page 418
- ③ Vance's Addn 1-16-47 Book 57 Page 323

INDEX

CULVER AVE
 CYPRESS
 DOWELL
 MAPLE
 N MAIN
 S MAIN
 SMITH AVE

B-3
 A-3
 B-3
 A-3
 A-3
 B-3
 A-3

