

Geometry Correction Historic Annex Ord 4-2010: City of Widener
February 2020

City: Widener
Mayor: Arvin Billingsley

Arkansas Code 14-40-101.

Before an entity undertakes an annexation, consolidation, or detachment proceeding under this chapter, the entity shall coordinate with the Arkansas Geographic Information Systems Office for preparation of legal descriptions and digital mapping for the relevant annexation, consolidation, and detachment areas.

The map contained herein, is evidence, the entity has met requirements of Act 914 of 2015

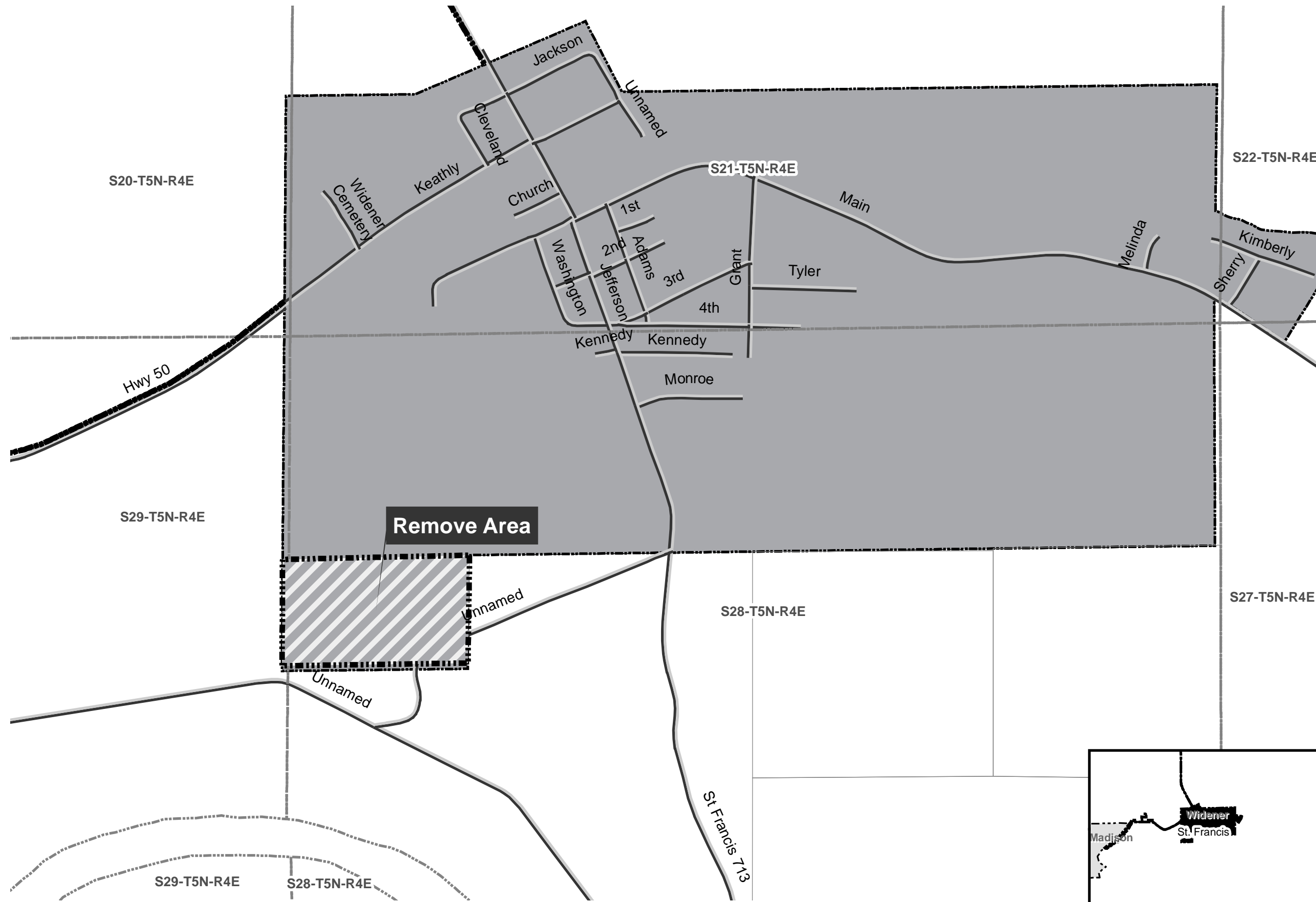

- Historic Annex
- Sections
- Parcels
- Minor Road
- Existing City
- Neighboring City
- County Boundary

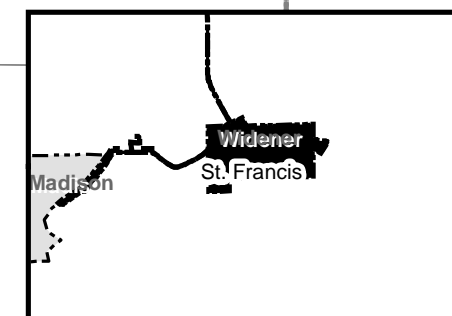
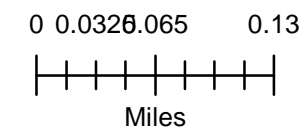



State of Arkansas Secretary of State

Charlie Daniels
Secretary of State

Business & Commercial Services	682-3409
Elections	682-5070
Building & Grounds	682-3407
Communications & Education	683-0057
State Capitol Police	682-5173
Business Office	682-8032
Information Technology	682-3411

July 27, 2010

The Honorable Elizabeth Smith
ST. Francis County Clerk
313 South IZard Street
Forrest City, AR 72335

Dear Ms. Smith:

The Following Information has been recorded and filed in the Office of the Secretary of State:

Date: July 27, 2010 County: St. Francis City: Widener

Annexation:	Ordinance No. --1 & 4-2010
	County Order No.---
	Plat -X-
	Election -05/18/2010
	Island -
Incorporation:	Ordinance No. -
	Co. Order No. -
	Plat -
	Election -

Census Information: The following City or Town has been upgraded or reduced to:

- 1st Class City -
- 2nd Class City -
- Incorporated Town -

I have forwarded this information to the Arkansas Municipal League and the Arkansas Highway and Transportation Department and the Arkansas State Data Center. If you have any further questions please do not hesitate to contact me at 1-800-482-1127 or 682-3451

Sincerely,

Pam Ratliff
Election Services
Arkansas Secretary of State

ORDINANCE NO. 4 -2010

AN ORDINANCE APPROVING THE ANNEXATION OF CERTAIN PROPERTY TO THE CITY OF WIDENER; AND FOR OTHER RELATED PURPOSES

WHEREAS, it appears to the City Council of the City of Widener, Arkansas, that the annexation of certain hereinafter described territory, contiguous to the City of Widener, is necessary for the orderly growth and development of the City;

WHEREAS, the lands furnish the abode for a densely settled community or represent the actual growth of the municipality beyond its legal boundary;

WHEREAS, the lands are platted or not, the lands are held to be sold as suburban property;

WHEREAS, the lands are needed for proper municipal purposes; or

WHEREAS, the lands are valuable by reason of their adaptability for prospective municipal uses.; and

WHEREAS, the qualified electors, on May 18, 2010, voted in favor of annexation.

NOW, THEREFORE, BE IT ORDAINED BY THE CITY COUNCIL OF THE CITY OF WIDENER, ARKANSAS:

SECTION 1. That the citizens of the City of Widener and those who are affected by annexation on May 18, 2010 voted in favor of annexation. The County Clerk and the St. Francis County election commission have certified the election results. The City Council for the City of Widener hereby approves the annexation of the following described area to the City of Widener:

Legal Description: Tract 1

A 1 foot wide strip of property located in Sections 8, 9, 17 and 21, T5N-R4E, St. Francis County, Arkansas, lying adjacent to and West of Arkansas Highway 38, the centerline of which is more particularly described as follows: Commencing at the Northeast Corner of property as recorded in Deed Book 513 at Page 535 of the Records of St. Francis County, Arkansas, thence West 0.5 feet along the North line thereof to the point of beginning; thence from the point of beginning N29°12'30"W 431.6 feet to a point; thence N29°00'51"W 1040.2 feet to a point; thence N23°16'09"W 903.5 feet to a point; thence N4°44'09"W 520.6 feet to a point; thence N0°06'33"E 1166.4 feet to a point; thence North 5303.9 feet to a point; thence N19°54'46"W 232.5 feet to a point; thence N20°32'20"E 136.6 feet to a point; thence N0°00'04"W 549.1 feet to a point; thence N0°00'51"E 1028.1 feet to a point; thence N0°00'51"E 814.7 feet to a point; thence East 152.0 feet to a point and end of said strip.

FILED

Legal Description: Tract 2

JUL 27 2010

CHARLIE DANIELS
SECRETARY OF STATE

FILED

BY _____ JUL 20 2010

Elizabeth Smith
County & Probate Clerk

A parcel of property located in the NE1/4, Section 17, T5N-R4E, St. Francis County, Arkansas and being more particularly described as follows: Commencing at the Northeast Corner of said Section 17, thence South 30 feet along the East line thereof; thence West 30 feet to a point on the West right of way line of Arkansas Highway 38 and the point of beginning; thence South 210 feet along said West right of way to a point; thence West 436 feet to a point; thence North 30 feet to a point on the South right of way line of U.S. Highway 70; thence Northeasterly 280 feet along said South right of way line to a point; thence East 226 feet to the point of beginning.

Legal Description: Tract 3

A parcel of property located in the S1/2, SE1/4, Section 8, T5N-R4E, St. Francis County, Arkansas and being more particularly described as follows: Commencing at the Southeast Corner of said Section 8, thence N0°25'E 312.1 feet along the East line of said SE1/4 and the centerline of Arkansas Highway 38 to a point; thence S49°07'W 143.9 feet to the point of beginning; thence from the point of beginning, N20°58'E 136.95 feet to a point on the West right of way line of said Highway 38; thence N0°25'E 549.1 feet along the West right of way line of said Highway 38 to a point on the South right of way line of U.S. Interstate 40; thence N55°08'49"W 141.9 feet along said South right of way line to a point; thence S89°59'46"W 181.9 feet along said South right of way line to a point; thence S0°25'W 268.1 feet to a point; thence N85°31'30"E 99.3 feet to a point; thence S0°25'W 386.2 feet to a point; thence S64°32'39"W 230 feet to a point; thence S33°49'48"E 247.6 feet to a point on the North right of way line of U.S. Highway 70; thence N48°47'58"E 294.7 feet along the North right of way line of said Highway 70 to the point of beginning.

Legal Description: Tract 4

A parcel of property located in the SW1/4 of the NW1/4, Section 9, T5N-R4E, St. Francis County, Arkansas and being more particularly described as follows: Beginning at a point where the North right of way line of the off ramp running Easterly from the main road of U.S. Interstate 40 intersects the right of way line of the County Road (Hwy 38) which crosses U.S. Interstate 40, run thence in an Easterly direction (S84°19'51"E - Measured) along the North right of way line of said off ramp 447.84 feet to the first point of curve of said North right of way line; run thence in a Northerly direction at a 90 degree angle to the first boundary described (N5°40'09"E - Measured) herein 400 feet to a point; run thence at a 90 degree angle in a Westerly direction (N84°19'51"W 380.95 feet - Measured) to a point on the East right of way line of the County Road (Hwy 38) which crosses U.S. Interstate 40; run thence in a Southerly direction (S28°21'12"W 123.1 feet - Measured and S10°08'40"W 287.6 feet - Measured) along said right of way line to the point of beginning, containing a total of 3.94 Acres, more or less.

Legal Description: Tract 5

A 1 foot wide strip of property located in Sections 20 and 29, T5N-R4E, St. Francis County, Arkansas, adjacent to and North of the North right of way line of Arkansas Highway 50, the centerline of which is more particularly described as follows: Commencing at the Southeast Corner of said Section 20, thence North 166.3 feet along the East line thereof to a point 0.5 feet

FILED

JUL 27 2010

CHARLIE DANIELS
SECRETARY OF STATE

BY _____

North of said North right of way line of Arkansas Highway 50 and the point of beginning; thence from the point of beginning, S52°49'16"W 390.2 feet to a point; thence S56°24'37"W 406.9 feet to a point; thence S64°08'12"W 806.6 feet to a point; thence S76°18'06"W 300.4 feet to a point; thence N66°55'40"W 282.1 feet to a point; thence N56°38'33"W 571.9 feet to a point; thence N47°17'21"W 238.7 feet to a point; thence N55°01'46"W 209.3 feet to a point; thence N79°02'41"W 187.9 feet to a point; thence N86°22'22"W 122.4 feet to a point; thence N85°24'12"W 201.2 feet to a point; thence S89°30'19"W 718.5 feet to a point; thence S87°58'44"W 111.1 feet to a point; thence S70°23'01"W 168.4 feet to a point on the South line of said Section 20 and end of said strip.

Legal Description: Tract 6

A 1 foot wide strip of property located in the SW1/4 of Section 20, T5N-R4E, St. Francis County, Arkansas, the centerline of which is more particularly described as follows: Commencing at the Southeast Corner of said SW1/4, Section 20, thence N89°34'W 1219.4 feet along the South line of said SW1/4 to a point in the centerline of Arkansas Highway 50; thence North 40.0 feet to a point on the North right of way line of said Highway 50 and the point of beginning; thence N7°48'26"W 507.7 feet along the centerline of an existing levee to a point; thence S89°34'E 325.0 feet to a point and end of strip.

Legal Description: Tract 7

A parcel of property located in SW1/4 of Section 20, T5N-R4E, St. Francis County, Arkansas and being more particularly described as follows: Commencing at the Southeast Corner of said SW1/4, thence N89°34'W 420.1 feet along the South line thereof to a point in the centerline of Arkansas Highway 50; thence N0°26'E 40.0 feet to a point on the North right of way line of said Arkansas Highway 50, and the point of beginning; thence from the point of beginning, continue N0°26'E 200.0 feet to a point; thence S89°34'E 200.0 feet to a point; thence S0°26'W 200.0 feet to a point of said North right of way line; thence N89°34'W 200.0 feet along said North right of way line to the point of beginning.

Legal Description: Tract 8

A parcel of property located in the SW1/4 of Section 20, T5N-R3E, St. Francis County, Arkansas and described as follows: Commencing at the Southeast Corner of said SW1/4, Section 20; thence N89°34'W 420.1 feet along the South line of said SW1/4, Section 20 to a point in the centerline of Arkansas Highway No. 50; thence N0°26'E 40.0 feet to a point on the North right of way line of said Arkansas Highway No. 50 and the point of beginning; thence from the point N0°26'E 200 feet; thence N89°34'W 200 feet; thence S0°26'W 186 feet to a point on said North right of way line of Arkansas Highway No. 50; thence S85°34'E 200.5 feet along said North right of way line of Arkansas Highway No. 50 to the point of beginning, containing a total of 0.9 Acres, more or less.

Legal Description: Tract 9

FILED

JUL 27 2010

CHARLIE DANIELS
SECRETARY OF STATE

BY _____

- Tract 7
- Tract 8
- Tract 9
- Tract 10
- Tract 11
- Tract 12
- Tract 13
- Tract 14

SECTION 4.

Emergency Clause

This ordinance being necessary for the immediate preservation of the public peace, health, safety, and welfare, as well as compliance with special election statutes, an emergency is hereby declared to exist and this ordinance shall be effective and full force and effect from and after its passage and approval.

PASSED: yes 5-0

ATTEST: [Signature]
City Clerk

APPROVED: [Signature]
Mayor

FILED

JUL 27 2010

CHARLIE DANIELS
SECRETARY OF STATE

BY _____

ORDINANCE NO. 1 -2010

FILED
MAR 12 2010

Elizabeth Smith
County & Probate Clerk

AN ORDINANCE SUBMITTING TO THE VOTERS OF THE CITY OF WIDENER, ARKANSAS, AND OTHER AFFECTED PERSONS, THE QUESTION OF ANNEXATION TO SAID CITY OF WIDENER CERTAIN CONTIGUOUS TERRITORY; AND DECLARING AN EMERGENCY

WHEREAS, it appears to the City Council of the City of Widener, Arkansas, that the annexation of certain hereinafter described territory, contiguous to the City of Widener, is necessary for the orderly growth and development of the City;

WHEREAS, the lands furnish the abode for a densely settled community or represent the actual growth of the municipality beyond its legal boundary;

WHEREAS, the lands are platted or not, the lands are held to be sold as suburban property;

WHEREAS, the lands are needed for proper municipal purposes; or

WHEREAS, the lands are valuable by reason of their adaptability for prospective municipal uses.

NOW, THEREFORE, BE IT ORDAINED BY THE CITY COUNCIL OF THE CITY OF WIDENER, ARKANSAS:

SECTION 1. That there shall be submitted to the qualified electors of the City of Widener and of the following described area, the question of the annexation of the following described territory to the City of Widener:

Legal Description: Tract 1

A 1 foot wide strip of property located in Sections 8, 9, 17 and 21, T5N-R4E, St. Francis County, Arkansas, lying adjacent to and West of Arkansas Highway 38, the centerline of which is more particularly described as follows: Commencing at the Northeast Corner of property as recorded in Deed Book 513 at Page 535 of the Records of St. Francis County, Arkansas, thence West 0.5 feet along the North line thereof to the point of beginning; thence from the point of beginning N29°12'30"W 431.6 feet to a point; thence N29°00'51"W 1040.2 feet to a point; thence N23°16'09"W 903.5 feet to a point; thence N4°44'09"W 520.6 feet to a point; thence N0°06'33"E 1166.4 feet to a point; thence North 5303.9 feet to a point; thence N19°54'46"W 232.5 feet to a point; thence N20°32'20"E 136.6 feet to a point; thence N0°00'04"W 549.1 feet to a point; thence N0°00'51"E 1028.1 feet to a point; thence N0°00'51"E 814.7 feet to a point; thence East 152.0 feet to a point and end of said strip.

Legal Description: Tract 2

A parcel of property located in the NE1/4, Section 17, T5N-R4E, St. Francis County, Arkansas and being more particularly described as follows: Commencing at the Northeast Corner of said Section 17, thence South 30 feet along the East line thereof; thence West 30 feet to a point on the West right of way line of Arkansas Highway 38 and the point of beginning; thence South 210 feet along said West right

FILED

MAR 27 2010
CHARLIE DANIELS
SECRETARY OF STATE

BY _____

of way to a point; thence West 436 feet to a point; thence North 30 feet to a point on the South right of way line of U.S. Highway 70; thence Northeasterly 280 feet along said South right of way line to a point; thence East 226 feet to the point of beginning.

Legal Description: Tract 3

A parcel of property located in the S1/2, SE1/4, Section 8, T5N-R4E, St. Francis County, Arkansas and being more particularly described as follows: Commencing at the Southeast Corner of said Section 8, thence N0°25'E 312.1 feet along the East line of said SE1/4 and the centerline of Arkansas Highway 38 to a point; thence S49°07'W 143.9 feet to the point of beginning; thence from the point of beginning, N20°58'E 136.95 feet to a point on the West right of way line of said Highway 38; thence N0°25'E 549.1 feet along the West right of way line of said Highway 38 to a point on the South right of way line of U.S. Interstate 40; thence N55°08'49"W 141.9 feet along said South right of way line to a point; thence S89°59'46"W 181.9 feet along said South right of way line to a point; thence S0°25'W 268.1 feet to a point; thence N85°31'30"E 99.3 feet to a point; thence S0°25'W 386.2 feet to a point; thence S64°32'39"W 230 feet to a point; thence S33°49'48"E 247.6 feet to a point on the North right of way line of U.S. Highway 70; thence N48°47'58"E 294.7 feet along the North right of way line of said Highway 70 to the point of beginning.

Legal Description: Tract 4

A parcel of property located in the SW1/4 of the NW1/4, Section 9, T5N-R4E, St. Francis County, Arkansas and being more particularly described as follows: Beginning at a point where the North right of way line of the off ramp running Easterly from the main road of U.S. Interstate 40 intersects the right of way line of the County Road (Hwy 38) which crosses U.S. Interstate 40, run thence in an Easterly direction (S84°19'51"E – Measured) along the North right of way line of said off ramp 447.84 feet to the first point of curve of said North right of way line; run thence in a Northerly direction at a 90 degree angle to the first boundary described (N5°40'09"E – Measured) herein 400 feet to a point; run thence at a 90 degree angle in a Westerly direction (N84°19'51"W 380.95 feet – Measured) to a point on the East right of way line of the County Road (Hwy 38) which crosses U.S. Interstate 40; run thence in a Southerly direction (S28°21'12"W 123.1 feet – Measured and S10°08'40"W 287.6 feet – Measured) along said right of way line to the point of beginning, containing a total of 3.94 Acres, more or less.

Legal Description: Tract 5

A 1 foot wide strip of property located in Sections 20 and 29, T5N-R4E, St. Francis County, Arkansas, adjacent to and North of the North right of way line of Arkansas Highway 50, the centerline of which is more particularly described as follows: Commencing at the Southeast Corner of said Section 20, thence North 166.3 feet along the East line thereof to a point 0.5 feet North of said North right of way line of Arkansas Highway 50 and the point of beginning; thence from the point of beginning, S52°49'16"W 390.2 feet to a point; thence S56°24'37"W 406.9 feet to a point; thence S64°08'12"W 806.6 feet to a point; thence S76°18'06"W 300.4 feet to a point; thence N66°55'40"W 282.1 feet to a point; thence N56°38'33"W 571.9 feet to a point; thence N47°17'21"W 238.7 feet to a point; thence N55°01'46"W 209.3 feet to a point; thence N79°02'41"W 187.9 feet to a point; thence N86°22'22"W 122.4 feet to a point; thence N85°24'12"W 201.2 feet to a point; thence S89°30'19"W 718.5 feet to a point; thence S87°58'44"W 111.1 feet to a point; thence S70°23'01"W 168.4 feet to a point on the South line of said Section 20 and end of said strip.

FILED

JUL 27 2010

CHARLIE DANIELS
SECRETARY OF STATE

BY

Legal Description: Tract 6

A 1 foot wide strip of property located in the SW1/4 of Section 20, T5N-R4E, St. Francis County, Arkansas, the centerline of which is more particularly described as follows: Commencing at the Southeast Corner of said SW1/4, Section 20, thence N89°34'W 1219.4 feet along the South line of said SW1/4 to a point in the centerline of Arkansas Highway 50; thence North 40.0 feet to a point on the North right of way line of said Highway 50 and the point of beginning; thence N7°48'26"W 507.7 feet along the centerline of an existing levee to a point; thence S89°34'E 325.0 feet to a point and end of strip.

Legal Description: Tract 7

A parcel of property located in SW1/4 of Section 20, T5N-R4E, St. Francis County, Arkansas and being more particularly described as follows: Commencing at the Southeast Corner of said SW1/4, thence N89°34'W 420.1 feet along the South line thereof to a point in the centerline of Arkansas Highway 50; thence N0°26'E 40.0 feet to a point on the North right of way line of said Arkansas Highway 50, and the point of beginning; thence from the point of beginning, continue N0°26'E 200.0 feet to a point; thence S89°34'E 200.0 feet to a point; thence S0°26'W 200.0 feet to a point of said North right of way line; thence N89°34'W 200.0 feet along said North right of way line to the point of beginning.

Legal Description: Tract 8

A parcel of property located in the SW1/4 of Section 20, T5N-R3E, St. Francis County, Arkansas and described as follows: Commencing at the Southeast Corner of said SW1/4, Section 20; thence N89°34'W 420.1 feet along the South line of said SW1/4, Section 20 to a point in the centerline of Arkansas Highway No. 50; thence N0°26'E 40.0 feet to a point on the North right of way line of said Arkansas Highway No. 50 and the point of beginning; thence from the point N0°26'E 200 feet; thence N89°34'W 200 feet; thence S0°26'W 186 feet to a point on said North right of way line of Arkansas Highway No. 50; thence S85°34'E 200.5 feet along said North right of way line of Arkansas Highway No. 50 to the point of beginning, containing a total of 0.9 Acres, more or less.

Legal Description: Tract 9

A parcel of property located in the S1/2 of Section 20, T5N-R4E, St. Francis County, Arkansas and being more particularly described as follows: Commencing at the Southeast Corner of the SW1/4, Section 20, thence N89°34'W 420.1 feet along the South line of said SW1/4 and centerline of Arkansas Highway 50 to a point; thence N0°26'E 240.0 feet to a point; thence N89°34'W 200.0 feet to a point; thence N0°26'E 302.5 feet to a point on the South line of property recorded in Deed Book 767 at Page 613 of the Records of St. Francis County, Arkansas; thence N89°34'W 206.15 feet along the South line of said property to the point of beginning; thence from the point of beginning, continue N89°34'W 140.0 feet to a point; thence N0°26'E 321.4 feet to a point on the North line of said property in Deed Book 767 at Page 613; thence S89°34'E 140 feet along said North line to a point; thence S0°26'W 321.4 feet to the point of beginning.

Legal Description: Tract 10

A parcel of property located in the SW1/4 of Section 20, T5N-R4E, St. Francis County, Arkansas and described as follows: Commencing at the Southeast Corner of said SW1/4, Section 20, T5N-R4E,

FILED

JUL 27 2010
CHARLIE DANIELS
SECRETARY OF STATE

BY _____

thence N89°34'W 2205.6 feet along the South line thereof to a point on the Northerly right of way line of Arkansas Highway No. 50 and the point of beginning; thence from the point of beginning, continue N89°34'W 179.5 feet along said South line of SW1/4 to a point on the East top bank of the St. Francis River; thence Northeasterly 364.6 feet along said East top high bank of river to a point; thence S89°34'E 305.3 feet along a line parallel to said South line of SW1/4 to a point on the West line of the Levee District right of way; thence S5°04'E 230.9 feet along said West line to a point; thence N88°39'29"W 208 feet along said Levee District right of way to a point; thence S5°35'04"W 98.0 feet along said Levee District right of way to a point on the Northerly right of way line of said Arkansas Highway No. 50; thence S63°25'25"W 50.5 feet along said Northerly right of way line of Arkansas Highway No. 50 to the point of beginning, containing 2.34 Acres.

Legal Description: Tract 11

Lots 1 thru 27 of the Riverbank Subdivision located in Sections 29 and 30, T5N-R4E, St. Francis County, Arkansas, as recorded in City Plat Book 4 at Page 104 of the Records of St. Francis County, Arkansas.

Legal Description: Tract 12

A parcel of property located in Section 30, T5N-R4E, St. Francis County, Arkansas, between Lots 12 and 13 of Riverbank Subdivision as recorded in City Plat Book 4 at Page 104 of the Records of St. Francis County, Arkansas and being more particularly described as follows: Beginning at the Northeast Corner of said Lot 12, thence N50°33'E 100 feet along the West right of way line of Arkansas Highway 50; thence N45°42'E 100 feet along said right of way line to the Southeast Corner of said Lot 13; thence N42°18'W 275 feet along the South line of said Lot 13 to the East top bank of the St. Francis River; thence Southwesterly 180 feet along said East bank to the Northwest Corner of said Lot 12; thence S37°27'E 265 feet along the North line of said Lot 12 to the point of beginning.

Legal Description: Tract 13

A parcel of property located in Section 29 and 30, T5N-R4E, St. Francis County, Arkansas, between Lots 25 and 26 of the Riverbank Subdivision as recorded in City Plat Book 4 at Page 104 of the Records of St. Francis County, Arkansas and being more particularly described as follows: Beginning at the Northeast Corner of said Lot 25, thence N33°59'E 100 feet along the West right of way line of Arkansas Highway 50; thence N31°29'E 100 feet along said right of way line to the Southeast Corner of said Lot 26; thence N56°31'W 240 feet along the South line of said Lot 26 to a point on the East top bank of the St. Francis River; thence Southwesterly 190 feet along said East top bank to the Northwest Corner of said Lot 25; thence S54°01'E 250 feet along the North line of said Lot 25 to the point of beginning.

Legal Description: Tract 14

A parcel of property located in the NW1/4 of Section 29, T5N-R4E, St. Francis County, Arkansas and being more particularly described as follows: Beginning at the intersection of the North line of said NW1/4, Section 29 and the West right of way line of Arkansas Highway 50, thence S56°59'W 75 feet along said West right of way line to a point; thence S52°06'W 50 feet along said right of way line to a point; thence S40°01'W 60 feet along said right of way line to a point; thence S32°15'W 40 feet along said West right of way line to the Northeast Corner of Lot 27 of the Riverbank Subdivision as recorded in City Plat Book 4 at Page 104 of the Records of St. Francis County, Arkansas; thence West 295 feet along

FILED
JUL 27 2010
CHARLIE DANIELS
SECRETARY OF STATE

BY _____

the North line of said Lot 27 to a point on the East top bank of the St. Francis River; thence Northeasterly 180 feet along said East top bank to a point on the North line of said NW1/4, Section 29; thence East 360 feet along the North line of said NW1/4 to the point of beginning.

A map depicting said annexation area is attached hereto as Exhibit A and made a part hereof.

SECTION 2. The question of annexation of the territory described above in Section 1 shall be submitted to the electors qualified to vote on this issue at a special election to be held on Tuesday, May 18, 2010. Once this ordinance takes effect, the City Clerk shall immediately notify the county Election Commission and the County Clerk by forwarding to each, a certified copy of this ordinance and the map showing the area to be annexed.

SECTION 3. If at such election a majority of the qualified electors voting in such election shall vote for such annexation, the annexation shall be effective and the territory included within the corporate limits of the City of Widener thirty (30) days following the County Clerk's certification of the election results and recording of the same, along with the description and a map of the annexed area, in the county records, and filing and certified copy thereof with the Secretary of State; or in the event an action is filed with the Circuit Court, on the date the judgment of said Court becomes final. If a majority of the qualified elector voting on the issue at the election vote against the annexation, the annexation ordinance shall be null and void.

SECTION 4. No later than forty-five (45) days prior to the election, the city shall identify all persons who reside within the area proposed to be annexed, and the county clerk shall assist the city in determining the names and addresses of all qualified electors residing within that area.

SECTION 5. The city clerk shall give notice of the election by publication by at least one (1) insertion in some newspaper having a general circulation in the city.

SECTION 6. If the annexation is approved and becomes final, the governing body of the city shall, by ordinance, as soon as practical after the annexation, attach and incorporate such annexed territory to and in one (1) or more wards of the city lying adjacent thereto, and the territory so assigned and attached to a ward shall thereafter be considered and become a part thereof as fully as any other part of the city.

SECTION 7. If the annexation is approved and becomes final, the following service shall be extended to the area within three (3) years:

SERVICE	DATE
Fire Protection	Immediately
Code Enforcement	Within 3 years
Sanitation Service	Within 3 years
Street Maintenance	Within 3 years

SECTION 8. The ballots used at said election on the question of annexation shall be marked as follows:

FILED

JUL 27 2010

CHARLIE DANIELS
SECRETARY OF STATE

BY _____

- [] FOR annexation of the territory described in Ordinance No. 1-2010
- [] AGAINST annexation of the territory described in Ordinance No. 1-2010

SECTION 9.

Emergency Clause

This ordinance being necessary for the immediate preservation of the public peace, health, safety, and welfare, as well as compliance with special election statutes, an emergency is hereby declared to exist and this ordinance shall be effective and full force and effect from and after its passage and approval.

PASSED: 3-11-10

ATTEST: Lillie Nelson
City Clerk

APPROVED: Albro Pitts
Mayor

FILED

JUL 27 2010

CHARLIE DANIELS
SECRETARY OF STATE

BY _____

Proposed Annexation
for the City of Widener, Arkansas

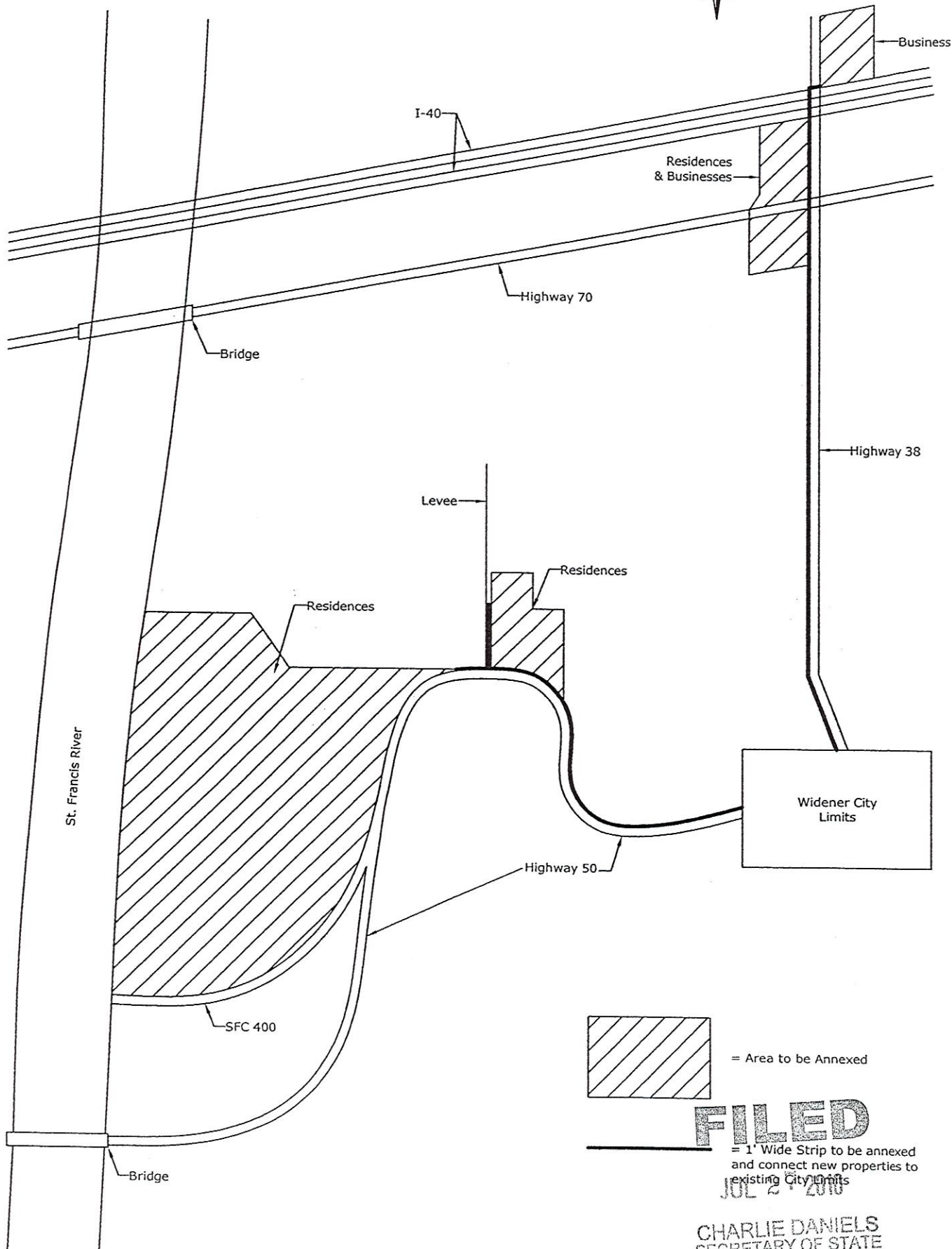

Town Of Widener
P.O. Box 130
Widener Arkansas 72394

Lillie Nelson, City Clerk of the City of Widener, hereby certify that this ordinance was duly passed and approved by a two-thirds vote of the total number of members the City Council of the Widener, Arkansas, on the 11th day of March, 2010.

Seal

Lillie Nelson
City Clerk

City of

Widener

ORDINANCE NO. *2010 - 1*
1 - 2010

Abron Pitts Mayor
870-633-8239
Hours 8am -4pm
Mon- Fri

FILED

JUL 27 2010

CHARLIE DANIELS
SECRETARY OF STATE

BY _____

ABSTRACT OF BALLOTS CAST
AT THE WIDENER ANNEXATION
HELD IN WIDENER ARKANSAS ON THE
18TH DAY OF MAY, 2010

FILED
JUN 18 2010
Elizabeth Smith
County & Probate Clerk

We hereby certify that the following is a true and correct abstract of the ballots for the annexation of Territory to Widener Annexation at the Election held in Widener Arkansas on the 18th day of May, 2010.

FOR ANNEXATION 67

AGAINST ANNEXATION 38

Witness our hands as Members of the St. Francis County Board of Election Commissioners this 20th day of May, 2010.

Democratic Chairman:

Frederick A. Freeman

Republican Chairman:

[Signature]

Third Member:

Judy Armstrong

FILED

JUL 27 2010

CHARLIE DANIELS
SECRETARY OF STATE

BY _____