

Jennifer Wheeler

From: Mallory Weaver <mweaver@gravettear.com>
Sent: Tuesday, April 21, 2020 11:00 AM
To: Jennifer Wheeler
Cc: Stephanie Shaw
Subject: Re: Gravette Census Correction

Yes, we agree the area below is outside city limits.

Thanks,

Mallory Weaver, MPA

City of Gravette
604 First Avenue SE
Gravette, AR 72736
P: 479-787-5757
gravettear.com

From: Jennifer Wheeler <Jennifer.Wheeler@arkansas.gov>
Sent: Tuesday, April 21, 2020 8:59 AM
To: Mallory Weaver <mweaver@gravettear.com>
Cc: Stephanie Shaw <sshaw@nwarpc.org>
Subject: Gravette Census Correction

Mallory,

I am working with the Census to ensure Gravette's city limits are correct. I also work with Stephanie Shaw at NWA regional planning—who is copied in this email. There is a spot in Gravette that the state, the county assessor, and Stephanie show is outside of the city while the Census shows it to be in. In order for them to make the correction they need approval from the city---which can be done by replying to this email.

Do you agree that the below area is outside of the city limits?

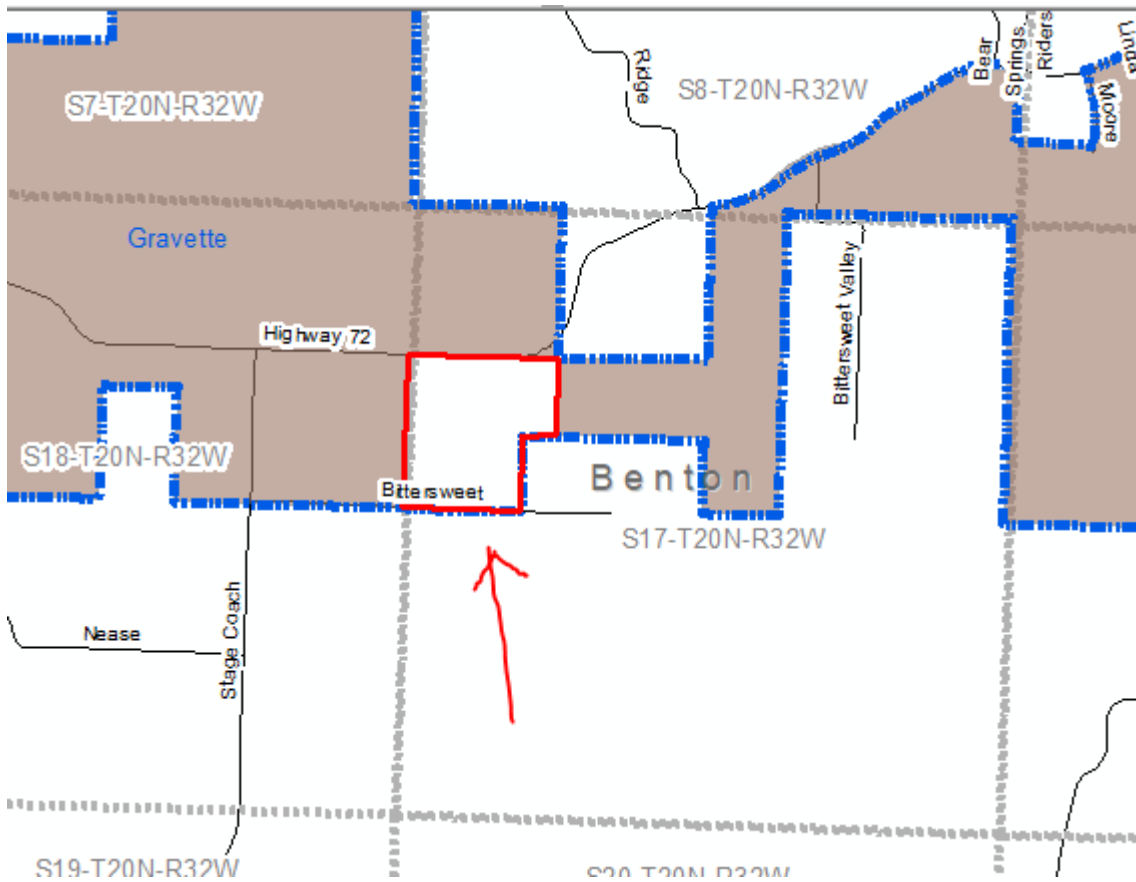

Jennifer Wheeler – GIS Analyst
 Department of Transformation & Shared Services
 Arkansas GIS Office
 1 Capitol Mall Ste 6D
 Little Rock, AR 72201
 501.682.2929 Office
 501.454.9524 Mobile
jennifer.wheeler@arkansas.gov Email
<https://www.gis.arkansas.gov> Web