

Boundary Correction Res 268: City of McGehee  
January 2021

City: McGehee  
Mayor: Jeff Owyong

Arkansas Code 14-40-101.

Before an entity undertakes an annexation, consolidation, or detachment proceeding under this chapter, the entity shall coordinate with the Arkansas Geographic Information Systems Office for preparation of legal descriptions and digital mapping for the relevant annexation, consolidation, and detachment areas.

The map contained herein, is evidence, the entity has met requirements of Act 914 of 2015

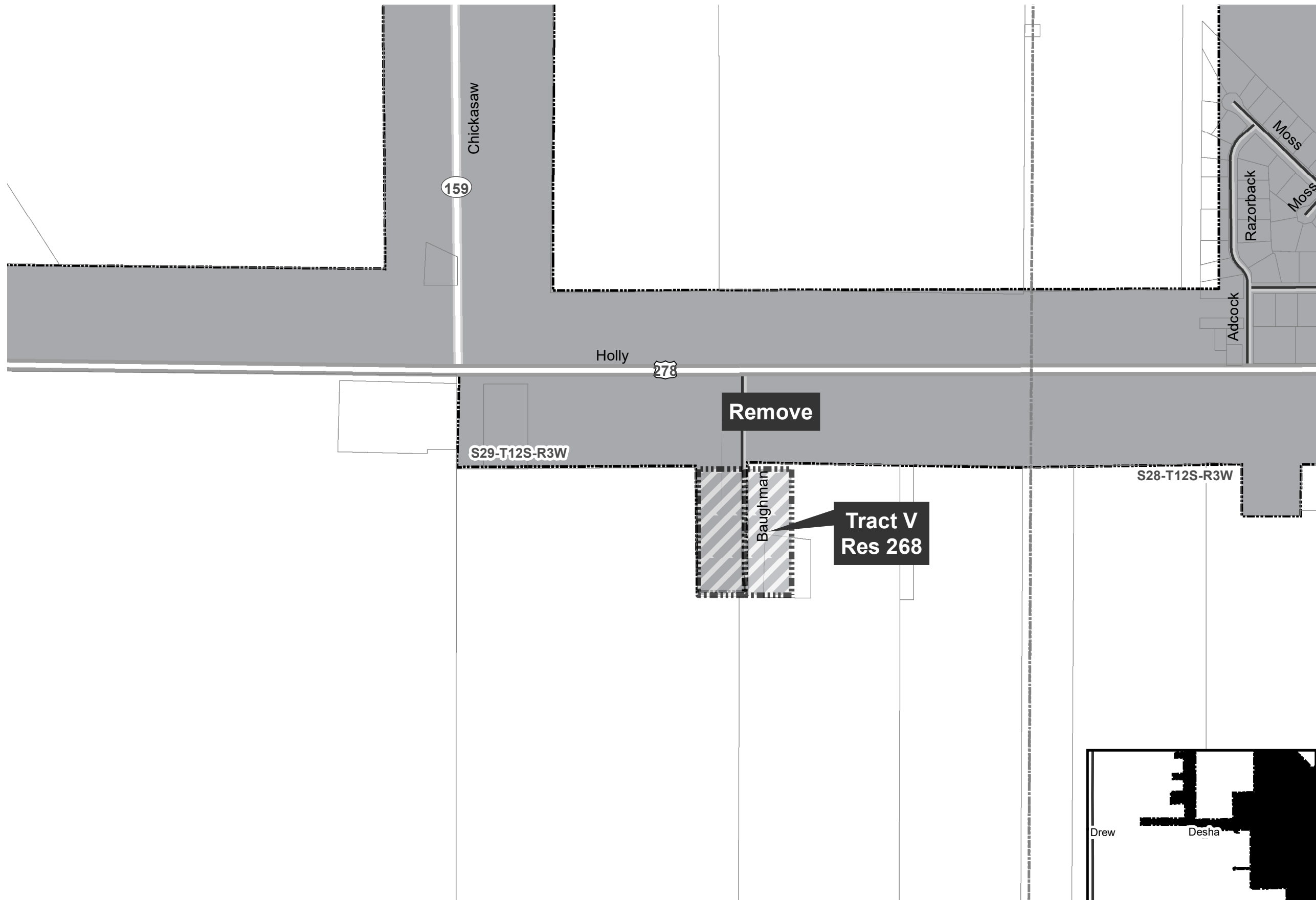

- Boundary Correction
- Sections
- Parcels
- Highway
- Minor Road
- Existing City

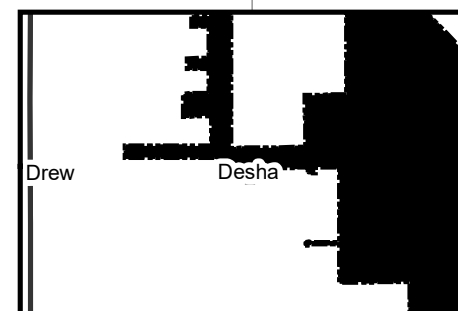
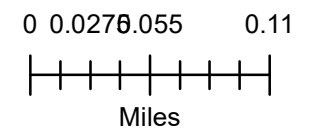

McGEEHEE

OK  
Shown ✓

RESOLUTION NO. 268

WHEREAS, the County Court, Desha County, Arkansas, has by its Order dated October 10, 1989, annexed to the City of McGehee, certain adjacent property as more particularly described hereinafter; and,

WHEREAS, the City of McGehee desires to accept said hereinafter described property;

THEREFORE, BE IT RESOLVED BY THE CITY COUNCIL OF THE CITY OF MCGEHEE, ARKANSAS, that:

(1) The area designated in an order of the County Court, Desha County, Arkansas, as City of McGehee Industrial Park, Dorman Addition, Gill, Schwartz & Glosup Addition, Snow/Cobb Addition, Baughman/McGhee Addition, more particularly described as:

↓ Tract I. CITY OF MCGEHEE INDUSTRIAL PARK

All of the East Half of the Southeast Quarter (E 1/2, SE 1/4) of Section Thirty-five (35), Township Twelve (12) South, Range Three (3) West of the Fifth Principal Meridian, lying North of the Northeasterly boundary of State Highway 4 and that portion of the Southwest Quarter (SW 1/4) of Section Thirty-six (36), Township Twelve (12) South, Range Three (3) West of the Fifth Principal Meridian lying North of State Highway 4 and also lying West of the McGehee Airport Entrance Road as described in Desha County Court Order signed by Judge Bain Poole on April 18, 1986, and filed by the County Clerk on April 21, 1986, in Desha County, Arkansas.

↓ Tract II. DORMAN ADDITION

All that part of the West Half of the Northeast Quarter (W 1/2, NE 1/4), Section One (1), Township Thirteen (13) South, Range Three (3) West, lying south of the North right of way of Arkansas State Highway No. 4 and North of the South right of way of Union Pacific Railroad.

↓ Tract III. GILL, SCHWARTZ & GLOSUP ADDITION

A part of Section One (1), Township Thirteen (13) South, Range Three (3) West, more particularly described as beginning at the center of said Section 1-13-3; thence North along east line of the NW 1/4 of said Section 1 a distance of 1,120 feet to the point of intersection with the southerly boundary of the Union Pacific Railroad Right of Way; thence Northwesterly along southerly boundary of said railroad right of way to a point 250 feet west of the east line of said NW 1/4; thence South along a line 250 feet west of and parallel to the east line of said NW 1/4 a distance of 1,140 feet to the point of intersection with the south line of said NW 1/4; thence West along the south line of said NW 1/4 a distance of 1,700 feet; thence South parallel with west line of the SW 1/4 of said Section 1 a distance of 300 feet; thence East parallel with north line of said

SW 1/4 and parallel with the north line of the SE 1/4 of said Section 1 a distance of 2,125 feet; thence North parallel with west line of said SE 1/4 a distance of 300 feet to the north line of said SE 1/4; thence West along north line of said SE 1/4 a distance of 400 feet to the center of Section 1 and the point of beginning.

Tract IV. SNOW/COBB ADDITION

A part of the Northwest Quarter (NW 1/4) of Section Twenty-nine (29) and a part of the Northeast Quarter (NE 1/4) of Section Thirty (30), Township Twelve (12), South, Range Three (3) West, more particularly described as beginning at the point of intersection of the east line of the said NW 1/4 with the north right of way of Highway No. 4; thence North along east line of said NW 1/4 a distance of 1,550 feet; thence West parallel to south line of said NW 1/4 of Section 29 a distance of 340 feet; thence South parallel to east line of said NW 1/4 a distance of 1,100 feet to a point 450 feet North of the north right of way of Highway No. 4 and 340 feet West of the east line of said NW 1/4; thence West along a line 450 feet north of and parallel to the north right of way of Highway No. 4 a distance of 3,680 feet; thence South parallel to west line of said NE 1/4, Section 30 a distance of 450 feet to the north right of way of Highway No. 4; thence East along the north right of way of Highway No. 4 a distance of 4,020 feet to the point of intersection with the east line of said NW 1/4, the point of beginning.

Tract V. BAUGHMAN/McGHEE ADDITION

A part of the East Half of the Southeast Quarter (E 1/2 SE 1/4), Section Twenty-nine (29), Township Twelve (12) South, Range Three (3) West, more particularly described as beginning at a point on the west line of the said E 1/2 SE 1/4, Section 29 which point is 400 feet South of the south right of way of Highway No. 4; thence South along west line of said E 1/2 SE 1/4 a distance of 600 feet; thence East parallel to north line of said E 1/2 SE 1/4 a distance of 220 feet; thence North parallel to west line of said E 1/2 SE 1/4 a distance of 600 feet; thence West parallel to north line of said E 1/2 SE 1/4 a distance of 220 feet to the point of beginning.

should be and hereby is accepted as City of McGehee Industrial Park, Dorman Addition, Gill, Schwartz & Glosup Addition, Snow/Cobb Addition, Baughman/McGhee Addition, in the City of McGehee, Arkansas.

PASSED: October 10, 1989.

  
ROSALIE S. GOULD, MAYOR

ATTEST:  
  
CHARLES E. LLOYD, City Clerk