



JOHN THURSTON  
—  
ARKANSAS SECRETARY OF STATE

December 10, 2019

The Hon. Tammy Sisson  
Franklin County Clerk  
211 W. Commercial  
Ozark, AR 72949

Re: City of Altus Annexation Ordinance 2019-3

Dear Ms. Sisson,

This letter acknowledges receipt and filing of the following notice of municipal boundary change by the Office of the Arkansas Secretary of State:

Filing Type: Annexation pursuant to A.C.A §14-40-501 (annexation of surrounded unincorporated area)  
Effective Date: 9/9/2019  
County: Franklin  
City Ordinance: 2019-3  
County Court Order: N/A  
City: Altus  
Dated: 9/9/2019  
Date Filed: N/A

A file marked copy of the ordinance and exhibits submitted to our Office are enclosed. By copy of this letter (and its enclosures), the Secretary of State hereby notifies the appropriate mapping authorities for Arkansas. Please retain these copies as official record of the filing of the municipal change by the Arkansas Secretary of State.

If you have any questions or concerns regarding this filing, please do not hesitate to contact our Office at 501-683-3717.

Sincerely,

A handwritten signature in cursive script that reads "Shantell McGraw".

Shantell McGraw  
Elections Division

cc: Arkansas Geographic Information Systems Office (w/encl)  
Arkansas Department of Transportation Mapping Department (w/encl)  
Department of Finance and Administration (w/encl)  
Arkansas Public Service Commission (w/encl)  
Arkansas Economic Development Institute (w/encl)  
The Hon. Veronica Post, Mayor of Altus (w/encl)



# Arkansas Secretary of State

**John Thurston** Arkansas Secretary of State, 500 Woodlane Ave, Little Rock, AR 72201-1094

## Municipal Boundary Change Checklist

Act 655 of 2017 and A.C.A. §14-40-103

County: FRANKLIN City/Town: ALTUS

City Ordinance/Resolution No: 2019-3 Date approved: September 9, 2019

County Court Case No: ~~2402-19-122~~ 51125119 Date Order Filed: October 16, 2019 8:11 AM

Type: Annexation of surrounded unincorporated area (island/doughnut holes) by ordinance A.C.A. 14-40-501  
(Choose from the list of Arkansas Code Sections located on the back) A.C.A. 14-40-501

Date Change Effective: 9/9/19 Set by:  Municipal Ordinance  Emergency Clause  Court  Default  
(Required by Act 655 of 2017)

For Circuit Court Challenge: Date Order Filed: NA  Upheld  Overturned  Other (attach explanation)

Please indicate which ward(s) the territory will be assigned to: Ward 3  
(See A.C.A. § 14-40-203)

### Initiating party:

All Landowners  Majority Landowners  Municipal Governing Body  State  Other \_\_\_\_\_

### Supporting Documentation attached (check all that apply):

- File marked copy of City Ordinance/Resolution (required)
- File marked copy of County Court Order or certified annexation election results (required except for A.C.A. §14-40-501)
- Copy of Arkansas GIS approved printed map and certification letter (required)
- Proof of Publication for all Legal Notices (include Hearing, Election, and City Ordinance/Resolution notices)
- File marked copy of Petition Part (if applicable)
- File marked copy of Complaint and final Circuit Court Order (Court Challenge only)

### Municipal Contact:

Name: Veronica Post Title: Mayor

Street Address: 316 West Park Street

City: Altus St: AR Zip code: 72821

Complete one form per ordinance/resolution, attach it as a cover page to the supporting document set and submit to the County Clerk's Office within 45 days of the Effective Date as required by Act 655 of 2017

### County Official:

Signature: Shawn King Title: Deputy Clerk

Date: 11-25-19

Pursuant to Act 655 of 2017, County Officials must submit a file-marked copy of municipal boundary change documents within 30 days of receipt to: Arkansas Secretary of State, Attn: Municipal Boundary Filing, 500 Woodlane Ave Suite 256, Little Rock, AR 72201-1094

Office of the Arkansas Secretary of State use only

Received by: [Signature]

**FILED**

**DEC 10 2019**

Rev. 2/2019

Arkansas  
Secretary of State

OCT 16 2019

ORDINANCE NO. 2019 - 3  
AN ORDINANCE ANNEXING CERTAIN LANDS THAT ARE COMPLETELY  
SURROUNDED BY THE INCORPORATED LIMITS OF THE  
CITY OF ALTUS, ARKANSAS; DECLARING AN  
EMERGENCY; AND FOR OTHER PURPOSES.

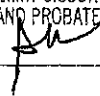
TAMMY SISSON  
COUNTY AND PROBATE CLERK  
BY: 

WHEREAS, Arkansas Code Annotated sections 14-40-501—14-40-503 provide that unincorporated islands of land that have been surrounded by the incorporated limits of a municipality may be annexed by that municipality, including situations in which the unincorporated area is surrounded on three sides by the municipal boundaries and on the fourth side by a state boundary, a military base, a state park, a national forest, a lake or a river.

WHEREAS, the City of Altus desires to annex certain lands more completely described below; and WHEREAS, all necessary urban services, such as fire and police protection, are to be extended to such area within a reasonable period of time; and

WHEREAS, the area to be annexed complies with the standards for lands qualifying for annexation which are set forth in A.C.A. § 14-40-302 and A.C.A. § 14-40-501; and

WHEREAS, the council finds that the territory to be annexed is considered an enclave since Tract 1 is surrounded by the incorporated limits of the City of Altus on all four sides and Tract 2 is surrounded on three sides by the municipal boundaries and on the fourth side by a majority portion of the city limits; and

WHEREAS, the council further finds that the territory consists of lands that:

- (1) Represent the actual growth of the municipality beyond its legal boundary; and
- (2) Are needed for proper municipal purposes such as for the extension of needed police regulation; and

WHEREAS, a public hearing was held on September 6, 2019, regarding this proposed annexation; and

WHEREAS, on August 21, 2019, a legal notice was published setting out the legal description of the territory proposed to be annexed, and all property owners within the area were notified by certified mail of their right to appear at the public hearing.

NOW, THEREFORE, BE IT ORDAINED BY THE CITY COUNCIL OF THE CITY OF ALTUS, ARKANSAS:

SECTION 1. That the following described unincorporated area which is completely surrounded by the city limits of the City of Altus, Arkansas, is hereby annexed to the City of Altus:

(Tract 1) A certain tract of land located in the South half of the Northwest Quarter of the Northwest Quarter of Section 22, Township 09 North, Range 26 West being more particularly described as follows: Commencing at a Spike at the NE Corner of the NW/4 of the NW/4 of said Section 22; THENCE: S 02 degrees 46 minutes 00 seconds West 662.35 feet along the East Line of said NW/4 of the NW/4 to the NE Corner of said S/2 of the NW/4 of the NW/4; THENCE: N 87 degrees 06 minutes 31seconds West 20.00 feet along the North Line of said S/2 of the NW/4 of the NW/4 to a Spike, the Point of Beginning; thence South 02 degrees 46 minutes 00 seconds West 197.00 feet to a 1/2 inch rebar; thence North 87 degrees 06 minutes 31 seconds West 221.50 feet to a 1/2 inch rebar; thence North 02 degrees 46 minutes 00 seconds East 197.00 feet to a 1/2 inch rebar on the North Line of said S/2 of the NW/4 of the NW/4; THENCE: South 87 degrees 06 minutes 31 seconds East 221.50 feet to the Point of Beginning.

(Tract 2) A CERTAIN TRACT OF LAND LOCATED IN THE NORTHWEST QUARTER OF THE NORTHWEST QUARTER OF SECTION 22, TOWNSHIP 9 NORTH, RANGE 26 WEST IN THE CITY OF ALTUS IN FRANKLIN COUNTY, ARKANSAS, BEING MORE PARTICULARLY DESCRIBED AS FOLLOWS AND AS SHOWN ON ARKANSAS RIVER VALLEY SURVEYING PLAT #2935: COMMENCING AT A SPIKE AT THE NE CORNER OF SAID NW/4 OF THE NW/4; THENCE SOUTH 02 DEGREES 46 MINUTES 00 SECONDS WEST 1050.76 FEET ALONG THE EAST LINE OF SAID NW/4 OF THE NW/4; THENCE NORTH 89 DEGREES 59 MINUTES 38 SECONDS WEST 340.69 FEET PARALLEL TO THE NORTH LINE OF SAID NW/4 OF THE NW/4 TO AN IRON PIPE, THE POINT OF BEGINNING; THENCE SOUTH 03 DEGREES 20 MINUTES 32 SECONDS WEST 261.30 FEET TO A 1/2 INCH

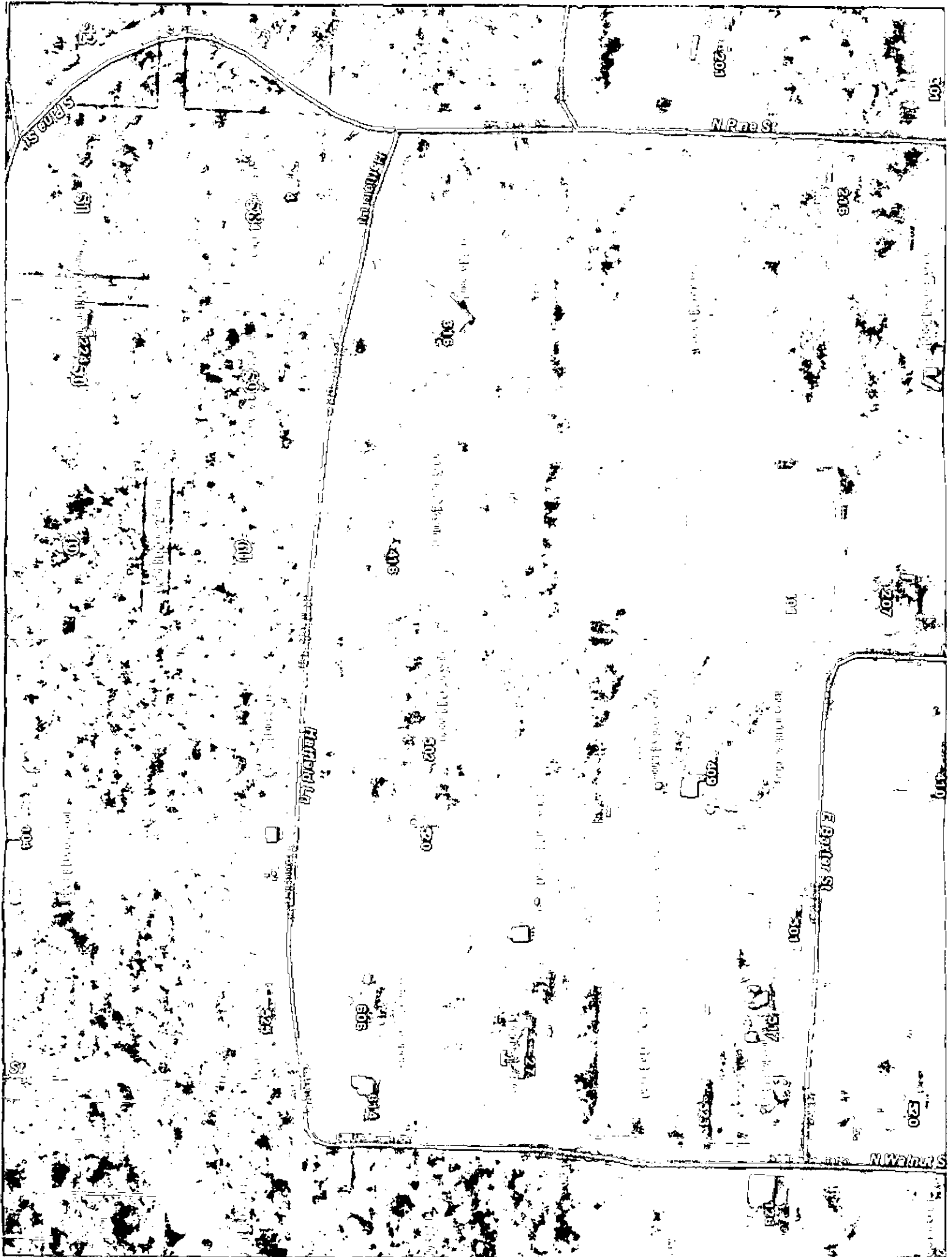



# ARKANSAS GIS OFFICE

A Division of the Department of Transformation and Shared Services

FILED  
Franklin County, Arkansas

OCT 16 2019

TAMMY SISSON  
COUNTY AND PROBATE CLERK

BY

August 14, 2019

Mayor Veronica Post  
P.O. Box 140  
ALTUS, AR 72821

RE: City of Altus Annexation Coordination Requirement

Honorable Mayor Post,

Thank you for coordinating with our office as you seek to annex property into the City of Altus under A.C.A. § 14-40-504. Enclaves prohibited. This letter represents confirmation that you have properly coordinated with our office (Arkansas GIS Office) as specified in A.C.A. § 14-40-101 (Act 914 of 2015) of the 90<sup>th</sup> General Assembly.

Our office will wait completion of any additional steps necessary for the proposed boundary change, which normally comes from the Arkansas Secretary of State Elections Division after any appropriate filing by your County Clerk.

Thank you,

Shelby D Johnson, State Geographic Information Officer  
/sdj

**Attachments:**

GIS Office Map of Enclave Annexation  
Legal Description  
Secretary of State Municipal Change Checklist

H:\City\_Annexations\Templates\Folder Structure\Doc\20190814\_Altus\_Enclave\_Annexation\_Coordination\_Letter.docx

ARKANSAS GIS OFFICE · 1 CAPITOL MALL SUITE 6D · LITTLE ROCK · ARKANSAS · 72201

PHONE (501) 682-2767 · [www.gis.arkansas.gov](http://www.gis.arkansas.gov)

Proposed Annex: City of Altus  
August 2019

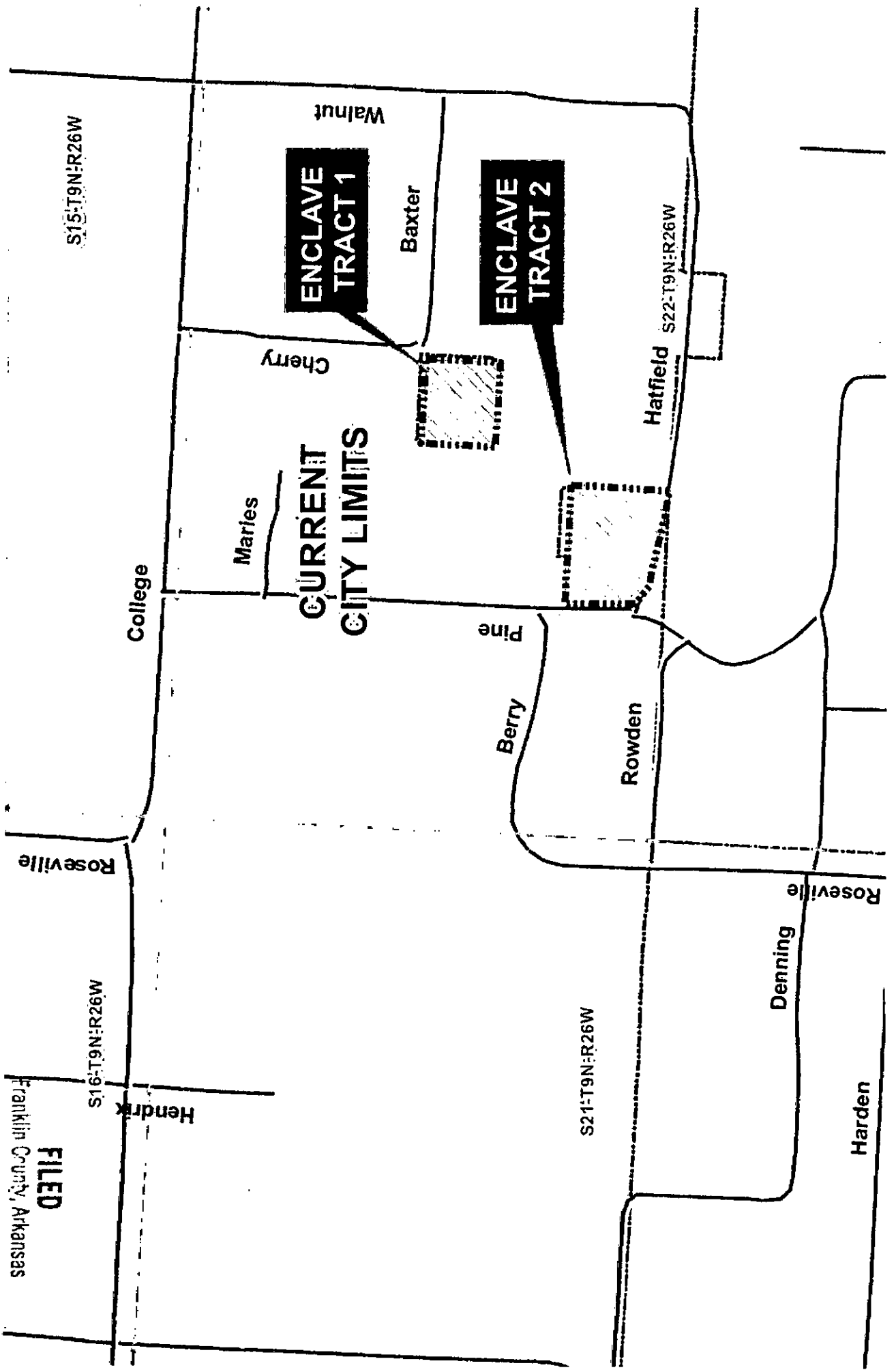

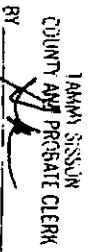
BY  TAMMIE SISSON  
COUNTY AND PROBATE CLERK

OCT 16 2019

Franklin County, Arkansas

**FILED**

*Tammy Sisson*

County and Probate Clerk  
Franklin County Courthouse  
211 West Commercial  
Suite 1600  
Ozark, Arkansas 72949  
479-667-3607 (Fax 479-667-3611)

October 31, 2019

Secretary Of State  
Office of the State Capitol  
Little Rock, Ar.

This is an annexation for the City of Altus, Arkansas. Our office was informed that this is all that was needed, and that our Judge did not need to issue an order. If there is anything else that is needed, please let me know. I'm new at annexations, and am trying to learn. Thank you.

Sincerely,

Sheri King  
Franklin County Deputy Clerk  
479-667-3607  
[sheri.king@franklincountyar.org](mailto:sheri.king@franklincountyar.org)