



ARKANSAS SECRETARY OF STATE

MARK MARTIN

January 26, 2016

The Honorable Tena O'Brien
Benton County Clerk
215 E. Central, Suite 217
Bentonville, AR 72712-5304

RE: Annexation

Dear Mrs. O'Brien,

The following information was received and has been recorded and filed in the office of the Secretary of State:

County: Benton

City: Bentonville

Annexation:

City Ordinance No. 2007-112 – Dated September 25, 2007
Plat of area to be annexed

By copy of this letter, I am sending file marked copies of all of the information to the UALR Institute for Economic Advancement, Arkansas Highway Mapping Department, TomTom, and the State Geographic Information Office. All others listed will only receive notification of the annexation by copy of this letter.

If you have any questions please do not hesitate to contact me at 1-800-482-1127.

Sincerely,

A handwritten signature in black ink, appearing to read "Peyton Murphy".

Peyton Murphy
Elections Attorney
Arkansas Secretary of State

cc: UALR Institute for Economic Advancement (w/encl)
Arkansas Highway Mapping Department (w/encl)
TomTom (w/encl)
Shelby Johnson, State Geographic Information Officer GIS (w/encl)
Arkansas Municipal League (w/o encl)
Bentonville City Clerk (w/o encl)



BENTON COUNTY

STATE OF ARKANSAS

TENA O'BRIEN

COUNTY CLERK & VOTER REGISTRAR
215 EAST CENTRAL, SUITE 217
BENTONVILLE, AR 72712-5373

PROBATE COURT CLERK
COURTHOUSE, 102 N.E. "A" STREET
BENTONVILLE, AR 72712-5350

January 12, 2016

Honorable Mark Martin
Secretary of State
Room 256 State Capitol
Little Rock, AR 72201-1094

RE: City of Bentonville Ordinance #2007-112
Detach Certain Land from the City of Rogers

Dear Secretary Martin:

Enclosed please find a certified copy of the City of Bentonville Ordinance #2007-112 detaching certain real property from the City of Rogers and annexing said real property into the City of Bentonville.

If you have any questions regarding this matter, please do not hesitate to call my office.

Sincerely,



Tena O'Brien By: T. Underwood

FILED

2016 JAN 12 AM 10:26

C E R T I F I C A T E

STATE OF ARKANSAS)
)
COUNTY OF BENTON)

January 11, 2016

County Court Case:

I, Linda Spence, City Clerk of the City of Bentonville, Arkansas, certify that the attached is a true and correct copy of Ordinance No. 2007-112 of the City of Bentonville. Said ordinance was adopted by the Bentonville City Council and approved by the Mayor of Bentonville on the 25th day of September, 2007, and is properly recorded in the records of the City of Bentonville, Arkansas.



Linda Spence
Linda Spence, City Clerk

2016 JAN 12 AM 10: 26

ORDINANCE NO. 2007-112

AN ORDINANCE CALLING FOR THE SIMULTANEOUS DETACHMENT OF CERTAIN LANDS FROM THE CITY OF ROGERS, ARKANSAS AND THE ANNEXATION OF THOSE LANDS INTO THE CITY OF BENTONVILLE, ARKANSAS.

NOW, THEREFORE, BE IT ORDAINED BY THE CITY COUNCIL FOR THE CITY OF BENTONVILLE, ARKANSAS.

Section 1: That certain lands currently in the corporate limits of the City of Rogers, Arkansas, as more particularly described in the legal description and diagram attached as Exhibit A and made a part of this ordinance, should be simultaneously detached from the City of Rogers and annexed in to the City of Bentonville pursuant to Ark. Code Ann. §14-40-2101.

Section 2: That this action is proposed at the request of the property owner who wishes to develop the property as part of a much larger parcel, the majority of which is currently in the City of Bentonville.

PASSED and APPROVED this 25th day of September, 2007.

Bob McCaslin
Bob McCaslin, Mayor

ATTEST:

Suzanne Grider
Suzanne Grider, City Clerk

2016 JAN 12 AM 10:26

TRACT B

A PART OF THE NORTHEAST QUARTER OF THE SOUTHEAST QUARTER (NE ¼ OF THE SE ¼) OF SECTION EIGHT (8), TOWNSHIP NINETEEN NORTH (TWP. 19 N.), RANGE THIRTY WEST (RNG. 30 W.), BENTON COUNTY, ARKANSAS, BEING MORE PARTICULARLY DESCRIBED AS FOLLOWS: COMMENCING AT THE SOUTHEAST CORNER OF THE NE ¼ OF THE SE ¼ OF SECTION 8, TWP. 19 N., RNG. 30 W., THENCE N87°31'21"W 420.00 FEET; THENCE N02°45'19"E 209.86 FEET TO A STEEL REBAR PIN, SAID PIN BEING THE POINT OF BEGINNING AND RUN THENCE N02°45'19"E 209.86 FEET; THENCE S87°31'21"E 420.00 FEET; THENCE S02°45'19"W 209.86 FEET; THENCE N87°31'21"W 420.00 FEET; TO THE POINT OF BEGINNING, CONTAINING APPROXIMATELY 88140.16 SQ. FT. OR 2.023 ACRES, MORE OR LESS.

G:\071067-00\SUR\DESC\TRACT B.DOC

2016 0068

SE WALTON BLVD

2213 MED

2016 JAN 12 AM 10:26

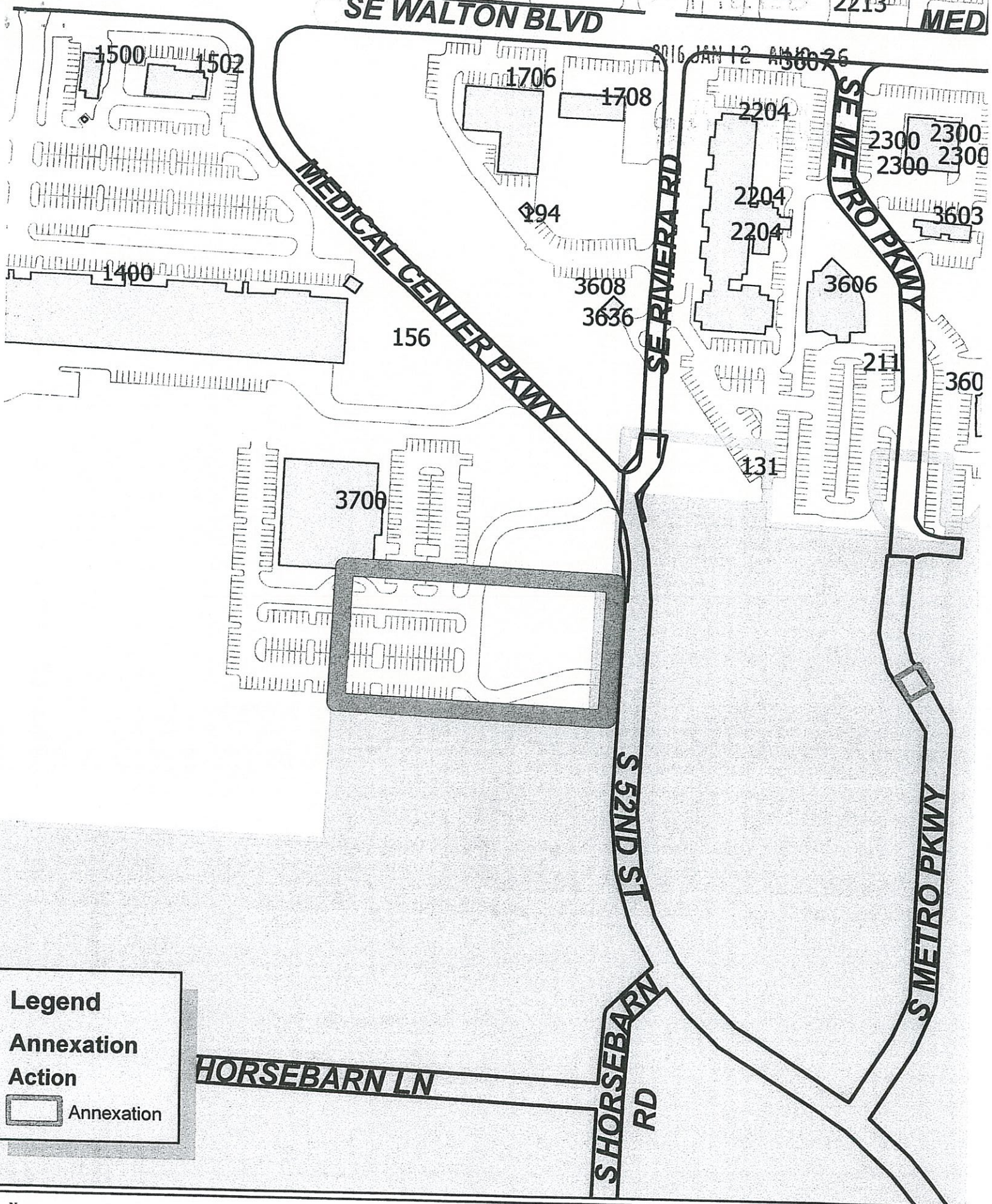

Legend

Annexation

Action

 Annexation

N
E 1 inch = 189 feet
S

Annexation 2016 : 0069
Ordinance 2007-112

