



ARKANSAS SECRETARY OF STATE

MARK MARTIN

August 19, 2016

The Honorable Tena O'Brien
Benton County Clerk
215 East Central, Suite 217
Bentonville, AR 72712-5373

Re: City of Bentonville Annexation Ordinance 2016-102

Dear Ms. O'Brien,

This letter acknowledges receipt and filing of the following notice of municipal boundary change by the Office of the Secretary of State:

Filing Type: Annexation pursuant to A.C.A § 14-40-609 (annexation by petition of 100% of land owners)

Effective Date: 08/09/2016

County: Benton

City: Bentonville

City Ordinance: 2016-102

Dated: 08/09/2016

County Court Order: 2016-09

Dated 06/28/2016

A file marked copy of the ordinance and exhibits submitted to our Office along with the GIS Office map are enclosed. By copy of this letter (and its enclosures), the Secretary of State hereby notifies the appropriate mapping authorities for Arkansas. Please retain these copies as official record of the filing of the municipal boundary change by the Arkansas Secretary of State.

If you have any questions or concerns regarding this pending filing please contact our office at 501-682-3401.

Sincerely,

A handwritten signature in cursive script that reads "Cynthia Fisher".

Cynthia Fisher
Special Projects Manager
Arkansas Secretary of State Legal Division
500 Woodlane St, Suite 256
Little Rock, AR 72201
501-682-3401

cc: Arkansas Geographic Information Systems Office (w/ encl)
 Arkansas Highway and Transportation Department Mapping Department (w/ encl)
 UALR Institution for Economic Advancement (w/encl)
 Tom-Tom (w/encl)
 Linda Spence, Bentonville City Clerk (mail w/ encl)

Room 256 State Capitol • Little Rock, Arkansas 72201-1094
501-682-1010 • Fax 501-682-3510
e-mail: arsos@sos.arkansas.gov • www.sos.arkansas.gov



BENTON COUNTY

STATE OF ARKANSAS

TENA O'BRIEN

COUNTY CLERK & VOTER REGISTRAR
215 EAST CENTRAL, SUITE 217
BENTONVILLE, AR 72712-5373

PROBATE COURT CLERK
COURTHOUSE, 102 N.E. "A" STREET
BENTONVILLE, AR 72712-5350

August 12, 2016

Honorable Mark Martin
Secretary of State
Room 256 State Capitol
Little Rock, AR 72201-1094

RECEIVED

AUG 18 2016

Arkansas
Secretary of State

Dear Secretary Martin:

RE: Hudson & Patricia Vanderhoff
City of Bentonville Annexation
Benton County Court Case No. CC# 2016-09

Dear Secretary Martin:

In accordance with the law, I am enclosing a certified copy of each of the following:

1. Map (survey and vicinity map) of the affected area
2. Order of Annexation entered on June 28, 2016
3. Ordinance No. 2016-102 adopted on August 09, 2016 by the City of Bentonville

If you have any questions regarding this matter, please do not hesitate to call my office.

Sincerely,

Tena O'Brien

Tena O'Brien By: T. Underwood

FILED

AUG 19 2016

Arkansas
Secretary of State

COUNTY CLERK
(479) 271-1013
FAX (479) 271-1019

VOTER REGISTRAR
(479) 271-5704

BENTONVILLE
(479) 271-1013
FAX (479) 271-1019

SILOAM SPRINGS
(479) 238-0120
FAX (479) 524-8534

PROBATE COURT CLERK
(479) 271-5727
FAX (479) 271-1712

ROGERS
(479) 636-3727
FAX (479) 636-4922
ARCHIVIST (479) 636-1037
FAX (479) 636-1053



Arkansas Secretary of State

Mark Martin

State Capitol 500 Woodlane Ave Suite 256 • Little Rock, AR 72201-1094

Municipal Boundary Change Form

County: Benton City/Town: Bentenville

City Ordinance/Resolution No: 2016-102 Date approved: 8-9-16

County Court Case No: CC 2016-09 Date of Order: 6-28-16

Filing Type: 100% Annexation

(List of municipal boundary changes with associated Arkansas Code sections reference on back)

Date Change Effective: 8-9-16 Emergency clause: Yes No

For Circuit Court Challenge: Date Filed: Upheld Overturned Other (attach explanation)

Initiating party:

All Landowners Majority Landowners Municipal Governing Body State Other

Supporting Documentation attached (check all that apply):

- File marked copy of City Ordinance/Resolution (not required for A.C.A § 14-40-1801)
File marked copy of County Court Order (not required for A.C.A. § 14-40-501)
Proof of Publication for all Legal Notices (Hearing, Election, City Ordinance/Resolution)
Copy of Arkansas GIS approved printed map and certification letter
File marked copy of Petition Part or File marked copy of the certified special election results (if applicable)
File marked copy of Complaint and final Circuit Court Order (Court Challenge only)

Municipal Contact:

Name: Linda Spence Title: City Clerk

Street Address: 117 W Central Ave

City: Bentenville St: AR Zip code: 72712

City/County Official:

Signature: [Signature] By: T. Underwood Title: County Clerk

Date: 8-12-16

(Submit form and supporting documents to Arkansas Secretary of State, 500 Woodlane Ave Suite 256, Little Rock, AR 72201-1094)

Office of the Arkansas Secretary of State use only

Received by: Cynthia Fisher

FILED

AUG 19 2016

Arkansas Secretary of State

Please complete this form and attach it as a cover page to each ordinance and supporting document set

FILED

2016 AUG 10 AM 11:23

TENA O'BRIEN
CO & PROBATE CLERK
BENTON COUNTY, AR

ORDINANCE NO. 2016-102

AN ORDINANCE ACCEPTING THE ANNEXATION OF CERTAIN TERRITORY TO THE CITY OF BENTONVILLE, ARKANSAS, AND MAKING SAME A PART OF THE CITY OF BENTONVILLE, AND ASSIGNING SAME TO WARDS.

WHEREAS, petition was filed with the County Clerk of Benton County, Arkansas by **Hudson and Patricia Vanderhoff**, owner(s) of the hereinafter described territory, praying that said territory be annexed to, and made a part of the City of Bentonville, Arkansas, and

WHEREAS, on the 22nd day of June, 2016, the County Court of Benton County, Arkansas, found that the petition was signed by the owners of said territory; that said territory was contiguous and adjoining the present corporate limits of the City of Bentonville, Arkansas; that an accurate plat or map of said territory had been filed with, and made a part of said petition; that proper notice had been given for the time and in the manner prescribed by law, and that all things pertaining thereto had been done in the manner prescribed by law, and that said lands and territory should be annexed to and a part of the City of Bentonville, Arkansas, subject to the acceptance of same by the City Council of said City at the proper time, as provided by law; and

WHEREAS, the time fixed by law for appealing from said order of annexation made by the County Court has expired and no appeal has been taken from said order.

NOW, THEREFORE BE IT ORDAINED BY THE CITY COUNCIL OF THE CITY OF BENTONVILLE, ARKANSAS:

FILED

AUG 19 2016

Arkansas
Secretary of State

2016 3489

FILED

2016 AUG 10 AM 11:23

TENA O'DRIEN
CO & PROBATE CLERK
BENTON COUNTY, AR

Section 1. That the lands described on the attached Exhibit A is territory contiguous to and adjoining the City of Bentonville, Arkansas be and the same is hereby accepted as part of and annexed to and made a part of the City of Bentonville.

Section 2. That the above described territory shall be annexed to and made a part of Ward 2 of the City of Bentonville, and the same shall henceforth be a part of said ward as fully as existing parts of said ward.

Section 3. That the above described territory shall be zoned A-1, to be used in accordance with City zoning laws and the laws of the State of Arkansas.

PASSED AND APPROVED THIS 9th DAY OF August, 2016.

APPROVED: Bob McCarlin
Mayor

ATTEST: Linda Spence
Clerk

FILED

AUG 19 2016

Arkansas
Secretary of State

2016 3490

FILED

2016 JUN 28 PM 4: 11

CLERK OF COURT
CO. & PROBATE CLERK
BENTON COUNTY, AR

IN THE MATTER OF ANNEXING TO THE CITY OF
BENTONVILLE, ARKANSAS CERTAIN TERRITORY
CONTIGUOUS TO SAID CITY OF BENTONVILLE, ARKANSAS

HUDSON & PATRICIA VANDERHOFF.
PETITIONER(S)

COUNTY COURT NO. CC 2016-09

ORDER AUTHORIZING ANNEXATION PURSUANT TO ACA § 14-40-609

I, Robert Clinard, County Judge of Benton County, having reviewed the attached petition for annexation and verification of petition, hereby find:

- (1) That the petition and verifications are complete and accurate;
- (2) That no enclaves will be created by the proposed annexation; and
- (3) That the petition contains a schedule of services.

The County Clerk is directed to forward a copy of this order and the related Petition to the Mayor of the City of Bentonville.



HON. ROBERT CLINARD, County Judge

6/28/16

Date

FILED

AUG 19 2016

Arkansas
Secretary of State

2016-3026



FILED

2016 AUG 11 AM 10:41

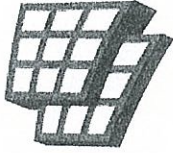

**ARKANSAS
GIS OFFICE**

TENA E'BENEN
CO. & PROBATE CLERK
BENTON COUNTY, ARK

August 10, 2016

Mrs. Tiffany Underwood
Benton County Clerk's Office
215 E. Central Ave.
Bentonville, AR 72712

RE: City of Bentonville Annexation Coordination Requirement

Mrs. Underwood,

Thank you for coordinating with our office as you seek to annex property into the City of Bentonville, AR case number CC2016-09. This letter represents confirmation that you have properly coordinated with our office (Arkansas GIS Office) as specified in § 14-40-101 (Act 914 of 2015) of the 90th General Assembly.

Our office will wait completion of any additional steps necessary for the proposed boundary change, which normally comes from the Arkansas Secretary of State Elections Division after any appropriate filing by your County Clerk.

Thank you,

Richie Pierce, Sr. GIS Analyst
/rp

Attachments:
GIS Office Map of Proposed Annexation
Secretary of State Municipal Change Checklist

FILED

AUG 19 2016

Arkansas
Secretary of State

FILED

2016 AUG 11 AM 10:41

TERA CUREN
CO. & PROBATE CLERK
BENTON COUNTY, ARK.

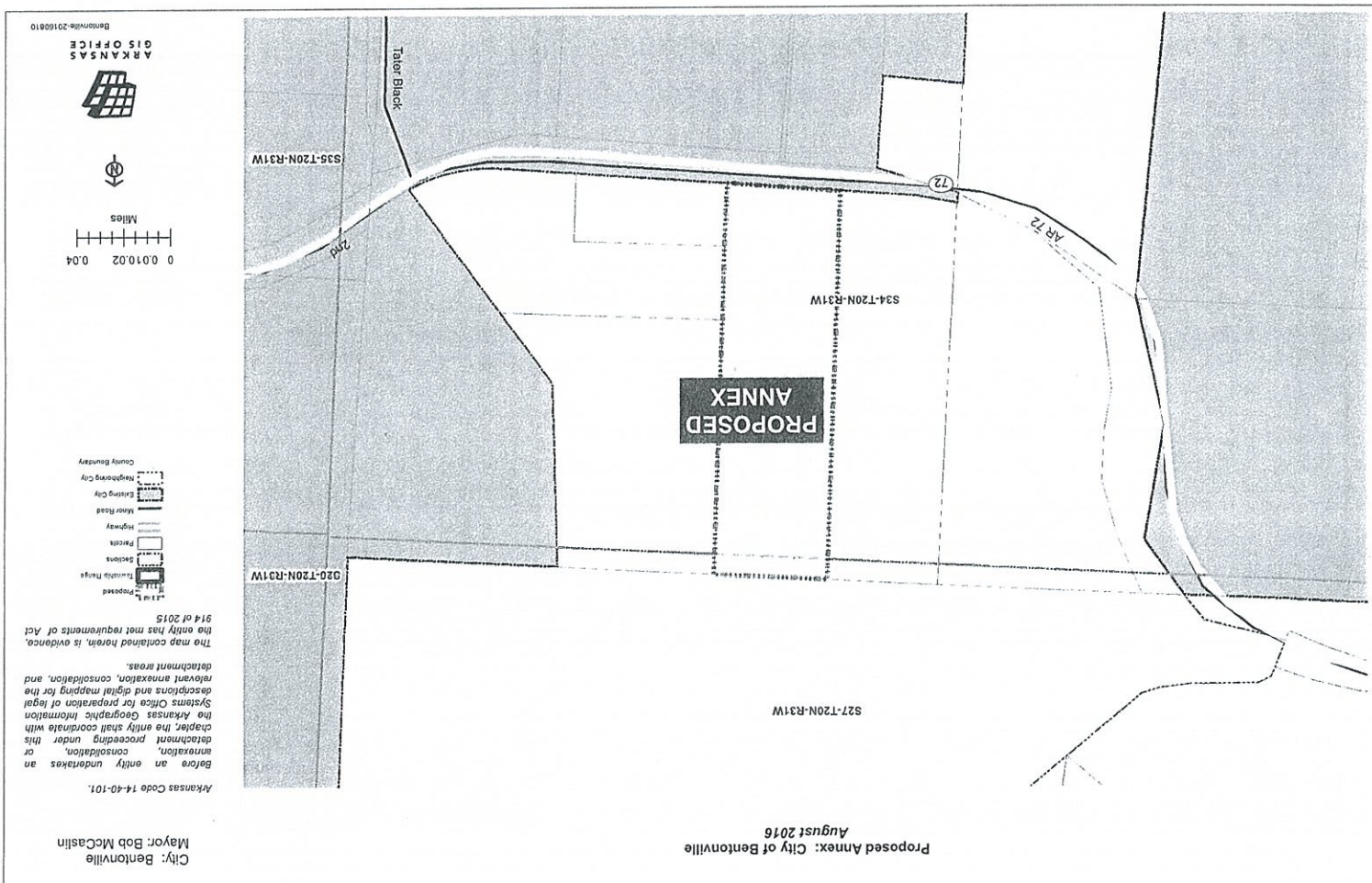

FILED
AUG 19 2016
Arkansas
Secretary of State