



ARKANSAS SECRETARY OF STATE

MARK MARTIN

October 20 2016

The Honorable Tena O'Brien
Benton County Clerk
215 E Central Ave, Suite 217
Bentonville, AR 72712-5304

Re: City of Bentonville Annexation Ordinance 2016-124

Dear Ms. O'Brien,

This letter acknowledges receipt and filing of the following notice of municipal boundary change by the Office of the Secretary of State:

Filing Type: Annexation by petition pursuant to A.C.A § 14-40-609 (petition by 100% of the land owners)

Effective Date: unknown

County: Benton

City: Bentonville

City Ordinance: 2016-124

Dated: 09/27/2016

County Court Order: CC-2016-19

Filed: 09/01/2016

Hon. Robert Clinard, County Judge, Benton County

A file marked copy of the ordinance, court order and exhibits submitted to our Office are enclosed. By copy of this letter (and its enclosures), the Secretary of State hereby notifies the appropriate mapping authorities for Arkansas. Please retain these copies as official record of the filing of the municipal boundary change by the Arkansas Secretary of State.

If you have any questions or concerns regarding this pending filing please contact our office at 501-682-3401.

Sincerely,

A handwritten signature in cursive script that reads "Cynthia Fisher".

Cynthia Fisher
Arkansas Secretary of State Legal Division
500 Woodlane St, Room 256
Little Rock, AR 72201
501-682-3401

cc: Arkansas Geographic Information Systems Office (w/ encl)
Arkansas Highway and Transportation Department Mapping Department (w/ encl)
UALR Institution for Economic Advancement (w/encl)
Tom-Tom (w/encl)
Honorable Bob McMaslin, Mayor of Bentonville, (w/encl)





Arkansas Secretary of State

Mark Martin

State Capitol 500 Woodlane Ave Suite 256 • Little Rock, AR 72201-1094

FILED

2016 OCT -4 PM 4:42

Municipal Boundary Change Form

TENA O'BRIEN
C. & PROBATE CLERK
BENTON COUNTY, ARK

County: Benton City/Town: Bentenville

City Ordinance/Resolution No: 2016-124 Date approved: 9-27-16

County Court Case No: CC-2016-19 Date of Order: 9-16-16

Filing Type: 100% Annexation 14-40-609

(List of municipal boundary changes with associated Arkansas Code sections reference on back)

Date Change Effective: _____ Emergency clause: Yes No

For Circuit Court Challenge: Date Filed: _____ Upheld Overturned Other (attach explanation)

Initiating party:

All Landowners Majority Landowners Municipal Governing Body State Other _____

Supporting Documentation attached (check all that apply):

- File marked copy of City Ordinance/Resolution (not required for A.C.A § 14-40-1801)
- File marked copy of County Court Order (not required for A.C.A. § 14-40-501))
- Proof of Publication for all Legal Notices (Hearing, Election, City Ordinance/Resolution)
- Copy of Arkansas GIS approved printed map and certification letter
- File marked copy of Petition Part or File marked copy of the certified special election results (if applicable)
- File marked copy of Complaint and final Circuit Court Order (Court Challenge only)

Municipal Contact:

Name: Bob McCaslin Title: Mayor

Street Address: 117 W Central Ave

City: Bentenville St: AR Zip code: 72712

City/County Official:

Signature: _____ Title: Deputy clerk

Date: 10-4-16

(Submit form and supporting documents to Arkansas Secretary of State, 500 Woodlane Ave Suite 256, Little Rock, AR 72201-1094)

Office of the Arkansas Secretary of State use only

Received by: Cynthia Fisher

FILED

OCT 20 2016

Arkansas
Secretary of State

Please complete this form and attach it as a cover page to each ordinance and supporting document set

BENTON COUNTY

STATE OF ARKANSAS

TENA O'BRIEN

COUNTY CLERK & VOTER REGISTRAR

215 EAST CENTRAL, SUITE 217
BENTONVILLE, AR 72712-5373

PROBATE COURT CLERK

COURTHOUSE, 102 N.E. "A" STREET
BENTONVILLE, AR 72712-5350

October 4, 2016

Honorable Mark Martin
Secretary of State
Room 256 State Capitol
Little Rock, AR 72201-1094

Dear Secretary Martin:

RE: Roger Reid
City of Bentonville Annexation
Benton County Court Case No. CC# 2016-19

Dear Secretary Martin:

In accordance with the law, I am enclosing a certified copy of each of the following:

1. Map (survey and vicinity map) of the affected area
2. Order Authorizing Annexation entered on September 16, 2016
3. Ordinance No. 2016-124 adopted on September 27, 2016 by the City of Bentonville

If you have any questions regarding this matter, please do not hesitate to call my office.

Sincerely,

Tena O'Brien

Tena O'Brien By: T. Underwood

RECEIVED

OCT 11 2016

Arkansas
Secretary of State

FILED

OCT 20 2016

Arkansas
Secretary of State

FILED

2016 OCT -4 PM 1:27

CC 2016 124
TENA O'BRIEN
CLERK
BENTON COUNTY AR

ORDINANCE NO. 2016-124

AN ORDINANCE ACCEPTING THE ANNEXATION OF CERTAIN TERRITORY TO THE CITY OF BENTONVILLE, ARKANSAS, AND MAKING SAME A PART OF THE CITY OF BENTONVILLE, AND ASSIGNING SAME TO WARDS.

WHEREAS, petition was filed with the County Clerk of Benton County, Arkansas by **Roger Reid**, owner(s) of the hereinafter described territory, praying that said territory be annexed to, and made a part of the City of Bentonville, Arkansas, and

WHEREAS, on the 16th day of September, 2016, the County Court of Benton County, Arkansas, found that the petition was signed by the owners of said territory; that said territory was contiguous and adjoining the present corporate limits of the City of Bentonville, Arkansas; that an accurate plat or map of said territory had been filed with, and made a part of said petition; that proper notice had been given for the time and in the manner prescribed by law, and that all things pertaining thereto had been done in the manner prescribed by law, and that said lands and territory should be annexed to and a part of the City of Bentonville, Arkansas, subject to the acceptance of same by the City Council of said City at the proper time, as provided by law; and

WHEREAS, the time fixed by law for appealing from said order of annexation made by the County Court has expired and no appeal has been taken from said order.

NOW, THEREFORE BE IT ORDAINED BY THE CITY COUNCIL OF THE CITY OF BENTONVILLE, ARKANSAS:

Section 1. That the lands described on the attached Exhibit A is territory contiguous to and adjoining the City of Bentonville, Arkansas be and the same is hereby accepted as part of and annexed to and made a part of the City of Bentonville.

FILED

OCT 20 2016

2016 4365

Arkansas
Secretary of State

FILED

2016 OCT -4 PM 1:27

TENA O'BRIEN
CO & PROBATE CLERK
BENTON COUNTY AR

Section 2. That the above described territory shall be annexed to and made a part of Ward 3 of the City of Bentonville, and the same shall henceforth be a part of said ward as fully as existing parts of said ward.

Section 3. That the above described territory shall be zoned A-1, to be used in accordance with City zoning laws and the laws of the State of Arkansas.

PASSED AND APPROVED THIS 27th DAY OF September, 2016.

APPROVED: _____



Mayor

ATTEST: Linda Spence

Clerk

Annexation-Roger Reid
Exhibit 'A'

FILED

2016 OCT -4 PM 1:28

A part of the NE $\frac{1}{4}$ of the NW $\frac{1}{4}$ of Section 14, Township 19N, Range 31W Benton County, Arkansas and more particularly described as follows:

TENA O'BRIEN
CO & PROBATE CLERK
BENTON COUNTY AR

Beginning at the NE Corner of said NE $\frac{1}{4}$ of the NW $\frac{1}{4}$;
Thence S $2^{\circ}27'54''$ W, 321.29';
Thence N $87^{\circ}43'18''$ W, 538.57';
Thence N $2^{\circ}25'59''$ E, 322.18';
Thence S $87^{\circ}37'38''$ E, 538.75' to the point of beginning.

2016 4367

SW FLAGSTONE BLVD
SW GEMSTONE BLVD
SW FLAGSTONE BLVD
SW RHINESTONE BLVD

SW LAYTON RD

FILED

2016 OCT -4 PM 1:28

TENA O'BRIEN
CO & PROBATE CLERK
BENTON COUNTY AR

SW MORNING STAR RD

SW JOSHUA AVE

SW BOXELDER ST

SW MAHOGANY AVE
SW HEMLOCK ST

SW RAINBOW FARM RD

S MORNING STAR RD

FILED

OCT 20 2016

Arkansas
Secretary of State

Legend

 BENTONVILLE



1 inch = 263 feet

2016 4368 *Annexation-Roger Reid*
3.98 Acres Total





ARKANSAS
GIS OFFICE

FILED
2016 SEP 23 PM 2:26

TENA O'BRIEN
CO. & PROBATE CLERK
BENTON COUNTY, ARK

September 23, 2016

Mrs. Tiffany Underwood
Benton County Clerk's Office
215 E. Central Ave.
Bentonville, AR 72712

RE: City of Bentonville Annexation Coordination Requirement

Mrs. Underwood,

Thank you for coordinating with our office as you seek to annex property into the City of Bentonville, AR case number CC2016-19. This letter represents confirmation that you have properly coordinated with our office (Arkansas GIS Office) as specified in § 14-40-101 (Act 914 of 2015) of the 90th General Assembly.

Our office will wait completion of any additional steps necessary for the proposed boundary change, which normally comes from the Arkansas Secretary of State Elections Division after any appropriate filing by your County Clerk.

Thank you,

Richie Pierce, Sr. GIS Analyst
/rp

Attachments:
GIS Office Map of Proposed Annexation
Secretary of State Municipal Change Checklist

2016 SEP 23 PM 2:27

TENA O'BRIEN
CO. & PROBATE CLERK
BENTON COUNTY, ARK

Proposed Annex: City of Bentonville
September 2016

City: Bentonville
Mayor: Bob McCaslin

Arkansas Code 14-40-101.

Before an entity undertakes an annexation, consolidation, or detachment proceeding under this chapter, the entity shall coordinate with the Arkansas Geographic Information Systems Office for preparation of legal descriptions and digital mapping for the relevant annexation, consolidation, and detachment areas.

The map contained herein, is evidence, the entity has met requirements of Act 914 of 2015

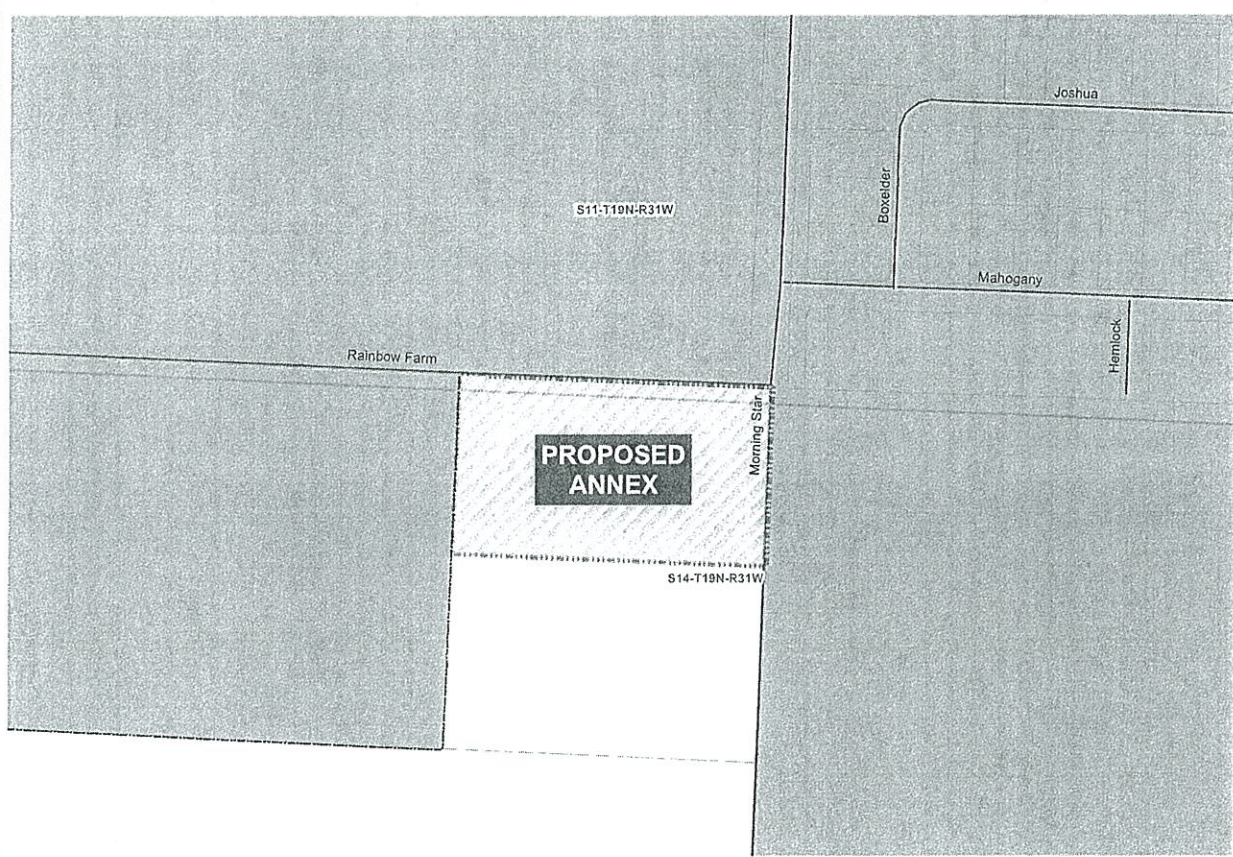

- Proposed Annex
- Township-Range
- Sections
- Parcels
- Highway
- Minor Road
- Existing City
- Neighboring City
- County Boundary

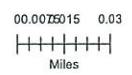

ARKANSAS
GIS OFFICE
Bentonville-20160923

FILED

OCT 20 2016

Arkansas
Secretary of State