



ARKANSAS SECRETARY OF STATE

MARK MARTIN

December 28, 2017

The Honorable Tena O'Brien
Benton County Clerk
215 East Central St, Suite 217
Bentonville, AR 72712-5373

Re: City of Bentonville Annexation Ordinance 2017-175

Dear Ms. O'Brien,

This letter acknowledges receipt and filing of the following notice of municipal boundary change by the Office of the Secretary of State:

Filing Type: Annexation pursuant to A.C.A § 14-40-609 (petition by 100% of the landowners)

Effective Date: 12/14/2017

County: Benton

City: Bentonville

City Ordinance: 2017-175

Dated: 11/14/2017

County Court Order: CC-2017-27

Date Filed: 11/20/2017 Honorable Barry Moehring, Benton County Judge

A file marked copy of the ordinance, Court Order and exhibits submitted to our Office are enclosed. By copy of this letter (and its enclosures), the Secretary of State hereby notifies the appropriate mapping authorities for Arkansas. Please retain these copies as official record of the filing of the municipal boundary change by the Arkansas Secretary of State.

If you have any questions or concerns regarding this pending filing, please contact our office at 501-682-3401.

Sincerely,

A handwritten signature in cursive script that reads "Cynthia Fisher".

Cynthia Fisher
Arkansas Secretary of State Legal Division
500 Woodlane St, Room 256
Little Rock, AR 72201
501-682-3401

cc: Arkansas Geographic Information Systems Office (w/ encl)
Arkansas Highway and Transportation Department Mapping Department (w/ encl)
Department of Finance and Administration (w/encl)
Arkansas Public Service Commission (w.encl)
UALR Institution for Economic Advancement (w/encl)
Tom-Tom (w/encl)
Honorable Bob McCaslin, Mayor of Bentonville



ARKANSAS SECRETARY OF STATE

MARK MARTIN

May 09, 2018

The Honorable Tena O'Brien
Benton County Clerk
215 East Central St, Suite 217
Bentonville, AR 72712-5373

Re: Corrected file copies of City of Bentonville Annexation Ordinances 2017-175, 2017-177, and 2017-178

Dear Ms. O'Brien,

For your files, please find enclosed the corrected document sets for Bentonville Annexation Ordinances 2017-175, 2017-177, and 2017-178 filed with the Secretary of State on December 28, 2017. The annexation document sets for these ordinances previously mailed by our Office contained a GIS map, which did not match the legal description of the annexation. The enclosed three document sets replaces the GIS map with the correct GIS map. All other pages remain the same.

Please replace the annexation filing copies sent by our Office in December with the enclosed document sets and destroy the older filing documents for Ordinance 2017-175, 2017-177 and 2017-178.

If you have any questions or concerns, please contact me at 501-682-3401.

Sincerely,

A handwritten signature in cursive script that reads "Cynthia Fisher".

Cynthia Fisher
Arkansas Secretary of State Legal Division
500 Woodlane St, Room 256
Little Rock, AR 72201
501-682-3401

cc: Arkansas Geographic Information Systems Office (w/ encl)
Arkansas Highway and Transportation Department Mapping Department (w/ encl)
Department of Finance and Administration (w/encl)
Arkansas Public Service Commission (w.encl)
UALR Institution for Economic Advancement (w/encl)
Tom-Tom (w/encl)
Honorable Bob McCaslin, Mayor of Bentonville (w/encl)
Mr. George Spence, Bentonville City Attorney (w/encl)



Arkansas Secretary of State

Mark Martin Arkansas Secretary of State, 500 Woodlane Ave, Little Rock, AR 72201-1094

Municipal Boundary Change Checklist

County: Benton City/Town: Bentonville

City Ordinance/Resolution No: ~~2017-177~~ ²⁰¹⁷⁻¹⁷⁵ Date approved: 11/14/2017

County Court Case No: CC 2017-27 Date Order Filed: 11/20/2017

Type: Annexation by Petition of all Landowners A.C.A §14-40-609

Date Change Effective: 12/14/2017 Set by: Municipal Ordinance Emergency Clause Default
(Required by Act 653 of 2017)

For Circuit Court Challenge: Date Order Filed: _____ Upheld Overturned Other *(attach explanation)*

Initiating party:

All Landowners Majority Landowners Municipal Governing Body State Other _____

Supporting Documentation attached *(check all that apply):*

- File marked copy of City Ordinance/Resolution *(required)*
- File marked copy of County Court Order or certified annexation election results *(required except for island annexation)*
- Copy of Arkansas GIS Office approved printed map and certification letter *(required)*
- Proof of Publication for all Legal Notices *(include Hearing, Election, and City Ordinance/Resolution notices)*
- File marked copy of Petition Part *(if applicable)*
- File marked copy of Complaint and final Circuit Court Order *(Court Challenge only)*

Municipal Contact:

Name: Bob McCaslin Title: Mayor

Street Address: 117 W Central Ave

City: Bentonville St: AR Zip code: 72712

Complete one form per ordinance/resolution, attach it as a cover page to the supporting document set and submit to the County Clerk's Office within 45 days of the Effective Date as required by Act 655 of 2017

County Official:

Signature: Tiffany Anderson Title: Deputy County Clerk

Date: 11-21-17

Pursuant to Act 655 of 2017, County Officials must submit a file-marked copy of municipal boundary change documentation within 30 days of receipt to: Arkansas Secretary of State, Attn: Municipal Boundary Filing, 500 Woodlane Ave Suite 256, Little Rock, AR 72201-1094

Office of the Arkansas Secretary of State use only

Received by: Cynthia Fisher

FILED
DEC 23 2017
Arkansas
Secretary of State

BENTON COUNTY

STATE OF ARKANSAS

TENA O'BRIEN

COUNTY CLERK & VOTER REGISTRAR

215 EAST CENTRAL, SUITE 217
BENTONVILLE, AR 72712-5373

November 21, 2017

PROBATE COURT CLERK

COURTHOUSE, 102 N.E. "A" STREET
BENTONVILLE, AR 72712-5350

Honorable Mark Martin
Secretary of State
Room 256 State Capitol
Little Rock, AR 72201-1094

RE: D.E.B. Farm Adventures, Inc
City of Bentonville Annexation
Benton County Court Case No. CC# 2017-27

Dear Secretary Martin:

In accordance with the law, I am enclosing a certified copy of each of the following:

1. Map (survey and vicinity map) of the affected area
2. Order Authorizing Confirming Annexation entered on November 20, 2017
3. Ordinance No. 2017-175 adopted on November 14, 2017, by the City of Bentonville

If you have any questions regarding this matter, please do not hesitate to call my office.

Sincerely,

Tena O'Brien

By: T. Underwood

TO/tku
Enclosures

cc: Roderick Grieve
Benton County Assessor

NW Arkansas Regional Planning Commission
1311 Clayton Street
Springdale, AR 72765

Benton County 9-1-1 Administration

COUNTY CLERK
(479) 271-1013
FAX (479) 271-1019

BENTONVILLE
(479) 271-1013
FAX (479) 271-1019

PROBATE COURT CLERK
(479) 271-5727
FAX (479) 271-1712

ROGERS
(479) 636-3727
FAX (479) 636-4922
ARCHIVIST (479) 636-1037
FAX (479) 636-1053

FILED

2017 NOV 15 AM 11:44

ORDINANCE NO. 2017-175

AN ORDINANCE ACCEPTING THE ANNEXATION OF CERTAIN TERRITORY TO THE CITY OF BENTONVILLE, ARKANSAS, AND MAKING SAME A PART OF THE CITY OF BENTONVILLE, AND ASSIGNING SAME TO WARDS.

WHEREAS, petition was filed with the County Clerk of Benton County, Arkansas by MICHAEL PAYNE, DEB FARMLAND ADVENTURES owner(s) of the hereinafter described territory, praying that said territory be annexed to, and made a part of the City of Bentonville, Arkansas, and

WHEREAS, on the 13th day of October, 2017, the County Court of Benton County, Arkansas, found that the petition was signed by the owners of said territory; that said territory was contiguous and adjoining the present corporate limits of the City of Bentonville, Arkansas; that an accurate plat or map of said territory had been filed with, and made a part of said petition; and that all things pertaining thereto had been done in the manner prescribed by law, and that said lands and territory should be annexed to and a part of the City of Bentonville, Arkansas, subject to the acceptance of same by the City Council of said City at the proper time, as provided by law; and

NOW, THEREFORE BE IT ORDAINED BY THE CITY COUNCIL OF THE CITY OF BENTONVILLE, ARKANSAS:

Section 1. That the land described on the attached Exhibit A is territory contiguous to and adjoining the City of Bentonville, Arkansas, and the same is hereby accepted as part of and annexed to and made a part of the City of Bentonville.

Section 2. That the above described territory shall be annexed to and made a part of Ward 3 of the City of Bentonville, and the same shall henceforth be a part of said ward as fully as existing parts of said ward.

Section 3. That the above described territory shall be zoned A-1, to be used in accordance with City zoning laws and the laws of the State of Arkansas.

2017 3728

FILED

2017 NOV 15 AM 11:44

Section 4: That this ordinance shall become effective 30 days from its passage and approval.

PASSED AND APPROVED THIS 14th DAY OF November, 2017.

APPROVED: Bobi McCash
Mayor

ATTEST: Kinda Spence
Clerk

Annexation-DEB Farm Adventures, Inc. 2017 NOV 15 PM 3: 32

Exhibit 'A'

Part of the NE $\frac{1}{4}$ of the NW $\frac{1}{4}$ of Section 21, Township 19N, Range 31W, Benton County, Arkansas; and more particularly described as follows:

From the NE Corner of Harris Addition, per plat record "O", Page 222, Run thence N 89°46'00" E, 434.49';

Thence S 0°31'20" W, 329.46' to the point of beginning.

Thence N 89°57'50" E, 649.57';

Thence S 0°58'37" E, 123.78';

Thence S 89°57'50" W, 507.94';

Thence S 75°13'45" W, 75';

Thence S 82°57'25" W, 73.15';

Thence N 88°10'15" W, 97.18';

Thence N 81°26'00" W, 84.70';

Thence N 44°15'40" W, 80.10';

Thence N 36°16'01" E, 15.79';

Thence S 40°31'38" E, 29.36';

Thence S 67°47'28" E, 32.79';

Thence S 87°26'05" E, 63.01';

Thence S 87°44'11" E, 115.55';

Thence N 0°31'20" E, 108.05' to the point of beginning.

AND

Part of the NE $\frac{1}{4}$ of the NW $\frac{1}{4}$ of Section 21, Township 19N, Range 31W, Benton County, Arkansas; and being more particularly described as follows:

Commencing at the SW Corner of said NE $\frac{1}{4}$ of the NW $\frac{1}{4}$ of Section 21.

Thence S 87°15'27" E, 170' to the true point of beginning;

Thence N 02°47'04" E, 96.92';

Thence S 87°15'27" E, 36';

Thence N 02°47'04" E, 257.45';

Thence along a curve to the left having a radius of 50', and arc length of 78.36', and a chord bearing and distance of N 29°28'06" E, 70.58';

Thence S 60°11'58" E, 112.19';

Thence S 3°01'43" W, 63.72';

Thence S 86°54'29" E, 169.02';

Thence N 02°29'20" E, 139.44';

Thence N 88°30'35" W, 67.66';

Thence N 3°57'56" E, 425.26';

Thence S 63°10'16" E, 36.51';

Thence S 78°59'55" E, 84.74';

Thence S 84°42'42" E, 97.20';

Thence N 86°26'11" E, 73.10';

Thence N 78°41'04" E, 75.02';

FILED

2017 NOV 15 PM 3: 32

Thence S 86°33'53" E, 507.88';
Thence S 02°30'27" W, 852.01';
Thence N 87°15'27" W, 1148.28' to the point of beginning.

AND

Part of the South ½ of the NW ¼ of Section 21, Township 19N, Range 31W, Benton County, Arkansas;
and being more particularly described as follows:

Beginning at the SW Corner of said NW ¼ of said Section 21;
Thence N 0°00'00"E, 992.21';
Thence S89°13'31"E, 263.81;
Thence N0°01'57"E, 330.55';
Thence S89°20'42"E, 2378.04'
Thence S00°04'26"W, 1324.40';
Thence N89°17'40"W, 2640.35' to the point of beginning.

2017 3731

FILED

2017 NOV 15 PM 3: 32

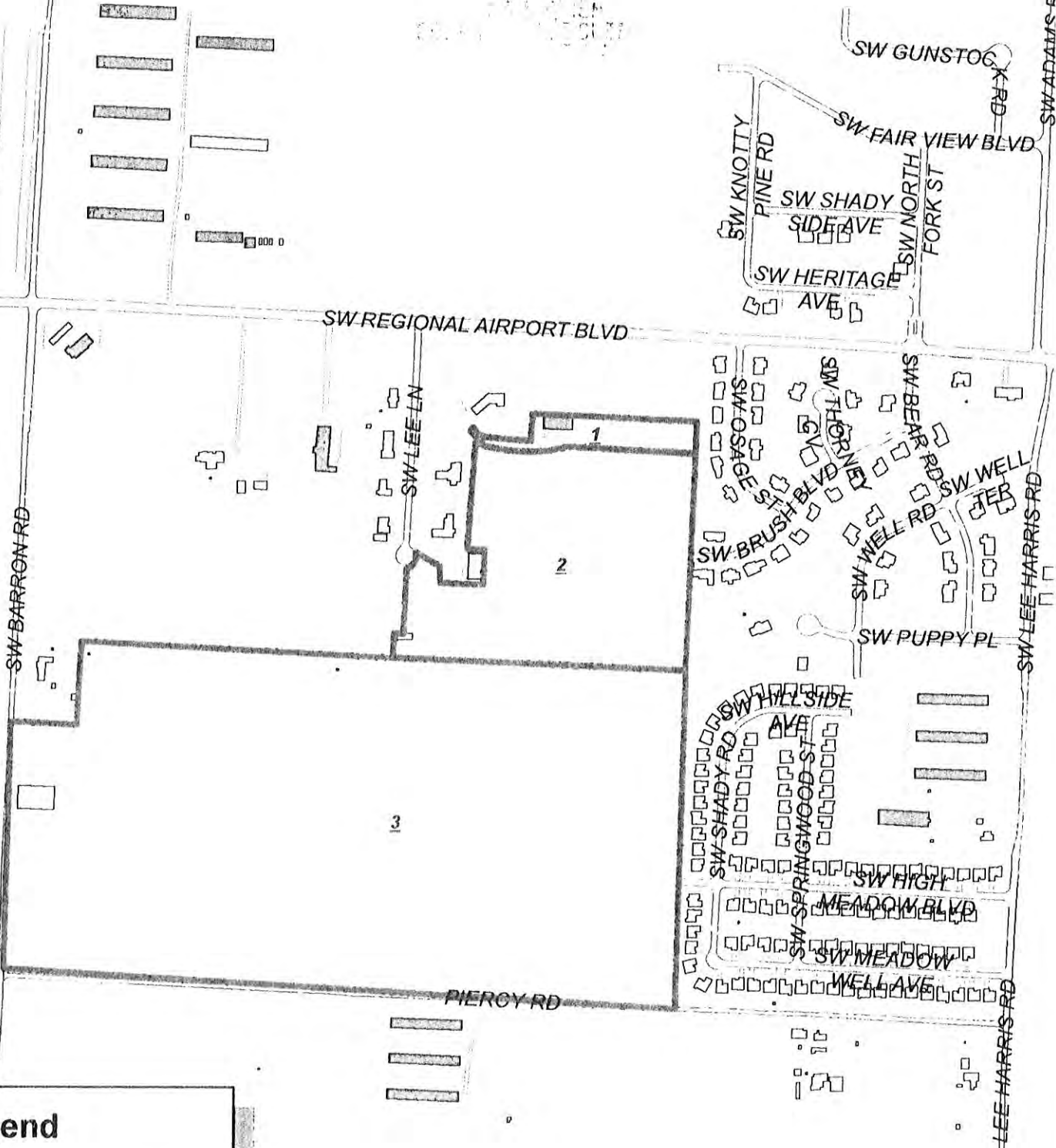

Legend

 Proposed Annexation

BENTONVILLE



2017 3732

Annexation
DEB Farm Adventures, Inc.

1 inch = 580 feet



2017 NOV 20 PM 4: 22

IN THE MATTER OF ANNEXING TO THE
CITY OF BENTONVILLE, ARKANSAS
CERTAIN TERRITORY CONTIGUOUS TO SAID
CITY OF BENTONVILLE, ARKANSAS

CC 2017-27

ORDER CONFIRMING ANNEXATION

Now on this day is presented to the Court the complete file for the annexation of certain land to the City of Bentonville, Benton County, Arkansas, under this file number, including specifically a copy of the plat of the annexed property and a copy of the resolution or ordinance of the governing body of the city or town accepting the property for annexation, and having reviewed the file and all things considered, the Court finds that all the requirements of § 14-40-609 of the Arkansas Code have been complied with and further that the annexation is in all respects proper, including if applicable, that the annexing city or town has included in the legal description included with its resolution or ordinance accepting the property for annexation certain dedicated public roads and rights of way abutting or traversing the property to be annexed if required by the Court's previous order entered in this file.

IT IS THEREFORE CONSIDERED AND ORDERED that the annexation of the above described lands to the City of Bentonville, Benton County, Arkansas, is hereby confirmed and that the same is and shall hence forth comprise a part of the City of Bentonville, Benton County, Arkansas.



HON. BARRY MOEHRING, County Judge

Date

11-20-2017

FILED

2017 OCT 17 PM 2:55

CLERK OF COURT
BENTON COUNTY, ARK.

IN THE MATTER OF ANNEXING TO THE
CITY OF BENTONVILLE, ARKANSAS
CERTAIN TERRITORY CONTIGUOUS TO SAID
CITY OF BENTONVILLE, ARKANSAS

D.E.B. Farm Adventures, Inc., Petitioners

COUNTY COURT ORDER NO. CC 2017-27

ORDER AUTHORIZING ANNEXATION PURSUANT TO ACA § 14-40-609

I, Barry Moehring, County Judge of Benton County, having reviewed the attached petition for annexation and verification of petition, hereby find that the petition:

- 1) is in writing;
- 2) contains an attestation signed before a notary or notaries by the property owner or owners of the relevant property or properties confirming their desire to be annexed;
- 3) contains an accurate description of the relevant property or properties;
- 4) contains a letter or title opinion from a certified abstractor or title company verifying that the petitioners are all owners of record of the relevant property or properties;
- 5) contains a letter or verification from a certified surveyor or engineer verifying that the relevant property or properties are contiguous with the annexing city or town and that no enclaves will be created if the property or properties are accepted by the city or town – additionally a copy of the letter from the State of Arkansas GIS office approving the legal description for the annexation was provided;
- 6) includes a schedule of services of the annexing city or town that will be extended to the area within three (3) years after the date the annexation becomes final; and
- 7) does not include in its description certain dedicated public roads and rights of way abutting or traversing the property to be annexed, the legal description(s) for which are included on the attached Exhibit “A” to this order, and which are depicted in the attached Exhibit “B” to this order, and any acceptance of this annexation by the City of Bentonville is required to include acceptance of the property described in Exhibit “A” and depicted in Exhibit “B” in the resolution or ordinance accepting such annexation or an order confirming the annexation will not be entered.

The County Clerk is directed to forward a copy of this order and the related Petition to the Mayor of the City of Bentonville.

 HON. BARRY MOEHRING, County Judge

Date

FILED
OCT 17 2017
CLERK OF COURT
BENTON COUNTY, ARK.

FILED

2017 OCT 17 PM 2:55

EXHIBIT "A"

RECORDED
PL & PROBATE CLERK
DISTRICT OF COLUMBIA

Right of Way description for Piercy Road

Beginning at the NW corner of the NW $\frac{1}{4}$ of the SW $\frac{1}{4}$ of section 21, township 19-north, range 31-west; thence N2°04'28"E 25.00 feet; thence S88°33'08"E 2625.82 feet; thence S1°10'17"W 50.00 feet; thence N88°33'08"W 2625.82 feet; thence N2°04'28"E 25.00 feet to the Point of Beginning.

Right of Way description for Barron Road

Beginning at the SW corner of the NW $\frac{1}{4}$ of the NW $\frac{1}{4}$ of section 21, township 19-north, range 31-west; thence N87°15'19"W 30.00 feet; thence N3°12'28"E 822.9 feet; thence S87°51'12"E 50.00 feet; thence S3°12'28"W 822.67 feet; thence N87°15'19"W 20.00 feet to the Point of Beginning.

2017 3397

Exhibit "B" CC 2017-27

FILED

2017 OCT 17 PM 2:55

Abutting ROW to Annexation

PLANNING & ZONING DEPARTMENT
COUNTY CLERK
BAYLOR COUNTY, TEXAS





ARKANSAS GIS OFFICE

July 14, 2017

Mr. Jim Wheeless
City of Bentonville
GIS Coordinator
305 SWA Street
Bentonville, AR 72712

RE: City of Bentonville Annexation Coordination Requirement

Mr. Wheeless,

Thank you for coordinating with our office as you seek to annex property into the City of Bentonville, AR. This letter represents confirmation that you have properly coordinated with our office (Arkansas GIS Office) as specified in § 14-40-101 (Act 914 of 2015) of the 90th General Assembly.

Our office will wait completion of any additional steps necessary for the proposed boundary change, which normally comes from the Arkansas Secretary of State Elections Division after any appropriate filing by your County Clerk.

Thank you,

Jennifer Wheeler, GIS Analyst
/jjw

Attachments:
GIS Office Map of Proposed Annexation
Secretary of State Municipal Change Checklist

H:\City Annexations\Cities\Bentonville\20170714\Doc\20170714_Bentonville_Annexation_Coordination_Letter.docx

Proposed Annex: City of Bentonville
July 2017

City: Bentonville
Mayor: Bob McCaslin

Arkansas Code 14-40-101

Before an entity undertakes an annexation, consolidation, or detachment proceeding under this chapter, the entity shall coordinate with the Arkansas Geographic Information Systems Office for preparation of legal descriptions and digital mapping for the relevant annexation, consolidation, and detachment areas.

The map contained herein, in evidence, the entity has met requirements of Act 914 of 2015.

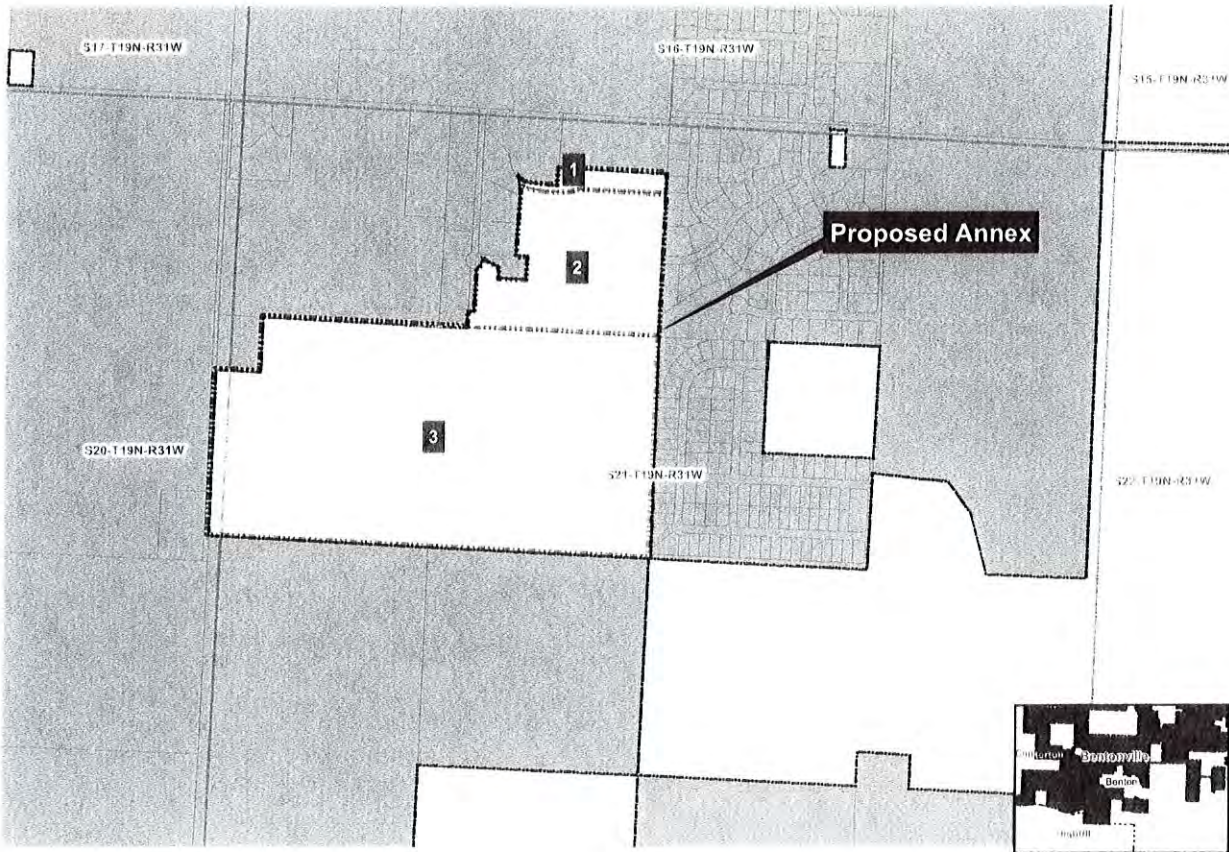

- Proposed Annex
- Section
- Parcel
- Existing City
- Neighboring City
- County Boundary

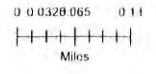

ARKANSAS
GIS OFFICE

IN THE MATTER OF ANNEXING TO THE
CITY OF BENTONVILLE, ARKANSAS
CERTAIN TERRITORY CONTIGUOUS TO SAID
CITY OF BENTONVILLE, ARKANSAS

2017 OCT 13 AM 10:51
TENA O'BRIEN
CO. & FRANCHISE CLERK
REC CC 2017-27

VERIFICATION OF PETITION FOR ANNEXATION PURSUANT TO ACA § 14-40-609

We, Tena O'Brien, County Clerk of Benton County, and Roderick Grieve, County Assessor of Benton County, attest as follows:

Our offices have received the attached petition seeking annexation. The petition has been reviewed and we hereby verify that the petition:

(A) is in writing;

(B) contains an attestation signed before a notary or notaries by the property owner or owners of the relevant property or properties confirming the desire to be annexed;

(C) contains an accurate description of the relevant property or properties;

(D) contains a letter or title opinion from a certified abstractor or title company verifying that the petitioners are all owners of record of the relevant property or properties;

(E) contains a letter or verification from a certified surveyor or engineer verifying that the relevant property or properties are contiguous with the annexing city or town and that no enclaves will be created if the property or properties are accepted by the city or town; and

(F) include a schedule of services of the annexing city or town that will be extended to the area within three (3) years after the date the annexation becomes final.

Additionally, we note that the legal description in (C) does not include in its description certain dedicated public roads and rights of way abutting or traversing the property to be annexed, the legal descriptions for which are included on the attached Exhibit "A" and which are depicted in the attached Exhibit "B" to this verification.



HON. TENA O'BRIEN, County Clerk

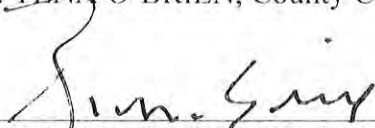

HON. RODERICK GRIEVE, County Assessor



2017 OCT 13 AM 10:51

TELL J-BIEN
CO. & PROBATE CLERK
BENTON COUNTY, ARKANSAS

Date: October 9, 2017
Subject: Proposed Annexation Checklist
CC 2017-21

- (A) is in writing;
 - (B) contains an attestation signed before a notary or notaries by the property owner or owners of the relevant property or properties confirming the desire to be annexed;
 - (C) contains an accurate description of the relevant property or properties;
 - (D) contains a letter or title opinion from a certified abstractor or title company verifying that the petitioners are all owners of record of the relevant property or properties;
 - (E) contains a letter or verification from a certified surveyor or engineer verifying that the relevant property or properties are contiguous with the annexing city or town and that no enclaves will be created if the property or properties are accepted by the city or town; and
 - (F) include a schedule of services of the annexing city or town that will be extended to the area within three (3) years after the date the annexation becomes final.
- [Additionally, we note that the legal description in (C) does not include in its description certain dedicated public roads and rights of way abutting or traversing the property to be annexed, the legal descriptions for which are included on the attached Exhibit "A"]

Please contact me if you have any questions.

Michael D. Million
Manager – Mapping Dept.
Benton County Assessor's Office
Phone: 479-271-1037, ext. 7004
Email: michael.million@bentoncountyar.gov

EXHIBIT "A"

2017 OCT 13 AM 10:11

TELEPHONE
CO. & FIELD CLERK
FELIX

Right of Way description for Piercy Road

Beginning at the NW corner of the NW ¼ of the SW ¼ of section 21, township 19-north, range 31-west; thence N2°04'28"E 25.00 feet; thence S88°33'08"E 2625.82 feet; thence S1°10'17"W 50.00 feet; thence N88°33'08"W 2625.82 feet; thence N2°04'28"E 25.00 feet to the Point of Beginning.

Right of Way description for Barron Road

Beginning at the SW corner of the NW ¼ of the NW ¼ of section 21, township 19-north, range 31-west; thence N87°15'19"W 30.00 feet; thence N3°12'28"E 822.9 feet; thence S87°51'12"E 50.00 feet; thence S3°12'28"W 822.67 feet; thence N87°15'19"W 20.00 feet to the Point of Beginning.

FILED

2017 OCT -6 PM 1:27

IN THE MATTER OF ANNEXING TO THE CITY
OF BENTONVILLE, ARKANSAS CERTAIN TERRITORY
CONTIGUOUS TO SAID CITY

NO. CC 2017-27

PETITION FOR ANNEXATION – 100 % OF OWNERS PETITIONING

DATE: 9-6-2017

Come now the undersigned petitioners, and state as follows:

1. That we, owning 100% of the property in the following described area, do hereby petition, pursuant to A.C.A. §14-40-609, the City Council of Bentonville, Arkansas, to annex the following lands to the City of Bentonville, Arkansas.

See legal description of the area to be annexed attached as Exhibit "A"

2. We further state that this petition is signed by one hundred percent (100%) of the real estate owners owning one hundred percent (100%) of the acreage in said area and that the area to be annexed does not contain property whose owners do not wish to have their property annexed.

3. That said property description herein is contiguous to and adjoining the present City of Bentonville city limits, as shown on the map attached hereto as Exhibit "B."

4. That no enclaves will be created if this petition is accepted and the territory annexed into the City of Bentonville.

5. That the following schedule of services shall be extended to the area by the City of Bentonville within three (3) years after the date the annexation becomes final:

All properties annexed into the City of Bentonville are provided with Police, Fire and EMS services.

Additional services such as water and sewer may be provided if readily available. Such services are provided in accordance with existing ordinances and terms of service, including but not limited to the payment of required fees, the necessary permits, inspections and approvals.

FILED

6. That a letter or title opinion from a certified abstractor or title company, verifying that the petitioners are all owners of record of the relevant property or properties is attached hereto as Exhibit "C" and is made part of this petition as if set out word for word herein. 2017 OCT 26 PM 1:27

7. That a letter or verification from a certified surveyor or engineer verifying that the relevant property or properties are contiguous with the City of Bentonville and that no enclaves will be created if the property or properties are accepted by the City of Bentonville is attached hereto as Exhibit "D" and is made part of this petition as if set out word for word herein.

8. That each of the undersigned persons executing this petition has confirmed by their signature below a desire that their property, which is included in the property described above, be annexed into the City of Bentonville.

FILED

I confirm my desire that property owned by me, which is to be included in a petition to annex property, be annexed into the City of Bentonville.

2017 OCT -6 PM 1:27

If the property being annexed is owned jointly, I attest that all owners of the property are signing a copy of this confirmation.

If the property is owned by a trust, I attest either that I have the authority to sign this confirmation on behalf of the trust, or that all persons required to do so by the trust are signing a copy of this confirmation.

If the property is owned by a corporation, limited liability company or other entity I attest either that I have the authority to sign this confirmation on behalf of the entity, or that all persons required to do so by the entity's governing documents are signing a copy of this confirmation.

Edward L Frail

Signature of Property Owner or
Legal Representative of Property Owner,
Petitioner

Trustee

Title, if applicable (i.e. Trustee,
(Managing Member, President,
Secretary)

18-09097-005 / 18-09097-004

Parcel number of property to be annexed

ACKNOWLEDGMENT

State of Arkansas)
) ss.
County of Benton)

On this the 18th day of September, 2017, before me, the undersigned officer, personally appeared Edward L Frail, known to me (or satisfactorily proven) to be the person whose name is subscribed above and acknowledged and attested that it was executed for the purposes therein apparent.

Deanne Edwards
NOTARY PUBLIC

My Commission Expires:

March 22, 2020

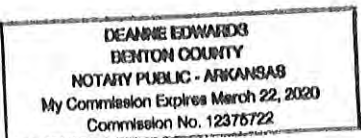

FILED

I confirm my desire that property owned by me, which is to be included in a petition to annex property, be annexed into the City of Bentonville.

2017 OCT -6 PM 1:27

If the property being annexed is owned jointly, I attest that all owners of the property are signing a copy of this confirmation.

If the property is owned by a trust, I attest either that I have the authority to sign this confirmation on behalf of the trust, or that all persons required to do so by the trust are signing a copy of this confirmation.

If the property is owned by a corporation, limited liability company or other entity I attest either that I have the authority to sign this confirmation on behalf of the entity, or that all persons required to do so by the entity's governing documents are signing a copy of this confirmation.

Amelda Trail
Signature of Property Owner or
Legal Representative of Property Owner,
Petitioner

Trustee
Title, if applicable (i.e. Trustee,
(Managing Member, President,
Secretary)

18-09097-005 / 18-09097-004
Parcel number of property to be annexed

ACKNOWLEDGMENT

State of Arkansas)
) ss.
County of Benton)

On this the 18th day of September, 2017, before me, the undersigned officer, personally appeared Amelda Trail, known to me (or satisfactorily proven) to be the person whose name is subscribed above and acknowledged and attested that it was executed for the purposes therein apparent.

Deanne Edwards
NOTARY PUBLIC

My Commission Expires:

March 22, 2020

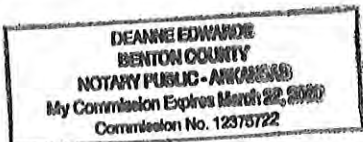

Annexation-DEB Farm Adventures, Inc.

FILED

Exhibit 'A'

Part of the NE ¼ of the NW ¼ of Section 21, Township 19N, Range 31W, Benton County, Arkansas, and more particularly described as follows:

From the NE Corner of Harris Addition, per plat record "O", Page 222, Run thence N 89°46'00" E, 434.49';
Thence S 0°31'20" W, 329.46' to the point of beginning.

Thence N 89°57'50" E, 649.57';
Thence S 0°58'37" E, 123.78';
Thence S 89°57'50" W, 507.94';
Thence S 75°13'45" W, 75';
Thence S 82°57'25" W, 73.15';
Thence N 88°10'15" W, 97.18';
Thence N 81°26'00" W, 84.70';
Thence N 44°15'40" W, 80.10';
Thence N 36°16'01" E, 15.79';
Thence S 40°31'38" E, 29.36';
Thence S 67°47'28" E, 32.79';
Thence S 87°26'05" E, 63.01';
Thence S 87°44'11" E, 115.55';
Thence N 0°31'20" E, 108.05' to the point of beginning.

AND

Part of the NE ¼ of the NW ¼ of Section 21, Township 19N, Range 31W, Benton County, Arkansas; and being more particularly described as follows:

Commencing at the SW Corner of said NE ¼ of the NW ¼ of Section 21.
Thence S 87°15'27" E, 170' to the true point of beginning;
Thence N 02°47'04" E, 96.92';
Thence S 87°15'27" E, 36';
Thence N 02°47'04" E, 257.45';
Thence along a curve to the left having a radius of 50', and arc length of 78.36', and a chord bearing and distance of N 29°28'06" E, 70.58';
Thence S 60°11'58" E, 112.19';
Thence S 3°01'43" W, 63.72';
Thence S 86°54'29" E, 169.02';
Thence N 02°29'20" E, 139.44';
Thence N 88°30'35" W, 67.66';
Thence N 3°57'56" E, 425.26';
Thence S 63°10'16" E, 36.51';
Thence S 78°59'55" E, 84.74';
Thence S 84°42'42" E, 97.20';
Thence N 86°26'11" E, 73.10';
Thence N 78°41'04" E, 75.02';

Thence S 86°33'53" E, 507.88';
Thence S 02°30'27" W, 852.01';
Thence N 87°15'27" W, 1148.28' to the point of beginning.

FILED

2017 OCT -6 PM 1:28

AND

Part of the South ½ of the NW ¼ of Section 21, Township 19N, Range 31W, Benton County, Arkansas;
and being more particularly described as follows:

Beginning at the SW Corner of said NW ¼ of said Section 21;
Thence N 0°00'00"E, 992.21';
Thence S89°13'31"E, 263.81;
Thence N0°01'57"E, 330.55';
Thence S89°20'42"E, 2378.04'
Thence S00°04'26"W, 1324.40';
Thence N89°17'40"W, 2640.35' to the point of beginning.

FILED

2017 OCT -6 PM 1:28

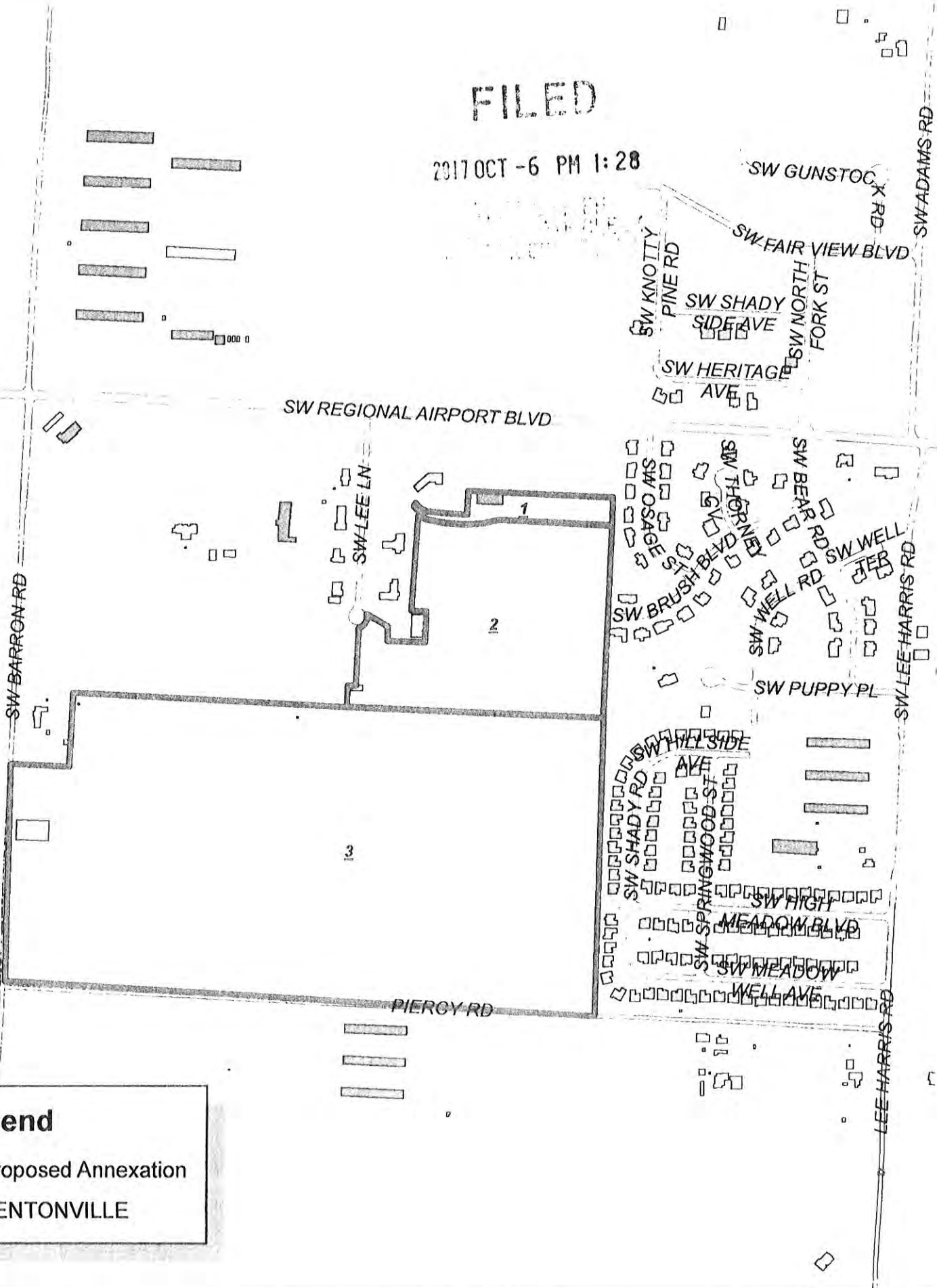

Legend

 Proposed Annexation
 BENTONVILLE

EXHIBIT "B"

Annexation
DEB Farm Adventures, Inc.

1 inch = 580 feet



Benton
216 W Sevier Street
Benton, AR 72015

Fayetteville
1420 Augustine Lane, Suite 1
Fayetteville, AR 72703



"EXHIBIT C"

Faulkner County Title Company
A Division of
First National Title Company
Conway
711 Locust Street
Conway, AR 72034

Little Rock Title Company
A Division of
First National Title Company
Little Rock
1001 W. Markham Street #100
Little Rock, AR 72201

Bentonville
300 SW 28th Street
Bentonville, AR 72712

Sheridan
206 N Rose Street
Sheridan, AR 72150

.....
F i r s t N a t i o n a l
.....
T i t l e C o m p a n y
.....

Greenbrier
8 Wagon Wheel Road, Suite A
Greenbrier, AR 72058

Jasper
201 N. Stone Street
P.O. Box 77
Jasper, AR 72641

Eureka Springs
70 S. Main Street, Suite 2
Eureka Springs, AR 72632

Harrison
218 E. Ridge Ave.
Harrison, AR 72601

Headquarters
First National Title Company
Little Rock
415 N McKinley Street Suite 1200
Little Rock, AR 72205

FILED
2010 OCT 6 PM 1:28

October 2, 2017

Greetings:

This letter is given in connection with what is understood to be an effort to voluntarily annex certain real property into the City of Bentonville. Based on our review, we verify that the persons listed in Exhibit C-1 to this letter are all the owners of record of the real property described in Exhibit C-1 to this Letter.

DEB Farm Adventures Inc., Mike Payne President: 18-09101-000, 18-09096-001

Sincerely,

Steve Pangle
Benton County Manager
First National Title

DEB FARMS ANNEXATION
EXHIBIT "C-1"

FILED

2017 OCT -6 PM 1:28

<u>Deb Farms Adventures LLC.</u>	<u>18-09101-000</u>
	<u>18-09096-001</u>
<u>Frail Trust</u>	<u>18-09097-004</u>
	<u>18-09097-005</u>

Annexation-DEB Farm Adventures, Inc.

FILED

Exhibit 'C-1'

2017 OCT -6 PM 1:28

Part of the NE ¼ of the NW ¼ of Section 21, Township 19N, Range 31W, Benton County, Arkansas; and more particularly described as follows:

From the NE Corner of Harris Addition, per plat record "O", Page 222, Run thence N 89°46'00" E, 434.49';
Thence S 0°31'20" W, 329.46' to the point of beginning.

Thence N 89°57'50" E, 649.57';
Thence S 0°58'37" E, 123.78';
Thence S 89°57'50" W, 507.94';
Thence S 75°13'45" W, 75';
Thence S 82°57'25" W, 73.15';
Thence N 88°10'15" W, 97.18';
Thence N 81°26'00" W, 84.70';
Thence N 44°15'40" W, 80.10';
Thence N 36°16'01" E, 15.79';
Thence S 40°31'38" E, 29.36';
Thence S 67°47'28" E, 32.79';
Thence S 87°26'05" E, 63.01';
Thence S 87°44'11" E, 115.55';
Thence N 0°31'20" E, 108.05' to the point of beginning.

AND

Part of the NE ¼ of the NW ¼ of Section 21, Township 19N, Range 31W, Benton County, Arkansas; and being more particularly described as follows:

Commencing at the SW Corner of said NE ¼ of the NW ¼ of Section 21.
Thence S 87°15'27" E, 170' to the true point of beginning;
Thence N 02°47'04" E, 96.92';
Thence S 87°15'27" E, 36';
Thence N 02°47'04" E, 257.45';
Thence along a curve to the left having a radius of 50', and arc length of 78.36', and a chord bearing and distance of N 29°28'06" E, 70.58';
Thence S 60°11'58" E, 112.19';
Thence S 3°01'43" W, 63.72';
Thence S 86°54'29" E, 169.02';
Thence N 02°29'20" E, 139.44';
Thence N 88°30'35" W, 67.66';
Thence N 3°57'56" E, 425.26';
Thence S 63°10'16" E, 36.51';
Thence S 78°59'55" E, 84.74';
Thence S 84°42'42" E, 97.20';
Thence N 86°26'11" E, 73.10';
Thence N 78°41'04" E, 75.02';

Thence S 86°33'53" E, 507.88';
Thence S 02°30'27" W, 852.01';
Thence N 87°15'27" W, 1148.28' to the point of beginning.

FILED

2017 OCT -6 PM 1:28

AND

Part of the South ½ of the NW ¼ of Section 21, Township 19N, Range 31W, Benton County, Arkansas;
and being more particularly described as follows:

Beginning at the SW Corner of said NW ¼ of said Section 21;
Thence N 0°00'00"E, 992.21';
Thence S89°13'31"E, 263.81;
Thence N0°01'57"E, 330.55';
Thence S89°20'42"E, 2378.04'
Thence S00°04'26"W, 1324.40';
Thence N89°17'40"W, 2640.35' to the point of beginning.

EXHIBIT "D"

FILED

Greetings:

2017 OCT -6 PM 1:28

This letter is given in connection with what is understood to be an effort to voluntarily annex certain real property into the City of Bentonville. I am a licensed Professional Engineer in the State of Arkansas. Based on my review, I verify that the real property described in Exhibit D-1 to this letter is contiguous with the City of Bentonville and that no enclaves will be created if the described property is accepted by the City of Bentonville.

Sincerely,

Travis Matlock, P.E.



9/20/17

Annexation-DEB Farm Adventures, Inc.

FILED

Exhibit 'D-1'

2017 OCT -6 PM 1:28

Part of the NE ¼ of the NW ¼ of Section 21, Township 19N, Range 31W, Benton County, Arkansas; and more particularly described as follows:

From the NE Corner of Harris Addition, per plat record "O", Page 222, Run thence N 89°46'00" E, 434.49';
Thence S 0°31'20" W, 329.46' to the point of beginning.

Thence N 89°57'50" E, 649.57';
Thence S 0°58'37" E, 123.78';
Thence S 89°57'50" W, 507.94';
Thence S 75°13'45" W, 75';
Thence S 82°57'25" W, 73.15';
Thence N 88°10'15" W, 97.18';
Thence N 81°26'00" W, 84.70';
Thence N 44°15'40" W, 80.10';
Thence N 36°16'01" E, 15.79';
Thence S 40°31'38" E, 29.36';
Thence S 67°47'28" E, 32.79';
Thence S 87°26'05" E, 63.01';
Thence S 87°44'11" E, 115.55';
Thence N 0°31'20" E, 108.05' to the point of beginning.

AND

Part of the NE ¼ of the NW ¼ of Section 21, Township 19N, Range 31W, Benton County, Arkansas; and being more particularly described as follows:

Commencing at the SW Corner of said NE ¼ of the NW ¼ of Section 21.
Thence S 87°15'27" E, 170' to the true point of beginning;
Thence N 02°47'04" E, 96.92';
Thence S 87°15'27" E, 36';
Thence N 02°47'04" E, 257.45';
Thence along a curve to the left having a radius of 50', and arc length of 78.36', and a chord bearing and distance of N 29°28'06" E, 70.58';
Thence S 60°11'58" E, 112.19';
Thence S 3°01'43" W, 63.72';
Thence S 86°54'29" E, 169.02';
Thence N 02°29'20" E, 139.44';
Thence N 88°30'35" W, 67.66';
Thence N 3°57'56" E, 425.26';
Thence S 63°10'16" E, 36.51';
Thence S 78°59'55" E, 84.74';
Thence S 84°42'42" E, 97.20';
Thence N 86°26'11" E, 73.10';
Thence N 78°41'04" E, 75.02';

Thence S 86°33'53" E, 507.88';
Thence S 02°30'27" W, 852.01';
Thence N 87°15'27" W, 1148.28' to the point of beginning.

FILED

2017 OCT -6 PM 1:28

AND

Part of the South ½ of the NW ¼ of Section 21, Township 19N, Range 31W, Benton County, Arkansas;
and being more particularly described as follows:

Beginning at the SW Corner of said NW ¼ of said Section 21;
Thence N 0°00'00"E, 992.21';
Thence S89°13'31"E, 263.81;
Thence N0°01'57"E, 330.55';
Thence S89°20'42"E, 2378.04'
Thence S00°04'26"W, 1324.40';
Thence N89°17'40"W, 2640.35' to the point of beginning.