



ARKANSAS SECRETARY OF STATE

MARK MARTIN

September 9, 2015

The Honorable Tena O'Brien
215 E Central Suite 217
Bentonville AR 72712

RE: Annexation

Dear Mrs. O'Brien,

The following information was received and has been filed in the office of the Secretary of State. It has been filed accordingly:

County: Benton

City: Centerton

Annexation:

Ordinance No. 2015-18- Dated August 13, 2015
County Court Order. CC2015-02- Dated July 1, 2015
Plat of area to be annexed

By copy of this letter, I am sending file marked copies of all of the information to the UALR Institute for Economic Advancement, Arkansas Highway Mapping Department, TomTom, and the State Geographic Information Office. All others listed will only receive notification of the annexation by copy of this letter.

If you have any questions please do not hesitate to contact me at 1-800-482-1127 or 501-682-3476.

Sincerely,

Jacqueline Cowan
Elections Services Representative
Arkansas Secretary of State

cc: UALR Institute for Economic Advancement (w/encl)
Arkansas Highway Mapping Department (w/encl)
TomTom (w/encl)
Shelby Johnson, State Geographic Information Officer GIS (w/encl)
Arkansas Municipal League (w/o encl)
Benton City Clerk (w/o encl)



FILED

2015 AUG 13 PM 3: 33

TEMA GIBSON
CO. & PROBATE CLERK
BENTON COUNTY, ARK

ORDINANCE NO. 2015-18

AN ORDINANCE ACCEPTING AND ANNEXING CERTAIN LAND BELONGING TO EDITH LUCILLE ELSEA; DON TERNYILA, BILL TERNYILA, AND KANDIS KEYES; BIG SKY LLC; AND THE COUGHLIN FAMILY REVOCABLE TRUST U/T/D/ NOVEMBER 25, 1991, AND CITY OF CENTERTON TO THE CITY OF CENTERTON, ARKANSAS; ASSIGNING SAME TO WARD 1 AND ZONING A-1; DECLARING AN EMERGENCY AND FOR OTHER PURPOSES.

FILED

AUG 17 2015

Arkansas
Secretary of State

WHEREAS, a Petition was filed in the County Court of Benton County, Arkansas, requesting that certain lands belonging to **EDITH LUCILLE ELSEA; DON TERNYILA, BILL TERNYILA, AND KANDIS KEYES; BIG SKY LLC; AND THE COUGHLIN FAMILY REVOCABLE TRUST U/T/D/ NOVEMBER 25, 1991, AND CITY OF CENTERTON** ; County Court Case No. CC2015-02; hereinafter described, lying adjacent and contiguous to the City of Centerton, Arkansas, be annexed to, and made a part of the City of Centerton, Arkansas; and,

WHEREAS, on July 1st, 2015, the County Court of Benton, Arkansas found that the petition was signed by the property owners of said territory; that said territory was contiguous and adjoining the present corporate limits of the City of Centerton, Arkansas; that an accurate plat or map of said territory had been filed with and made a part of said petition; that proper notice had been given for the time and in the manner prescribed by law, and that all things pertaining thereto had been done in the manner prescribed by law, and that said lands and territory should be annexed to and made a part of the City of Centerton, Arkansas, subject to the acceptance of same by the City Council of said City at the proper time, as provided by law and approved, decreed and ordered by County Judge; and

WHEREAS, the time fixed by law of 30 days for appealing said order of annexation made by the County Court has expired and no appeal has been taken from said order.

NOW, THEREFORE, be it ordained by the City Council of the City of Centerton, Arkansas:

Section 1: That the following described lands and territory contiguous and adjoining the City of Centerton, Arkansas, be and the same is hereby accepted as part of and annexed to and made a part of the City of Centerton.

FILED

2015 AUG 13 PM 3: 33

LENA J. JORDAN
CO. & PROBATE CLERK
BENTON COUNTY, ARK

Legal Description:

Beginning at a point on the Centerton city limit line at the SE corner of the North half of the SE ¼ NE ¼ of S29, T20N, R31W, same point being the SE corner of Benton County parcel #18-09955-000; thence north 665.23 feet more or less, to the NE corner of the SE ¼ NE ¼ of said S29, same point being the NE corner of said parcel; thence West 664.06 feet more or less to a point, same being the SE corner of parcel #18-09950-003; thence North 1305.77 feet more or less to a point, same being the NE corner of parcel #18-09950-003; thence East 235.02 feet more or less to a point, same being the SE corner of parcel #18-09783-004; thence North 333.38 feet more or less to a point, same being the NW corner of parcel #18-09783-000; thence West 236.92 feet more or less to a point, same being the SW corner of parcel #18-09783-005; thence North 331.79 feet more or less to a point, same being the NW corner of parcel #18-09783-005; thence East 672.61 feet more or less to a point, same being the SE corner of parcel #18-09780-000; thence North 1990.53 feet more or less to a point, same being the NE corner of parcel #18-09778-000; thence West 1329.45 feet more or less to a point, same being the SE corner of parcel #18-09764-001; thence North 2635.30 feet more or less to a point, same being the SW corner of parcel #18-09699-000; thence East 681.67 feet more or less to a point, same being the NW corner of parcel #18-09758-000; thence South 344.16 feet more or less to a point, same being the SW corner of parcel #18-09758-000; thence East 650.33 feet more or less to a point, same being the SE corner of parcel #18-09758-000; thence North 340.30 feet more or less to the SE corner of S17, T20N, R31W, same being the NE corner of parcel #18-09758-000; thence North 795.75 feet more or less to a point, same being the NE corner of parcel #18-09699-000; thence Northwesterly 1512.81 feet more or less to a point, same being the NW corner of parcel #18-09699-000; thence South 1371.85 feet more or less to a point, same being the NE corner of parcel #18-09703-001; thence West 1304.30 feet more or less to a point, same being the NW corner of parcel #18-09704-000; thence South 1431.59 feet more or less to a point, same being the SW corner of parcel #18-09763-000; thence West 1327.08 feet more or less to a point, same being the NW corner of parcel #18-09764-000; thence South 1974.45 feet more or less to a point, same being the SW corner of parcel #18-09764-002; thence East 1350.97 feet more or less to a point, same being on the N/S center section line of S20, T20N, R31W; thence South 663.89 feet more or less to a point, same being the NW corner of parcel #18-09782-000; thence East 1318.12 feet more or less to a point, same being the NE corner of parcel #18-09782-000; thence South 1326.12 feet more or less to a point, same being the NE corner of parcel #18-09951-001; thence West 207.72 feet more or less to a point, same being the NW corner of parcel #18-09951-001; thence South 210.77 feet more or less to a point, same being the SW corner of parcel #18-09951-001; thence East 208.71 feet more or less to a point, same being the SE corner of parcel #18-09951-001; thence South 1763.37 feet more or less to a point, same being the SW

FILED
2015 AUG 13 PM 3:33

TENA CARRIEN
CO. & PROBATE CLERK
BENTON COUNTY, ARK

corner of parcel #18-09955-000; thence East 1326.90 feet more or less to a point, same being the SE corner of parcel #18-09955-000 and the point of beginning; AND all contiguous and adjacent platted and prescriptive road rights-of-ways. SAME BEING all of the following Benton County parcels: #18-09955-000; #18-09950-003; #18-09951-001; #18-09783-004; #18-09780-000; #18-09779-000; #18-09778-000; #18-09764-000; #18-09764-002; #18-09764-001; #18-09763-000; #18-09763-001; #18-09704-000; #18-09703-001; #18-09699-000; and #18-09758-000; AND all contiguous and adjacent platted and prescriptive road rights-of-ways.

Layman Description: 336.857 Acres located west of Gamble/Walters Road and south of W Hwy 72 to Cutberth Road including adjacent prescriptive ROW on Walters and Herbaugh Road.

Section 2: A map of said described lands are attached and made a part of this ordinance as Exhibit "A".

Section 3: That the above described territory shall be annexed to and made a part of Ward 1 of the City of Centerton, and the same shall henceforth be a part of said ward as fully as existing parts of said ward.

Section 4: That the above-described property is hereby zoned as Agricultural (A-1).

Section 5: The City Council of the City of Centerton, Arkansas, has determined that an emergency is hereby found to exist in order to avoid delay in zoning and development. Therefore, this Ordinance shall be in full force and effect from and after its passage, approval and publication.

PASSED AND APPROVED this 11th day of August, 2015.

APPROVED:



BILL EDWARDS, Mayor

ATTEST:



TODD WRIGHT, City Clerk

2015 2210

Arkansas
Secretary of State

TERA DUBOIS
CO. & PROBATE CLERK
BENTON COUNTY, ARK
EXHIBIT A

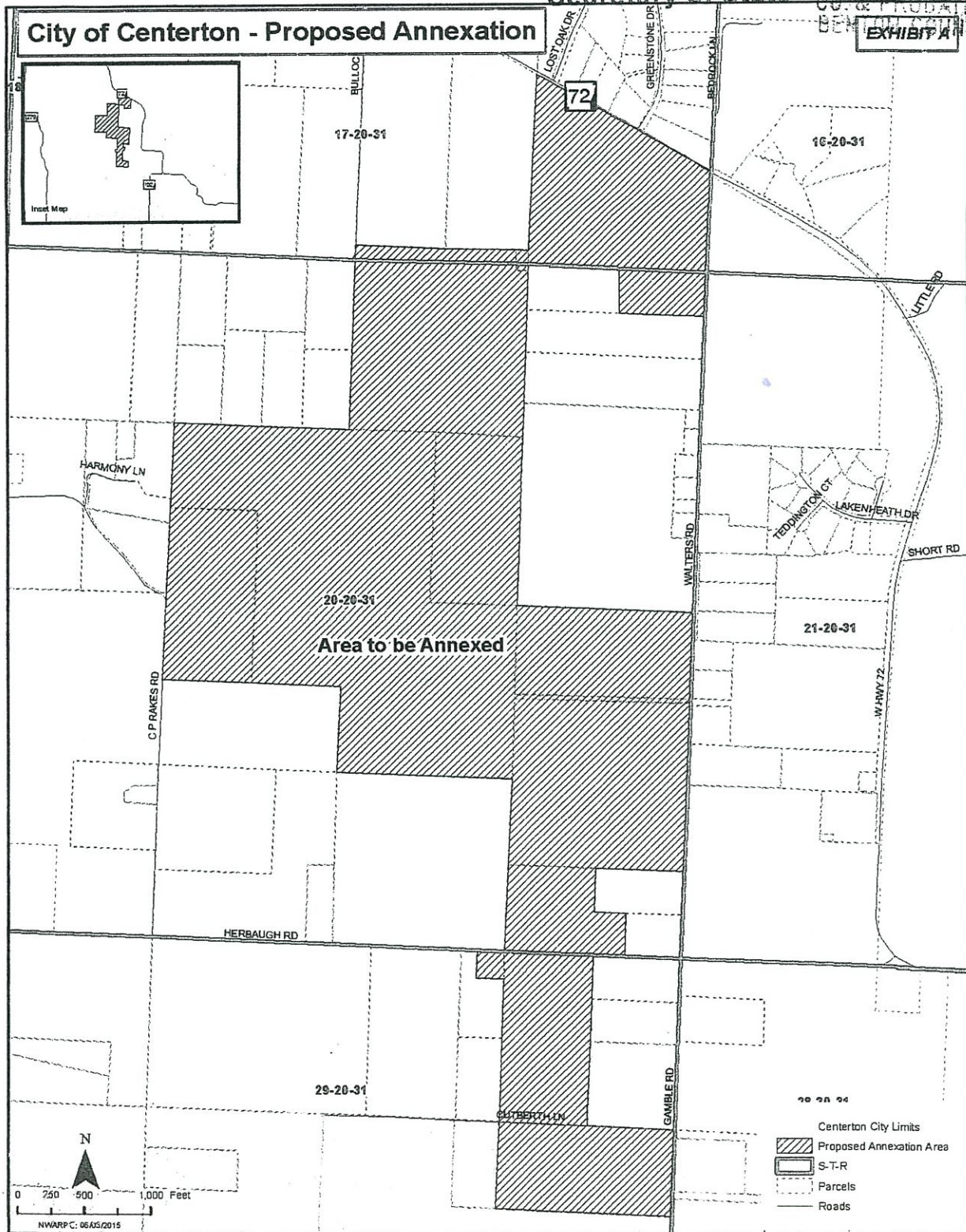

2015 JUL -1 PM 1:47

TERRY BURNIER
CLERK & DEPUTY CLERK
BENTON COUNTY, ARK

IN THE COUNTY COURT OF BENTON COUNTY, ARKANSAS

IN THE MATTER OF ANNEXING TO
THE CITY OF CENTERTON, ARKANSAS
CERTAIN PROPERTY CONTIGUOUS TO
SAID TOWN OF BENTON COUNTY,
ARKANSAS

CASE NO. CC 2015-02

Edith Lucille Elsea; Don Ternyila, Bill Ternyila, and Kandis Keyes;
Big Sky LLC and the Coughlin Family Revocable
Living Trust u/t/d November 25, 1991, City of Centerton

Petitioners

FILED

AUG 17 2015

Arkansas
Secretary of State

DECREE OF ANNEXATION

On this 15th day of July, 2015, a day of the regular term of the
County Court of Benton County, Arkansas, there is presented to the court by the
petitioners, a Petition for annexation of certain territory, hereinafter more particularly
described, to the City of Centerton, Arkansas, and the court being fully advised of the
facts and the law, doth hereby find, judge and decree as follows:

1. The Court finds that the Petition for Annexation was filed in the office of the Clerk of this Court more than thirty (30) days prior to this date.
2. The Court doth find that a majority of the total number of real estate owners in the area affected by the Petition has signed said Petition and that such majority owns more than one-half of the acreage affected.
3. The Court further finds that the territory sought to be annexed was accurately described in said Petition, or as amended, and that said territory is contiguous to the boundaries of the City of Centerton, Arkansas.
4. The Court further finds that attached to and made a part of said Petition is an accurate map of the territory sought to be annexed to the City of Centerton, Arkansas.
5. The Court further finds that the prayer of the Petition is right and proper.

WHEREFORE, THE COURT DOTH HEREBY ORDER, JUDGE AND
DECREE that the following described territory be and the same is hereby annexed
and made a part of the City of Centerton, Arkansas, to-wit:

FILED

2015 JUL -1 PM 1:47

See attached "Exhibit #1"

TERA BROWN
CO. & FINANCE CLERK
BENTON COUNTY, ARK

THE COURT DOTH FURTHER ORDER that this Order be delivered to the County Clerk for the same to be properly recorded upon the records of Benton County, Arkansas, and the Clerk, after properly recording and filing the same, prepare transcripts and deliver one of the certified transcripts to the City of Centerton, Arkansas, one copy to the Secretary of State, and one copy to the Director of the Tax Division of the Arkansas Public Service Commission.

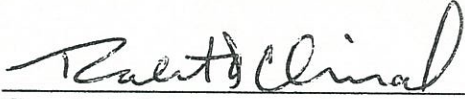

County Judge

2015 1693

"Exhibit 1"

Page 1 of 2
2015 JUL -1 PM 1:47

Big Sky Annexation Description

JEFF BIRNEN
CO. & PROBATE CLERK
BENTON COUNTY, ARK

Beginning at a point on the Centerton city limit line at the SE corner of the North half of the SE ¼ NE ¼ of S29, T20N, R31W, same point being the SE corner of Benton County parcel #18-09955-000; thence north 665.23 feet more or less, to the NE corner of the SE ¼ NE ¼ of said S29, same point being the NE corner of said parcel; thence West 664.06 feet more or less to a point, same being the SE corner of parcel #18-09950-003; thence North 1305.77 feet more or less to a point, same being the NE corner of parcel #18-09950-003; thence East 235.02 feet more or less to a point, same being the SE corner of parcel #18-09783-004; thence North 333.38 feet more or less to a point, same being the NW corner of parcel #18-09783-000; thence West 236.92 feet more or less to a point, same being the SW corner of parcel #18-09783-005; thence North 331.79 feet more or less to a point, same being the NW corner of parcel #18-09783-005; thence East 672.61 feet more or less to a point, same being the SE corner of parcel #18-09780-000; thence North 1990.53 feet more or less to a point, same being the NE corner of parcel #18-09778-000; thence West 1329.45 feet more or less to a point, same being the SE corner of parcel #18-09764-001; thence North 2635.30 feet more or less to a point, same being the SW corner of parcel #18-09699-000; thence East 681.67 feet more or less to a point, same being the NW corner of parcel #18-09758-000; thence South 344.16 feet more or less to a point, same being the SW corner of parcel #18-09758-000; thence East 650.33 feet more or less to a point, same being the SE corner of parcel #18-09758-000; thence North 340.30 feet more or less to the SE corner of S17, T20N, R31W, same being the NE corner of parcel #18-09758-000; thence North 795.75 feet more or less to a point, same being the NE corner of parcel #18-09699-000; thence Northwesterly 1512.81 feet more or less to a point, same being the NW corner of parcel #18-09699-000; thence South 1371.85 feet more or less to a point, same being the NE corner of parcel #18-09703-001; thence West 1304.30 feet more or less to a point, same being the NW corner of parcel #18-09704-000; thence South 1431.59 feet more or less to a point, same being the SW corner of parcel #18-09763-000; thence West 1327.08 feet more or less to a point, same being the NW corner of parcel #18-09764-000; thence South 1974.45 feet more or less to a point, same being the SW corner of parcel #18-09764-002; thence East 1350.97 feet more or less to a point, same being on the N/S center section line of S20, T20N, R31W; thence South 663.89 feet more or less to a point, same being the NW corner of parcel #18-09782-000; thence East 1318.12 feet more or less to a point, same being the NE corner of parcel #18-09782-000; thence South 1326.12 feet more or less to a point, same being the NE corner of parcel #18-09951-001; thence West 207.72 feet more or less to a point, same being the NW corner of parcel #18-09951-001; thence South 210.77 feet more or less to a point, same being the SW corner of parcel #18-09951-001; thence East 208.71 feet more or less to a point, same being the SE corner of parcel #18-09951-001; thence South 1763.37 feet more or less to a point, same being the SW corner of parcel #18-09955-000; thence East 1326.90 feet more or less to a point, same being the SE corner of parcel #18-09955-000 and the point of beginning; AND all contiguous and adjacent platted and prescriptive road rights-of-ways. SAME BEING all of the following Benton County parcels: #18-09955-000; #18-09950-003; #18-09951-001; #18-09783-004; #18-09780-000; #18-09779-000; #18-09778-000; #18-09764-000; #18-09764-002;

2015 1694

ENC

"Exhibit 1"

Page 2 of 2

#18-09764-001; #18-09763-000; #18-09763-001; #18-09704-000; #18-09703-001; #18-09699-000; and #18-09758-000; AND all contiguous and adjacent platted and prescriptive road rights-of-ways.

FILED
2015 JUL -1 PM 1:47
TALLAHASSEE
CO. & PROBATE CLERK
DENISE DEBARTY, RMC

RMC

City of Centerton - Proposed Annexation

EXHIBIT A

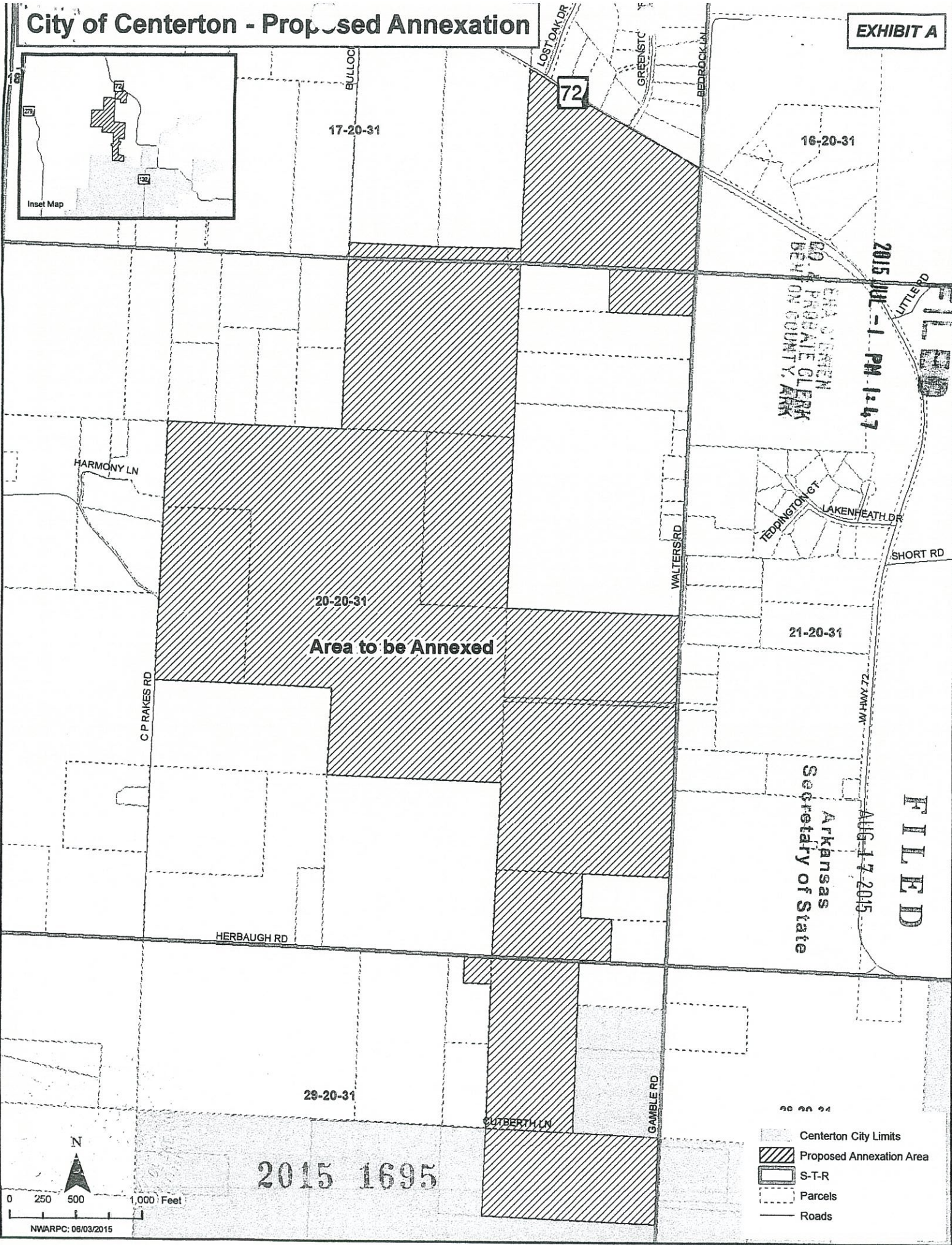
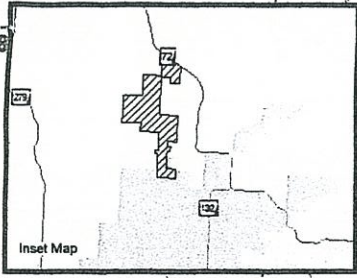

2015 JUL -1 PM 1:47
BNA SYSTEMS
BO. J. PARRALE GLENN
BEIT ON COUNTY, ARK

2015 JUL -1 PM 1:47
AUG 17 2015
Arkansas
Secretary of State

FILED

2015 1695

- Centerton City Limits
- Proposed Annexation Area
- S-T-R
- Parcels
- Roads

