



JOHN THURSTON

ARKANSAS SECRETARY OF STATE

February 23, 2021

The Hon. Margaret Darter
Faulkner County Clerk
801 Locust St.
Conway, AR 72034

Re: City of Conway Annexation Ordinance O-20-59

Dear Ms. Darter,

This letter acknowledges receipt and filing of the following notice of municipal boundary change by the Office of the Arkansas Secretary of State:

Filing Type: Annexation pursuant to A.C.A §14-40-609 (petition of all landowners)

Effective Date: 10/13/2020

County: Faulkner

City Ordinance: O-20-59

County Court Order: CC-20-06

City: Conway

Dated: 10/13/2020

Date Filed: 8/25/2020

A file marked copy of the ordinance, court order and exhibits submitted to our Office are enclosed. By copy of this letter (and its enclosures), the Secretary of State hereby notifies the appropriate mapping authorities for Arkansas. Please retain these copies as official record of the filing of the municipal change by the Arkansas Secretary of State.

If you have any questions or concerns regarding this filing, please do not hesitate to contact our Office at 501-683-3717.

Sincerely,

Shantell McGraw
Elections Division

cc: Arkansas Geographic Information Systems Office (w/encl)
Arkansas Department of Transportation Mapping Department (w/encl)
Department of Finance and Administration (w/encl)
Arkansas Public Service Commission (w/encl)
Arkansas Economic Development Institute (w/encl)
The Hon. Bart Castleberry, Mayor of Conway (w/encl)
The Hon. Michael Garrett, Conway City Clerk (w/encl)



Arkansas Secretary of State

John Thurston Arkansas Secretary of State, 500 Woodlane Ave, Little Rock, AR 72201-1094

Municipal Boundary Change Checklist

Act 655 of 2017 and A.C.A. §14-40-103

County: Faulkner City/Town: Conway

City Ordinance/Resolution No: O-20-59 Date approved: 10/13/2020

County Court Case No: CC-20-06 Date Order Filed: 8/25/2020

Type: Annexation by Petition of all Landowners A.C.A. 14-40-609
(Choose from the list of Arkansas Code Sections located on the back)

Date Change Effective: 10/13/2020 Set by: Municipal Ordinance Emergency Clause Court Default
(Required by Act 655 of 2017)

For Circuit Court Challenge: Date Order Filed: _____ Upheld Overturned Other (attach explanation)

Please indicate which ward(s) the territory will be assigned to: Ward 2
(See A.C.A § 14-40-203)

Initiating party:

All Landowners Majority Landowners Municipal Governing Body State Other _____

Supporting Documentation attached (check all that apply):

- File marked copy of City Ordinance/Resolution (required)
- File marked copy of County Court Order or certified annexation election results (required except for A.C.A. §14-40-501)
- Copy of Arkansas GIS approved printed map and certification letter (required)
- Proof of Publication for all Legal Notices (include Hearing, Election, and City Ordinance/Resolution notices)
- File marked copy of Petition Part (if applicable)
- File marked copy of Complaint and final Circuit Court Order (Court Challenge only)

Municipal Contact:

Name: Michael Garrett Title: City Clerk

Street Address: 1111 Main Street

City: Conway St: AR Zip code: 72032

Complete one form per ordinance/resolution, attach it as a cover page to the supporting document set and submit to the County Clerk's Office within 45 days of the Effective Date as required by Act 655 of 2017

County Official:
Signature: Margaret Darter Title: County Clerk
Date: 1/19/2021

Pursuant to Act 655 of 2017, County Officials must submit a file-marked copy of municipal boundary change documents within 30 days of receipt to: Arkansas Secretary of State, Attn: Municipal Boundary Filing, 500 Woodlane Ave Suite 256, Little Rock, AR 72201-1094

Office of the Arkansas Secretary of State use only

Received by: [Signature]

FEB 23 2021

Arkansas Secretary of State

Margaret Darter
CLERK OF THE COUNTY & PROBATE COURTS
FAULKNER COUNTY

801 Locust Avenue * Conway, AR 72034
(501) 450-4909 * FAX (501) 450-4938§
Margaret.darter@faulknercounty.org

January 19, 2021

Secretary of State
Attn: Annexation
State Capitol
500 Woodlane St., Suite 256
Little Rock, AR 72201

Director Tax Division
P.O. Box 8021
Little Rock, AR 72203-8021

Re: Faulkner County Annexations CC-20-06
Annexation City of Conway

To whom it may concern:

Pursuant to A.C.A. § 14-40-605, enclosed herein are certified copies of the Orders of the Court, the Ordinances and plats of the territory annexed in Faulkner County regarding the above-referenced matter.

Sincerely,

Margaret Darter

CC: Jennifer Wheeler, GIS Office
Krissy Lewis, Assessor Office
Shelia Bellott, OEM Office

3



CERTIFICATE OF RECORD
FAULKNER CO, AR FEE \$25.00
 I hereby certify that this instrument was
 Filed and Recorded in the Official Records
 In Doc Num **L202020253** 3 Pages
 RECORDED: 11-02-2020 03:03:11 PM
 CRYSTAL TAYLOR
 FAULKNER COUNTY CIRCUIT CLERK
 BY: DIANA VARNER, D.C.
ORDINANCE

City of Conway, Arkansas
Ordinance No. O-20-59

A ORDINANCE ACCEPTING THE ANNEXATION OF CERTAIN LANDS COMPRISED OF 2 TRACTS TOTALING +/- 29.07 ACRES LOCATED EAST OF EAST GERMAN LANE, TO THE CITY OF CONWAY:

NOW, THEREFORE, BE IT ORDAINED BY THE CITY COUNCIL OF THE CITY OF CONWAY, ARKANSAS THAT:

SECTION 1.A: That the City of Conway, Arkansas, hereby accepts the hereinafter described territory, including all adjacent and abutting rights-of-way, annexed to said City by order of the County Court of Faulkner County, Arkansas heretofore entered on **October 13, 2020** and said territory being situated in Faulkner County, Arkansas, shall be a part of the City of Conway and shall be zoned **A-1**. Legal description as follows:

A PART OF THE W1/2 W1/2 SW1/4, SECTION 33, T-6-N, R-13-W, FAULKNER COUNTY, ARKANSAS BEING MORE PARTICULARLY DESCRIBED AS FOLLOWS:

BEGINNING AT A FOUND PK NAIL FOR THE SW CORNER OF SAID W1/2 W1/2 SW1/4; THENCE ALONG THE WEST LINE OF SAID W1/2 W1/2 SW1/4 N01°35'51"E A DISTANCE OF 330.86' TO A SET PK NAIL; THENCE LEAVING SAID WEST LINE S88°18'20"E A DISTANCE OF 40.00' TO A SET 1/2" REBAR W/CAP (1363) BEING ON THE PROPOSED EAST RIGHT OF WAY OF EAST GERMAN LANE; THENCE ALONG SAID PROPOSED RIGHT OF WAY THE FOLLOWING CALLS: N01°35'51"E A DISTANCE OF 1604.88'; THENCE WITH A CURVE TURNING TO THE RIGHT WITH AN ARC LENGTH OF 160.01', WITH A RADIUS OF 100.00', WITH A CHORD BEARING OF N47°26'10"E, WITH A CHORD LENGTH OF 143.48' TO A SET 1/2" REBAR W/CAP (1363) BEING ON THE PROPOSED SOUTH RIGHT OF WAY OF LOWER RIDGE ROAD; THENCE ALONG SAID PROPOSED RIGHT OF WAY S86°43'30"E A DISTANCE OF 184.40' TO A SET 1/2" REBAR W/CAP (1363); THENCE LEAVING SAID PROPOSED RIGHT OF WAY S01°41'40"W A DISTANCE OF 184.13' TO A SET 1/2" REBAR W/CAP (1363); THENCE S88°18'20"E A DISTANCE OF 17.09' TO SET 1/2" REBAR W/CAP (1363); THENCE S01°35'51"W A DISTANCE OF 1515.80' TO A SET 1/2" REBAR W/CAP (1363); THENCE S88°18'20"E A DISTANCE OF 314.24' TO A SET 1/2" REBAR W/CAP (1363) BEING ON THE EAST LINE OF SAID W1/2 W1/2 SW1/4; THENCE ALONG THE SAID EAST LINE S01°35'22"W A DISTANCE OF 330.86' TO A SET 1/2" REBAR W/CAP (1363) FOR THE SE CORNER OF SAID W1/2 W1/2 SW1/4; THENCE ALONG THE SOUTH LINE OF SAID W1/2 W1/2 SW1/4 N88°18'20"W A DISTANCE OF 658.31' TO THE POINT OF BEGINNING, CONTAINING 16.77 ACRES MORE OR LESS.

SECTION 1.B: That the City of Conway, Arkansas, hereby accepts the hereinafter described territory, including all adjacent and abutting rights-of-way, annexed to said City by order of the County Court of Faulkner County, Arkansas heretofore entered on **October 13, 2020** and said territory being situated in Faulkner County, Arkansas, shall be a part of the City of Conway and shall be zoned **R-1**. Legal description as follows:

A PART OF THE W1/2 W1/2 SW1/4, SECTION 33, T-6-N, R-13-W, FAULKNER COUNTY, ARKANSAS BEING MORE PARTICULARLY DESCRIBED AS FOLLOWS:

COMMENCING AT A FOUND PK NAIL FOR THE SW CORNER OF SAID W1/2 W1/2 SW1/4; THENCE ALONG THE SOUTH LINE OF SAID W1/2 W1/2 SW1/4 S88°18'20"E A DISTANCE OF 658.31' TO THE SE CORNER OF SAID W1/2 W1/2 SW1/4; THENCE LEAVING SAID SOUTH LINE AND ALONG THE EAST LINE OF SAID W1/2 W1/2 SW1/4 N01°35'22"E A DISTANCE OF 330.86' TO A SET 1/2" REBAR W/CAP (1363) FOR THE POINT OF

BEGINNING; THENCE LEAVING SAID EAST LINE AND PARALLEL TO THE SOUTH LINE OF SAID W1/2 W1/2 SW1/4 N88°18'20"W A DISTANCE OF 314.24' TO A SET 1/2" REBAR W/CAP (1363); THENCE LEAVING SAID PARALLEL LINE N01°35'51"E A DISTANCE OF 1515.80' TO A SET 1/2" REBAR W/CAP (1363); THENCE N88°18'20"W A DISTANCE OF 17.09' TO A SET 1/2" REBAR W/CAP (1363); THENCE N01°41'40"E A DISTANCE OF 184.13' TO A SET 1/2" REBAR W/CAP (1363) BEING ON THE PROPOSED SOUTH RIGHT OF WAY OF LOWER RIDGE ROAD; THENCE ALONG SAID PROPOSED RIGHT OF WAY S86°43'30"E A DISTANCE OF 330.92' TO A SET 1/2" REBAR W/CAP (1363) BEING ON THE EAST LINE OF SAID W1/2 W1/2 SW1/4; THENCE ALONG SAID EAST LINE S01°35'22"W A DISTANCE OF 1690.80' TO THE POINT OF BEGINNING, CONTAINING 12.30 ACRES MORE OR LESS.

And that the above described lands and territory be, and the same hereby are, declared to be a part of the City of Conway, Faulkner County, Arkansas.

SECTION 2: From and after this date, all inhabitants residing within and upon the hereinabove described lands and territory shall have and enjoy all the rights and privileges of, and be subject to all the laws, rules, ordinances, limitations and regulations imposed upon the inhabitants within the original limits of said City of Conway, Arkansas, and for voting purposes, said lands are hereby assigned to and designated as part of **Ward 2** of the City of Conway, Arkansas.

SECTION 3: It is hereby declared the annexed land shall be provided the following services immediately upon the effective date of this annexation: police protection; fire protection; maintenance of any publicly dedicated streets within the property; and opportunity to connect to potable water, sanitary sewer, electric, and telecommunications services provided by Conway Corporation at the expense of the property owner.

PASSED this 13th day of October, 2020.

APPROVED:

Mayor Bart Castleberry

ATTEST:

Michael O. Garrett
City Clerk/Treasurer

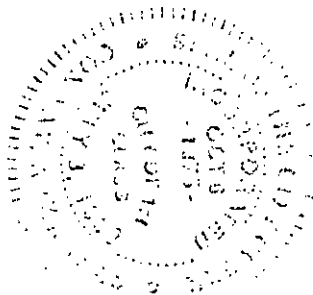

FILED
TIME: 1:24

AUG 25 2020

IN THE COUNTY COURT OF FAULKNER COUNTY, ARKANSAS

Harold Halter Crafton, Trustee of Crafton Lee Fowler Irrevocable Trust, Petitioners *Amie* DC

MARGARET DARTER
FAULKNER COUNTY CLERK

CC-20-06

ORDER

Comes now before the Court the above-styled case, and after having been presented the facts and circumstances, and having considered the relevant laws, this Court finds and orders the following:

1. A petition of annexation was filed August 24, 2020.
2. All appropriate signatures were affixed to the Petition, as required by A.C.A. 14-40-609.
3. The proposed site to be annexed was adequately described and further displayed a map of the proposed site.
4. The appropriate documentation was provided under A.C.A. 14-40-609.
5. Based on the above premises, the Petitioner's prayer is right and proper.

WHEREFORE, this Court finds that the area described in Exhibit A should be, and hereby is, released for annexation into the City of Conway:

IT IS SO ORDERED.

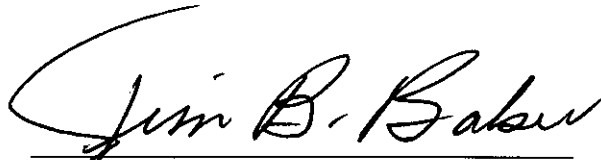

HON. JIM B. BAKER
Faulkner County Judge

Dated 8-25-2020

We verify that the above referenced Petition complies with A.C.A. 14-40-609.



Margaret Darter, Clerk

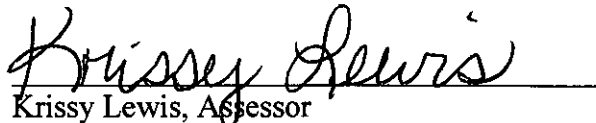

Krissy Lewis, Assessor

Exhibit A

LEGAL DESCRIPTION:

A PART OF THE W1/2 W1/2 SW1/4, SECTION 33, T-6-N, R-13-W, FAULKNER COUNTY, ARKANSAS
BEING MORE PARTICULARLY DESCRIBED AS FOLLOWS:

BEGINNING AT A FOUND PK NAIL FOR THE SW CORNER OF SAID W1/2 W1/2 SW1/4; THENCE ALONG
THE WEST LINE OF SAID W1/2 W1/2 SW1/4 N01°35'51"E A DISTANCE OF 330.86' TO A SET PK NAIL;
THENCE LEAVING SAID WEST LINE S88°18'20"E A DISTANCE OF 40.00' TO A SET 1/2" REBAR W/CAP
(1363) BEING ON THE PROPOSED EAST RIGHT OF WAY OF EAST GERMAN LANE; THENCE ALONG
SAID RIGHT OF WAY N01°35'51"E A DISTANCE OF 1604.88' TO A SET 1/2" REBAR W/CAP (1363);
THENCE WITH A CURVE TURNING TO THE RIGHT WITH AN ARC LENGTH OF 160.01', WITH A
RADIUS OF 100.00', WITH A CHORD BEARING OF N47°26'10"E, WITH A CHORD LENGTH OF 143.48' TO
A SET 1/2" REBAR W/CAP (1363) BEING ON THE PROPOSED SOUTH RIGHT OF WAY OF LOWER
RIDGE ROAD; THENCE ALONG SAID RIGHT OF WAY S86°43'30"E A DISTANCE OF 515.32' TO A SET
1/2" REBAR W/CAP (1363) BEING ON THE EAST LINE OF SAID W1/2 W1/2 SW1/4; THENCE LEAVING
SAID RIGHT OF WAY AND ALONG SAID EAST LINE S01°35'22"W A DISTANCE OF 2021.66' TO A SET
1/2" REBAR W/CAP (1363) BEING ON THE SOUTH LINE OF SAID W1/2 W1/2 SW1/4; THENCE ALONG
SAID SOUTH LINE N88°18'20"W A DISTANCE OF 658.31' TO THE POINT OF BEGINNING, CONTAINING
29.06 ACRES MORE OR LESS.

FILED

AUG 24 2020

IN THE COUNTY COURT OF FAULKNER COUNTY, ARKANSAS

MARGARET DARTER
FAULKNER COUNTY CLERK

BY S. Haile DC

Harold Halter Crafton, Trustee of the Crafton Lee Flower Irrevocable Trust, PETITIONERS

NO. CC-20-06

PETITION FOR ANNEXATION

Harold Halter Crafton, Trustee of the Crafton Lee Fowler Irrevocable Trust, for their petition for the annexation of certain lands unto the City of Conway, Arkansas, state:

1. Petitioners are the owners of the following described lands in Faulkner County, Arkansas:

Legal Description: See Exhibit B

2. Said lands are contiguous to and adjoin lands which are within the city limits of the City of Conway, Arkansas; said lands are adaptable for residential and other appropriate purposes; an accurate map of said lands is attached to this petition; the limits of territory to be annexed have been accurately described herein; all other requirements of the law for the annexation of said lands unto the City of Conway, Arkansas, have been met; and said lands should be annexed unto the City of Conway, Arkansas, and become a part thereof.

WHEREFORE, Petitioners pray that this Court enter its order abandoning unto the City of Conway Arkansas, for annexation, the aforesaid lands.

By: Halter Trustee

Date: 8-21-20

By: _____

Date: _____

State of Arkansas, County of Faulkner

Subscribed and sworn to before me on this 24th day of AUGUST 2020
by the petitioners listed above.

Signature of Notary Public Starla Wood

My Commission Expires: 12/01-2025



FILED

AUG 24 2020

Exhibit A

MARGARET DARTER
FAULKNER COUNTY CLERK
By S. Haile DC

Annexation Petition for The Crafton L Fowler Irrevocable Trust

Schedule of Services to be extended to the property:

1. Police and Fire protection.
2. Electric power service by Conway Corp.
3. Telecommunications service by Conway Corp.
4. Natural gas service provided by Centerpoint Energy.
5. Maintenance of water line conduit and appurtenances provided at petitioner's expense and dedicated to Conway Corp.
6. Maintenance of street and drainage improvements provided at petitioner's expense and dedicated to the City of Conway.
7. Garbage collection service provided by City of Conway Sanitation.

County Court Case No: _____

Petitioner's Signature

Hal Crafton Trustee

Hal Crafton, Trustee of the Crafton L Fowler Irrevocable Trust

EXHIBIT "B"

LEGAL DESCRIPTION:

A PART OF THE W1/2 W1/2 SW1/4, SECTION 33, T-6-N, R-13-W. FAULKNER COUNTY, ARKANSAS
BEING MORE PARTICULARLY DESCRIBED AS FOLLOWS:

BEGINNING AT A FOUND PK NAIL FOR THE SW CORNER OF SAID W1/2 W1/2 SW1/4; THENCE ALONG THE WEST LINE OF SAID W1/2 W1/2 SW1/4 N01°35'51"E A DISTANCE OF 330.86' TO A SET PK NAIL; THENCE LEAVING SAID WEST LINE S88°18'20"E A DISTANCE OF 40.00' TO A SET 1/2" REBAR W/CAP (1363) BEING ON THE PROPOSED EAST RIGHT OF WAY OF EAST GERMAN LANE; THENCE ALONG SAID RIGHT OF WAY N01°35'51"E A DISTANCE OF 1604.88' TO A SET 1/2" REBAR W/CAP (1363); THENCE WITH A CURVE TURNING TO THE RIGHT WITH AN ARC LENGTH OF 160.01', WITH A RADIUS OF 100.00', WITH A CHORD BEARING OF N47°26'10"E, WITH A CHORD LENGTH OF 143.48' TO A SET 1/2" REBAR W/CAP (1363) BEING ON THE PROPOSED SOUTH RIGHT OF WAY OF LOWER RIDGE ROAD; THENCE ALONG SAID RIGHT OF WAY S86°43'30"E A DISTANCE OF 515.32' TO A SET 1/2" REBAR W/CAP (1363) BEING ON THE EAST LINE OF SAID W1/2 W1/2 SW1/4; THENCE LEAVING SAID RIGHT OF WAY AND ALONG SAID EAST LINE S01°35'22"W A DISTANCE OF 2021.66' TO A SET 1/2" REBAR W/CAP (1363) BEING ON THE SOUTH LINE OF SAID W1/2 W1/2 SW1/4; THENCE ALONG SAID SOUTH LINE N88°18'20"W A DISTANCE OF 658.31' TO THE POINT OF BEGINNING, CONTAINING 29.06 ACRES MORE OR LESS.

Clerk's Certificate

STATE OF ARKANSAS
COUNTY OF FAULKNER

I, Margaret Darter, County Clerk of Faulkner County, Arkansas, do hereby certify that the foregoing pleadings are a true and correct copy of the original documents filed in my case in Case Number CC-20-06

Witness my hand and seal as such Clerk on this 19th day of January, 2021.

MARGARET DARTER
FAULKNER COUNTY CLERK

By Stephanie Haile D.C.

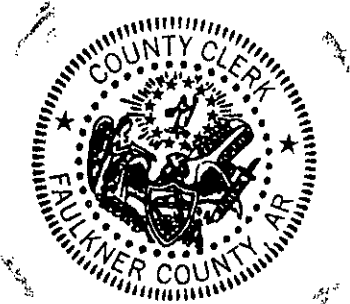

(Seal)



**ARKANSAS
GIS OFFICE**

Department of Transformation
and Shared Services
Governor Asa Hutchinson
Secretary Amy Fecher
Director Shelby Johnson

August 18, 2020

Ms. Starla Wood
C.A.P.S., LLC
1021 Front Street
Conway, AR 72032

RE: City of Conway Annexation Coordination Requirement

FILED

AUG 24 2020

MARGARET DARTER
FAULKNER COUNTY CLERK
BY S. Haile DC

Ms. Wood,

Thank you for coordinating with our office as you seek to annex property into the City of Conway, AR located in Section 33, Township 6 North, Range 13 West. This letter represents confirmation that you have properly coordinated with our office (Arkansas GIS Office) as specified in § 14-40-101 (Act 914 of 2015) of the 90th General Assembly.

Our office will wait completion of any additional steps necessary for the proposed boundary change, which normally comes from the Arkansas Secretary of State Elections Division after any appropriate filing by your County Clerk.

Thank you,

Jennifer Wheeler, GIS Analyst

Attachments:
GIS Office Map of Proposed Annexation
Legal Description
Secretary of State Municipal Change Checklist

H:\City_Annexations\Cities\Conway\20200817\Doc\20200817_Conway_Annexation_Coordination_Letter.docx



FILED

Proposed Annex: City of Conway
August 2020

AUG 24 2020

MARGARET DARTER
FAULKNER COUNTY CLERK
BY *S. Hilde*

City: Conway
Mayor: Bart Castlebar

Arkansas Code 14-10-101.

Before an entity undertakes annexation, consolidation, detachment, proceeding under chapter, the entity shall coordinate the Arkansas Geographic Information Systems Office for preparation of a description and digital mapping of the relevant annexation, consolidation, detachment areas.

The map contained herein, is evidence the only has met requirements of 914 of 2015

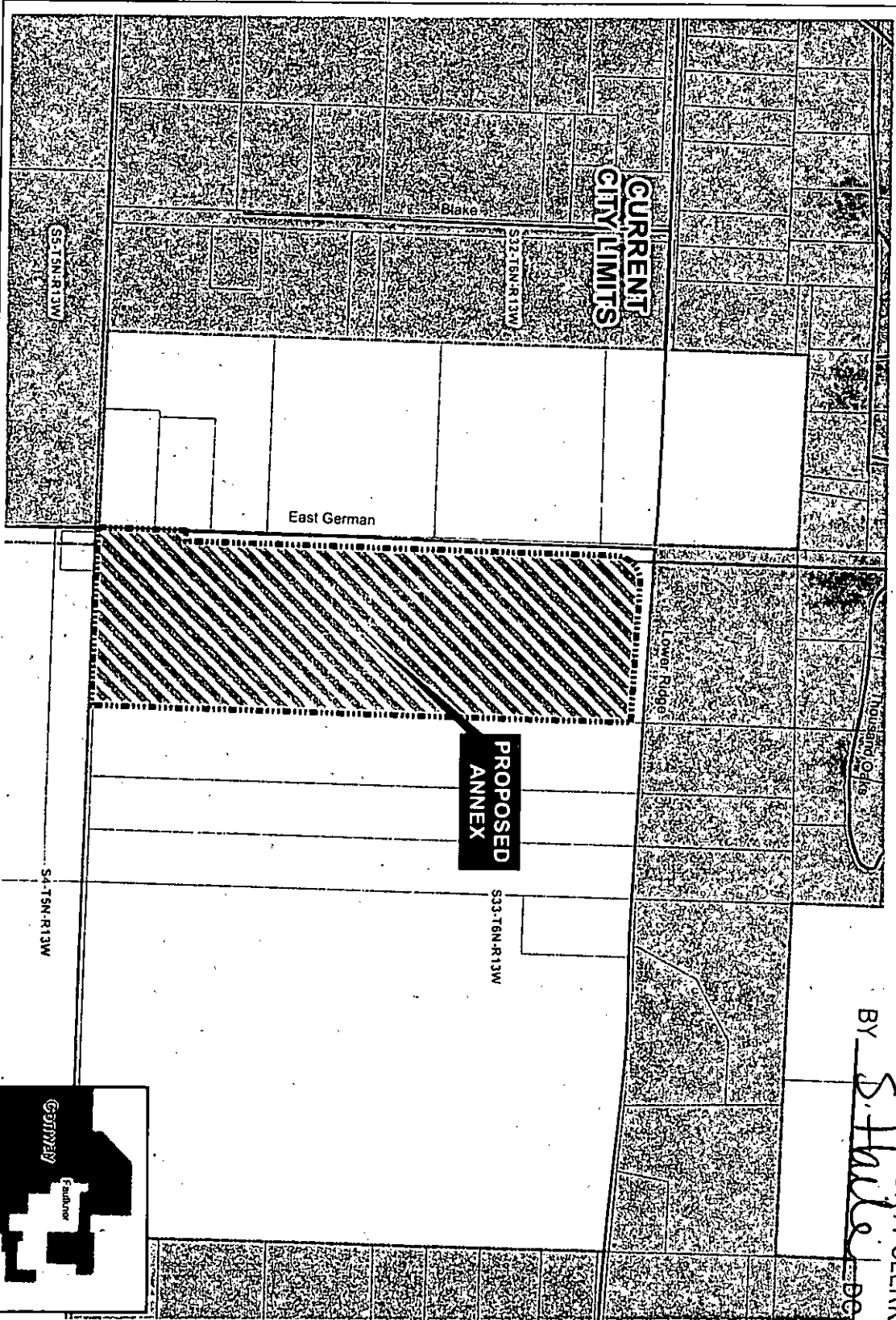

- Proposed Annex
- Existing City
- Major Road
- Highway
- Private
- Setback

0 0.0228 0.045 0.09
Miles



H:\City_Annotations\CityOfConway\20200811