



ARKANSAS SECRETARY OF STATE

MARK MARTIN

March 3, 2016

The Honorable Deborah Akin
Sevier County Clerk
115 North 3rd Street
De Queen, AR 71832

RE: Annexation

Dear Ms. Akin,

The following information was received and has been recorded and filed in the office of the Secretary of State:

County: Sevier City: De Queen

Annexation: Ordinance No. 1017 – February 16, 2016
County Court Decree 2016-017 – January 12, 2016
Plat of annexed area

By copy of this letter, I am sending file marked copies of all of the information to the UALR Institute for Economic Advancement, Arkansas Highway Mapping Department, TomTom, and the State Geographic Information Office. All others listed will only receive notification of the annexation by copy of this letter.

If you have any questions please do not hesitate to contact me at 1-800-482-1127.

Sincerely,

A handwritten signature in black ink, appearing to read "Peyton Murphy".

Peyton Murphy
Elections Attorney
Arkansas Secretary of State

cc: UALR Institute for Economic Advancement (w/encl)
Arkansas Highway Mapping Department (w/encl)
TomTom (w/encl)
Shelby Johnson, State Geographic Information Officer GIS (w/encl)
Arkansas Municipal League (w/o encl)
De Queen City Clerk (w/o encl)



ORDINANCE NO. 1017

AN ORDINANCE ACCEPTING THE ANNEXATION OF CERTAIN TERRITORY TO THE CITY OF De QUEEN, ARKANSAS, AND MAKING SAME A PART OF THE CITY OF DE QUEEN, AND ASSIGNING SAME TO WARDS.

WHEREAS, a Petition was filed with the County Clerk of Sevier County, Arkansas, by the sole real estate owner of the hereinafter described territory praying that said territory be annexed to, and made a part of the City of De Queen, Arkansas; and,

WHEREAS, on the 12th day of January, 2016, the County Court of Sevier County, Arkansas, found that the Petition was signed by the sole real estate owners in said territory; that said territory was contiguous and adjoining the present corporate limits of the City of De Queen, Arkansas; that an accurate plat or map of said territory had been filed with and made a part of said Petition; that proper notice had been given for the time and in the manner prescribed by law, and that all things pertaining thereto had been done in the manner prescribed by law, and that said lands and territory should be annexed to and made a part of the City of De Queen, Arkansas, subject to the acceptance of same by the City Council of De Queen at the proper time, as provided by law; and

WHEREAS, the time fixed by law for appealing from said order of annexation made by the County Court has expired and no appeal has been taken from said Order. Now, therefore, be it ordained by the City Council of the City of De Queen, Arkansas:

Section 1. That the following described lands and territory contiguous and adjoining the City of De Queen, Arkansas, be and the same is hereby accepted as part of and annexed to and made part of the City of De Queen, Arkansas:

A PART OF THE E½ OF THE SW¼ OF THE SW¼ OF SECTION 21, TOWNSHIP 8 SOUTH, RANGE 31 WEST, SEVIER COUNTY, ARKANSAS, BEING MORE PARTICULARLY DESCRIBED AS FOLLOWS: BEGINNING AT THE SE CORNER OF THE E½ SW¼ SW¼ OF SAID SECTION 21; THENCE S89°51'43"W 659.17 FEET TO THE SW CORNER OF SAID E½ SW¼ SW¼; THENCE N0°07'18"W 792.64 FEET ALONG THE WEST LINE OF SAID E½; THENCE N89°51'43"E 659.76 FEET TO THE EAST LINE OF SAID E½; THENCE S0°04'45"E 792.64 FEET ALONG SAID EAST LINE TO THE POINT OF BEGINNING.

SUBJECT TO A 20 FOOT WIDE ACCESS EASEMENT DESCRIBED AS 20 FEET OF EQUAL AND UNIFORM

State of Arkansas, County of Sevier
I hereby certify this to be a true copy of the original
Ordinance filed in the County
Court of Sevier County on Feb 26 2016
Deborah K. Akin
County Clerk

SEVIER COUNTY, ARK.
FILED
ON THIS 26th DAY OF Feb 2016
Deborah K. Akin CLERK



WIDTH PARALLEL WITH AND ADJACENT TO THE WEST LINE OF THE ABOVE DESCRIBED TRACT AND BEGINNING 319.90 FEET N0°17'18"W FROM THE SOUTHWEST CORNER OF THE E½ SW¼ SW¼ OF SAID SECTION 21.

Section 2. That the above described territory shall be annexed to and made part of Ward Three (3) of the City of De Queen, and the same shall henceforth be a part of said ward as fully as existing parts of said ward.

Section 3. That the services listed in the schedule of services contained in the Petition shall be extended to the annexed area within three (3) years after the date the annexation becomes final. The scheduled services contained in the petition are:

1. Sewage service.
2. Police protection
3. Fire protection
4. Sanitation (trash service)

The schedule of services shall be included in the annual written report required by ACA 14-40-2201 and 14-40-2202.

Passed and approved this 16th day of February, 2016

Approved By: Billy Ray McKelvy
Billy Ray McKelvy, Mayor

Attest:

Donna Jones
Donna Jones, CMC, CAMC
City Clerk/Treasurer

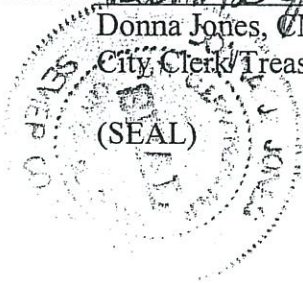

CLERK'S CERTIFICATE

I, DONNA JONES, City Clerk of the City of De Queen, Sevier County, Arkansas, the duly elected and serving custodian of the official records of the City, hereby certify that the above and foregoing Ordinance Number 1017 was passed and adopted by the City Council of the City of De Queen, Arkansas on the 16th day of February, 2016 in regular session assembled, at which meeting a quorum, as required by law, was present and voting thereon.

WITNESS my hand and the Seal of the City of De Queen, Arkansas this 16th day of February, 2016.



Donna Jones, OMC, CAMC
City Clerk/Treasurer

(SEAL)

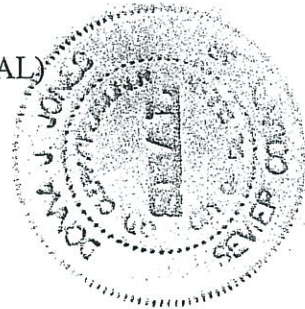

IN THE COUNTY COURT OF SEVIER COUNTY, ARKANSAS IN THE MATTER OF ANNEXING TO THE CITY OF De QUEEN, ARKANSAS, CERTAIN TERRITORY CONTIGUOUS TO THE SAID CITY OF De QUEEN, ARKANSAS.

DECREE OF ANNEXATION

On this regular day of a regular term of the County Court of Sevier County, Arkansas, there is presented to the Court by Kenneth W. "Bud" Gentry Jr., agent of the Petitioners K & J Rental, LLC, a Petition for annexation of certain territory, hereinafter more particularly described, to the City of De Queen, Arkansas, and the Court being fully advised of the facts and the law, does hereby find, judge and decree as follows:

The Court finds that the Petition was filed more than thirty (30) days prior to this date and that in said Petition the said Kenneth W. "Bud" Gentry Jr. was selected by the Petitioners to act on their behalf in filing and presenting the Petition.

The Court further finds that notice of the hearing on this matter was published one (1) time a week for three (3) consecutive weeks as required by ACA 14-40-602.

The Court finds that the sole of real estate owners in the area affected by this Petition have signed said Petition and that such majority owns more than one-half of the acreage affected.

The Court further finds that the territory consists of lands that:

1. Are needed for any proper municipal purposes such as for the extension of needed police regulation; or
2. Are valuable by reason of their adaptability for prospective municipal uses.

The Court further finds that the territory sought to be annexed was accurately described in said Petition and that said territory is contiguous to the boundaries of the City of De Queen, Arkansas.

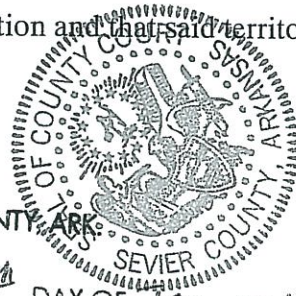

SEVIER COUNTY ARK
FILED
ON THIS 12th DAY OF Jan 2016
Deborah K. Akin CLERK

State of Arkansas, County of Sevier
I hereby certify this to be a true copy of the original
Decree filed in the County
Court of Sevier County on Jan 12th 2016
Deborah K. Akin
County Clerk

Recorded
Book 41 Pages 218-221

Decree of Annexation

The Court further finds that attached to and made a part of said Petition is an accurate map of the territory sought to be annexed to the City of De Queen.

The Court further finds that the prayer of the Petition is right and proper.

Therefore, the Court hereby ORDERS, JUDGES and DECREES that the following described territory be and the same is hereby annexed to and made a part of the City of De Queen, Arkansas, to-wit:

A PART OF THE E $\frac{1}{2}$ OF THE SW $\frac{1}{4}$ OF THE SW $\frac{1}{4}$ OF SECTION 21, TOWNSHIP 8 SOUTH, RANGE 31 WEST, SEVIER COUNTY, ARKANSAS, BEING MORE PARTICULARLY DESCRIBED AS FOLLOWS: BEGINNING AT THE SE CORNER OF THE E $\frac{1}{2}$ SW $\frac{1}{4}$ SW $\frac{1}{4}$ OF SAID SECTION 21; THENCE S89°51'43"W 659.17 FEET TO THE SW CORNER OF SAID E $\frac{1}{2}$ SW $\frac{1}{4}$ SW $\frac{1}{4}$; THENCE N0°07'18"W 792.64 FEET ALONG THE WEST LINE OF SAID E $\frac{1}{2}$; THENCE N89°51'43"E 659.76 FEET TO THE EAST LINE OF SAID E $\frac{1}{2}$; THENCE S0°04'45"E 792.64 FEET ALONG SAID EAST LINE TO THE POINT OF BEGINNING.

SUBJECT TO A 20 FOOT WIDE ACCESS EASEMENT DESCRIBED AS 20 FEET OF EQUAL AND UNIFORM WIDTH PARALLEL WITH AND ADJACENT TO THE WEST LINE OF THE ABOVE DESCRIBED TRACT AND BEGINNING 319.90 FEET N0°17'18"W FROM THE SOUTHWEST CORNER OF THE E $\frac{1}{2}$ SW $\frac{1}{4}$ SW $\frac{1}{4}$ OF SAID SECTION 21.

The Court further orders that the original papers in this cause be delivered to the Clerk of Sevier County, Arkansas, same to be properly recorded upon the records of Sevier County, Arkansas, and the Clerk, after properly recording and filing the original papers, prepare

Decree of Annexation

transcripts of same; that one of the certified transcripts be delivered to the City of De Queen, Arkansas, one copy to the Secretary of State and one copy to the Director of the Tax Division of the Arkansas Public Service Commission.



Greg Ray, County Judge

Dated: 1-12-2016

Attest: Deborah K. Akin
Deborah K. Akin, County Clerk

Proposed Annex: City of De Queen
January 2016

City: De Queen
Mayor: Billy Ray McKelvy
City Clerk: Donna J.

Arkansas Code 14-40-101.

Before an entity undertakes an annexation, consolidation, or detachment, proceeding under this chapter, the entity shall coordinate with the Arkansas Geographic Information Systems Office for preparation of legal descriptions and digital mapping for the relevant annexation, consolidation, and detachment areas.

The map contained herein, is evidence, the entity has met requirements of Act 914 of 2015

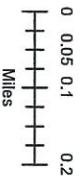
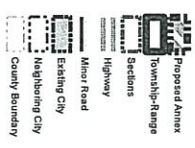
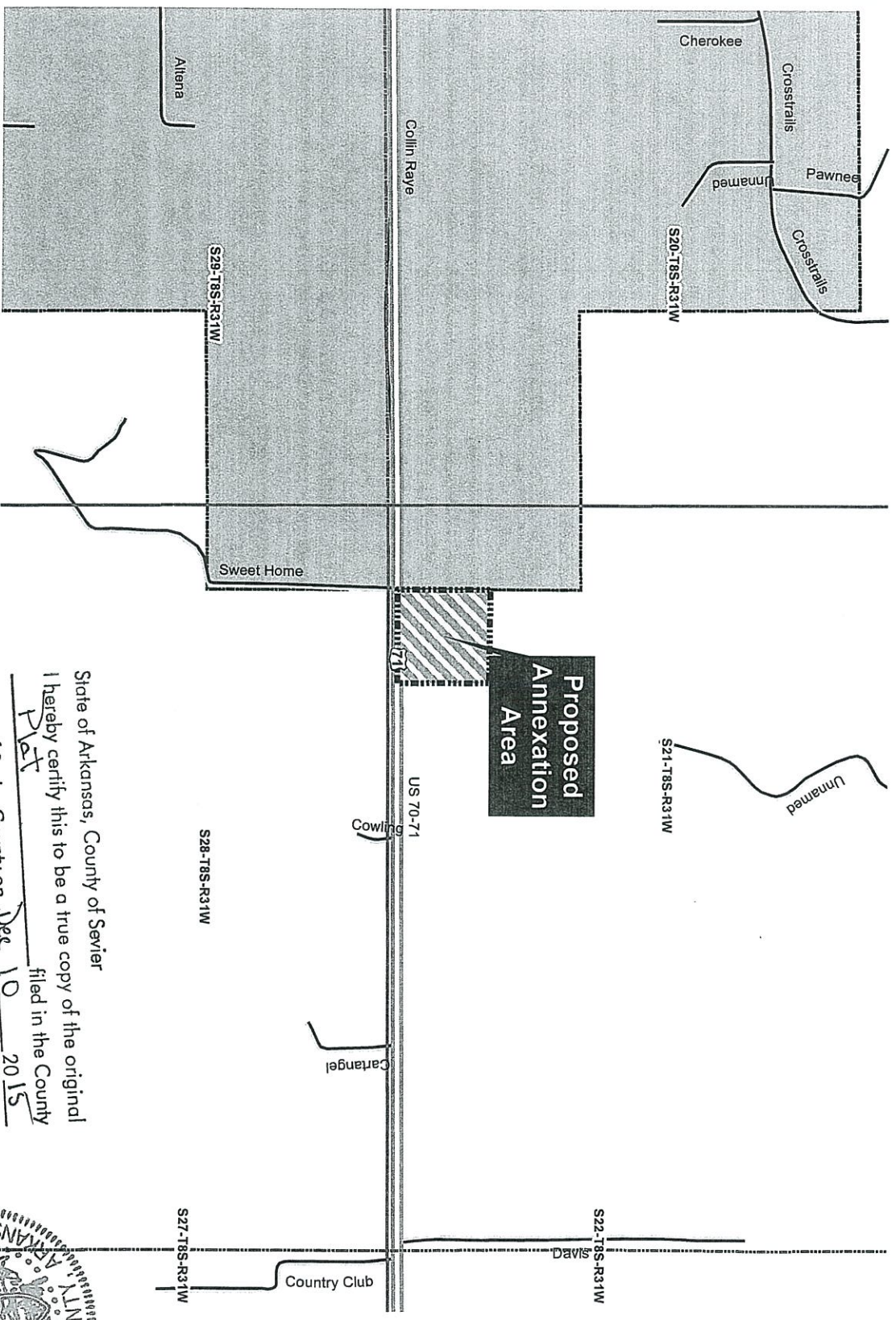

State of Arkansas, County of Sevier
I hereby certify this to be a true copy of the original
filed in the County
Plat

Court of Sevier County on Dec 10 2015

Deborah K. Olin
County Clerk

