



JOHN THURSTON  
ARKANSAS SECRETARY OF STATE

June 3, 2019

The Hon. Becky Lewallen  
Washington County Clerk  
280 N. College, Suite 300  
Fayetteville, AR 72701

Re: City of Fayetteville Annexation Ordinance 6110

Dear Ms. Lewallen,

This letter acknowledges receipt and filing of the following notice of municipal boundary change by the Office of the Secretary of State;

Filing Type: Annexation pursuant to A.C.A. §14-40-609 (annexation by 100% of the landowners)

Effective Date: 12/10/18

County: Washington

City Ordinance: 6110

County Court Order: 2017-11

City: Fayetteville

Dated: 11/8/18

Date Filed: 10/13/17

A file marked copy of the ordinance, court order and exhibits submitted to our Office are enclosed. By copy of this letter (and its enclosures), the Secretary of State hereby notifies the appropriate mapping authorities for Arkansas. Please retain these copies as official record of the filing of the municipal boundary change by the Arkansas Secretary of State.

If you have any questions or concerns regarding this filing, please contact our office at 501-682-3478.

Sincerely,

Rusty Jackson

Elections Division

Room 26

501-682-3478

cc: Arkansas Geographic Information Systems Office (w/encl)  
Arkansas Department of Transportation Mapping Department (w/encl)  
Department of Finance and Administration (w/encl)  
Arkansas Public Service Commission (w/encl)  
Arkansas Economic Development Institute (w/encl)  
The Honorable Lioneld Jordan, Mayor of Fayetteville (w/encl)



# Arkansas Secretary of State

**John Thurston** Arkansas Secretary of State, 500 Woodlane Ave, Little Rock, AR 72201-1094

## Municipal Boundary Change Checklist

Act 655 of 2017 and A.C.A. §14-40-103

FILED  
2019 APR 26 PM 3:52  
CLERK OF THE SECRETARY OF STATE  
MUNICIPAL BOUNDARY CHANGES

County: Washington City/Town: Fayetteville

City Ordinance/Resolution No: 6110 Date approved: November 8, 2018

County Court Case No: CC 2017-11 Date Order Filed: October 13, 2017

Type: Annexation of land in adjoining County A.C.A. 14-40-401  
Annexation by Petition, 100% Landowners RJ 6/6/19

Date Change Effective: December 10, 2018 Set by:  Municipal Ordinance  Emergency Clause  Court  Default  
*(Required by Act 655 of 2017)*

For Circuit Court Challenge: Date Order Filed: \_\_\_\_\_  Upheld  Overturned  Other *(attach explanation)*

Please indicate which ward(s) the territory will be assigned to: Ward 4  
*(See A.C.A. § 14-40-203)*

### Initiating party:

All Landowners  Majority Landowners  Municipal Governing Body  State  Other \_\_\_\_\_

### Supporting Documentation attached (check all that apply):

- File marked copy of City Ordinance/Resolution *(required)*
- File marked copy of County Court Order or certified annexation election results *(required except for A.C.A. §14-40-501)*
- Copy of Arkansas GIS approved printed map and certification letter *(required)*
- Proof of Publication for all Legal Notices *(include Hearing, Election, and City Ordinance/Resolution notices)*
- File marked copy of Petition Part *(if applicable)*
- File marked copy of Complaint and final Circuit Court Order *(Court Challenge only)*

### Municipal Contact:

Name: Andrew Garner Title: City Planning Director

Street Address: 113 West Mountain

City: Fayetteville St: AR Zip code: 72701

*Complete one form per ordinance/resolution, attach it as a cover page to the supporting document set and submit to the County Clerk's Office within 45 days of the Effective Date as required by Act 655 of 2017*

### County Official:

Signature: *Priscilla Sharp* Title: Chief Deputy Clerk

Date: 5/21/19

*Pursuant to Act 655 of 2017, County Officials must submit a file-marked copy of municipal boundary change documents within 30 days of receipt to: Arkansas Secretary of State, Attn: Municipal Boundary Filing, 500 Woodlane Ave Suite 256, Little Rock, AR 72201-1094*

Office of the Arkansas Secretary of State use only

Received by: *[Signature]*

FILED

2018 DEC 13 AM 8:48

WILLIAM L. LINDEN  
CO. & PROBATE CLERK  
WASHINGTON CO. AR



113 West Mountain Street  
Fayetteville, AR 72701  
(479) 575-8323

**Ordinance: 6110**



Doc ID: 018391560004 Type: REL  
Kind: ORDINANCE  
Recorded: 12/04/2018 at 11:03:52 AM  
Fee Amt: \$30.00 Page 1 of 4  
Washington County, AR  
Kyle Sylvester Circuit Clerk

File **2018-00035810**

---

**File Number: 2018-0608**

**ANX 17-5990 (NORTH OF RUPPLE RD./MCFARLAND FAMILY TRUST) APPEAL:**

AN ORDINANCE TO APPROVE THE ANNEXATION PETITION OF THE MCFARLAND FAMILY TRUST AND ANNEX 68.65 ACRES ADJOINING AND WEST OF THE PROPOSED NORTHERN EXPANSION OF RUPPLE ROAD

**WHEREAS**, the McFarland Family Trust has properly secured the Washington County Judge's authorization to annex their 68.65 acres west of and along the planned Ruppel Road expansion north toward Howard Nickell Road; and

**WHEREAS**, the McFarland Family Trust through Swope Engineering has offered to donate and dedicate sufficient right of way along their frontage with the Ruppel Road expansion to enable its construction; and

**WHEREAS**, the McFarland Family Trust has further offered to designate a conservation area preservation of natural habitat along the creek and the construction or extension of city trails within its property;

**NOW, THEREFORE, BE IT ORDAINED BY THE CITY COUNCIL OF THE CITY OF FAYETTEVILLE, ARKANSAS:**

Section 1. That the City Council of the City of Fayetteville, Arkansas hereby accepts the offer of the McFarland Family Trust for its donation and dedication of Ruppel Road right of way, conservation easements and trail right of way and construction and confirms the annexation to the City of Fayetteville, Arkansas of about 68.65 acres as described in Exhibit B and the map shown on Exhibit A both attached to the Planning Department's agenda memo.

Section 2. That the City Council of the City of Fayetteville, Arkansas hereby zones the newly annexed

Ordinance: 6110

File Number: 2018-0608

---

property R-A, Residential Agricultural.

Section 3. That the City Council of the City of Fayetteville, Arkansas hereby amends the official map and zoning map of the City of Fayetteville to recognize this annexation and zoning.

Section 4. That the City Council of the City of Fayetteville, Arkansas hereby assigns this 68.65 acres to Ward Four of the City of Fayetteville.

PASSED and APPROVED on 11/8/2018

Approved:

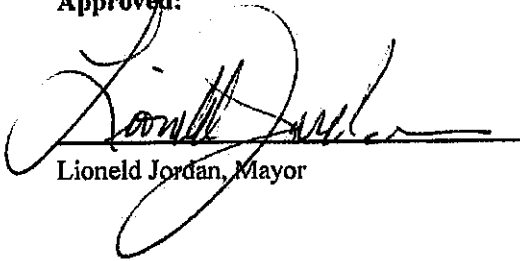
  
Lioneld Jordan, Mayor

Attest:

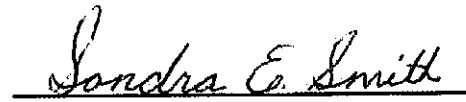
  
Sondra E. Smith, City Clerk Treasurer

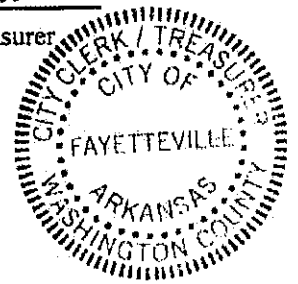

**FILED**

**JUN 06 2019**

**Arkansas  
Secretary of State**

ANX17-5990

# MCFARLAND FAMILY TRUST

17-5990  
EXHIBIT 'A'

Close Up View

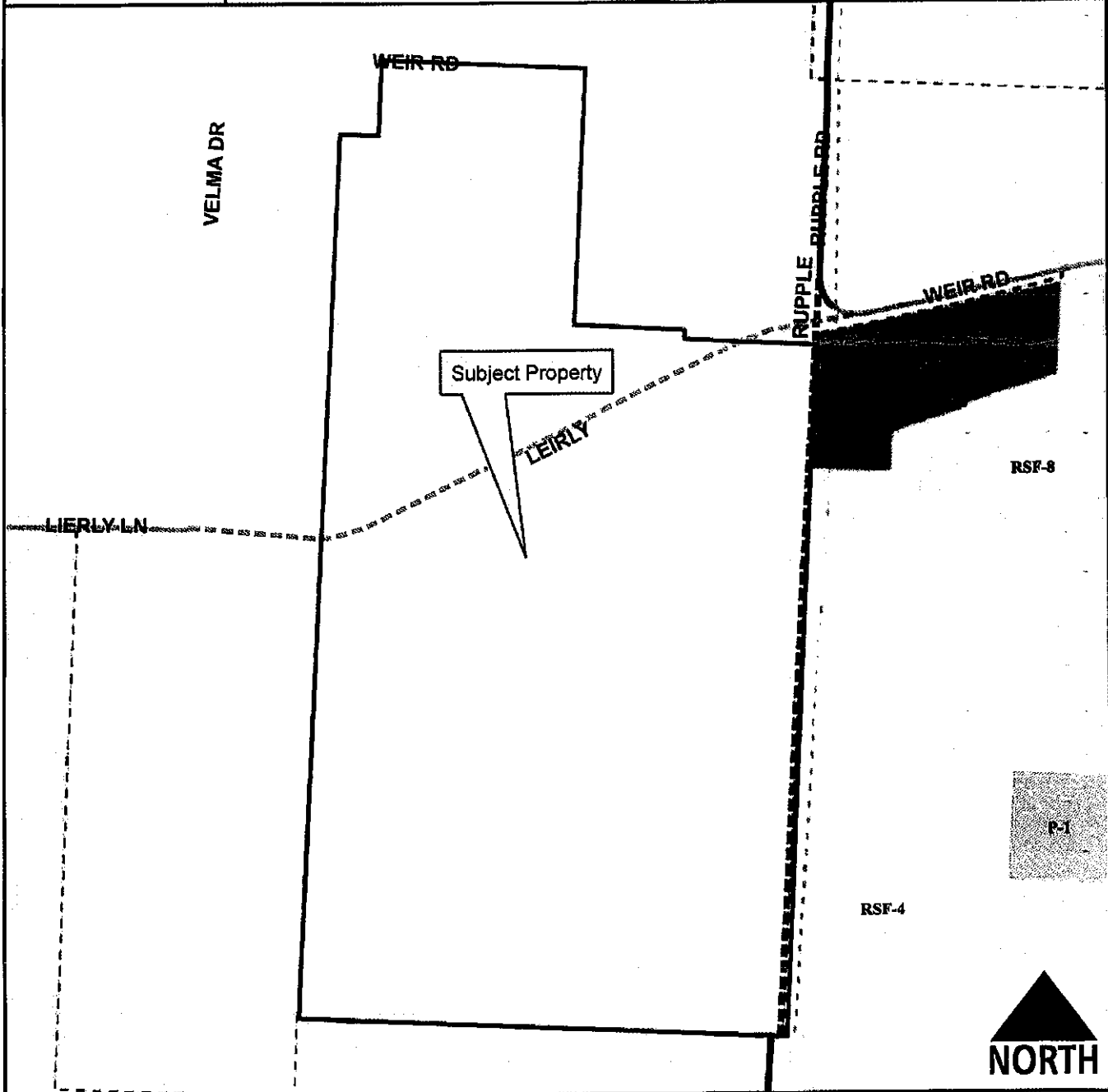

### Legend

- Planning Area
- Fayetteville City Limits
- Trail (Proposed)
- Building Footprint

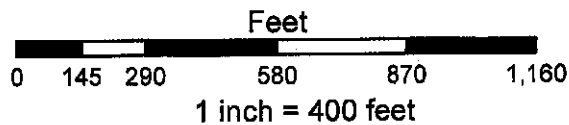

- Residential-Agricultural
- RSF-4
- RSF-8
- P-1

**17-5990**  
**EXHIBIT 'B'**

**SURVEY DESCRIPTION FOR ANNEXATION: A PART OF THE NORTHEAST QUARTER OF THE NORTHEAST QUARTER AND A PART OF THE SOUTHEAST QUARTER OF THE NORTHEAST QUARTER OF SECTION 31, TOWNSHIP 17 NORTH, RANGE 30 WEST, WASHINGTON COUNTY, ARKANSAS, BEING MORE PARTICULARLY DESCRIBED AS FOLLOWS, TO-WIT: COMMENCING AT A FOUND IRON PIN, LOCATED AT THE NORTHEAST CORNER OF SAID FORTY ACRE TRACT AND THENCE N87°08'20"W 680.17 FEET TO A SET P/K NAIL, SAID POINT BEING THE TRUE POINT OF BEGINNING AND RUNNING THENCE S02°43'44"W 702.02 FEET TO A SET IRON PIN, THENCE S87°08'20"E 301.80 FEET TO A SET IRON PIN, THENCE S02°39'43"W 25.00 FEET TO A SET IRON PIN, THENCE S87°08'20"E 359.09 FEET TO A SET IRON PIN, THENCE S02°39'43"W 1904.10 FEET TO A SET IRON PIN, THENCE N87°25'05"W 1326.48 FEET TO THE SOUTHWEST CORNER OF THE SOUTHEAST QUARTER OF THE NORTHEAST QUARTER OF SAID SECTION, THENCE N02°48'50"E 2428.66 FEET TO A FOUND IRON PIN, THENCE S87°05'15"E 104.59 FEET TO A FOUND IRON PIN, THENCE N02°47'54"E 208.98 FEET TO A FOUND COTTON SPINDLE, THENCE S87°08'20"E 554.78 FEET TO THE POINT OF BEGINNING, CONTAINING IN ALL 68.65 ACRES, MORE OR LESS. SUBJECT TO ALL EASEMENTS AND RIGHTS-OF-WAY OF RECORD.**

Washington County, AR  
I certify this instrument was filed on  
12/04/2018 11:03:52 AM  
and recorded in Real Estate  
File Number 2018-00035810  
Kyle Sylvester - Circuit Clerk

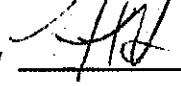
by  \_\_\_\_\_

OFFICE OF THE CITY CLERK TREASURER

Sondra E. Smith – City Clerk Treasurer  
Lisa Branson – Deputy City Clerk



Phone 479.575.8323  
cityclerk@fayetteville-ar.gov

113 W. Mountain Street, Suite 308  
Fayetteville, AR 72701

**CERTIFICATE OF RECORD**

State of Arkansas     )  
                                  )ss:  
City of Fayetteville    )

REC'D  
CLERK  
CO. & PROBATE CLERK  
WASHINGTON CO. AR

2018 DEC 13 AM 8:49

FILED

I, Sondra E. Smith, City Clerk Treasurer for the City of Fayetteville, Arkansas, do hereby certify that the foregoing instrument is a true and correct copy of the original Ordinance 6110 ANX 17-5990 (North Ruppel Rd./McFarland Family Trust) Appeal filed in my office November 8, 2018.

WITNESS my hand and seal this 12<sup>th</sup> day of December 2018.

*Sondra E. Smith*  
\_\_\_\_\_  
Sondra E. Smith, City Clerk Treasurer  
City of Fayetteville, Arkansas



**ANX 17-5990**  
**Order of**  
**Annexation**

**IN THE COUNTY COURT OF WASHINGTON COUNTY, ARKANSAS**

**IN THE MATTER OF  
THE PETITION OF CERTAIN  
PROPERTY TO FAYETTEVILLE,  
WASHINGTON COUNTY, ARKANSAS**

**CC 2017-11**

FILED  
2017 OCT 13 PM 2:21  
CLERK OF THE COURT  
WASHINGTON CO. AR

**ORDER OF ANNEXATION**

NOW on this 13<sup>th</sup> day of October, 2017, comes on for consideration before this Court the matter of annexation of certain lands from the unincorporated area of Washington County, Arkansas to the city of Fayetteville, Arkansas. Said land is described as follows:

A PART OF THE NORTHEAST QUARTER OF THE NORTHEAST QUARTER AND A PART OF THE SOUTHEAST QUARTER OF THE NORTHEAST QUARTER OF SECTION 31, TOWNSHIP 17 NORTH, RANGE 30 WEST, WASHINGTON COUNTY, ARKANSAS, BEING MORE PARTICULARLY DESCRIBED AS FOLLOWS, TO-WIT: COMMENCING AT A FOUND IRON PIN, LOCATED AT THE NORTHEAST CORNER OF SAID FORTY ACRE TRACT AND THENCE N87°08'20"W 660.17 FEET TO A SET P/K NAIL, SAID POINT BEING THE TRUE POINT OF BEGINNING AND RUNNING THENCE S02°43'44"W 702.02 FEET TO A SET IRON PIN, THENCE S87°08'20"E 301.90 FEET TO A SET IRON PIN, THENCE S02°39'43"W 25.00 FEET TO A SET IRON PIN, THENCE S87°08'20"E 359.09 FEET TO A SET IRON PIN, THENCE S02°39'43"W 1904.10 FEET TO A SET IRON PIN, THENCE N87°25'05"W 1326.48 FEET TO THE SOUTHWEST CORNER OF THE SOUTHEAST QUARTER OF THE NORTHEAST QUARTER OF SAID SECTION, THENCE N02°48'50"E 2428.66 FEET TO A FOUND IRON PIN, THENCE S87°05'15"E 104.59 FEET TO A FOUND IRON PIN, THENCE N02°47'54"E 208.99 FEET TO A FOUND COTTON SPINDLE, THENCE S87°08'20"E 554.78 FEET TO THE POINT OF BEGINNING. CONTAINING IN ALL 68.65 ACRES, MORE OR LESS. SUBJECT TO ALL EASEMENTS AND RIGHTS-OF-WAY OF RECORD.

From the evidence presented by the Petitioners through their representative, Joseph Orr, the Court finds as follows:

1. The Petitioners have petitioned this Court to annex the above described property into the City of Fayetteville, Washington County, Arkansas. Said annexation is brought pursuant to A.C.A. §14-40-609.

2. The petition was submitted in writing and attested by the property owners.
3. The petition contains an accurate description of the relevant property or properties.
4. The petitioners have provided a schedule of services that will be extended to the area within three (3) years after the date the annexation becomes final.
5. The County Assessor and County Clerk have verified the identity of the petitioners, that there are no property owners included in the petition that do not wish to have their property annexed, that the property or properties are contiguous with the city, and that no enclaves will be created if the petition is accepted by the city.
6. The property which is legally described in the petition has been accurately described, an accurate map thereof has been made and filed, and the prayer of the petitioners is right and proper.
7. This court therefore determines that and Order of Annexation is proper and that the petition and this order shall be submitted to the city of Fayetteville, Arkansas.

IT IS THEREFORE, CONSIDERED, ORDERED AND DECREED that the above described tracts of land be, and hereby are annexed to and made a part of the City of Fayetteville, Washington County, Arkansas, subject to approval by the City Council for the City of Fayetteville, Arkansas.

**IT IS SO ORDERED.**

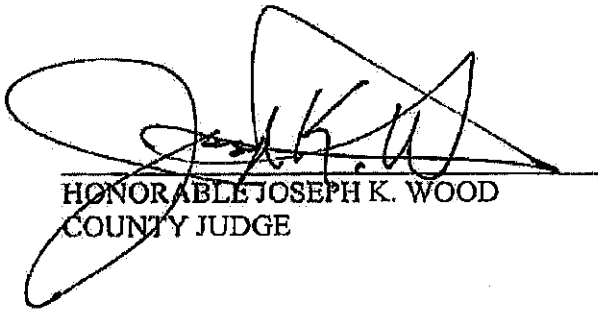

HONORABLE JOSEPH K. WOOD  
COUNTY JUDGE

**Prepared by:**  
**Brian R. Lester**  
 Washington County Attorney  
 280 North College Ave., Suite 500  
 Fayetteville, AR 72701  
 t/(479) 973-8415  
 f/(479) 444-1889  
 blester@co.washington.ar.us

**FILED**

**JUN 06 2019**

**Arkansas  
Secretary of State**

CERTIFICATE  
 I CERTIFY THAT THIS INSTRUMENT IS A  
 TRUE COPY OF THE ORIGINAL  
 FILED IN THIS OFFICE AT 5/21/19  
 BECKY LEWIS, COUNTY CLERK  
 JENNIFER WOOD



**ARKANSAS  
GIS OFFICE**

---

July 20, 2017

Mr Joseph Orr – Representing Petitioner Juliana Salazar  
Blew & Associates, P.A.  
524 W Sycamore St STE D  
Fayetteville AR 72703

RE: City of Fayetteville Annexation Coordination Requirement

Mr. Orr,

Thank you for coordinating with our office as you seek to annex property into the City of Fayetteville, AR situated in the Northeast Quarter and Southeast Quarter of the Northeast Quarter of Section 31, Township 17 North Range 30 West. This letter represents confirmation that you have properly coordinated with our office (Arkansas GIS Office) as specified in § 14-40-101 (Act 914 of 2015) of the 90<sup>th</sup> General Assembly.

Our office will wait completion of any additional steps necessary for the proposed boundary change, which normally comes from the Arkansas Secretary of State Elections Division after any appropriate filing by your County Clerk.

Thank you,

Shelby D Johnson, State Geographic Information Officer  
/sdj

Attachments:  
GIS Office Map of Proposed Annexation  
Secretary of State Municipal Change Checklist

**FILED**

**JUN 06 2019**

**Arkansas  
Secretary of State**

H:\City\_Annexations\Templates\Folder Structure\Doc\20170720\_Fayetteville\_Annexation\_Coordination\_Letter.docx

City: Fayetteville  
 Mayor: Lioneld Jordan

Mayes

Proposed Annex: City of Fayetteville  
 July 2017

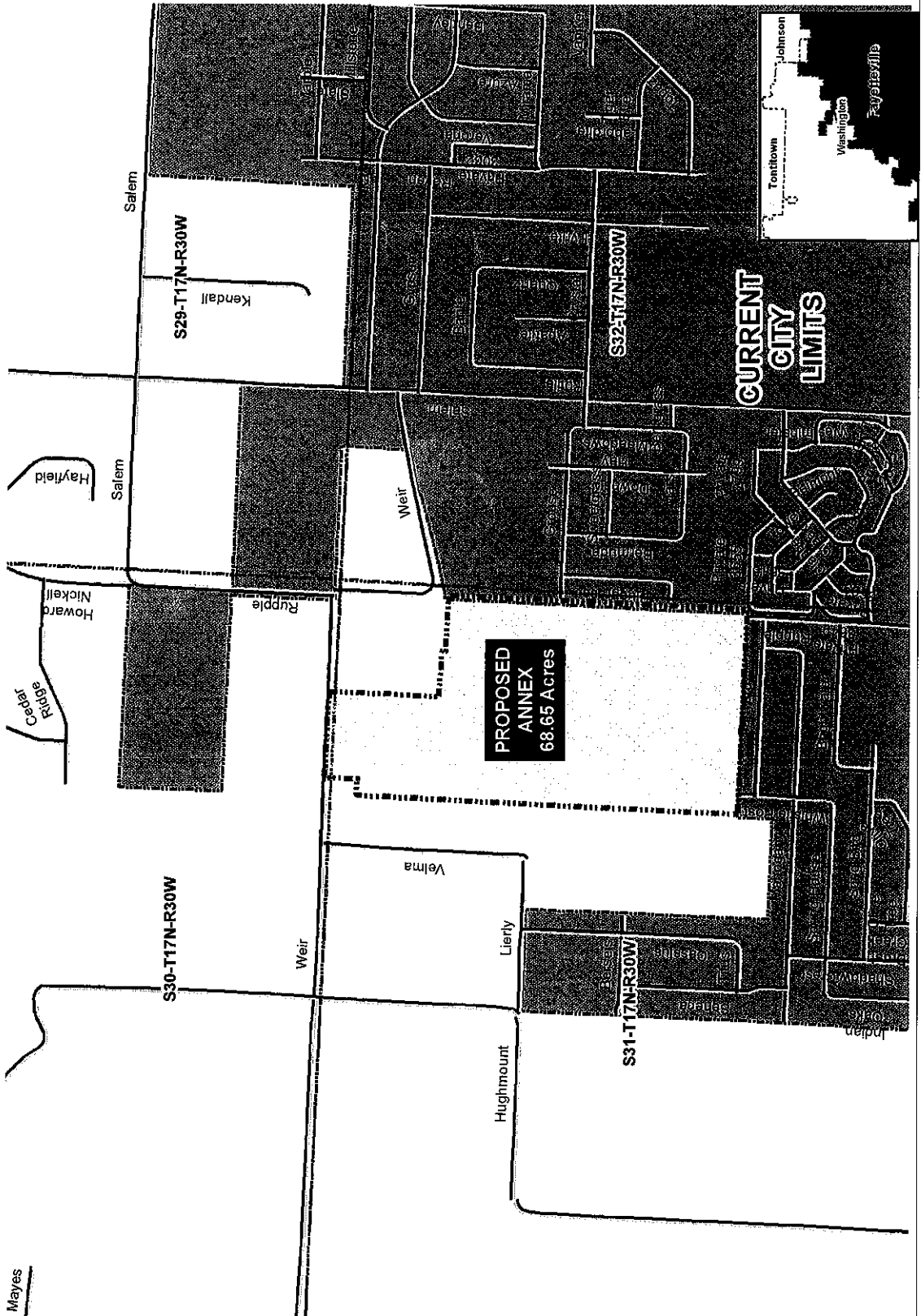

Arkansas Code 14-40-101.  
 Before an entity undertakes an annexation, consolidation, or detachment proceeding under this chapter, the entity shall coordinate with the Arkansas Geographic Information Systems Office for preparation or legal descriptions and digital mapping for the relevant annexation, consolidation, and detachment areas.

The map contained herein, is evidence, the entity has met requirements of Act 914 of 2015

- Proposed Annex
- Sections
- Highway
- Minor Road
- Existing City

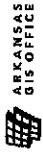
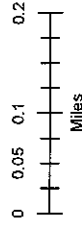

ARKANSAS  
 GIS OFFICE

H:\City\_Annexations\City of Fayetteville\20170720

**BLEW & ASSOCIATES, PA**  
**CIVIL ENGINEERS & LAND SURVEYORS**

---

July 20, 2017

City of Fayetteville  
113 West Mountain Street  
Fayetteville, AR 72701

SUBJECT: Annexation Legal Description

To Whom It May Concern:

SURVEY DESCRIPTION FOR ANNEXATION: A PART OF THE NORTHEAST QUARTER OF THE NORTHEAST QUARTER AND A PART OF THE SOUTHEAST QUARTER OF THE NORTHEAST QUARTER OF SECTION 31, TOWNSHIP 17 NORTH, RANGE 30 WEST, WASHINGTON COUNTY, ARKANSAS, BEING MORE PARTICULARLY DESCRIBED AS FOLLOWS, TO-WIT: COMMENCING AT A FOUND IRON PIN, LOCATED AT THE NORTHEAST CORNER OF SAID FORTY ACRE TRACT AND THENCE N87°08'20"W 660.17 FEET TO A SET P/K NAIL, SAID POINT BEING THE TRUE POINT OF BEGINNING AND RUNNING THENCE S02°43'44"W 702.02 FEET TO A SET IRON PIN, THENCE S87°08'20"E 301.90 FEET TO A SET IRON PIN, THENCE S02°39'43"W 25.00 FEET TO A SET IRON PIN, THENCE S87°08'20"E 359.09 FEET TO A SET IRON PIN, THENCE S02°39'43"W 1904.10 FEET TO A SET IRON PIN, THENCE N87°25'05"W 1326.48 FEET TO THE SOUTHWEST CORNER OF THE SOUTHEAST QUARTER OF THE NORTHEAST QUARTER OF SAID SECTION, THENCE N02°48'50"E 2428.66 FEET TO A FOUND IRON PIN, THENCE S87°05'15"E 104.59 FEET TO A FOUND IRON PIN, THENCE N02°47'54"E 208.99 FEET TO A FOUND COTTON SPINDLE, THENCE S87°08'20"E 554.78 FEET TO THE POINT OF BEGINNING. CONTAINING IN ALL 68.65 ACRES, MORE OR LESS. SUBJECT TO ALL EASEMENTS AND RIGHTS-OF-WAY OF RECORD.

# NORTHWEST ARKANSAS Democrat Gazette

1100 W. WASHINGTON ST., FAYETTEVILLE, AR. PHONE: 479-424-1100 FAX: 479-424-1101 WWW.NWGAZ.COM

## AFFIDAVIT OF PUBLICATION

I Karen Caler, do solemnly swear that I am the Legal Clerk of the Northwest Arkansas Democrat-Gazette, printed and published in Washington County and Benton County, Arkansas, and of bona fide circulation, that from my own personal knowledge and reference to the files of said publication, the advertisement of:

CITY OF FAYETTEVILLE  
Notice of Public Hearing

Was inserted in the Regular Edition on:

November 10, 2017

Publication Charges: \$ 42.90

  
Karen Caler

Subscribed and sworn to before me  
This 17 day of Nov, 2017.

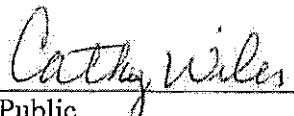
  
Notary Public  
My Commission Expires: 2/20/24

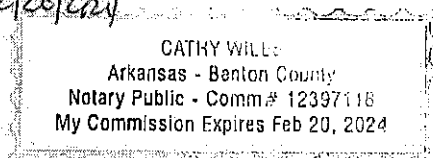

**\*\*NOTE\*\***  
Please do not pay from Affidavit.  
Invoice will be sent.

NOTICE OF PUBLIC HEARING  
At 5:30 p.m., in room 219, Fayetteville Administration Building at 113 W. Mountain Street, Fayetteville, Arkansas, 72701 the following items will be heard at the Monday, November 27, 2017 Fayetteville Planning Commission meeting.  
RZN 17-5993: Rezone (NORTH OF 7008 W. WEDINGTON DR./PRESLEY, 395): The request is to rezone the properties to C-2, THOROUGHFARE COMMERCIAL.  
RZN 17-5991: Rezone (NORTH OF N. RUPPLE RD./MCFARLAND FAMILY TRUST, 244): The request is to rezone the properties to RSF-4, RESIDENTIAL SINGLE FAMILY, 4 UNITS PER ACRE.  
ANX 17-5990: Annexation (NORTH OF N. RUPPLE RD./MCFARLAND FAMILY TRUST, 244): The request is to be annexed into the City Limits of Fayetteville.  
74335826 Nov. 10, 2017

===== TRANSACTION RECORD =====  
NW ARK NEWSPAPERS LLC  
212 N EAST AVE  
FAYETTEVILLE, AR 72702  
United States  
WWW.NWADG.COM

TYPE: Purchase

ACCT: Visa \$ 42.90 USD

CARDHOLDER NAME : City of Fayetteville  
CARD NUMBER : #####2501  
DATE/TIME : 07 Nov 17 08:11:17  
REFERENCE # : 001 0276856 M  
AUTHOR. # : 035492  
TRANS. REF. : C6014528

Approved - Thank You 100

Please retain this copy for your records.

Cardholder will pay above amount to  
card issuer pursuant to cardholder  
agreement.

\*\*\*\*\*

RECEIVED

DEC 11 2018

CITY OF FAYETTEVILLE  
CITY CLERK'S OFFICE

NORTHWEST ARKANSAS  
**Democrat & Gazette**

NO. 1102 (2017) EXPIRES FEBRUARY 1, 2019 • (779) 442-1700 • FAX: (779) 442-1705 • WWW.NWGAZETTE.COM

**AFFIDAVIT OF PUBLICATION**

I Cathy Wiles, do solemnly swear that I am the Legal Clerk of the Northwest Arkansas Democrat-Gazette, printed and published in Washington County and Benton County, Arkansas, and of bona fide circulation, that from my own personal knowledge and reference to the files of said publication, the advertisement of:

CITY OF FAYETTEVILLE  
Ord 6110

Was inserted in the Regular Edition on:

November 22, 2018

Publication Charges: \$ 127.40

Cathy Wiles  
Cathy Wiles

Subscribed and sworn to before me  
This 5<sup>th</sup> day of Dec, 2018.

Sandra O. Robinson  
Notary Public  
My Commission Expires: 3-16-25

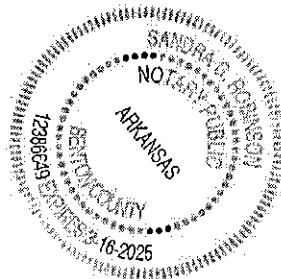

**\*\*NOTE\*\***  
Please do not pay from Affidavit.  
Invoice will be sent.

Ordinance: 6110  
File Number: 2018-0608  
ANX 17-5990 (NORTH OF RUPPLE RD./MCFARLAND FAMILY TRUST)  
APPEAL:  
AN ORDINANCE TO APPROVE THE ANNEXATION PETITION OF THE MCFARLAND FAMILY TRUST AND ANNEX 68.65 ACRES ADJOINING AND WEST OF THE PROPOSED NORTHERN EXPANSION OF RUPPLE ROAD  
WHEREAS, the McFarland Family Trust has properly secured the Washington County Judge's authorization to annex their 68.65 acres west of and along the planned Ruppel Road expansion north toward Howard Nickell Road; and  
WHEREAS, the McFarland Family Trust through Swope Engineering has offered to donate and dedicate sufficient right of way along their frontage with the Ruppel Road expansion to enable its construction; and  
WHEREAS, the McFarland Family Trust has further offered to designate a conservation area preservation of natural habitat along the creek and the construction or extension of city trails within its property;  
NOW, THEREFORE, BE IT ORDAINED BY THE CITY COUNCIL OF THE CITY OF FAYETTEVILLE, ARKANSAS:  
Section 1. That the City Council of the City of Fayetteville, Arkansas hereby accepts the offer of the McFarland Family Trust for its donation and dedication of Ruppel Road right of way, conservation easements and trail right of way and construction and confirms the annexation to the City of Fayetteville, Arkansas of about 68.65 acres as described in Exhibit B and the map shown on Exhibit A both attached to the Planning Department's agenda memo.  
Section 2. That the City Council of the City of Fayetteville, Arkansas hereby zones the newly annexed property R-A, Residential Agricultural.  
Section 3. That the City Council of the City of Fayetteville, Arkansas hereby amends the official map and zoning map of the City of Fayetteville to recognize this annexation and zoning.  
Section 4. That the City Council of the City of Fayetteville, Arkansas hereby assigns this 68.65 acres to Ward Four of the City of Fayetteville.  
PASSED and APPROVED on 11/8/2018  
Approved:  
Lionel Jordan, Mayor  
Attest:  
Sandra E. Smith, City Clerk Treasurer  
74754322 Nov. 22, 2018





# WASHINGTON COUNTY

STATE OF ARKANSAS

Washington County Courthouse  
280 North College Avenue, Suite 300  
Fayetteville, Arkansas 72701  
Telephone: (479) 444-1711  
Fax: (479) 444-1894

BECKY LEWALLEN  
County And Probate Clerk

May 22, 2019

To Whom it may Concern:

You will find enclosed an Annexation to the City of Fayetteville. If you have any further questions please don't hesitate to call.

Thanks,

A handwritten signature in cursive script that reads "Jennifer Sharpshair".

Jennifer Sharpshair



JOHN THURSTON

ARKANSAS SECRETARY OF STATE

RECEIVED

APR 8 2019

CITY OF FAYETTEVILLE  
MAYOR'S OFFICE

April 4, 2019

The Honorable Becky Lewallen  
Washington County Clerk  
280 N. College, Suite 300  
Fayetteville, AR 72701

Re: Fayetteville City Ordinance 6110 - Missing Information

Dear Ms. Lewallen:

This letter acknowledges receipt of the Fayetteville City Ordinance 6110 and its supporting documentation by the Office of the Arkansas Secretary of State. However, our Office is unable to file the annexation at this time because a completed Municipal Boundary Change form was not included or completed incorrectly. This form is required for all municipal boundary changes pursuant to Ark. Code Ann. § 14-40-103. A blank copy of the form is enclosed for your convenience. A fillable PDF is also available online at: [https://www.sos.arkansas.gov/uploads/elections/Municipal\\_Change\\_Checklist\\_Fillable.pdf](https://www.sos.arkansas.gov/uploads/elections/Municipal_Change_Checklist_Fillable.pdf).

To complete this filing, please provide the completed Municipal Boundary Change form as soon as it becomes available. If you have any questions or concerns regarding this matter, please do not hesitate to contact me at (501) 682-3478. Thank you for your assistance in this matter.

Sincerely,

  
Rusty Jackson  
Elections Division

Enclosure as stated

cc: The Honorable Lioneld Jordan, Mayor of Fayetteville