



ARKANSAS SECRETARY OF STATE

MARK MARTIN

November 19, 2015

The Honorable Tena O'Brien
Benton County Clerk
215 E. Central, Suite 217
Bentonville, AR 72712-5304

RE: Annexation

Dear Mrs. O'Brien,

The following information was received and has been recorded and filed in the office of the Secretary of State:

County: Benton

City: Gravette

Annexation:

City Ordinance No. 15-21 – Dated October 23, 2015

Decree of Annexation No. CC2015-09 – Dated September 17, 2015

Plat of Area to be Annexed

By copy of this letter, I am sending file marked copies of all of the information to the UALR Institute for Economic Advancement, Arkansas Highway Mapping Department, TomTom, and the State Geographic Information Office. All others listed will only receive notification of the annexation by copy of this letter.

If you have any questions please do not hesitate to contact me at 1-800-482-1127 or 501-682-5070.

Sincerely,

A handwritten signature in cursive script that reads "Jacqueline Cowan".

Jacqueline Cowan
Elections Services Representative
Arkansas Secretary of State

cc: UALR Institute for Economic Advancement (w/encl)
Arkansas Highway Mapping Department (w/encl)
TomTom (w/encl)
Shelby Johnson, State Geographic Information Officer GIS (w/encl)
Arkansas Municipal League (w/o encl)
Gravette City Clerk (w/o encl)



Gravette Proposed Voluntary Annexation - July 2015

EXHIBIT

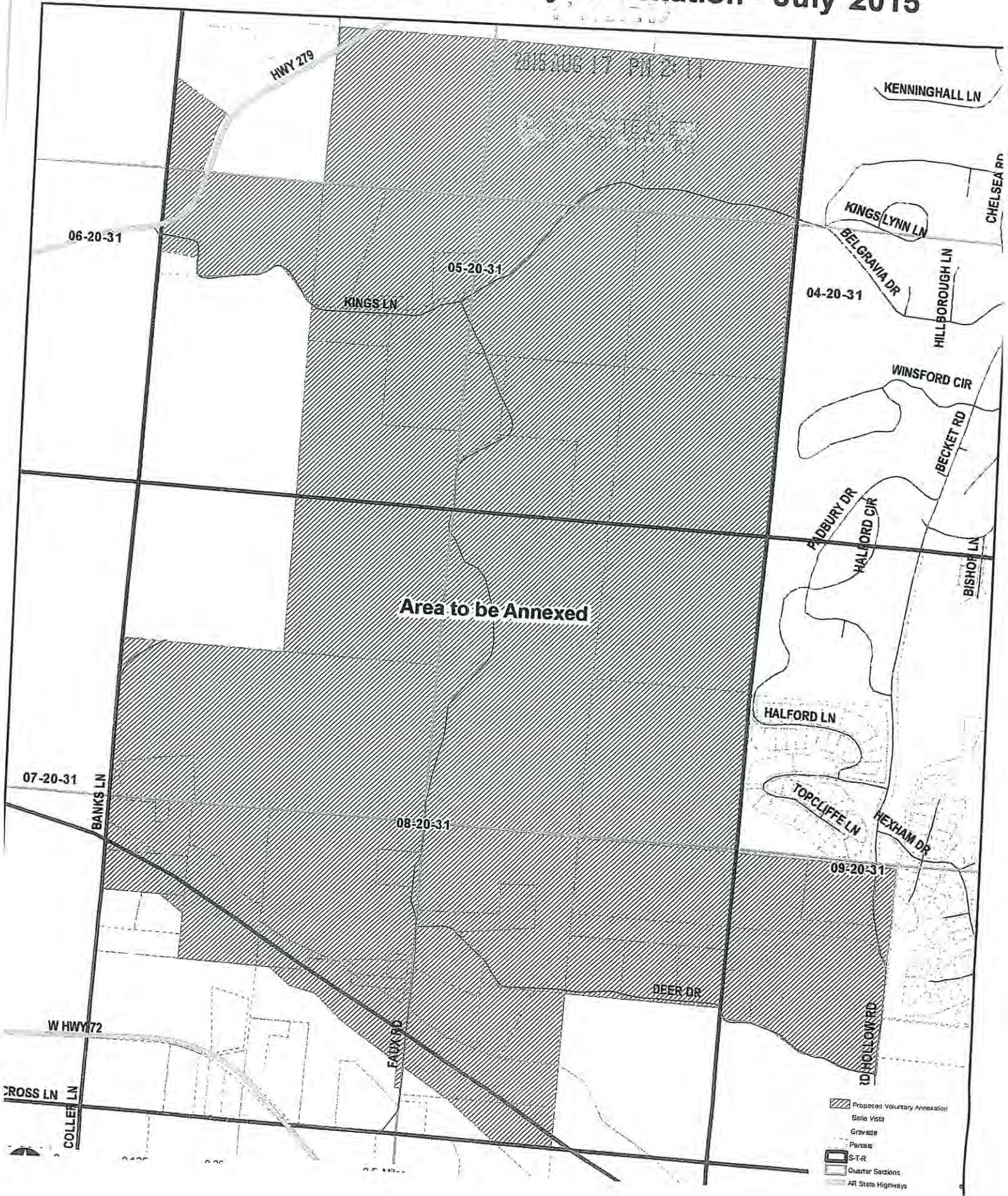

IN THE COUNTY COURT OF BENTON COUNTY, ARKANSAS

2015 SEP 17 AM 11:28

CLERK OF COURT
BENTON COUNTY, ARK

CASE NO. CC-2015-09

IN THE MATTER OF ANNEXING TO
THE CITY OF GRAVETTE, ARKANSAS,
CERTAIN PROPERTY CONTIGUOUS
TO SAID CITY OF GRAVETTE IN
BENTON COUNTY, ARKANSAS

PETITIONERS

- Joseph and Kathryn Mabry
- Glen Norris Puryear
- Tim and Beth Crane
- Bill and Barbara Puryear
- Paul and Fannie Mahon
- Robert and Gloria Hill
- Emery Humphries
- Jacob Ramos
- Chris and Katie Horner
- Shane and Brandie Perry (Rebel Run Farms LLC)
- Tim Crane and Carol Cowger
- Danny Banks
- Charles and Cloetta Walker
- Steve and Judy Fenton
- Gary Curtis
- Michael McDaniel
- Glenda Crowder
- Van and Patricia Neely
- Ron Kelly
- Billy Leon Elsea

DECREE OF ANNEXATION

On this 17th of September, 2015, a day of the regular term of the County Court of Benton County, Arkansas, there is presented to the court by the petitioner or Michael von Ree, their agent, a Petition for annexation of certain territory,

2015 2477

hereinafter more particularly described, to the City of Gravette, Arkansas, and the Court being fully advised of the facts and the law, doth hereby find, judge and decree as follows:

2015 SEP 17 AM 11:28
L. B. RICH
CLERK
GRAVETTE, ARK

1. The court finds that the Petition for annexation was filed in the office of the Clerk of this Court more than thirty (30) days prior to the date.
2. The Court doth find that a majority of the total numbers of real estate owners in the area affected by the Petition has signed said Petition and that such a majority owns more than one-half of the acreage affected.
3. The Court further finds that the territory sought to be annexed was accurately described in said Petition, or as amended, and that said territory is contiguous to the boundaries of the City of Gravette, Arkansas.
4. The Court further finds that attached to and made a part of said Petition is an accurate map of the territory sought to be annexed to the City of Gravette, Arkansas.
5. The Court further finds that the prayer of the Petition is right and proper.

WHEREFORE, THE COURT DOTH HEREBY ORDER, JUDGE AND DECREE. That the following described territory be and the same is hereby annexed to and made part of the City of Gravette, Arkansas to-wit:

All unincorporated territory in S5, T20N, R31 W; all unincorporated territory in S8, T20N, R31 W lying North of the South R-O-W line of the highway to be known as I-49, less and except the SE ¼ SE ¼ of said S8; all unincorporated territory in the W ¼ of S9, T20N, R31 W lying north of Deer Drive; AND all contiguous and adjacent dedicated and prescriptive road rights-of-ways.

1. That the boundaries if the above described property adjoin the corporate limits of the City of Gravette, Arkansas.
2. That the Petitioners desire that their lands become a part of the City of Gravette, Arkansas,

3. That the limits of the lands to be annexed have been accurately described and an accurate map thereof has been made and is attached to this petition.
4. That Michael von Ree, is herein designated as the person authorized to act on the behalf of the Petitioners.
5. WHEREFORE, Petitioners pray that this court enter its Order annexing the above described real estate to the City of Gravette, Arkansas, and for all other relief to which they may prove themselves entitled.

2015 OCT 17 AM 11:20
 TENA O'BRIEN
 COUNTY CLERK
 BENTON COUNTY, ARK.

Signed Petition attached.

THE COURT DOTH FURTHER ORDER that the County Clerk, after properly recording this Order, deliver one certified copy thereof to the City of Gravette, Arkansas.

After thirty (30) days from entry of this Order, if no challenge to this Order has been initiated in the Circuit Court, the City of Gravette may adopt an ordinance or resolution accepting the property annexed by this Order. Upon doing so, the City of Gravette shall return one certified copy of its ordinance or resolution to the County Clerk.

Thereafter, the County Clerk shall deliver one copy each of this Order and the ordinance or resolution of the City of Gravette accepting this annexation to the Secretary of State, and one copy to the Director of the Tax Division of the Arkansas Public Service Commission.

 ROBERT D. CLINARD, COUNTY JUDGE

STATE OF ARKANSAS)
 COUNTY OF BENTON)
 I, TENA O'BRIEN, Clerk of the County and Probate Courts
 in and for the County and State aforesaid, do hereby certify
 that this instrument of writing is a true and complete copy,
 and the same appears of record in County Court
 Book 2015 Page 2479 being on file in my said office.
 I have hereunto set my hand and official seal this 10th
 day of November, 20 15
 TENA O'BRIEN, Clerk
 Benton County Arkansas
 By B. Barrett

ORDINANCE NO. 15-21 2015 OCT 23 PM 12:07

AN ORDINANCE APPROVING THE VOLUNTARY ANNEXATION OF CERTAIN LANDS INTO THE CITY OF GRAVETTE, ARKANSAS.

WHEREAS, property owners contiguous to the City of Gravette, Arkansas have signed a petition to annex said property into the City of Gravette, Arkansas, and

WHEREAS, the land is further described by metes and bounds in said decree of annexation as attached herewith as Exhibits "A", and

WHEREAS, said petition has been reviewed and approved by County Judge Bob Clinard in an open hearing on September 17, 2015, and

WHEREAS, these lands are contiguous to the City of Gravette, Arkansas, and

WHEREAS, at least 51% of the property owners affected have signed said petition, and at least 51% of the land is owned by the petitioners, and

WHEREAS, annexation of said property is necessary for the future growth of the City of Gravette, Arkansas, and

WHEREAS, annexation of said property is necessary to provide adequate police and fire protection for the citizens in the affected area, and

WHEREAS, a public hearing was held at a special meeting of the Gravette City Council on October 22, 2015, and

WHEREAS, following said public hearing, the City Council for the City of Gravette, Arkansas voted to approve the annexation petition as presented.

NOW, THEREFORE, BE IT ORDAINED BY THE CITY COUNCIL FOR THE CITY OF GRAVETTE, ARKANSAS:

SECTION 1: That annexation of said property as described in Exhibit "A" as attachments to this Ordinance is approved by the City Council of the City of Gravette.

SECTION 2: That the Mayor and City Recorder be and are hereby authorized and directed to evidence the acceptance of said petition by certifying said acceptance on the approved petition for annexation.

SECTION 3: If any section or provision of this Ordinance shall be held to be unconstitutional or invalid for any reason, such holding shall not render the remaining sections or provisions of this Ordinance unconstitutional or affect the validity of the same.

SECTION 4. That this Ordinance is necessary for timely annexation of the above lands and an emergency is therefore deemed to exist and this ordinance shall be in full force and effect from and after the date of its passage.

2015 OCT 23 PM 12:08
TENA O'BRIEN
CLERK
BENTON COUNTY, ARK

PASSED AND APPROVED THIS 22nd DAY OF October, 2015

APPROVED:

MAYOR

ATTEST:

CITY RECORDER

STATE OF ARKANSAS
CITY OF GRAVETTE
CERTIFICATE OF RECORDER
I, Mike VonRee, Recorder of the City of Gravette, Benton County, Arkansas
In and for the City of the State aforesaid, do hereby certify that this
instrument of writing is a true and complete copy, and the same appears of
record of Gravette East Annexation
being on file in my said office. I have here unto set my hand this 22nd
day of October, 2015
Mike VonRee, Recorder
City of Gravette, Benton County, AR
By 

STATE OF ARKANSAS
COUNTY OF BENTON
CERTIFICATE OF CLERK
I, TENA O'BRIEN, Clerk of the County and Probate Courts
in and for the County and State aforesaid, do hereby certify
that this instrument of writing is a true and complete copy,
and the same appears of record in County Court
Book 2015 Page 2733 being on file in my said office.
I have hereunto set my hand and official seal this 10th
day of November, 2015
TENA O'BRIEN, Clerk
Benton County Arkansas
By B. Barrett

2015 2733