

BENTON COUNTY

STATE OF ARKANSAS

BENTONVILLE, ARKANSAS 72712

MARY L. SLINKARD
COUNTY AND PROBATE CLERK
VOTER REGISTRAR

COURTHOUSE ROOM #202
102 N.E. "A" STREET
TELEPHONE (501) 271-1013 FAX (501) 271-1019

March 6, 1995

Tax Division
Arkansas Public Service Commission
1000 Center Street
2nd Floor - North
Little Rock, AR 72202

Handwritten:
~~Handwritten notes~~
0-1-1995

Re: Dorothy Hamilton, et al
Gravette Annexation
Benton County Case No. CC 94-34

Gentlemen:

As required by law, I am enclosing a copy of the Order of Annexation with maps (survey and vicinity map) attached regarding the above annexation.

If you need anything further, please let me know.

Very truly yours,

Mary L. Slinkard

Mary L. Slinkard

MS

Enclosures

cc: ✓ Shirley Sandlin
Benton County Assessor
Bentonville, AR 72712

Nancy Wood
NW Arkansas Regional Planning Commission
P. O. Box 745
Springdale, AR 72765

11-14-20-30

CC 94-34

Gravette 95-10

'95 JAN 11 PM 2 00

MARY L. SLINKARD
CO. & PROBATE CLERK
BENTON COUNTY, ARK.

IN THE COUNTY COURT OF BENTON COUNTY, ARKANSAS

IN THE MATTER OF ANNEXING TO
THE CITY OF GRAVETTE, ARKANSAS
CERTAIN PROPERTY CONTIGUOUS TO
SAID CITY OF GRAVETTE, ARKANSAS

NO CC- 94-34

CITY OF GRAVETTE, AN ARKANSAS
MUNICIPAL CORPORATION,
(ON BEHALF OF DOROTHY HAMILTON,
ROBERT MARTIN, ROBERT SOOTER, AND
MARGARET MARTIN, AND LEROY B. BEILER,
PATRICIA A. BEILER), ROBERT K. THOMPSON.
CHERYL H. THOMPSON, HOUPE'S ELECTRONICS,
MARY FLO EDMINSTON

PETITIONERS

ANNEXATION ORDER

Now on this 11th day of January, 1995, the same being a regular day of the County Court of Benton County, Arkansas, comes on for Public Hearing the Petition for Annexation filed herein on the 9th day of December, 1994, notice of this hearing have been published for the time and in the manner required by law, as evidenced by the Certificate of Publication filed herein, and the Petitioners, having appeared by their attorney, Kevin J. Pawlik, and no other person having appeared to either object to or support the Petition For Annexation filed herein, and after being well and sufficiently advised both as to law and as to the facts, the Court does find and order as follows:

1. That the Petitioners are the majority owners of the land sought to be annexed, which is more particularly described as follows, to wit:

✓ THE NORTHWEST 1/4 OF THE SOUTHWEST 1/4 OF SECTION 11, TOWNSHIP 20 NORTH RANGE 33 WEST; AND COMMENCING AT THE NORTHEAST CORNER OF THE SOUTHEAST 1/4 OF THE SOUTHWEST 1/4 OF SECTION 11, TOWNSHIP 20 NORTH RANGE 33 WEST, RUN

95 0047

'95 JAN 11 PM 2 0

MARY L. SUNKARD
CO. & PROBATE CLERK
BENTON COUNTY, ARK

P1 → ⁷⁶² THENCE SOUTH 254 YARDS, MORE OR LESS, TO AUSTIN LAND; THENCE WEST 600 FEET; THENCE NORTH TO THE NORTH LINE OF SAID SOUTHEAST 1/4 OF THE SOUTHWEST 1/4; THENCE EAST 600 FEET TO THE PLACE OF BEGINNING;

P2 → AND PART OF THE SOUTHEAST 1/4 OF THE SOUTHWEST 1/4 OF SECTION 11, TOWNSHIP 20 NORTH RANGE 33 WEST DESCRIBED AS BEGINNING 420 EAST OF THE NORTHWEST CORNER OF THE SAID SOUTHEAST 1/4 OF THE SOUTHWEST 1/4, THENCE SOUTH 568 FEET; THENCE NORTH OF EAST 300 FEET; THENCE IN A NORTHERLY DIRECTION 552 FEET TO THE NORTH LINE OF THE SAID SOUTHEAST 1/4 OF THE SOUTHWEST 1/4; THENCE WEST 300 FEET TO THE PLACE OF BEGINNING;

P3 → AND PART OF THE SOUTHEAST 1/4 OF THE SOUTHWEST 1/4 SECTION 11, TOWNSHIP 20 NORTH RANGE 33 WEST, DESCRIBED AS BEGINNING AT A POINT 420 FEET SOUTH 89 DEGREE 58'31" EAST AND 560.04 FEET SOUTH 00 DEGREES 47'17" WEST OF THE NORTHWEST CORNER OF THE SAID SOUTHEAST 1/2 OF THE SOUTHWEST 1/4; THENCE SOUTH 89 DEGREES 58'31" EAST 296.66 FEET; THENCE SOUTH 01 DEGREES 07'48" WEST 287.97; THENCE SOUTH 87 DEGREES 06'18" WEST 295.52 FEET; THENCE NORTH 00 DEGREES 47'17" EAST 303.00 FEET TO THE POINT OF BEGINNING;

P4 → AND PART OF THE SOUTHEAST 1/4 OF THE SOUTHWEST 1/4 OF SECTION 11, TOWNSHIP 20 NORTH RANGE 33 WEST, DESCRIBED AS BEGINNING 200 FEET EAST OF THE NORTHWEST CORNER OF THE SAID SOUTHEAST 1/4 OF THE SOUTHWEST 1/4; THENCE EAST 130 FEET THENCE SOUTH 872 FEET; THENCE WESTERLY TO A POINT DUE SOUTH OF THE PLACE OF BEGINNING; THENCE NORTH 878 FEET TO THE PLACE OF BEGINNING;

P5 → AND BEGINNING AT THE SOUTHWEST CORNER OF SAID SOUTHEAST 1/4 SOUTHWEST 1/4 SECTION 11; THENCE NORTH 00 DEGREES 19'43" WEST 429.00 FEET; THENCE NORTH 75 DEGREES 55'39" EAST 514.10 FEET; THENCE SOUTH 00 DEGREES 19'43" EAST 549.67 FEET TO THE CENTERLINE OF THE COUNTY ROAD; THENCE SOUTH 89 DEGREES 30'09" WEST 499.39 FEET ALONG SAID CENTERLINE TO THE POINT OF BEGINNING, SUBJECT TO THE RIGHT-OF-WAY OF SAID ROAD.

AND PART OF THE SOUTHWEST 1/4 OF THE SOUTHWEST 1/4, SECTION 11, TOWNSHIP 20 NORTH, RANGE 33 WEST, DESCRIBED AS BEGINNING 190 FEET SOUTH

MARY L. SPINKARD
CO. & PROBATE CLERK
BENTON COUNTY, ARK.

P6 →

AND 100 FEET WEST OF THE NORTHEAST CORNER THEREOF, THENCE NORTH 150 FEET, THENCE WEST 30 FEET, THENCE SOUTH 366 FEET, THENCE EAST 30 FEET, THENCE NORTH 216 FEET TO THE POINT OF BEGINNING.

P7 →

PART OF THE SOUTHWEST 1/4 OF THE SOUTHWEST SECTION II, TOWNSHIP 20, RANGE 33, AND PART OF THE WEST 1/2 OF THE NORTHWEST 1/4, SECTION 14, TOWNSHIP 20 NORTH, RANGE 33 WEST, BEGINNING 406 FEET SOUTH OF THE NORTHEAST CORNER OF THE SAID SOUTHWEST 1/4 OF THE SOUTHWEST 1/4, SOUTH 2284 FEET, WEST 50 FEET, NORTH 1667 FEET, WEST 303.1 FEET, NORTH 617 FEET, EAST 353.1 FEET, TO THE POINT OF BEGINNING.

P8 →

PART OF THE NORTHWEST 1/4 OF THE NORTHWEST 1/4 OF SECTION 14, TOWNSHIP 20 NORTH, RANGE 33 WEST, DESCRIBED AS BEGINNING 421.21 FEET SOUTH 00 DEGREES 01'34" EAST OF THE NORTHEAST CORNER OF THE SAID NORTHWEST 1/4 OF THE NORTHWEST 1/4; THENCE SOUTH 00 DEGREES 01'34" EAST 284.68 FEET; THENCE NORTH 88 DEGREES 38'33" WEST 341/95 FEET, THENCE NORTH 02 DEGREES 51'17" EAST 292.55 FEET TO A COUNTY ROAD, THENCE ALONG SAID ROAD SOUTH 87 DEGREES 16'20" EAST 327.53 FEET, TO THE POINT OF BEGINNING. SUBJECT TO COUNTY ROAD ON THE NORTH SIDE THEREOF.

2. That the limits of the lands to be annexed have been accurately described and an accurate map thereof has been made and filed herein.

3. That the request of the Petitioner for annexation of this land into the City of Gravette, Arkansas is right and proper and the Petitioner's request should be granted.

IT IS, THEREFORE, ORDERED that the above described property is hereby annexed into the City of Gravette, Arkansas and this Order shall be recorded in the office of the County Clerk of Benton County, Arkansas.

 COUNTY JUDGE
[Signature]
95 0049

FILED

'94 DEC 9 PM 4 10

MARY L. SLINKARD
CO. & PROBATE CLERK
BENTON COUNTY, ARK.

72

Blue line-city limits
Green-area to be annexed

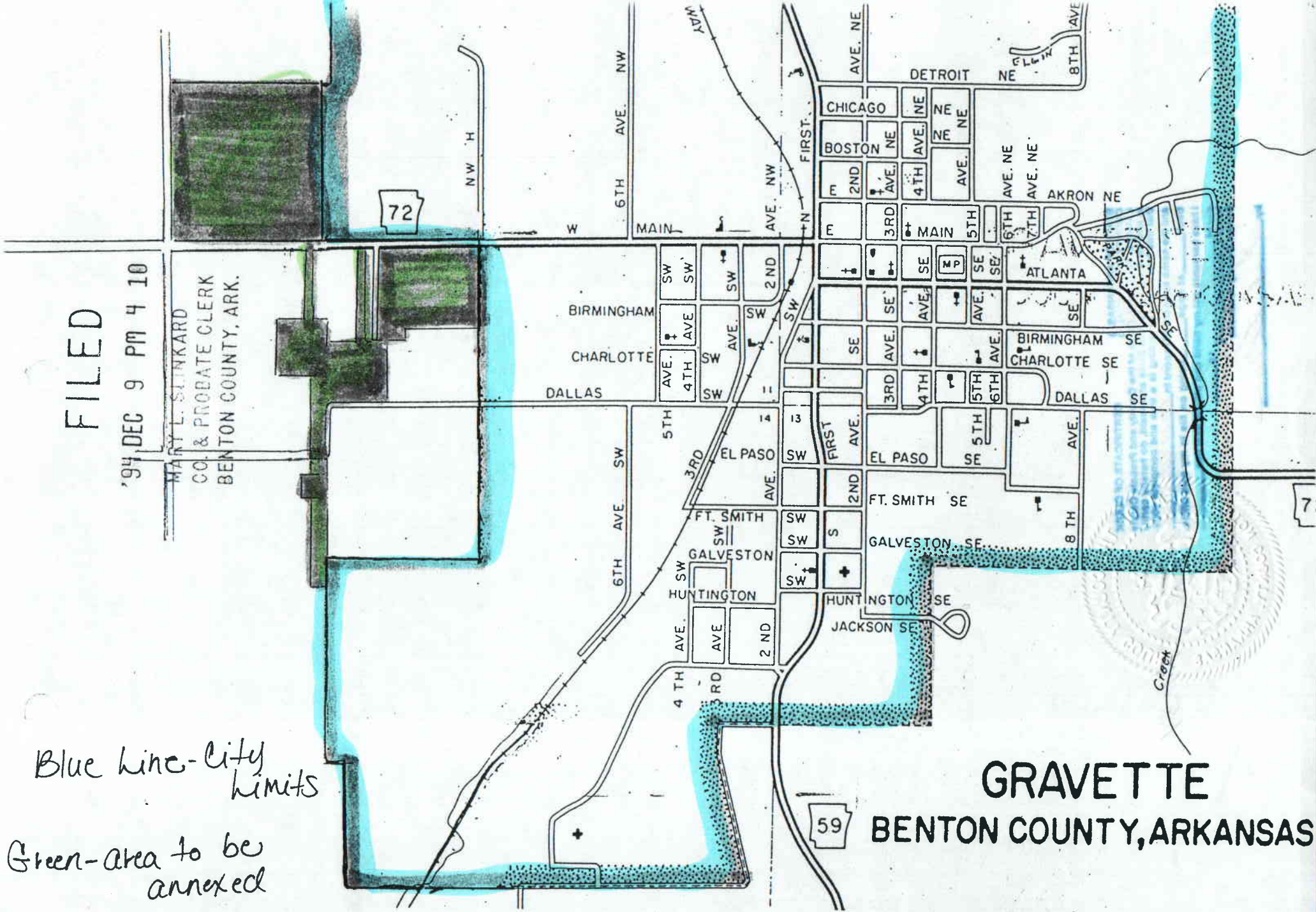

GRAVETTE
BENTON COUNTY, ARKANSAS

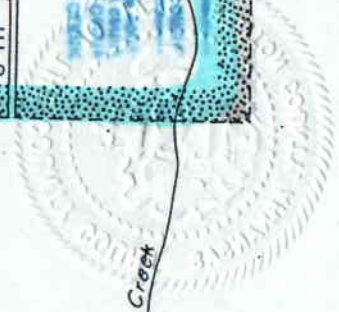

BENTON COUNTY

STATE OF ARKANSAS

BENTONVILLE, ARKANSAS 72712

MARY L. SLINKARD
COUNTY AND PROBATE CLERK
VOTER REGISTRAR

May 24, 1995

COURTHOUSE ROOM #202
102 N.E. "A" STREET
TELEPHONE (501) 271-1013
FAX (501) 271-1019

Tax Division
Arkansas Public Service Commission
1000 Center Street
2nd Floor - North
Little Rock, AR 72202

RE: Gravette Annexation
Dorothy Hamilton, et al
Benton County Case No. CC 94-34

Gentlemen:

Enclosed please a certified copy of Gravette City Ordinance No. 95-10 which corrects a scrivener's error in their City Ordinance No. 95-5.

If you have any questions regarding this matter, please do not hesitate to contact me.

Very truly yours,



Mary L. Slinkard
County Clerk

64 J.O

Enclosures

cc: ✓ Shirley Sandlin
Benton County Assessor

Nancy Wood
NW Arkansas Regional Planning Commission
P.O. Box 745
Springdale, AR 72765

CC 94-34

'95 MAY 3 PM 4 14

MARY L SWINKARD
CLERK & PROBATE CLERK
BENTON COUNTY, ARK.

ORDINANCE NO. 95-10

AN ORDINANCE AMENDING ORDINANCE NO. 95-5 TO CORRECT AND ERROR
IN DESCRIPTION, ANNEXING CERTAIN REAL PROPERTY TO THE CITY OF
GRAVETTE, ARKANSAS, ASSIGNING THE SAME TO WARDS AND DECLARING AN
EMERGENCY.

WHEREAS, the owners of the hereinafter described real property
have filed a petition in the County Court of Benton County,
Arkansas requesting the annexation into the City of Gravette,
Arkansas of the following described real property situate in Benton
County, Arkansas, to-wit:

THE NORTHWEST 1/4 OF THE SOUTHWEST 1/4 OF SECTION 11,
TOWNSHIP 20 NORTH, RANGE 33 WEST; AND COMMENCING AT THE
NORTHEAST CORNER OF THE SOUTHWEST 1/4 OF THE SOUTHWEST
1/4 OF SECTION 11, TOWNSHIP 20 NORTH, RANGE 33 WEST, RUN
THENCE SOUTH 254 YARDS, MORE OR LESS, TO AUSTIN LAND;
THENCE WEST 600 FEET; THENCE NORTH TO THE NORTH LINE OF
SAID SOUTHWEST 1/4 OF THE SOUTHWEST 1/4; THENCE EAST 600
FEET TO THE PLACE OF BEGINNING;

AND PART OF THE SOUTHWEST 1/4 OF THE SOUTHWEST 1/4 OF
SECTION 11, TOWNSHIP 20 NORTH, RANGE 33 WEST, DESCRIBED
AS BEGINNING 420 FEET EAST OF THE NORTHWEST CORNER OF THE
SAID SOUTHWEST 1/4 OF THE SOUTHWEST 1/4, THENCE SOUTH 568
FEET; THENCE NORTH OF EAST 300 FEET; THENCE IN A
NORTHERLY DIRECTION 552 FEET TO THE NORTH LINE OF THE
SAID SOUTHWEST 1/4 OF THE SOUTHWEST 1/4; THENCE WEST 300
FEET TO THE PLACE OF BEGINNING;

AND PART OF THE SOUTHWEST 1/4 OF THE SOUTHWEST 1/4
SECTION 11, TOWNSHIP 20 NORTH, RANGE 33 WEST, DESCRIBED
AS BEGINNING AT A POINT 420 FEET SOUTH 89 DEGREES 58'31"
EAST AND 560.04 FEET SOUTH 00 DEGREES 47'17" WEST OF THE
NORTHWEST CORNER OF THE SAID SOUTHWEST 1/4 OF THE
SOUTHWEST 1/4; THENCE SOUTH 89 DEGREES 58'31" EAST 296.66
FEET; THENCE SOUTH 01 DEGREES 07'48" WEST 287.97 FEET;
THENCE SOUTH 87 DEGREES 06'18" WEST 287.97; THENCE NORTH
00 DEGREES 47'17" EAST 303.00 FEET TO THE POINT OF
BEGINNING;

295.52 on 94-34

AND PART OF THE SOUTHWEST 1/4 OF THE SOUTHWEST 1/4 OF
SECTION 11, TOWNSHIP 20 NORTH, RANGE 33 WEST, DESCRIBED
AS BEGINNING 200 FEET EAST OF THE NORTHWEST CORNER OF THE
SAID SOUTHWEST 1/4 OF THE SOUTHWEST 1/4; THENCE EAST 130
FEET THENCE SOUTH 872 FEET; THENCE WESTERLY TO A POINT

MARY L. SPINKARD
 CO. & FREIGHT CLERK

DUE SOUTH OF THE PLACE OF BEGINNING; THENCE NORTH 87°8' ARK.
 FEET TO THE PLACE OF BEGINNING;

AND BEGINNING AT THE SOUTHWEST CORNER OF SAID SOUTHEAST 1/4 SOUTHWEST 1/4 SECTION 11; THENCE NORTH 00 DEGREES 19'43" WEST 429.00 FEET; THENCE NORTH 75 DEGREES 55'39" EAST 514.10 FEET; THENCE SOUTH 00 DEGREES 19'43" EAST 549.67 FEET TO THE CENTERLINE OF THE COUNTY ROAD; THENCE SOUTH 89 DEGREES 30'09" WEST 499.39 FEET ALONG SAID CENTERLINE TO THE POINT OF BEGINNING, SUBJECT TO THE RIGHT-OF-WAY OF SAID ROAD.

AND PART OF THE SOUTHWEST 1/4 OF THE SOUTHWEST 1/4, SECTION 11, TOWNSHIP 20 NORTH, RANGE 33 WEST, DESCRIBED AS BEGINNING 190 FEET SOUTH AND 100 FEET WEST OF THE NORTHEAST CORNER THEREOF, THENCE NORTH 150 FEET, THENCE WEST 30 FEET, THENCE SOUTH 366 FEET, THENCE EAST 30 FEET, THENCE NORTH 216 FEET TO THE POINT OF BEGINNING.

PART OF THE SOUTHWEST 1/4 OF THE SOUTHWEST 1/4, SECTION 11, TOWNSHIP 20, RANGE 33 WEST, AND PART OF THE WEST 1/2 OF THE NORTHWEST 1/4, SECTION 14, TOWNSHIP 20 NORTH, RANGE 33 WEST, BEGINNING 406 FEET SOUTH OF THE NORTHEAST CORNER OF THE SAID SOUTHWEST 1/4 OF THE SOUTHWEST 1/4, SOUTH 2284 FEET, WEST 50 FEET, NORTH 1667 FEET, WEST 303.1 FEET, NORTH 617 FEET, EAST 353.1 FEET, TO THE POINT OF BEGINNING.

PART OF THE NORTHWEST 1/4 OF THE NORTHWEST 1/4 OF SECTION 14, TOWNSHIP 20 NORTH, RANGE 33 WEST, DESCRIBED AS BEGINNING 421.21 FEET SOUTH 00 DEGREES 01'34" EAST OF THE NORTHEAST CORNER OF THE SAID NORTHWEST 1/4 OF THE NORTHWEST 1/4; THENCE SOUTH 00 DEGREES 01'34" EAST 284.68 FEET; THENCE NORTH 88 DEGREES 38'33" WEST 341.95 FEET, THENCE NORTH 02 DEGREES 51'17" EAST 292.55 FEET TO A COUNTY ROAD THENCE ALONG SAID ROAD SOUTH 87 DEGREES 16'20" EAST 327.53 FEET, TO THE POINT OF BEGINNING SUBJECT TO COUNTY ROAD ON THE NORTH SIDE THEREOF.

WHEREAS, on the 11th day of January, 1995, the County Court of Benton County, Arkansas duly issued an Order annexing the above described property to the City Gravette, Arkansas, and;

WHEREAS, on the 16th day of January, 1995, the City Council passed Ordinance No. 95-5 which contained certain errors in the description of property contained therein and it is necessary that a new Ordinance should be passed amending said Ordinance No. 95-5: and;

FILED

WHEREAS, the City Council of the City of Gravette, Arkansas has determined that the above described property real property should be accepted into the City of Gravette, Arkansas.

95 APR 9 PM 4 14
MAYOR L. HOWARD
CITY CLERK
BENTON COUNTY, ARK.

NOW, THEREFORE, BE IT ORDAINED BY THE CITY COUNCIL OF THE CITY OF GRAVETTE, ARKANSAS:

Section 1. That Ordinance 95-5 be amended as set forth here ~~and~~ ⁱⁿ above to correct the description of property covered by the annexation petition and the Order of Annexation, and the above described real property is hereby accepted into the City of Gravette, Arkansas, and shall hereafter be a part of the City of Gravette, Arkansas, and all persons residing hereon shall be citizens of and qualified voters of the City of Gravette, Arkansas, and shall be designated as voters of Ward One. This Ordinance shall refer back to and be in effect as of the 16th day of February, 1995.

Section 2. This Ordinance is necessary to preserve the public peace, health, safety and welfare and because of such an emergency is declared to exist and this Ordinance shall be in full force and effect from and after the date of this passage.

PASSED AND APPROVED THIS 6th DAY OF April, 1995.

APPROVED:

Bill Howard
MAYOR

ATTEST:

Doris A. Raby
CITY RECORDER



RECORDED
INDEXED
APR 10 1995
BENTON COUNTY, ARKANSAS
CITY CLERK'S OFFICE