



ARKANSAS SECRETARY OF STATE

MARK MARTIN

July 14., 2016

Ms. Stephanie Sharp
Recorder/Treasurer City of Greenland
P.O. 67
Greenland, AR 72737

Re: City of Little Flock Annexation Ordinance 2015-001

Dear Ms. Sharp,

This letter acknowledges receipt and filing of the following notice of municipal boundary change by the Office of the Secretary of State:

Filing Type: Annexation pursuant to A.C.A § 14-40-602 (annexation by petition of a majority land owners)

Effective Date: unknown

County: Washington

City: Greenland

City Ordinance: 271

Dated: 06/08/2008

County Court Order: N/A

A file marked copy of the ordinance and exhibits submitted to our Office along with the GIS Office map are enclosed. By copy of this letter (and its enclosures), the Secretary of State hereby notifies the appropriate mapping authorities for Arkansas. Please retain these copies as official record of the filing of the municipal boundary change by the Arkansas Secretary of State.

If you have any questions or concerns regarding this pending filing please contact our office at 501-682-3401.

Sincerely,

A handwritten signature in cursive script that reads "Cynthia Fisher".

Cynthia Fisher
Special Projects Manager
Arkansas Secretary of State Legal Division
500 Woodlane St, Suite 256
Little Rock, AR 72201
501-682-3401

Cc: ✓ Arkansas Geographic Information Systems Office (w/ encl)
Arkansas Highway and Transportation Department Mapping Department (w/ encl)
UALR Institution for Economic Advancement (w/encl)
Tom-Tom (w/encl)
Hon. Becky Lewallen, Washington County Clerk (w/encl)

Room 256 State Capitol • Little Rock, Arkansas 72201-1094
501-682-1010 • Fax 501-682-3510
e-mail: arsos@sos.arkansas.gov • www.sos.arkansas.gov





Arkansas Secretary of State

Mark Martin Arkansas Secretary of State, 500 Woodlane Ave, Little Rock, AR 72201-1094

Municipal Boundary Change Checklist

County: Washington City/Town: Greenland

City Ordinance/Resolution No: 271 Date approved: 06/08/2008

County Court Case No: _____ Date of Order: _____

Type: Annexation by Petition majority of Landowners A.C.A §14-40-602

Date Change Effective: _____ Emergency clause: Yes No

For Circuit Court Challenge: Date Filed: _____ Upheld Overturned Other (attach explanation)

Initiating party:

All Landowners Majority Landowners Municipal Governing Body State Other _____

Supporting Documentation attached (check all that apply):

- File marked copy of City Ordinance/Resolution (not required for A.C.A § 14-40-1801)
- File marked copy of County Court Order (not required for A.C.A. § 14-40-501)
- Proof of Publication for all Legal Notices (Hearing, Election, City Ordinance/Resolution)
- Copy of Arkansas GIS approved printed map and certification letter
- File marked copy of Petition Part or File marked copy of the certified special election results (if applicable)
- File marked copy of Complaint and final Circuit Court Order (Court Challenge only)

Municipal Contact:

Name: Stephanie Sharp Title: Greenland Recorder/Treasurer

Street Address: P.O. Box 67

City: Greenland St: AR Zip code: 72737

City/County Official:

Signature: _____ Title: _____

Date: _____

Complete one form for each ordinance/resolution and attach it as a cover page to the supporting document set. Submit the documents to Arkansas Secretary of State, Atten: Municipal Boundary Filing, 500 Woodlane Ave, Little Rock, AR 72201-1094

Office of the Arkansas Secretary of State use only

F I L E D

JUL 14 2016

Received by: Cynthia Fisher

Arkansas
Secretary of State

City of Greenland

Stephanie Sharp
Recorder / Treasurer
8 Ross St.
PO Box 67
Greenland, AR 72737

Telephone (479) 521-5760
Fax (479) 521-7780

June 30, 2016

Mr. Martin,

Our city attorney attended a meeting recently where a representative from your office, AJ Kelly spoke. Per our city attorney's advice, I am sending you a copy of an annexation that the city of Greenland did in June of 2008. It was filed with the county but we were advised to send you a copy in the event that you did not receive the information. This is the only one done in the city of Greenland in the past 8 years.



Stephanie Sharp
Recorder/Treasurer
City of Greenland

F I L E D

JUL 14 2016

Arkansas
Secretary of State



Doc ID: 012380150004 Type: REL
Recorded: 07/16/2008 at 10:33:13 AM
Fee Amt: \$30.00 Page 1 of 4
Washington County, AR
Bette Stamps Circuit Clerk

File **2008-00023392**

ORDINANCE NO. 271

AN ORDINANCE ANNEXING TO THE CITY OF GREENLAND, ARKANSAS, A TRACT OF LAND IDENTIFIED IN "ORDER" ENTERED APRIL 22, 2008, BY HONORABLE JERRY HUNTON IN CASE NO. CC-2008-4 IN THE COUNTY COURT OF WASHINGTON COUNTY, ARKANSAS, AND FOR OTHER PURPOSES.

2008 JUL 16 AM 10:34
FILED
CLERK OF COURT
CO. & PROBATE CLERK
WASHINGTON COUNTY

WHEREAS, over fifty percent (50%) of the owners of over fifty percent (50%) of the property described at Exhibit A hereto, which tract is adjacent to the City of Greenland, Arkansas, desire to be annexed into the City of Greenland, and is described as follows, to-wit:

Please See Exhibit "A" for Legal Description and Exhibit "B" for Map.

WHEREAS, the majority of the owners who own the majority of the land described at Exhibit A, have requested that the above described tract of real property be annexed to the City of Greenland, Arkansas.

WHEREAS, the majority of the owners of a majority of the land described at Exhibit A, prosecuted an action before the County Court of Washington County, Arkansas, securing an "Order" on April 22, 2008.

WHEREAS, said property meets at least two of the Vestal criteria in that it is being held for sale or use as municipal lots and/or suburban property and that it represents the actual growth of the City of Greenland beyond its legal boundary.

BE IT ORDAINED BY THE CITY COUNCIL OF THE CITY OF GREENLAND, ARKANSAS,

F I L E D
JUL 14 2016
Arkansas
Secretary of State

SECTION 1: That the tract of land described at Exhibit A hereto and situate in Washington County, Arkansas is hereby accepted as an annexation to the City of Greenland, Arkansas.

SECTION 2: It is hereby determined that the tract of real property is contiguous and adjacent to other lands in Greenland, Arkansas, which are located in Ward 4, and therefore such tract of land described at Exhibit A is determined and declared to all be in Ward 4, of the City of Greenland.

SECTION 3: The official Zoning Districts map of the City of Greenland, Arkansas, is hereby amended to show the annexation to the City of the tract of real property described at Exhibit A and such tract is hereby zoned A-1.

PASSED AND APPROVED this 9th day of June, 2008.



JOHN GRAY, Mayor

ATTEST:



DONNA CHEEVERS, Recorder/Treasurer



F I L E D

JUL 14 2016

Arkansas
Secretary of State

EXHIBIT A

Land situate in Washington County, Arkansas, and contiguous to Greenland, to wit:

Starting at the NW corner of the SE1/4 NW1/4 of S8, T15N, R30W; thence S 02°12'00" W 67.7 feet; thence S 89°41'06" E 1 foot to the point of beginning on the Greenland city limit line; thence S 87°38'22" E 178.8 feet; thence N 05°10'27" W 36.5 feet to the city limit line; thence running along the city limit line S 75°27'35" E 3.9 feet; thence S 66°13'54" E 43.35 feet; thence S 00°16'12" E 19.55 feet; thence S 87°46'58" E 75.13 feet to the city limit line; thence along the city limit line S 80°04'29" E 25.62 feet; thence S 80°56'56" E 80.08 feet to the E line of the SE1/4 NW1/4 of S8, T15N, R30W; thence S 81°23'09" E 84.82 feet; thence S 87°38'50" E 17.89 feet; thence S 87°38'50" E 15.712 feet; thence N 89°37'46" E 131.04 feet; thence S 02°15'38" W 72.14 feet; thence S 87°32'45" E 141.83 feet; thence S 03°04'07" W 91.93 feet; thence N 88°17'00" E 10.95 feet to the E line of the SW1/4 NE1/4 of said S8; thence running southerly along said line S 02°06'35" W 145.09 feet; thence N 87°51'23" W 682.22 feet; thence S 00°57'29" W 133.62 feet; thence N 86°47'09" W 121.89 feet; thence S 02°16'49" W 281.79 feet to the city limit line; thence S 87°38'17" E 54.51 feet along said line; thence S 36°46'40" E 73.09 feet; thence S 31°29'18" E 20.34 feet; thence S 23°35'22" E 19.655 feet; thence S 14°16'44" B 27.468 feet; thence S 09°54'51" E. 159.37 feet; thence N 87°06'02" W 560.675 feet to the E line of S7, T15N, R30W; thence southerly along said line S 02°18'59" W 133.41 feet; thence N 86°49'12" W 187.31 feet; thence N 11°12'44" E 1217.759 feet to the NW corner of the SW1/4 NW1/4 of S8, T15N, R30W, same point being on the city limit line; thence southerly along said line S 02°24'52" W 403.026 feet; thence S 87°46'01" E 398.864 feet along said line; thence N 02°21'42" E 338.307 feet along said line to the P.O.B., less and except all Arkansas State Highway Commission right-of-way, and containing 159.78 acres more or less.

F I L E D

JUL 14 2016

Arkansas
Secretary of State

Greenland, Arkansas

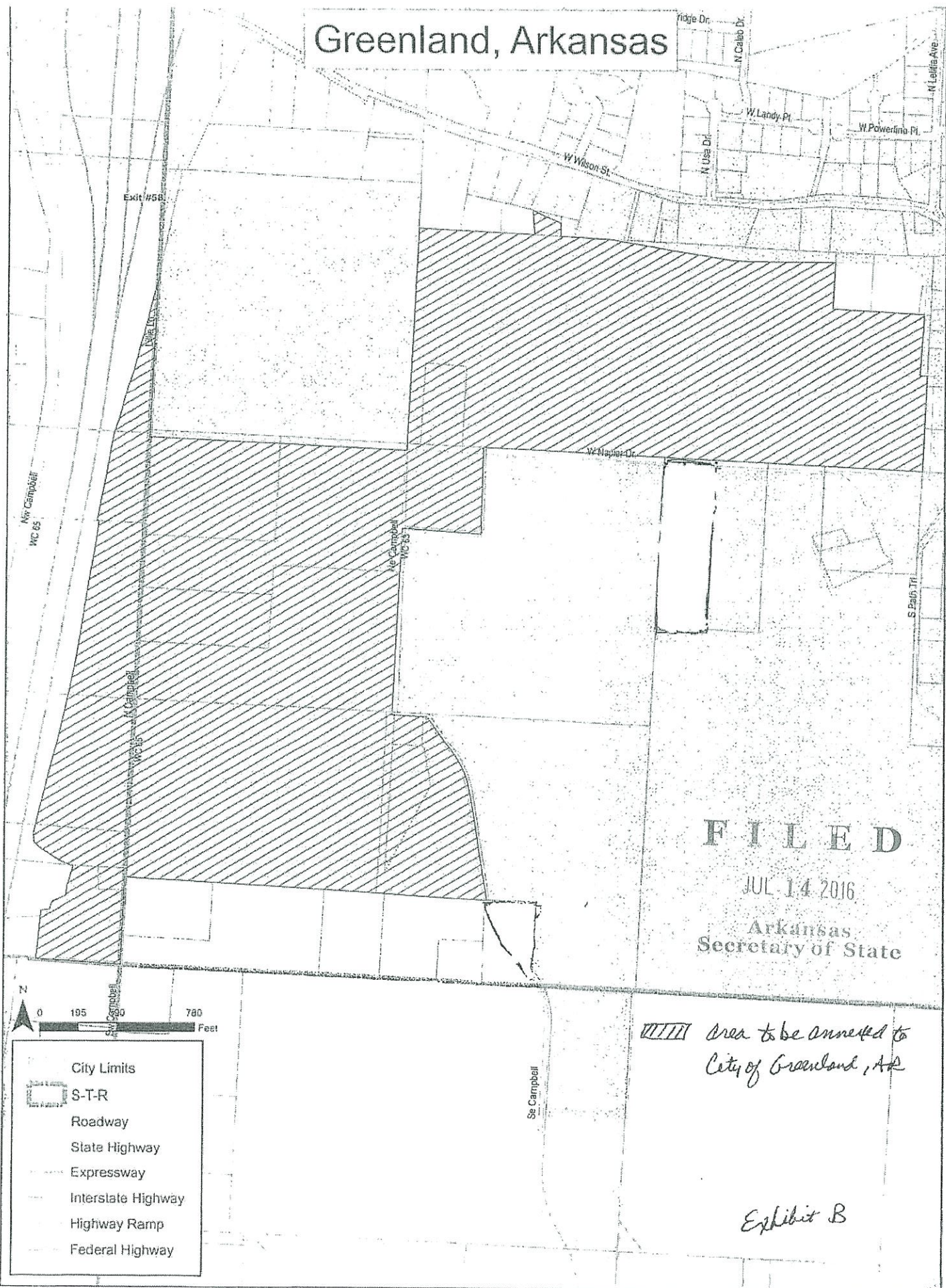

FILED

JUL 14 2016

Arkansas
Secretary of State

*Area to be annexed to
City of Greenland, AR*

Exhibit B



ARKANSAS
GIS OFFICE

July 12, 2016

Mrs. Cynthia Fisher
Special Projects Manager
AR Secretary of State Legal Division

RE: City of Greenland Annexation Coordination Requirement

Mrs. Underwood,

Thank you for coordinating with our office as you seek to annex property into the City of Greenland, AR ordinance no. 271. This letter represents confirmation that you have properly coordinated with our office (Arkansas GIS Office) as specified in § 14-40-101 (Act 914 of 2015) of the 90th General Assembly.

Our office will wait completion of any additional steps necessary for the proposed boundary change, which normally comes from the Arkansas Secretary of State Elections Division after any appropriate filing by your County Clerk.

Thank you,

Richie Pierce, Sr. GIS Analyst
/rp

Attachments:
GIS Office Map of Proposed Annexation
Secretary of State Municipal Change Checklist

FILED

JUL 14 2016

Arkansas
Secretary of State

City: Greenland
 Mayor: Bill Groom

Arkansas Code 14-40-101.

Before an entity undertakes an annexation, consolidation, or detachment, proceeding under this chapter, the entity shall coordinate with the Arkansas Geographic Information Systems Office for preparation of legal descriptions and digital mapping for the relevant annexation, consolidation, and detachment areas.

The map contained herein, is evidence the entity has met requirements of Act 914 of 2015

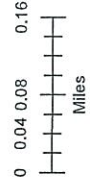
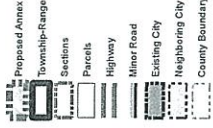

ARKANSAS
 GIS OFFICE

Greenland-20160712

Proposed Annex: City of Greenland
 July 2016

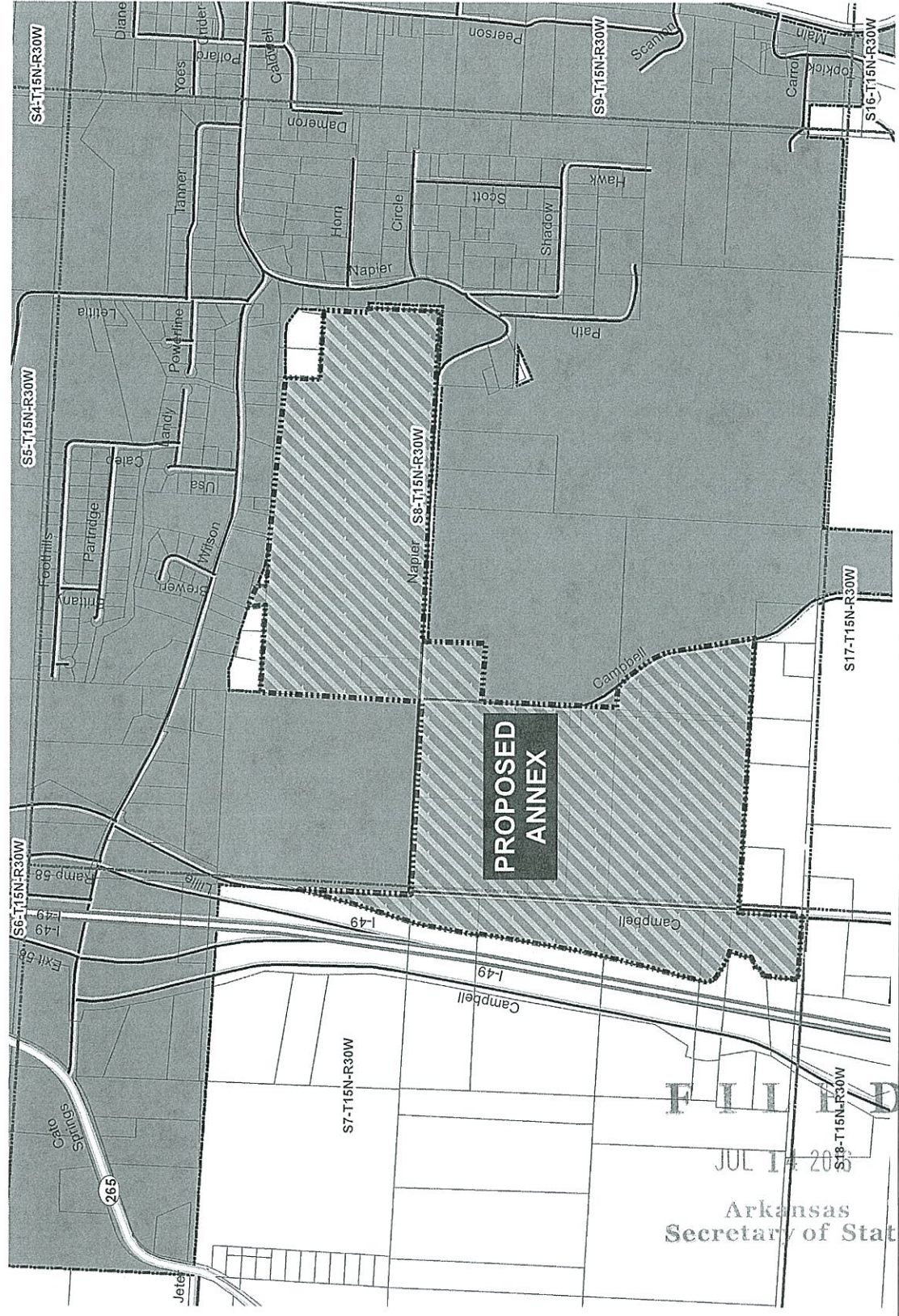

FILED
 JUL 14 2016
 Arkansas
 Secretary of State