



ARKANSAS SECRETARY OF STATE

MARK MARTIN

September 8, 2016

The Honorable Sandra Rodgers
Hempstead County Clerk
P.O. Box 1420
Hope, AR 71802

Re: City of Hope Annexation Ordinance 1620

Dear Ms. Rodgers,

This letter acknowledges receipt and filing of the following notice of municipal boundary change by the Office of the Secretary of State:

Filing Type: Annexation pursuant to A.C.A § 14-40-501 (annexation of surrounded unincorporated areas)
Effective Date: 08/02/2016 (Emergency declared)
County: Hempstead City: Hope
City Ordinance: 1620 Dated: 08/02/2016
County Court Order: N/A

A file marked copy of the ordinance and exhibits submitted to our Office along with the GIS Office map are enclosed. By copy of this letter (and its enclosures), the Secretary of State hereby notifies the appropriate mapping authorities for Arkansas. Please retain these copies as official record of the filing of the municipal boundary change by the Arkansas Secretary of State.

If you have any questions or concerns regarding this pending filing please contact our office at 501-682-3401.

Sincerely,

A handwritten signature in cursive script that reads "Cynthia Fisher".

Cynthia Fisher
Special Projects Manager
Arkansas Secretary of State Legal Division
500 Woodlane St, Suite 256
Little Rock, AR 72201
501-682-3401

Cc: ✓ Arkansas Geographic Information Systems Office (w/ encl)
Arkansas Highway and Transportation Department Mapping Department (w/ encl)
UALR Institution for Economic Advancement (w/encl)
Tom-Tom (w/encl)
Ms. Catherine Cook, Hope City Manager

Room 256 State Capitol • Little Rock, Arkansas 72201-1094
501-682-1010 • Fax 501-682-3510
e-mail: arsos@sos.arkansas.gov • www.sos.arkansas.gov



SEP 06 2016



Arkansas Secretary of State

Mark Martin Arkansas Secretary of State, 500 Woodlane Ave, Little Rock, AR 72201-1094
 Secretary of State

Municipal Boundary Change Checklist

County: Hempstead County City/Town: Hope

City Ordinance/Resolution No: 1620 Date approved: 08/02/2016

County Court Case No: _____ Date of Order: _____

Type: Annexation of surrounded unincorporated area (island/doughnut holes) by ordinance A.C.A. §14-40-501

Date Change Effective: 08/02/2016 Emergency clause: Yes No

For Circuit Court Challenge: Date Filed: _____ Upheld Overturned Other (attach explanation)

Initiating party:

All Landowners Majority Landowners Municipal Governing Body State Other _____

Supporting Documentation attached (check all that apply):

- File marked copy of City Ordinance/Resolution (not required for A.C.A § 14-40-1801)
- File marked copy of County Court Order (not required for A.C.A. § 14-40-501)
- Proof of Publication for all Legal Notices (Hearing, Election, City Ordinance/Resolution)
- Copy of Arkansas GIS approved printed map and certification letter
- File marked copy of Petition Part or File marked copy of the certified special election results (if applicable)
- File marked copy of Complaint and final Circuit Court Order (Court Challenge only)

Municipal Contact:

Name: Catherine Cook Title: City Manager

Street Address: 206 W Ave A

City: Hope St: AR Zip code: 71801

City/County Official:

Signature: Catherine Cook Title: City Manager

Date: 08/28/2016

Complete one form for each ordinance/resolution and attach it as a cover page to the supporting document set. Submit the documents to Arkansas Secretary of State, Atten: Municipal Boundary Filing, 500 Woodlane Ave, Little Rock, AR 72201-1094

Office of the Arkansas Secretary of State use only

Received by: Cynthia Fisher

FILED

SEP 08 2016

Arkansas Secretary of State

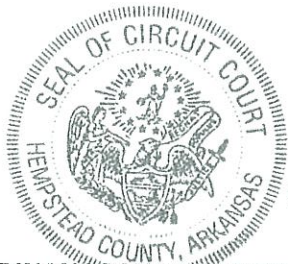

CERTIFICATE OF RECORD
Land Records Book
Filed: 08/26/2016 03:40 pm
Pages: 9
Hempstead County Arkansas
Gail Wolfenbarger Circuit Clerk
Michelle Brown

ORDINANCE NO. 1620

AN ORDINANCE ANNEXING CERTAIN LANDS THAT ARE COMPLETELY SURROUNDED BY THE INCORPORATED LIMITS OF THE CITY OF HOPE, ARKANSAS; DECLARING AN EMERGENCY; AND FOR ~~OTHER~~ D.C. OTHER PURPOSES.

WHEREAS, ACA 14-40-501 – 14-40-503 provides that unincorporated islands of land that have been completely surrounded by the incorporated limits of a municipality may be annexed by that municipality.

WHEREAS, the City of Hope, Arkansas desires to annex certain lands more completely described below; and

WHEREAS, all necessary urban services, such as sanitation, fire and police protection, are to be extended to such areas within a reasonable period of time; and

WHEREAS, the area to be annexed complies with the standards for lands qualifying for annexation which are set forth in ACA 14-40-302 and ACA 14-40-501; and

WHEREAS, a public hearing was held on May 17, 2016, regarding this proposed annexation; and

WHEREAS, on April 26, 2016, legal notice was published setting out the legal description of the territory proposed to be annexed, and all property owners within the area were notified by certified mail of their right to appear at the public hearing.

NOW, THEREFORE, BE IT ORDAINED BY THE CITY COUNCIL OF THE CITY OF HOPE, ARKANSAS:

SECTION 1. That the following described unincorporated areas which is completely surrounded by the city limits of the City of Hope, Arkansas is hereby annexed to the City of Hope, Arkansas.

TRACT "15": All that portion of the following described lands lying North and West of diagonal line running from the Southwest Corner to the Northeast Corner of said NE1/4 NE1/4 of Section 20, Township 12 South, Range 24 West, to-wit: Commencing at the Southwest Corner of said NE1/4 NE1/4, thence run East with the South line of said NE1/4 NE1/4, a distance of 1041.16 feet to a point in the Westerly right-of-way line of Arkansas Highway #29, thence run North 24 degrees 09 minutes West with said Highway right-of-way line, 483.29 feet to the POINT OF BEGINNING: Thence run with said Highway right-of-way line and a curve to the left having a radius of 728.76 feet, an arc distance of 263.29 feet, thence run South 65 degrees 31 minutes West 320.00 feet, thence run South 34 degree 39 minutes East 260.00 feet, thence run South 34 degrees 39 minutes East 260.00 feet, thence run North 65 degrees 51 minutes East 320.00 feet to the POINT OF BEGINNING, and containing 1.92 acres of land, more or less.

SEP 08 2016
Arkansas
Secretary of State

Prepared by:
JR Wilson, Police Chief
PO Box 667
Hope, AR 71802

ALSO All that portion of the following described lands lying North and West of diagonal line running from the Southwest Corner to the Northeast Corner of said NE1/4 NE1/4 of Section 20, Township 12 South, Range 24 West, to-wit: Commencing at the Southwest Corner of said NE1/4 NE1/4, run thence East with the South line of said NE1/4 NE1/4, a distance of 1041.16 feet to a point in the Westerly right-of-way line of Arkansas State Highway #29, thence run North-westerly with said Westerly right-of-way line of Highway #29 the following courses and distances: North 24 degrees 09 minutes West 483.29 feet, thence North 34 degrees 35 minutes West 261.86 feet to THE POINT OF BEGINNING: Run thence South 65 degrees 31 minutes West, 320.00 feet, run thence North 56 degrees 20 minutes West, 149.40 feet, run thence North 66 degrees 27 minutes East, 350.58 feet to a point in said Westerly right of way line of Highway #29, run thence South 46 degrees 13 minutes East, 130.46 feet to the POINT OF BEGINNING, and containing 0.95 acres of land, more or less.

TRACT "16": A tract of land being part of the Northwest Quarter of the Southeast Quarter in Section 21, Township 12 South, Range 24 West and also being the same tracts as recorded in Clerk's Deed of Tax Sale dated November 28, 1979, in Book 499, Page 373 all in Hempstead County, Arkansas, more particularly described as follows: Commence at the Southwest corner of the Northwest Quarter of the Southeast Quarter in Section 21, thence North 00 degrees 18 minutes 00 seconds East 198.00 feet to iron pin set for the POINT OF BEGINNING; thence North 00 degrees 18 minutes 00 seconds East 237.65 feet along and with old fence line to iron pin set at south right-of-way of Hwy. 29 By-Pass; thence South 89 degrees 16 minutes 00 seconds East 332.10 feet along with right-of-way fence to iron pin set; thence South 00 degrees 10 minutes 00 seconds East 233.83 feet along and with old fence to iron pin set; thence North 89 degrees 55 minutes 30 seconds West 334.00 feet along and with old fence to the POINT OF BEGINNING, containing 1.805 acres of land, more or less.

TRACT "17": The South Three (3) acres of the SW1/4 NW1/4 SE1/4 of Section 21, Township 12 South, Range 24 West, more particularly described as follows: Begin at the SW corner of said NW1/4 SE1/4 of said section 21, and run thence North 198 feet run thence East 660 feet to the East boundary line of said SW1/4 NW1/4 SE1/4 of said section, run thence South 198 feet, run thence West 660 feet, back to the POINT OF BEGINNING, containing three (3) acres, more or less,

LESS AND EXCEPT THE FOLLOWING TWO TRACTS:

Tract 1: Part of the SW1/4 NW1/4 SE1/4 of Section 21, Township 12 South, Range 24 West, more particularly described as follows, to-wit: Beginning at the SE corner of the said SW1/4 NW1/4 SE1/4 of said Section 21 and run thence West 198 feet, thence North 50 feet, thence East 198 feet, thence South 50 feet, back to the POINT OF BEGINNING.

Tract 2: Part of the NW1/4 SE1/4 of Section 21, Township 12 South, Range 24 West, more particularly described as follows: Begin at the SW corner of the said NW1/4 SE1/4 East 260 feet to the POINT OF BEGINNING, run thence East 350 feet to a stake, run

thence North 198 feet to a stake, run thence West 350, run thence South 198 feet back to the POINT OF BEGINNING.

TRACT "18": Lot 1, Block 1, Parkview Subdivision No. 2 to the City of Hope, Hempstead County, Arkansas.

TRACT "19": Lot 2, Block 1, Parkview Subdivision No. 2 to the City of Hope, Hempstead County, Arkansas.

TRACT "20": Lot 3, Block 1, Parkview Subdivision No. 2 to the City of Hope, Hempstead County, Arkansas.

TRACT "21": Lot 4, Block 1, Parkview Subdivision No. 2 to the City of Hope, Hempstead County, Arkansas.

TRACT "22": Part of the Southwest Quarter of the Northwest Quarter of the Southeast Quarter (SW1/4 NW1/4 SE1/4) of Section Twenty-one (21), Township Twelve (12) South, Range Twenty-four (24) West, more particularly described as follows, to-wit: Beginning at the Southeast Corner of the said SW1/4 NW1 /4 SE1/4 of said Section 21 and thence West 198 feet, thence North 50 feet, thence East 198 feet, thence South 50 feet back to THE POINT OF BEGINNING, containing .20 acre, more or less.

TRACT "23": A part of the NW1/4 of the SE1/4 of Section 21, Township 12 South, Range 24 West, Hempstead County, Arkansas and being more particularly described as follows:

Commence at the SW corner of the NW1/4 of the SE1/4 of Section 21, Township 12 South, Range 24 West and run thence N 1°41'52"E 198.00 feet along the westerly boundary of the NW1/4 of the SE1/4 to a point, leaving the forty line run thence S 88°48'15"E 333.99 feet to parallel with southerly boundary of the NW1/4 of the SE1/4 to the POINT OF BEGINNING, run thence N 1°13'52"E 232.19 feet to a point on the southerly Right-of-Way of Relocated State Highway no. 29, run thence N 88°20'21"E 302.00 feet along the highway right-of-way to a point, run thence S 87°51'48"E 26.43 feet also along the said highway right-of-way to a point, leaving the Relocated State Highway no. 29 Right-of-Way run thence S 1°42'13"W 246.82 feet to a point, run thence N 88°48'15"W 326.01 feet back to the POINT OF BEGINNING, containing 1.78 acres more or less.

TRACT "24": All of the following land that is South of the Arkansas State Highway Commission Right-Of-Way of State Highway 29/Bypass, which was previously annexed 60 feet on both sides of the centerline: Commence at the Northwest corner of the Southwest quarter of the Southeast quarter of Section 21, Township 12 South, Range 24 West, thence East 660 feet to a stake, THE POINT OF BEGINNING, thence North 587.4 feet to a stake, thence East 462 feet to a stake, thence South 587.4 feet to a stake, thence West 462 feet to the point of beginning, containing 6.26 acres, more or less, - this being a part of the Northwest quarter of the Southeast quarter Section 21, Township 12 South, Range 24 West.

TRACT "25" AND "26": All of the following land that is South of the Arkansas State Highway Commission Right-Of-Way of State Highway 29/Bypass, which was previously annexed 60 feet on both sides of the centerline: The West Half of the Northeast Quarter of the Southeast Quarter of Section 21, Township 12 South Range 24 West, containing 20 acres, more or less; also, the following described tract of land: Commence at the Northeast corner of the Northwest Quarter of the Southeast Quarter of Section 21, Township 12 South, Range 24 West, and run thence South 209 feet to the point of beginning, run thence West 214 ½ feet, run thence South to the South line of said Northwest Quarter Southeast Quarter of said Section 21, run thence East 214 ½ feet to the Southeast corner of said Northwest Quarter Southeast Quarter of said Section 21, run thence North to the point of beginning, containing 5 1/2 acres.

Excepting, however, that portion of the aforesaid lands which were conveyed by the Grantors herein to Cecil A. Flenory and R.E. Epps, as tenants in common, by Warranty Deed dated February 14, 1983 and now recorded in Book 494 at Page 743, deed records within and for Hempstead County, Arkansas such tract being composed of 2.0 acres, more or less.

TRACT "27": Part of the West Half of the Northeast Quarter of the Southeast Quarter (W1/2 NE1/4 SE1/4) of Section 21, Township 12 South, Range 24 West in Hempstead County, Arkansas more particularly described as follows: Commence at the Southeast corner of the W1/2 of the NE1/4 of the SE1/4 of Section 21 and run thence North 86 degrees 45 minutes West 31.4 feet along the South line of the W1/2 of the NE1/4 of the SE1/4 to the point of its intersection with the West right-of-way line of Spruce Street; said point being the point of beginning; thence continue North 86 degrees 45 minutes West 580.8 feet along the South line of the W1/2 of the NE1/4 of the SE1/4, run thence North 2 degrees 18 minutes East 150.0 feet, run thence South 86 degrees 45 minutes East 580.8 feet to the West right-of-way line of Spruce Street, run thence South 2 degrees 18 minutes West 150.0 feet along the West right-of-way line of Spruce Street to the point of beginning, containing 2.0 acres, more or Less.

TRACT "28": Commence at the Northeast corner of the Northeast Quarter of the Southeast Quarter (NE1/4 SE1/4) of Section Twenty-one (21), Township Twelve (12) South, Range Twenty-four (24) West at a 1 1/2" iron pipe and run East along land line 159.13 feet to an iron pipe, thence South 1° 11' 51" West 1070.94 feet to the Northeast corner of Park, thence North 89° 53' 33" West 825.0 feet, thence North 1° 11' 51" East 57.57 feet to the POINT OF BEGINNING: Thence continue North 1° 11' 51" East 86.37 feet, thence South 89° 53' 33" East 472.87 feet, thence South 1° 11' 51" West 86.37 feet, thence North 89° 53' 33" West 472.87 feet back to the POINT OF BEGINNING.

TRACT "29": A part of the Northeast Quarter Southeast Quarter of Section 21 and a part of the Northwest Quarter, Southwest Quarter of Section 22, Township 12 South, Range 24 West, Hempstead county, Arkansas; Commence at 3/4" rod found for the Northeast corner of the said Northeast Quarter Southeast Quarter of Section 21 and run thence South 0 degrees 07 minutes 18 seconds West 1035.00 feet to the POINT OF BEGINNING, run thence North 89 degrees 55 minutes 03 seconds West 193.00 feet to a point, run thence North 0 degrees 07 minutes 18

seconds East 118 .15 feet to a point on the Southerly right-of-way of Arkansas State Highway 29 Bypass, run thence South 86 degrees 54 minutes 33 seconds East 34.30 feet along the said right-of-way to a right-of-way marker found, run thence South 85 degrees 54 minutes 18 seconds East 97.59 feet to a right-of-way marker found, run thence South 81 degrees 52 minutes 20 seconds East 223.57 feet to a point which is the intersection of the east line of the Hayes tract and the southerly line of the Highway 29 Bypass, run thence south 0 degrees 07 minutes 18 seconds West 78.23 feet along the said east line of the Hayes tract to a point, run thence North 89 degrees 55 minutes 03 seconds West 160.00 feet back to the POINT OF BEGINNING, containing 0.82 acres more or less.

TRACT "30": The South 15.1 acres of the following land: Part of the E1/2 of the SE1/4 of Sec. 21, and part of the W1/2 of the SW1/4 of Sec. 22, in Twp. 12 S, Range 24 W, more particularly described as follows, to-wit: Begin at the NE corner of the NW1/4 of the SW ¼ of Sec. 22, run thence West 17.5 chains, run thence South 14.55 chains to a stake, the point of beginning, run thence West 12.5 chains to the center of the Hope and DeAnn Public Road, run thence South 13.65 chains along the center of said Road, run thence East 12.5 chains, Run thence North 13.65 chains, back to the point of beginning, containing 17.6 acres, more or less.

TRACT "30-1": Commence at the Northeast corner of the Northeast Quarter of the Southeast quarter (NE1/4 SE1/4) of Section Twenty-one (21), Township Twelve (12) South, Range Twenty-four (24) West at a 1 1/2" iron pipe and run East along land line 159.13 feet to an iron pipe, thence South 1° 11' 51" West 1035.0 feet to the POINT OF BEGINNING: Thence continue South 1° 11' 51" West 35.94 feet to the Northeast corner of Park, thence North 89° 53' 33" West along North line of Park 825.0 feet to Deann Road, thence North 1° 11' 51" East 57.57 feet, thence South 89° 53' 33" East 472.87 feet, thence South 1° 11' 51" East 21.63 feet, thence South 89° 53' 33" East 352.13 feet back to the POINT OF BEGINNING.

TRACT "31": A part of the West Half of the Southwest Quarter of Section 22, Township 12 South, Range 24 West, Hempstead county, Arkansas more particularly described as follows: Commence at the Northwest corner of the said West Half of the Southwest Quarter of Section 22 and run thence South 0 degrees 07 minutes 18 seconds West 1035.00 feet to a point, run thence South 89 degrees 55 minutes 03 seconds East 160.00 feet to the POINT OF BEGINNING: Run thence South 0 degrees 07 minutes 18 seconds West 818.72 feet to the southeast corner of the City Park, run thence North 89 degrees 45 minutes 12 seconds East 308.43 feet to a cotton spindle set in the center of Lincoln Street, run thence North 39 degrees 17 minutes 29 seconds East 184.94 feet along the center of Lincoln Street to a cotton spindle set in line with an existing fence, said fence running adjacent to, and parallel with a creek, leaving Lincoln Street run thence North 15 degrees 55 minutes 23 seconds West 727.34 feet along the said fence to a 3/8" rod set in a fence along the southerly right-of-way of the relocated State Highway No. 29 Bypass, run thence North 72 degrees 09 minutes 45 seconds West 63.58 feet to a point on the said right-of-way, run thence North 75 degrees 55 minutes 52 seconds West 97.81 feet to a disk found at a right-of-way marker, run thence North 81 degrees 52 minutes 20 seconds West 69.39 feet to the intersection of the southerly right-of-way of the said relocated Highway 29 and the west line of

the Jerry Whitehurst land (also the east line of the David Hayes land), run thence South 0 degrees 07 minutes 18 seconds West 78.23 feet back to the POINT OF BEGINNING, containing 6.58 acres more or less.

TRACT "32": All of the following land that is South and West of the Arkansas State Highway Commission Right-Of-Way of State Highway 29/Bypass, which was previously annexed 60 feet on both sides of the centerline: Part of the West Half of the Southwest Quarter (W1/2 SW1/4) of Section Twenty-Two (22), Township Twelve (12) South, Range Twenty-Four (24) West of the Fifth Principal Meridian, more particularly described as follows: Beginning at the Northeast corner of the Northwest Quarter of the Southwest Quarter (NW1/4 SW1/4) of said Section 22, thence West 17 1/2 chains, thence South 28.20 chains, thence due East 4.35 chains to the center of the Hope and Emmett Public Road, thence in a Northeasterly direction along the center of said road to the intersection of the center line of said road with the East boundary line of the Northwest Quarter of the Southwest Quarter (N1/4 SW1/4) of said Section 22, thence North to the point of beginning, excepting therefrom a tract described as commencing at the Northeast corner of the West Half of the Southwest Quarter (W1/2 SW1/4) of said Section 22, thence South 1 degree 10 minutes West 511.4 feet to the point of beginning, thence continue South 1 degree 10 minutes West 250.6 feet to the center of the County Road, thence South 41 degrees 19 minutes West 129.0 feet along the center of said County Road, thence North 49 degrees 5 minutes West 195.9 feet, thence North 47 degrees 21 minutes East 323.8 feet to the point of beginning, and further except a tract described as commencing at the Northeast corner of the West Half of the Southwest Quarter (W1/2 SW1/4) of said Section 22, thence South 1 degree 10 minutes West 762 feet to the center of the County Road, thence South 41 degrees 19 minutes West 147.4 feet along the center of said County Road to the point of beginning, thence North 48 degrees 19 minutes West 184.2 feet, thence South 41 degrees 1 minute West 151.7 feet, thence South 44 degrees 49 minutes East 183.8 feet to the center of the County Road, thence North 41 degrees 19 minutes East 162.9 feet along the center of said County Road to the point of beginning. Subject to all public and private roads and easements.

TRACTS "33-36" & "44-49": All of Blocks 33, 34, 35, 36, and 38 in E. C. Brown's Extension to Hempstead Heights Addition to the City of Hope;

And Lots 1, 2, 3, 4, 5, 6, 7, 8, 9, 10, 11, and 12 in Block 39, in E. C. Brown's Extension to Hempstead Heights Addition to the City of Hope.

TRACT "37": Lots One (1), Two (2), Three (3) and Four (4), Block Thirty-seven (37), Brown's Extension Addition to the City of Hope, Hempstead County, Arkansas.

TRACT "38": Part of the North Half of the Northwest Quarter (N1/2 NW1/4) of Section Twenty-seven (27), Township Twelve (12) South, Range Twenty-four (24) West, described as follows: Commence 1075 feet East of the Southwest corner of the N1/2 NW1/4 of said Section, run thence North 372 feet to THE POINT OF BEGINNING, run thence East 650 feet, run thence North

614 feet, run thence West 650 feet, run thence South 614 feet back to THE POINT OF BEGINNING, containing 10 acres, more or less.

TRACT "39": Lot 1, Block 12 of Brown's Extension to Hempstead Heights Addition.

TRACT "40": Lot 2, Block 12 of Brown's Extension to Hempstead Heights Addition.

TRACT "41": Lot 3, Block 12 of Brown's Addition lying in the North Half (N1/2) of the Northwest Quarter of the Northwest Quarter (NW1/4 NW1/4) of Section 32, Township 13 South, Range 24 West.

TRACT "42": Lot 4, Block 12 of Brown's Extension to Hempstead Heights Addition.

TRACT "43": Lot Six (6) in Block Twelve (12) in E.C. Brown's Extension to Hempstead Heights Addition to the City of Hope, Arkansas, according to the plat of said Extension to said Addition.

TRACTS "50" & "51": ALL of Blocks Eighteen (18) and Nineteen (19), Hempstead Heights Addition to the City of Hope, Arkansas.

TRACTS "52" & "53": Lots One (1), Two (2), Three (3), Ten (10), Eleven (11) and Twelve (12) in Block Two (2) and All of Block Fifteen (15) – ALL in Hempstead Heights Addition to the City of Hope, County of Hempstead, State of Arkansas.

TRACT "54": Lots 4, 5, 6, and 7, Block 2 in Hempstead Heights Addition to the City of Hope, Arkansas.

TRACT "55": Begin at the Southwest corner of the Southeast Quarter of the Northwest Quarter (SE1/4 NW1/4) of Section Twenty-Seven (27), Township Twelve (12) South, Range Twenty-Four (24) West, and run East along the 40 acre line a distance of 101.04 feet, run thence North 25 feet to the point of beginning; run thence North 1295 feet to the North line of said SE1/4 NW1/4, thence East 200 feet, thence South 1295 feet, and thence West 200 feet to the point of beginning, with appurtenances thereto belonging.

TRACTS "56-58" & "60-67": A part of Section 27, T-12-S, R-24-W, Hempstead County, Arkansas; BEGINNING at the NE corner of the NW1/4, SW1/4, Section 27, T-12-S, R-24-W, a R.R. spike set for corner, run thence S 1°13'52" W for 375 feet to a 3/8" rod set for corner, run thence N 88°31'01" W for 1332.93 feet to a 3/8" rod set for corner in the west line of section 27, run thence S 1°15'00" W for 343.80 feet to a 3/8" rod set for corner, thence run S 31°00'00" E for 268.53 feet to a R.R. spike set for corner near the center of a paved road, run thence S 1°15'00" W for 188.00 feet to a R.R. spike set for corner in the west margin of said road, thence leaving road run S 74°02'53" W for 104.00 feet to a 3/8" rod set for corner, run thence S 1°15'00" W for 262.00 feet to a R.R. spike set for corner on the northerly R.O.W. of the Missouri-Pacific Railroad, run thence N 74°02'53" E along said R.O.W. for 1349.56 feet to a 3/8" rod set for corner, run thence N 1°13'52" E for 104.67 feet to a 3/8" rod set for corner on the R.O.W. of the said Missouri-Pacific Railroad, thence continue N 74°02'53" E along said R.O.W. for 3653.27 feet to a 3/8" rod set for corner, thence leaving said R.O.W. run N 1°09'52" E for 2462.85 feet to a 3/8" rod set for corner in an east-west fence row, said row being on the north line of section

27, run thence N 88°31'01" W along the said north line of section 27 for 2651.44 feet to an old fence corner, run thence S 1°12'55" W for 1320.00 feet to a 3/8" rod set for corner near an old fence corner, run thence N 88°31'01" W for 534.90 feet to a 3/8" rod set for corner, run thence S 1°13'52" for 1295.00 feet to a R.R. spike set for corner in the north rut of a dirt lane, run thence N 88°31'01" W for 200.00 feet to a 3/8" rod set for corner, run thence S 1°13'52" W for 25.00 feet to a 3/8" rod set for corner under a fence, run thence N 88°31'01" W for 101.4 feet back to the POINT OF BEGINNING, containing 231.622 acres more or less.

TRACT "59": Beginning at the NE Corner of the NW1/4 SW1/4 of Section 27, Township 12 S, Range 24 W, run thence S 350 feet; run thence W 945 feet to the Street; run thence N 350 feet; run thence E 945 feet back to the Point of Beginning, containing 7.10 acres, more or less.

TRACT "68": Beginning at the NW corner of Section Twenty-six (26), Township Twelve (12) South, Range Twenty-four (24) West, run thence North 89°51'39" E for 1329.81 feet to a 3/8" rod set for the NE corner of the NW1/4 NW1/4; run thence S 00°55'17" W for 585.31 feet to a 3/8" rod set on the Westerly boundary of U. S. Highway #67; thence along the said Westerly Right of Way run S 13°27'46" W for 188.36 feet; run thence N 76°32'14" W along the Right of Way for 25.00 feet; thence also along the Right of Way run S 13°27'46" W 1231.47 feet to a 3/8" rod set at the intersection of the Rights of Way of U.S. Highway #67 and the Union Pacific Railroad; run thence S 72°40'38" W along the said Union Pacific Railroad Right of Way for 1521.16 feet to a 3/8" rod set; run thence N 00°14'59" E for 2410.56 feet to a 3/8" rod found, said rod being located on the section line between Sections 22 and 27; run thence along the said section lines 89°55'52" E for 497.15 feet back to the POINT OF BEGINNING, containing 83.239 acres, more or less.

TRACT "69": Part of the Northeast Quarter of the Northwest Quarter (NE1/4 NW1/4) of Section Three (3), Township Thirteen (13) South, Range Twenty-four (24) West, more particularly described as follows to-wit: Commence at the Southwest Corner of said NE1/4 NW1/4 and run thence North 1,063 feet to the Northwest Corner of that tract of land in said Forty owned by John Robert Graves, THE POINT OF BEGINNING: Run thence North 277 feet to the Northwest Corner of said NE1/4 NW1/4, run thence East 400 feet, run thence South 277 feet to the Northeast Corner of that tract of land in said Forty owned by John Robert Graves, run thence West 400 feet back to THE POINT OF BEGINNING, containing 2.5 acres, more or less, in Hempstead County, Arkansas.

TRACT "70": All of the Northeast Quarter of the Northwest Quarter (NE1/4 NW1/4) of Section Three (3), Township Thirteen (13) South, Range Twenty-four (24) West, in Hempstead County, Arkansas, that is West of the Arkansas State Highway Commission Right-Of-Way of State Highway 29/Bypass, which was previously annexed 60 feet on both sides of the centerline: LESS AND EXCEPT THE FOLLOWING DESCRIBED LANDS:

Part of the Northeast Quarter of the Northwest Quarter (NE1/4 NW1/4) of Section Three (3), Township 13 South, Range Twenty-four (24) West, more particularly described as follows, to-wit: Commence at the Southwest Corner of said NE1/4 NW1/4 and run thence North 1,063 feet to the Northwest Corner of that tract of land in said Forty owned by John Robert Graves, THE

POINT OF BEGINNING: Run thence North 277 feet to the Northwest Corner of said NE1/4 NW1/4, run thence East 400 feet, run thence South 277 feet to the Northeast Corner of that tract of land in said Forty owned by John Robert Graves, run thence West 400 feet back to THE POINT OF BEGINNING, containing 2.5 acres, more or less; AND

Part of the Northeast Quarter of the Northwest Quarter (NE1/4 NW1/4) of Section Three (3), Township Thirteen (13) South, Range Twenty-four (24) West, more particularly described as follows, to-wit: Commence at the Southwest Corner of said NE1/4 NW1/4 and run thence North 700 feet to THE POINT OF BEGINNING: Run thence North 363 feet; run thence East 400 feet; run thence South 363 feet; run thence West 400 feet back to THE POINT OF BEGINNING, containing approximately 3.3 acres, more or less.

TRACT "71": All of the following land that is North and West of the Arkansas State Highway Commission Right-Of-Way of State Highway 29/Bypass, which was previously annexed 60 feet on both sides of the centerline: The Southeast Quarter of the Northwest Quarter (SE1/4 NW1/4) of Section 3, Township 13 South, Range 24 West.

SECTION 2. All necessary urban services, such as sanitation, police and fire protection, shall extend to such areas within a reasonable time.

SECTION 3. Because these areas are in need of all necessary urban services, such as police and fire protection, and this is necessary for the public peace, health, safety and welfare, an emergency is declared to exist. Therefore, this ordinance shall be in full force and effect from after the date of passage.

Passed this 2nd day of Aug, 2016.



City Clerk

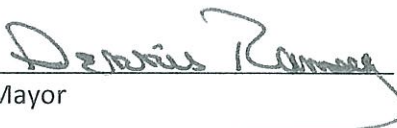

Mayor

F I L E D

SEP 08 2016

Arkansas
Secretary of State



**ARKANSAS
GIS OFFICE**

August 25, 2016

Mr. Darrell Allen
GIS & Technology Coordinator
City of Hope Arkansas
PO Box 667
1603 W. 3rd St.
Hope, AR 71802-2511

RE: City of Hope Annexation Coordination Requirement

Mr. Allen,

Thank you for coordinating with our office as you seek to annex property into the City of Hope, AR Ordinance Number 1620. This letter represents confirmation that you have properly coordinated with our office (Arkansas GIS Office) as specified in § 14-40-101 (Act 914 of 2015) of the 90th General Assembly.

Our office will wait completion of any additional steps necessary for the proposed boundary change, which normally comes from the Arkansas Secretary of State Elections Division after any appropriate filing by your County Clerk.

Thank you,

Richie Pierce, Sr. GIS Analyst
/rp

Attachments:
GIS Office Map of Proposed Annexation
Secretary of State Municipal Change Checklist

F I L E D

SEP 08 2016

Arkansas
Secretary of State

Proposed Annex: City of Hope
August 2016

City: Hope
Mayor: Dennis Ramsey

Arkansas Code 14-40-101.
Before an entity undertakes an annexation, consolidation, or detachment proceeding under this chapter, the entity shall coordinate with the Arkansas Geographic Information Systems Office for preparation of legal descriptions and digital mapping for the relevant annexation, consolidation, and detachment areas.
The map contained herein, is evidence, the entity has met requirements of Act 914 of 2015

- Proposed Annex
- Township-Range
- Sections
- Parcels
- Highway
- Minor Road
- Existing City
- Neighboring City
- County Boundary

FILED
SEP 08 2016
Arkansas
Secretary of State

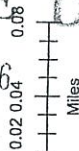

Hope-20160825

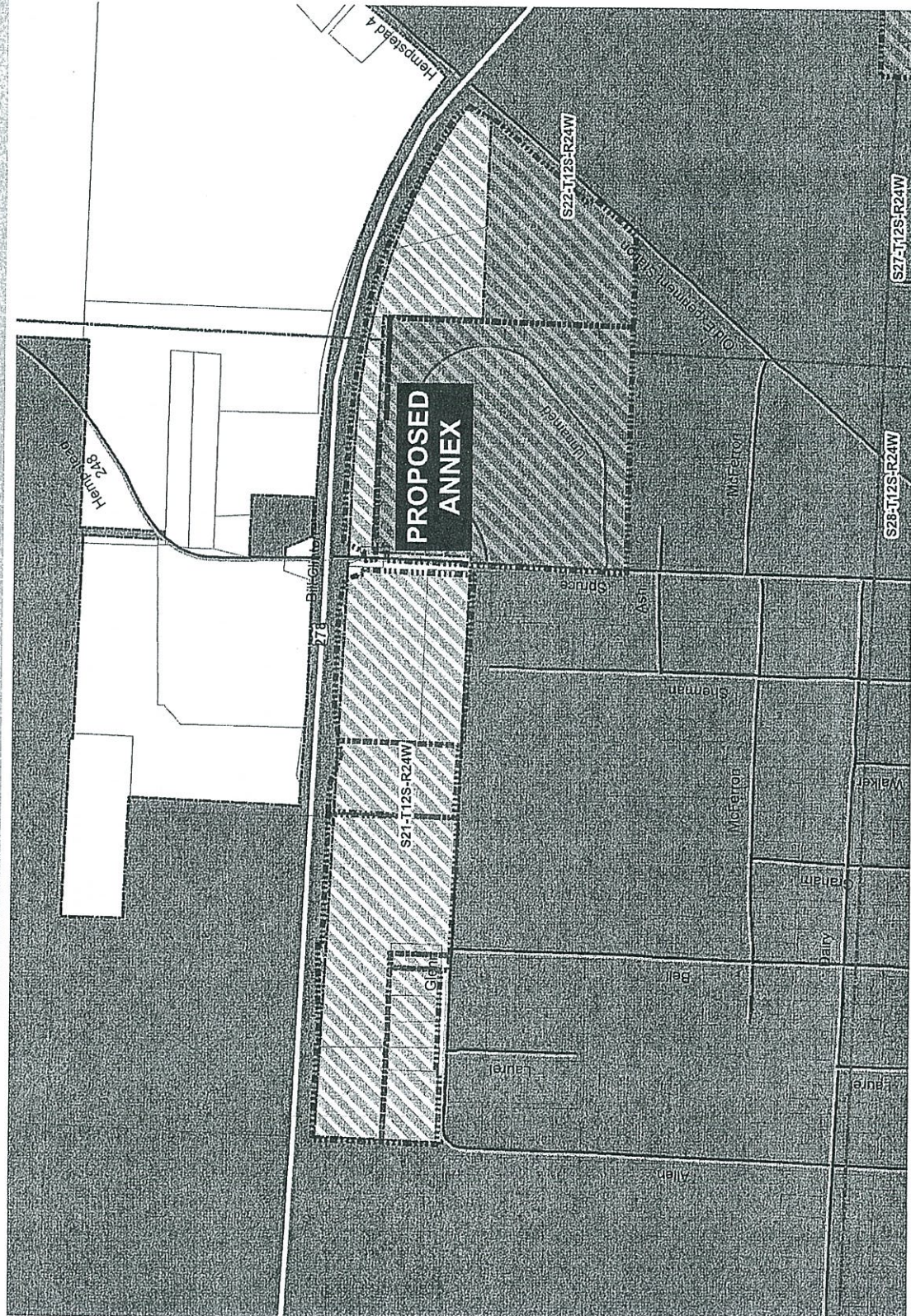

Proposed Annex: City of Hope
August 2016

City: Hope
Mayor: Dennis Ramsey

Arkansas Code 14-40-101.

Before an entity undertakes an annexation, consolidation, or detachment, proceeding under this chapter, the entity shall coordinate with the Arkansas Geographic Information Systems Office for preparation of legal descriptions and digital mapping for the relevant annexation, consolidation, and detachment areas.

The map contained herein, is evidence, the entity has met requirements of Act 914 of 2015

- Proposed Annex
- Township-Range
- Sections
- Parcels
- Highway
- Minor Road
- Existing City
- Neighboring City
- County Boundary

0 0.0226.045 0.09
Miles



Hope-20160825

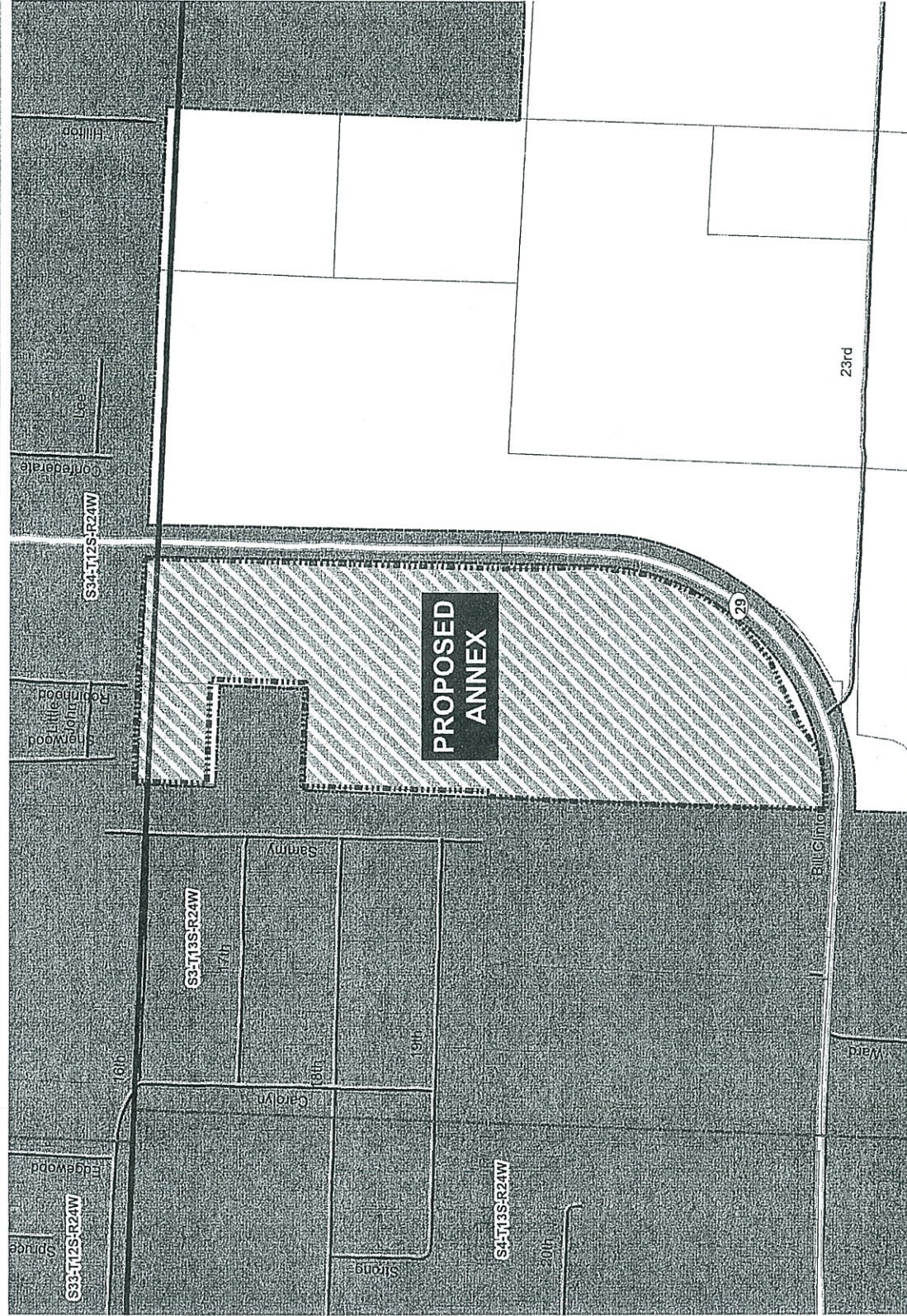

City: Hope
Mayor: Dennis Ramsey

Arkansas Code 14-40-101.
Before an entity undertakes an annexation, consolidation, or detachment proceeding under this chapter, the entity shall coordinate with the Arkansas Geographic Information Systems Office for preparation of legal descriptions and digital mapping for the relevant annexation, consolidation, and detachment areas.

The map contained herein, is evidence, the entity has met requirements of Act 914 of 2015

- Proposed Annex
- Township-Range
- Sections
- Parcels
- Highway
- Minor Road
- Existing City
- Neighboring City
- County Boundary

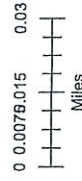

ARKANSAS
GIS OFFICE

Hope-20160825

Proposed Annex: City of Hope
August 2016

