



ARKANSAS SECRETARY OF STATE

MARK MARTIN

April 1, 2013

Faron Ledbetter
Madison County Clerk
PO Box 37
Huntsville AR 72740

RE: Annexation

Dear Ms. McGuire,

The following information has been recorded and filed in the office of the Secretary of State:

County: Madison City: Huntsville

Annexation:

Ordinance No. 13-5 – March 13, 2013

County Court Order – No. 2012-3 – February 6, 2013; Resolution 4-13 and Plat (Area 1)

County Court Order – No. 2012-4 – February 6, 2013; Resolution 5-13 and Plat (Area 2)

County Court Order – No. 2012-5 – February 6, 2013; Resolution 6-13 and Plat (Area 3)

County Court Order – No. 2012-6 – February 6, 2013; Resolution 7-13 and Plat (Area 4)

County Court Order – No. 2012-7 – February 6, 2013; Resolution 8-13 and Plat (Area 5)

County Court Order – No. 2012-8 – February 6, 2013; Resolution 9-13 and Plat (Area 6)

County Court Order – No. 2012-9 – February 6, 2013; Resolution 10-13 and Plat (Area 7)

County Court Order – No. 2012-10 – February 6, 2013; Resolution 11-13 and Plat (Area 8)

By copy of this letter, I am sending file marked copies of all of the information to the UALR Institute for Economic Advancement, Arkansas Highway Mapping Department, and TomTom. All others listed will only receive notification of the annexation by copy of this letter. Annexations should also be filed with your County Clerk's office. Please provide a copy of these documents to your County Clerk, if you haven't already done so.

If you have any questions please do not hesitate to contact me at 1-800-482-1127 or 501-683-6729.

Sincerely,

A handwritten signature in black ink, appearing to read "Justin Tate".

Justin Tate
Assistant Legal Counsel
Arkansas Secretary of State



CC: UALR Institute for Economic Advancement
Arkansas Highway Mapping Department
TomTom
Arkansas Municipal League
Shelby Johnson, State Geographical Information Officer
Janice Smith, Huntsville City Recorder

MAR 19 2013

Arkansas
Secretary of State

IN THE MADISON COUNTY COURT

IN THE MATTER OF ANNEXING TO THE CITY OF
HUNTSVILLE, ARKANSAS, CERTAIN
TERRITORY CONTIGUOUS TO THE CITY OF
HUNTSVILLE, ARKANSAS

Case No. 2012-3

DECREE OF ANNEXATION

On this, the 06 day of FEB, 2013, there is presented to the Court, by Darrell Trahan, agent of the petitioners, a petition for annexation of certain territory, hereinafter more particularly described, to the City of Huntsville, Arkansas; and the Court being fully advised of the facts and the law, doth hereby find, judge and decree as follows:

- (1) That the petition was filed more than thirty (30) days prior to this date, and that in said petition, the said Darrell Trahan was selected to act on behalf of the petitioners in filing and presenting the petition;
- (2) That a majority of the total number of real estate owners in the area affected by this petition, have signed said petition, and that such majority owns more than one-half of the acreage affected;
- (3) That the territory sought to be annexed was accurately described in said petition, and that said territory is contiguous to the boundaries of the City of Huntsville;
- (4) That attached to and made a part of said petition is an accurate map of the territory sought to be annexed into the City of Huntsville;
- (5) That between the time the petition was filed, and the date of this hearing, the petitioners did cause a notice to be published once each week, for three (3) consecutive weeks, in a newspaper of general circulation in the county; and
- (6) That the prayer of the petition is right and proper.

Therefore, the Court doth hereby order, judge and decree that the following described territory be and the same is hereby annexed to and made a part of the City of Huntsville, Arkansas, to-wit: Start at the NE corner of the SW ¼ of S3, T16N, R26W; thence southerly along the east line of said SW ¼ of S3 886.20 feet more or less, to a point on the Huntsville city limit line, same being the NE corner of parcel 001-07884-000, and the point of beginning; thence southerly along the east line of the SW ¼ of S3 441.66 feet to a point, same being the SE corner of parcel 001-07884-000; thence westerly along the south line of said parcel 623.91 feet to a point, same being the SW corner of said parcel; thence north 259.80 feet to a point, same being the SE corner of parcel 001-07890-000; thence westerly 346.15 feet along the south line of said parcel to a point, same being the SE corner of parcel 001-07890-001; thence continue westerly along the south line of said parcel to the Huntsville city limit line; thence northerly along said city limit line 163.90 feet more or less, to a point where the city limit line turns east; thence easterly 1,233.0 feet more or less, along the city limit line to the P. O. B.

STATE OF ARKANSAS
COUNTY OF MADISON
I hereby certify that this instrument was filed
for record in my office the 6 day of Feb,
13, and duly recorded in 10 Record Book
13 at page 20 through 25
Witness my hand and the Court Seal this 13
day of March 2013
FARON LEDBETTER, County and Probate Clerk
[Signature] Deputy Clerk

FILED FOR RECORD
AT 10:11 O'CLOCK A.M.
FARON LEDBETTER
COUNTY CLERK
MADISON COUNTY, ARKANSAS

FEB 06 2013

I CERTIFY THAT THIS INSTRUMENT WAS FILED
FOR RECORD IN MY OFFICE AND RECORDED
IN 10 BOOK 13 PAGE 20-25
Faron Ledbetter COUNTY CLERK
[Signature]

The Court doth further order that the original papers in this cause be delivered to the Clerk of Madison County, same to be properly recorded and filed pursuant to law.

IT IS SO ORDERED.

Frank Weaver, County Judge

RESOLUTION NO. 4-13

A RESOLUTION ACCEPTING THE ANNEXATION OF CERTAIN PROPERTY

WHEREAS, a majority of the owners, owning a majority of certain property hereinafter described, located in Madison County and contiguous to the corporate limits of the City of Huntsville, heretofore filed a petition in the Madison County Court to annex territory to the City of Huntsville, Arkansas; and

WHEREAS, a notice was duly published, as required by law, of the filing of said petition and that a hearing on the petition would held in the County Court of Madison County; and

WHEREAS, at the time and place fixed in said notice, the County Court, being fully advised of the facts and the law, heard all persons desiring to be heard. The Court subsequently ascertained and declared in a Decree of Annexation order that the petition was signed by a majority of the real estate owners, owning a majority of the acreage affected; that said territory sought to be annexed was accurately described in said petition; that said territory is contiguous to the corporate boundary of Huntsville; that an accurate map of said territory was attached to and made a part of said petition; and that the prayer of the petition is right and proper, and ordered that the territory be annexed to the City of Huntsville; and

WHEREAS, no appeals having been taken within thirty (30) days from issuance of the County Court's order, it is now the desire of the Huntsville City Council to accept the said annexation.

NOW, THEREFORE, BE IT RESOLVED BY THE CITY COUNCIL OF THE CITY OF HUNTSVILLE, ARKANSAS:

That the following described land is hereby annexed into and accepted as part of the City of Huntsville, Arkansas, to-wit:

Start at the NE corner of the SW $\frac{1}{4}$ of S3, T16N, R26W; thence southerly along the east line of said SW $\frac{1}{4}$ of S3 886.20 feet more or less, to a point on the Huntsville city limit line, same being the NE corner of parcel 001-07884-000, and the point of beginning; thence southerly along the east line of the SW $\frac{1}{4}$ of S3 441.66 feet to a point, same being the SE corner of parcel 001-07884-000; thence westerly along the south line of said parcel 623.91 feet to a point, same being the SW corner of said parcel; thence north 259.80 feet to a point, same being the SE corner of parcel 001-07890-000; thence westerly 346.15 feet along the south line of said parcel to a point, same being the SE corner of parcel 001-07890-001; thence continue westerly along the south line of said parcel to the Huntsville city limit line; thence northerly along said city limit line 163.90

feet more or less, to a point where the city limit line turns east; thence easterly 1,233.0 feet more or less, along the city limit line to the P. O. B.

PASSED AND APPROVED THIS 11th DAY OF March, 2013.

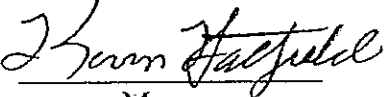
Mayor

Attest:

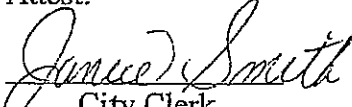
City Clerk

Huntsville Annexation - Area 1

Exhibit A

	City Limits
	Annexation Area
	Parcels
	Sections
	Qtr Sections
	Roads

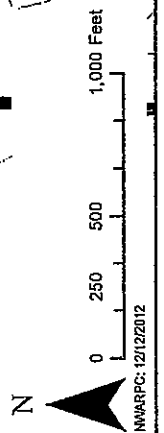
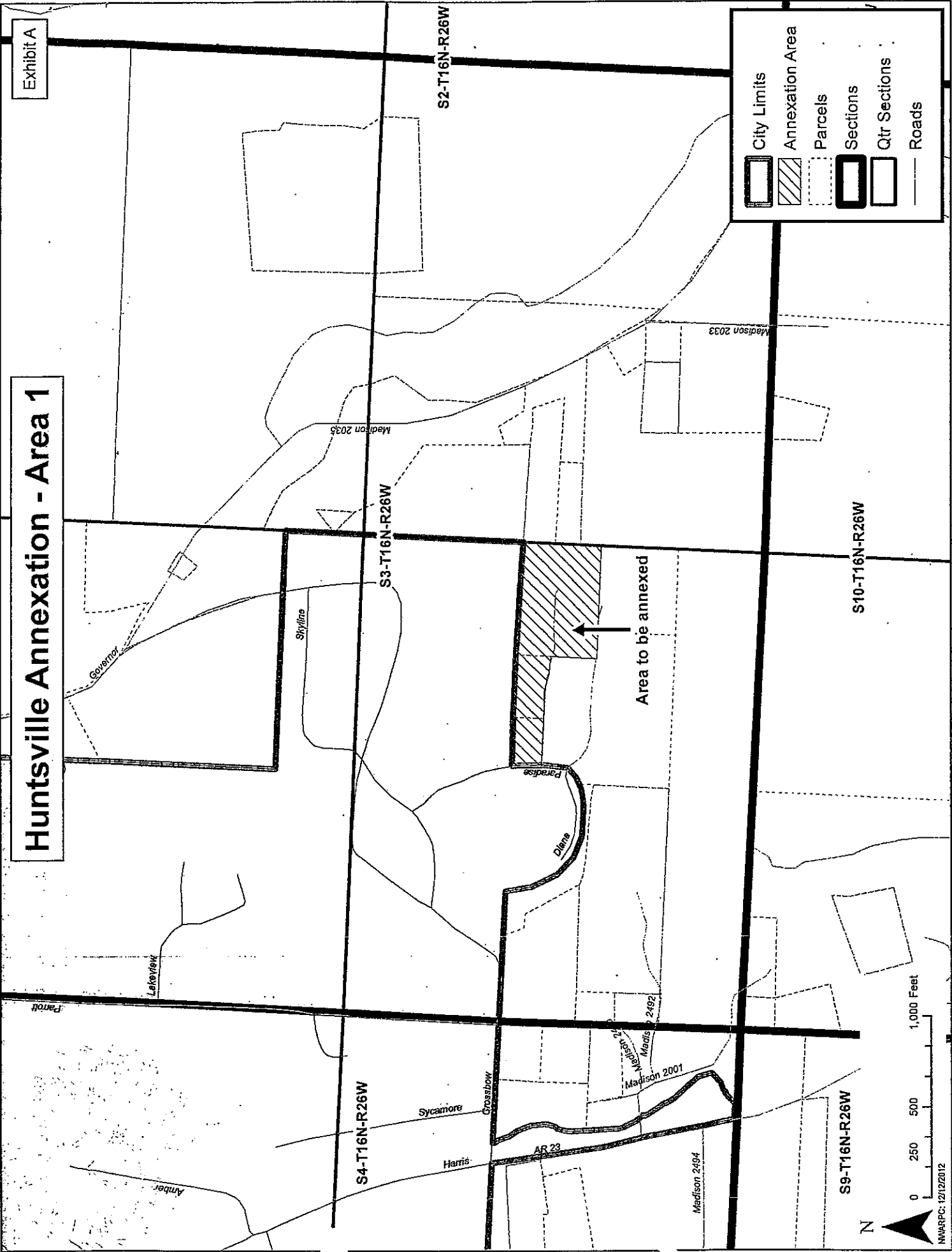

NWARP: 12/12/2012

MAR 19 2013

Arkansas
Secretary of State

IN THE MADISON COUNTY COURT

IN THE MATTER OF ANNEXING TO THE CITY OF
HUNTSVILLE, ARKANSAS, CERTAIN
TERRITORY CONTIGUOUS TO THE CITY OF
HUNTSVILLE, ARKANSAS

Case No. 2012-4

DECREE OF ANNEXATION

On this, the 6 day of FEB, 2013, there is presented to the Court, by Darrell Trahan, agent of the petitioners, a petition for annexation of certain territory, hereinafter more particularly described, to the City of Huntsville, Arkansas; and the Court being fully advised of the facts and the law, doth hereby find, judge and decree as follows:

- (1) That the petition was filed more than thirty (30) days prior to this date, and that in said petition, the said Darrell Trahan was selected to act on behalf of the petitioners in filing and presenting the petition;
- (2) That a majority of the total number of real estate owners in the area affected by this petition, have signed said petition, and that such majority owns more than one-half of the acreage affected;
- (3) That the territory sought to be annexed was accurately described in said petition, and that said territory is contiguous to the boundaries of the City of Huntsville;
- (4) That attached to and made a part of said petition is an accurate map of the territory sought to be annexed into the City of Huntsville;
- (5) That between the time the petition was filed, and the date of this hearing, the petitioners did cause a notice to be published once each week, for three (3) consecutive weeks, in a newspaper of general circulation in the county; and
- (6) That the prayer of the petition is right and proper.

Therefore, the Court doth hereby order, judge and decree that the following described territory be and the same is hereby annexed to and made a part of the City of Huntsville, Arkansas, to-wit: Start at the SW corner of S3, T16N, R26W; thence north along the W line of said S3 833.54 feet more or less, to a point, same being the SE corner of parcel 001-07929-000, and the point of beginning; thence west along the south line of parcels 001-07929-000 and 001-07929-001 586.82 feet more or less, to the Huntsville city limit line; thence northerly and thence generally easterly along the city limit line to its intersection with the east line of the SW ¼ SW ¼ of S3, T16N, R26W; thence south along said east line 84.96 feet; thence N 76 degrees 08' 43" W 67.46 feet; thence N 84 degrees 28' 21" W 132.24 feet; thence N 85 degrees 14' 14" W 102.26 feet; thence N 83 degrees 53' 04" W 119.57 feet; thence N 81 degrees 01' 39" W 81.67 feet; thence N 67 degrees 22' 39" W 55.20 feet to a point, same being the SE corner of parcel 001-07891-000; thence west along the south line of said parcel 769.14 feet more or less, to the W line of S3, T16N, R26W; thence south along said line to the P. O. B.

STATE OF ARKANSAS }
COUNTY OF MADISON } SS

I hereby certify that this instrument was filed for record in my office the 6 day of FEB, 2013, and duly recorded in 10 Record Book 12 at page 23 through 24.

Witness my hand and the Court Seal this 12 day of March, 2013
FARON LEDBETTER, County and Probate Clerk
Smith Bladen Deputy Clerk

FILED FOR RECORD
AT 10:18 O'CLOCK A.M.
FARON LEDBETTER
COUNTY CLERK
MADISON COUNTY, ARKANSAS

FEB 06 2013

I CERTIFY THAT THIS INSTRUMENT WAS FILED FOR RECORD IN MY OFFICE AND RECORDED IN 10 BOOK 12 PAGE 23-24
Faron Ledbetter COUNTY CLERK
Smith Bladen

The Court doth further order that the original papers in this cause be delivered to the Clerk of Madison County, same to be properly recorded and filed pursuant to law.

IT IS SO ORDERED.



Frank Weaver, County Judge

RESOLUTION NO. 5-13

A RESOLUTION ACCEPTING THE ANNEXATION OF CERTAIN PROPERTY

WHEREAS, a majority of the owners, owning a majority of certain property hereinafter described, located in Madison County and contiguous to the corporate limits of the City of Huntsville, heretofore filed a petition in the Madison County Court to annex territory to the City of Huntsville, Arkansas; and

WHEREAS, a notice was duly published, as required by law, of the filing of said petition and that a hearing on the petition would held in the County Court of Madison County; and

WHEREAS, at the time and place fixed in said notice, the County Court, being fully advised of the facts and the law, heard all persons desiring to be heard. The Court subsequently ascertained and declared in a Decree of Annexation order that the petition was signed by a majority of the real estate owners, owning a majority of the acreage affected; that said territory sought to be annexed was accurately described in said petition; that said territory is contiguous to the corporate boundary of Huntsville; that an accurate map of said territory was attached to and made a part of said petition; and that the prayer of the petition is right and proper, and ordered that the territory be annexed to the City of Huntsville; and

WHEREAS, no appeals having been taken within thirty (30) days from issuance of the County Court's order, it is now the desire of the Huntsville City Council to accept the said annexation.

NOW, THEREFORE, BE IT RESOLVED BY THE CITY COUNCIL OF THE CITY OF HUNTSVILLE, ARKANSAS:

That the following described land is hereby annexed into and accepted as part of the City of Huntsville, Arkansas, to-wit:

Start at the SW corner of S3, T16N, R26W; thence north along the W line of said S3 833.54 feet more or less, to a point, same being the SE corner of parcel 001-07929-000, and the point of beginning; thence west along the south line of parcels 001-07929-000 and 001-07929-001 586.82 feet more or less, to the Huntsville city limit line; thence northerly and thence generally easterly along the city limit line to its intersection with the east line of the SW ¼ SW ¼ of S3, T16N, R26W; thence south along said east line 84.96 feet; thence N 76 degrees 08' 43" W 67.46 feet; thence N 84 degrees 28' 21" W 132.24 feet; thence N 85 degrees 14' 14" W 102.26 feet; thence N 83 degrees 53' 04" W 119.57 feet; thence N 81 degrees 01' 39" W 81.67 feet; thence N 67 degrees 22' 39" W 55.20 feet to a point, same being the SE corner of parcel 001-07891-000; thence west along the

south line of said parcel 769.14 feet more or less, to the W line of S3, T16N, R26W;
thence south along said line to the P. O. B.

PASSED AND APPROVED THIS 11th DAY OF March, 2013.

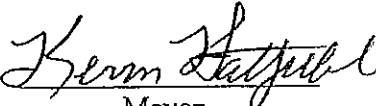
Mayor

Attest:

City Clerk

Huntsville Annexation - Area 2

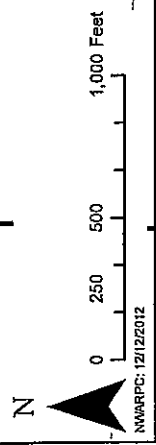
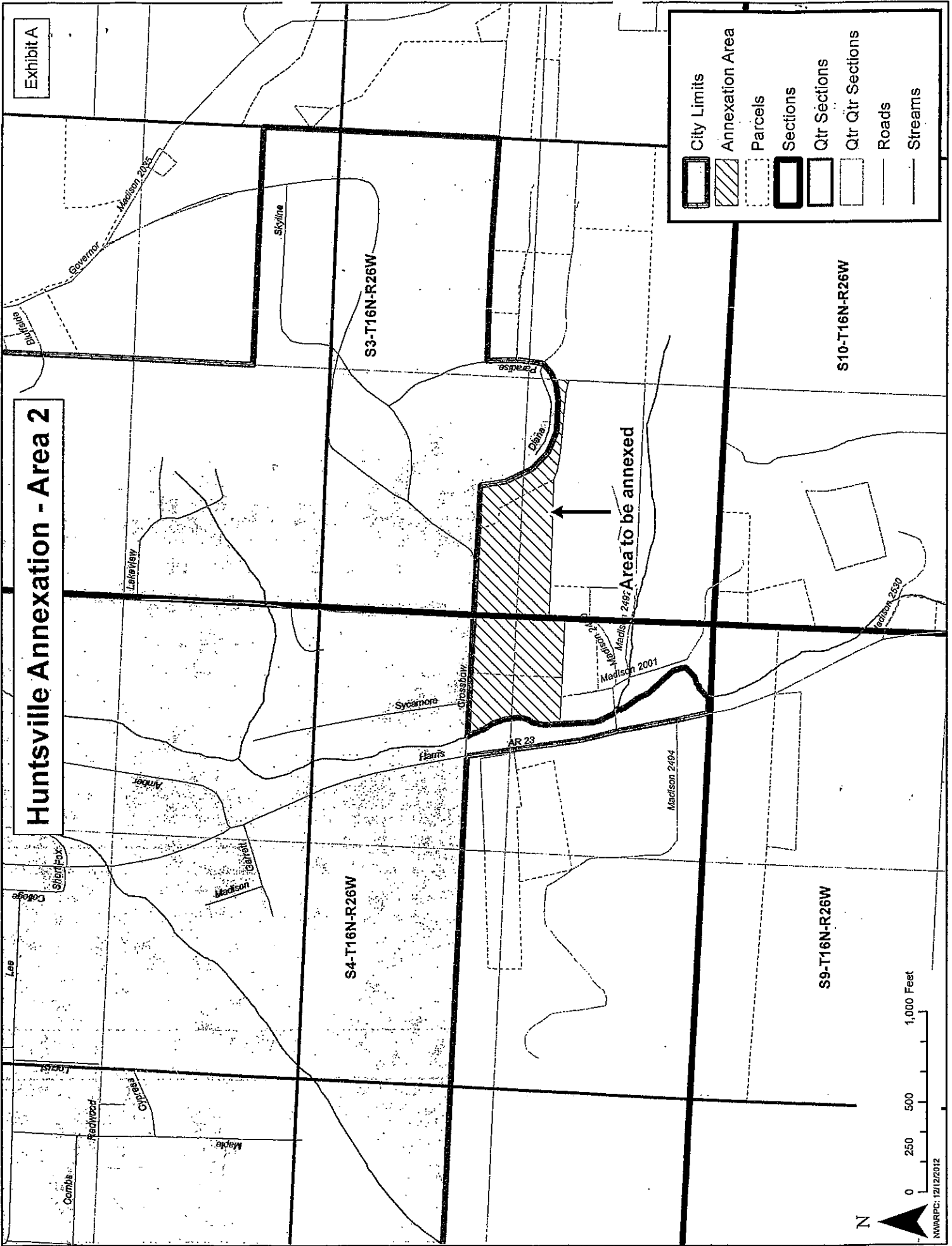
	City Limits
	Annexation Area
	Parcels
	Sections
	Qtr Sections
	Qtr Qtr Sections
	Roads
	Streams



MAR 19 2013

Arkansas
Secretary of State

IN THE MADISON COUNTY COURT

Case No. 2012-5

IN THE MATTER OF ANNEXING TO THE CITY OF
HUNTSVILLE, ARKANSAS, CERTAIN
TERRITORY CONTIGUOUS TO THE CITY OF
HUNTSVILLE, ARKANSAS

DECREE OF ANNEXATION

On this, the 6 day of FEB, 2013, there is presented to the Court, by Darrell Trahan, agent of the petitioners, a petition for annexation of certain territory, hereinafter more particularly described, to the City of Huntsville, Arkansas; and the Court being fully advised of the facts and the law, doth hereby find, judge and decree as follows:

- (1) That the petition was filed more than thirty (30) days prior to this date, and that in said petition, the said Darrell Trahan was selected to act on behalf of the petitioners in filing and presenting the petition;
- (2) That a majority of the total number of real estate owners in the area affected by this petition, have signed said petition, and that such majority owns more than one-half of the acreage affected;
- (3) That the territory sought to be annexed was accurately described in said petition, and that said territory is contiguous to the boundaries of the City of Huntsville;
- (4) That attached to and made a part of said petition is an accurate map of the territory sought to be annexed into the City of Huntsville;
- (5) That between the time the petition was filed, and the date of this hearing, the petitioners did cause a notice to be published once each week, for three (3) consecutive weeks, in a newspaper of general circulation in the county; and
- (6) That the prayer of the petition is right and proper.

Therefore, the Court doth hereby order, judge and decree that the following described territory be and the same is hereby annexed to and made a part of the City of Huntsville, Arkansas, to-wit: The unincorporated portion of Lot 11 of Faubus Heights Subdivision (parcel 063-00011-000), same being contiguous to the Huntsville city limits.

The Court doth further order that the original papers in this cause be delivered to the Clerk of Madison County, same to be properly recorded and filed pursuant to law.

IT IS SO ORDERED.

Frank Weaver
Frank Weaver, County Judge

FILED FOR RECORD
AT 10:19 O'CLOCK A.M.
FARON LEDBETTER
COUNTY CLERK
MADISON COUNTY, ARKANSAS

FEB 06 2013

STATE OF ARKANSAS }
COUNTY OF MADISON } SS

I hereby certify that this instrument was filed for record in my office the 6 day of Feb, and duly recorded in 10 Record Book 12 at page 20 through 20.
Witness my hand and the Court Seal this 6 day of Feb, 2013.
FARON LEDBETTER, County and Probate Clerk
[Signature] Deputy Clerk

I CERTIFY THAT THIS INSTRUMENT WAS FILED FOR RECORD IN MY OFFICE AND RECORDED IN 10 BOOK 12 PAGE 20
Faron Ledbetter COUNTY CLERK
[Signature] D.C.

RESOLUTION NO. 6-13

A RESOLUTION ACCEPTING THE ANNEXATION OF CERTAIN PROPERTY

WHEREAS, a majority of the owners, owning a majority of certain property hereinafter described, located in Madison County and contiguous to the corporate limits of the City of Huntsville, heretofore filed a petition in the Madison County Court to annex territory to the City of Huntsville, Arkansas; and

WHEREAS, a notice was duly published, as required by law, of the filing of said petition and that a hearing on the petition would held in the County Court of Madison County; and

WHEREAS, at the time and place fixed in said notice, the County Court, being fully advised of the facts and the law, heard all persons desiring to be heard. The Court subsequently ascertained and declared in a Decree of Annexation order that the petition was signed by a majority of the real estate owners, owning a majority of the acreage affected; that said territory sought to be annexed was accurately described in said petition; that said territory is contiguous to the corporate boundary of Huntsville; that an accurate map of said territory was attached to and made a part of said petition; and that the prayer of the petition is right and proper, and ordered that the territory be annexed to the City of Huntsville; and

WHEREAS, no appeals having been taken within thirty (30) days from issuance of the County Court's order, it is now the desire of the Huntsville City Council to accept the said annexation.

NOW, THEREFORE, BE IT RESOLVED BY THE CITY COUNCIL OF THE CITY OF HUNTSVILLE, ARKANSAS:

That the following described land is hereby annexed into and accepted as part of the City of Huntsville, Arkansas, to-wit:

The unincorporated portion of Lot 11 of Faubus Heights Subdivision (parcel 063-00011-000), same being contiguous to the Huntsville city limits.

PASSED AND APPROVED THIS 11 **DAY OF** March, 2013.

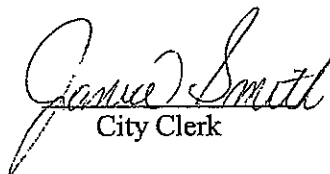

Mayor

Attest:

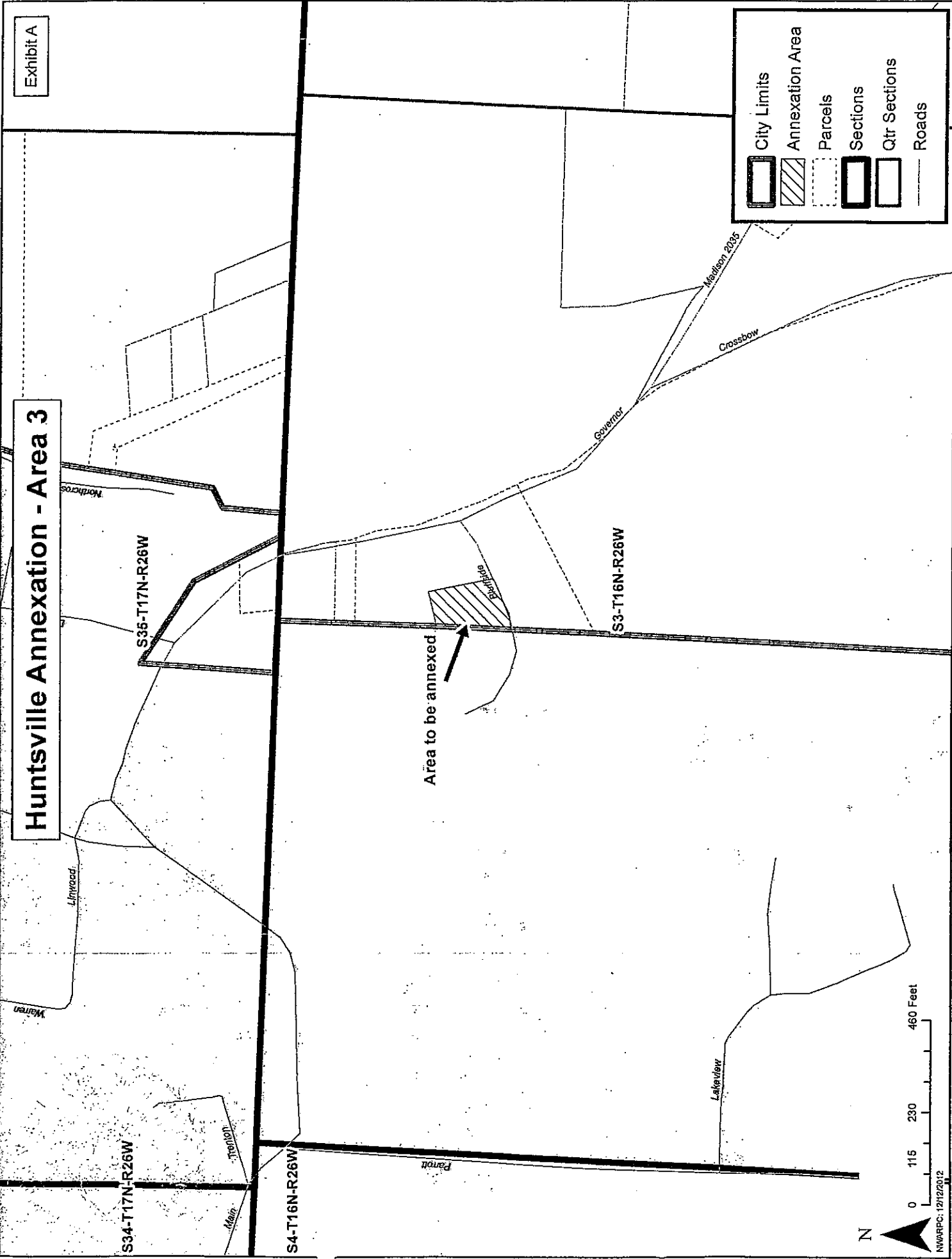

City Clerk

Huntsville Annexation - Area 3

	City Limits
	Annexation Area
	Parcels
	Sections
	Qtr Sections
	Roads

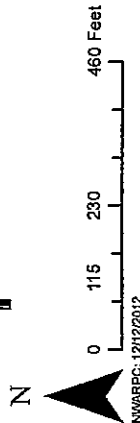

Area to be annexed



MAR 19 2013

Arkansas
Secretary of State

IN THE MADISON COUNTY COURT

IN THE MATTER OF ANNEXING TO THE CITY OF
HUNTSVILLE, ARKANSAS, CERTAIN
TERRITORY CONTIGUOUS TO THE CITY OF
HUNTSVILLE, ARKANSAS

Case No. 2012-6

DECREE OF ANNEXATION

On this, the 6 day of FEB, 2013, there is presented to the Court, by Darrell Trahan, agent of the petitioners, a petition for annexation of certain territory, hereinafter more particularly described, to the City of Huntsville, Arkansas; and the Court being fully advised of the facts and the law, doth hereby find, judge and decree as follows:

(1) That the petition was filed more than thirty (30) days prior to this date, and that in said petition, the said Darrell Trahan was selected to act on behalf of the petitioners in filing and presenting the petition;

(2) That a majority of the total number of real estate owners in the area affected by this petition, have signed said petition, and that such majority owns more than one-half of the acreage affected;

(3) That the territory sought to be annexed was accurately described in said petition, and that said territory is contiguous to the boundaries of the City of Huntsville;

(4) That attached to and made a part of said petition is an accurate map of the territory sought to be annexed into the City of Huntsville;

(5) That between the time the petition was filed, and the date of this hearing, the petitioners did cause a notice to be published once each week, for three (3) consecutive weeks, in a newspaper of general circulation in the county; and

(6) That the prayer of the petition is right and proper.

Therefore, the Court doth hereby order, judge and decree that the following described territory be and the same is hereby annexed to and made a part of the City of Huntsville, Arkansas, to-wit: Beginning at the NW corner of Lot 10 of Dogwood Unit 3, same point being on the Huntsville city limit line; thence east along the north lines of Lot 10 and Lot 9 of Dogwood Unit 3 to the NE corner of said Lot 9; thence south to the SE corner of said Lot 9; thence west along the south lines of said Lot 9 and of said Lot 10 to the SW corner of Lot 10; thence north to the P. O. B.

The Court doth further order that the original papers in this cause be delivered to the Clerk of Madison County, same to be properly recorded and filed pursuant to law.

IT IS SO ORDERED.

STATE OF ARKANSAS }
COUNTY OF MADISON } ss

I hereby certify that this instrument was filed for record in my office the 6 day of Feb, 2013, and duly recorded in 10 Record Book 206 at page 206 through 206.

Witness my hand and the Court Seal this 15 day of March, 2013
FARON LEDBETTER - County and Probate Clerk
[Signature] Deputy Clerk

[Signature]
FILED FOR RECORD
AT 10:20 O'CLOCK A.M.
Frank Weaver, FARM LEASING
COUNTY CLERK
MADISON COUNTY, ARKANSAS

FEB 06 2013

I CERTIFY THAT THIS INSTRUMENT WAS FILED FOR RECORD IN MY OFFICE AND RECORDED IN 10 BOOK 206 PAGE 206
[Signature] COUNTY CLERK
[Signature] D.C.

RESOLUTION NO. 7-13

A RESOLUTION ACCEPTING THE ANNEXATION OF CERTAIN PROPERTY

WHEREAS, a majority of the owners, owning a majority of certain property hereinafter described, located in Madison County and contiguous to the corporate limits of the City of Huntsville, heretofore filed a petition in the Madison County Court to annex territory to the City of Huntsville, Arkansas; and

WHEREAS, a notice was duly published, as required by law, of the filing of said petition and that a hearing on the petition would held in the County Court of Madison County; and

WHEREAS, at the time and place fixed in said notice, the County Court, being fully advised of the facts and the law, heard all persons desiring to be heard. The Court subsequently ascertained and declared in a Decree of Annexation order that the petition was signed by a majority of the real estate owners, owning a majority of the acreage affected; that said territory sought to be annexed was accurately described in said petition; that said territory is contiguous to the corporate boundary of Huntsville; that an accurate map of said territory was attached to and made a part of said petition; and that the prayer of the petition is right and proper, and ordered that the territory be annexed to the City of Huntsville; and

WHEREAS, no appeals having been taken within thirty (30) days from issuance of the County Court's order, it is now the desire of the Huntsville City Council to accept the said annexation.

NOW, THEREFORE, BE IT RESOLVED BY THE CITY COUNCIL OF THE CITY OF HUNTSVILLE, ARKANSAS:

That the following described land is hereby annexed into and accepted as part of the City of Huntsville, Arkansas, to-wit:

Beginning at the NW corner of Lot 10 of Dogwood Unit 3, same point being on the Huntsville city limit line; thence east along the north lines of Lot 10 and Lot 9 of Dogwood Unit 3 to the NE corner of said Lot 9; thence south to the SE corner of said Lot 9; thence west along the south lines of said Lot 9 and of said Lot 10 to the SW corner of Lot 10; thence north to the P. O. B.

PASSED AND APPROVED THIS 11 **DAY OF** March, 2013.

Attest:

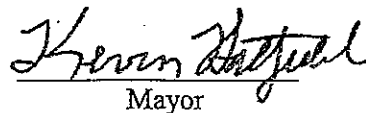

City Clerk

Mayor

Huntsville Annexation - Area 4

Exhibit A

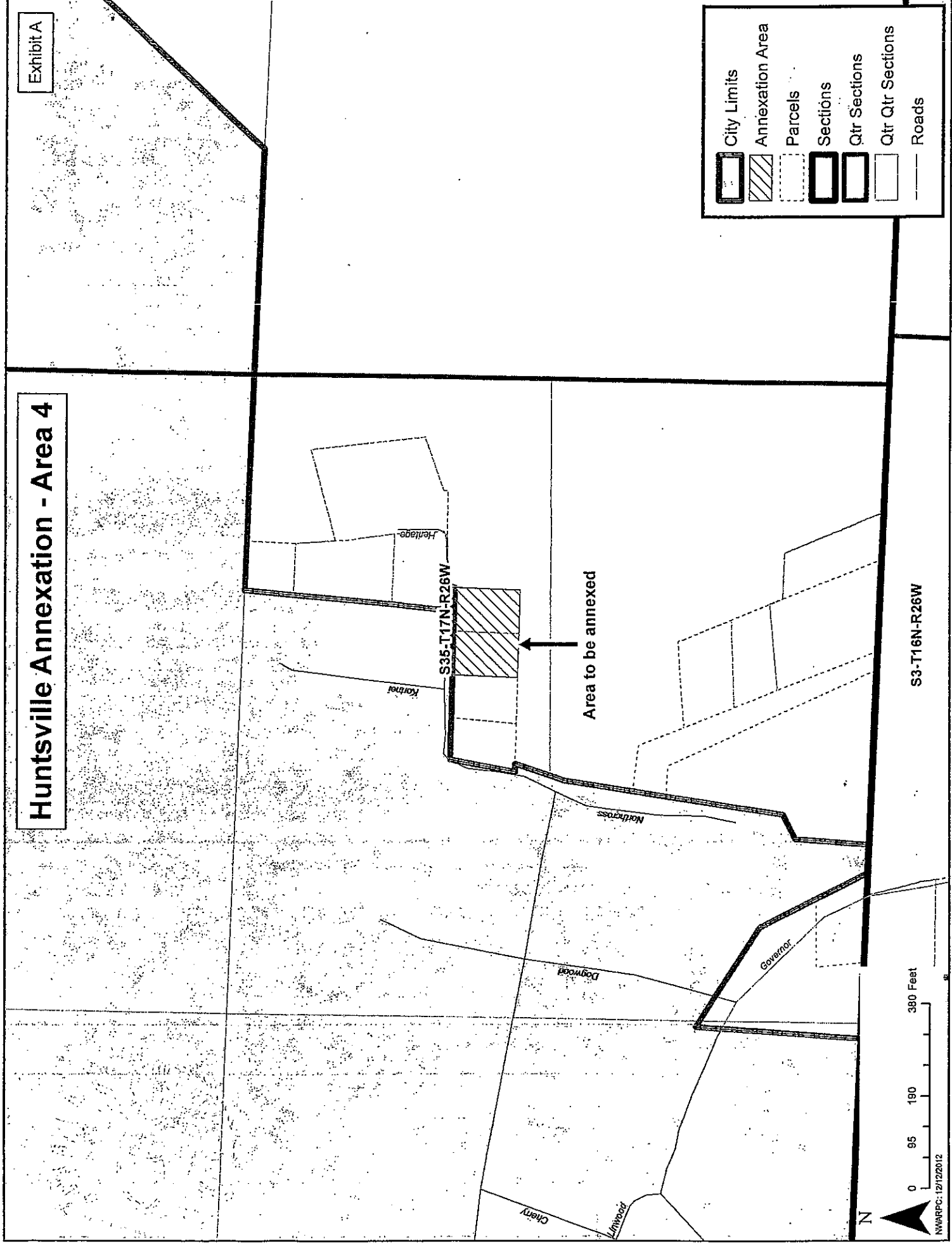
	City Limits
	Annexation Area
	Parcels
	Sections
	Qtr Sections
	Qtr Qtr Sections
	Roads



S3-T16N-R26W

0 95 190 380 Feet

N
NW/RPC:12/12/2012

MAR 19 2013

Arkansas
Secretary of State

IN THE MADISON COUNTY COURT

IN THE MATTER OF ANNEXING TO THE CITY OF
HUNTSVILLE, ARKANSAS, CERTAIN
TERRITORY CONTIGUOUS TO THE CITY OF
HUNTSVILLE, ARKANSAS

Case No. 201 2-7

DECREE OF ANNEXATION

On this, the 6 day of FEB, 2013, there is presented to the Court, by Darrell Trahan, agent of the petitioners, a petition for annexation of certain territory, hereinafter more particularly described, to the City of Huntsville, Arkansas; and the Court being fully advised of the facts and the law, doth hereby find, judge and decree as follows:

(1) That the petition was filed more than thirty (30) days prior to this date, and that in said petition, the said Darrell Trahan was selected to act on behalf of the petitioners in filing and presenting the petition;

(2) That a majority of the total number of real estate owners in the area affected by this petition, have signed said petition, and that such majority owns more than one-half of the acreage affected;

(3) That the territory sought to be annexed was accurately described in said petition, and that said territory is contiguous to the boundaries of the City of Huntsville;

(4) That attached to and made a part of said petition is an accurate map of the territory sought to be annexed into the City of Huntsville;

(5) That between the time the petition was filed, and the date of this hearing, the petitioners did cause a notice to be published once each week, for three (3) consecutive weeks, in a newspaper of general circulation in the county; and

(6) That the prayer of the petition is right and proper.

Therefore, the Court doth hereby order, judge and decree that the following described territory be and the same is hereby annexed to and made a part of the City of Huntsville, Arkansas, to-wit: Part of the NW ¼ NW ¼ of S34, T17N, R26W described as follows: Beginning at the intersection of the Huntsville city limit line and the eastern edge of U.S. 412 Business (West); thence west along said city limit line to a point, same being the SW corner of parcel 001-11737-000; thence northwesterly along the west line of said parcel to the NW corner of said parcel; thence northeasterly along the north line of said parcel to the NE corner of said parcel; thence southeasterly along the east line of said parcel to the eastern edge of U.S. 412 Business (West) thence southeasterly along the eastern edge of U.S. 412 Business (West) to the P. O. B.

The Court doth further order that the original papers in this cause be delivered to the Clerk of Madison County, same to be docketed and filed pursuant to law.

IT IS SO ORDERED.

MADISON COUNTY, ARKANSAS

FEB 06 2013

Frank Weaver
Frank Weaver, County Judge

STATE OF ARKANSAS }
COUNTY OF MADISON } SS
I hereby certify that this instrument was filed
record in my office the 6 day of Feb
2, and duly recorded in 60 Record Book
2 at page 201 through 201
less my hand and the Court Seal this 15
of March, 2013
FRANK WEAVER, County and Probate Clerk
Deputy Clerk

I CERTIFY THAT THIS INSTRUMENT WAS FILED
FOR RECORD IN MY OFFICE AND RECORDED
IN 60 BOOK 2 PAGE 201
Frank Weaver
COUNTY CLERK
D.C.

RESOLUTION NO. 8-13

A RESOLUTION ACCEPTING THE ANNEXATION OF CERTAIN PROPERTY

WHEREAS, a majority of the owners, owning a majority of certain property hereinafter described, located in Madison County and contiguous to the corporate limits of the City of Huntsville, heretofore filed a petition in the Madison County Court to annex territory to the City of Huntsville, Arkansas; and

WHEREAS, a notice was duly published, as required by law, of the filing of said petition and that a hearing on the petition would held in the County Court of Madison County; and

WHEREAS, at the time and place fixed in said notice, the County Court, being fully advised of the facts and the law, heard all persons desiring to be heard. The Court subsequently ascertained and declared in a Decree of Annexation order that the petition was signed by a majority of the real estate owners, owning a majority of the acreage affected; that said territory sought to be annexed was accurately described in said petition; that said territory is contiguous to the corporate boundary of Huntsville; that an accurate map of said territory was attached to and made a part of said petition; and that the prayer of the petition is right and proper, and ordered that the territory be annexed to the City of Huntsville; and

WHEREAS, no appeals having been taken within thirty (30) days from issuance of the County Court's order, it is now the desire of the Huntsville City Council to accept the said annexation.

NOW, THEREFORE, BE IT RESOLVED BY THE CITY COUNCIL OF THE CITY OF HUNTSVILLE, ARKANSAS:

That the following described land is hereby annexed into and accepted as part of the City of Huntsville, Arkansas, to-wit:

Part of the NW $\frac{1}{4}$ NW $\frac{1}{4}$ of S34, T17N, R26W described as follows: Beginning at the intersection of the Huntsville city limit line and the eastern edge of U.S. 412 Business (West); thence west along said city limit line to a point, same being the SW corner of parcel 001-11737-000; thence northwesterly along the west line of said parcel to the NW corner of said parcel; thence northeasterly along the north line of said parcel to the NE corner of said parcel; thence southeasterly along the east line of said parcel to the eastern

edge of U.S. 412 Business (West) thence southeasterly along the eastern edge of U.S. 412 Business (West) to the P. O. B.

PASSED AND APPROVED THIS 11th DAY OF March, 2013.

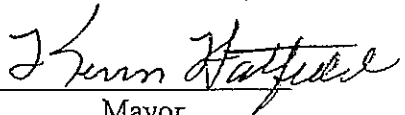

Mayor







Attest:



City Clerk

Huntsville Annexation - Area 5

Exhibit A

	City Limits
	Annexation Area
	Parcels
	Sections
	Qtr Sections
	Qtr Qtr Sections
	Roads

S27-T17N-R26W

S34-T17N-R26W

S28-T17N-R26W

S33-T17N-R26W

Medison 8621

Business 2

College

Acorn

Cedar

Cash

Miller

Gaskin

Area to be annexed



NWAPC:12/12/2012

MAR 19 2013

Arkansas Secretary of State

IN THE MADISON COUNTY COURT

IN THE MATTER OF ANNEXING TO THE CITY OF HUNTSVILLE, ARKANSAS, CERTAIN TERRITORY CONTIGUOUS TO THE CITY OF HUNTSVILLE, ARKANSAS

Case No. 2012-8

DECREE OF ANNEXATION

On this, the 6 day of FEB, 2013, there is presented to the Court, by Darrell Trahan, agent of the petitioners, a petition for annexation of certain territory, hereinafter more particularly described, to the City of Huntsville, Arkansas; and the Court being fully advised of the facts and the law, doth hereby find, judge and decree as follows:

- (1) That the petition was filed more than thirty (30) days prior to this date, and that in said petition, the said Darrell Trahan was selected to act on behalf of the petitioners in filing and presenting the petition;
(2) That a majority of the total number of real estate owners in the area affected by this petition, have signed said petition, and that such majority owns more than one-half of the acreage affected;
(3) That the territory sought to be annexed was accurately described in said petition, and that said territory is contiguous to the boundaries of the City of Huntsville;
(4) That attached to and made a part of said petition is an accurate map of the territory sought to be annexed into the City of Huntsville;
(5) That between the time the petition was filed, and the date of this hearing, the petitioners did cause a notice to be published once each week, for three (3) consecutive weeks, in a newspaper of general circulation in the county; and
(6) That the prayer of the petition is right and proper.

Therefore, the Court doth hereby order, judge and decree that the following described territory be and the same is hereby annexed to and made a part of the City of Huntsville, Arkansas, to-wit: Start at the SW corner of the SE 1/4 of S27, T17N, R26W; thence north along the west line of said SE 1/4 967.24 feet to the point of beginning, same being on the Huntsville city limit line and the NW corner of parcel 001-11554-001; thence easterly along the north line of parcels 001-11554-001 and 075-00629-003 to the center of Town Branch Creek, same point being on the city limit line; thence southerly, westerly, and northerly along the city limit line to the P. O. B.

The Court doth further order that the original papers in this cause be delivered to the Clerk of Madison County, same to be properly recorded and filed pursuant to law.

FILED FOR RECORD AT 10:20 O'CLOCK A.M. FARON LEDBETTER COUNTY CLERK MADISON COUNTY, ARKANSAS

Frank Weaver, County Judge

IT IS SO ORDERED.

FEB 06 2013

STATE OF ARKANSAS } COUNTY OF MADISON } SS I hereby certify that this instrument was filed for record in my office the 6th day of Feb, 2013 and duly recorded in Record Book 12 at page 208 through 208. I witness my hand and the Court Seal this 15th day of March, 2013. FARON LEDBETTER County and Probate Clerk J. Smith Deputy Clerk

I CERTIFY THAT THIS INSTRUMENT WAS FILED FOR RECORD IN MY OFFICE AND RECORDED IN BOOK 12 PAGE 208. Frank Ledbetter COUNTY CLERK J. Smith D.C.

RESOLUTION NO. 9-13

A RESOLUTION ACCEPTING THE ANNEXATION OF CERTAIN PROPERTY

WHEREAS, a majority of the owners, owning a majority of certain property hereinafter described, located in Madison County and contiguous to the corporate limits of the City of Huntsville, heretofore filed a petition in the Madison County Court to annex territory to the City of Huntsville, Arkansas; and

WHEREAS, a notice was duly published, as required by law, of the filing of said petition and that a hearing on the petition would held in the County Court of Madison County; and

WHEREAS, at the time and place fixed in said notice, the County Court, being fully advised of the facts and the law, heard all persons desiring to be heard. The Court subsequently ascertained and declared in a Decree of Annexation order that the petition was signed by a majority of the real estate owners, owning a majority of the acreage affected; that said territory sought to be annexed was accurately described in said petition; that said territory is contiguous to the corporate boundary of Huntsville; that an accurate map of said territory was attached to and made a part of said petition; and that the prayer of the petition is right and proper, and ordered that the territory be annexed to the City of Huntsville; and

WHEREAS, no appeals having been taken within thirty (30) days from issuance of the County Court's order, it is now the desire of the Huntsville City Council to accept the said annexation.

NOW, THEREFORE, BE IT RESOLVED BY THE CITY COUNCIL OF THE CITY OF HUNTSVILLE, ARKANSAS:

That the following described land is hereby annexed into and accepted as part of the City of Huntsville, Arkansas, to-wit:

Start at the SW corner of the SE ¼ of S27, T17N, R26W; thence north along the west line of said SE ¼ 967.24 feet to the point of beginning, same being on the Huntsville city limit line and the NW corner of parcel 001-11554-001; thence easterly along the north line of parcels 001-11554-001 and 075-00629-003 to the center of Town Branch Creek, same point being on the city limit line; thence southerly, westerly, and northerly along the city limit line to the P. O. B.

PASSED AND APPROVED THIS 11 DAY OF March, 2013.



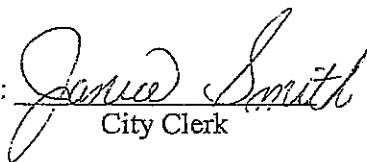





Attest:



City Clerk

Mayor

Huntsville Annexation - Area 6

Exhibit A

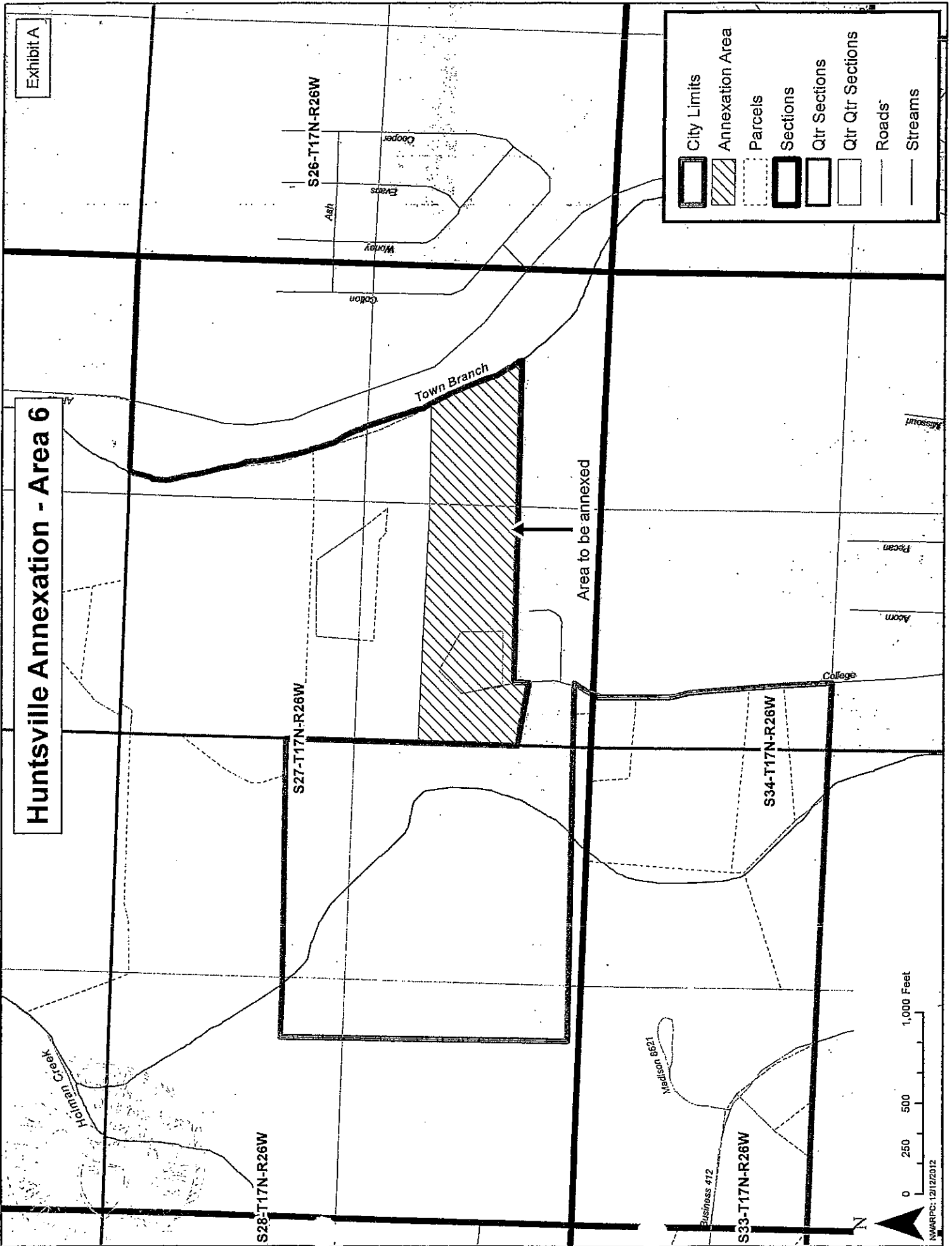
	City Limits
	Annexation Area
	Parcels
	Sections
	Qtr Sections
	Qtr Qtr Sections
	Roads
	Streams



MAR 19 2013

Arkansas
Secretary of State

IN THE MADISON COUNTY COURT

IN THE MATTER OF ANNEXING TO THE CITY OF
HUNTSVILLE, ARKANSAS, CERTAIN
TERRITORY CONTIGUOUS TO THE CITY OF
HUNTSVILLE, ARKANSAS

Case No. 201 2-9

DECREE OF ANNEXATION

On this, the 6 day of FEB, 2013, there is presented to the Court, by Darrell Trahan, agent of the petitioners, a petition for annexation of certain territory, hereinafter more particularly described, to the City of Huntsville, Arkansas; and the Court being fully advised of the facts and the law, doth hereby find, judge and decree as follows:

(1) That the petition was filed more than thirty (30) days prior to this date, and that in said petition, the said Darrell Trahan was selected to act on behalf of the petitioners in filing and presenting the petition;

(2) That a majority of the total number of real estate owners in the area affected by this petition, have signed said petition, and that such majority owns more than one-half of the acreage affected;

(3) That the territory sought to be annexed was accurately described in said petition, and that said territory is contiguous to the boundaries of the City of Huntsville;

(4) That attached to and made a part of said petition is an accurate map of the territory sought to be annexed into the City of Huntsville;

(5) That between the time the petition was filed, and the date of this hearing, the petitioners did cause a notice to be published once each week, for three (3) consecutive weeks, in a newspaper of general circulation in the county; and

(6) That the prayer of the petition is right and proper.

Therefore, the Court doth hereby order, judge and decree that the following described territory be and the same is hereby annexed to and made a part of the City of Huntsville, Arkansas, to-wit: All unincorporated territory contiguous to the city limits of Huntsville, lying in the E 1/2 of the NW 1/4 of S25, T17N, R26W, less and except parcels: 001-11473-005; 001-11471-002; 001-11470-002; 001-11470-000; and 001-11470-001; and less and except that part of the U.S. 412 R-O-W lying east of the N/S centerline of the NE 1/4 NW 1/4 of said S25.

The Court doth further order that the original papers in this cause be delivered to the Clerk of Madison County, same to be properly recorded and filed pursuant to law.

IT IS SO ORDERED.

FILED FOR RECORD
AT 10:30 O'CLOCK A.M.
FARON LEDBETTER
COUNTY CLERK
MADISON COUNTY, ARKANSAS

Frank Weaver
Frank Weaver, County Judge

FEB 06 2013

STATE OF ARKANSAS }
COUNTY OF MADISON } SS
I hereby certify that this instrument was filed
for record in my office the 6 day of Feb,
12 and duly recorded in 12 Record Book
12 at page 209 through 12.
Witness my hand and the Court Seal this 12
day of March, 2013
FARON LEDBETTER - County and Probate Clerk
Faron Ledbetter Deputy Clerk

I CERTIFY THAT THIS INSTRUMENT WAS FILED
FOR RECORD IN MY OFFICE AND RECORDED
IN 12 BOOK 12 PAGE 209
Faron Ledbetter COUNTY CLERK
Darrell Trahan D.C.

RESOLUTION NO. 10-13

A RESOLUTION ACCEPTING THE ANNEXATION OF CERTAIN PROPERTY

WHEREAS, a majority of the owners, owning a majority of certain property hereinafter described, located in Madison County and contiguous to the corporate limits of the City of Huntsville, heretofore filed a petition in the Madison County Court to annex territory to the City of Huntsville, Arkansas; and

WHEREAS, a notice was duly published, as required by law, of the filing of said petition and that a hearing on the petition would held in the County Court of Madison County; and

WHEREAS, at the time and place fixed in said notice, the County Court, being fully advised of the facts and the law, heard all persons desiring to be heard. The Court subsequently ascertained and declared in a Decree of Annexation order that the petition was signed by a majority of the real estate owners, owning a majority of the acreage affected; that said territory sought to be annexed was accurately described in said petition; that said territory is contiguous to the corporate boundary of Huntsville; that an accurate map of said territory was attached to and made a part of said petition; and that the prayer of the petition is right and proper, and ordered that the territory be annexed to the City of Huntsville; and

WHEREAS, no appeals having been taken within thirty (30) days from issuance of the County Court's order, it is now the desire of the Huntsville City Council to accept the said annexation.

NOW, THEREFORE, BE IT RESOLVED BY THE CITY COUNCIL OF THE CITY OF HUNTSVILLE, ARKANSAS:

That the following described land is hereby annexed into and accepted as part of the City of Huntsville, Arkansas, to-wit:

All unincorporated territory contiguous to the city limits of Huntsville, lying in the E ½ of the NW ¼ of S25, T17N, R26W, less and except parcels: 001-11473-005; 001-11471-002; 001-11470-002; 001-11470-000; and 001-11470-001; and less and except that part of the U.S. 412 R-O-W lying east of the N/S centerline of the NE ¼ NW ¼ of said S25.

PASSED AND APPROVED THIS 11 DAY OF March, 2013.

Mayor

Attest:

City Clerk

Huntsville Annexation - Area 7

Exhibit A

	City Limits
	Annexation Area
	Parcels
	Sections
	Qtr Sections
	Qtr Qtr Sections
	Roads
	Streams

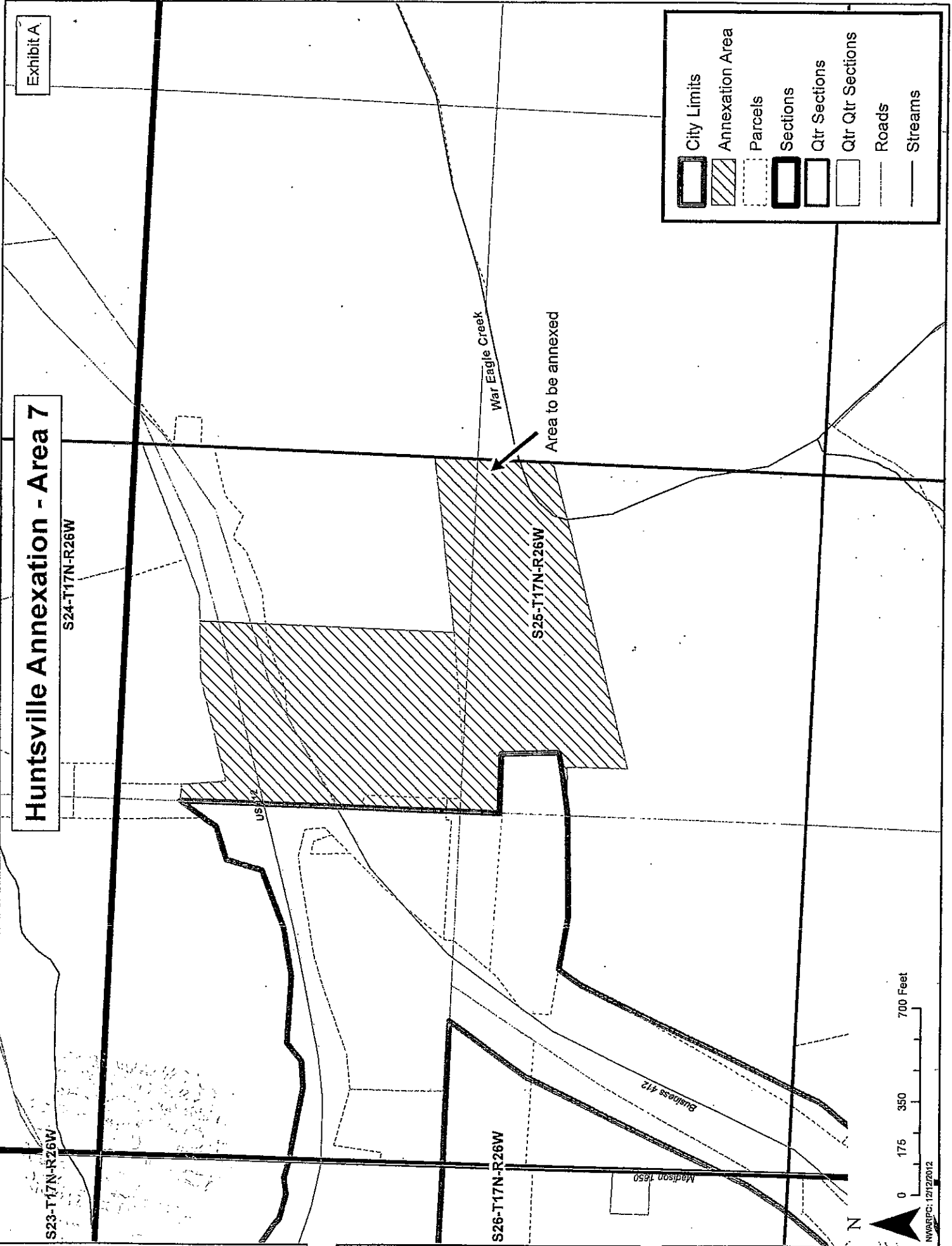

IN THE MADISON COUNTY COURT

FILED FOR RECORD AT 3:10 O'CLOCK P.M.

FARON LEDBETTER COUNTY CLERK

Case No. MADISON COUNTY, ARKANSAS

IN THE MATTER OF ANNEXING TO THE CITY OF HUNTSVILLE, ARKANSAS, CERTAIN TERRITORY CONTIGUOUS TO THE CITY OF HUNTSVILLE, ARKANSAS

FEB 08 2013

DECREE OF ANNEXATION

I CERTIFY THAT THIS INSTRUMENT WAS FILED FOR RECORD IN MY OFFICE AND RECORDED IN Court BOOK 12 PAGE 210-21 Faron Ledbetter COUNTY CLERK D.C.

On this, the 8 day of FEB, 2013, there is presented to the Court, by Darrell Trahan, agent of the petitioners, a petition for annexation of certain territory, hereinafter more particularly described, to the City of Huntsville, Arkansas; and the Court being fully advised of the facts and the law, doth hereby find, judge and decree as follows:

- (1) That the petition was filed more than thirty (30) days prior to this date, and that in said petition, the said Darrell Trahan was selected to act on behalf of the petitioners in filing and presenting the petition;
(2) That a majority of the total number of real estate owners in the area affected by this petition, have signed said petition, and that such majority owns more than one-half of the acreage affected;
(3) That the territory sought to be annexed was accurately described in said petition, and that said territory is contiguous to the boundaries of the City of Huntsville;
(4) That attached to and made a part of said petition is an accurate map of the territory sought to be annexed into the City of Huntsville;
(5) That between the time the petition was filed, and the date of this hearing, the petitioners did cause a notice to be published once each week, for three (3) consecutive weeks, in a newspaper of general circulation in the county; and
(6) That the Court, in light of relevant public comments and concerns received, has elected to exclude from this annexation, parcel 001-11559-000; parcel 001-11559-002; and parcel 003-11559-000. As such said parcels have been less and excepted from the description below, and a revised map showing the territory to be annexed is attached hereto.
(7) That the prayer of the petition is right and proper.

Therefore, the Court doth hereby order, judge and decree that the following described territory be and the same is hereby annexed to and made a part of the City of Huntsville, Arkansas, to-wit: Beginning at a point on the Huntsville city limit line at the intersection of Town Branch Creek and the E/W center section line of S27, T17N, R26W; thence in a generally easterly direction along said city limit line to the east line of the NW 1/4 NW 1/4 of S25, T17N, R26W; thence north to the north line of said S25; thence west along the north lines of S25 and S26 of T17N, R26W to the SE corner of the SW 1/4 SE 1/4 of S23, T17N, R26W; thence north to the NE corner of said SW 1/4 SE 1/4; thence west to the NW corner of said SW 1/4 SE 1/4; thence north to the E/W center section line of said S23; thence west along the E/W center section lines of S23 and S22 of T17N, R26W to the NE corner of the NE 1/4 SW 1/4 of said S22; thence south along the east line of said NE 1/4 SW

FILED MAR 19 2013 Secretary of State Arkansas

STATE OF ARKANSAS COUNTY OF MADISON I hereby certify that this instrument was filed for record in my office the 6 day of Feb and duly recorded in Record Book at page 210 through 211 Witness my hand and the Court Seal this 10 day of Feb FARON LEDBETTER - County and Probate Clerk Deputy Clerk

¼ to the R-O-W of U.S. 412; thence westerly along said R-O-W to the north line of the S ¼ of said S22; thence west along the north lines of the S ¼ of S22 and S21 of T17N, R26W to the NW corner of the SE ¼ SW ¼ of said S21; thence south along the west lines of said SE ¼ SW ¼ and the NE ¼ NW ¼ of S28, T17N, R26W to the SW corner of said NE ¼ NW ¼; thence east to the NW corner of the SW ¼ NE ¼ of said S28; thence south to the SW corner of said SW ¼ NE ¼; thence east along the E/W center section lines of S28 and S27 of T17N, R26W to the P. O. B.; less and except the following parcels: 001-11414-000; 001-11415-000; 001-11418-000; 001-11419-000; 001-11425-001; 001-11430-000; 001-11431-000; 001-11431-002; 001-11433-000; 001-11433-002; 001-11470-002; 001-11492-000; 001-11494-000; 001-11494-001; 001-11527-000; 001-11531-000; 001-11532-000; 001-11532-001; 001-11534-000; 001-11539-000; 001-11540-000; 001-11541-000; 001-11559-000; 001-11559-002; 003-11559-000; 001-11562-000; 001-11562-002; 095-00001-000; 095-00002-000; 095-00007-000; 095-00010-000; 095-00011-000.

The Court doth further order that the original papers in this cause be delivered to the Clerk of Madison County, same to be properly recorded and filed pursuant to law.

IT IS SO ORDERED.

Frank Weaver, County Judge

RESOLUTION NO. 11-13

A RESOLUTION ACCEPTING THE ANNEXATION OF CERTAIN PROPERTY

WHEREAS, a majority of the owners, owning a majority of certain property hereinafter described, located in Madison County and contiguous to the corporate limits of the City of Huntsville, heretofore filed a petition in the Madison County Court to annex territory to the City of Huntsville, Arkansas; and

WHEREAS, a notice was duly published, as required by law, of the filing of said petition and that a hearing on the petition would held in the County Court of Madison County; and

WHEREAS, at the time and place fixed in said notice, the County Court, being fully advised of the facts and the law, heard all persons desiring to be heard. The Court subsequently ascertained and declared in a Decree of Annexation order that the petition was signed by a majority of the real estate owners, owning a majority of the acreage affected; that said territory sought to be annexed was accurately described in said petition; that said territory is contiguous to the corporate boundary of Huntsville; that an accurate map of said territory was attached to and made a-part of said petition; and that the prayer of the petition is right and proper, and ordered that the territory be annexed to the City of Huntsville; and

WHEREAS, no appeals having been taken within thirty (30) days from issuance of the County Court's order, it is now the desire of the Huntsville City Council to accept the said annexation.

NOW; THEREFORE, BE IT RESOLVED BY THE CITY COUNCIL OF THE CITY OF HUNTSVILLE, ARKANSAS:

That the following described land is hereby annexed into and accepted as part of the City of Huntsville, Arkansas, to-wit:

Beginning at a point on the Huntsville city limit line at the intersection of Town Branch Creek and the E/W center section line of S27, T17N, R26W; thence in a generally easterly direction along said city limit line to the east line of the NW $\frac{1}{4}$ NW $\frac{1}{4}$ of S25, T17N, R26W; thence north to the north line of said S25; thence west along the north lines of S25 and S26 of T17N, R26W to the SE corner of the SW $\frac{1}{4}$ SE $\frac{1}{4}$ of S23, T17N, R26W; thence north to the NE corner of said SW $\frac{1}{4}$ SE $\frac{1}{4}$; thence west to the NW corner of said SW $\frac{1}{4}$ SE $\frac{1}{4}$; thence north to the E/W center section line of said S23; thence west along the E/W center section lines of S23 and S22 of T17N, R26W to the NE corner of the NE $\frac{1}{4}$ SW $\frac{1}{4}$ of said S22; thence south along the east line of said NE $\frac{1}{4}$ SW $\frac{1}{4}$ to the R-O-W of U.S. 412; thence westerly along said R-O-W to the north line of the S $\frac{1}{4}$ of said S22; thence west along the north lines of the S $\frac{1}{4}$ of S22 and S21 of T17N, R26W to

the NW corner of the SE ¼ SW ¼ of said S21; thence south along the west lines of said SE ¼ SW ¼ and the NE ¼ NW ¼ of S28, T17N, R26W to the SW corner of said NE ¼ NW ¼; thence east to the NW corner of the SW ¼ NE ¼ of said S28; thence south to the SW corner of said SW ¼ NE ¼; thence east along the E/W center section lines of S28 and S27 of T17N, R26W to the P. O. B.; less and except the following parcels: 001-11414-000; 001-11415-000; 001-11418-000; 001-11419-000; 001-11425-001; 001-11430-000; 001-11431-000; 001-11431-002; 001-11433-000; 001-11433-002; 001-11470-002; 001-11492-000; 001-11494-000; 001-11494-001; 001-11527-000; 001-11531-000; 001-11532-000; 001-11532-001; 001-11534-000; 001-11539-000; 001-540-000; 001-11541-000; 001-11559-000; 001-11559-002; 003-11559-000; 001-11562-000; 001-11562-002; 095-00001-000; 095-00002-000; 095-00007-000; 095-00010-000; 095-00011-000.

PASSED AND APPROVED THIS 11th DAY OF March, 2013.

Mayor

Attest:

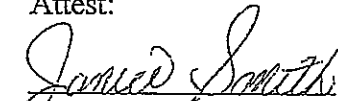
City Clerk

Huntsville Annexation - Area 8

Exhibit A

War Eagle Creek

Madison 1267

S24-T17N-R26W

Madison 1325

Madison 1319

S14-T17N-R26W

S23-T17N-R26W

Madison 1285

Madison 1650

Madison 1623

Madison 1620

Madison 1746

Madison 1670

S26-T17N-R26W

Madison 1712

Madison 2200

S35-T17N-R26W

Cooper

Evans

Ash

Collins

Town Branch

Area to be annexed

S27-T17N-R26W

S34-T17N-R26W

Madison 1610

S22-T17N-R26W

Madison 8925

S16-T17N-R26W

S21-T17N-R26W

Smyrna Branch

Madison 8633

S28-T17N-R26W

Holman Creek

Madison 862

Madison 412

2,400 Feet

1,200

600

0

2,400 Feet

0 600 1,200 2,400 Feet

0 600 1,200 2,400 Feet

0 600 1,200 2,400 Feet

Legend:

- City Limits
- Annexation Area
- Parcels
- Sections
- Qtr Sections
- Qtr Qtr Sections
- Roads
- Streams

F I L E D

MAR 19 2013

**Arkansas
Secretary of State**

ORDINANCE 13-5

L201300690
MADISON CO, AR FEE \$0.00
PRESENTED: 03-13-2013 09:41:59 AM
RECORDED: 03-13-2013
PHYLLIS VILLINES
CIRCUIT CLERK AND RECORDER
BY: FRANCES EASTERLING
DEPUTY CLERK
MISCELLANEOUS FEE
14 Pages

AN ORDINANCE ANNEXING CERTAIN LANDS THAT ARE COMPLETELY SURROUNDED BY THE INCORPORATED LIMITS OF THE CITY OF HUNTSVILLE; DECLARING AN EMERGENCY; AND FOR OTHER PURPOSES

WHEREAS, A.C.A. 14-40-501 – 14-40-503 provides that unincorporated islands of land that have been completely surrounded by the incorporated limits of a municipality may be annexed by that municipality; and

WHEREAS, the City of Huntsville desires to annex certain lands more completely described below; and

WHEREAS, the area to be annexed complies with the standards for lands qualifying for annexation which are set forth in A.C.A. 14-40-302 and A.C.A. 14-40-501; and

WHEREAS, on January 24, 2013, a legal notice was published setting out the description of the territory proposed to be annexed, and all property owners within the area were notified by certified mail of their right to appear at a public hearing on this matter; and

WHEREAS, said public hearing was held on February 11, 2013 at 6:00 PM.

NOW, THEREFORE, BE IT ORDAINED BY THE CITY COUNCIL OF THE CITY OF HUNTSVILLE, ARKANSAS:

SECTION 1. That the following described unincorporated lands, which are completely surrounded by the city limits of the City of Huntsville, are hereby annexed to the City of Huntsville: All unincorporated territory in the E ½ of S26, T17N, R26W lying south of the Huntsville northern city limit line and west of U.S. 412 Business (East); AND all unincorporated territory in the SW ¼ of the NW ¼ of S25, T17N, R26W lying west of U.S. 412 Business (East).

SECTION 2. That the above described territory shall be annexed to and become a part of Ward # 3 of the City of Huntsville, and the same shall henceforth be a part of said ward as fully as existing parts of said ward.

SECTION 3. All necessary urban services, such as police and fire protection, shall be extended to such area within a reasonable time.

SECTION 4. Emergency Clause. Because these areas are in need of all necessary urban services, such as police and fire protection, and this is necessary for the public peace, health, safety and welfare, an emergency is declared to exist. Therefore, this ordinance

shall be in full force and effect from and after the date of its passage, approval, and publication.

PASSED AND APPROVED THIS 11th DAY OF March, 2013.

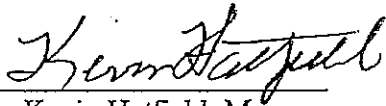
Kevin Hatfield, Mayor

ATTEST:

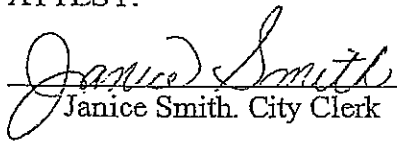
Janice Smith, City Clerk

Huntsville Annexation Areas - 2013

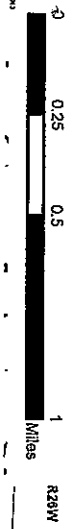
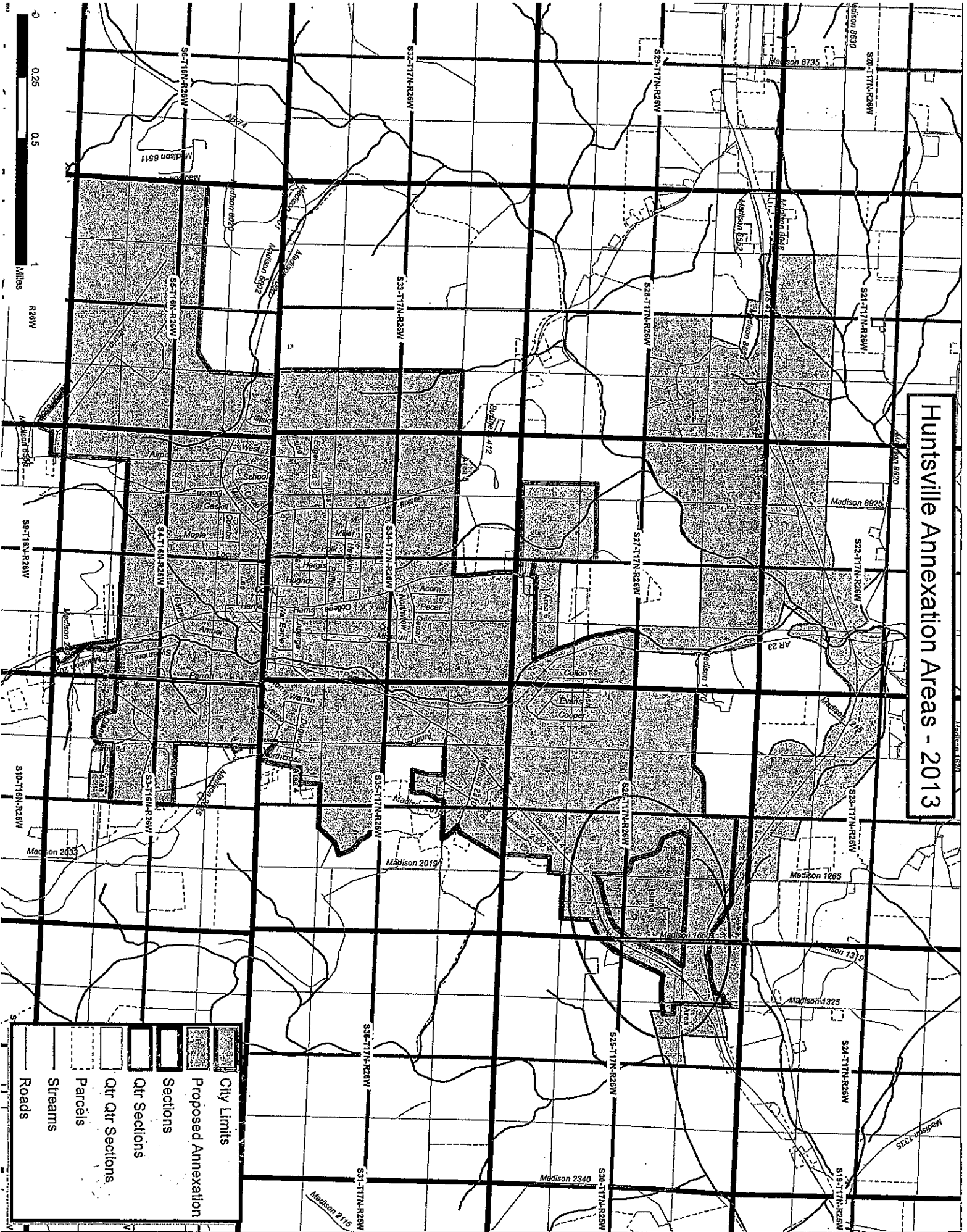

	City Limits
	Proposed Annexation
	Sections
	Qtr Sections
	Qtr Qtr Sections
	Parcels
	Streams
	Roads



FARON LEDBETTER

MADISON COUNTY CLERK
P. O. BOX 37
HUNTSVILLE, ARKANSAS 72740
PHONE 479-738-2747
FAX 479-738-2735



March 15, 2013

State of Arkansas
Secretary of State
Room 256 State Capitol
Little Rock, AR 72201-1094

Re: Annexation of Lands to the City of Huntsville, Arkansas

Dear Sir or Madam:

In accordance with A.C.A. 14-40-605, please find enclosed the following nine (9) sets of documents, which annex different parcels of land into the City of Huntsville, Arkansas:

1. Decree of Annexation, CC-2012-3; Resolution 4-13; and Plat Map for Area 1
2. Decree of Annexation, CC-2012-4; Resolution 5-13; and Plat Map for Area 2
3. Decree of Annexation, CC-2012-5; Resolution 6-13; and Plat Map for Area 3
4. Decree of Annexation, CC-2012-6; Resolution 7-13; and Plat Map for Area 4
5. Decree of Annexation, CC-2012-7; Resolution 8-13; and Plat Map for Area 5
6. Decree of Annexation, CC-2012-8; Resolution 9-13; and Plat Map for Area 6
7. Decree of Annexation, CC-2012-9; Resolution 10-13; and Plat Map for Area 7
8. Decree of Annexation, CC-2012-10; Resolution 11-13; and Plat Map for Area 8
9. Ordinance No. 13-5 and Plat Map showing Island to be Annexed

If you should have any questions, please feel free to give me a call.

Thank you,

A handwritten signature in black ink that reads "Tamitha Blocker".

Tamitha Blocker
Deputy County Clerk

Encl

FILED

MAR 19 2013

Arkansas
Secretary of State



ARKANSAS SECRETARY OF STATE

MARK MARTIN

May 1, 2013

Faron Ledbetter
Madison County Clerk
PO Box 37
Huntsville AR 72740

RE: Annexation

Dear Mr. Ledbetter,

The following information has been recorded and filed in the office of the Secretary of State:

County: Madison City: Huntsville

Annexation:

Ordinance No. 13-5 – March 13, 2013

County Court Order – No. 2012-10 – February 6, 2013; Resolution 11-13 and Plat (Area 8) AMENDED

By copy of this letter, I am sending file marked copies of all of the information to the UALR Institute for Economic Advancement, Arkansas Highway Mapping Department, and TomTom. All others listed will only receive notification of the annexation by copy of this letter. Annexations should also be filed with your County Clerk's office. Please provide a copy of these documents to your County Clerk, if you haven't already done so.

If you have any questions please do not hesitate to contact me at 1-800-482-1127 or 501-683-6729.

Sincerely,

A handwritten signature in black ink, appearing to read "Justin Tate".

Justin Tate
Assistant Legal Counsel
Arkansas Secretary of State

CC: UALR Institute for Economic Advancement
Arkansas Highway Mapping Department
TomTom
Arkansas Municipal League
Shelby Johnson, State Geographical Information Officer
Janice Smith, Huntsville City Recorder





FARON LEDBETTER

MADISON COUNTY CLERK
P. O. BOX 37
HUNTSVILLE, ARKANSAS 72740
PHONE 479-738-2747
FAX 479-738-2735



April 17, 2013

Arkansas Secretary of State
State Capitol
Attn: Justin Tate, Assistant Legal Counsel
Room 256
Little Rock, AR 72201-1094

RE: Amended Annexation Decree and Resolution
City of Huntsville, Arkansas

Dear Mr. Tate:

Please find enclosed an Amended Decree of Annexation and Resolution No. 12-13 for the City of Huntsville, Arkansas.

The original decree, submitted several weeks ago, contained a parcel of land that was not intended for annexation. Please file the amended decree and resolution to correct this error.

If you should have any questions, please feel free to contact me at the number listed above.

Sincerely,

A handwritten signature in black ink that reads "Tamitha Blocker".

Tamitha Blocker
Deputy County Clerk

Encl

FILED

IN THE COUNTY COURT OF MADISON COUNTY, ARKANSAS APR 1 2013

IN THE MATTER OF ANNEXING TO THE CITY OF HUNTSVILLE, ARKANSAS, CERTAIN TERRITORY CONTIGUOUS TO THE CITY OF HUNTSVILLE, ARKANSAS

FARON LEDBETTER
COUNTY AND PROBATE CLERK
MADISON COUNTY, ARKANSAS
BY [Signature] D.C.
Book 12 Pg 228-229
CC-2012-10

FILED

AMENDED DECREE OF ANNEXATION

APR 23 2013

On this 1st day of April, 2013, there is presented to the Court by the City of Arkansas
Huntsville, AR, a petition to amend the original Decree of Annexation entered by the Court
on February 8, 2013. The original petition and Decree of Annexation contained a parcel of
property that was not intended for annexation and it is the desire of the Mayor and City
Council of Huntsville, AR that the appropriate correction be made to the legal description
of the territory to be annexed and that an amended Decree of Annexation be issued by the
Court.

Therefore, the Court doth hereby order, judge, and decree that the Decree of
Annexation entered on February 8, 2013 is hereby amended and the following described
territory be and the same is hereby annexed to and made part of the City of
Huntsville, Arkansas, to-wit:

Beginning at a point on the Huntsville city limit line at the intersection of Town Branch Creek and the E/W center section line of S27, T17N, R26W; thence in a generally easterly direction along said city limit line to the east line of the NW ¼ NW ¼ of S25, T17N, R26W; thence north to the north line of said S25; thence west along the north lines of S25 and S26 of T17N, R26W to the SE corner of the SW ¼ SE ¼ of S23, T17N, R26W; thence north to the NE corner of said SW1/4 SE1/4; thence west to the NW corner of said SW ¼ SE¼; thence north to the E/W center section line of said S23; thence west along the E/W center section lines of S 23 and S22 of T17N, R26W to the NE corner of the NE ¼ SW ¼ of said S22; thence south along the east line of said NE ¼ SW ¼ to the R-O-W of U.S. 412; thence westerly along said R-O-W to the north line of the S ¼ of said S22; thence west along the north lines of the S ¼ of S22 and S21 of T17N, R26W to the NW corner of the SE ¼ SW ¼ of said S21; thence south along the west lines of said SE ¼ SW ¼ and the NE ¼ NW ¼ of S28, T17N, R26W to the SW corner of said NE ¼ NW ¼; thence east to the NW corner of the SW ¼ NE ¼ of said S28; thence south to the SW corner of said SW ¼ NE 1/4 ; thence east along the E/W center section line of S28 and S27 of T17N, R26W to the P.O.B.; less and except the following parcels: 001-11414-000; 001-11415-000; 001-11418-000; 001-11419-000; 001-11425-001; 001-11430-000; 001-11431-000; 001-

11431-002; 001-11433-000; 001-11433-002; 001-11470-002; 001-11492-000; 001-11494-000; 001-11494-001; 001-11527-000; 001-11531-000; 001-11532-000; 001-11532-001; 001-11534-000; 001-11539-000; 001-11540-000; 001-11541-000; 001-11559-000; 001-11559-002; 003-11559-000; 001-11562-000; 001-11562-001; 001-11562-002; 095-00001-000; 095-00002-000; 095-00007-000; 095-00010-000; and 095-00011-000.

The Court doth further order that the original papers in this cause be delivered to the Clerk of Madison County, Arkansas, same to be properly recorded upon the records of Madison County, Arkansas, and the Clerk, after properly recording and filing the original papers, prepare transcripts of same; that one of the certified transcripts be delivered to the City of Huntsville, Arkansas, one copy to the Secretary of State and one copy to the Director of the Tax Division of the Arkansas Public Service Commission.

Frank Weaver
Frank Weaver, County Judge

STATE OF ARKANSAS }
COUNTY OF MADISON } ss
I hereby certify that this instrument was filed
for record in my office the 1 day of April,
13, and duly recorded in 10 Record Book
12 at page 228 through 229.
Witness my hand and the Court Seal this 11
day of April, 13.
FARON LEDBETTER County and Probate Clerk
Janet Deaton Deputy Clerk





L201300969

MADISON CO, AR FEE \$0.00

PRESENTED: 04-11-2013 09:16:59 AM

RECORDED: 04-11-2013

PHYLLIS VILLINES
CIRCUIT CLERK AND RECORDER

BY: SHAILEE LEDBETTER
DEPUTY CIRCUIT CLERK

MISCELLANEOUS FEE

2 Pages

RESOLUTION NO. 12-13

A RESOLUTION AMENDING THE DESCRIPTION IN RESOLUTION #11-13

WHEREAS, Resolution #11-13, accepting the annexation of certain territory, contained a parcel of property that was not intended for annexation: and

WHEREAS, it is the desire of the Mayor and City Council that the appropriate correction be made in the description of the territory accepted for annexation.

NOW, THEREFORE, BE IT RESOLVED BY THE CITY COUNCIL OF THE CITY OF HUNTSVILLE, ARKANSAS:

That the following described land is hereby annexed into and accepted as part of the City of Huntsville, Arkansas, to-wit:

Beginning at a point on the Huntsville city limit line at the intersection of Town Branch Creek and the E/W center section line of S27, T17N, R26W; thence in a generally easterly direction along said city limit line to the east line of the NW ¼ NW ¼ of S25, T17N, R26W; thence north to the north line of said S25; thence west along the north lines of S25 and S26 of T17N, R26W to the SE corner of the SW ¼ SE ¼ of S23, T17N, R26W; thence north to the NE corner of said SW ¼ SE ¼; thence west to the NW corner of said SW ¼ SE ¼; thence north to the E/W center section line of said S23; thence west along the E/W center section lines of S23 and S22 of T17N, R26W to the NE corner of the NE ¼ SW ¼ of said S22; thence south along the east line of said NE ¼ SW ¼ to the R-O-W of U.S. 412; thence westerly along said R-O-W to the north line of the S ¼ of said S22; thence west along the north lines of the S ¼ of S22 and S21 of T17N, R26W to the NW corner of the SE ¼ SW ¼ of said S21; thence south along the west lines of said SE ¼ SW ¼ and the NE ¼ NW ¼ of S28, T17N, R26W to the SW corner of said NE ¼ NW ¼; thence east to the NW corner of the SW ¼ NE ¼ of said S28; thence south to the SW corner of said SW ¼ NE ¼; thence east along the E/W center section lines of S28 and S27 of T17N, R26W to the P. O. B.; less and except the following parcels: 001-11414-000; 001-11415-000; 001-11418-000; 001-11419-000; 001-11425-001; 001-11430-000; 001-11431-000; 001-11431-002; 001-11433-000; 001-11433-002; 001-11470-002; 001-11492-000; 001-11494-000; 001-11494-001; 001-11527-000; 001-11531-000; 001-11532-000; 001-11532-001; 001-11534-000; 001-11539-000; 001-540-000; 001-11541-000; 001-11559-000; 001-11559-002; 003-11559-000; 001-11562-000;

Arkansas
Secretary of State

APR 23 2013

F I L E D

001-11562-001; 001-11562-002; 095-00001-000; 095-00002-000; 095-00007-000; 095-00010-000; and 095-00011-000.

PASSED AND APPROVED THIS 8 DAY OF April, 2013.



Mayor

Attest:

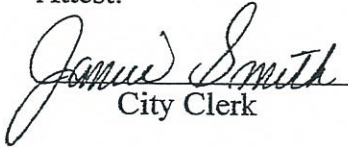

City Clerk