

**Proposed Annex: City of Harrison 2014 Historic Annexation
October 2017**

City: Harrison
Mayor: Dan Sherrell

Arkansas Code 14-40-101.

Before an entity undertakes an annexation, consolidation, or detachment proceeding under this chapter, the entity shall coordinate with the Arkansas Geographic Information Systems Office for preparation of legal descriptions and digital mapping for the relevant annexation, consolidation, and detachment areas.

The map contained herein, is evidence, the entity has met requirements of Act 914 of 2015

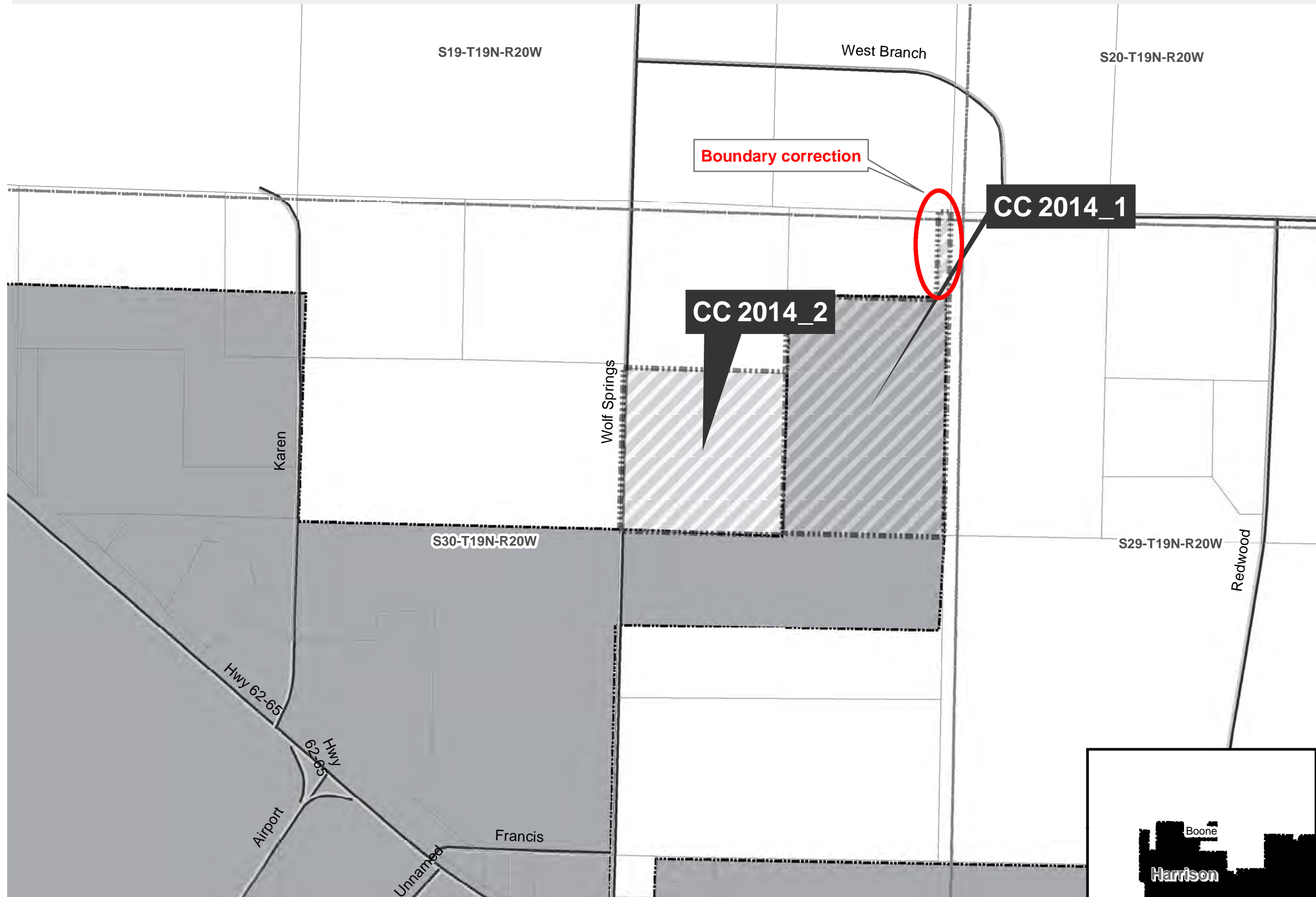

- Annexations
- Sections
- Parcels
- Minor Road
- Existing City
- County Boundary

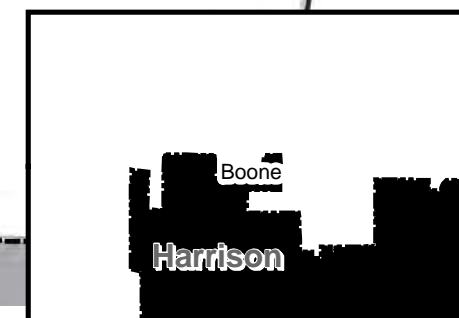
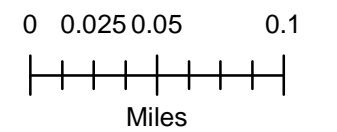

F I L E D

DEC 29 2014

Arkansas
Secretary of State

need updating
FILED
TIME 4:00 AM/PM

OCT - 7 2014

CRYSTAL GRADY
BOONE COUNTY CLERK

IN THE COUNTY COURT OF BOONE COUNTY, ARKANSAS D.C.

IN THE MATTER OF THE ANNEXATION
OF CERTAIN LANDS INTO THE CITY
OF HARRISON, ARKANSAS.

NO. 05CC 2014- 2

ORDER OF ANNEXATION

FILED

On this day comes for hearing the Petition of Jerry Jackson and Peggy Jackson, Husband and Wife, (Tract 1) and Kenneth E. Jones and Marilyn M. Jones, as Trustees of the Jones Family Living Trust, dated March 1, 2010, (Tract 2), being the owners of the following described tract of real estate in Harrison, Boone County, Arkansas, pursuant to Arkansas Code Section 14-40-601, to grant an Order allowing the annexation into the City of Harrison, Arkansas, to-wit:

10/09/2014 10:10 AM
Book 2014 Page 18
Crystal Grady
Boone County Clerk
500

Tract 1:

A PART OF THE NORTHEAST QUARTER OF THE NORTHEAST QUARTER OF SECTION THIRTY (30), TOWNSHIP NINETEEN (19) NORTH, RANGE TWENTY (20) WEST, BOONE COUNTY, ARKANSAS, MORE PARTICULARLY DESCRIBED AS FOLLOWS: BEGINNING AT A 5/8" IRON PIN FOR THE NORTHEAST CORNER OF SAID FORTY THENCE SOUTH 01°18'15" WEST 1322.22 FEET TO A NAIL IN A FENCE POST; THENCE NORTH 88°36'14" WEST 658.35 FEET TO A 3/8" IRON PIN; THENCE NORTH 01°18'17" EAST 967.06 FEET TO A SET 3/8" IRON PIN WITH CAP #1389; THENCE SOUTH 88°21'17" EAST 608.35 FEET TO A SET 3/8" IRON PIN WITH CAP #1389; THENCE NORTH 01°18'15" EAST 358.02 FEET TO A SET 3/8" IRON PIN WITH CAP #1389; THENCE SOUTH 88°21'17" EAST 50.00 FEET TO THE POINT OF REAL BEGINNING. CONTAINING 15.01 ACRES\128, MORE OR LESS.

Tract 2:

A PART OF THE NORTHEAST QUARTER OF THE NORTHEAST QUARTER OF SECTION THIRTY (30), TOWNSHIP NINETEEN (19) NORTH, RANGE TWENTY (20) WEST, BOONE COUNTY, ARKANSAS, MORE PARTICULARLY DESCRIBED AS FOLLOWS: BEGINNING AT A COTTON PICKER SPINDLE FOR THE SOUTHWEST CORNER OF SAID FORTY THENCE NORTH 01°20'56" EAST 663.99 FEET TO A SET COTTON PICKER SPINDLE; THENCE SOUTH 88°22'09" EAST 661.46 FEET TO A SET 3/8" IRON PIN WITH CAP #1389; THENCE SOUTH 01°22'39" WEST 662.68 FEET TO A 3/8" IRON PIN; THENCE NORTH 88°28'57" WEST 661.12 FEET TO THE POINT OF BEGINNING. CONTAINING 10.07 ACRES\128, MORE OR LESS.

That this being the day and hour set by this Court for hearing on said Petition with notice having been published in the manner and time prescribed by law; that no objections have been filed to the granting of said petition and no one has appeared in opposition thereto. The Court further finds that at the time of filing the Petitioner is the owner of the lands being annexed; that said lands are contiguous to and join existing City limits of the City of Harrison; that a plat of said lands is filed in the official file and that the annexation of said lands is in the best interest of the City of Harrison and Boone County and said Petition should be granted.

Now, therefore, it is the Order of the Court that said Petition be, and it hereby is, granted, and the described lands may be annexed when approved by the passing of a City ordinance to become a part of the City of Harrison, Arkansas.

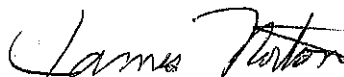

James Norton, County Judge

Date: 10-7-14

Book 2014 Page 19

RECORDED IN
BOOK 2014 PAGE 21

FILED

2014 NOV 12 PM 2:34

IN THE COUNTY COURT OF BOONE COUNTY, ARKANSAS, L. GRADY
BOONE COUNTY CLERK

BY [Signature] D.C.

IN THE MATTER OF THE ANNEXATION OF
CERTAIN LANDS INTO THE INCORPORATED
CITY OF HARRISON, ARKANSAS

NO. 05CC-2014-2

FILED

DEC 29 2014

Arkansas
Secretary of State

**ORDER CONFIRMING
ORDER OF ANNEXATION**

On this 7th day of November, 2014, this Court finds that no objections have been filed in this Annexation proceeding; that the lands described below were annexed by this Court on October 7, 2014, and that no objections thereto have been filed since such Order; that 30 days have elapsed since such Annexation Order was made and that the Court's Order of Annexation should be confirmed in all respects. Said lands more particularly described as follows, to-wit:

Tract 1:

A PART OF THE NORTHEAST QUARTER OF THE NORTHEAST QUARTER OF SECTION THIRTY (30), TOWNSHIP NINETEEN (19) NORTH, RANGE TWENTY (20) WEST, BOONE COUNTY, ARKANSAS, MORE PARTICULARLY DESCRIBED AS FOLLOWS: BEGINNING AT A 5/8" IRON PIN FOR THE NORTHEAST CORNER OF SAID FORTY THENCE SOUTH 01°18'15" WEST 1322.22 FEET TO A NAIL IN A FENCE POST; THENCE NORTH 88°36'14" WEST 658.35 FEET TO A 3/8" IRON PIN; THENCE NORTH 01°18'17" EAST 967.06 FEET TO A SET 3/8" IRON PIN WITH CAP #1389; THENCE SOUTH 88°21'17" EAST 608.35 FEET TO A SET 3/8" IRON PIN WITH CAP #1389; THENCE NORTH 01°18'15" EAST 358.02 FEET TO A SET 3/8" IRON PIN WITH CAP #1389; THENCE SOUTH 88°21'17" EAST 50.00 FEET TO THE POINT OF REAL BEGINNING. CONTAINING 15.01 ACRES\128, MORE OR LESS.

Tract 2:

A PART OF THE NORTHEAST QUARTER OF THE NORTHEAST QUARTER OF SECTION THIRTY (30), TOWNSHIP NINETEEN (19) NORTH, RANGE TWENTY (20) WEST, BOONE COUNTY, ARKANSAS, MORE PARTICULARLY DESCRIBED AS FOLLOWS: BEGINNING AT A COTTON PICKER SPINDLE FOR THE SOUTHWEST CORNER OF SAID FORTY THENCE NORTH 01°20'56" EAST 663.99 FEET TO A SET COTTON PICKER SPINDLE; THENCE SOUTH 88°22'09" EAST 661.46 FEET TO A SET 3/8" IRON PIN WITH CAP #1389; THENCE SOUTH 01°22'39" WEST 662.68 FEET TO A 3/8" IRON PIN; THENCE NORTH 88°28'57" WEST 661.12 FEET TO THE POINT OF BEGINNING. CONTAINING 10.07 ACRES\128, MORE OR LESS.

IT IS NOW THEREFORE THE ORDER OF THIS COURT that its Annexation Order, dated the 7th day of **October, 2014**, in this case be and hereby is in all respects confirmed.

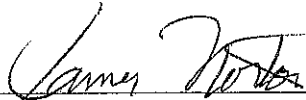

JAMES NORTON
COUNTY JUDGE

RECORDED IN
BOOK 2014 PAGE 22

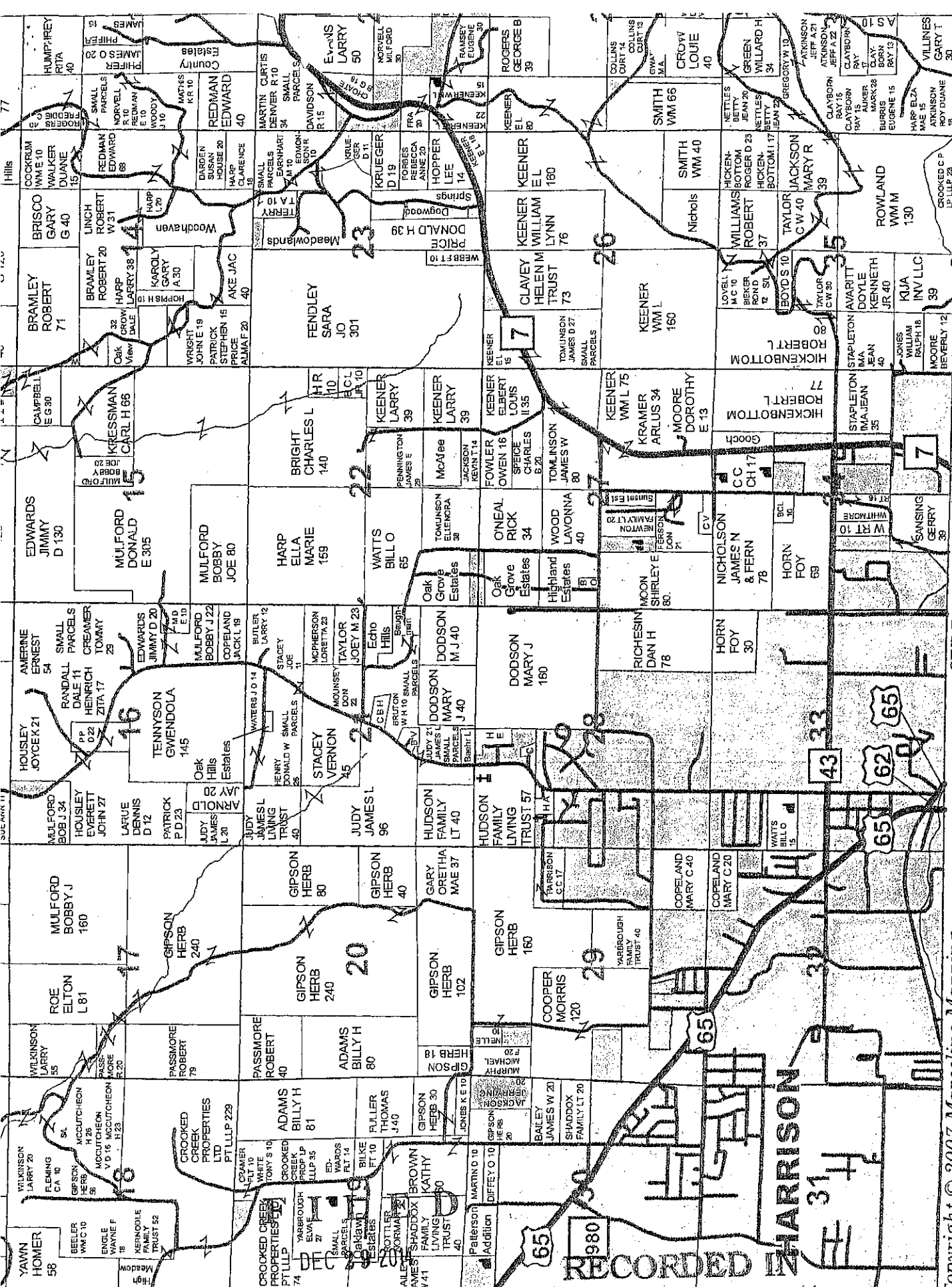

SEE PAGE 43

Copyright © 2007 Marceline Mapping

Arkansas Secretary of State

RECORDED IN Harrison, ARK. BOOK 2017 PAGE 24

SEE PAGE 33