

Hector

2-25-80

B.J. Bryce  
V.L. Bryce  
PROP.

ORDINANCE NO. \_\_\_\_\_

AN ORDINANCE ACCEPTING AND APPROVING THE ANNEXATION OF A TRACT OF LAND LYING IN SECTION 11, TOWNSHIP 9 NORTH, RANGE 19 WEST.

WHEREAS, there has been presented to the City Council, City of Hector, Arkansas, an Order of the Circuit Court of Pope County, Arkansas, dated the 30th day of October, 1979, to annex to the City of Hector, Arkansas the following described tract of land:

SURFACE ONLY:

The West 1/2 of the Northwest Quarter (NW1/4) of the Northeast Quarter (NE1/4) of Section 11, Township 9 North, Range 19 West less and except the following described tracts:

TRACT #1: Part of the West 1/2 of the Northwest Quarter NW1/4, of the Northeast Quarter (NE1/4) of section 11, Township 9 North, Range 19 West described as beginning 200' South of the Northeast corner of the West 1/2 of the Northwest Quarter (NW1/4) of the Northeast Quarter (NE1/4) thence West 210', thence South 105', thence East 210', thence North 105' to the point of beginning, containing .50 acres.

TRACT #2: Part of the West 1/2 of the Northwest Quarter (NW1/4) of the Northeast Quarter (NE1/4) of Section 11, Township 9 North, Range 19 West described as beginning at the Northwest corner of the West 1/2 of the Northwest Quarter (NW1/4) of the Northeast Quarter (NE1/4), thence South 210', thence East 210' to the point of beginning, thence North 210', thence East 105', thence South 210', thence West 105' to the point of beginning, containing .50 acres.

TRACT #3: Part of the West 1/2 of the Northwest Quarter (NW1/4) of the Northeast Quarter (NE1/4) of Section 11, Township 9 North, Range 19 West described as beginning at the Northeast corner of the West 1/2 of the NW1/4 of the NE1/4 thence South 525' to the Point of beginning, thence West 210', thence South 105', thence East 210', thence North 105' containing .50 acres.

TRACT #4: Part of the West 1/2 of the Northwest Quarter (NW1/4) of the Northeast Quarter (NE1/4) of Section 11, Township 9 North, Range 19 West, described as beginning at the Northwest corner of the West 1/2 of the NW1/4 NE1/4 thence South 210', thence East 210' to the point of beginning, thence East 210', thence South 105', thence West 210', thence North 105', containing .50 acres.

TRACT containing eighteen acres (18) after said exceptions.

The above and foregoing enacted by the City Council of Hector, Arkansas, in regular session assembled at the City Hall in said City this 25 day of February, 1980.

*David Riey*  
MAYOR

Recorder: *Jimmy Stroud*

Filed this 27 day of Feb. 1980  
Ernest R. Owens COUNTY CLERK  
Pope County Arkansas

NW CORNER  
W 1/4 NW 1/4 NE 1/4  
11-9-19

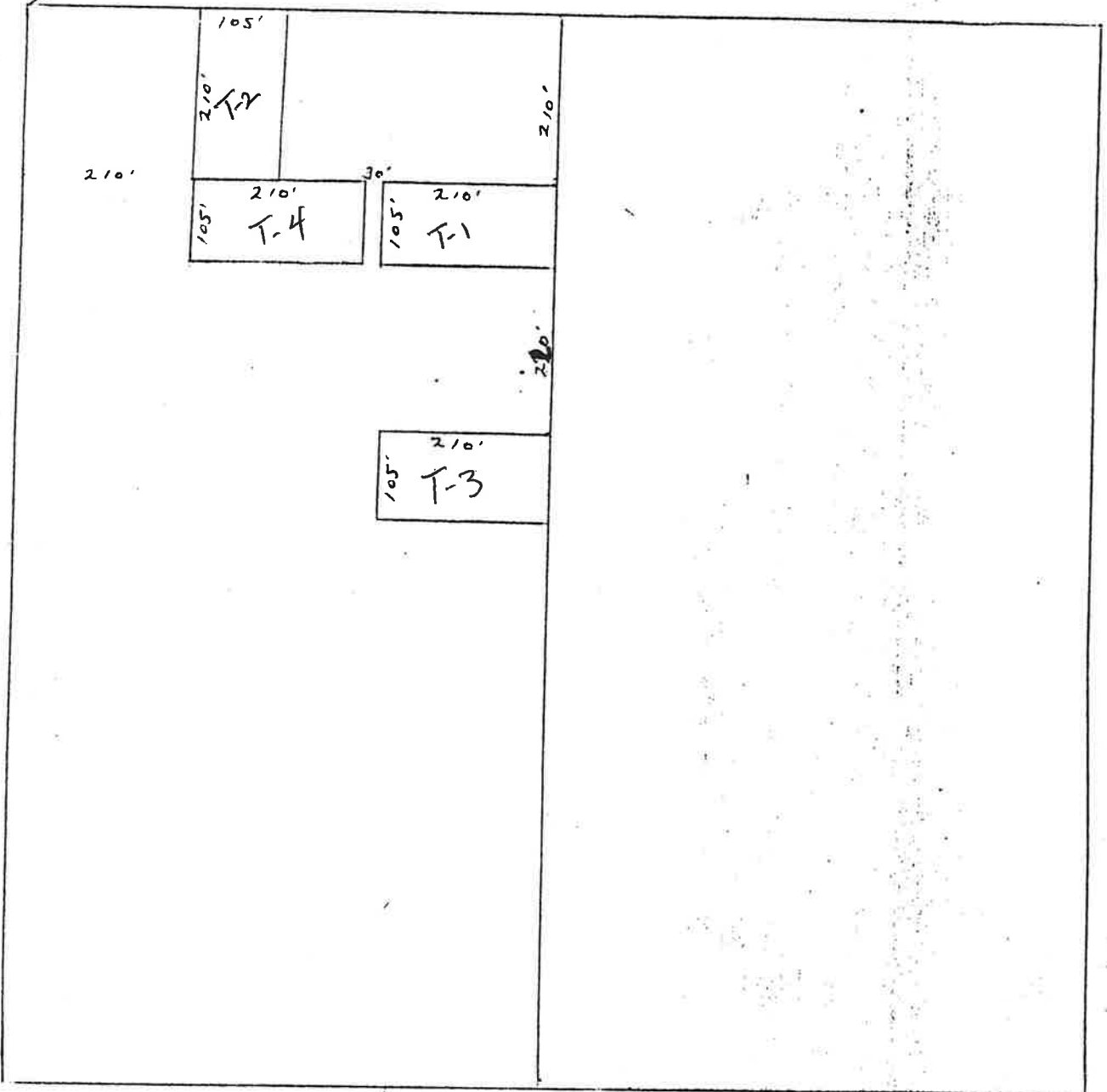

Filed this 13 day of Dec 1974  
Ernest R. Powers COUNTY CLERK  
POPE COUNTY, ARKANSAS

2-309