



ARKANSAS SECRETARY OF STATE

MARK MARTIN

August 16, 2018

The Honorable Donnie Davis
Newton County Clerk
100 East Court St
Jasper, AR 72614

Re: City of Jasper Annexation Ordinance 2018-3

Dear Mr. Davis,

This letter acknowledges receipt and filing of the following notice of municipal boundary change by the Office of the Secretary of State:

Filing Type: Annexation pursuant to A.C.A § 14-40-609 (annexation by 100% of the landowners)

Effective Date: 08/07/2018 (emergency clause)

County: Newton

City: Jasper

City Ordinance: 2018-3

Dated: 08/07/2018

County Court Order: CC-2018-01

Date Filed: 07/30/2018

A file marked copy of the ordinance, court order and exhibits submitted to our Office are enclosed. By copy of this letter (and its enclosures), the Secretary of State hereby notifies the appropriate mapping authorities for Arkansas. Please retain these copies as official record of the filing of the municipal boundary change by the Arkansas Secretary of State.

If you have any questions or concerns regarding this pending filing, please contact our office at 501-682-3401.

Sincerely,

A handwritten signature in cursive script that reads "Cynthia Fisher".

Cynthia Fisher
Arkansas Secretary of State Legal Division
500 Woodlane St, Room 256
Little Rock, AR 72201
501-682-3401

cc: Arkansas Geographic Information Systems Office (w/ encl)
Arkansas Highway and Transportation Department Mapping Department (w/ encl)
Department of Finance and Administration (w/encl)
Arkansas Public Service Commission (w.encl)
UALR Institution for Economic Advancement (w/encl)
Tom-Tom (w/encl)
Honorable Jan Larson, Mayor of Jasper (w/encl)



Arkansas Secretary of State

Mark Martin Arkansas Secretary of State, 500 Woodlane Ave, Little Rock, AR 72201-1094

Municipal Boundary Change Checklist

County: Newton City/Town: Jasper

City Ordinance/Resolution No: 2018-3 Date approved: 8-7-18

County Court Case No: 2018-01 Date Order Filed: 07-30-2018

Type: Annexation by Petition of all landowners A.C.S. 14-40-609
(Choose from the list of Arkansas Code Sections located on the back)

Date Change Effective: August 7, 2018 Set by: Municipal Ordinance Emergency Clause Court Default
(Required by Act 655 of 2017)

For Circuit Court Challenge: Date Order Filed: _____ Upheld Overturned Other (attach explanation)

Initiating party:

All Landowners Majority Landowners Municipal Governing Body State Other _____

Supporting Documentation attached (check all that apply):

- File marked copy of City Ordinance/Resolution (required)
- File marked copy of County Court Order (required except for island annexation and annexation approved by election)
- Copy of Arkansas GIS approved printed map and certification letter (required)
- Proof of Publication for all Legal Notices (include Hearing, Election, and City Ordinance/Resolution notices)
- File marked copy of Petition Part or File marked copy of the certified special election results (if applicable)
- File marked copy of Complaint and final Circuit Court Order (Court Challenge only)

Municipal Contact:

Name: Jan Larsen Title: Mayor

Street Address: 101 East Elm Street

City: Jasper St: Ar Zip code: 72104

Complete one form per ordinance/resolution, attach it as a cover page to the supporting document set and submit to the County Clerk's Office within 45 days of the Effective Date as required by Act 655 of 2017

County Official:

Signature: [Signature] Title: County Clerk

Date: 8-8-2018

Pursuant to Act 655 of 2017, County Officials must submit a file-marked copy of municipal boundary change documents within 30 days of receipt to: Arkansas Secretary of State, Attn: Municipal Boundary Filing, 500 Woodlane Ave Suite 256, Little Rock, AR 72201-1094

Office of the Arkansas Secretary of State use only

Received by: Cynthia Fisher

FILED

AUG 16 2018

**Arkansas
Secretary of State**

ORDINANCE NO. 2018-3

AN ORDINANCE ACCEPTING THE ANNEXATION OF CERTAIN
TERRITORY TO THE CITY OF JASPER, ARKANSAS, AND MAKING
SAME A PART OF THE CITY OF JASPER, ARKANSAS
AND ASSIGNING SAME TO WARDS.

WHEREAS, a petition was filed with the County Clerk of Newton County, Arkansas, by the majority of the real estate owners of the hereinafter described territory praying that said territory be annexed to, and made a part of the City of Jasper, Arkansas; and,

WHEREAS, on July 27, 2018, the County Court of Newton County, Arkansas, found that the petition was signed by a majority of the real estate owners in said territory; that said territory was contiguous and adjoining the present corporate limits of the City of Jasper, Arkansas; that an accurate plat or map of said territory had been filed with and made a part of said petition; that proper notice had been given for the time and in the manner prescribed by law, and that all things pertaining thereto had been done in the manner prescribed by law, and that said lands and territory should be annexed to and made a part of the City of Jasper, Arkansas, subject to the acceptance of same by the City Council of said City at the proper time, as provided by law; and

WHEREAS, the time fixed by law for appealing from said order of annexation made by the County Court has expired and no appeal has been taken from said order.

Now, therefore, be it ordained by the city council of the City of Jasper, Arkansas:

SECTION 1. That the following described lands and territory contiguous and adjoining the City of Jasper, Arkansas, be and the same is hereby accepted as part of and annexed to and made a part of the City of Jasper effective July 27, 2018.

THE EAST HALF OF THE NORTHWEST QUARTER OF THE NORTHEAST QUARTER, A PART OF THE SOUTHWEST QUARTER OF THE NORTHEAST QUARTER, THE NORTHEAST QUARTER OF THE NORTHEAST QUARTER OF THE SOUTHWEST QUARTER, A PART OF THE NORTHWEST QUARTER OF THE SOUTHWEST QUARTER, A PART OF THE SOUTHWEST QUARTER OF THE SOUTHWEST QUARTER AND A PART OF THE SOUTHWEST QUARTER OF THE SOUTHWEST QUARTER ALL IN SECTION TWENTY SEVEN (27), TOWNSHIP SIXTEEN (16) NORTH, RANGE TWENTY ONE (21) WEST, NEWTON COUNTY ARKANSAS, DESCRIBED AS FOLLOWS;

FROM THE NORTHWEST CORNER OF THE SAID EAST HALF OF THE NORTHWEST OF THE NORTHEAST, POINT OF BEGINNING OF TRACT BEING DESCRIBED, GO ALONG THE WEST LINE SOUTH 1320 FEET TO THE SOUTHWEST CORNER THEN GO WEST 150 FEET, SOUTH 660 FEET, SOUTH 39° WEST 707 FEET TO THE SOUTH LINE SOUTHWEST QUARTER OF THE NORTHEAST QUARTER, THEN GO WEST ALONG THE SOUTH LINE OF THE SOUTHWEST OF THE NORTHEAST AND THE NORTH LINE OF THE NORTHEAST QUARTER OF THE SOUTHWEST QUARTER TO THE NORTHWEST CORNER OF THE NORTHEAST QUARTER OF THE NORTHEAST QUARTER OF THE SOUTHWEST QUARTER, THEN GO ALONG THE WEST

FILED

AUG 16 2018

Arkansas
Secretary of Stat

LINE SOUTH 660 FEET TO THE SOUTHWEST CORNER, THEN GO EAST 660' FEET TO THE SOUTHEAST CORNER, THEN GO SOUTH ALONG THE WEST LINE OF THE NORTHWEST QUARTER OF THE SOUTHEAST QUARTER AND THE SOUTHWEST QUARTER OF THE SOUTHEAST QUARTER TO THE CENTER OF LITTLE BUFFALO RIVER, THEN GO NORTHEASTERLY WITH THE CENTERLINE OF THE RIVER TO A POINT 250 FEET WEST OF THE WESTERN BOUNDARY OF HIGHWAY 7 AND 100 FEET SOUTH OF THE SOUTH BOUNDARY OF HIGHWAY 74, THEN GO NORTHWESTERLY PARALLEL AND 100 FEET SOUTH AND WEST OF THE SOUTH BOUNDARY OF HIGHWAY 74 TO THE END OF FIRST HAIRPIN CURVE, THEN GO NORTH 500 FOOT TO THE NORTH LINE OF THE NORTHWEST QUARTER OF THE SOUTHEAST QUARTER, THEN CONTINUE NORTH 250 FEET, THEN GO EAST TO THE EAST LINE OF THE SOUTHWEST OF THE NORTHEAST, THEN GO NORTH ALONG THE EAST LINE TO THE NORTHEAST CORNER, THEN CONTINUE NORTH ALONG THE EAST LINE OF THE EAST HALF OF THE NORTHWEST OF THE NORTHEAST 1320 FEET TO THE NORTHEAST CORNER, THEN GO ALONG THE NORTH LINE WEST 660 FEET TO THE POINT OF BEGINNING.

SECTION 2. That the above described territory shall be annexed to and made a part of Ward **ONE** of the City of Jasper, and the same shall henceforth be a part of said ward as fully as existing parts of said ward.

SECTION 3. Notice. Within forty-five (45) days of the effective date of this ordinance the city clerk shall provide written notice, along with complete documentation, to the county clerk of each county in which the territory is affected.

SECTION 4: Because of the short period of time available for action and the need to keep services, uniform and available in the annexed area, the adoption of this ordinance is necessary for the public peace, health, safety and welfare, AN EMERGENCY is declared to exist. Therefore, this ordinance shall be in full force and effect from and after the date of its passage.

PASSED AND APPROVED THIS 7th DAY OF AUGUST 2018.

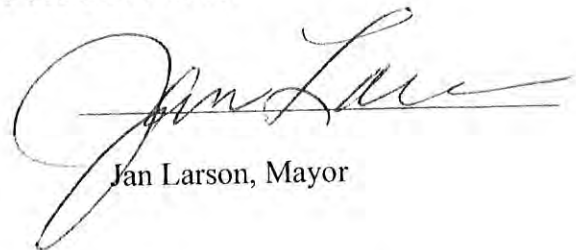
Jan Larson, Mayor

ATTEST:

Tiffany Davis, Recorder

FILED
OFFICE OF THE CIRCUIT CLERK
NEWTON COUNTY ARKANSAS



AUG 08 2018
A.M. 3:15 P.M.
BOOK 6 PAGE 548
DONNIE DAVIS

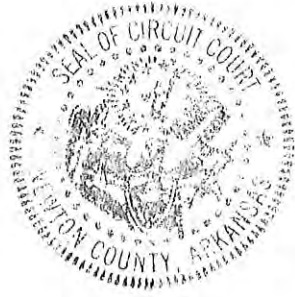

FILED
OFFICE OF THE CIRCUIT CLERK
NEWTON COUNTY ARKANSAS

JUL 30 2018

11:05 A.M. _____ P.M.
BOOK X PAGE 611
DONNIE DAVIS

IN THE COUNTY COURT OF NEWTON COUNTY, ARKANSAS

**IN THE MATTER OF: ANNEXING TO THE
CITY OF JASPER, ARKANSAS CERTAIN
TERRITORY CONTIGUOUS TO SAID CITY
OF JASPER, ARKANSAS**

NO. CC-2018-01

DECREE OF ANNEXATION

On this regular day of a regular term of the County Court of Newton County, Arkansas, there is presented to the Court by, TIFFANY DAVIS, agent of the petitioners, a petition for annexation of certain territory, hereinafter more particularly described, to the City of Jasper, Arkansas, and the Court being fully advised of the facts and the law, does hereby find, judge and decree as follows:

The Court finds that the petition was filed more than thirty [30] days prior to this date and that in said petition the said was selected by the petitioners to act on their behalf in filing and presenting the petition.

The court further finds that notice of the hearing on this matter was published one [1] time a week for three [3] consecutive weeks as required by A.C.A. § 14-40-602.

The Court finds that a majority of the total number of real estate owners in the area affected by this petition have signed said petition and that such majority owns more than one-half of the acreage affected.

The Court further finds that the territory consists of lands that:

- (1) Whether platted or not, are held to be sold as suburban property;
- (2) Furnish the abode for a densely settled community or represent the actual growth of the municipality beyond its legal boundary;
- (3) Are needed for any proper municipal purposes; or
- (4) Are valuable by reason of their adaptability for prospective municipal uses.

F I L E D

AUG 16 2018

Arkansas
Secretary of State

The Court further finds that the territory sought to be annexed was accurately described in said petition and that said territory is contiguous to the boundaries of the City of Jasper, Arkansas. The Court further finds that attached to and made a part of said petition is an accurate map of the territory sought to be annexed to the City of Jasper.

The Court further finds that the prayer of the petition is right and proper.

Therefore, the Court hereby ORDERS, JUDGES and DECREES that the following described territory be and the same is hereby annexed to and made a part of the City of Jasper, Arkansas, to-wit:

THE EAST HALF OF THE NORTHWEST QUARTER OF THE NORTHEAST QUARTER, A PART OF THE SOUTHWEST QUARTER OF THE NORTHEAST QUARTER, THE NORTHEAST QUARTER OF THE NORTHEAST QUARTER OF THE SOUTHWEST QUARTER, A PART OF THE NORTHWEST QUARTER OF THE SOUTHEAST QUARTER, A PART OF THE SOUTHWEST QUARTER OF THE SOUTHEAST QUARTER AND A PART OF THE SOUTHEAST QUARTER OF THE SOUTHEAST QUARTER ALL IN SECTION TWENTY SEVEN (27), TOWNSHIP SIXTEEN (16) NORTH, RANGE TWENTY ONE (21) WEST, NEWTON COUNTY ARKANSAS, DESCRIBED AS FOLLOWS:

FROM THE NORTHWEST CORNER OF THE SAID EAST HALF OF THE NORTHWEST OF THE NORTHEAST, POINT OF BEGINNING OF TRACT BEING DESCRIBED, GO ALONG THE WEST LINE SOUTH 1320 FEET TO THE SOUTHWEST CORNER THEN GO WEST 150 FEET, SOUTH 660 FEET, SOUTH 39° WEST 707 FEET TO THE SOUTH LINE SOUTHWEST QUARTER OF THE NORTHEAST QUARTER, THEN GO WEST ALONG THE SOUTH LINE OF THE SOUTHWEST OF THE NORTHEAST AND THE NORTH LINE OF THE NORTHEAST QUARTER OF THE SOUTHWEST QUARTER TO THE NORTHWEST CORNER OF THE NORTHEAST QUARTER OF THE NORTHEAST QUARTER OF THE SOUTHWEST QUARTER, THEN GO ALONG THE WEST LINE SOUTH 660 FEET TO THE SOUTHWEST CORNER, THEN GO EAST 660' FEET TO THE SOUTHEAST CORNER, THEN GO SOUTH ALONG THE WEST LINE OF THE NORTHWEST QUARTER OF THE SOUTHEAST QUARTER AND THE SOUTHWEST QUARTER OF THE SOUTHEAST QUARTER TO THE CENTER OF LITTLE BUFFALO RIVER, THEN GO NORTHEASTERLY WITH THE CENTERLINE OF THE RIVER TO A POINT 250 FEET WEST OF THE WESTERN BOUNDARY OF HIGHWAY 7 AND 100 FEET SOUTH OF THE SOUTH BOUNDARY OF HIGHWAY 74, THEN GO

NORTHWESTERLY PARALLEL AND 100 FEET SOUTH AND WEST OF THE SOUTH BOUNDARY OF HIGHWAY 74 TO THE END OF FIRST HAIRPIN CURVE, THEN GO NORTH 500 FOOT TO THE NORTH LINE OF THE NORTHWEST QUARTER OF THE SOUTHEAST QUARTER, THEN CONTINUE NORTH 250 FEET, THEN GO EAST TO THE EAST LINE OF THE SOUTHWEST OF THE NORTHEAST, THEN GO NORTH ALONG THE EAST LINE TO THE NORTHEAST CORNER, THEN CONTINUE NORTH ALONG THE EAST LINE OF THE EAST HALF OF THE NORTHWEST OF THE NORTHEAST 1320 FEET TO THE NORTHEAST CORNER, THEN GO ALONG THE NORTH LINE WEST 660 FEET TO THE POINT OF BEGINNING.

The Court further orders that the original papers in this cause be delivered to the Clerk of County, Arkansas, same to be properly recorded upon the records of County, Arkansas, and the Clerk, after properly recording and filing the original papers, prepare transcripts of same; that one of the certified transcripts be delivered to the City of Jasper, Arkansas, one copy to the Secretary of State and one copy to the Director of the Tax Division of the Arkansas Public Service Commission.

County Judge





ARKANSAS
GIS OFFICE

July 20, 2018

Mayor Jan Larson
101 East Elm St
Jasper AR 72641

RE: City of Jasper Annexation Coordination Requirement

Honorable Mayor Larson,

Thank you for coordinating with our office as you seek to amend and correct the legal description adopted by the City of Jasper Ordinance 2009-2. The map is shown to amend the area of legal description you provided.

This letter represents confirmation that you have properly coordinated with our office (Arkansas GIS Office) as specified in § 14-40-101 (Act 914 of 2015) of the 90th General Assembly.

Our office will wait completion of any additional steps necessary for the proposed boundary change, which normally comes from the Arkansas Secretary of State Elections Division after any appropriate filing by your County Clerk.

Thank you,

Shelby D Johnson, State Geographic Information Officer
/sdj

F I L E D

AUG 16 2018

**Arkansas
Secretary of State**

Attachments:
GIS Office Map of Proposed Annexation
Legal Description
Secretary of State Municipal Change Checklist

H:\City_Annexations\Templates\Folder Structure\Doc\20180720_Jasper_Annexation_Amendment-2009-2_Letter.docx

Annexation Map Correction Amending Ordinance 2009-2: City of Jasper July, 2018

City: Jasper
Mayor: Jan Larson

Arkansas Code 14-40-101

Before an entity undertakes an annexation, consolidation, or detachment proceeding under this chapter, the entity shall coordinate with the Arkansas Geographic Information Systems Office for preparation of legal descriptions and digital mapping for the relevant annexation, consolidation, and detachment areas.

The map contained herein, is evidence, the entity has met requirements of Act 914 of 2015

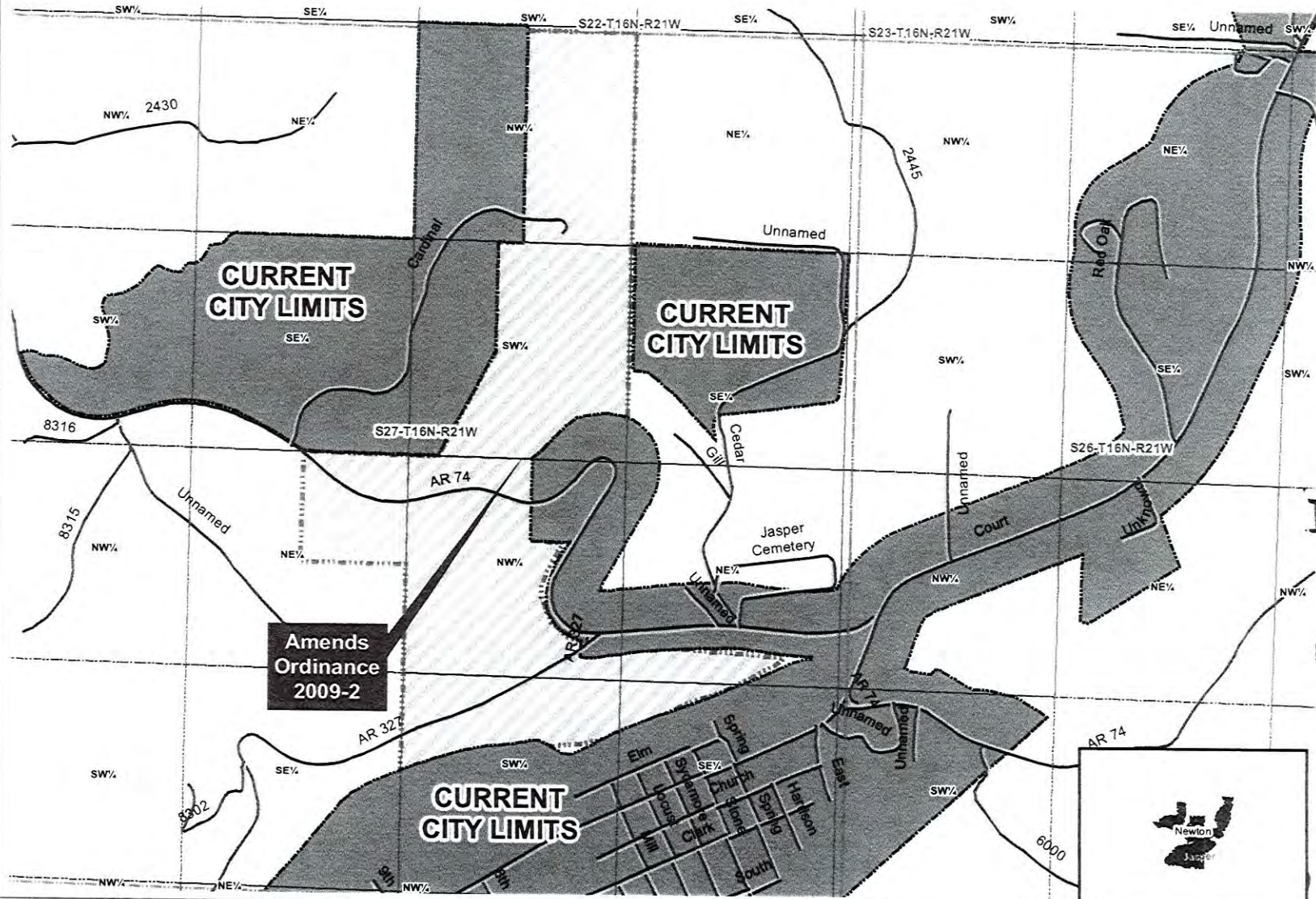

- Sections
- Minor Road
- Existing City
- Amended Legal Description

FILED
AUG 16 2018
Arkansas Secretary of State
0.14 Miles

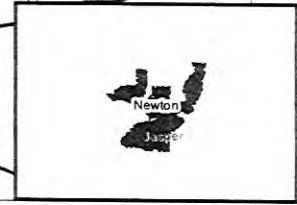

Tract 1

Annexation 1

FILED
OFFICE OF THE CIRCUIT CLERK
NEWTON COUNTY ARKANSAS

JUN 26 2018

____ A.M. 3.00 P.M.

IN THE COUNTY COURT OF NEWTON COUNTY, ARKANSAS

**IN THE MATTER OF: ANNEXING TO THE
CITY OF JASPER, ARKANSAS CERTAIN
TERRITORY CONTIGUOUS TO SAID CITY
OF JASPER, ARKANSAS**

NO. CC-2018-01

PETITION

WE, as the majority of property owners of the following described area do hereby petition the County Court of Newton County, Arkansas to annex the following lands to the City of Jasper, Arkansas. We further state that the petition is signed by the majority of real estate owners owning the majority of the acreage in said area and do further by our signatures on this petition appoint TIFFANY DAVIS to act on behalf of the petitioners in presenting this matter to the court.

Description of the areas to be annexed to the City of Jasper, Arkansas:

THE EAST HALF OF THE NORTHWEST QUARTER OF THE NORTHEAST QUARTER, A PART OF THE SOUTHWEST QUARTER OF THE NORTHEAST QUARTER, THE NORTHEAST QUARTER OF THE NORTHEAST QUARTER OF THE SOUTHWEST QUARTER, A PART OF THE NORTHWEST QUARTER OF THE SOUTHWEST QUARTER, A PART OF THE SOUTHWEST QUARTER OF THE

F I L E D

AUG 16 2018

**Arkansas
Secretary of State**

SOUTHEAST QUARTER AND A PART OF THE SOUTHEAST QUARTER OF THE SOUTHEAST QUARTER ALL IN SECTION TWENTY SEVEN (27), TOWNSHIP SIXTEEN (16) NORTH, RANGE TWENTY ONE (21) WEST, NEWTON COUNTY ARKANSAS, DESCRIBED AS FOLLOWS:

FROM THE NORTHWEST CORNER OF THE SAID EAST HALF OF THE NORTHWEST OF THE NORTHEAST, POINT OF BEGINNING OF TRACT BEING DESCRIBED, GO ALONG THE WEST LINE SOUTH 1320 FEET TO THE SOUTHWEST CORNER THEN GO WEST 150 FEET, SOUTH 660 FEET, SOUTH 39° WEST 707 FEET TO THE SOUTH LINE SOUTHWEST QUARTER OF THE NORTHEAST QUARTER, THEN GO WEST ALONG THE SOUTH LINE OF THE SOUTHWEST OF THE NORTHEAST AND THE NORTH LINE OF THE NORTHEAST QUARTER OF THE SOUTHWEST QUARTER TO THE NORTHWEST CORNER OF THE NORTHEAST QUARTER OF THE NORTHEAST QUARTER OF THE SOUTHWEST QUARTER, THEN GO ALONG THE WEST LINE SOUTH 660 FEET TO THE SOUTHWEST CORNER, THEN GO EAST 660' FEET TO THE SOUTHEAST CORNER, THEN GO SOUTH ALONG THE WEST LINE OF THE NORTHWEST QUARTER OF THE SOUTHEAST QUARTER AND THE SOUTHWEST QUARTER OF THE SOUTHEAST QUARTER TO THE CENTER OF LITTLE BUFFALO RIVER, THEN GO NORTHEASTERLY WITH THE CENTERLINE OF THE RIVER TO A POINT 250 FEET WEST OF THE WESTERN BOUNDARY OF HIGHWAY 7 AND 100 FEET SOUTH OF THE SOUTH BOUNDARY OF HIGHWAY 74, THEN GO NORTHWESTERLY PARALLEL AND 100 FEET SOUTH AND WEST OF THE SOUTH BOUNDARY OF HIGHWAY 74 TO THE END OF FIRST HAIRPIN CURVE, THEN GO NORTH 500 FOOT TO THE NORTH LINE OF THE NORTHWEST QUARTER OF THE SOUTHEAST QUARTER, THEN CONTINUE NORTH 250 FEET, THEN GO EAST TO THE EAST LINE OF THE SOUTHWEST OF THE NORTHEAST, THEN GO NORTH ALONG THE EAST LINE TO THE NORTHEAST CORNER, THEN CONTINUE NORTH ALONG THE EAST LINE OF THE EAST HALF OF THE NORTHWEST OF THE NORTHEAST 1320 FEET TO THE NORTHEAST CORNER, THEN GO ALONG THE NORTH LINE WEST 660 FEET TO THE POINT OF BEGINNING.

WHEREFORE, Petitioners respectfully pray that the court ORDER, JUDGE and DECREE that the land described within this petition be annexed to and made a part of the City of Jasper, Arkansas.

Blake Matthew
Signature of Property Owner

Jan Lee
Signature of Attesting Witness

HCR 70 Box 16 Jasper AR 72641
Address

Anna M. Matthees
Signature of Property Owner

Jan Lee
Signature of Attesting Witness

HCR 70 Box 16 - JASPER AR 72641
Address

Coly Brass
Signature of Property Owner

Michael Fisher
Signature of Attesting Witness

108 Cardinal Lane
Address

Jenny Brasel
Signature of Property Owner

Michael Fisher
Signature of Attesting Witness

108 Cardinal Lane
Address
Jasper, AR 72641

Jesta Jones
Signature of Property Owner
P.O. Box 297 Jasper, AR 72641

Lindsay Graham
Signature of Attesting Witness

Kim M. Hill
Signature of Property Owner

Jan Lee
Signature of Attesting Witness

Hc 70 Box 16A Jasper, AR 72641
Address

✓ Paul Davis
Signature of Property Owner
Address: HC 70 Box 14

[Signature]
Signature of Attesting Witness

✓ Muffany Davis
Signature of Property Owner
Address: HC 70 Box 14

[Signature]
Signature of Attesting Witness

✓ Charles E. House
Signature of Property Owner
Address: P.O. Box 143 Jasper AR 72641
#88 Hwy 827 Jasper AR 72641

[Signature]
Signature of Attesting Witness

✓ Jay David Buller
Signature of Property Owner
Address: HC 70 Box 13

[Signature]
Signature of Attesting Witness

✓ Judy Walker
Signature of Property Owner
Address: 115 Hwy 74 West
Jasper, AR 72641

[Signature]
Signature of Attesting Witness

✓ Judy Walker
Signature of Property Owner
Address: 115 HWY 74 West, Jasper, AR
72641

[Signature]
Signature of Attesting Witness

✓ Maria Clark
Signature of Property Owner
Address: 107 Hwy 74 West

Lindsey Graham
Signature of Attesting Witness

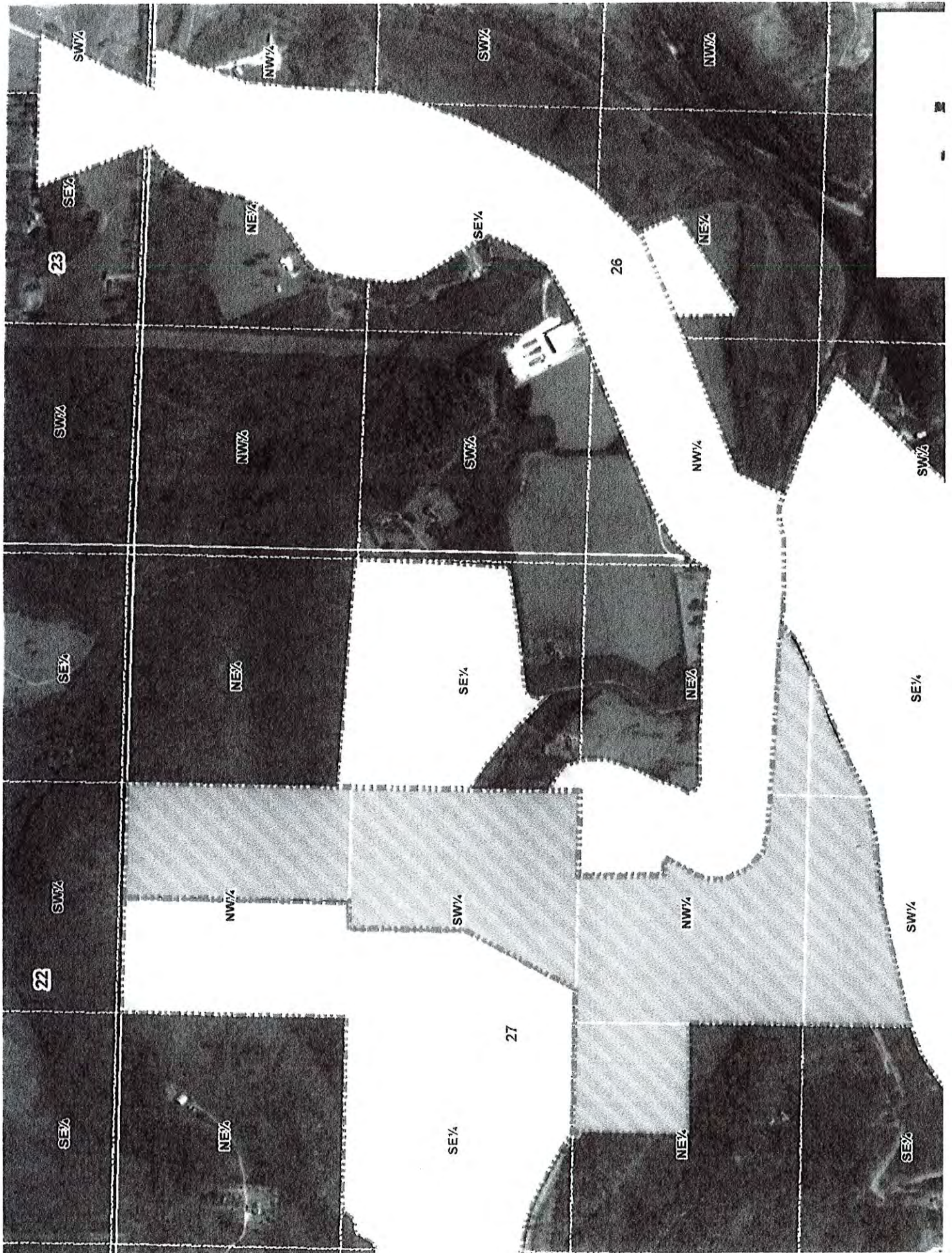

IN THE COUNTY COURT OF NEWTON COUNTY, ARKANSAS

IN THE MATTER OF: ANNEXING TO THE
CITY OF JASPER, ARKANSAS CERTAIN
TERRITORY CONTIGUOUS TO SAID CITY
OF JASPER, ARKANSAS

NO. CC-2018-01

ORDER

On this the 26th day of June, 2018 is filed the petition of real estate owners desiring the annexation of territory to the City of Jasper, Arkansas, more particularly described therein, and this Court does hereby fix the 30th day of July, 2018 as the date for hearing on said petition, and, the agent named by said petitioners, shall give notice of such hearing as provided by law, said hearing to be held in the office of the County Judge at 11:00 a.m.

William Campbell
County Judge

FILED
OFFICE OF THE CIRCUIT CLERK
NEWTON COUNTY ARKANSAS

JUL 06 2018

11:20 A.M. _____ P.M.
BOOK X PAGE 585
DONNIE DAVIS

Newton County, Clerk
Annexing to the City of Jasper

Certificate of Publication

STATE OF ARKANSAS

SS

COUNTY OF NEWTON

I, Carol Lawson upon oath state that I am Business Manager of THE NEWTON COUNTY TIMES, a weekly newspaper published at Jasper, Newton County, Arkansas, and that said newspaper has a bona fide

circulation in said county, that the annexed advertisement was inserted, and published, in said newspaper for 37 consecutive weeks, as follows: 1st insertion

IN THE COUNTY COURT OF
NEWTON COUNTY,
ARKANSAS
IN THE MATTER OF:
ANNEXING TO THE CITY OF
JASPER, ARKANSAS
CERTAIN TERRITORY
CONTIGUOUS TO SAID CITY
OF JASPER, ARKANSAS
NO. CC-2018-01
ORDER

On this the 26th day of June, 2018 is filed the petition of real estate owners desiring the annexation of territory to the City of Jasper, Arkansas, more particularly described therein, and this Court does hereby fix the 30th day of July, 2018 as the date for hearing on said petition, and, the agent named by said petitioners, shall give notice of such hearing as provided by law, said hearing to be held in the office of the County Judge at 11:00 a.m.
Warren Campbell
County Judge
(SEAL)
1st. Pub. 7/11/18, 3t.

on the 11 day of July 2018

2nd on the 18 day of July 2018

3rd on the 25 day of July 2018

4th on the ___ day of _____ 20__

5th on the ___ day of _____ 20__

6th on the ___ day of _____ 20__

Carol Lawson
Business Manager

Subscribed and sworn to before me this ___ day of _____, 20__

M. Anderson

FEE 92.25

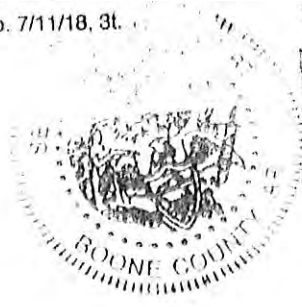

Annexation Map Correction Amending Ordinance 2009-2: City of Jasper July, 2018

City: Jasper
Mayor: Jan Larson

Arkansas Code 14-40-101.

Before an entity undertakes an annexation, consolidation, or detachment proceeding under this chapter, the entity shall coordinate with the Arkansas Geographic Information Systems Office for preparation of legal descriptions and digital mapping for the relevant annexation, consolidation, and detachment areas.

The map contained herein, is evidence, the entity has met requirements of Act 914 of 2015

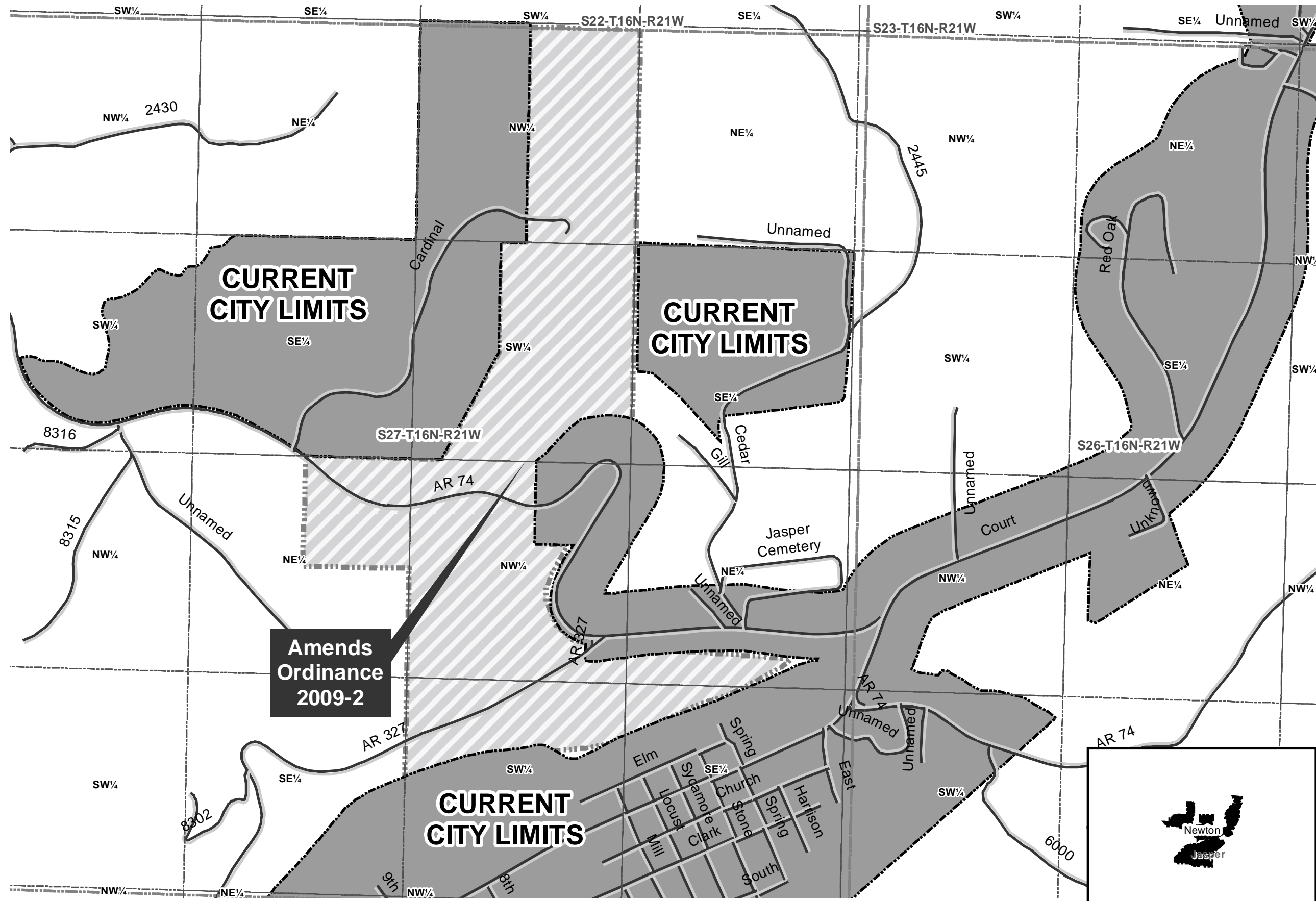

- Sections
- Minor Road
- Existing City
- Amended Legal Description

