



ARKANSAS SECRETARY OF STATE

MARK MARTIN

October 10, 2018

The Honorable Donnie Davis
Newton County and Circuit Clerk
100 Court ST
Jasper, AR 72641

Re: City of Jasper Annexation Ordinance 2018-5

Dear Mr. Davis,

This letter acknowledges receipt and filing of the following notice of a municipal boundary change by the Office of the Secretary of State:

Filing Type: Annexation pursuant to A.C.A § 14-40-602 (annexation by a majority of the landowners)

Effective Date: 10/20/2018

County: Newton

City: Jasper

City Ordinance: 2018-5

Dated: 09/20/2018

County Court Order: CC-2018-03

Date Filed: 09/04/2018 Hon. Warren Campbell, Newton County Judge

A file marked copy of the ordinance, court order and exhibits submitted to our Office are enclosed. By copy of this letter (and its enclosures), the Secretary of State hereby notifies the appropriate mapping authorities for Arkansas. Please retain these copies as official record of the filing of the municipal boundary change by the Arkansas Secretary of State.

If you have any questions or concerns regarding this pending filing, please contact our office at 501-682-3401.

Sincerely,

A handwritten signature in cursive script that reads "Cynthia Fisher".

Cynthia Fisher
Arkansas Secretary of State Legal Division
500 Woodlane St, Room 256
Little Rock, AR 72201
501-682-3401

cc: Arkansas Geographic Information Systems Office (w/ encl)
Arkansas Highway and Transportation Department Mapping Department (w/ encl)
Department of Finance and Administration (w/encl)
Arkansas Public Service Commission (w.encl)
UALR Institution for Economic Advancement (w/encl)
Honorable Jan Larson, Mayor of Jasper (w/encl)



Arkansas Secretary of State

Mark Martin Arkansas Secretary of State, 500 Woodlane Ave, Little Rock, AR 72201-1094

Municipal Boundary Change Checklist

County: Newton City/Town: Jasper

City Ordinance/Resolution No: 2018-5 Date approved: 9-20-2018

County Court Case No: CC 2018-03 Date Order Filed: 9-09-18

Type: Majority of Landowners
(Choose from the list of Arkansas Code Sections located on the back)

Date Change Effective: 9-20-18 Set by: Municipal Ordinance Emergency Clause Court Default
(Required by Act 655 of 2017)

For Circuit Court Challenge: Date Order Filed: 9-04-18 Upheld Overturned Other (attach explanation)

Initiating party:

All Landowners Majority Landowners Municipal Governing Body State Other _____

Supporting Documentation attached (check all that apply):

- File marked copy of City Ordinance/Resolution (required)
- File marked copy of County Court Order (required except for island annexation and annexation approved by election)
- Copy of Arkansas GIS approved printed map and certification letter (required)
- Proof of Publication for all Legal Notices (include Hearing, Election, and City Ordinance/Resolution notices)
- File marked copy of Petition Part or File marked copy of the certified special election results (if applicable)
- File marked copy of Complaint and final Circuit Court Order (Court Challenge only)

Municipal Contact:

Name: Jan Larson Title: Mayer

Street Address: 101 E Elm

City: Jasper St: AR Zip code: 72641

Complete one form per ordinance/resolution, attach it as a cover page to the supporting document set and submit to the County Clerk's Office within 45 days of the Effective Date as required by Act 655 of 2017

County Official:

Signature: [Signature] Title: County Clerk

Date: 9-27-18

Pursuant to Act 655 of 2017, County Officials must submit a file-marked copy of municipal boundary change documents within 30 days of receipt to: Arkansas Secretary of State, Attn: Municipal Boundary Filing, 500 Woodlane Ave Suite 256, Little Rock, AR 72201-1094

Office of the Arkansas Secretary of State use only

Received by: Cynthia Fisher

FILED

OCT 10 2018

Arkansas
Secretary of State

ORDINANCE NO. 2018-5

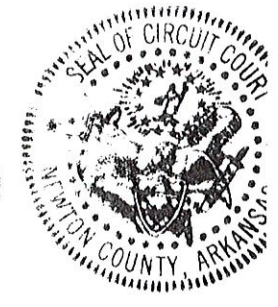

AN ORDINANCE ACCEPTING THE ANNEXATION OF CERTAIN TERRITORY TO THE CITY OF JASPER, ARKANSAS, AND MAKING SAME A PART OF THE CITY OF JASPER, ARKANSAS AND ASSIGNING SAME TO WARDS.

WHEREAS, a petition was filed with the County Clerk of Newton County, Arkansas, by the majority of the real estate owners of the hereinafter described territory praying that said territory be annexed to, and made a part of the City of Jasper, Arkansas; and,

WHEREAS, on September 10, 2018, the County Court of Newton County, Arkansas, found that the petition was signed by a majority of the real estate owners in said territory; that said territory was contiguous and adjoining the present corporate limits of the City of Jasper, Arkansas; that an accurate plat or map of said territory had been filed with and made a part of said petition; that proper notice had been given for the time and in the manner prescribed by law, and that all things pertaining thereto had been done in the manner prescribed by law, and that said lands and territory should be annexed to and made a part of the City of Jasper, Arkansas, subject to the acceptance of same by the City Council of said City at the proper time, as provided by law; and

WHEREAS, the time fixed by law for appealing from said order of annexation made by the County Court has expired and no appeal has been taken from said order.

Now, therefore, be it ordained by the city council of the City of Jasper, Arkansas:

SECTION 1. That the following described lands and territory contiguous and adjoining the City of Jasper, Arkansas, be and the same is hereby accepted as part of and annexed to and made a part of the City of Jasper effective September 10, 2018.

TRACT 1: A PART OF THE SOUTHEAST QUARTER OF THE NORTHEAST QUARTER AND A PART OF THE NORTHEAST QUARTER OF THE SOUTHEAST QUARTER OF SECTION TWENTY SEVEN (27), A PART OF THE NORTHWEST QUARTER OF THE NORTHWEST QUARTER, PART OF THE SOUTHWEST QUARTER OF THE NORTHWEST QUARTER, A PART OF THE NORTHWEST QUARTER OF THE SOUTHWEST QUARTER AND A PART OF THE SOUTHEAST QUARTER OF THE NORTHWEST QUARTER OF SECTION TWENTY SIX (26), ALL IN TOWNSHIP SIXTEEN (16) NORTH, RANGE TWENTY ONE (21) WEST, NEWTON COUNTY ARKANSAS, DESCRIBED AS FOLLOWS;

FROM THE SOUTHWEST CORNER OF THE SAID SOUTHEAST OF THE NORTHEAST QUARTER, POINT OF BEGINNING OF TRACT BEING DESCRIBED GO ALONG THE WEST LINE NORTH 01°42'52" EAST 1310.60 FEET TO THE NORTHWEST CORNER, THEN GO ALONG THE NORTH LINE SOUTH 89°11'07" EAST 1311.85 FEET TO THE NORTHEAST CORNER, THEN GO ALONG THE WEST LINE OF THE NORTHWEST QUARTER OF THE NORTHWEST QUARTER OF SECTION TWENTY SIX (26) NORTH 01°11'55"

FILED
OFFICE OF THE CIRCUIT CLERK
NEWTON COUNTY ARKANSAS

SEP 21 2018

8:00 A.M. P.M.
2018

FILED

OCT 10 2018

Arkansas
Secretary of State

EAST 816.69 FEET, THEN LEAVING THE WEST LINE GO NORTH 61°38'47" EAST 18.06 FEET, SOUTH 22°26'51" EAST 547.57 FEET, SOUTH 33°14'01" EAST 164.05 FEET, SOUTH 07°42'56" WEST 185.14 FEET, SOUTH 07°22'40" WEST 94.36 FEET, SOUTH 08°28'54" EAST 218.48 FEET, SOUTH 33°03'31" EAST 357.64 FEET, SOUTH 47°45'55" WEST 340.00 FEET, NORTH 52°33'05" WEST 160.00 FEET, NORTH 03°03'55" EAST 205.00 FEET, NORTH 32°04'51" WEST 301.71 FEET TO THE EAST LINE OF THE SOUTHEAST QUARTER OF THE NORTHEAST QUARTER OF SECTION TWENTY SEVEN (27), THEN GO ALONG THE EAST LINE SOUTH 01°11'31" WEST 640.42 FEET, THEN LEAVING THE EAST LINE GO SOUTH 25°07'09" WEST 21.84 FEET, SOUTH 58°12'16" WEST 27.01 FEET, SOUTH 81°27'36" WEST 284.36 FEET, SOUTH 08°49'24" EAST 310.00 FEET, SOUTH 81°10'41" WEST 457.00 FEET TO THE CENTERLINE OF CEDAR LANE, THEN GO SOUTH ALONG THE CENTERLINE OF CEDAR LANE TO THE NORTH LINE OF THE CITY OF JASPER BY ORDINANCE 1991-33-125, THEN GO ALONG THE NORTH LINE EAST 288.00 FEET TO THE WEST LINE OF THE JASPER CEMETERY, THEN GO ALONG THE BOUNDARY NORTH 13°40'00" WEST 260.25 FEET, THEN GO ALONG THE NORTH LINE NORTH 85°00'00" EAST 505.90 FEET, THEN GO ALONG THE EAST LINE SOUTH 18°39'09" EAST 29.80 FEET TO THE NORTH LINE OF THE JASPER FIRST BAPTIST CHURCH BOUNDARY, THEN GO ALONG THE BOUNDARY NORTH 84°28'48" EAST 424.61 FEET TO THE NORTH LINE OF THE CITY OF JASPER, THEN GO ALONG THE BOUNDARY IN A NORTHEAST DIRECTION 295.39 FEET, THEN GO NORTH 00°14'30" EAST 407.23 FEET, SOUTH 89°45'30" EAST 520.00 FEET TO THE WEST LINE OF THE CARROLL ELECTRIC PROPERTY, THEN GO ALONG THE WEST LINE NORTH 27°54'48" WEST 276.84 FEET TO THE NORTH LINE, THEN GO ALONG THE NORTH LINE NORTH 62°05'10" EAST 298.75 FEET TO THE NORTHEAST CORNER, THEN GO ALONG THE EAST LINE SOUTH 27°54'49" EAST 488.24 FEET TO THE OF THE CITY OF JASPER, THEN GO SOUTH AND WEST ALONG THE NORTH LINE PARALLEL TO HIGHWAYS 7 AND 74 TO THE WEST LINE OF THE NORTHEAST OF THE SOUTHEAST OF SECTION TWENTY SEVEN (27), THEN GO ALONG THE WEST LINE NORTH 01°16'54" EAST TO THE POINT OF BEGINNING OF SAID PROPERTY AND INCLUDES THAT LANDS PREVIOUSLY ANNEXATED BY ORDINANCE 2001-1.

TRACT 2: A PART OF THE SOUTHWEST QUARTER OF THE SOUTHWEST QUARTER OF SECTION TWENTY SIX (26), TOWNSHIP SIXTEEN (16) NORTH, RANGE TWENTY ONE (21) WEST, NEWTON COUNTY ARKANSAS, DESCRIBED AS FOLLOWS;

FROM THE SOUTHEAST CORNER OF THE SAID SOUTHWEST OF THE SOUTHWEST RUN IN A NORTHWESTERLY DIRECTION MEANDERING A DRY BRANCH TO THE SOUTH BOUNDARY OF HIGHWAY 74, THEN GO IN A EASTERLY DIRECTION ALONG THE SOUTH BOUNDARY OF HIGHWAY 74 150.00 FEET TO THE POINT OF BEGINNING OF TRACT BEING DESCRIBED, THEN CONTINUE EAST ALONG SAID RIGHT OF WAY 110.00 FEET, THEN GO SOUTH 150.00 FEET, THEN GO WEST PARALLEL TO THE HIGHWAY 110.00 FEET, THEN GO NORTH 150.00 FEET TO THE POINT OF BEGINNING OF SAID TRACT. DISCRPTION FROM WARRENTY DEED BOOK 123A, PAGE 585 FILED 12-17-2014.

SECTION 2. That Tract 1 of the above described territory shall be annexed to and made a part of Ward 1 of the City of Jasper, and the same shall henceforth be a part of said ward as fully as existing parts of said ward.

SECTION 3. That Tract 2 of the above described territory shall be annexed to and made a part of Ward 2 of the City of Jasper, and the same shall henceforth be a part of said ward as fully as existing parts of said ward.

SECTION 4. Notice. Within forty-five (45) days of the effective date of this ordinance the city clerk shall provide written notice, along with complete documentation, to the county clerk of each county in which the territory is affected.

SECTION 5: Because of the short period of time available for action and the need to keep services, uniform and available in the annexed area, the adoption of this ordinance is necessary for the public peace, health, safety and welfare, AN EMERGENCY is declared to exist. Therefore, this ordinance shall be in full force and effect from and after the date of its passage.

PASSED AND APPROVED THIS 20th DAY OF September 2018.

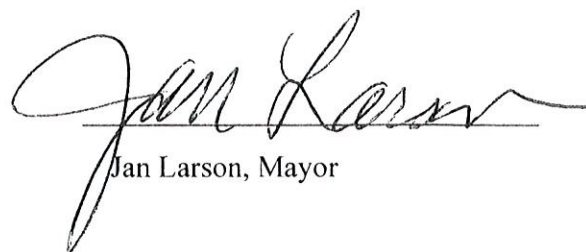
Jan Larson, Mayor

ATTEST:

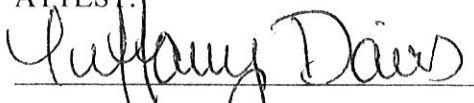

Tiffany Davis, Recorder

IN THE COUNTY COURT OF NEWTON COUNTY, ARKANSAS

IN THE MATTER OF: ANNEXING TO THE
CITY OF JASPER, ARKANSAS CERTAIN
TERRITORY CONTIGUOUS TO SAID CITY
OF JASPER, ARKANSAS

NO. CC-2018-23

DECREE OF ANNEXATION

On this regular day of a regular term of the County Court of Newton County, Arkansas, there is presented to the Court by, DAVID FAUGHT, agent of the petitioners, a petition for annexation of certain territory, hereinafter more particularly described, to the City of Jasper, Arkansas, and the Court being fully advised of the facts and the law, does hereby find, judge and decree as follows:

The Court finds that the petition was filed more than thirty [30] days prior to this date and that in said petition the said was selected by the petitioners to act on their behalf in filing and presenting the petition.

The court further finds that notice of the hearing on this matter was published one [1] time a week for three [3] consecutive weeks as required by A.C.A. § 14-40-602.

The Court finds that a majority of the total number of real estate owners in the area affected by this petition have signed said petition and that such majority owns more than one-half of the acreage affected.

The Court further finds that the territory consists of lands that:

- (1) Whether platted or not, are held to be sold as suburban property;
- (2) Furnish the abode for a densely settled community or represent the actual growth of the municipality beyond its legal boundary;
- (3) Are needed for any proper municipal purposes; or
- (4) Are valuable by reason of their adaptability for prospective municipal uses.

FILED

OCT 10 2018

Arkansas
Secretary of State

FILED
OFFICE OF THE CIRCUIT CLERK
NEWTON COUNTY ARKANSAS

SEP 10 2018

9:00 A.M. P.M.
BOOK X PAGE 651



The Court further finds that the territory sought to be annexed was accurately described in said petition and that said territory is contiguous to the boundaries of the City of Jasper, Arkansas. The Court further finds that attached to and made a part of said petition is an accurate map of the territory sought to be annexed to the City of Jasper.

The Court further finds that the prayer of the petition is right and proper.

Therefore, the Court hereby ORDERS, JUDGES and DECREES that the following described territory be and the same is hereby annexed to and made a part of the City of Jasper, Arkansas, to-wit:

TRACT 1:

A PART OF THE SOUTHEAST QUARTER OF THE NORTHEAST QUARTER AND A PART OF THE NORTHEAST QUARTER OF THE SOUTHEAST QUARTER OF SECTION TWENTY SEVEN (27), A PART OF THE NORTHWEST QUARTER OF THE NORTHWEST QUARTER, PART OF THE SOUTHWEST QUARTER OF THE NORTHWEST QUARTER, A PART OF THE NORTHWEST QUARTER OF THE SOUTHWEST QUARTER AND A PART OF THE SOUTHEAST QUARTER OF THE NORTHWEST QUARTER OF SECTION TWENTY SIX (26), ALL IN TOWNSHIP SIXTEEN (16) NORTH, RANGE TWENTY ONE (21) WEST, NEWTON COUNTY ARKANSAS, DESCRIBD AS FOLLOWS;

FROM THE SOUTHWEST CORNER OF THE SAID SOUTHEAST OF THE NORTHEAST QUARTER, POINT OF BEGINNING OF TRACT BEING DESCRIBED GO ALONG THE WEST LINE NORTH 01°42'52" EAST 1310.60 FEET TO THE NORTHWEST CORNER, THEN GO ALONG THE NORTH LINE SOUTH 89°11'07" EAST 1311.85 FEET TO THE NORTHEAST CORNER, THEN GO ALONG THE WEST LINE OF THE NORTHWEST QUARTER OF THE NORTHWEST QUARTER OF SECTION TWENTY SIX (26) NORTH 01°11'55" EAST 816.69 FEET, THEN LEAVING THE WEST LINE GO NORTH 61°38'47" EAST 18.06 FEET, SOUTH 22°26'51" EAST 547.57 FEET, SOUTH 33°14'01" EAST 164.05 FEET, SOUTH 07°42'56" WEST 185.14 FEET, SOUTH 07°22'40" WEST 94.36 FEET, SOUTH 08°28'54" EAST 218.48 FEET, SOUTH 33°03'31" EAST 357.64 FEET, SOUTH 47°45'55" WEST 340.00 FEET, NORTH 52°33'05" WEST 160.00 FEET, NORTH 03°03'55" EAST 205.00 FEET, NORTH 32°04'51" WEST 301.71 FEET TO THE EAST LINE OF THE SOUTHEAST QUARTER OF THE NORTHEAST QUARTER OF SECTION TWENTY SEVEN (27), THEN GO ALONG THE EAST LINE SOUTH 01°11'31" WEST 640.42 FEET, THEN LEAVING THE EAST LINE GO SOUTH 25°07'09" WEST 21.84 FEET, SOUTH 58°12'16" WEST 27.01 FEET, SOUTH 81°27'36" WEST 284.36 FEET, SOUTH 08°49'24" EAST 310.00 FEET, SOUTH 81°10'41" WEST 457.00 FEET TO THE CENTERLINE OF CEDAR LANE, THEN GO SOUTH ALONG THE CENTERLINE OF CEDAR LANE TO THE NORTH LINE OF THE CITY OF JASPER BY ORDINANCE 1991-33-125, THEN GO ALONG THE NORTH LINE EAST 288.00 FEET TO THE WEST LINE OF THE JASPER CEMETERY, THEN GO ALONG THE BOUNDARY NORTH 13°40'00" WEST 260.25 FEET, THEN GO ALONG THE NORTH LINE NORTH 85°00'00" EAST 505.90 FEET, THEN GO ALONG THE EAST LINE SOUTH 18°39'09" EAST 29.80 FEET TO THE NORTH LINE OF THE JASPER FIRST BAPTIST CHURCH BOUNDARY, THEN GO ALONG THE BOUNDARY NORTH 84°28'48" EAST 424.61 FEET TO THE NORTH LINE OF THE CITY OF JASPER, THEN GO ALONG THE BOUNDARY IN A

NORTHEAST DIRECTION 295.39 FEET, THEN GO NORTH 00°14'30" EAST 407.23 FEET, SOUTH 89°45'30" EAST 520.00 FEET TO THE WEST LINE OF THE CARROLL ELECTRIC PROPERTY, THEN GO ALONG THE WEST LINE NORTH 27°54'48" WEST 276.84 FEET TO THE NORTH LINE, THEN GO ALONG THE NORTH LINE NORTH 62°05'10" EAST 298.75 FEET TO THE NORTHEAST CORNER, THEN GO ALONG THE EAST LINE SOUTH 27°54'49" EAST 488.24 FEET TO THE OF THE CITY OF JASPER, THEN GO SOUTH AND WEST ALONG THE NORTH LINE PARALLEL TO HIGHWAYS 7 AND 74 TO THE WEST LINE OF THE NORTHEAST OF THE SOUTHEAST OF SECTION TWENTY SEVEN (27), THEN GO ALONG THE WEST LINE NORTH 01°16'54" EAST TO THE POINT OF BEGINNING OF SAID PROPERTY AND INCLUDES THAT LANDS PREVIOUSLY ANNEXATED BY ORDINANCE 2001-1.

TRACT 2:

A PART OF THE SOUTHWEST QUARTER OF THE SOUTHWEST QUARTER OF SECTION TWENTY-SIX (26), TOWNSHIP SIXTEEN (16) NORTH, RANGE TWENTY-ONE (21) WEST, NEWTON COUNTY ARKANSAS, DESCRIBED AS FOLLOWS;

FROM THE SOUTHEAST CORNER OF THE SAID SOUTHWEST OF THE SOUTHWEST RUN IN A NORTHWESTERLY DIRECTION MEANDERING A DRY BRANCH TO THE SOUTH BOUNDARY OF HIGHWAY 74, THEN GO IN A EASTERLY DIRECTION ALONG THE SOUTH BOUNDARY OF HIGHWAY 74 150.00 FEET TO THE POINT OF BEGINNING OF TRACT BEING DESCRIBED, THEN CONTINUE EAST ALONG SAID RIGHT OF WAY 110.00 FEET, THEN GO SOUTH 150.00 FEET, THEN GO WEST PARALLEL TO THE HIGHWAY 110.00 FEET, THEN GO NORTH 150.00 FEET TO THE POINT OF BEGINNING OF SAID TRACT. DISCRIPTION FROM WARRENTY DEED BOOK 123A, PAGE 585 FILED 12-17-2014.

The Court further orders that the original papers in this cause be delivered to the Clerk of County, Arkansas, same to be properly recorded upon the records of County, Arkansas, and the Clerk, after properly recording and filing the original papers, prepare transcripts of same; that one of the certified transcripts be delivered to the City of Jasper, Arkansas, one copy to the Secretary of State and one copy to the Director of the Tax Division of the Arkansas Public Service Commission.

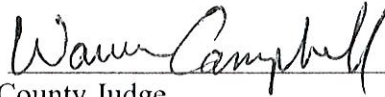
County Judge

IN THE COUNTY COURT OF NEWTON COUNTY, ARKANSAS

IN THE MATTER OF: ANNEXING TO THE City
OF JASPER, ARKANSAS CERTAIN TERRITORY CONTIGUOUS
TO SAID CITY OF JASPER, ARKANSAS

NO. CC-2018-13

DECREE OF ANNEXATION

On this regular day of a regular term of the County Court of Newton County, Arkansas, there is presented to the Court by, David Faught, agent of the petitioners, a petition for annexation of certain territory, hereinafter more particularly described, to the City of Jasper, Arkansas, and the Court being fully advised of the facts and the law, does hereby find, judge and decree as follows:

The Court finds that the petition was filed more than thirty (30) days prior to this date and that in said petition the said was selected by the petitioners to act on their behalf in filing and presenting the petition.

The Court further finds that notice of the hearing on this matter was published one (1) time a week for three (3) consecutive weeks as required by A.C.A. 14-40-602. The Court finds that a majority of the total number of real estate owners in the area affected by this petition have signed said petition and that such majority owns more than one-half of the acreage affected.

The Court further finds that the territory consists of lands that:

1. Whether platted or not, are held to be sold as suburban property;
2. Furnish the abode for a densely settled community or represent the actual growth of the municipality beyond its legal boundary;
3. Are needed for any proper municipal purposes; or
4. Are valuable by reason of their adaptability of prospective municipal uses.

The Court further finds that the territory sought to be annexed was accurately described in said petition and that said territory is contiguous to the boundaries of the City of Jasper, Arkansas.

The Court further finds that attached to and made a part of said petition is an accurate map of the territory sought to be annexed to the City of Jasper.

The Court further finds that the prayer of the petition is right and proper.

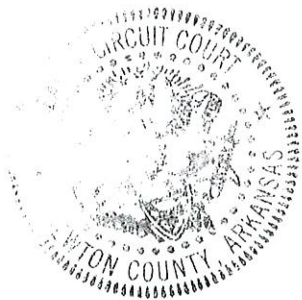

FILED
OCT 10 2018
Arkansas
Secretary of State

FILED
OFFICE OF THE CIRCUIT CLERK
NEWTON COUNTY ARKANSAS
SEP 10 2018
9:00 A.M. _____ P.M.
BOOK X PAGE 654

Therefore, the Court hereby ORDERS, JUDGES and DECREES that the following described territory be and the same is hereby annexed to and made a part of the City of Jasper, Arkansas to wit:

TRACT 1

A PART OF THE SOUTHEAST QUARTER OF THE NORTHEAST QUARTER AND A PART OF THE NORTHEAST QUARTER OF THE SOUTHEAST QUARTER OF SECTION TWENTY SEVEN (27), A PART OF THE NORTHWEST QUARTER OF THE NORTHWEST QUARTER, PART OF THE SOUTHWEST QUARTER OF THE NORTHWEST QUARTER, A PART OF THE NORTHWEST QUARTER OF THE SOUTHWEST QUARTER AND A PART OF THE SOUTHEAST QUARTER OF THE NORTHWEST QUARTER OF SECTION TWENTY SIX (26), ALL IN TOWNSHIP SIXTEEN (16) NORTH, RANGE TWENTY ONE (21) WEST, NEWTON COUNTY ARKANSAS, DESCRIBD AS FOLLOWS;
FROM THE SOUTHWEST CORNER OF THE SAID SOUTHEAST OF THE NORTHEAST QUARTER, POINT OF BEGINNING OF TRACT BEING DESCRIBED GO ALONG THE WEST LINE NORTH $01^{\circ}42'52''$ EAST 1310.60 FEET TO THE NORTHWEST CORNER, THEN GO ALONG THE NORTH LINE SOUTH $89^{\circ}11'07''$ EAST 1311.85 FEET TO THE NORTHEAST CORNER, THEN GO ALONG THE WEST LINE OF THE NORTHWEST QUARTER OF THE NORTHWEST QUARTER OF SECTION TWENTY SIX (26) NORTH $01^{\circ}11'55''$ EAST 816.69 FEET, THEN LEAVING THE WEST LINE GO NORTH $61^{\circ}38'47''$ EAST 18.06 FEET, SOUTH $22^{\circ}26'51''$ EAST 547.57 FEET, SOUTH $33^{\circ}14'01''$ EAST 164.05 FEET, SOUTH $07^{\circ}42'56''$ WEST 185.14 FEET, SOUTH $07^{\circ}22'40''$ WEST 94.36 FEET, SOUTH $08^{\circ}28'54''$ EAST 218.48 FEET, SOUTH $33^{\circ}03'31''$ EAST 357.64 FEET, SOUTH $47^{\circ}45'55''$ WEST 340.00 FEET, NORTH $52^{\circ}33'05''$ WEST 160.00 FEET, NORTH $03^{\circ}03'55''$ EAST 205.00 FEET, NORTH $32^{\circ}04'51''$ WEST 301.71 FEET TO THE EAST LINE OF THE SOUTHEAST QUARTER OF THE NORTHEAST QUARTER OF SECTION TWENTY SEVEN (27), THEN GO ALONG THE EAST LINE SOUTH $01^{\circ}11'31''$ WEST 640.42 FEET, THEN LEAVING THE EAST LINE GO SOUTH $25^{\circ}07'09''$ WEST 21.84 FEET, SOUTH $58^{\circ}12'16''$ WEST 27.01 FEET, SOUTH $81^{\circ}27'36''$ WEST 284.36 FEET, SOUTH $08^{\circ}49'24''$ EAST 310.00 FEET, SOUTH $81^{\circ}10'41''$ WEST 457.00 FEET TO THE CENTERLINE OF CEDAR LANE, THEN GO SOUTH ALONG THE CENTERLINE OF CEDAR LANE TO THE NORTH LINE OF THE CITY OF JASPER BY ORDINANCE 1991-33-125, THEN GO ALONG THE NORTH LINE EAST 288.00 FEET TO THE WEST LINE OF THE JASPER CEMETERY, THEN GO ALONG THE BOUNDARY NORTH $13^{\circ}40'00''$ WEST 260.25 FEET, THEN GO ALONG THE NORTH LINE NORTH $85^{\circ}00'00''$ EAST 505.90 FEET, THEN GO ALONG THE EAST LINE SOUTH $18^{\circ}39'09''$ EAST 29.80 FEET TO THE NORTH LINE OF THE JASPER FIRST BAPTIST CHURCH BOUNDARY, THEN GO ALONG THE BOUNDARY NORTH $84^{\circ}28'48''$ EAST 424.61 FEET TO THE NORTH LINE OF THE CITY OF JASPER, THEN GO ALONG THE BOUNDARY IN A NORTHEAST DIRECTION 295.39 FEET, THEN GO NORTH $00^{\circ}14'30''$ EAST 407.23 FEET, SOUTH $89^{\circ}45'30''$ EAST 520.00 FEET TO THE WEST LINE OF THE CARROLL ELECTRIC PROPERTY, THEN GO ALONG THE WEST LINE NORTH $27^{\circ}54'48''$ WEST 276.84 FEET TO THE NORTH LINE, THEN GO ALONG THE NORTH LINE NORTH $62^{\circ}05'10''$ EAST 298.75 FEET TO THE NORTHEAST CORNER, THEN GO ALONG THE EAST LINE SOUTH $27^{\circ}54'49''$ EAST 488.24 FEET TO THE OF THE CITY OF JASPER, THEN GO SOUTH AND WEST ALONG THE NORTH LINE PARALLEL TO HIGHWAYS 7 AND 74 TO THE WEST

LINE OF THE NORTHEAST OF THE SOUTHEAST OF SECTION TWENTY SEVEN (27), THEN GO ALONG THE WEST LINE NORTH 01° 16'54" EAST TO THE POINT OF BEGINNING OF SAID PROPERTY AND INCLUDES THAT LANDS PREVIOUSLY ANNEXATED BY ORDINANCE 2001-1.

TRACT 2

A PART OF THE SOUTHWEST QUARTER OF THE SOUTHWEST QUARTER OF SECTION TWENTY SIX (26), TOWNSHIP SIXTEEN (16) NORTH, RANGE TWENTY ONE (21) WEST, NEWTON COUNTY ARKANSAS, DESCRIBED AS FOLLOWS;

FROM THE SOUTHEAST CORNER OF THE SAID SOUTHWEST OF THE SOUTHWEST RUN IN A NORTHWESTERLY DIRECTION MEANDERING A DRY BRANCH TO THE SOUTH BOUNDARY OF HIGHWAY 74, THEN GO IN A EASTERLY DIRECTION ALONG THE SOUTH BOUNDARY OF HIGHWAY 74 150.00 FEET TO THE POINT OF BEGINNING OF TRACT BEING DESCRIBED, THEN CONTINUE EAST ALONG SAID RIGHT OF WAY 110.00 FEET, THEN GO SOUTH 150.00 FEET, THEN GO WEST PARALLEL TO THE HIGHWAY 110.00 FEET, THEN GO NORTH 150.00 FEET TO THE POINT OF BEGINNING OF SAID TRACT.

DISCRIPTION FROM WARRENTY DEED BOOK 123A, PAGE 585 FILED 12-17-2014.

The Court further orders that the original papers in this cause be delivered to the Clerk of Newton County, Arkansas, same to be properly recorded upon the records of Newton County, Arkansas, and the Clerk, after properly recording and filing the original papers, prepare transcripts of same; that one of the certified transcripts be delivered to the City of Jasper, Arkansas, one copy to the Secretary of State and one copy to the Director of the Tax Division of the Arkansas Public Service Commission.



Warren Campbell, Newton County Judge



**ARKANSAS
GIS OFFICE**

July 20, 2018

Mayor Jan Larson
101 East Elm St
Jasper AR 72641

RE: City of Jasper Annexation Coordination Requirement

Honorable Mayor Larson,

Thank you for coordinating with our office as you seek to annex property into the City of Jasper, AR. The legal description you provided includes Tract 1 and Tract 2, and therefore we prepared two maps attached herein corresponding to both tracts.

This letter represents confirmation that you have properly coordinated with our office (Arkansas GIS Office) as specified in § 14-40-101 (Act 914 of 2015) of the 90th General Assembly.

Our office will wait completion of any additional steps necessary for the proposed boundary change, which normally comes from the Arkansas Secretary of State Elections Division after any appropriate filing by your County Clerk.

Thank you,

Shelby D Johnson, State Geographic Information Officer
/sdj

Attachments:
GIS Office Map of Proposed Annexation
Legal Description
Secretary of State Municipal Change Checklist

FILED

OCT 10 2018

**Arkansas
Secretary of State**

H:\City_Annexations\Templates\Folder Structure\Doc\20180720_Jasper_Annexation_Coordination_Letter.docx

ARKANSAS GIS OFFICE · 1 CAPITOL MALL SUITE 6D · LITTLE ROCK · ARKANSAS · 72201

PHONE (501) 682-2767 · www.gis.arkansas.gov · FAX (501) 682-6077

Proposed Annex: City of Jasper
July 2018 TRACT 1

City: Jasper
Mayor: Jan Larson

Arkansas Code 14-40-101

Before an entity undertakes an annexation, consolidation, or detachment, proceeding under this chapter, the entity shall coordinate with the Arkansas Geographic Information Systems Office for preparation of legal descriptions and digital mapping for the relevant annexation, consolidation, and detachment areas.

FIELD
The map contained herein, is in accordance with the requirements of Act 914 of 2014.

OCT 10 2018

Arkansas
Secretary of State

-  Sections
-  Minor Road
-  Proposed Annex
-  Existing City

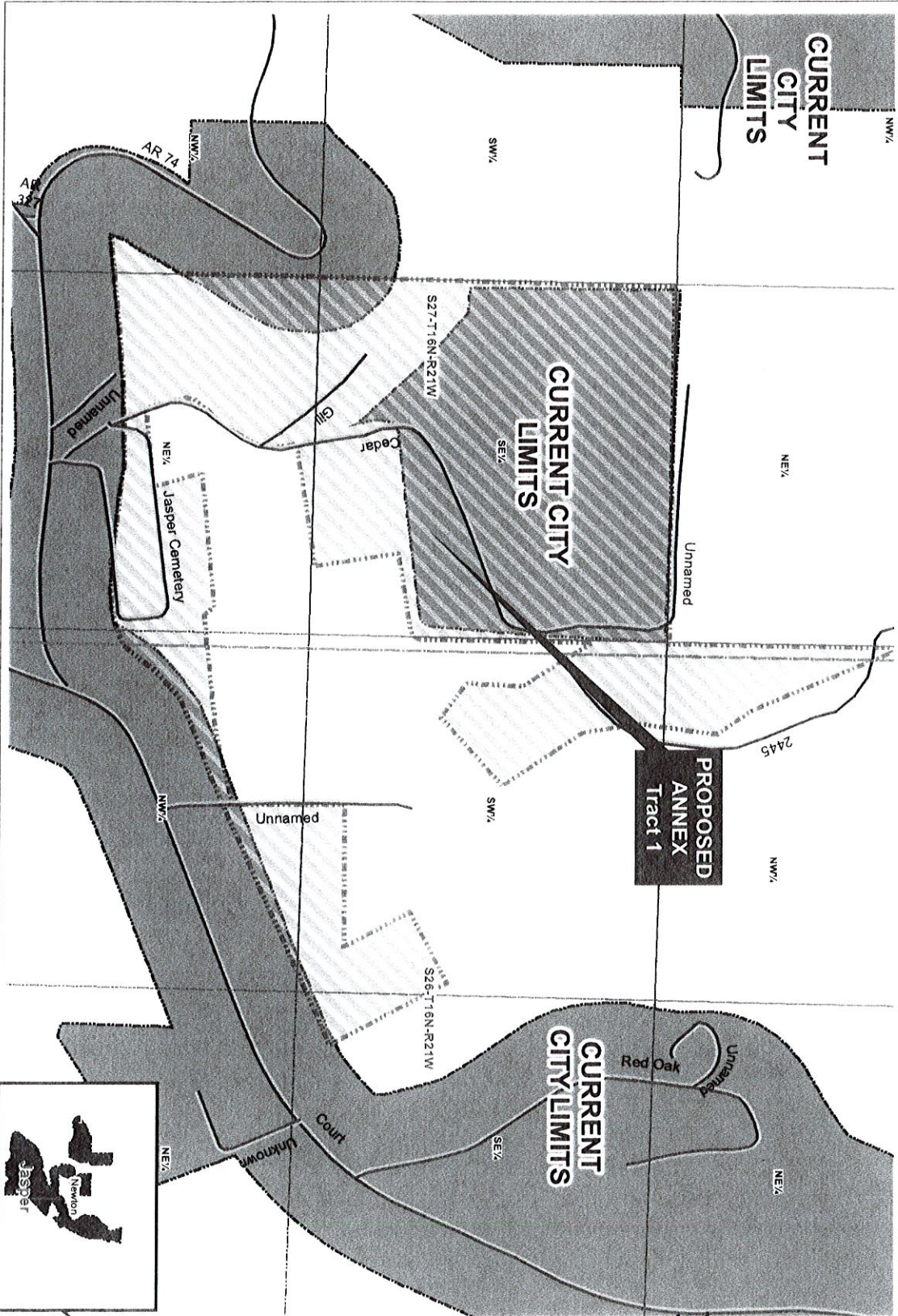

H:\City_Annexations\Cities\Jasper\201807181

Proposed Annex: City of Jasper
July 2018 TRACT 2

City: Jasper
Mayor: Jan Larson

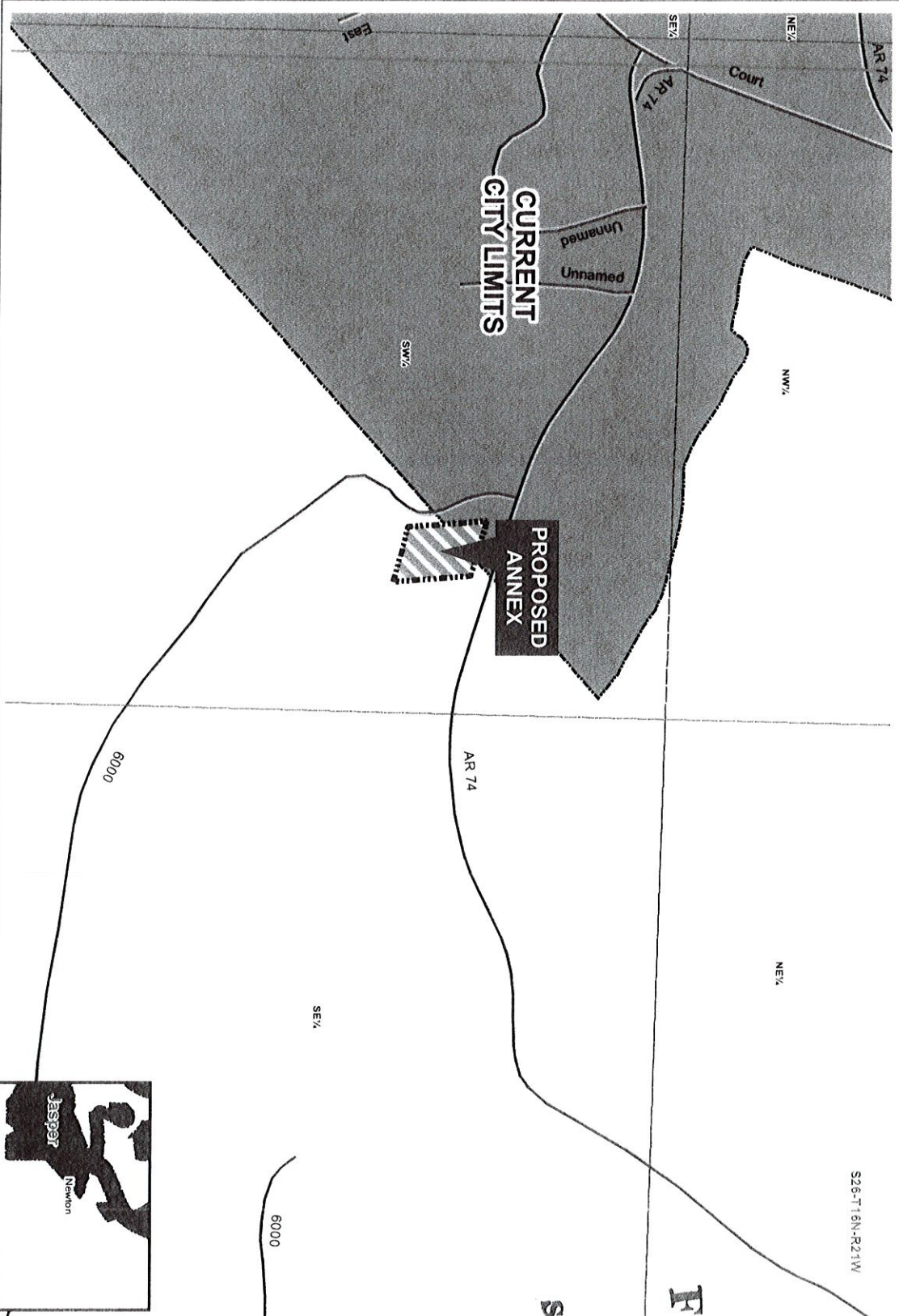

Arkansas Code 14-40-101

Before an entity undertakes an annexation, consolidation, or detachment, proceeding under this chapter, the entity shall coordinate with the Arkansas Geographic Information Systems Office for preparation of legal descriptions and digital mapping for the relevant annexation, consolidation, and detachment areas.

FIELD
The map contains, having no evidence, the entity has met the requirements of Act 1914 of 2015.

OCT 10 2018

Arkansas
Secretary of State

- Sections
- Minor Road
- Proposed Annex
- Existing City



H:\City_Annexations\Cities\Jasper\20180718

FILED
OFFICE OF THE CIRCUIT CLERK
NEWTON COUNTY ARKANSAS

SEP 04 2018

9:00 A.M. _____ P.M.

IN THE COUNTY COURT OF NEWTON COUNTY, ARKANSAS

**IN THE MATTER OF: ANNEXING TO THE
CITY OF JASPER, ARKANSAS CERTAIN
TERRITORY CONTIGUOUS TO SAID CITY
OF JASPER, ARKANSAS**

NO. CC-2018 23

PETITION

WE, as the majority of property owners of the following described area do hereby petition the County Court of Newton County, Arkansas to annex the following lands to the City of Jasper, Arkansas. We further state that the petition is signed by the majority of real estate owners owning the majority of the acreage in said area and do further by our signatures on the petition appoint DAVID FAUGHT to act on behalf of the petitioners in prescribing this matter to the court.

Description of the areas to be annexed to the City of Jasper, Arkansas (Tracts 1 and 2):

FILED

OCT 10 2018

Arkansas
Secretary of State

TRACT 1

A PART OF THE SOUTHEAST QUARTER OF THE NORTHEAST QUARTER AND A PART OF THE NORTHEAST QUARTER OF THE SOUTHEAST QUARTER OF SECTION TWENTY SEVEN (27), A PART OF THE NORTHWEST QUARTER OF THE NORTHWEST QUARTER, PART OF THE SOUTHWEST QUARTER OF THE NORTHWEST QUARTER, A PART OF THE NORTHWEST QUARTER OF THE SOUTHWEST QUARTER AND A PART OF THE SOUTHEAST QUARTER OF THE NORTHWEST QUARTER OF SECTION TWENTY SIX (26), ALL IN TOWNSHIP SIXTEEN (16) NORTH, RANGE TWENTY ONE (21) WEST, NEWTON COUNTY ARKANSAS, DESCRIBD AS FOLLOWS;

FROM THE SOUTHWEST CORNER OF THE SAID SOUTHEAST OF THE NORTHEAST QUARTER, POINT OF BEGINNING OF TRACT BEING DESCRIBED GO ALONG THE WEST LINE NORTH 01°42'52" EAST 1310.60 FEET TO THE NORTHWEST CORNER, THEN GO ALONG THE NORTH LINE SOUTH 89°11'07" EAST 1311.85 FEET TO THE NORTHEAST CORNER, THEN GO ALONG THE WEST LINE OF THE NORTHWEST QUARTER OF THE NORTHWEST QUARTER OF SECTION TWENTY SIX (26) NORTH 01°11'55" EAST 816.69 FEET, THEN LEAVING THE WEST LINE GO NORTH 61°38'47" EAST 18.06 FEET, SOUTH 22°26'51" EAST 547.57 FEET, SOUTH 33°14'01" EAST 164.05 FEET, SOUTH 07°42'56" WEST 185.14 FEET, SOUTH 07°22'40" WEST 94.36 FEET, SOUTH 08°28'54" EAST 218.48 FEET, SOUTH 33°03'31" EAST 357.64 FEET, SOUTH 47°45'55" WEST 340.00 FEET, NORTH 52°33'05" WEST 160.00 FEET, NORTH 03°03'55" EAST 205.00 FEET, NORTH 32°04'51" WEST 301.71 FEET TO THE EAST LINE OF THE SOUTHEAST QUARTER OF THE NORTHEAST QUARTER OF SECTION TWENTY SEVEN (27), THEN GO ALONG THE EAST LINE SOUTH 01°11'31" WEST 640.42 FEET, THEN LEAVING THE EAST LINE GO SOUTH 25°07'09" WEST 21.84 FEET, SOUTH 58°12'16" WEST 27.01 FEET, SOUTH 81°27'36" WEST 284.36 FEET, SOUTH 08°49'24" EAST 310.00 FEET, SOUTH 81°10'41" WEST 457.00 FEET TO THE CENTERLINE OF CEDAR LANE, THEN GO SOUTH ALONG THE CENTERLINE OF CEDAR LANE TO THE NORTH LINE OF THE CITY OF JASPER BY ORDINANCE 1991-33-125, THEN GO ALONG THE NORTH LINE EAST 288.00 FEET TO THE WEST LINE OF THE JASPER CEMETERY, THEN GO ALONG THE BOUNDARY NORTH 13°40'00" WEST 260.25 FEET, THEN GO ALONG THE NORTH LINE NORTH 85°00'00" EAST 505.90 FEET, THEN GO ALONG THE EAST LINE SOUTH 18°39'09" EAST 29.80 FEET TO THE NORTH LINE OF THE JASPER FIRST BAPTIST CHURCH BOUNDARY, THEN GO ALONG THE BOUNDARY NORTH 84°28'48" EAST 424.61 FEET TO THE NORTH LINE OF THE CITY OF JASPER, THEN GO ALONG THE BOUNDARY IN A NORTHEAST DIRECTION 295.39 FEET, THEN GO NORTH 00°14'30" EAST 407.23 FEET, SOUTH 89°45'30" EAST 520.00 FEET TO THE WEST LINE OF THE CARROLL ELECTRIC PROPERTY, THEN GO ALONG THE WEST LINE NORTH 27°54'48" WEST 276.84 FEET TO THE NORTH LINE, THEN GO ALONG THE NORTH LINE NORTH 62°05'10" EAST 298.75 FEET TO THE NORTHEAST CORNER, THEN GO ALONG THE EAST LINE SOUTH 27°54'49" EAST 488.24 FEET TO THE OF THE CITY OF JASPER, THEN GO SOUTH AND WEST ALONG THE NORTH LINE PARALLEL TO HIGHWAYS 7 AND 74 TO THE WEST LINE OF THE NORTHEAST OF THE SOUTHEAST OF SECTION TWENTY SEVEN (27), THEN GO ALONG THE WEST LINE NORTH 01°16'54" EAST TO THE POINT OF BEGINNING OF SAID PROPERTY AND INCLUDES THAT LANDS PREVIOUSLY ANNEXATED BY ORDINANCE 2001-1.

TRACT 2

A PART OF THE SOUTHWEST QUARTER OF THE SOUTHWEST QUARTER OF SECTION TWENTY SIX (26), TOWNSHIP SIXTEEN (16) NORTH, RANGE TWENTY ONE (21) WEST, NEWTON COUNTY ARKANSAS, DESCRIBED AS FOLLOWS;

FROM THE SOUTHEAST CORNER OF THE SAID SOUTHWEST OF THE SOUTHWEST RUN IN A NORTHWESTERLY DIRECTION MEANDERING A DRY BRANCH TO THE SOUTH BOUNDARY OF HIGHWAY 74, THEN GO IN A EASTERLY DIRECTION ALONG THE SOUTH BOUNDARY OF HIGHWAY 74 150.00 FEET TO THE POINT OF BEGINNING OF TRACT BEING DESCRIBED, THEN CONTINUE EAST ALONG SAID RIGHT OF WAY 110.00 FEET, THEN GO SOUTH 150.00 FEET, THEN GO WEST PARALLEL TO THE HIGHWAY 110.00 FEET, THEN GO NORTH 150.00 FEET TO THE POINT OF BEGINNING OF SAID TRACT.

DISCRPTION FROM WARRENTY DEED BOOK 123A, PAGE 585 FILED 12-17-2014.

WHEREFORE, Petitioners respectfully pray that the court ORDER, JUDGE and DECREE that the land described within this petition be annexed to and made a part of the City of Jasper, Arkansas.



Signature of Property Owner

511 E. Court St, Jasper, AR 72641
Address

Signature of Property Owner

Address

Signature of Property Owner

Address

Signature of Property Owner

Address

Signature of Property Owner

Address



Signature of Attesting Witness

Signature of Attesting Witness

Signature of Attesting Witness

Signature of Attesting Witness

Signature of Attesting Witness

CARROLL ELECTRIC COOPERATIVE CORPORATION
Box 4000
Berryville, Arkansas

Excerpts from Minutes of a Regular Meeting
of Board of Directors held August 23, 2018

Arkansas 18 Carroll

Vice President Monty Williams and President Boaz presented a request from the City of Jasper, Ark., to voluntarily annex all of Carroll Electric Cooperative's Jasper office property into the city limits. Presently, a portion of the existing property is outside city limits but contiguous to the present city limits. Upon motion and second, the board unanimously passed the following resolution:

WHEREAS, property owned by Carroll Electric Cooperative Corporation on which the Jasper district office is presently constructed is partially outside the city limits of Jasper, Ark., and

WHEREAS, it is the desire of the board of directors to make whole the Cooperative's property to fully reside within city limits;

BE IT THEREFORE NOW RESOLVED That the board of directors of Carroll Electric Cooperative Corporation desire to voluntarily annex all of its property presently contiguous to the city limits of Jasper, Ark., and the officers of the Corporation are directed to execute, deliver, and accept any and all documents to accomplish this annexation.

CERTIFICATION

I, Winfred Prier, do hereby certify that I am the duly elected, qualified and acting Secretary of the Carroll Electric Cooperative Corporation, and the present keeper of the records; that the foregoing is a true and correct copy of a resolution duly adopted at a meeting of the directors duly convened and held at Jasper, Arkansas, August 23, 2018, at which meeting a quorum of directors was present and acted throughout, that said resolution remains in full force and effect and has not been rescinded.

Witness my hand and seal on this 23rd day of August 2018.

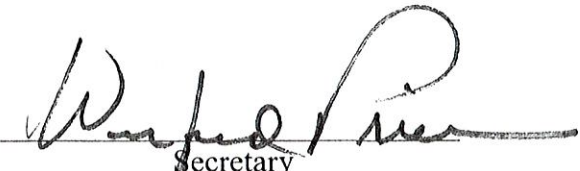
Secretary

WHEREFORE, Petitioners respectfully pray that the court ORDER, JUDGE and DECREE that the land described within this petition be annexed to and made a part of the City of Jasper, Arkansas.

First National Bank of North Arkansas

by Tony Co., President

Signature of Property Owner



Signature of Attesting Witness

Po Box 367 Berryville AR 72616

Address

Signature of Property Owner

Signature of Attesting Witness

Address

Signature of Property Owner

Signature of Attesting Witness

Address

Signature of Property Owner

Signature of Attesting Witness

Address

Signature of Property Owner

Signature of Attesting Witness

Address

Signature of Property Owner

Signature of Attesting Witness

Address

Bobby Hantsch

Signature of Property Owner

P.O. Box 278 Jasper AR 72641

Address

Janice H.

Signature of Attesting Witness

Samuel

Signature of Property Owner

311 Cedar Lane Estates

Address

Lindsey Graham

Signature of Attesting Witness

Betty Payne

Signature of Property Owner

102 Hwy 74 West

Address Jasper AR 72641

Lindsey Graham

Signature of Attesting Witness

E. W. Campbell

Signature of Property Owner

207 Cedar Ln.

Address

Jim R.

Signature of Attesting Witness

Freda Campbell

Signature of Property Owner

207 Cedar Lane

Address

Jim R.

Signature of Attesting Witness

David Trapp

Signature of Property Owner

401e HWY 7 North

Address

Jim R.

Signature of Attesting Witness

Furrow

Signature of Property Owner

Box 186

Address

Jasper, AR 72641

Tanet Clark

Signature of Attesting Witness

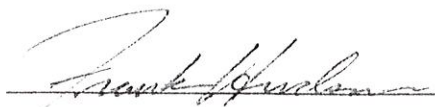

Signature of Property Owner



Signature of Attesting Witness

Address: 308 CEDAR LANE JASPER, AR 72641

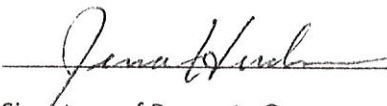

Signature of Property Owner

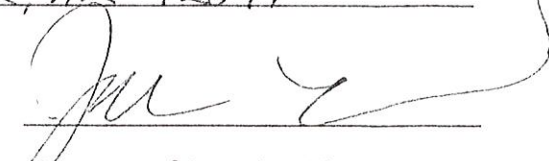

Signature of Attesting Witness

Address: 308 CEDAR LANE JASPER, AR 72641

Signature of Property Owner

Signature of Attesting Witness

Address: _____

Signature of Property Owner

Signature of Attesting Witness

Address: _____

Signature of Property Owner

Signature of Attesting Witness

Address: _____

Signature of Property Owner

Signature of Attesting Witness

Address: _____

Signature of Property Owner

Signature of Attesting Witness

Address: _____

IN THE COUNTY COURT OF NEWTON COUNTY, ARKANSAS

IN THE MATTER OF: ANNEXING TO THE
CITY OF JASPER, ARKANSAS CERTAIN TERRITORY
CONTIGUOUS TO SAID CITY OF JASPER, ARKANSAS

NO. CC-2018-03

ORDER

On this the 4th day of September, 2018 is filed the petition of real estate owners desiring the annexation of territory to the City of Jasper, Arkansas, more particularly described therein, and this Court does hereby fix the 4th day of Sept. 2018, as the date for hearing on said petition, and, the agent named by said petitioners, shall give notice of such hearing as provided by law, said hearing to be held in the office of the County Judge at 10:00 a.m.

Warren Campbell

Warren Campbell, Newton County Judge

FILED
OFFICE OF THE CIRCUIT CLERK
NEWTON COUNTY ARKANSAS

SEP 06 2018

8.00 A.M. _____ P.M.
BOOK X PAGE 637
DONNIE DAVIS

City of Jasper
Ord # 2018-5

Certificate of Publication

STATE OF ARKANSAS

SS

COUNTY OF NEWTON

I, Carol Lawson upon oath state that I am Business Manager of THE NEWTON COUNTY TIMES, a weekly newspaper published at Jasper, Newton County, Arkansas, and that said newspaper has a bona fide

circulation in said county, that the annexed advertisement was inserted, and published, in said newspaper for 17 consecutive weeks, as follows: 1st insertion

ORDINANCE NO. 2018-5
AN ORDINANCE ACCEPTING
THE ANNEXATION OF
CERTAIN TERRITORY TO
THE CITY OF JASPER,
ARKANSAS, AND MAKING
SAME A PART OF THE CITY
OF JASPER, ARKANSAS
AND ASSIGNING SAME
TO WARDS.

on the 26 day of Sept, 2018

2nd on the ___ day of _____ 20__

3rd on the ___ day of _____ 20__

4th on the ___ day of _____ 20__

5th on the ___ day of _____ 20__

6th on the ___ day of _____ 20__

WHEREAS, a petition was filed with the County Clerk of Newton County, Arkansas, by the majority of the real estate owners of the hereinafter described territory praying that said territory be annexed to, and made a part of the City of Jasper, Arkansas; and,

Carol Lawson
Business Manager

WHEREAS, on September 10, 2018, the County Court of Newton County, Arkansas, found that the petition was signed by a majority of the real estate owners in said territory; that said territory was contiguous and adjoining the present corporate limits of the City of Jasper, Arkansas; that an accurate plat or map of said territory had been filed with and made a part of said petition; that proper

Subscribed and sworn to before me this ___ day of _____, 20__

M Anderson

FEE \$ 294.75

notice had been given for the time and in the manner prescribed by law, and that all things pertaining thereto had been done in the manner prescribed by law, and that said lands and territory should be annexed to and made a part of the City of Jasper, Arkansas, subject to the acceptance of same by the



Newton County Clerk

Annexing To City of Jasper
Certificate of Publication

STATE OF ARKANSAS

SS

COUNTY OF NEWTON

I, Carol Lawson upon oath state that I am Business Manager of THE NEWTON COUNTY TIMES, a weekly newspaper published at Jasper, Newton County, Arkansas, and that said newspaper has a bona fide circulation in said county, that the annexed advertisement was inserted, and published, in said newspaper for 37 consecutive weeks, as follows: 1st insertion

IN THE COUNTY COURT OF
NEWTON COUNTY,
ARKANSAS
IN THE MATER OF:
ANNEXING TO THE CITY OF
JASPER, ARKANSAS
CERTAIN TERRITORY
CONTIGUOUS TO SAID CITY
OF JASPER, ARKANSAS
NO. CC-2018-02

ORDER
On this the 6th day of August, 2018 is filed the petition of real estate owners desiring the annexation of territory to the City of Jasper, Arkansas, more particularly described therein, and this Court does hereby fix the 4th day of September, 2018 as the date for hearing on said petition, and, the agent named by said petitioners, shall give notice of such hearing as provided by law, said hearing to be held in the office of the County Judge at 10:00 a.m.
Warren Campbell
County Judge
(SEAL)
1st. Pub. 8/08/18, 3t.

on the 8 day of August 2018

2nd on the 15 day of August 2018

3rd on the 22 day of August 2018

4th on the ___ day of _____ 20__

5th on the ___ day of _____ 20__

6th on the ___ day of _____ 20__

Carol Lawson
Business Manager

Subscribed and sworn to before me this ___ day of _____, 20__

M. Anderson
FEE 92.25

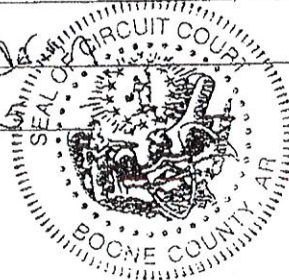

IN THE COUNTY COURT OF
NEWTON COUNTY,
ARKANSAS
IN THE MATER OF:
ANNEXING TO THE CITY OF
JASPER, ARKANSAS
CERTAIN TERRITORY
CONTIGUOUS TO SAID CITY
OF JASPER, ARKANSAS
NO. CC-2018-02
ORDER

On this the 6th day of August,
2018 is filed the petition of real
estate owners desiring the
annexation of territory to the
City of Jasper, Arkansas, more
particularly described therein,
and this Court does hereby fix
the 4th day of September, 2018
as the date for hearing on said
petition, and, the agent named
by said petitioners, shall give
notice of such hearing as
provided by law, said hearing to
be held in the office of the
County Judge at 10:00 a.m.
Warren Campbell
County Judge
(SEAL)
1st. Pub. 8/08/18, 3t.

Acc.Id: 26790
Name: NEWTON COUNTY CLERK
Phone: 870-446-5125
Address: PO BOX 410
City: JASPER
State: AR
Postcode: 72641
Class: 0050 Legal-Newton
County
Edition: NCT NCT NCT
Start: 08/08/2018
Stop: 08/22/2018
Issues: 3
Units 123.00
Order ID: CC 91356
TFN: C
TFN cycle:
Rep: DEBBIEAM
Status: OK
Source: EM
Paytype: BI
Rate: PP
Cost EXC 92.25
GST:
Tax: 0.00
Total Charge: 92.25
Printed on: 09/21/2018 10:01:04
Printed by: DEBBIEAM