



ARKANSAS SECRETARY OF STATE
—
MARK MARTIN

January 17, 2017

The Honorable Kade Holliday
Craighead County Clerk
P.O. Box 1167
Jonesboro, AR 72403-1167

Re: City of Jonesboro Annexation Ordinance ORD-16:057

Dear Mr. Holliday,

This letter acknowledges receipt and filing of the following notice of municipal boundary change by the Office of the Secretary of State:

Filing Type: Annexation by petition pursuant to A.C.A § 14-40-609 (petition by 100% of the landowners)
Effective Date: 10/07/2016 (emergency declared)
County: Craighead City: Jonesboro
City Ordinance: ORD-16:57 Dated: 10/07/2016
County Court Order: Filed: 05/22/1989

A file marked copy of the court order submitted to our Office is enclosed. By copy of this letter (and its enclosure), the Secretary of State hereby notifies the appropriate mapping authorities for Arkansas. Please retain these copies as official record of the filing of the municipal boundary change by the Arkansas Secretary of State.

If you have any questions or concerns regarding this filing please contact our office at 501-682-3401.

Sincerely,

A handwritten signature in blue ink that reads "Cynthia Fisher".

Cynthia Fisher
Arkansas Secretary of State Legal Division
500 Woodlane St
Little Rock, AR 72201
501-682-3401

cc: Arkansas Geographic Information Systems Office (w/ encl)
Arkansas Highway and Transportation Department Mapping Department (w/ encl)
UALR Institution for Economic Advancement (w/encl)
Tom-Tom (w/encl)
Ms. Donna Jackson, Jonesboro City Clerk (w/encl)





Arkansas Secretary of State

Mark Martin Arkansas Secretary of State, 500 Woodlane Ave, Little Rock, AR 72201-1094

Municipal Boundary Change Checklist

County: Craighead City/Town: Jonesboro

City Ordinance/Resolution No: ORD-16:057 Date approved: 10/07/2016

County Court Case No: _____ Date Order Filed: 05/22/1989

Type: Annexation by Petition of all Landowners A.C.A §14-40-609

Date Change Effective: 10/07/2016 Emergency clause: Yes No

For Circuit Court Challenge: Date Filed: _____ Upheld Overturned Other (attach explanation)

Initiating party:

All Landowners Majority Landowners Municipal Governing Body State Other _____

Supporting Documentation attached (check all that apply):

- File marked copy of City Ordinance/Resolution (not required for A.C.A §14-40-1801)
- File marked copy of County Court Order (not required for A.C.A. §14-40-501)
- Proof of Publication for all Legal Notices (Hearing, Election, City Ordinance/Resolution)
- Copy of Arkansas GIS approved printed map and certification letter
- File marked copy of Petition Part or File marked copy of the certified special election results (if applicable)
- File marked copy of Complaint and final Circuit Court Order (Court Challenge only)

Municipal Contact:

Name: Ms. Donna Jackson Title: Jonesboro City Clerk

Street Address: P.O. Box 1845

City: Jonesboro St: AR Zip code: 72403

City/County Official:

Signature: Hon. Kade Holliday Title: Craighead County Clerk

Date: _____

Complete one form for each ordinance/resolution and attach it as a cover page to the supporting document set. Submit the documents to Arkansas Secretary of State, Atten: Municipal Boundary Filing, 500 Woodlane Ave, Little Rock, AR 72201-1094

Office of the Arkansas Secretary of State use only

Received by: Cynthia Fisher

FILED

JAN 17 2017

Arkansas
Secretary of State

FILED

OCT 07 2016

City of Jonesboro

KADE HOLLIDAY
COUNTY & PROBATE COURT CLERK
300 S. Church Street
Jonesboro, AR 72401



Signature Copy

Ordinance: O-EN-051-2016

File Number: ORD-16:057

Enactment Number: O-EN-051-2016

AN ORDINANCE REPEALING A CERTAIN ORDINANCE ACCEPTING LANDS ANNEXED TO THE CITY OF JONESBORO, ARKANSAS, BY ORDER OF THE COUNTY COURT OF CRAIGHEAD COUNTY, ARKANSAS; ASSIGNING SAID ANNEXED TERRITORIES TO WARD 2; DECLARING THE ZONING FOR THE ANNEXED TRACT; DECLARING AN EMERGENCY; AND FOR OTHER PURPOSES

WHEREAS, a petition for the annexation of a particular tract to the City of Jonesboro, Arkansas, hereinafter described, was duly filed in the County Court of Craighead County, Arkansas, on April 18, 1989; and

WHEREAS, said petition for annexation for these lands was duly signed by all of the owners of the tracts to be annexed to the City of Jonesboro, Arkansas; and

WHEREAS, an order setting a hearing upon said petition was entered, notice was duly published of said hearing and a hearing upon said petition was duly had and held in the County Court of Craighead County, Arkansas, on May 22, 1989, at which hearing it was duly found and declared that said petition for annexation was right and proper and that such lands hereinafter described should be annexed to the City of Jonesboro, Arkansas, whereupon an order of annexation was made and entered; and

NOW, THEREFORE, BE IT ORDAINED AND ENACTED by the City Council of the City of Jonesboro, Arkansas:

SECTION 1: All of the territory and lands annexed to the City of Jonesboro by order of the County Court of Craighead County, Arkansas, by its order of June 28, 1989, and by Ordinance 2242 be and they are hereby repealed.

SECTION 2: The portion of lands and territory previously annexed to and accepted by the city of Jonesboro, Arkansas and affected by the repeal of Ordinance 2242 are more particularly described as follows:

The NW - 1/4 of the SE - 1/4 and the SW - 1/4 of the SE - 1/4 and a part of the NE - 1/4 of the SW - 1/4 of Section 36, Township 15 North, Range 3 East, being more particularly described as follows: Begin at the NE Corner of the NE - 1/4 of the SW - 1/4 of said Section 36; thence South 0°23'36" West on the 40 acre line 891.19 feet to the Easterly right-of-way line of Duncan Road; thence with the meanderings of said right-of-way line as follows: North 4°27'07" West 110.75 feet; North 16°41'30" West 139.68 feet; North 32°24'11" West 229.25 feet; North 53°02'48" West 190.51 feet; North 44°14'100" East 472.96 feet to the point of beginning, containing in aggregate 82.54 acres, more or less, subject to all rights-of-way and easements of record.

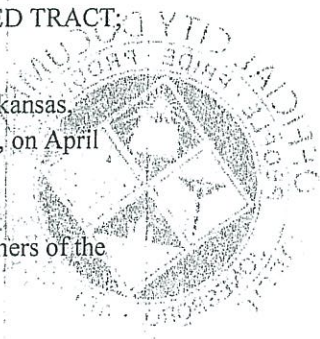

FILED

JAN 17 2017

Arkansas
Secretary of State

SECTION 3: It is hereby found and declared by the City Council of the City of Jonesboro, Arkansas, that there is now an extreme urgency that Ordinance 2242 be repealed by the City of Jonesboro, Arkansas, in order to allow orderly growth and development of said lands and territory. Therefore, an emergency is declared to exist and this ordinance being necessary for the preservation of the public peace, health and safety, it shall take effect and be in full force from and after its passage.

PASSED AND APPROVED on this 4th of October, 2016.

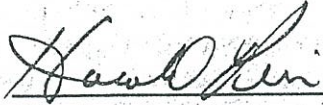

Harold Perrin, Mayor

Date 10-7-16





Donna Jackson, City Clerk

Date 10/7/16



DONNA K. JACKSON
CITY CLERK

December 27, 2016

Cynthia Cole Fisher
Special Projects Manager
Arkansas Secretary of State
500 Woodland St, Suite 256
Little Rock, AR 72201-1094

RECEIVED

JAN 04 2017

**Arkansas
Secretary of State**

Re: Annexation Ordinances/Resolutions Needed

Dear Ms. Fisher:

In our audit of ordinances/resolutions regarding annexations since 2000, for the City of Jonesboro, we have discovered three (3) additional legislative documents not part of the Craighead County Clerk's findings. They are: Ord. No. 3210 – adopted in 2000. Ord. No. 08:045 adopted in 2008, and a de-annexation, Ord. No. 16:057 adopted in 2016. Please note the file stamp of each of the documents by the Craighead County Clerk's Office as required by State Statute.

In the future, I hope you will feel free to contact me if questions arise regarding annexations and de-annexations.

Sincerely,

Donna K. Jackson
Jonesboro City Clerk

Enclosures

Executive Office
City Hall
P.O. Box 1845
300 S. Church
Jonesboro, AR 72403

Phone: 870-935-0305
Fax: 870-933-4637

Email: djackson@jonesboro.org



ARKANSAS
GIS OFFICE

January 12, 2017

Mrs. Cynthia Fisher
Special Projects Manager
AR Secretary of State Legal Division

RE: City of Jonesboro Annexation Coordination Requirement

Mrs. Fisher,

Thank you for coordinating with our office as you seek to annex property into the City of Jonesboro, AR – Ordinance O-EN-051-2016 . This letter represents confirmation that you have properly coordinated with our office (Arkansas GIS Office) as specified in § 14-40-101 (Act 914 of 2015) of the 90th General Assembly.

Our office will wait completion of any additional steps necessary for the proposed boundary change, which normally comes from the Arkansas Secretary of State Elections Division after any appropriate filing by your County Clerk.

Thank you,

Richie Pierce, Sr. GIS Analyst
/rp

Attachments:
GIS Office Map of Proposed Annexation
Secretary of State Municipal Change Checklist

FILED

JAN 17 2017

Arkansas
Secretary of State

Proposed Annex: City of Jonesboro
January 2017

City: Jonesboro
Mayor: Harold Perrin

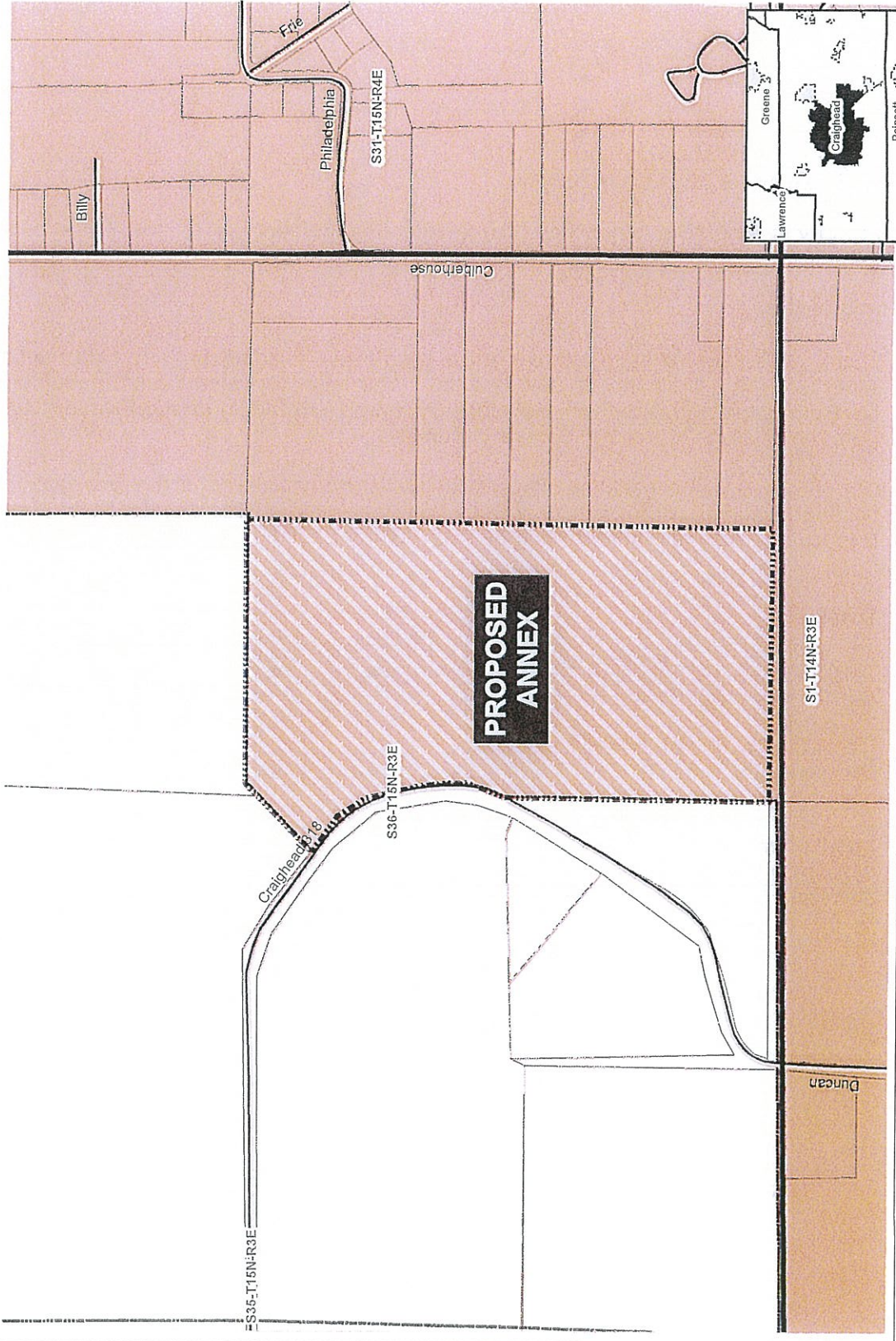

Arkansas Code 14-40-101.
Before an entity undertakes an annexation, consolidation, or detachment proceeding under this chapter, the entity shall coordinate with the Arkansas Geographic Information Systems Office for preparation of legal descriptions and digital mapping for the relevant annexation, consolidation, and detachment areas.
The map contained herein, is evidence, the entity has met requirements of Act 974 of 2015

- Proposed Annex
- Township-Range
- Sections
- Parcels
- Highway
- Minor Road
- Existing City
- Neighboring City
- County Boundary

E I L E D

JAN 17 2017

Arkansas
Secretary of State

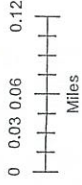

ARKANSAS
GIS OFFICE
Jonesboro-2017012