



ARKANSAS SECRETARY OF STATE  

---

**MARK MARTIN**

February 7, 2017

The Honorable Kade Holliday  
Craighead County Clerk  
P.O. Box 1167  
Jonesboro, AR 72403-1167

Re: City of Lake City Annexation Ordinance 286-16

Dear Mr. Holliday,

This letter acknowledges receipt and filing of the following notice of municipal boundary change by the Office of the Secretary of State:

Filing Type: Annexation by petition pursuant to A.C.A § 14-40-609 (petition by 100% of the landowners)

Effective Date: unknown

County: Craighead

City: Lake City

City Ordinance: 286-16

Dated: 01/17/2017

County Court Order: unknown

A file marked copy of the ordinance and exhibits submitted to our Office are enclosed. By copy of this letter (and its enclosures), the Secretary of State hereby notifies the appropriate mapping authorities for Arkansas. Please retain these copies as official record of the filing of the municipal boundary change by the Arkansas Secretary of State.

If you have any questions or concerns regarding this filing please contact our office at 501-682-3401.

Sincerely,

A handwritten signature in cursive script that reads "Cynthia Fisher".

Cynthia Fisher  
Arkansas Secretary of State Legal Division  
500 Woodlane St, Room 256  
Little Rock, AR 72201  
501-682-3401

cc: Arkansas Geographic Information Systems Office (w/ encl)  
Arkansas Highway and Transportation Department Mapping Department (w/ encl)  
UALR Institution for Economic Advancement (w/encl)  
Tom-Tom (w/encl)  
Ms. Linda Simpson, Lake City Clerk/Treasurer (w/encl)





# Arkansas Secretary of State

**Mark Martin** Arkansas Secretary of State, 500 Woodlane Ave, Little Rock, AR 72201-1094

## Municipal Boundary Change Checklist

County: Craighead City/Town: Lake City

City Ordinance/Resolution No: 286-16 Date approved: 01/17/2017

County Court Case No: unknown Date Order Filed: \_\_\_\_\_

Type: Annexation by Petition of all Landowners A.C.A §14-40-609

Date Change Effective: \_\_\_\_\_ Emergency clause:  Yes  No

For Circuit Court Challenge: Date Order Filed: \_\_\_\_\_  Upheld  Overturned  Other (attach explanation)

### Initiating party:

All Landowners  Majority Landowners  Municipal Governing Body  State  Other \_\_\_\_\_

### Supporting Documentation attached (check all that apply):

- File marked copy of City Ordinance/Resolution (not required for A.C.A §14-40-1801)
- File marked copy of County Court Order (not required for A.C.A. §14-40-501)
- Proof of Publication for all Legal Notices (Hearing, Election, City Ordinance/Resolution)
- Copy of Arkansas GIS approved printed map and certification letter
- File marked copy of Petition Part or File marked copy of the certified special election results (if applicable)
- File marked copy of Complaint and final Circuit Court Order (Court Challenge only)

### Municipal Contact:

Name: Ms. Linda Simpson Title: Lake City Clerk and Treasurer

Street Address: P.O. Box 660

City: Lake City St: AR Zip code: 72437

### City/County Official:

Signature: Hon. Kade Holliday Title: Craighead County Clerk

Date: \_\_\_\_\_

Complete one form for each ordinance/resolution and attach it as a cover page to the supporting document set. Submit the documents to Arkansas Secretary of State, Atten: Municipal Boundary Filing, 500 Woodlane Ave, Little Rock, AR 72201-1094

Office of the Arkansas Secretary of State use only

Received by: Cynthia Fisher

**FILED**

FEB 07 2017

Arkansas  
Secretary of State



JON MILLIGAN  
MAYOR

P.O. Box 660 LAKE CITY, ARKANSAS 72437

870-237-4431  
FAX 870-237-4015

LINDA SIMPSON  
CLERK/TREASURER

**RECEIVED**

JAN 26 2017

**Arkansas  
Secretary of State**

January 23, 2017

Cynthia Cole Fisher  
Special Projects Manager  
Arkansas Secretary of State  
500 Woodlane St Ste 256  
Little Rock AR 72201-1094

Dear Ms. Fisher:

In response to your letter I am sending you a copy of Ordinance No. 286-16 of the recently approved lands to be annexed to the city limits of Lake City. At this time we do not have a copy of the map or plat or the area. The Mayor has contacted the Engineer and asked for a plat of said land. When it becomes available we will gladly forward to you.

If I can be of any further assistance please feel free to contact me at the numbers above.

Sincerely,

A handwritten signature in cursive script that reads "Linda Simpson".

Linda Simpson

City Clerk/Treasurer



ORDINANCE NO. 286-16

**AN ORDINANCE APPROVING ANNEXATION OF CERTAIN CONTIGUOUS  
LANDS TO THE CITY LIMITS OF THE CITY OF LAKE CITY ARKANSAS**

WHEREAS, it has come to the attention of the City Council that certain property owners have filed a request to annex their property to the city limits of Lake City;

WHEREAS, the annexation is consistent with the growth in population in the city and the annexation has been approved by the Craighead County Judge's office, the County Clerk and County Assessor's office:

WHEREAS, the annexation petition conforms with the requirements of A.C.A. 14-40-609 in all respects;

WHEREAS, the property to be annexed is described as follows:

*ALL OF LOTS 1 AND 3 OF THE UNITED STATES GOVERNMENT SUPPLEMENTAL SURVEY OF SECTION 28, TOWNSHIP 14 NORTH, RANGE 6 EAST, THAT IS SITUATED IN THE SOUTH HALF OF THE NORTHWEST QUARTER OF SAID SECTION 28 AND LYING EAST OF PURCELL SLOUGH, AND ALL THAT PART OF THE SOUTH HALF OF THE NORTHWEST QUARTER OF SECTION 28, TOWNSHIP 14 NORTH, RANGE 06 EAST, LYING EAST OF PURCELL SLOUGH, CRAIGHEAD COUNTY, ARKANSAS, CONTAINING APPROXIMATELY 57 ACRES.*

WHEREAS, acceptance of the property proposed to be annexed is in the best interest of the City of Lake City and should be approved;

THEREFORE, BE IT ORDAINED: That the City of Lake City approves the proposed annexation of the above described property to the jurisdiction of the City and that the property shall be subject to all rules, regulations and laws as the present City Limits from and after the passage of this Ordinance.

PASSED AND ADOPTED this 17<sup>th</sup> day of January, 2018.

Read 11/21/16  
Read 12/12/16  
Read 1/16/17

APPROVED: Jon Milligan  
Jon Milligan, Mayor

ATTEST: Linda Simpson  
Linda Simpson, City Clerk

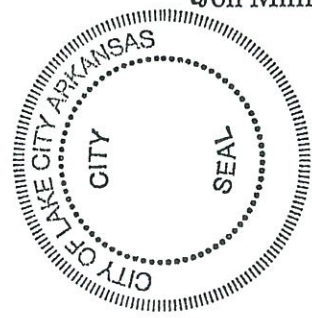

**FILED**  
FEB 07 2017  
Arkansas  
Secretary of State



ARKANSAS  
GIS OFFICE

---

February 6, 2017

Mrs. Linda Simpson  
City Clerk/Treasurer  
P.O. Box 660  
Lake City, AR 72437

RE: City of Lake City Annexation Coordination Requirement

Mrs. Simpson,

Thank you for coordinating with our office as you seek to annex property into the City of Lake City, AR ordinance number 286-16. This letter represents confirmation that you have properly coordinated with our office (Arkansas GIS Office) as specified in § 14-40-101 (Act 914 of 2015) of the 90<sup>th</sup> General Assembly.

Our office will wait completion of any additional steps necessary for the proposed boundary change, which normally comes from the Arkansas Secretary of State Elections Division after any appropriate filing by your County Clerk.

Thank you,

Richie Pierce, Sr. GIS Analyst  
/rp

Attachments:  
GIS Office Map of Proposed Annexation  
Secretary of State Municipal Change Checklist



Proposed Annex: City of Lake City  
February 2017

City: Lake City  
Mayor: Jon Milligan

Arkansas Code 14-40-101.

Before an entity undertakes an annexation, consolidation, or detachment proceeding under this chapter, the entity shall coordinate with the Arkansas Geographic Information Systems Office for preparation of legal descriptions and digital mapping for the relevant annexation, consolidation, and detachment areas.

The map contained herein, in evidence, the entity has met requirements of Act 914 of 2015.

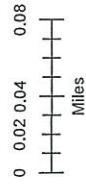
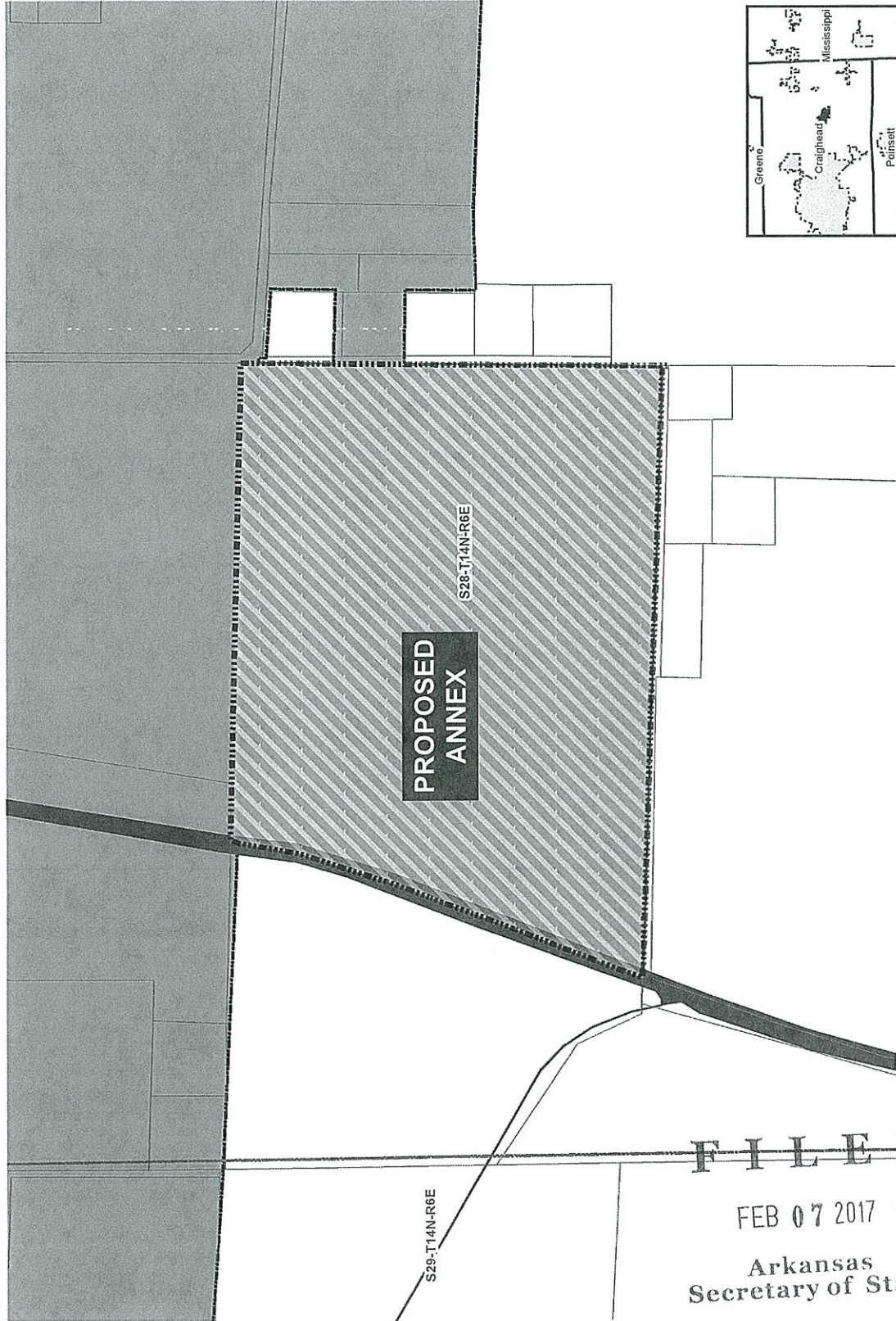
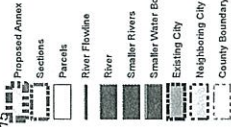

ARKANSAS  
GIS OFFICE  
Lake\_City-20170206

