



ARKANSAS SECRETARY OF STATE

MARK MARTIN

December 29, 2017

The Honorable Debbie Loggins
Searcy County & Circuit Clerk
P.O. Box 884
Marshall, AR 72650

Re: City of Leslie Annexation Ordinance 236

Dear Ms. Loggins,

This letter acknowledges receipt and filing of the following notice of municipal boundary change by the Office of the Arkansas Secretary of State:

Filing Type: Annexation pursuant to A.C.A § 14-40-609 (petition by 100% of the land owners)

Effective Date: 12/6/2017

County: Searcy

City: Leslie

City Ordinance: 236

Dated: 11/06/2017

County Court Order: 65CO-17-1

Date Filed: 10/11/2017 Hon. Jim Harness, Searcy County Judge

A file marked copy of the ordinance, Court Order, and exhibits submitted to our Office are enclosed. By copy of this letter (and its enclosures), the Secretary of State hereby notifies the appropriate mapping authorities for Arkansas. Please retain these copies as official record of the filing of the municipal boundary change by the Arkansas Secretary of State.

If you have any questions or concerns regarding this pending filing, please contact our office at 501-682-3401.

Sincerely,

A handwritten signature in cursive script that reads "Cynthia Fisher".

Cynthia Fisher
Special Projects Manager
Arkansas Secretary of State Legal Division
500 Woodlane St, Suite 256
Little Rock, AR 72201
501-682-3401

cc: Arkansas Geographic Information Systems Office (w/ encl)
Arkansas Highway and Transportation Department Mapping Department (w/ encl)
Department of Finance and Administration (w/encl)
Arkansas Public Service Commission (w.encl)
UALR Institution for Economic Advancement (w/encl)
Tom-Tom (w/encl)
Hon. Tabitha Hardin, Mayor of Leslie (w/encl)





Arkansas Secretary of State

Mark Martin Arkansas Secretary of State, 500 Woodlane Ave, Little Rock, AR 72201-1094

Municipal Boundary Change Checklist

County: Searcy City/Town: Leslie

City Ordinance/Resolution No: 236 Date approved: 11/6/17

County Court Case No: 65CO-17-1 Date Order Filed: 10/11/17

Type: A.C.A. 14-40-609
(Choose from the list of Arkansas Code Sections located on the back)

Date Change Effective: 12/6/17 Set by: Municipal Ordinance Emergency Clause Court Default
(Required by Act 655 of 2017)

For Circuit Court Challenge: Date Order Filed: _____ Upheld Overturned Other (attach explanation)

Initiating party:

All Landowners Majority Landowners Municipal Governing Body State Other _____

Supporting Documentation attached (check all that apply):

- File marked copy of City Ordinance/Resolution (required)
- File marked copy of County Court Order (required except for island annexation and annexation approved by election)
- Copy of Arkansas GIS approved printed map and certification letter (required)
- Proof of Publication for all Legal Notices (include Hearing, Election, and City Ordinance/Resolution notices)
- File marked copy of Petition Part or File marked copy of the certified special election results (if applicable)
- File marked copy of Complaint and final Circuit Court Order (Court Challenge only)

N/A
N/A
N/A

Municipal Contact:

Name: Talitha Hardin Title: Mayor

Street Address: Main St.

City: Leslie St: AR Zip code: 72645

Complete one form per ordinance/resolution, attach it as a cover page to the supporting document set and submit to the County Clerk's Office within 45 days of the Effective Date as required by Act 655 of 2017

County Official:

Signature: Debbie Loggins Title: County Circuit Clerk

Date: 11/09/2017

Pursuant to Act 655 of 2017, County Officials must submit a file-marked copy of municipal boundary change documents within 30 days of receipt to: Arkansas Secretary of State, Attn: Municipal Boundary Filing, 500 Woodlane Ave Suite 256, Little Rock, AR 72201-1094

Office of the Arkansas Secretary of State use only

Received by: Cynthia Fisher

FILED
DEC 29 2017
Arkansas
Secretary of State

ORDINANCE # 236



AN ORDINANCE ACCEPTING THE ANNEXATION OF CERTAIN TERRITORY TO THE CITY OF LESLIE; APPROVING THE SCHEDULE OF SERVICES TO BE EXTENDED TO SAID AREA; AND ASSIGNING SUCH TO WARDS

WHEREAS, a petition was filed, pursuant to Arkansas Code Annotated section 14-40-609, for the annexation of certain territory into the City of Leslie, Arkansas; and

WHEREAS, the Searcy County Assessor and the Searcy County Clerk have

- A. Verified the identity of the petitioners;
- B. Verified that there are no property owners included in the petition that do not wish to have their property annexed;
- C. Verified that the property or properties are contiguous with the City of Leslie;
- D. Verified that no enclaves will be created if the petition is accepted by the City of Leslie; and presented the petition and their respective verifications to the Searcy County Judge; and

WHEREAS, the County Judge has

- A. Reviewed the petition and verifications for completeness and accuracy;
- B. Determined that no enclaves will be created by the annexation;
- C. Confirmed that the petition contains a schedule of services;
- D. Found that the land to be annexed furnish the abode for a densely settled community or represent the actual growth of the municipality beyond its legal boundary and are valuable by reason of their adaptability for prospective municipal uses;
- E. Issued an order articulating these findings and forwarded the petition and order to the contiguous City of Leslie for consideration; and

WHEREAS, it is the desire of the City Council of Leslie that said territory be annexed.

NOW, THEREFORE, BE IT ORDAINED BY THE CITY COUNCIL OF THE CITY OF LESLIE, ARKANSAS:

SECTION 1. That the following described territory, contiguous to the City of Leslie, be and the same is hereby accepted as part of the City of Leslie, Arkansas:

Please see attached map and description from the Arkansas Geographic Information Systems Office.

FILED

DEC 29 2017

**Arkansas
Secretary of State**

Proposed Annex: City of Leslie
October 2017

City: Leslie
Mayor: Talitha Hardin

Arkansas Code 14-40-101.
Before an entity undertakes an annexation, consolidation, or detachment proceeding under this chapter, the entity shall coordinate with the Arkansas Geographic Information Systems Office for preparation of legal descriptions and digital mapping for the relevant annexation, consolidation, and detachment areas.
The map contained herein, is evidence, the entity has met requirements of Act 974 of 2015

Proposed Annex
Sections
Parcels
Minor Road
Existing City
Neighboring City
County Boundary

FILED

DEC 29 2017

Arkansas
Secretary of State

0.0 0.1 0.25 0.5 1.0 Miles

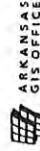
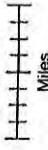

H:\City_Annexation\City\Leslie

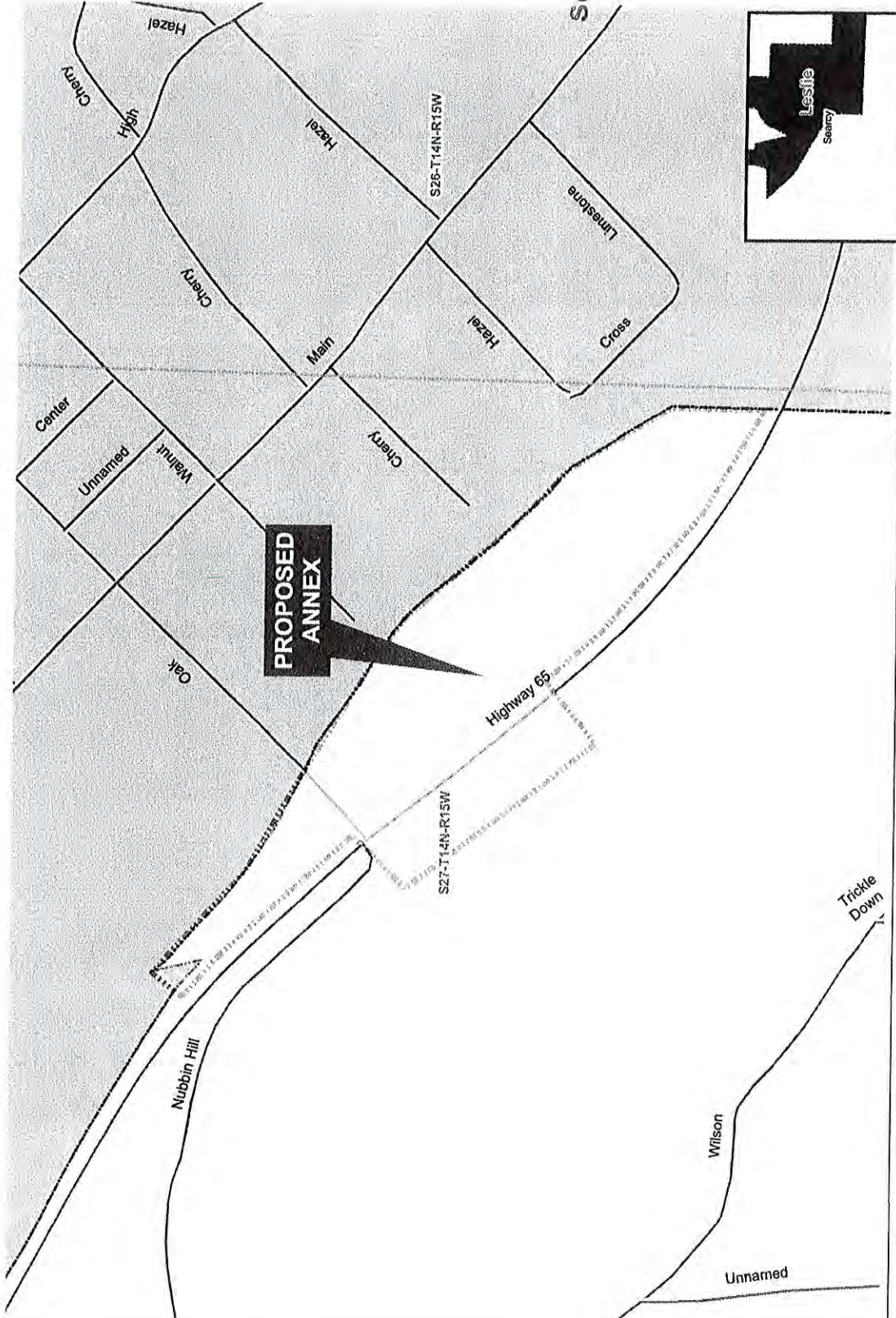

This is NOT a survey grade legal description. This legal description was devised using provided legal descriptions and GIS mapping software to more completely illustrate the intention of this annexation.

A portion of land in part of the SE NE and part of the NE SE of section 27, Township 14 North, Range 15 West more particularly described as starting at the SW corner of the SE, NE of section 27, Township 14 North, Range 15 West thence north along section line N0°49'42" E745' to the north ROW of HWY 65 and the POB thence northwesterly along HWY 65 ROW the following calls;

N42°58'39" W158.65'

N48°14'4" W120.7'

Thence leaving ROW N37°46'39" E91.92' to the current boundary of the City of Leslie. Thence continuing southeasterly along the current city limit boundary the following calls;

S48°3'58" E331.89'

S59°11'18" E277.54' to the centerline of Oak Street, thence

S57°5'22" E360.84'

S51°50'31" E97.03'

S40°39'45" E360.38'

S45°13'23" E177.21'

S30°25'58" E296.07'

S1°27'37" W230' to the north ROW of HWY 65

Thence northwesterly along the north ROW of HWY 65 the following calls;

N59°26'36" W294.93'

N48°52'59" W378.42'

N40°26'11" W185.04'

Thence leaving said ROW S49°14'10" W197.71' to the southeast corner of lot 12 of the West Leslie Subdivision as recorded in Book 31, Page 100 in the records of Searcy County, Arkansas. Thence following, in a northwesterly direction, the southern border of the West Leslie Subdivision N37°2'39" W584.88' to the southwest corner of lot 1 of said subdivision. Thence N42°48'32" E185.21' to the northwest corner of lot 1 of said subdivision also being a point on the northern ROW of HWY 65. Thence following northern ROW of HWY 65 N41°0'46" W292.64 to the POB containing 13.4 acres more or less.

SECTION 2. That the following schedule of services shall be extended to the area by the City of Leslie within the statutorily required three (3) year period after the date the annexation becomes final, as follows: water and sewer, pending state approval and new business.

SECTION 3. That the above described territory shall be annexed to and made part of **Ward 3** of the City of Leslie, and the same shall henceforth be a part of said ward as fully existing parts of said ward.

SECTION 4. Thirty (30) days after passage and publication or posting of this Ordinance as authorized by law, the annexation shall be final and the property shall be within the corporate limits of the city, except as otherwise ordered by the Circuit Court pursuant to a cause of action filed within said thirty (30) day period.

PASSED AND APPROVED THIS November 6 DAY OF 2017.

SIGNED: Talitha Hardin
Talitha Hardin, Mayor

ATTEST: Benny Davis
Benny Davis, Recorder

IN THE COUNTY COURT OF SEARCY COUNTY, ARKANSAS

RE: IN THE MATTER OF ANNEXING TO THE
CITY OF LESLIE, ARKANSAS, CERTAIN
TERRITORY CONTIGUOUS TO SAID CITY
OF LESLIE, ARKANSAS.

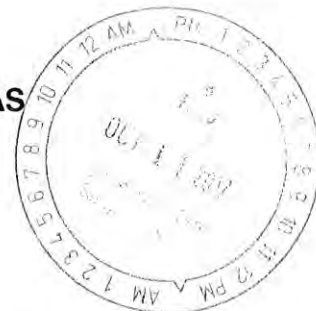

CASE NO.: 6500-17-1

ORDER CONCERNING ANNEXATION

On this regular day of a regular term of the County Court of Searcy County, Arkansas, there is presented to the Court by Wade and Debbie Smith, and Jerry Passmore the petition of real estate owners desiring the annexation of territory to the City of Leslie, Arkansas, more particularly described therein. The court has received the verification of the county assessor and county clerk required by Arkansas Code Annotated 14-40-609. This Court being fully advised of the facts and the law, does hereby find as follows:

The Court finds that the petition and verifications are complete and accurate.

The Court further finds that no enclaves will be created by the annexation.

The Court finds that the petition contains a schedule of services.

The Court further finds that the territory consists of lands that:

1. Furnish the abode for a densely settled community or represent the actual growth of the municipality beyond its legal boundary;
2. Are valuable by reason of their adaptability for prospective municipal uses.

Therefore, the Court hereby **ORDERS** that the petition and this Order be delivered to the City of Leslie, Arkansas.

PASSED AND APPROVED THIS 10-11-17 DAY OF 2017.



FILED

DEC 29 2017

Arkansas
Secretary of State

SIGNED:

The Honorable Jim Harness
Searcy County Judge



**ARKANSAS
GIS OFFICE**

October 30, 2017

Mayor Talitha Hardin
City of Leslie
PO Box 366
Leslie, AR 72645

RE: City of Leslie Annexation Coordination Requirement

Honorable Hardin,

Thank you for coordinating with our office as you seek to annex property into the City of Leslie, AR. This letter represents confirmation that you have properly coordinated with our office (Arkansas GIS Office) as specified in § 14-40-101 (Act 914 of 2015) of the 90th General Assembly.

Our office will wait completion of any additional steps necessary for the proposed boundary change, which normally comes from the Arkansas Secretary of State Elections Division after any appropriate filing by your County Clerk.

Thank you,

Jennifer Wheeler, GIS Analyst
/jjw

FILED

DEC 29 2017

**Arkansas
Secretary of State**

Attachments:
GIS Office Map of Proposed Annexation
Devised legal description using parcel legals and mapping software
Secretary of State Municipal Change Checklist

Proposed Annex: City of Leslie
October 2017

City: Leslie
Mayor: Talitha Hardin

Arkansas Code 14-40-101.

Before an entity undertakes an annexation, consolidation, or detachment proceeding under this chapter, the entity shall coordinate with the Arkansas Geographic Information Systems Office for preparation of legal descriptions and digital mapping for the relevant annexation, consolidation, and detachment areas.

The map contained herein is evidence the entity has met requirements of Act 914 of 2015.

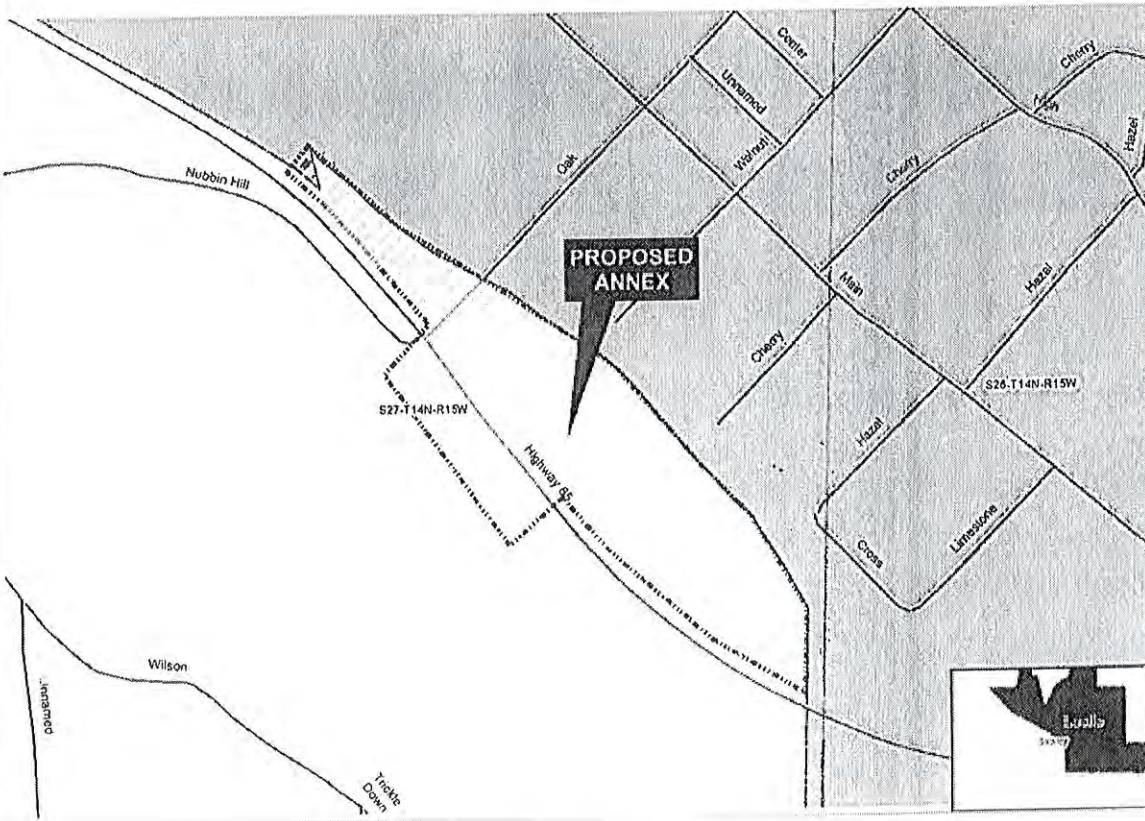

FILED

DEC 29 2017

Arkansas
Secretary of State

FILED

DEC 29 2017

Arkansas
Secretary of State

November 3, 2017

Mayor Talitha Hardin
City of Leslie
P.O. Box 366
Leslie, Arkansas 72645

RE: Proposed Annexation

Honorable Talitha Hardin:

We are in receipt of the information from the Arkansas GIS Office related to the proposed annexation generally near intersection of U.S. Highway 65 and Arkansas Highway 66. We have reviewed the information submitted and offer the following:

- While no on-site survey has been conducted, it appears there are no enclaves created by the proposed annexation.

The attached information from GIS is attached to this letter for reference.

If you have any questions or need additional information please do not hesitate to contact our office.

Sincerely,

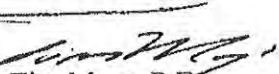

Tim Mays, P.E.
Vice President

This is NOT a survey grade legal description. This legal description was devised using provided legal descriptions and GIS mapping software to more completely illustrate the intention of this annexation.

A portion of land in part of the SE NE and part of the NE SE of section 27, Township 14 North, Range 15 West more particularly described as starting at the SW corner of the SE, NE of section 27, Township 14 North, Range 15 West thence north along section line $N0^{\circ}49'42''$ E745' to the north ROW of HWY 65 and the POB thence northwesterly along HWY 65 ROW the following calls;

$N42^{\circ}58'39''$ W158.65'

$N48^{\circ}14'4''$ W120.7'

Thence leaving ROW $N37^{\circ}46'39''$ E91.92' to the current boundary of the City of Leslie. Thence continuing southeasterly along the current city limit boundary the following calls;

$S48^{\circ}3'58''$ E331.89'

$S59^{\circ}11'18''$ E277.54' to the centerline of Oak Street, thence

$S57^{\circ}5'22''$ E360.84'

$S51^{\circ}50'31''$ E97.03'

$S40^{\circ}39'45''$ E360.38'

$S45^{\circ}13'23''$ E177.21'

$S30^{\circ}25'58''$ E296.07'

$S1^{\circ}27'37''$ W230' to the north ROW of HWY 65

Thence northwesterly along the north ROW of HWY 65 the following calls;

$N59^{\circ}26'36''$ W294.93'

$N48^{\circ}52'59''$ W378.42'

$N40^{\circ}26'11''$ W185.04'

Thence leaving said ROW $S49^{\circ}14'10''$ W197.71' to the southeast corner of lot 12 of the West Leslie Subdivision as recorded in Book 31, Page 100 in the records of Searcy County, Arkansas. Thence following, in a northwesterly direction, the southern border of the West Leslie Subdivision $N37^{\circ}2'39''$ W584.88' to the southwest corner of lot 1 of said subdivision. Thence $N42^{\circ}48'32''$ E185.21' to the northwest corner of lot 1 of said subdivision also being a point on the northern ROW of HWY 65. Thence following northern ROW of HWY 65 $N41^{\circ}0'46''$ W292.64 to the POB containing 13.4 acres more or less.

VERIFICATION

**RE: IN THE MATTER OF ANNEXING TO THE
CITY OF LESLIE, ARKANSAS, CERTAIN
TERRITORY CONTIGUOUS TO SAID CITY
OF LESLIE, ARKANSAS.**



CASE NO.: 65CO-17-1

I, Randy Crumbly, County Assessor of the County of Searcy, Arkansas, with respect to the annexation by one-hundred percent petition filed by Wade and Debbie Smith, and Jerry Passmore on Oct. 11, 2017, do hereby verify:

1. That the identity of the petitioners as listed on the petition is accurate.
2. That all property owners included in the petition do wish to have their property annexed.
3. That the property or properties are contiguous with the city or town.
4. That an enclave will not be created if the petition is accepted by the city or town.

SIGNED: Randy Crumbly
Searcy County Assessor

DATE: 10/11/17



CERTIFIED COPY
SEARCY COUNTY & CIRCUIT CLERK
DEBBIE LOGGINS, CLERK

VERIFICATION



**RE: IN THE MATTER OF ANNEXING TO THE
CITY OF LESLIE, ARKANSAS, CERTAIN
TERRITORY CONTIGUOUS TO SAID CITY
OF LESLIE, ARKANSAS.**

CASE NO.: 6500-17-1

I, Debbie Loggins, County Clerk of the County of Searcy, Arkansas, with respect to the annexation by one-hundred percent petition filed by Wade and Debbie Smith, and Jerry Passmore on October 11, 2017, do hereby verify:

1. That the identity of the petitioners as listed on the petition is accurate.
2. That all property owners included in the petition do wish to have their property annexed.
3. That the property or properties are contiguous with the city or town.
4. That an enclave will not be created if the petition is accepted by the city or town.

SIGNED: Deborah Loggins
Searcy County Clerk

DATE: October 11, 2017



CERTIFIED COPY
SEARCY COUNTY & CIRCUIT CLERK
DEBBIE LOGGINS, CLERK

2. Continued – Description of the area to be annexed.

Parcel Number 001-02350-000

Smith, Wade & Deborah

27-14-15 0.16 acres

Parcel Number 001-02351-000

Smith, Wade & Deborah

27-14-15 0.068 acres

Beginning at the Southwest corner of the SE¼ of the NE¼ of Section 27, Township 14 North, Range 15 West; thence East 40 rods to East Boundary line of U. S. Highway No. 65; thence North 41 degrees West 13½ rods to point of beginning; thence North 46 degrees East 50 feet; thence North 41 degrees West 200 feet; thence South 46 degrees West 50 feet to the East boundary line of U. S. Highway No. 65; thence South 41 degrees East 200 feet to point of beginning, being a Part of the SE¼ of the NE¼ of Section 27, Township 14 North, Range 15 West, containing one-fourth (1/4) acre, more or less.

Parcel Number 001-02353-000

Smith, Wade & Debbie

27-14-15 1 acres

Beginning at a point at the Northwest intersection of U. S. Highway No. 65 and State Highway No. 66; thence in a Northeast direction with the right of way line of State Highway No. 66 to the channel of Cove Creek; thence up said Cove Creek 210 feet; thence in a Southwest direction 210 feet to a stake; thence in an Easterly direction to the place of beginning, being a Part of the SE ¼ of the NE ¼ Section 27, Township 14 North, Range 15 West containing one acre, more or less.

LESS the amount taken for Highway Improvement.

Parcel Number 001-02354-000

Smith, Wade & Debbie

27-14-15 0.62 acres

Also, commencing at the Southeast corner of the NE¼ of the SE¼ of Section 27, Township 14 North, Range 15 West; thence North 20 chains; thence West 9.50 chains; thence North 40½ degrees West 6.58 chains to iron pin on East boundary of U. S. Highway No. 65 for the point of beginning; thence North 46 degrees East 3.75 chains to center of Cove Creek; thence North 49½ degrees West 1.77 chains with creek; thence South 42 degrees West 3.48½ chains to iron pin on East boundary of U. S. Highway No. 65; thence South 39 degrees East 100 feet to the point of beginning, being a Part of the SE¼ of the NE¼ of Section 27, Township 14 North, Range 15 West, and containing ¾ of an acre, more or less.

**IN THE MATTER OF ANNEXING TO THE COUNTY OF SEARCY,
ARKANSAS, ON OCTOBER 9, 2017, CERTAIN TERRITORY
CONTIGUOUS TO SAID CITY OF LESLIE, ARKANSAS**

Come now the undersigned petitioners, and state as follows:

1. That we, owning 100% of the property in the following described area, do hereby petition, pursuant to Arkansas Code Annotated section 14-40-609, the City Council of Leslie, Arkansas, to annex the following lands to the City of Leslie, Arkansas:
2. **See attached.**
3. We further state that this petition is signed by one hundred percent (100%) of the real estate owners owning one hundred percent (100%) of the acreage in said area and that the area to be annexed does not contain property whose owners do not wish to have their property annexed.
4. That said property describe herein is contiguous to and adjoining the Leslie City limits, as shown on the map attached hereto as Exhibit A.
5. That no enclaves will be created in this petition is accepted and the territory annexed into the City of Leslie.
6. That the following schedule of services shall be extended to the area by the City of Leslie within three (3) years after the date the annexation becomes final: Water and Sewer Service, pending state approval and new business.

<u>Wade Smith</u> Signature of Property Owner	<u>Debbie Smith</u> Signature of Attesting Witness
<u>Wade Smith</u> Printed Name of Owner	<u>Debbie Smith</u> Printed Name of Witness

264 Strikeout Drive
 Address Leslie, AR 72645

<u>Debbie Smith</u> Signature of Property Owner	<u>Wade Smith</u> Signature of Attesting Witness
<u>Debbie Smith</u> Printed Name of Owner	<u>Wade Smith</u> Printed Name of Witness

264 Strikeout Dr.
 Address Leslie, AR 72645

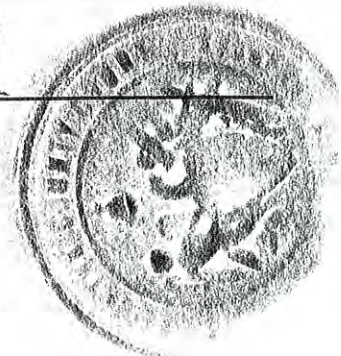

CERTIFIED COPY
 SEARCY COUNTY & CIRCUIT CLERK
 DEBBIE LOGGINS, CLERK

Jerry Passmore

Signature of Property Owner

Wade Smith

Signature of Attesting Witness

JERRY PASSMORE

Printed Name of Owner

Wade Smith

Printed Name of Witness

Box 248 Leslie Ave 72645

Address

Parcel Number 001-02355-000

Smith, Wade & Debbie

27-14-15 0.25 acres

Starting at the SW corner of SE $\frac{1}{4}$ of the NE $\frac{1}{4}$ of Section 27, Township 14 North, Range 15 West; thence East 40 rods to East boundary line of U. S. Highway No. 65; thence North 41 degrees West with right-of-way, 31 $\frac{1}{2}$ rods for beginning point; thence North 42 degrees East 3.37 chains to center of Cove Creek; thence North 41 degrees West 1.11 chains to South boundary line of State Highway No. 66; thence South 42 degrees West 3.37 chains with South boundary line of State Highway No. 66 to intersection of East boundary line of U. S. Highway No. 65; thence South 41 degrees East 1.11 chains back to the point of beginning, being Part of the SE $\frac{1}{4}$ of the NE $\frac{1}{4}$ of Section 27, Township 14 North, Range 15 West, and containing $\frac{1}{4}$ of an acre, more or less.

Parcel Number 001-02357-000

Smith, Wade & Debbie

27-14-15 4.66 acres

Beginning 50 feet South of the Southwest corner of Hugh Boyd's Out Lot for a starting point; thence South with right of way of U.S. Highway No. 65 to Cove Creek; thence Northwest with channel of Cove Creek to right of way of State Highway No. 66; thence West to Northeast corner of Hugh Boyd's Out lot; thence South with line of said Out Lot to Southeast corner; thence South 50 feet; thence West to right of way of U.S. Highway No. 65, to place of beginning, same being a part of the SE $\frac{1}{4}$ of the NE $\frac{1}{4}$ Section 27, Township 14 North, Range 15 West, containing 5 acres, more or less.

Parcel Numbers 300-00001-000 Lots 1-2-3

Parcel Number 300-00002-000 Lots 4-5-6-7-8

Parcel Number 300-00003-000 Lots 9-10

Parcel Number 300-00004-000 Lots 11-12

Jerry and Gail Passmore Family Trust, dated August 20, 2001

West Leslie Addition

Lots One (1), Two (2), Three (3), Four (4), Five (5), Six (6), Seven (7), Eight (8), Nine (9), Ten (10), Eleven (11) and Twelve (12) in the West Leslie Sub-division to the city of Leslie, AR, same being a part of the Northeast Quarter (NE1/4) of the Southeast Quarter (SE1/4) and a part of the Southeast Quarter (SE1/4) of the Northeast Quarter (NE1/4) of Section 27, Township 14 North, Range 15 West, and same shown on plat recorded as Book 31, Page 100, in the records of Searcy County, Arkansas.

LESS AND EXCEPT the following tract conveyed to the Arkansas State Highway Commission by Warranty Deed dated 09/29/1960 and recorded in Deed Book 68 at pages 257-258, to-wit: Part of Lots 1, 2 and 3, West Leslie Sub-division, Searcy County, Arkansas, more particularly described as follows: Beginning at the Northwest corner of Lot 1, West Leslie Sub-division; thence South 40 degrees 55 minutes East along the North line of Lot 1 and existing right-of-way line of U. S. Highway No. 65, a distance of 131.00 feet to a point; thence South 40 degrees 05 minutes West a distance of 10.00 feet to a point on the proposed westerly right-of-way line for U. S. Highway No. 65; thence North 40 degrees 55 minutes West a distance of 129.9 feet to a point on the West line of Lot 1; thence North 42 degrees 08 minutes East, along the said lot line, a distance of 10.00 feet, returning to the point of beginning, and containing 1304.00 square feet, more or less.

