



# ARKANSAS SECRETARY OF STATE

## MARK MARTIN

June 29, 2019

The Honorable Larry Crane  
Pulaski County Clerk  
401 W Markham St  
Little Rock, AR 72201

Re: City of Little Rock Annexation Ordinance 21362

Dear Mr. Crane,

This letter acknowledges receipt and filing of the following notice of municipal boundary change by the Office of the Secretary of State:

Filing Type: Annexation pursuant to A.C.A § 14-40-609 (petition by 100% of the landowners)

Effective Date: unknown

County: Pulaski

City: Little Rock

City Ordinance: 21362

Dated: 02/07/2017

County Court Order: CI-2016-012

Filed: 11/21/2016

Honorable Barry Hyde, Pulaski County Judge

A file marked copy of the ordinance and exhibits submitted to our Office are enclosed. By copy of this letter (and its enclosures), the Secretary of State hereby notifies the appropriate mapping authorities for Arkansas. Please retain these copies as official record of the filing of the municipal boundary change by the Arkansas Secretary of State.

If you have any questions or concerns regarding this pending filing please contact our office at 501-682-3401.

Sincerely,

A handwritten signature in cursive script, appearing to read "Cynthia Fisher".

Cynthia Fisher  
Arkansas Secretary of State Legal Division  
500 Woodlane St  
Little Rock, AR 72201  
501-682-3401

cc: Arkansas Geographic Information Systems Office (w/ encl)  
Arkansas Highway and Transportation Department Mapping Department (w/ encl)  
Department of Finance and Administration (w/encl)  
Arkansas Public Service Commission (w.encl)  
UALR Institution for Economic Advancement (w/encl)  
Tom-Tom (w/encl)  
Ms. Susan Langley, Little Rock City Clerk (w/encl)





# Arkansas Secretary of State

**Mark Martin** Arkansas Secretary of State, 500 Woodlane Ave, Little Rock, AR 72201-1094

## Municipal Boundary Change Checklist

County: Pulaski City/Town: Little Rock

City Ordinance/Resolution No: 21,362 Date approved: 02/07/2017

County Court Case No: CI-2016-012 Date Order Filed: 11/21/2016

Type: Annexation by Petition of all Landowners A.C.A §14-40-609

Date Change Effective: \_\_\_\_\_ Set by:  Municipal Ordinance  Emergency Clause  Default  
*(Required by Act 653 of 2017)*

For Circuit Court Challenge: Date Order Filed: \_\_\_\_\_  Upheld  Overturned  Other *(attach explanation)*

### Initiating party:

All Landowners  Majority Landowners  Municipal Governing Body  State  Other \_\_\_\_\_

### Supporting Documentation attached *(check all that apply):*

- File marked copy of City Ordinance/Resolution *(required)*
- File marked copy of County Court Order *(required except for island annexation and annexation approved by election)*
- Copy of Arkansas GIS Office approved printed map and certification letter *(required)*
- Proof of Publication for all Legal Notices *(include Hearing, Election, and City Ordinance/Resolution notices)*
- File marked copy of Petition Part or File marked copy of the certified special election results *(if applicable)*
- File marked copy of Complaint and final Circuit Court Order *(Court Challenge only)*

### Municipal Contact:

Name: Ms. Susan Langley Title: Little Rock City Clerk

Street Address: 500 W. Markham, Suite 200

City: Little Rock St: AR Zip code: 72201

*Complete one form per ordinance/resolution, attach it as a cover page to the supporting document set and submit to the County Clerk's Office within 45 days of the Effective Date as required by Act 655 of 2017*

### County Official:

Signature: \_\_\_\_\_ Title: \_\_\_\_\_

Date: \_\_\_\_\_

*Pursuant to Act 655 of 2017, County Officials must submit a file-marked copy of municipal boundary change documentation within 30 days of receipt to: Arkansas Secretary of State, Attn: Municipal Boundary Filing, 500 Woodlane Ave Suite 256, Little Rock, AR 72201-1094*

Office of the Arkansas Secretary of State use only

**F I L E D**

JUN 29 2017

Arkansas  
Secretary of State

Received by: *Sybil Fisher*

LARRY CRANE  
PULASKI CIRCUIT/COUNTY CLERK



401 WEST MARKHAM STREET, SUITE 103  
LITTLE ROCK, ARKANSAS 72201  
(501)340-8766 Fax (501)340-8884

June 6, 2017

Hon. Mark Martin  
Arkansas Secretary of State  
State Capitol, Suite 256  
500 Woodlane Ave.  
Little Rock, AR 72201

Re: Annexations

To whom it may concern:

Enclosed, find certified copies of the Annexations: Little Rock Ordinance numbers  
No.21,362, No.21,187, and No.20,948.

A handwritten signature in black ink, appearing to read "Douglas A. DalPorto".

Douglas A. DalPorto  
Supervisor, Records



2017010533

PRESENTED: 02-16-2017 10:25:52 AM RECORDED: 02-16-2017 10:28:50 AM

In Official Records of Larry Crane Circuit/County Clerk

PULASKI CO, AR FEE \$40.00

**ORDINANCE NO. 21,362**

1  
2  
3  
4  
5  
6  
7  
8

**AN ORDINANCE TO ACCEPT THE 3M COMPANY THREE (3)-TRACT ANNEXATION (A-329), TO ADD CERTAIN LANDS TO THE CITY OF LITTLE ROCK, ARKANSAS; TO INITIATE M, MINING DISTRICT, ZONING FOR TRACT 2 OF THE ANNEXATION; AND FOR OTHER PURPOSES.**

9 **WHEREAS**, a petition for voluntary annexation (the "Petition") was filed with the County Clerk of  
10 Pulaski County, Arkansas, by the owner of hereinafter designated lands praying that said lands be annexed  
11 to and made part of the City of Little Rock, Arkansas; and, Larry Crane Pulaski Circuit Clerk

12 **WHEREAS**, the County Court of Pulaski County, Arkansas found that the Petition was signed by all  
13 the real property owners of the area to be annexed and the annexation request met all requirements of  
14 Arkansas Code 14-40-609; and,

15 **WHEREAS**, the Pulaski County Judge has signed an Annexation Order for the sites requesting  
16 annexation (on November 21, 2016); and,

17 **WHEREAS**, an accurate map of said lands has been filed with and made a part of said Petition; and,

18 **WHEREAS**, proper notice has been given for the time and in the manner prescribed by law; and,

19 **WHEREAS**, all things pertaining thereto have been done in the manner prescribed by law and that said  
20 lands should be annexed to and made part of the City of Little Rock.

21 **NOW, THEREFORE, BE IT ORDAINED BY THE BOARD OF DIRECTORS OF THE CITY**  
22 **OF LITTLE ROCK, ARKANSAS:**

23 **Section 1.** The following described territory contiguous and adjoining the City of Little Rock,  
24 Arkansas is accepted as annexed to and made a part of the City of Little Rock, Pulaski County, Arkansas,  
25 to wit:

26  
27  
28  
29

**3M COMPANY 3-TRACT**  
**ANNEXATION (A-329)**



30 **TRACT 1:** PART OF THE SOUTHEAST QUARTER OF THE NORTHEAST QUARTER OF  
31 **AND PART OF THE NORTHEAST QUARTER OF THE SOUTHEAST QUARTER OF**  
32 **SECTION 13, TOWNSHIP 1 NORTH, RANGE 12 WEST, ALSO PART OF THE**  
33 **SOUTHWEST QUARTER OF THE NORTHWEST QUARTER AND PART OF THE**

**FILED**  
JUN 29 2017  
Arkansas  
Secretary of State

1 NORTHWEST QUARTER OF THE SOUTHWEST QUARTER OF SECTION 18,  
2 TOWNSHIP 1 NORTH, RANGE 11 WEST, ALL IN PULASKI COUNTY ARKANSAS,  
3 BEING MORE PARTICULARLY DESCRIBED AS FOLLOWS: BEGINNING AT THE  
4 SOUTHWEST CORNER OF THE SAID SOUTHEAST QUARTER OF THE NORTHEAST  
5 QUARTER OF SECTION 13; THENCE NORTH 02 DEGREES 45 MINUTES 19  
6 SECONDS EAST 740.69 FEET TO A POINT IN THE CENTERLINE OF FOURCHE  
7 CREEK; THENCE ALONG THE SAID CENTERLINE THE FOLLOWING EIGHT (8)  
8 COURSES AND DISTANCES; THENCE NORTH 65 DEGREES 48 MINUTES 24  
9 SECONDS EAST 258.02 FEET TO A POINT; THENCE NORTH 65 DEGREES 15  
10 MINUTES 07 SECONDS EAST 236.40 FEET TO A POINT; THENCE NORTH 77  
11 DEGREES 56 MINUTES 52 SECONDS EAST 93.23 FEET TO A POINT; THENCE  
12 SOUTH 78 DEGREES 49 MINUTES 31 SECONDS EAST 85.96 FEET TO A POINT;  
13 THENCE SOUTH 59 DEGREES 55 MINUTES 33 SECONDS EAST 207.23 FEET TO A  
14 POINT; THENCE SOUTH 49 DEGREES 03 MINUTES 30 SECONDS EAST 164.77 FEET  
15 TO A POINT; THENCE SOUTH 68 DEGREES 17 MINUTES 32 SECONDS EAST 114.85  
16 FEET TO A POINT; THENCE NORTH 86 DEGREES 13 MINUTES 10 SECONDS EAST  
17 137.31 FEET TO THE WEST RIGHT-OF-WAY LINE OF THE UNION PACIFIC  
18 RAILROAD; THENCE ALONG THE SAID RIGHT OF WAY LINE THE FOLLOWING  
19 FOUR (4) COURSES AND DISTANCES; THENCE SOUTH 29 DEGREES 34 MINUTES  
20 21 SECONDS EAST 164.23 FEET TO A POINT; THENCE SOUTH 29 DEGREES 31  
21 MINUTES 37 SECONDS EAST 223.96 FEET TO A POINT ON THE SOUTH RIGHT-OF-  
22 WAY LINE OF INTERSTATE 440; THENCE SOUTH 27 DEGREES 50 MINUTES  
23 00 SECONDS EAST 558.63 FEET TO A POINT; THENCE SOUTH 27 DEGREES 50  
24 MINUTES 00 SECONDS EAST 644.85 FEET TO A POINT; THENCE DEPARTING SAID  
25 WEST RIGHT-OF-WAY LINE NORTH 88 DEGREES 26 MINUTES 03 SECONDS WEST  
26 1980.39 FEET TO A POINT; THENCE NORTH 01 DEGREES 33 MINUTES 57 SECONDS  
27 EAST 645.98 FEET TO THE POINT OF BEGINNING CONTAINING 2,324,179 SQUARE-  
28 FEET OR 53.36 ACRES, MORE OR LESS.

29 AND

30  
31 TRACT 2: PART OF THE SOUTHEAST QUARTER OF THE SOUTHEAST QUARTER  
32 AND PART OF THE NORTHEAST QUARTER OF THE SOUTHEAST QUARTER OF  
33 SECTION 24, TOWNSHIP 1 NORTH, RANGE 12 WEST, ALSO PART OF THE  
34 NORTHWEST QUARTER OF THE SOUTHWEST QUARTER AND PART OF THE

1       **Z-9188:** DESCRIBED AS: PART OF THE SOUTHEAST QUARTER OF THE  
2       SOUTHEAST QUARTER AND PART OF THE NORTHEAST QUARTER OF THE  
3       SOUTHEAST QUARTER OF SECTION 24, TOWNSHIP 1 NORTH, RANGE 12 WEST,  
4       ALSO PART OF THE NORTHWEST QUARTER OF THE SOUTHWEST QUARTER  
5       AND PART OF THE SOUTHWEST QUARTER OF THE SOUTHWEST QUARTER OF  
6       SECTION 19, TOWNSHIP 1 NORTH, RANGE 11 WEST, ALL IN PULASKI COUNTY,  
7       ARKANSAS, BEING MORE PARTICULARLY DESCRIBED AS FOLLOWS:  
8       COMMENCING AT THE SOUTHWEST CORNER OF THE SAID SOUTHEAST  
9       QUARTER OF THE SOUTHEAST QUARTER OF SECTION 24; THENCE SOUTH 89  
10      DEGREES 13 MINUTES 10 SECONDS EAST 54.80 FEET TO A POINT ON THE EAST  
11      RIGHT-OF-WAY LINE OF ARKANSAS STATE HIGHWAY 365; THENCE ALONG THE  
12      SAID RIGHT-OF-WAY LINE THE FOLLOWING TWO (2) COURSES AND  
13      DISTANCES; THENCE NORTH 01 DEGREES 49 MINUTES 20 SECONDS EAST 579.00  
14      FEET TO THE POINT OF BEGINNING; THENCE NORTH 01 DEGREES 49 MINUTES  
15      20 SECONDS EAST 1086.23 FEET TO A POINT; THENCE DEPARTING SAID RIGHT-  
16      OF-WAY LINE SOUTH 88 DEGREES 11 MINUTES 47 SECONDS EAST 257.00 FEET TO  
17      A POINT; THENCE SOUTH 02 DEGREES 53 MINUTES 51 SECONDS WEST 336.06  
18      FEET TO A POINT; THENCE SOUTH 88 DEGREES 11 MINUTES 47 SECONDS EAST  
19      367.98 FEET TO A POINT; THENCE NORTH 02 DEGREES 53 MINUTES 51 SECONDS  
20      EAST 365.53 FEET TO A POINT; THENCE SOUTH 88 DEGREES 11 MINUTES 47  
21      SECONDS EAST 680.95 FEET TO A POINT; THENCE NORTH 01 DEGREES 40  
22      MINUTES 28 SECONDS EAST 215.81 FEET TO A POINT; THENCE SOUTH 88  
23      DEGREES 03 MINUTES 39 SECONDS EAST 1215.52 FEET TO A POINT ON THE WEST  
24      RIGHT-OF-WAY LINE OF THE McGEORGE RAIL ROAD SPUR OF THE UNION  
25      PACIFIC RAIL ROAD; THENCE THE FOLLOWING EIGHT (8) COURSES AND  
26      DISTANCES ALONG SAID RIGHT-OF-WAY LINE AND ALSO COMMON WITH THE  
27      WEST AND NORTH LINES OF THE McGEORGE RAILROAD SPUR AS SET OUT IN  
28      THE LEGAL DESCRIPTION CONTAINED IN WARRANTY DEED BOOK 1110 PAGE  
29      459 AND INSTRUMENT 97 050070; THENCE SOUTH 25 DEGREES 29 MINUTES 52  
30      SECONDS WEST 1499.08 FEET TO A POINT; THENCE NORTH 87 DEGREES 59  
31      MINUTES 02 SECONDS WEST 277.95 FEET TO A POINT; THENCE SOUTH 31  
32      DEGREES 26 MINUTES 00 SECONDS WEST 46.80 FEET TO A POINT; THENCE  
33      NORTH 73 DEGREES 00 MINUTES 12 SECONDS WEST 320.99 FEET TO A POINT;  
34      THENCE SOUTH 01 DEGREES 40 MINUTES 28 SECONDS WEST 77. 76 FEET TO A

1 POINT; THENCE NORTH 73 DEGREES 00 MINUTES 12 SECONDS WEST 138.77 FEET  
2 TO A POINT; THENCE 217.34 FEET ALONG THE ARC OF A 865.60-FOOT RADIUS  
3 CURVE TO THE LEFT HAVING A CHORD BEARING AND DISTANCE OF NORTH 80  
4 DEGREES 15 MINUTES 58 SECONDS WEST 216.77 FEET TO A POINT; THENCE  
5 NORTH 87 DEGREES 32 MINUTES 26 SECONDS WEST 960.98 FEET TO THE POINT  
6 OF BEGINNING CONTAINING 2,590.191 SQUARE-FEET OR 59.45 ACRES, MORE OR  
7 LESS. (5600 – 5900 Blocks of State Highway 365).

8 Section 4. *Severability*. In the event any title, section, paragraph, item, sentence, clause, phrase, or  
9 word of this ordinance is declared or adjudged to be invalid or unconstitutional, such declaration or  
10 adjudication shall not affect the remaining portions of the ordinance which shall remain in full force and  
11 effect as if the portion so declared or adjudged invalid or unconstitutional was not originally a part of the  
12 ordinance.

13 Section 5. *Repealer*. All ordinances or resolutions of the City in conflict herewith are hereby repealed  
14 to the extent of such conflict.

15 PASSED: February 7, 2017

16 ATTEST:

17   
18 \_\_\_\_\_  
19 Susan Langley, City Clerk

APPROVED:

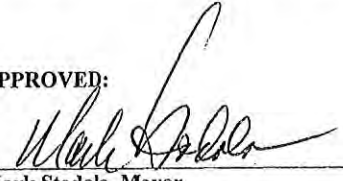
  
\_\_\_\_\_  
Mark Stodola, Mayor

20 APPROVED AS TO LEGAL FORM:

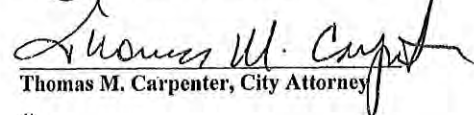
21   
22 \_\_\_\_\_  
23 Thomas M. Carpenter, City Attorney

24 //  
25 //  
26 //  
27 //  
28 //  
29 //  
30 //  
31 //  
32 //  
33 //  
34 //  
35 //

IN THE COUNTY COURT OF PULASKI COUNTY, ARKANSAS  
IN THE MATTER OF THE PETITION BY 3M COMPANY FOR  
THE ANNEXATION OF CERTAIN TERRITORY

NO. CI-2016-012

ORDER

On this 21<sup>st</sup> of November, 2016 comes on for approval the petition for annexation to the City of Little Rock, Arkansas pursuant to Ark. Code Ann. §14-40-609 of the lands described in the caption hereof and hereinafter described, the original of said written petition for annexation being presented to the Court by 3M Company, who is the sole petitioner; and receiving the verification of the Petition by the Pulaski County Clerk and Pulaski County Assessor, as required by Ark. Code Ann. §14-40-609(b)(3), and reviewing such petition and verifying the accuracy of the same and the accuracy of the verifications thereof, it is established to the satisfaction of the Court: that said petition was duly filed in the office of the County Clerk of Pulaski County, Arkansas (the "Clerk", and in the office of the County Assessor of Pulaski County, Arkansas (the "Assessor") on the 15<sup>th</sup> day of November, 2016; that said petition was transmitted to the Court on the \_\_\_ day of \_\_\_, 2016; that said petition and the verification of the petition by the Clerk and the Assessor, as required by Ark. Code Ann. §14-40-609(b)(3) is complete and accurate; that the annexation proposed by the petition will not create any enclaves; and that the petition contains a schedule of services; that the prayer of said petition is right and proper, that this Court has jurisdiction of this matter, and the Court being satisfied of all of the foregoing doth find that said petition should be, and the same is hereby, granted.

F I L E D  
JUN 29 2017  
Arkansas  
Secretary of State



IT IS THEREFORE, CONSIDERED, ORDERED AND ADJUDGED by the Court that the following described areas, all lying wholly within Pulaski County, Arkansas, to-wit:

**TRACT 1:**

PART OF THE SOUTHEAST QUARTER OF THE NORTHEAST QUARTER AND PART OF THE NORTHEAST QUARTER OF THE SOUTHEAST QUARTER OF SECTION 13, TOWNSHIP 1 NORTH, RANGE 12 WEST, ALSO PART OF THE SOUTHWEST QUARTER OF THE NORTHWEST QUARTER AND PART OF THE NORTHWEST QUARTER OF THE SOUTHWEST QUARTER OF SECTION 18, TOWNSHIP 1 NORTH, RANGE 11 WEST, ALL IN PULASKI COUNTY ARKANSAS, BEING MORE PARTICULARLY DESCRIBED AS FOLLOWS: BEGINNING AT THE SOUTHWEST CORNER OF THE SAID SOUTHEAST QUARTER OF THE NORTHEAST QUARTER OF SECTION 13; THENCE NORTH 02 DEGREES 45 MINUTES 19 SECONDS EAST 740.69 FEET TO A POINT IN THE CENTERLINE OF FOURCHE CREEK; THENCE ALONG THE SAID CENTERLINE THE FOLLOWING EIGHT (8) COURSES AND DISTANCES; THENCE NORTH 65 DEGREES 48 MINUTES 24 SECONDS EAST 258.02 FEET TO A POINT; THENCE NORTH 65 DEGREES 15 MINUTES 07 SECONDS EAST 236.40 FEET TO A POINT; THENCE NORTH 77 DEGREES 56 MINUTES 52 SECONDS EAST 93.23 FEET TO A POINT; THENCE SOUTH 78 DEGREES 49 MINUTES 31 SECONDS EAST 85.96 FEET TO A POINT; THENCE SOUTH 59 DEGREES 55 MINUTES 33 SECONDS EAST 207.23 FEET TO A POINT; THENCE SOUTH 49 DEGREES 03 MINUTES 30 SECONDS EAST 164.77 FEET TO A POINT; THENCE SOUTH 68 DEGREES 17 MINUTES 32 SECONDS EAST 114.85 FEET TO A POINT; THENCE NORTH 86 DEGREES 13 MINUTES 10 SECONDS EAST 137.31 FEET TO THE WEST RIGHT OF WAY LINE OF THE UNION PACIFIC RAILROAD; THENCE ALONG THE SAID RIGHT OF WAY LINE THE FOLLOWING FOUR (4) COURSES AND DISTANCES; THENCE SOUTH 29 DEGREES 34 MINUTES 21 SECONDS EAST 164.23 FEET TO A POINT; THENCE SOUTH 29 DEGREES 31 MINUTES 37 SECONDS EAST 223.96 FEET TO A POINT ON THE SOUTH RIGHT OF WAY LINE OF I-440; THENCE SOUTH 27 DEGREES 50 MINUTES 00 SECONDS EAST 558.63 FEET TO A POINT; THENCE SOUTH 27 DEGREES 50 MINUTES 00 SECONDS EAST 644.85 FEET TO A POINT; THENCE DEPARTING SAID WEST RIGHT OF WAY LINE NORTH 88 DEGREES 26 MINUTES 03 SECONDS WEST 1980.39 FEET TO A POINT; THENCE NORTH 01 DEGREES 33 MINUTES 57 SECONDS EAST 645.98 FEET TO THE POINT OF BEGINNING CONTAINING 2,324,179 SQUARE FEET OR 53.36 ACRES MORE OR LESS.

LESS AND EXCEPT ANY DEDICATED ROADS AND RIGHTS OF WAY IN PULASKI COUNTY AND LESS AND EXCEPT ANY REAL PROPERTY OWNED IN THE FOREGOING TRACT BY ARKANSAS STATE HIGHWAY COMMISSION.

AND

**TRACT 2**

PART OF THE SOUTHEAST QUARTER OF THE SOUTHEAST QUARTER AND PART OF THE NORTHEAST QUARTER OF THE SOUTHEAST QUARTER OF SECTION 24, TOWNSHIP 1 NORTH, RANGE 12 WEST, ALSO PART OF THE NORTHWEST QUARTER OF THE SOUTHWEST QUARTER AND PART OF THE SOUTHWEST QUARTER OF THE SOUTHWEST QUARTER OF SECTION 19, TOWNSHIP 1 NORTH, RANGE 11 WEST, ALL IN PULASKI COUNTY, ARKANSAS, BEING MORE PARTICULARLY DESCRIBED AS FOLLOWS: COMMENCING AT THE SOUTHWEST CORNER OF THE SAID SOUTHEAST QUARTER OF THE SOUTHEAST QUARTER OF SECTION 24; THENCE SOUTH 89 DEGREES 13 MINUTES 10 SECONDS EAST 54.80 FEET TO A POINT ON THE EAST RIGHT OF WAY LINE OF ARKANSAS STATE HIGHWAY 365; THENCE ALONG THE SAID RIGHT OF WAY LINE THE FOLLOWING TWO (2) COURSES AND

DISTANCES; THENCE NORTH 01 DEGREES 49 MINUTES 20 SECONDS EAST 579.00 FEET TO THE POINT OF BEGINNING; THENCE NORTH 01 DEGREES 49 MINUTES 20 SECONDS EAST 1086.23 FEET TO A POINT; THENCE DEPARTING SAID RIGHT OF WAY LINE SOUTH 88 DEGREES 11 MINUTES 47 SECONDS EAST 257.00 FEET TO A POINT; THENCE SOUTH 02 DEGREES 53 MINUTES 51 SECONDS WEST 336.06 FEET TO A POINT; THENCE SOUTH 88 DEGREES 11 MINUTES 47 SECONDS EAST 367.98 FEET TO A POINT; THENCE NORTH 02 DEGREES 53 MINUTES 51 SECONDS EAST 365.53 FEET TO A POINT; THENCE SOUTH 88 DEGREES 11 MINUTES 47 SECONDS EAST 680.95 FEET TO A POINT; THENCE NORTH 01 DEGREES 40 MINUTES 28 SECONDS EAST 215.81 FEET TO A POINT; THENCE SOUTH 88 DEGREES 03 MINUTES 39 SECONDS EAST 1215.52 FEET TO A POINT ON THE WEST RIGHT OF WAY LINE OF THE McGEORGE RAIL ROAD SPUR OF THE UNION PACIFIC RAIL ROAD; THENCE THE FOLLOWING EIGHT (8) COURSES AND DISTANCES ALONG SAID RIGHT OF WAY LINE AND ALSO COMMON WITH THE WEST AND NORTH LINES OF THE McGEORGE RAILROAD SPUR AS SET OUT IN THE LEGAL DESCRIPTION CONTAINED IN WARRANTY DEED BOOK 1110 PAGE 459 AND INSTRUMENT 97 050070; THENCE SOUTH 25 DEGREES 29 MINUTES 52 SECONDS WEST 1499.08 FEET TO A POINT; THENCE NORTH 87 DEGREES 59 MINUTES 02 SECONDS WEST 277.95 FEET TO A POINT; THENCE SOUTH 31 DEGREES 26 MINUTES 00 SECONDS WEST 46.80 FEET TO A POINT; THENCE NORTH 73 DEGREES 00 MINUTES 12 SECONDS WEST 320.99 FEET TO A POINT; THENCE SOUTH 01 DEGREES 40 MINUTES 28 SECONDS WEST 77.76 FEET TO A POINT; THENCE NORTH 73 DEGREES 00 MINUTES 12 SECONDS WEST 138.77 FEET TO A POINT; THENCE 217.34 FEET ALONG THE ARC OF A 865.60 FOOT RADIUS CURVE TO THE LEFT HAVING A CHORD BEARING AND DISTANCE OF NORTH 80 DEGREES 15 MINUTES 58 SECONDS WEST 216.77 FEET TO A POINT; THENCE NORTH 87 DEGREES 32 MINUTES 26 SECONDS WEST 960.98 FEET TO THE POINT OF BEGINNING CONTAINING 2,590.191 SQUARE FEET OR 59.45 ACRES MORE OR LESS.

LESS AND EXCEPT ANY DEDICATED ROADS AND RIGHTS OF WAY IN PULASKI COUNTY.

AND

**TRACT 3:**

PART OF THE SOUTHWEST QUARTER OF THE SOUTHWEST QUARTER, AND PART OF THE NORTHWEST QUARTER OF THE SOUTHWEST QUARTER, ALL IN SECTION 18, TOWNSHIP 1 NORTH, RANGE 11 WEST, ALL IN PULASKI COUNTY ARKANSAS, BEING MORE PARTICULARLY DESCRIBED AS FOLLOWS: COMMENCING AT THE NORTHWEST CORNER OF THE SOUTHWEST QUARTER OF THE SOUTHWEST QUARTER, SECTION 18, TOWNSHIP 1 NORTH, RANGE 11 WEST, THENCE SOUTH 88 DEGREES 26 MINUTES 03 SECONDS EAST 339.01 FEET TO THE POINT OF BEGINNING; THENCE NORTH 02 DEGREES 18 MINUTES 19 SECONDS EAST 50.45 FEET TO A POINT; THENCE SOUTH 88 DEGREES 35 MINUTES 20 SECONDS EAST 751.51 FEET TO A POINT; THENCE SOUTH 27 DEGREES 51 MINUTES 30 SECONDS EAST 75.55 FEET TO A POINT; THENCE SOUTH 02 DEGREES 15 MINUTES 07 SECONDS WEST 587.20 FEET TO A POINT; THENCE NORTH 88 DEGREES 29 MINUTES 34 SECONDS WEST 640.00 FEET TO A POINT; THENCE SOUTH 02 DEGREES 17 MINUTES 21 SECONDS WEST 329.95 FEET TO A POINT; THENCE NORTH 88 DEGREES 29 MINUTES 56 SECONDS WEST 465.96 FEET TO A POINT; THENCE NORTH 02 DEGREES 33 MINUTES 17 SECONDS EAST 508.04 FEET TO A POINT; THENCE SOUTH 88 DEGREES 29 MINUTES 34 SECONDS EAST 313.65 FEET TO A POINT; THENCE NORTH 02 DEGREES 18 MINUTES 19 SECONDS EAST 423.34 FEET TO THE POINT OF BEGINNING, CONTAINING 723,322 SQUARE FEET OR 16.61 ACRES MORE OR LESS.

LESS AND EXCEPT ANY DEDICATED ROADS AND RIGHTS OF WAY IN PULASKI COUNTY.

AND

ANY AND ALL PUBLIC STREETS AND RIGHTS-OF-WAY ABUTTING OR TRAVERSING TRACTS 1, 2 AND 3 ABOVE, INCLUDING BUT NOT LIMITED TO THE REAL PROPERTY





ARKANSAS  
GIS OFFICE

---

July 15, 2016

Mr. Kyle Gorden  
Operations Director  
Arkansas Surveying and Consulting  
1926 Salem Rd. Benton, AR 72019

RE: City of Little Rock Annexation Coordination Requirement

Mr. Gorden,

Thank you for coordinating with our office as you seek to annex property into the City of Little Rock, AR of the 3M Company Tract 1, Tract 2, and Tract 3. This letter represents confirmation that you have properly coordinated with our office (Arkansas GIS Office) as specified in § 14-40-101 (Act 914 of 2015) of the 90<sup>th</sup> General Assembly.

Our office will wait completion of any additional steps necessary for the proposed boundary change, which normally comes from the Arkansas Secretary of State Elections Division after any appropriate filing by your County Clerk.

Thank you,

Richie Pierce, Sr. GIS Analyst  
/rp

Attachments:  
GIS Office Map of Proposed Annexation  
Secretary of State Municipal Change Checklist

FILED

JUN 29 2017

Arkansas  
Secretary of State

City: Little Rock  
Mayor: Mark Stodola

Proposed Annex: City of Little Rock  
July 2016

Arkansas Code 14-40-101.

Before an entity undertakes an annexation, consolidation, or detachment proceeding under this chapter, the entity shall coordinate with the Arkansas Geographic Information Systems Office for preparation of legal descriptions and digital mapping for the relevant annexation, consolidation, and detachment areas.

The map contained herein, is evidence, the entity has met requirements of Act 914 of 2015

- Proposed Annex
- Township-Range
- Sections
- Parcels
- Highway
- Minor Road
- Existing City
- Neighboring City
- County Boundary

S13-T1N-R12W

**PROPOSED ANNEX**

S18-T1N-R11W

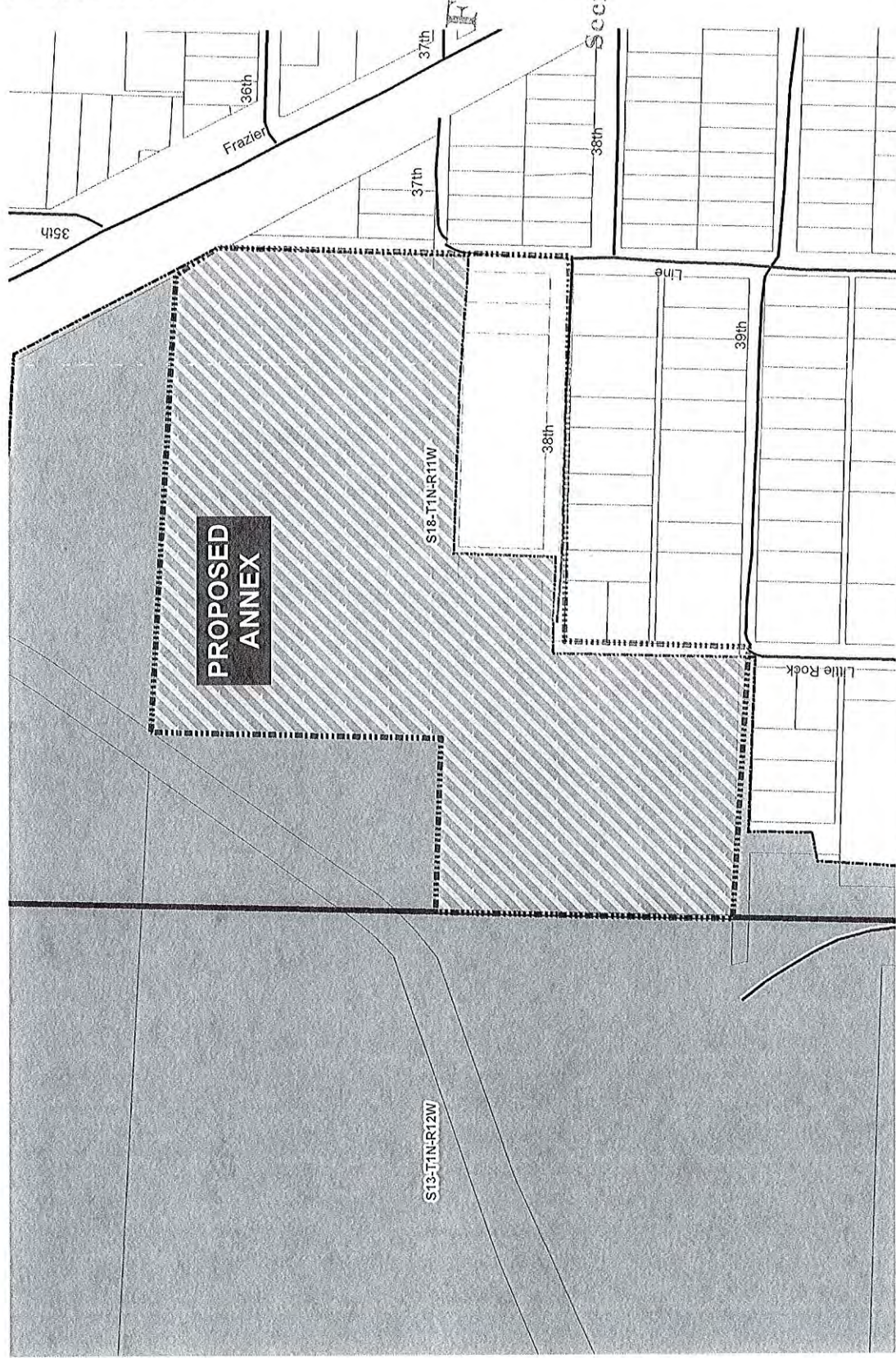

FILED

JUN 29 2017

Arkansas  
Secretary of State



ARKANSAS  
GIS OFFICE

Little Rock 20160120

Proposed Annex: City of Little Rock  
July 2016

City: Little Rock  
Mayor: Mark Stodola

Arkansas Code 14-40-101.

Before an entity undertakes an annexation, consolidation, or detachment proceeding under this chapter, the entity shall coordinate with the Arkansas Geographic Information Systems Office for preparation of legal descriptions and digital mapping for the relevant annexation, consolidation, and detachment areas.

The map contained herein, in evidence, the entity has met requirements of Act 914 of 2015

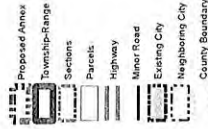

F I L E D

JUN 29 2017

Arkansas  
Secretary of State

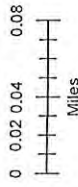

ARKANSAS  
GIS OFFICE

Little Rock-20160120

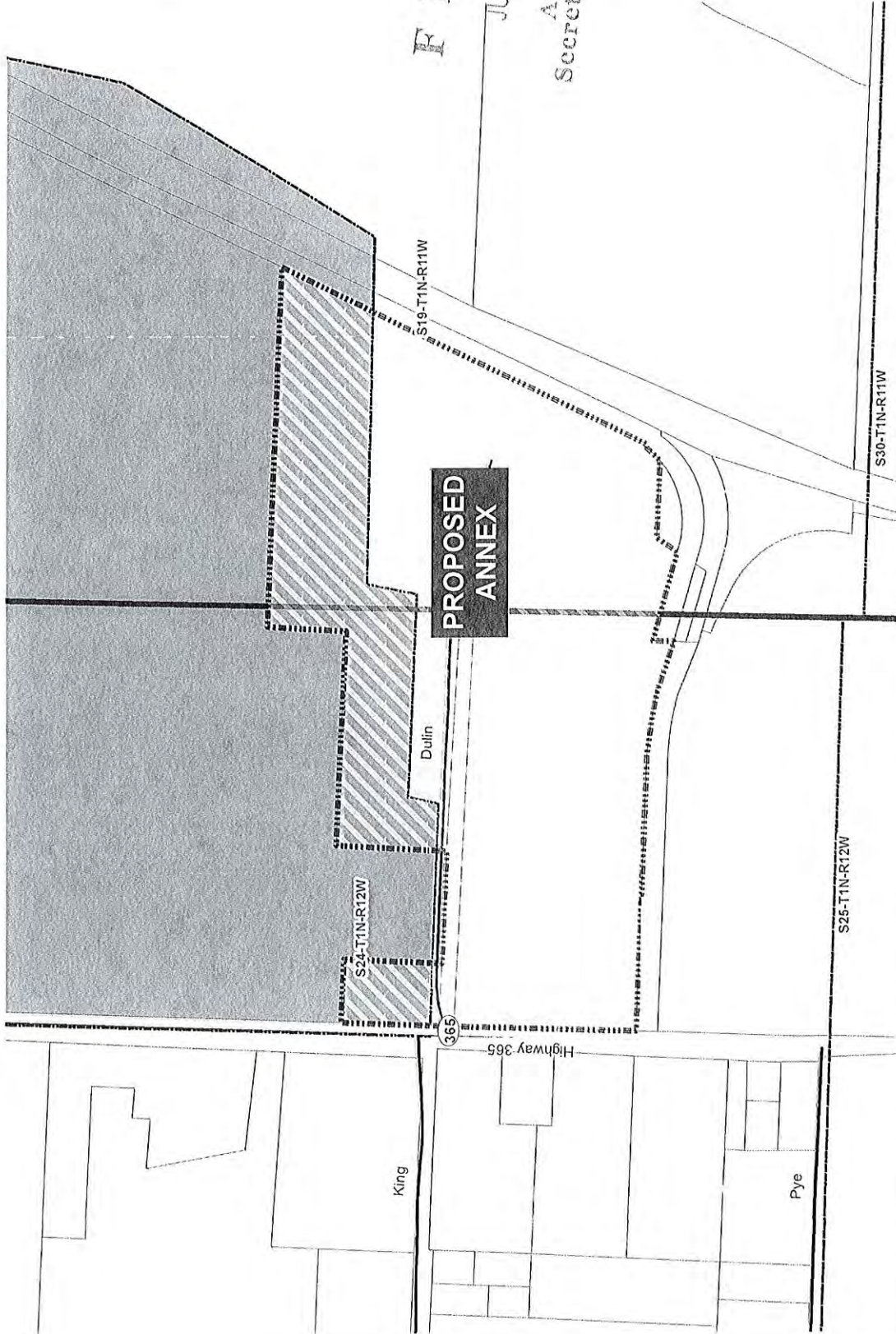

Proposed Annex: City of Little Rock  
July 2016

City: Little Rock  
Mayor: Mark Stoddola

Arkansas Code 14-40-101.

Before an entity undertakes an annexation, consolidation, or detachment proceeding under this chapter, the entity shall coordinate with the Arkansas Geographic Information Systems Office for preparation of legal descriptions and digital mapping for the relevant annexation, consolidation, and detachment areas.

The map contained herein, in evidence, the entity has met requirements of Act 914 of 2015

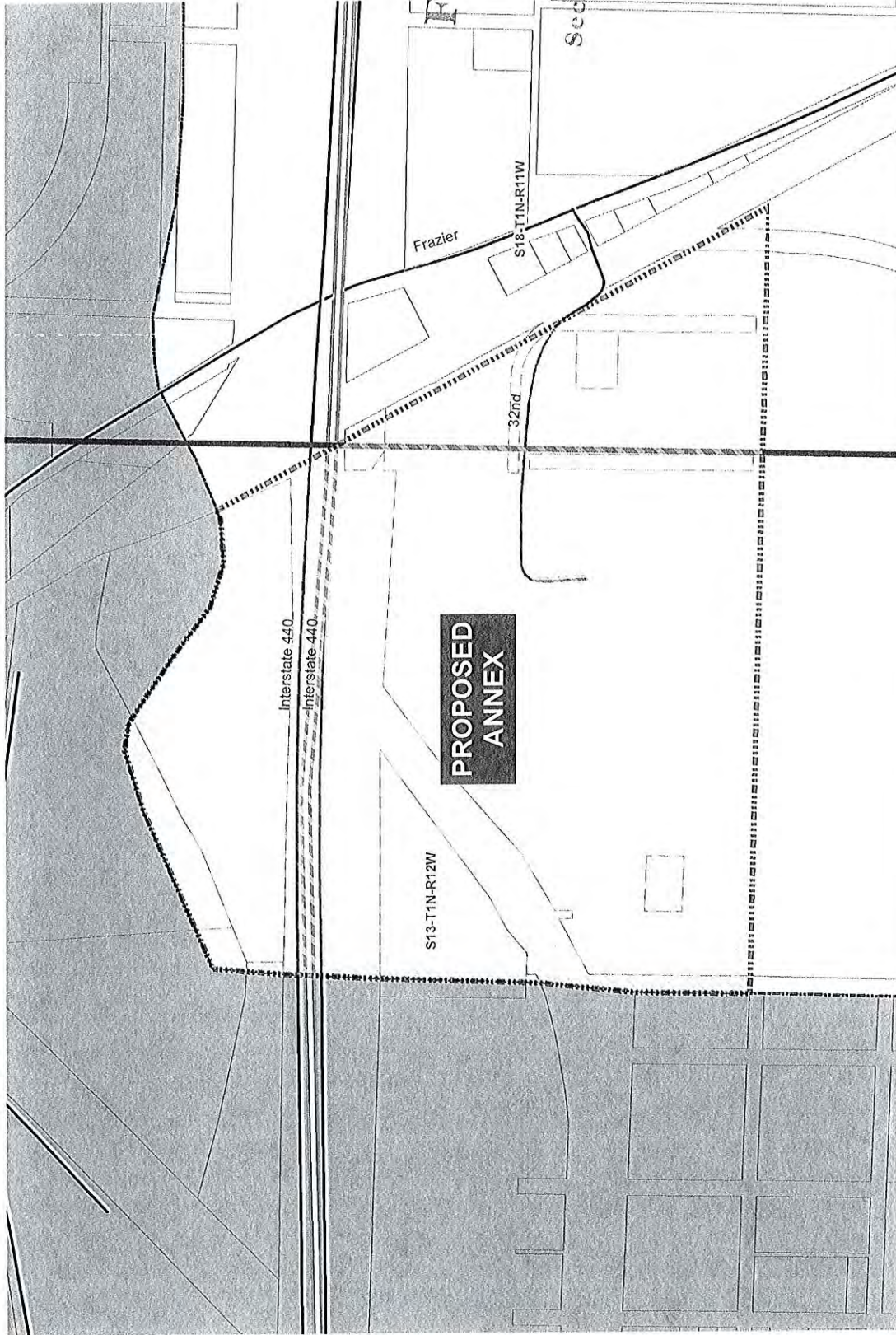
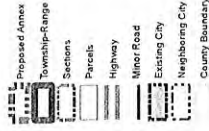

FILED

JUN 29 2017

Arkansas  
Secretary of State

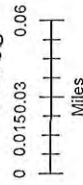

ARKANSAS  
GIS OFFICE

Little Rock-20160120