



## ARKANSAS SECRETARY OF STATE

MARK MARTIN

June 29, 2019

The Honorable Larry Crane  
Pulaski County Clerk  
401 W Markham St  
Little Rock, AR 72201

Re: City of Little Rock Annexation Ordinance 21187

Dear Mr. Crane,

This letter acknowledges receipt and filing of the following notice of municipal boundary change by the Office of the Secretary of State:

Filing Type: Annexation pursuant to A.C.A § 14-40-602 (petition by a majority of the landowners)

Effective Date: unknown

County: Pulaski

City: Little Rock

City Ordinance: 21187

Dated: 03/01/2016

County Court Order: 2016-0009

Filed: 01/12/2016

Honorable Barry Hyde, Pulaski County Judge

A file marked copy of the ordinance and exhibits submitted to our Office are enclosed. By copy of this letter (and its enclosures), the Secretary of State hereby notifies the appropriate mapping authorities for Arkansas. Please retain these copies as official record of the filing of the municipal boundary change by the Arkansas Secretary of State.

If you have any questions or concerns regarding this pending filing please contact our office at 501-682-3401.

Sincerely,

A handwritten signature in cursive script that reads "Cynthia Fisher".

Cynthia Fisher  
Arkansas Secretary of State Legal Division  
500 Woodlane St  
Little Rock, AR 72201  
501-682-3401

cc: Arkansas Geographic Information Systems Office (w/ encl)  
Arkansas Highway and Transportation Department Mapping Department (w/ encl)  
Department of Finance and Administration (w/encl)  
Arkansas Public Service Commission (w.encl)  
UALR Institution for Economic Advancement (w/encl)  
Tom-Tom (w/encl)  
Ms. Susan Langley, Little Rock City Clerk (w/encl)





# Arkansas Secretary of State

**Mark Martin** Arkansas Secretary of State, 500 Woodlane Ave, Little Rock, AR 72201-1094

## Municipal Boundary Change Checklist

County: Pulaski City/Town: Little Rock

City Ordinance/Resolution No: 21,187 Date approved: 03/01/2016

County Court Case No: 2016-0009 Date Order Filed: 01/12/2016

Type: Annexation by Petition majority of Landowners A.C.A §14-40-602

Date Change Effective: \_\_\_\_\_ Set by:  Municipal Ordinance  Emergency Clause  Default  
*(Required by Act 653 of 2017)*

For Circuit Court Challenge: Date Order Filed: \_\_\_\_\_  Upheld  Overturned  Other *(attach explanation)*

### Initiating party:

All Landowners  Majority Landowners  Municipal Governing Body  State  Other \_\_\_\_\_

### Supporting Documentation attached *(check all that apply):*

- File marked copy of City Ordinance/Resolution *(required)*
- File marked copy of County Court Order *(required except for island annexation and annexation approved by election)*
- Copy of Arkansas GIS Office approved printed map and certification letter *(required)*
- Proof of Publication for all Legal Notices *(include Hearing, Election, and City Ordinance/Resolution notices)*
- File marked copy of Petition Part or File marked copy of the certified special election results *(if applicable)*
- File marked copy of Complaint and final Circuit Court Order *(Court Challenge only)*

### Municipal Contact:

Name: Ms. Susan Langley Title: Little Rock City Clerk

Street Address: 500 W. Markham, Suite 200

City: Little Rock St: AR Zip code: 72201

*Complete one form per ordinance/resolution, attach it as a cover page to the supporting document set and submit to the County Clerk's Office within 45 days of the Effective Date as required by Act 655 of 2017*

### County Official:

Signature: \_\_\_\_\_ Title: \_\_\_\_\_

Date: \_\_\_\_\_

*Pursuant to Act 655 of 2017, County Officials must submit a file-marked copy of municipal boundary change documentation within 30 days of receipt to: Arkansas Secretary of State, Attn: Municipal Boundary Filing, 500 Woodlane Ave Suite 256, Little Rock, AR 72201-1094*

Office of the Arkansas Secretary of State use only

Received by: *Cynthia Tucker*

**FILED**  
JUN 29 2017  
Arkansas  
Secretary of State

LARRY CRANE  
PULASKI CIRCUIT/COUNTY CLERK



401 WEST MARKHAM STREET, SUITE 103  
LITTLE ROCK, ARKANSAS 72201  
(501)340-8766 Fax (501)340-8884

June 6, 2017

Hon. Mark Martin  
Arkansas Secretary of State  
State Capitol, Suite 256  
500 Woodlane Ave.  
Little Rock, AR 72201

Re: Annexations

To whom it may concern:

Enclosed, find certified copies of the Annexations: Little Rock Ordinance numbers No.21,362, No.21,187, and No.20,948.

Douglas A. DalPorto  
Supervisor, Records



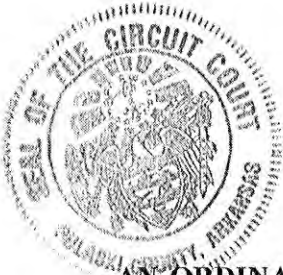

2016013344

PRESENTED: 03-07-2016 10:17:57 AM RECORDED: 03-07-2016 10:22:35 AM

**ORDINANCE NO. 21,187**

In Official Records of Larry Crane Circuit/County Clerk  
PULASKI CO, AR FEE \$20.00  
FILED 03-07-2016  
Larry Crane Pulaski Circuit/County Clerk

**AN ORDINANCE TO ACCEPT THE KANIS RIDGE ANNEXATION (A-326), TO ADD CERTAIN LANDS TO THE CITY OF LITTLE ROCK, ARKANSAS; AND FOR OTHER PURPOSES.**

**WHEREAS**, a petition for voluntary annexation (the "Petition") was filed with the County Clerk of Pulaski County, Arkansas, by the owner of hereinafter designated lands praying that said lands be annexed to and made part of the City of Little Rock, Arkansas; and,

**WHEREAS**, on January 12, 2016, the County Court of Pulaski County, Arkansas, found that the Petition was signed by a majority of the total number of the residential property owners of the area to be annexed and by the owners of some 9.4 acres of said area; and,

**WHEREAS**, said lands are contiguous to and adjoining the present corporate limits of the City of Little Rock; and,

**WHEREAS**, an accurate map of said lands has been filed with and made a part of said Petition; and,

**WHEREAS**, proper notice has been given for the time and in the manner prescribed by law; and,

**WHEREAS**, all things pertaining thereto have been done in the manner prescribed by law and that said lands should be annexed to and made part of the City of Little Rock.

**NOW, THEREFORE, BE IT ORDAINED BY THE BOARD OF DIRECTORS OF THE CITY OF LITTLE ROCK, ARKANSAS:**

**SECTION 1.** The following described territory contiguous and adjoining the City of Little Rock, Arkansas is accepted as annexed to and made a part of the City of Little Rock, Pulaski County, Arkansas, to wit:

**KANIS RIDGE**  
**ANNEXATION (A-326)**

Tract 10, Sachs' Suburban Subdivision, filed for record Book 2, Phase 87, Records of Pulaski County, Arkansas, lying in the Southeast Quarter of Section 6, Township 1 North, Range 13 West, Pulaski County, Arkansas more particularly described as described as follows:

Beginning at a found one (1)-inch bolt at the southeast corner of Summit Ridge Subdivision south 01 degrees 47 minutes 13 seconds west 320.98 feet; thence north 88 degrees 32 minutes 13 seconds west 1,154.74 feet to a point on the north right-of-way line of Kanis Road; thence along said right-of-way north 35 degrees 18 minutes 59 seconds west 397.54 feet; thence leaving said right-of-way south 88 degrees 38

**FILED**

JUN 29 2017

1 minutes 32 seconds east 1,394.57 feet to the point of beginning containing 9.36 acres,  
2 more or less, and including all adjacent and abutting streets and rights-of-way.

3 SECTION 2. The City of Little Rock shall provide police and fire protection and assume  
4 maintenance responsibility for the portion of Kanis Road fronting said property from the effective date of  
5 the annexation.

6 SECTION 3. *Severability.* In the event any title, section, paragraph, item, sentence, clause, phrase,  
7 or word of this ordinance is declared or adjudged to be invalid or unconstitutional, such declaration or  
8 adjudication shall not affect the remaining portions of the ordinance which shall remain in full force and  
9 effect as if the portion so declared or adjudged invalid or unconstitutional was not originally a part of the  
10 ordinance.

11 SECTION 4. *Repealer.* All ordinances or resolutions of the City in conflict herewith are hereby  
12 repealed to the extent of such conflict.

13 PASSED: March 1, 2016

14 ATTEST:

15   
16 \_\_\_\_\_  
17 Susan Langley, City Clerk

APPROVED:

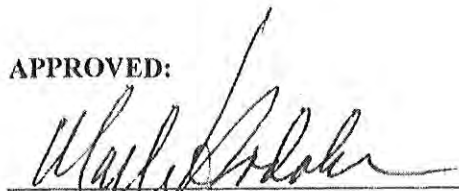
18   
19 \_\_\_\_\_  
20 Mark Stodola, Mayor

21 APPROVED AS TO LEGAL FORM:

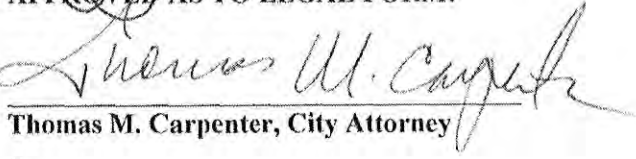
22   
23 \_\_\_\_\_  
24 Thomas M. Carpenter, City Attorney

25 //  
26 //  
27 //  
28 //  
29 //  
30 //  
31 //  
32 //  
33 //  
34 //  
35 //



IN THE COUNTY COURT OF PULASKI COUNTY, ARKANSAS IN THE  
MATTER OF THE ANNEXATION OF PROPERTY LOCATED IN SECTION 6,  
TOWNSHIP 1 NORTH, RANGE 13 WEST, KANIS RIDGE ESTATES SUBDIVISION

ORDER

On this Tuesday, January 12, 2016 comes on for public hearing the petition for annexation to the City of Little Rock, Arkansas, of the lands described in the caption hereof and hereinafter described, the original of said written petition for annexation being presented to the Court by Holloway Engineering, Surveying & Civil Design, PLLC who is named in said petition as the person authorized to act in behalf of the petitioners; and after hearing said verified petition, viewing the signatures thereto, and hearing the testimony of witnesses taken orally before the Court in support of said petition, it is established to the satisfaction of the Court: that said petition for annexation was presented to this Court on the 12th day of January, 2016 at which time the Court fixed \_\_\_\_\_ in the office of the County Judge of Pulaski County, Arkansas, in the Courthouse, Little Rock, Arkansas, as the time and place for a public hearing on said petition; that said petition was duly filed in the office of the County Clerk of Pulaski County, Arkansas, on the 9th day of December, 2015 since which time it has continuously been there kept subject to the inspection of any person or persons interested; that petitioners, and the said Holloway Engineering, Surveying & Civil Design, PLLC acting in behalf of petitioners, caused a notice to be published on December 17, 2015, December 24, 2015, and December 31, 2015 being once a week for three consecutive weeks, in the Arkansas Democrat Gazette, a newspaper having a general circulation in Pulaski County, Arkansas, containing the substance of said petition and stating the said

7011111  
2016-01-12 10:00 AM

**P U L A S K I C O U N T Y**

JUN 29 2017

Arkansas  
Secretary of State

time and the said place appointed for the hearing thereof in all things as provided by law as more fully appears from the proof of publication of said notice heretofore duly filed with the Clerk of this Court in this proceeding; that the area described in said petition and notice and hereinafter described is contiguous to and adjoining the City of Little Rock, Arkansas; that said petition has been signed by a majority of the total number of real estate owners in said area proposed to be annexed, the signers of said petition being the sole and absolute owners of the fee simple title to more than one-half of the acreage in the area proposed to be annexed and hereinafter described; that the requirements for signatures on said petition under the laws of the State of Arkansas have been fully complied with; that the limits of the area proposed to be annexed have been accurately described in both said petition and said notice; that an accurate map of said area proposed to be annexed plainly showing the limits thereof has been made, is attached to, and was filed with said petition; that the allegations of said petition for annexation are sustained by the proof; that the prayer of said petition is right and proper, that this Court has jurisdiction of this matter, and the Court being satisfied of all of the foregoing doth find that said petition should be, and the same is hereby, granted.

IT IS THEREFORE, CONSIDERED, ORDERED AND ADJUDGED by the Court that the following described area, all lying wholly within Pulaski County, Arkansas, to-wit:

Legal Description:

Tract 10, Sachs' Suburban Subdivision, filed for record Book 2, Phase 87, Records of Pulaski County, Arkansas, lying in the Southeast Quarter of Section 6, Township 1 North, Range 13 West, Pulaski County, Arkansas more particularly described as follows:

Beginning at a found 1" bolt at the Southeast Corner of Summit Ridge Subdivision South 01 degrees 47 minutes 13 seconds West 320.98 feet; thence North 88 degrees 32 minutes 13 seconds West 1,154.74 feet to a point on the North Right-of-Way Line of Kanis Road; thence along said Right-of-Way North 35 degrees 18 minutes 59 seconds West 397.54 feet; thence leaving said Right-of-Way South 88 degrees 38 minutes 32 seconds East 1,394.57 feet to the point of beginning containing 9.36 acres more or less, and including all adjacent and abutting streets and rights-of-way.

be and the same is hereby annexed to and made a part of the City of Little Rock, Pulaski County, Arkansas, as authorized and provided by law.

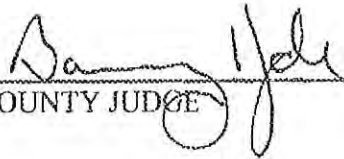
  
COUNTY JUDGE

APPROVED

  
NAME

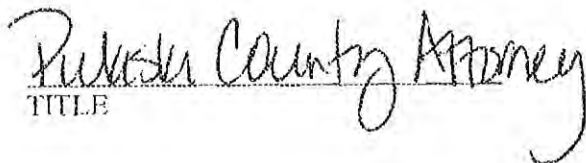
  
TITLE



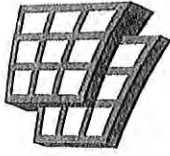

ARKANSAS  
GIS OFFICE

---

March 23, 2016

Walter Malone, Department of Planning  
City of Little Rock  
723 West Markham St  
Little Rock AR 72201

RE: City of Little Rock Annexation Coordination Requirement

Mr. Malone,

Thank you for coordinating with our office as you seek to annex property into the City of Little Rock, AR situated along the west side of the 15000 block of Kanis Road. This letter represents confirmation that you have properly coordinated with our office (Arkansas GIS Office) as specified in § 14-40-101 (Act 914 of 2015) of the 90<sup>th</sup> General Assembly.

Our office will wait completion of any additional steps necessary for the proposed boundary change, which normally comes from the Arkansas Secretary of State Elections Division after any appropriate filing by your County Clerk.

Thank you,

Shelby D Johnson, Director  
/sdj

FILED

JUN 29 2017

Arkansas  
Secretary of State

Proposed Annex: City of Little Rock  
June 2016

City: Little Rock  
Mayor: Mark Stodola

Arkansas Code 14-40-101.  
Before an entity undertakes an annexation, consolidation, or detachment proceeding under this chapter, the entity shall coordinate with the Arkansas Geographic Information Systems Office for preparation of legal descriptions and digital mapping for the relevant annexation, consolidation, and detachment areas.

The map contained herein, in evidence, the entity has met requirements of Act 914 of 2015

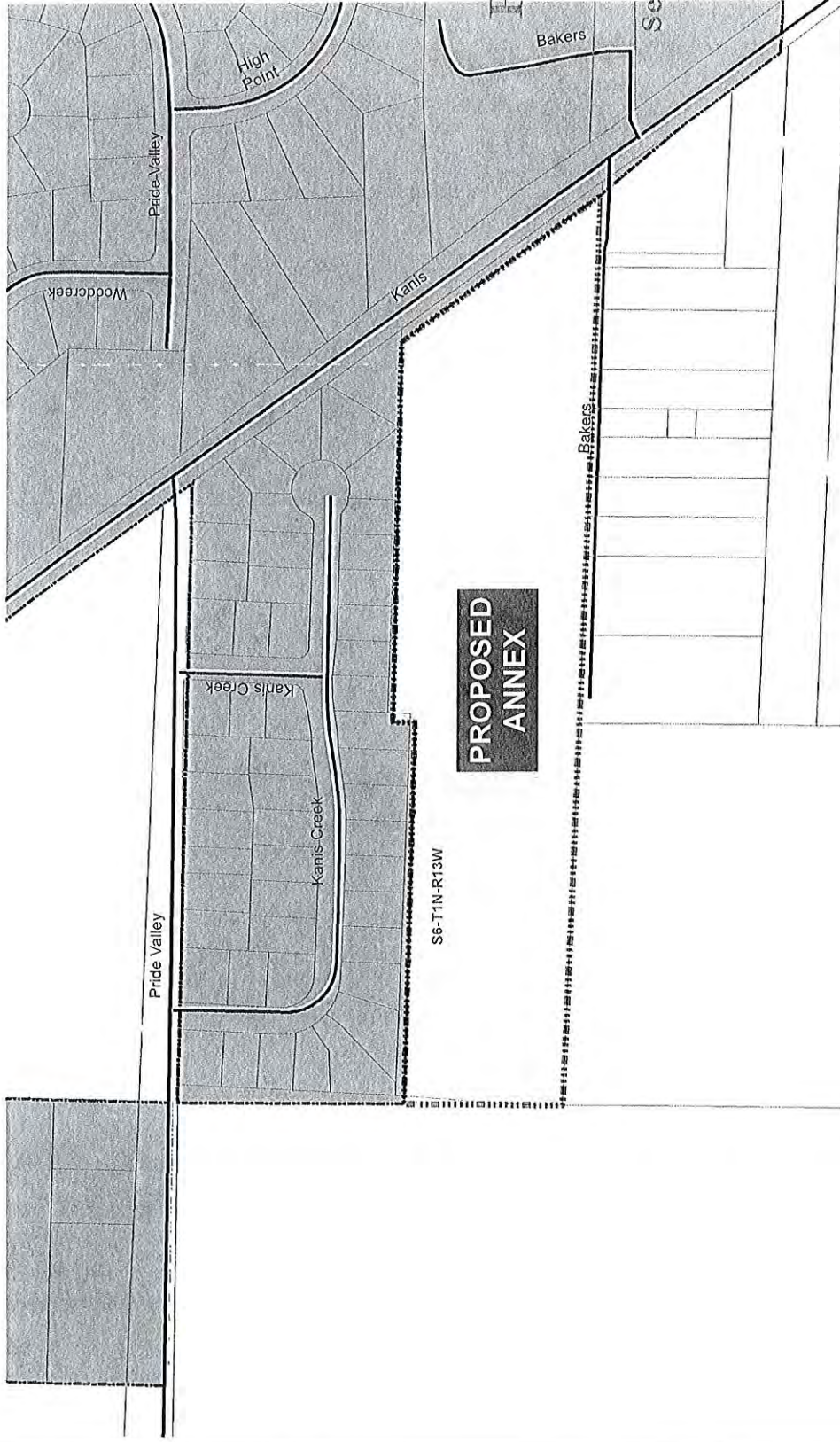

- Proposed Annex
- Township-Range
- Sections
- Plat
- Highway
- Minor Road
- Existing City
- Neighboring City
- County Boundary

**PROPOSED ANNEX**

F I L L E D

JUN 29 2017

Arkansas  
Secretary of State

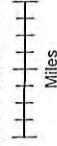

ARKANSAS  
GIS OFFICE

Little Rock-20160318