



**ARKANSAS SECRETARY OF STATE**  
**MARK MARTIN**

February 15, 2018

The Honorable Larry Crane  
Pulaski County Clerk  
401 W Markham St  
Little Rock, AR 72201

Re: City of Little Rock Annexation Ordinance 21508

Dear Mr. Crane,

This letter acknowledges receipt and filing of the following notice of municipal boundary change by the Office of the Secretary of State:

Filing Type: Annexation pursuant to A.C.A § 14-40-609 (petition by 100% of the landowners)

Effective Date: 12/21/2017

County: Pulaski

City: Little Rock

City Ordinance: 21508

Dated: 11/21/2017

County Court Order: CI 2017-021

Filed: 10/06/2017

Honorable Barry Hyde, Pulaski County Judge

A file marked copy of the ordinance, court order and exhibits submitted to our Office are enclosed. By copy of this letter (and its enclosures), the Secretary of State hereby notifies the appropriate mapping authorities for Arkansas. Please retain these copies as official record of the filing of the municipal boundary change by the Arkansas Secretary of State.

If you have any questions or concerns regarding this pending filing, please contact our office at 501-682-3401.

Sincerely,

A handwritten signature in cursive script that reads "Cynthia Fisher".

Cynthia Fisher  
Arkansas Secretary of State Legal Division  
500 Woodlane St, Room 256  
Little Rock, AR 72201  
501-682-3401

cc: Arkansas Geographic Information Systems Office (w/ encl)  
Arkansas Highway and Transportation Department Mapping Department (w/ encl)  
Department of Finance and Administration (w/encl)  
Arkansas Public Service Commission (w.encl)  
UALR Institution for Economic Advancement (w/encl)  
Tom-Tom (w/encl)  
Ms. Susan Langley, Little Rock City Clerk (w/encl)



# Arkansas Secretary of State

**Mark Martin** Arkansas Secretary of State, 500 Woodlane Ave, Little Rock, AR 72201-1094

## Municipal Boundary Change Checklist

County: Pulaski City/Town: Little Rock

City Ordinance/Resolution No: 21,508 Date approved: 11/21/2017

County Court Case No: CI 2017-021 Date Order Filed: 10/06/2017

Type: Annexation by Petition of all Landowners A.C.A §14-40-609

Date Change Effective: 12/21/2017 Set by:  Municipal Ordinance  Emergency Clause  Court  Default  
*(Required by Act 653 of 2017)*

For Circuit Court Challenge: Date Order Filed: \_\_\_\_\_  Upheld  Overturned  Other *(attach explanation)*

### Initiating party:

All Landowners  Majority Landowners  Municipal Governing Body  State  Other \_\_\_\_\_

### Supporting Documentation attached *(check all that apply):*

- File marked copy of City Ordinance/Resolution *(required)*
- File marked copy of County Court Order or certified annexation election results *(required except for island annexation)*
- Copy of Arkansas GIS Office approved printed map and certification letter *(required)*
- Proof of Publication for all Legal Notices *(include Hearing, Election, and City Ordinance/Resolution notices)*
- File marked copy of Petition Part *(if applicable)*
- File marked copy of Complaint and final Circuit Court Order *(Court Challenge only)*

### Municipal Contact:

Name: Ms. Susan Langley Title: Little Rock City Clerk

Street Address: 200 W Markham St, Rm 200

City: Little Rock St: AR Zip code: 72201

*Complete one form per ordinance/resolution, attach it as a cover page to the supporting document set and submit to the County Clerk's Office within 45 days of the Effective Date as required by Act 655 of 2017*

### County Official:

Signature: \_\_\_\_\_ Title: Pulaski County Clerk

Date: 02/07/2018

*Pursuant to Act 655 of 2017, County Officials must submit a file-marked copy of municipal boundary change documentation within 30 days of receipt to: Arkansas Secretary of State, Attn: Municipal Boundary Filing, 500 Woodlane Ave Suite 256, Little Rock, AR 72201-1094*

Office of the Arkansas Secretary of State use only

Received by: *Cynthia Fisher*

FILED  
FEB 7 2018  
LITTLE ROCK  
Arkansas Secretary of State

LARRY CRANE  
PULASKI CIRCUIT/COUNTY CLERK



401 WEST MARKHAM STREET, SUITE 103  
LITTLE ROCK, ARKANSAS 72201  
(501)340-8766 Fax (501)340-8884

February 7, 2018

Cynthia Fisher  
Arkansas Secretary of State Legal Division  
500 Woodlane St. Room 256  
Little Rock, AR 72201

Re: Little Rock Annexation of Revel Cove

Ms. Fisher,

Enclosed is the certified documentation for Little Rock's Annexation of Revel Cove. If you have any Questions or concerns you can Email me at [ddalporto@pulaskiclerk.com](mailto:ddalporto@pulaskiclerk.com) or call me at (501)340-8766.



Douglas A. DalPorto  
Supervisor, Court Records



**FILED**



NOV 30 2017 ORDINANCE NO. 21,508 PULASKI CO, AR FEE \$20.00

**LARRY CRANE  
CIRCUIT COUNTY CLERK**

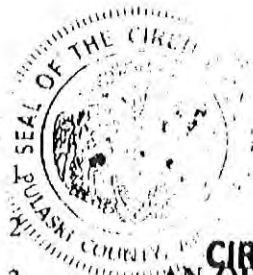

3 AN ORDINANCE TO ACCEPT THE REVEL COVE ANNEXATION (A-  
4 330), TO ADD CERTAIN LANDS TO THE CITY OF LITTLE ROCK,  
5 ARKANSAS; AND FOR OTHER PURPOSES.

7 **WHEREAS**, a petition for voluntary annexation (the "Petition") was filed with the County Clerk of  
8 Pulaski County, Arkansas, by the owner of hereinafter designated lands praying that said lands be annexed  
9 to and made part of the City of Little Rock, Arkansas; and,

10 **WHEREAS**, the County Court of Pulaski County, Arkansas, found that the Petition was signed by all  
11 the real property owners of the area to be annexed and the annexation request met all requirements of  
12 Arkansas Code 14-40-609; and,

13 **WHEREAS**, the Pulaski County Judge has signed an Annexation Order for the site requesting  
14 annexation (on October 6, 2017); and,

15 **WHEREAS**, an accurate map of said lands has been filed with and made a part of said Petition; and,

16 **WHEREAS**, proper notice has been given for the time and in the manner prescribed by law; and,

17 **WHEREAS**, all things pertaining thereto have been done in the manner prescribed by law and that said  
18 lands should be annexed to and made part of the City of Little Rock.

19 **NOW, THEREFORE, BE IT ORDAINED BY THE BOARD OF DIRECTORS OF THE CITY**  
20 **OF LITTLE ROCK, ARKANSAS:**

21 **Section 1.** The following described territory contiguous and adjoining the City of Little Rock,  
22 Arkansas is accepted as annexed to and made a part of the City of Little Rock, Pulaski County, Arkansas,  
23 to wit:

24 **A-330 - Revel Cove Annexation:** A part of the SW1/4 NW1/4 of Section 6, T-1-N,  
25 R-13-W, Pulaski County, Arkansas, being more particularly described as follows:  
26 beginning at the southwest corner of the said SW1/4 NW1/4; Thence N 01° 18' 33"  
27 E, along the west line of said Section 6, a distance of 1165.00 feet; Thence  
28 S89°04'21"E, a distance of 382.20 feet; Thence S 00° 59' 17" W, a distance of  
29 465.00 feet; Thence N 89° 04' 15" W, a distance of 46.09 feet; Thence S 01° 39' 12"  
30 W, a distance of 700.00 feet to the south line of the said SW1/4 NW1/4; Thence  
31 N 89° 04'40"W, along said south line, a distance of 334.51 feet to the point of  
32 beginning, containing 9.5028 acres, more or less. **LESS & EXCEPT** any part of  
33 subject property condemned in Circuit Court Case No. 89-3386, records of Pulaski  
34 County, Arkansas. And all adjacent public streets and right-of-ways abutting said  
35 tract.

**FILED**  
Secretary of State

1       **Section 2.** The City of Little Rock, Arkansas, shall provide police and fire protection; assume  
2 maintenance responsibility for the portion of Pride Valley Road fronting said property; make available  
3 Code and other services of the City; and allow the applicant to extend service lines to the Little Rock Waste  
4 Water System and Central Arkansas Water system from the effective date of the annexation.

5       **Section 4. Severability.** In the event any title, section, paragraph, item, sentence, clause, phrase, or  
6 word of this ordinance is declared or adjudged to be invalid or unconstitutional, such declaration or  
7 adjudication shall not affect the remaining portions of the ordinance which shall remain in full force and  
8 effect as if the portion so declared or adjudged invalid or unconstitutional was not originally a part of the  
9 ordinance.

10       **Section 5. Repealer.** All ordinances or resolutions of the City in conflict herewith are hereby repealed  
11 to the extent of such conflict.

12 **PASSED: November 21, 2017**

13 **ATTEST:**

14   
15 \_\_\_\_\_  
16 Susan Langley, City Clerk

**APPROVED:**

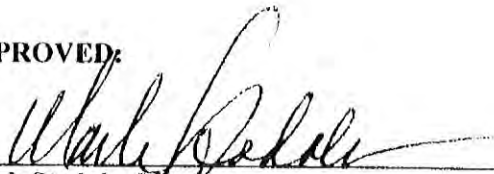
  
17 \_\_\_\_\_  
18 Mark Stodola, Mayor

17 **APPROVED AS TO LEGAL FORM:**

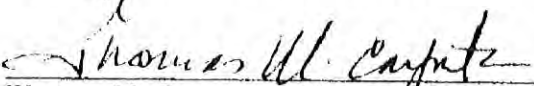
18   
19 \_\_\_\_\_  
20 Thomas M. Carpenter, City Attorney

21 //  
22 //  
23 //  
24 //  
25 //  
26 //  
27 //  
28 //  
29 //  
30 //  
31 //  
32 //  
33 //  
34 //  
35 //  
36 //

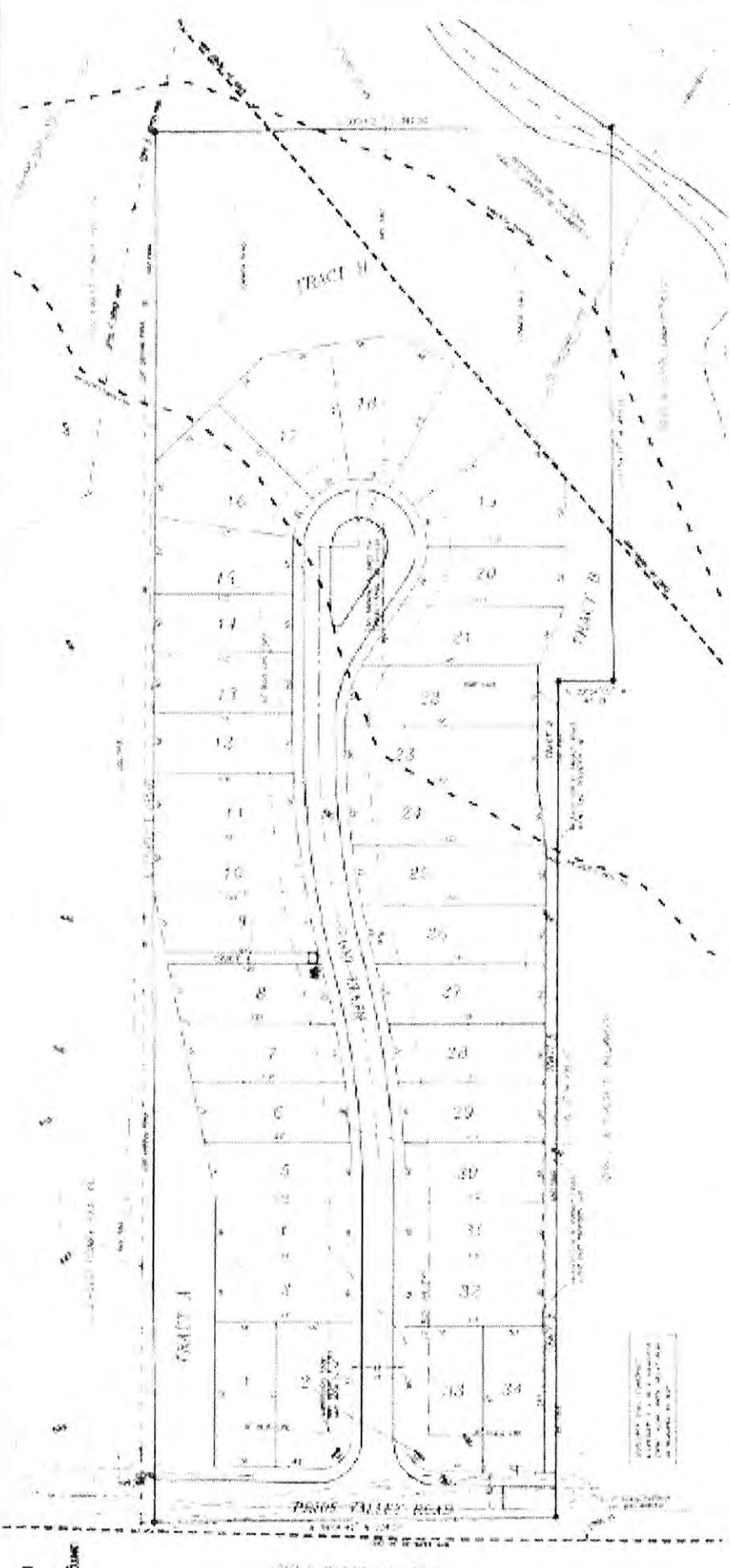

**FILED**  
 JUL 24 2017  
 CLERK OF COURTS  
 HARRIS COUNTY TEXAS

**PLANNED RESIDENTIAL DEVELOPMENT**

LOTS 1 - 34  
 TRACTS A, B, C

**REVEL COVE**

AN ADDITION TO THE CITY OF  
 LITTLE ROCK ARKANSAS

JULY 24, 2017  
 REVISED AUGUST 14, 2017

REGISTERED  
 SURVEYOR  
 NO. 17181

BERNARD J. BARNETT, INC.

- 1. The owner of the property is: [Name]
- 2. The name of the subdivision is: [Name]
- 3. The name of the subdivision is: [Name]
- 4. The name of the subdivision is: [Name]
- 5. The name of the subdivision is: [Name]
- 6. The name of the subdivision is: [Name]
- 7. The name of the subdivision is: [Name]
- 8. The name of the subdivision is: [Name]
- 9. The name of the subdivision is: [Name]
- 10. The name of the subdivision is: [Name]
- 11. The name of the subdivision is: [Name]
- 12. The name of the subdivision is: [Name]
- 13. The name of the subdivision is: [Name]
- 14. The name of the subdivision is: [Name]
- 15. The name of the subdivision is: [Name]
- 16. The name of the subdivision is: [Name]
- 17. The name of the subdivision is: [Name]
- 18. The name of the subdivision is: [Name]
- 19. The name of the subdivision is: [Name]
- 20. The name of the subdivision is: [Name]
- 21. The name of the subdivision is: [Name]
- 22. The name of the subdivision is: [Name]
- 23. The name of the subdivision is: [Name]
- 24. The name of the subdivision is: [Name]
- 25. The name of the subdivision is: [Name]
- 26. The name of the subdivision is: [Name]
- 27. The name of the subdivision is: [Name]
- 28. The name of the subdivision is: [Name]
- 29. The name of the subdivision is: [Name]
- 30. The name of the subdivision is: [Name]
- 31. The name of the subdivision is: [Name]
- 32. The name of the subdivision is: [Name]
- 33. The name of the subdivision is: [Name]
- 34. The name of the subdivision is: [Name]

1. The owner of the property is: [Name]

2. The name of the subdivision is: [Name]

3. The name of the subdivision is: [Name]

4. The name of the subdivision is: [Name]

5. The name of the subdivision is: [Name]

6. The name of the subdivision is: [Name]

7. The name of the subdivision is: [Name]

8. The name of the subdivision is: [Name]

9. The name of the subdivision is: [Name]

10. The name of the subdivision is: [Name]

11. The name of the subdivision is: [Name]

12. The name of the subdivision is: [Name]

13. The name of the subdivision is: [Name]

14. The name of the subdivision is: [Name]

15. The name of the subdivision is: [Name]

16. The name of the subdivision is: [Name]

17. The name of the subdivision is: [Name]

18. The name of the subdivision is: [Name]

19. The name of the subdivision is: [Name]

20. The name of the subdivision is: [Name]

21. The name of the subdivision is: [Name]

22. The name of the subdivision is: [Name]

23. The name of the subdivision is: [Name]

24. The name of the subdivision is: [Name]

25. The name of the subdivision is: [Name]

26. The name of the subdivision is: [Name]

27. The name of the subdivision is: [Name]

28. The name of the subdivision is: [Name]

29. The name of the subdivision is: [Name]

30. The name of the subdivision is: [Name]

31. The name of the subdivision is: [Name]

32. The name of the subdivision is: [Name]

33. The name of the subdivision is: [Name]

34. The name of the subdivision is: [Name]

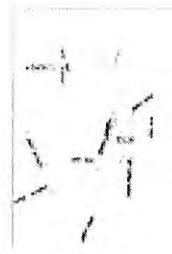

**FILED**

FEB 06 2018

IN THE COUNTY COURT OF PULASKI COUNTY, ARKANSAS

IN THE MATTER OF THE ANNEXATION OF  
CERTAIN TERRITORY LOCATED WITHIN  
SW ¼ NW ¼ OF SECTION 6, TOWNSHIP 1 NORTH,  
RANGE 13 WEST TO THE CITY OF LITTLE ROCK,  
PULASKI COUNTY, ARKANSAS

**LARRY CRANE**  
**CIRCUIT COUNTY CLERK**

NO. 2017-021

2018-0356

**ORDER OF CONFIRMATION OF ANNEXATION**

On this day is presented to the Court a certified copy of the Ordinance duly adopted by the Board of Directors of Little Rock, Arkansas on the 21<sup>st</sup> Day of November, 2017 accepting as a part and parcel of the City of Little Rock, Arkansas, in accordance with the order of annexation made and entered by this Court on October 6, 2017, the following area described in both said order of this Court and said Ordinance of the Board of Directors of the City of Little Rock, Arkansas, lying wholly within Pulaski County, Arkansas, to-wit:

**LEGAL DESCRIPTION**

A PART OF THE SW1/4 NW1/4 OF SECTION 6, TOWNSHIP 1 NORTH, RANGE 13 WEST, PULASKI COUNTY, ARKANSAS BEING MORE PARTICULARLY DESCRIBED AS FOLLOWS:

BEGINNING AT THE SOUTHWEST CORNER OF THE SAID SW1/4 NW1/4; THENCE NORTH 01 DEGREES 18 MINUTES 33 SECONDS EAST, ALONG THE WEST LINE OF SAID SECTION 6, A DISTANCE OF 1165.00 FEET; THENCE SOUTH 89 DEGREES 04 MINUTES 21 SECONDS EAST, A DISTANCE OF 382.20 FEET; THENCE SOUTH 00 DEGREES 59 MINUTES 17 SECONDS WEST, A DISTANCE OF 465 FEET; THENCE NORTH 89 DEGREES 04 MINUTES 15 SECONDS WEST, A DISTANCE OF 46.09 FEET; THENCE SOUTH 01 DEGREES 12 MINUTES 12 SECONDS WEST, A DISTANCE OF 700.00 FEET TO THE SOUTH LINE OF SAID SW1/4 NW1/4; THENCE NORTH 89 DEGREES 04 MINUTES 40 SECONDS WEST, ALONG SAID SOUTH LINE, A DISTANCE OF 334.51 FEET TO THE POINT OF BEGINNING, CONTAINING 9.5028 ACRES, MORE OR LESS. AND ALL ADJACENT, ABUTTING AND TRAVERSING ROADS AND RIGHTS-OF-WAY.

And it appearing to the Court that the statements in said Ordinance are true and correct and that no person has given any notice or instituted any proceeding to prevent

**FILED**  
FEB 16 2018  
Arkansas  
Secretary of State

said annexation of said area to the City of Little Rock, Arkansas; it is therefore considered, ordered and adjudged by the Court that the proceeding annexing the area hereinbefore described to and making the same a part and parcel of the City of Little Rock, Arkansas, be and the same is hereby in all things ratified and confirmed.

And the Clerk of this Court is hereby ordered and directed to make and duly certify one copy of the plat of such annexed territory, one copy of the said order of annexation made and entered by this Court on October 6, 2017 and the said Ordinance adopted by the Board of Directors of the City of Little Rock, Arkansas, and forward a copy of each, together with a certified copy of this Order, to the Secretary of State, who shall file and preserve the same; the Clerk of this Court shall forward one copy of the plat of such annexed territory and one copy of said order of annexation made and entered by this Court on October 6, 2017 to the Director of the Tax Division of the Arkansas Public Service Commission so that it may file and preserve the same and so that it may notify all utility companies having property in the City of Little Rock, Arkansas, as provided by law (Ark. Stats. Sec. 19-305 as amended); and, the Clerk of this Court is further ordered and directed to forward a certified copy of said order of annexation made and entered by this Court on October 6, 2017, together with a certified copy of this Order, to the City Clerk of the City of Little Rock, Arkansas.

**IT IS SO ORDERED.**

  
\_\_\_\_\_  
Barry Hyde  
County Judge/Chief Executive Officer

Date: 2/6/18

**A TRUE COPY CERTIFIED THIS**

2-7-18

**LARRY CRANE  
CIRCUIT COUNTY CLERK**

BY:   
\_\_\_\_\_  
**DEPUTY CLERK**

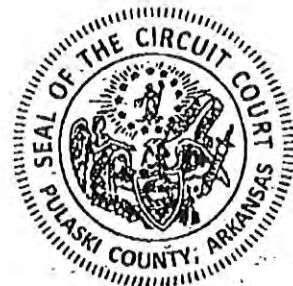



**FILED**

OCT 06 2017

IN THE COUNTY COURT OF PULASKI COUNTY, ARKANSAS

IN THE MATTER OF THE PETITION FOR ANNEXATION OF  
CERTAIN TERRITORY LOCATED WITHIN  
SW ¼ NW ¼ OF SECTION 6, TOWNSHIP 1 NORTH,  
RANGE 13 WEST TO THE CITY OF  
LITTLE ROCK, PULASKI COUNTY, ARKANSAS

**LARRY CRANE  
CIRCUIT COUNTY CLERK**

NO. CI-2017-021

**ORDER**

On Tuesday, September 19, 2017, Petitioner filed its Amended Petition for Annexation pursuant to Arkansas Code Annotated § 14-40-609, which provides a process for annexation of property by a petition of 100% of the owners of the subject property. On Friday, October 5<sup>th</sup> and 6<sup>th</sup>, the county clerk and county assessor, respectively, timely filed verifications recognizing that the petitioners' identities are verified by notarized signature to the Petition; that the Petitioners have attested that the Petitioners own one hundred percent (100%) of the property for which annexation is sought; and that Petitioners attached the letter of Lenders Title Company, a qualified title company, to its Petition, finding ownership in Petitioners and no ownership or interest in any person or entity other than Petitioners; and Petitioners attached the letter of Brian Dale, a professional civil engineer, indicating that the property is contiguous to and adjoins an already established boundary of the City of Little Rock and finding that the proposed annexation will not create an enclave if accepted by the City of Little Rock. This Court, having reviewed the Petition, Attachments and Verifications, is satisfied that all are complete and accurate; that no enclaves will be created by the annexation of the property to the City of Little Rock; confirms that the Petition contains a schedule of services; and hereby issues this Order.

As such:

IT IS THEREFORE, CONSIDERED, ORDERED AND ADJUDGED by the Court that the following described area, all lying wholly within Pulaski County, Arkansas, to wit:

LEGAL DESCRIPTION:

A PART OF THE SW1/4 NW1/4 OF SECTION 6, TOWNSHIP 1 NORTH, RANGE 13 WEST, PULASKI COUNTY, ARKANSAS, BEING MORE PARTICULARLY DESCRIBED AS FOLLOWS:

BEGINNING AT THE SOUTHWEST CORNER OF THE SAID SW1/4 NW1/4;  
THENCE NORTH 01 DEGREES 18 MINUTES 33 SECONDS EAST, ALONG THE

WEST LINE OF SAID SECTION 6, A DISTANCE OF 1165.00 FEET; THENCE SOUTH 89 DEGREES 04 MINUTES 21 SECONDS EAST, A DISTANCE OF 382.20 FEET; THENCE SOUTH 00 DEGREES 59 MINUTES 17 SECONDS WEST, A DISTANCE OF 465 FEET; THENCE NORTH 89 DEGREES 04 MINUTES 15 SECONDS WEST, A DISTANCE OF 46.09 FEET; THENCE SOUTH 01 DEGREES 39 MINUTES 12 SECONDS WEST, A DISTANCE OF 700.00 FEET TO THE SOUTH LINE OF THE SAID SW1/4 NW1/4; THENCE NORTH 89 DEGREES 04 MINUTES 40 SECONDS WEST, ALONG SAID SOUTH LINE, A DISTANCE OF 334.51 FEET TO THE POINT OF BEGINNING, CONTAINING 9.5028 ACRES, MORE OR LESS.

AND ALL ADJACENT, ABUTTING AND TRAVERSING ROADS AND RIGHTS-OF-WAY.

is the subject of this petition and the same may hereby be annexed to and made a part of the City of Little Rock, Pulaski County, Arkansas, as authorized and provided by law.

  
PULASKI COUNTY JUDGE

Order approved as to form and provided by:

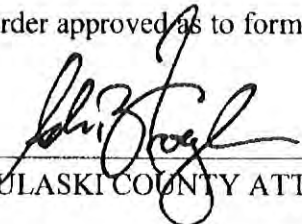
  
PULASKI COUNTY ATTORNEY

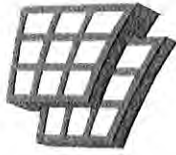

# ARKANSAS GIS OFFICE

August 1, 2017

Mr. Brian Dale, P.E.  
Vice President  
White-Daters & Associates, Inc.  
24 Rahling Circle  
Little Rock, AR 72223

RE: City of Little Rock Annexation Coordination Requirement

Mr. Dale,

Thank you for coordinating with our office as you seek to annex property into the City of Little Rock, AR to be known as Revel Cove located in Section 6, Township 1 North, Range 13 West. This letter represents confirmation that you have properly coordinated with our office (Arkansas GIS Office) as specified in § 14-40-101 (Act 914 of 2015) of the 90<sup>th</sup> General Assembly.

Our office will wait completion of any additional steps necessary for the proposed boundary change, which normally comes from the Arkansas Secretary of State Elections Division after any appropriate filing by your County Clerk.

Thank you,

Jennifer Wheeler, GIS Analyst  
/jjw

**Attachments:**  
GIS Office Map of Proposed Annexation  
Secretary of State Municipal Change Checklist  
Survey of Revel Cove

8-1-17

Secretary of State

H:\City\_Annexations\Cities\Little\_Rock\20170801\Doc\20170801\_LittleRock\_Annexation\_Coordination\_Letter.docx

Proposed Annex: City of Little Rock  
August 2017

City: Little Rock  
Mayor: Mark Stodola

Arkansas Code 14-40-011  
Before an entity undertakes an annexation, consolidation, or detachment proceeding under this chapter, the entity shall coordinate with the Arkansas Geographic Information Systems Office for preparation of legal descriptions and digital mapping for the relevant annexation, consolidation, and detachment areas.  
The map contained herein is advisory; the entity has met requirements of Act 914 of 2015.

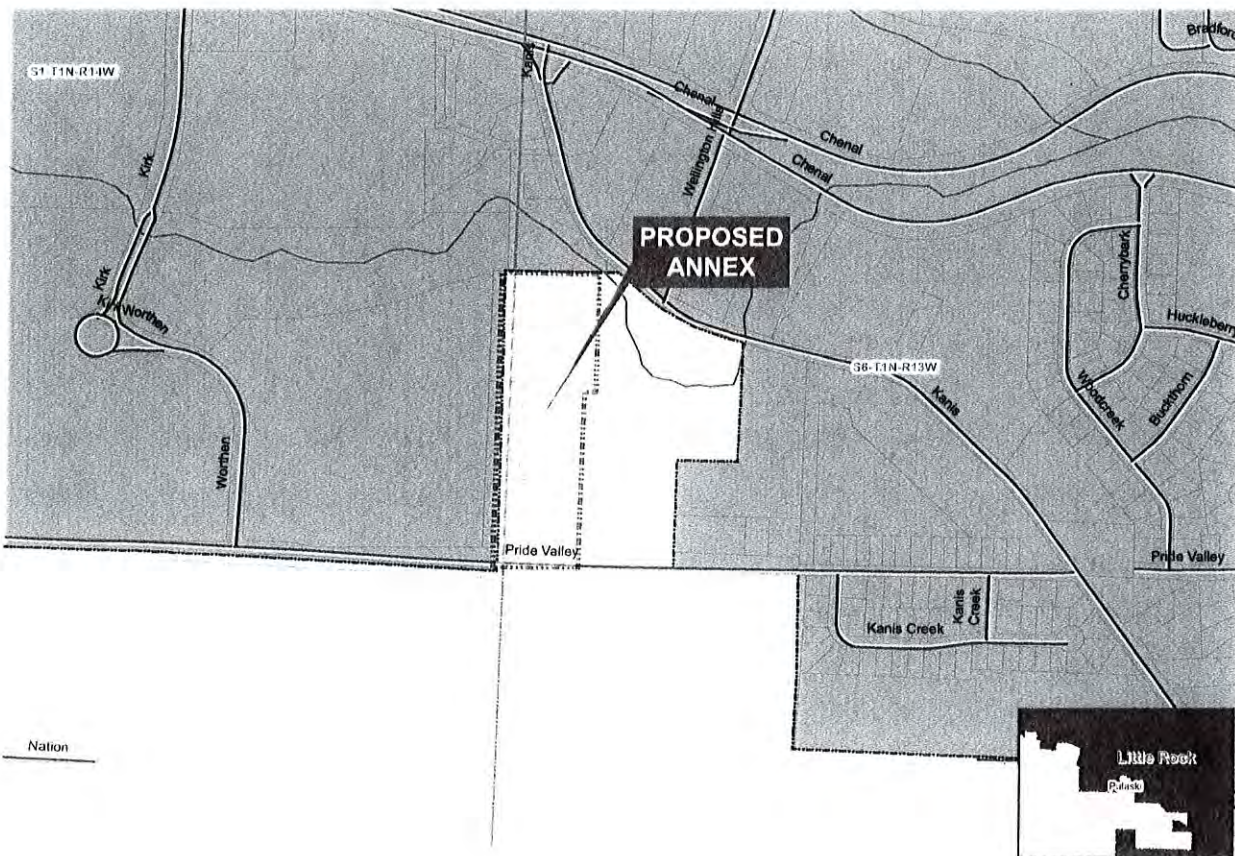

- Proposed Annex
- Incident
- Tactics
- Highway
- Main Road
- Feet Road
- Park
- Urban Core
- Open Water Body
- Existing City
- Study Boundary

0 0.0229 0.045 0.09  
Miles



ARKANSAS  
GIS OFFICE  
City of Little Rock, Dept. of Public Works

FILED  
FF  
Secretary of State



**City of Little Rock**

Office of the  
City Clerk

City Hall - 200  
500 W. Markham Street  
Little Rock, Arkansas 72201-1429  
Phone: (501) 371-6803

**FILED**

DEC 22 2017

**LARRY CRANE  
CIRCUIT COUNTY CLERK**

Pulaski County Clerk's Office

2017-021

401 West Markham St.  
Room 100  
Little Rock, AR 72201

Dear Mr. Crane:

On November 21, 2017, the Little Rock City Board of Directors passed Ordinance No. 21,508, to accept the Revel Code Annexation (A-330); to add certain lands to the City of Little Rock, Arkansas. When my office filed the annexation paperwork with your office, the wrong maps were inadvertently attached to the packet. Please accept the attached corrected maps reflecting the area for the annexation.

Respectfully Submitted,

Susan Langley  
City Clerk

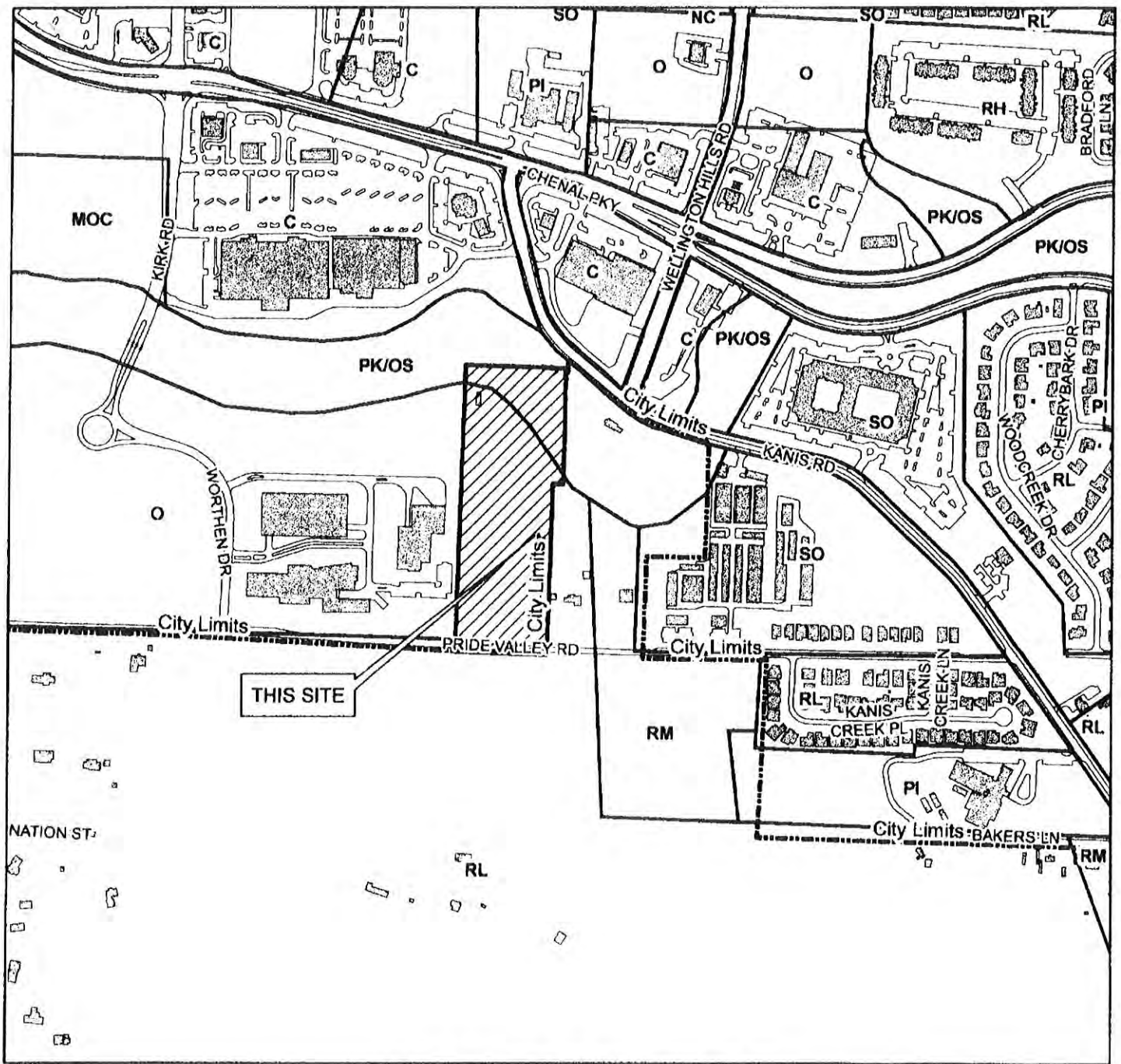

# Land Use Plan

City of Little Rock Planning & Development

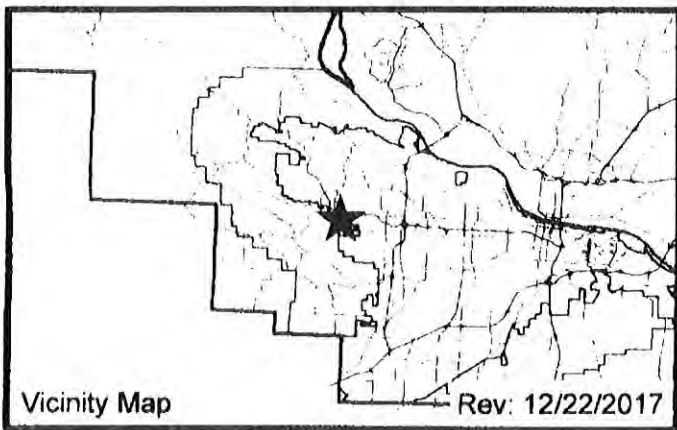

Case: A-330

Location: 15700 Pride Valley Road

Ward: N/A

PD: 18

CT: 42.07

TRS: T1N R13W 6

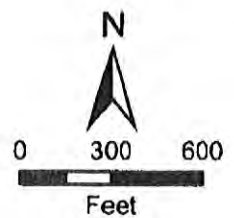

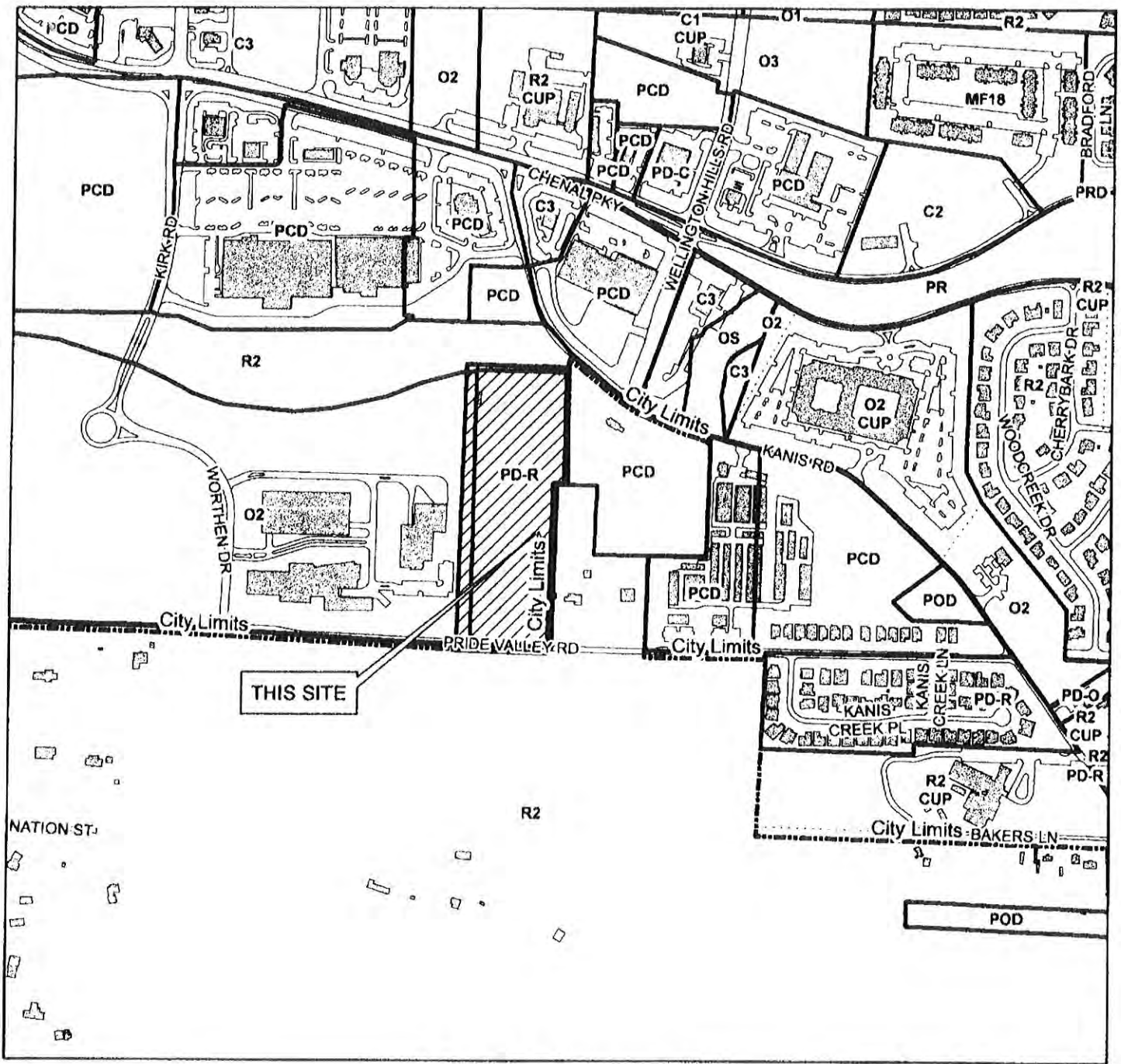

## Area Zoning

City of Little Rock Planning & Development

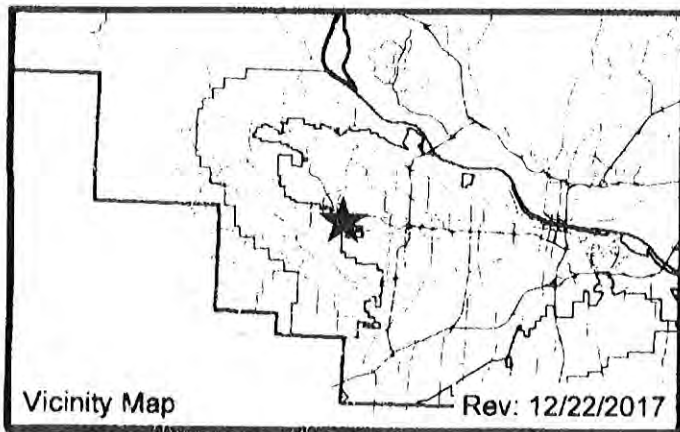

<p><b>Case: A-330</b></p> <p><b>Location: 15700 Pride Valley Road</b></p> <p><b>Ward: N/A</b></p> <p><b>PD: 18</b></p> <p><b>CT: 42.07</b></p> <p><b>TRS: T1N R13W 6</b></p>	<p>0    300    600 Feet</p>
--	---------------------------------