



ARKANSAS SECRETARY OF STATE

MARK MARTIN

December 5, 2018

The Honorable Larry Crane
Pulaski County Clerk
401 W Markham St
Little Rock, AR 72201

Re: City of Little Rock Annexation Ordinance 21615

Dear Mr. Crane,

This letter acknowledges receipt and filing of the following notice of municipal boundary change by the Office of the Secretary of State:

Filing Type: Annexation pursuant to A.C.A § 14-40-609 (petition by 100% of the landowners)

Effective Date: 11/26/2018

County: Pulaski

City: Little Rock

City Ordinance: 21615

Dated: 08/21/2018

County Court Order: CI 2018-16

Filed: 11/26/2018

Honorable Barry Hyde, Pulaski County Judge

A file marked copy of the ordinance, court order and exhibits submitted to our Office are enclosed. By copy of this letter (and its enclosures), the Secretary of State hereby notifies the appropriate mapping authorities for Arkansas. Please retain these copies as official record of the filing of the municipal boundary change by the Arkansas Secretary of State.

If you have any questions or concerns regarding this pending filing, please contact our office at 501-682-3401.

Sincerely,

A handwritten signature in cursive script that reads "Cynthia Fisher".

Cynthia Fisher
Arkansas Secretary of State Legal Division
500 Woodlane St, Room 256
Little Rock, AR 72201
501-682-3401

cc: Arkansas Geographic Information Systems Office (w/ encl)
Arkansas Highway and Transportation Department Mapping Department (w/ encl)
Department of Finance and Administration (w/encl)
Arkansas Public Service Commission (w.encl)
UALR Institution for Economic Advancement (w/encl)
Ms. Susan Langley, Little Rock City Clerk (w/encl)





Arkansas Secretary of State

Mark Martin Arkansas Secretary of State, 500 Woodlane Ave, Little Rock, AR 72201-1094

Municipal Boundary Change Checklist

County: Pulaski City/Town: Little Rock

City Ordinance/Resolution No: 21615 Date approved: 08/21/2018

County Court Case No: CI-2018-16 Date Order Filed: 11/26/2018

Type: Annexation by Petition of all Landowners A.C.A §14-40-609

Date Change Effective: 11/26/2018 Set by: Municipal Ordinance Emergency Clause Court Default
(Required by Act 653 of 2017)

For Circuit Court Challenge: Date Order Filed: _____ Upheld Overturned Other *(attach explanation)*

Initiating party:

All Landowners Majority Landowners Municipal Governing Body State Other _____

Supporting Documentation attached *(check all that apply):*

- File marked copy of City Ordinance/Resolution *(required)*
- File marked copy of County Court Order or certified annexation election results *(required except for island annexation)*
- Copy of Arkansas GIS Office approved printed map and certification letter *(required)*
- Proof of Publication for all Legal Notices *(include Hearing, Election, and City Ordinance/Resolution notices)*
- File marked copy of Petition Part *(if applicable)*
- File marked copy of Complaint and final Circuit Court Order *(Court Challenge only)*

Municipal Contact:

Name: Ms. Susan Langley Title: Little Rock City Clerk

Street Address: 500 W. Markham, Room 203

City: Little Rock St: AR Zip code: 72201

Complete one form per ordinance/resolution, attach it as a cover page to the supporting document set and submit to the County Clerk's Office within 45 days of the Effective Date as required by Act 655 of 2017

County Official:

Signature: _____ Title: Pulaski County Clerk

Date: _____

Pursuant to Act 655 of 2017, County Officials must submit a file-marked copy of municipal boundary change documentation within 30 days of receipt to: Arkansas Secretary of State, Attn: Municipal Boundary Filing, 500 Woodlane Ave Suite 256, Little Rock, AR 72201-1094

Office of the Arkansas Secretary of State use only

Received by: *Lynthia Fisher*

FILED
DEC 05 2018
Arkansas
Secretary of State

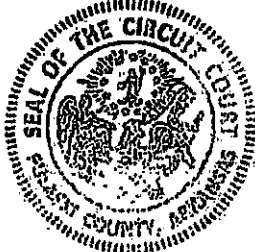

2018052703

ORDINANCE NO. 21,615

PRESENTED: 08-22-2018 03:27:10 PM

RECORDED: 08-22-2018 03:33:07 PM

In Official Records of Larry Crane Circuit/County Clerk

PULASKI CO, AR FEE \$25.00

FILED

AUG 22 2018

**LARRY CRANE
CIRCUIT COUNTY CLERK**

1
2
3
4
5
6
7
8
9
10
11
12
13
14
15
16
17
18
19
20
21
22
23
24
25
26
27
28
29
30
31
32
33
34

AN ORDINANCE TO ACCEPT THE KANIS ROAD DELTIC POTLATCH ANNEXATION (A-332), TO ADD CERTAIN LANDS TO THE CITY OF LITTLE ROCK, ARKANSAS; AND FOR OTHER PURPOSES.

WHEREAS, a petition for voluntary annexation (the "Petition") was filed with Pulaski County, Arkansas, by a majority of the owners hereinafter designated lands praying that said lands be annexed to and made part of the City of Little Rock, Arkansas; and,

WHEREAS, the County Court of Pulaski County, Arkansas found that the Petition was signed by a majority of the real property owners of the area (by area and number) to be annexed and the annexation request met all requirements of Arkansas Code 14-40-601 through 14-40-603; and,

WHEREAS, the Pulaski County Judge has signed an Annexation Order for the site requesting annexation (filed May 4, 2018); and,

WHEREAS, an accurate map of said lands has been filed with and made a part of said Petition; and,

WHEREAS, proper notice has been given for the time and in the manner prescribed by law; and,

WHEREAS, all things pertaining thereto have been done in the manner prescribed by law and that said lands should be annexed to and made part of the City of Little Rock.

NOW, THEREFORE, BE IT ORDAINED BY THE BOARD OF DIRECTORS OF THE CITY OF LITTLE ROCK, ARKANSAS:

Section 1. The following described territory contiguous and adjoining the City of Little Rock, Arkansas is accepted as annexed to and made a part of the City of Little Rock, Pulaski County, Arkansas, to wit:

KANIS ROAD DELTIC POTLATCH ANNEXATION (A-332)

A portion of Section 34 in T-2-N, R-14-W, Pulaski County, Arkansas being more particularly described: As beginning at the northwest corner of the E 1/2 SW 1/4 of said Section 34; thence easterly along the north Line of the said E 1/2 SW 1/4 of Section 34, and along the present City Limits line, to the northeast corner of the Said E 1/2 SW 1/4 of Section 34; thence southerly along the east line of the said E 1/2 SW 1/4 of Section 34, and the present City Limits line, to the northwest corner of the S 1/2 NW 1/4 SE 1/4 of said Section 34; thence easterly along the north Line of the said S 1/2 NW 1/4 SE 1/4, and along the present City Limits line, to the northeast corner of the said S 1/2 NW 1/4 SE 1/4 of Section 34; thence southerly along the east line of the said S 1/2 NW 1/4 SE 1/4, and along the present City Limits

FILED

DEC 05 2018

Arkansas
Secretary of State

1 line, to the northwest corner of the SE 1/4 SE 1/4 of said Section 34; thence easterly
2 along the north line of the said SE 1/4 SE 1/4 of Section 34, and along the present City
3 Limits line, to a point 200 feet west of the northeast corner of the said SE 1/4 SE 1/4
4 of Section 34; thence southerly along a line 200 feet west of and parallel to the east
5 line of the said SE 1/4 SE 1/4 of Section 34 to a point on the south line of said Section
6 34; thence westerly along said south line of Section 34 to a point on the northerly
7 right-of-way line of Kanis Road; thence westerly along said northerly right-of-way
8 line of Kanis Road to point where the said northerly right-of-way line of Kanis Road
9 intersects the west line of the E 1/2 SW 1/4 of said Section 34; thence northerly along
10 the west line of the said E 1/2 SW 1/4 of Section 34 to the point of beginning.

11 AND

12 The SW 1/4 NW 1/4 of Section 34 IN T-2-N, R-14-W, Pulaski County, Arkansas. And
13 all that portion of Section 3, T-1-N, R-14-W, Pulaski County, Arkansas, lying
14 north of the northerly right-of-way line of Kanis Road less & except the east
15 370.23 feet thereof. All Containing 180 Acres, more or less, and all adjoining,
16 abutting and traversing road and rights-of-way.

17 Section 2. The City of Little Rock shall provide Police and Fire protection; assume maintenance
18 responsibility for the portion of Kanis Road fronting said property; make available Code and other services
19 of the City; and upon approval by the respective utility allow the property owners within the annexation to
20 extend service lines to the Little Rock Water Reclamation System and Central Arkansas Water System from
21 the effective date of the annexation.

22 Section 3. *Severability.* In the event any title, section, paragraph, item, sentence, clause, phrase, or
23 word of this ordinance is declared or adjudged to be invalid or unconstitutional, such declaration or
24 adjudication shall not affect the remaining portions of the ordinance which shall remain in full force and
25 effect as if the portion so declared or adjudged invalid or unconstitutional was not originally a part of the
26 ordinance.

27 Section 4. *Repealer.* All laws, ordinances or resolutions, or parts of the same, that are in inconsistent
28 with the provisions of this ordinance, are hereby repealed to the extent of such inconsistency.

29 PASSED: August 21, 2018

30 ATTEST:

31 
32 _____
33 Susan Langley, City Clerk

30 APPROVED:

31 
32 _____
33 Mark Stodola, Mayor

FILED

IN THE COUNTY COURT OF PULASKI COUNTY, ARKANSAS NOV 26 2018

Case No. CI-2018-16

**LARRY CRANE
CIRCUIT COUNTY CLERK**

**IN THE MATTER OF ANNEXING LANDS,
PARTICULARLY DESCRIBED AS FOLLOWS:**

A PORTION OF SECTION 34 IN T-2-N, R-14-W, PULASKI COUNTY, ARKANSAS, BEING MORE PARTICULARLY DESCRIBED AS BEGINNING AT THE NORTHWEST CORNER OF THE E1/2 SW1/4 OF SAID SECTION 34; THENCE EASTERLY ALONG THE NORTH LINE OF THE SAID E1/2 SW1/4 OF SECTION 34, AND ALONG THE PRESENT CITY LIMITS LINE, TO THE NORTHEAST CORNER OF THE SAID E1/2 SW1/4 OF SECTION 34; THENCE SOUTHERLY ALONG THE EAST LINE OF THE SAID E1/2 SW1/4 OF SECTION 34, AND THE PRESENT CITY LIMITS LINE, TO THE NORTHWEST CORNER OF THE S1/2 NW1/4 SE1/4 OF SAID SECTION 34; THENCE EASTERLY ALONG THE NORTH LINE OF THE SAID S1/2 NW1/4 SE1/4, AND ALONG THE PRESENT CITY LIMITS LINE, TO THE NORTHEAST CORNER OF THE SAID S1/2 NW1/4 SE1/4 OF SECTION 34; THENCE SOUTHERLY ALONG THE EAST LINE OF THE SAID S1/2 NW1/4 SE1/4, AND ALONG THE PRESENT CITY LIMITS LINE, TO THE NORTHWEST CORNER OF THE SE1/4 SE1/4 OF SAID SECTION 34; THENCE EASTERLY ALONG THE NORTH LINE OF THE SAID SE1/4 SE1/4 OF SECTION 34, AND ALONG THE PRESENT CITY LIMITS LINE, TO A POINT 200 FEET WEST OF THE NORTHEAST CORNER OF THE SAID SE1/4 SE1/4 OF SECTION 34; THENCE SOUTHERLY ALONG A LINE 200 FEET WEST OF AND PARALLEL TO THE EAST LINE OF THE SAID SE1/4 SE1/4 OF SECTION 34 TO A POINT ON THE SOUTH LINE OF SAID SECTION 34; THENCE WESTERLY ALONG SAID SOUTH LINE OF SECTION 34 TO A POINT ON THE NORTHERLY RIGHT-OF-WAY LINE OF KANIS ROAD; THENCE WESTERLY ALONG SAID NORTHERLY RIGHT-OF-WAY LINE OF KANIS ROAD TO A POINT WHERE THE SAID NORTHERLY RIGHT-OF-WAY LINE OF KANIS ROAD INTERSECTS THE WEST LINE OF THE E1/2 SW1/4 OF SAID SECTION 34; THENCE NORTHERLY ALONG THE WEST LINE OF THE SAID E1/2 SW1/4 OF SECTION 34 TO THE POINT OF BEGINNING.

AND

THE SW1/4 NW1/4 OF SECTION 34 IN T-2-N, R-14-W, PULASKI COUNTY, ARKANSAS.

AND ALL THAT PORTION OF SECTION 3, T-1-N, R-14-W, PULASKI COUNTY, ARKANSAS, LYING NORTH OF THE NORTHERLY RIGHT-OF-WAY LINE OF KANIS ROAD. LESS & EXCEPT THE EAST 370.23 FEET THEREOF.

ALL CONTAINING 180 ACRES, MORE OR LESS;

AND INCLUDING ALL ADJOINING, ABUTTING, AND TRAVERSING ROAD AND RIGHTS-OF-WAY.

FILED

DEC 05 2018

**Arkansas
Secretary of State**

ORDER CONFIRMING ANNEXATION

On the 26th day of November, 2018, the Court, having received from the City Clerk of Little Rock, Arkansas certified copies of the plat of the annexed property and ordinance approved by the City Board of the City of Little Rock, Arkansas finds that all requirements of law for entry of an Order confirming annexation of the above referenced lands have been met.

IT IS THEREFORE CONSIDERED, ORDERED AND ADJUDGED that the following described territory be, and the same hereby is annexed to the City of Little Rock, Arkansas, to-wit:

A PORTION OF SECTION 34 IN T-2-N, R-14-W, PULASKI COUNTY, ARKANSAS, BEING MORE PARTICULARLY DESCRIBED AS BEGINNING AT THE NORTHWEST CORNER OF THE E1/2 SW1/4 OF SAID SECTION 34; THENCE EASTERLY ALONG THE NORTH LINE OF THE SAID E1/2 SW1/4 OF SECTION 34, AND ALONG THE PRESENT CITY LIMITS LINE, TO THE NORTHEAST CORNER OF THE SAID E1/2 SW1/4 OF SECTION 34; THENCE SOUTHERLY ALONG THE EAST LINE OF THE SAID E1/2 SW1/4 OF SECTION 34, AND THE PRESENT CITY LIMITS LINE, TO THE NORTHWEST CORNER OF THE S1/2 NW1/4 SE1/4 OF SAID SECTION 34; THENCE EASTERLY ALONG THE NORTH LINE OF THE SAID S1/2 NW1/4 SE1/4, AND ALONG THE PRESENT CITY LIMITS LINE, TO THE NORTHEAST CORNER OF THE SAID S1/2 NW1/4 SE1/4 OF SECTION 34; THENCE SOUTHERLY ALONG THE EAST LINE OF THE SAID S1/2 NW1/4 SE1/4, AND ALONG THE PRESENT CITY LIMITS LINE, TO THE NORTHWEST CORNER OF THE SE1/4 SE1/4 OF SAID SECTION 34; THENCE EASTERLY ALONG THE NORTH LINE OF THE SAID SE1/4 SE1/4 OF SECTION 34, AND ALONG THE PRESENT CITY LIMITS LINE, TO A POINT 200 FEET WEST OF THE NORTHEAST CORNER OF THE SAID SE1/4 SE1/4 OF SECTION 34; THENCE SOUTHERLY ALONG A LINE 200 FEET WEST OF AND PARALLEL TO THE EAST LINE OF THE SAID SE1/4 SE1/4 OF SECTION 34 TO A POINT ON THE SOUTH LINE OF SAID SECTION 34; THENCE WESTERLY ALONG SAID SOUTH LINE OF SECTION 34 TO A POINT ON THE NORTHERLY RIGHT-OF-WAY LINE OF KANIS ROAD; THENCE WESTERLY ALONG SAID NORTHERLY RIGHT-OF-WAY LINE OF KANIS ROAD TO A POINT WHERE THE SAID NORTHERLY RIGHT-OF-WAY LINE OF KANIS ROAD INTERSECTS THE WEST LINE OF THE E1/2 SW1/4 OF SAID SECTION 34; THENCE NORTHERLY ALONG THE WEST LINE OF THE SAID E1/2 SW1/4 OF SECTION 34 TO THE POINT OF BEGINNING.

AND

THE SW1/4 NW1/4 OF SECTION 34 IN T-2-N, R-14-W, PULASKI COUNTY,
ARKANSAS.

AND ALL THAT PORTION OF SECTION 3, T-1-N, R-14-W, PULASKI
COUNTY, ARKANSAS, LYING NORTH OF THE NORTHERLY RIGHT-OF-
WAY LINE OF KANIS ROAD. LESS & EXCEPT THE EAST 370.23 FEET
THEREOF.

ALL CONTAINING 180 ACRES, MORE OR LESS;

AND INCLUDING ALL ADJOINING, ABUTTING, AND TRAVERSING
ROAD AND RIGHTS-OF-WAY.

IT IS SO ORDERED this 26th day of November, 2018.



HONORABLE BARRY HYDE
PULASKI COUNTY JUDGE

1 APPROVED AS TO LEGAL FORM:

2

3

4

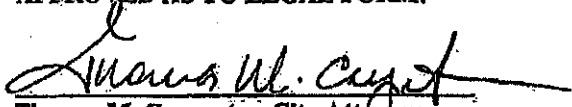
Thomas M. Carpenter, City Attorney

5 //

6 //

7 //

8 //

9 //

10 //

11 //

12 //

13 //

14 //

15 //

16 //

17 //

18 //

19 //

20 //

21 //

22 //

23 //

24 //

25 //

26 //

27 //

28 //

29 //

30 //

31 //

32 //

33 //

34 //

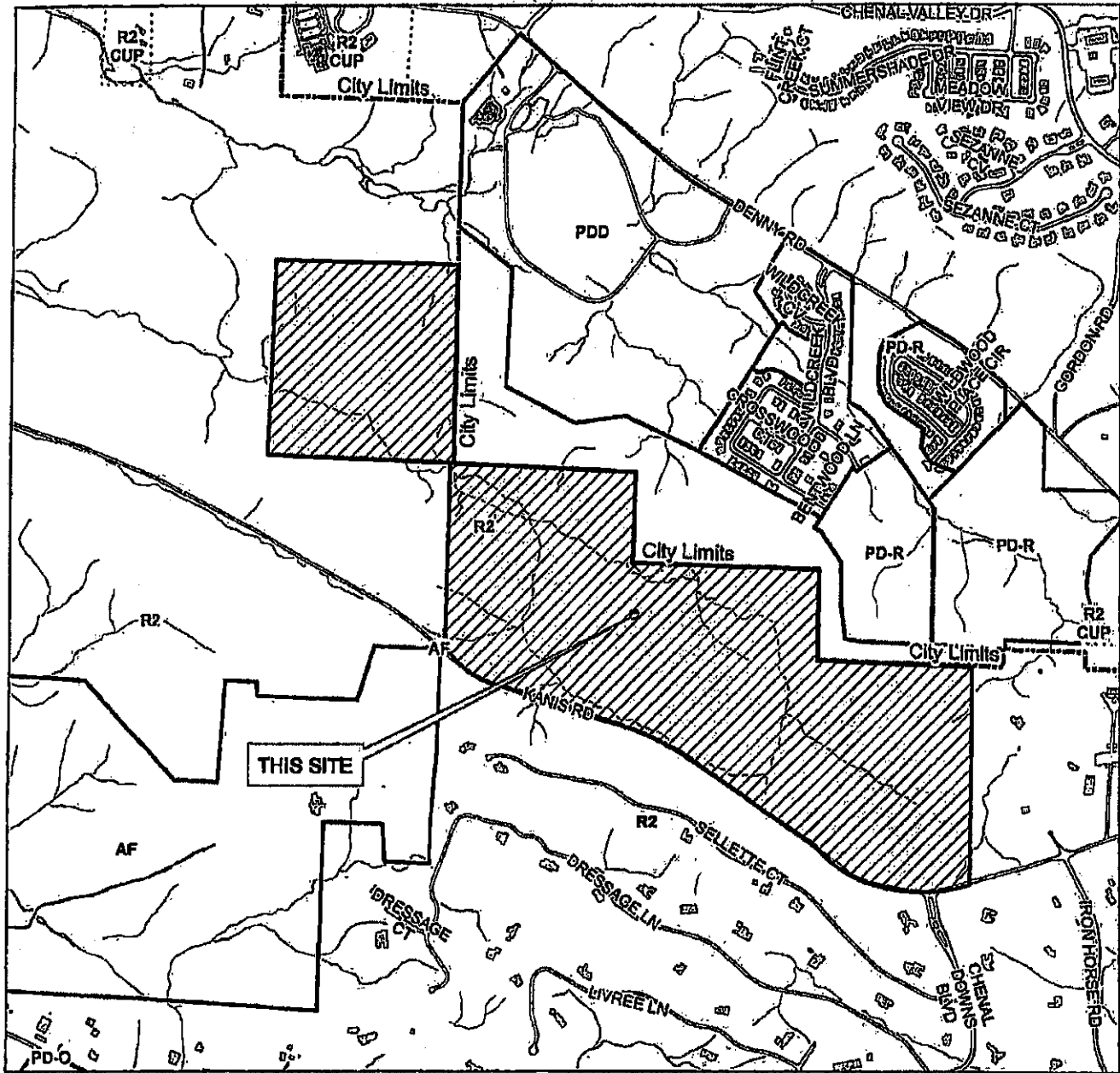

Area Zoning

City of Little Rock Planning & Development

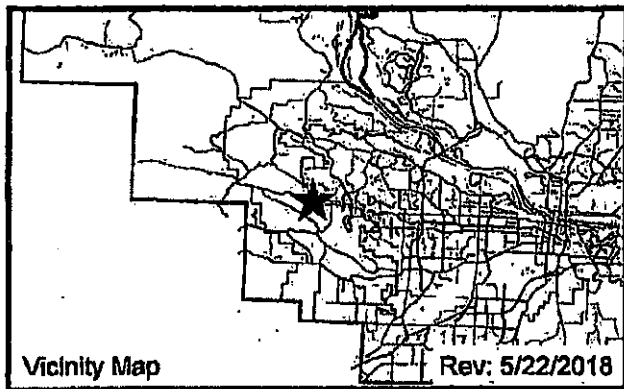

Case: A-332

Location: North Side of Kanis Road. West of Iron Horse Road

Ward: N/A

PD: 21

CT: 42.02

TRS: T2N R14W 34

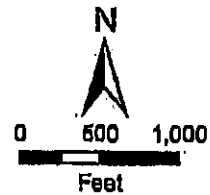



**ARKANSAS
GIS OFFICE**

April 16, 2018

Mr. Timothy E Daters, PE
White-Daters & Associates
24 Rahling Circle
Little Rock, AR 72223

RE: City of Little Rock Annexation Coordination Requirement

Mr. Daters,

Thank you for coordinating with our office as you seek to annex property into the City of Little Rock, AR located in Section 34, Township 2 North, Range 14 West and Section 3, Township 1 North, Range 14 West. This letter represents confirmation that you have properly coordinated with our office (Arkansas GIS Office) as specified in § 14-40-101 (Act 914 of 2015) of the 90th General Assembly.

Our office will wait completion of any additional steps necessary for the proposed boundary change, which normally comes from the Arkansas Secretary of State Elections Division after any appropriate filing by your County Clerk.

Thank you,

Jennifer Wheeler, GIS Analyst
/jjw

Attachments:
GIS Office Map of Proposed Annexation
Legal Description extracted from survey
Secretary of State Municipal Change Checklist

F I L E D

DEC 05 2018

**Arkansas
Secretary of State**

H:\City_Annexations\Cities\Little_Rock\20180416\Doc\20180416_LittleRock_Annexation_Coordination_Letter.docx

PROPERTY TO BE ANNEXED TO THE CITY OF LITTLE ROCK, ARKANSAS

A PORTION OF SECTION 34 IN T-2-N, R-14-W, PULASKI COUNTY, ARKANSAS, BEING MORE PARTICULARLY DESCRIBED AS BEGINNING AT THE NORTHWEST CORNER OF THE E1/2 SW1/4 OF SAID SECTION 34; THENCE EASTERLY ALONG THE NORTH LINE OF THE SAID E1/2 SW1/4 OF SECTION 34, AND ALONG THE PRESENT CITY LIMITS LINE, TO THE NORTHEAST CORNER OF THE SAID E1/2 SW1/4 OF SECTION 34; THENCE SOUTHERLY ALONG THE EAST LINE OF THE SAID E1/2 SW1/4 OF SECTION 34, AND THE PRESENT CITY LIMITS LINE, TO THE NORTHWEST CORNER OF THE S1/2 NW1/4 SE1/4 OF SAID SECTION 34; THENCE EASTERLY ALONG THE NORTH LINE OF THE SAID S1/2 NW1/4 SE1/4, AND ALONG THE PRESENT CITY LIMITS LINE, TO THE NORTHEAST CORNER OF THE SAID S1/2 NW1/4 SE1/4 OF SECTION 34; THENCE SOUTHERLY ALONG THE EAST LINE OF THE SAID S1/2 NW1/4 SE1/4, AND ALONG THE PRESENT CITY LIMITS LINE, TO THE NORTHWEST CORNER OF THE SE1/4 SE1/4 OF SAID SECTION 34; THENCE EASTERLY ALONG THE NORTH LINE OF THE SAID SE1/4 SE1/4 OF SECTION 34, AND ALONG THE PRESENT CITY LIMITS LINE, TO A POINT 200 FEET WEST OF THE NORTHEAST CORNER OF THE SAID SE1/4 SE1/4 OF SECTION 34; THENCE SOUTHERLY ALONG A LINE 200 FEET WEST OF AND PARALLEL TO THE EAST LINE OF THE SAID SE1/4 SE1/4 OF SECTION 34 TO A POINT ON THE SOUTH LINE OF SAID SECTION 34; THENCE WESTERLY ALONG SAID SOUTH LINE OF SECTION 34 TO A POINT ON THE NORTHERLY RIGHT-OF-WAY LINE OF KANIS ROAD; THENCE WESTERLY ALONG SAID NORTHERLY RIGHT-OF-WAY LINE OF KANIS ROAD TO A POINT WHERE THE SAID NORTHERLY RIGHT-OF-WAY LINE OF KANIS ROAD INTERSECTS THE WEST LINE OF THE E1/2 SW1/4 OF SAID SECTION 34; THENCE NORTHERLY ALONG THE WEST LINE OF THE SAID E1/2 SW1/4 OF SECTION 34 TO THE POINT OF BEGINNING.

AND

THE SW1/4 NW1/4 OF SECTION 34 IN T-2-N, R-14-W, PULASKI COUNTY, ARKANSAS.

AND ALL THAT PORTION OF SECTION 3, T-1-N, R-14-W, PULASKI COUNTY, ARKANSAS, LYING NORTH OF THE NORTHERLY RIGHT-OF-WAY LINE OF KANIS ROAD. LESS & EXCEPT THE EAST 370.23 FEET THEREOF.

ALL CONTAINING 180 ACRES, MORE OR LESS.

**Proposed Annex: City of Little Rock
April 2018**

City: Little Rock
Mayor: Mark Stodola

Arkansas Code 14-40-101.

Before an entity undertakes an annexation, consolidation, or detachment proceeding under this chapter, the entity shall coordinate with the Arkansas Geographic Information Systems Office for preparation of legal descriptions and digital mapping for the relevant annexation, consolidation, and detachment areas.

The map contained herein is evidence, the entity has met requirements of Act 914 of 2015

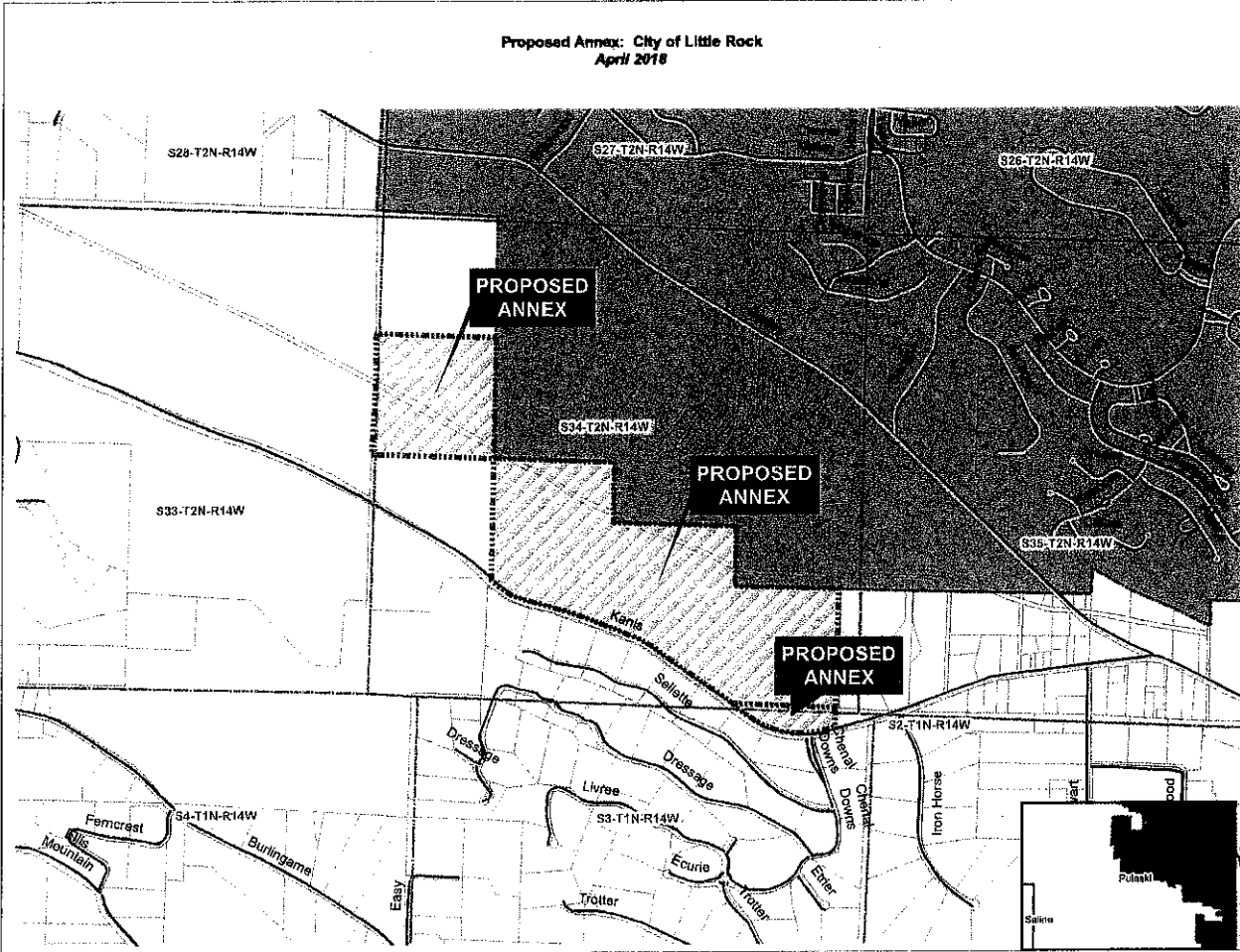

- Proposed Annex
- Sections
- Parcels
- Most Recent
- Existing Only

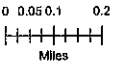

ARKANSAS GIS OFFICE

H:\City_Annexions\GIS\Little_Rock\0180416

FILED

DEC 05 2018

**Arkansas
Secretary of State**



City of Little Rock

Department of Planning and Development

723 West Markham Street
Little Rock, Arkansas 72201-1334
Phone: (501) 371-4790 Fax: (501) 399-3435 or 371-6863

**Planning
Zoning and
Subdivision**

August 23, 2018

Timothy Daters, P.E.
White-Daters & Associates, Inc.
24 Rahling Circle
Little Rock, AR 72223

Dear Mr. Daters:

This letter is to confirm that your property, as shown on the attached sketch has been annexed to the City of Little Rock. The effective date for the annexation is September 21, 2018. A copy of the Ordinance and map are attached for your convenience.

If you have any questions, feel free to contact me at (501) 371-6819.

Sincerely,

Walter Malone, AICP
Planning Manager

A TRUE COPY CERTIFIED THIS

11/27/2018

LARRY GRANE
CIRCUIT COUNTY CLERK

BY:

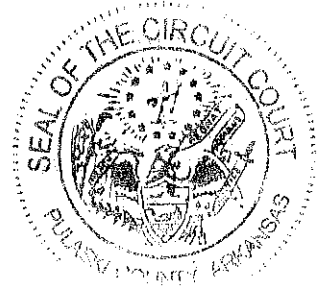
DEPUTY CLERK

LARRY CRANE
PULASKI CIRCUIT/COUNTY CLERK

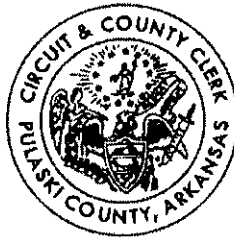

401 WEST MARKHAM STREET, SUITE 100
LITTLE ROCK, ARKANSAS 72201

Mark Martin
Arkansas Secretary of State
500 Woodlane Ave.
Little Rock AR 72201

November 27, 2018

To whom it may concern.

Enclosed are certified copies of an annexation to the City of Little Rock.

Sincerely,

Douglas DalPorto
Supervisor, Court Records,
County Records and Marriage License.

FILED

IN THE COUNTY COURT OF PULASKI COUNTY, ARKANSAS **NOV 04 2018**

Case No. CI-2018-16
2018-0437

**LARRY CRANE
CIRCUIT COUNTY CLERK**

**IN THE MATTER OF ANNEXING LANDS,
PARTICULARLY DESCRIBED AS FOLLOWS:**

PROPERTY TO BE ANNEXED TO THE CITY OF LITTLE ROCK, ARKANSAS

A PORTION OF SECTION 34 IN T-2-N, R-14-W, PULASKI COUNTY, ARKANSAS, BEING MORE PARTICULARLY DESCRIBED AS BEGINNING AT THE NORTHWEST CORNER OF THE E1/2 SW1/4 OF SAID SECTION 34; THENCE EASTERLY ALONG THE NORTH LINE OF THE SAID E1/2 SW1/4 OF SECTION 34, AND ALONG THE PRESENT CITY LIMITS LINE, TO THE NORTHEAST CORNER OF THE SAID E1/2 SW1/4 OF SECTION 34; THENCE SOUTHERLY ALONG THE EAST LINE OF THE SAID E1/2 SW1/4 OF SECTION 34, AND THE PRESENT CITY LIMITS LINE, TO THE NORTHWEST CORNER OF THE S1/2 NW1/4 SE1/4 OF SAID SECTION 34; THENCE EASTERLY ALONG THE NORTH LINE OF THE SAID S1/2 NW1/4 SE1/4, AND ALONG THE PRESENT CITY LIMITS LINE, TO THE NORTHEAST CORNER OF THE SAID S1/2 NW1/4 SE1/4 OF SECTION 34; THENCE SOUTHERLY ALONG THE EAST LINE OF THE SAID S1/2 NW1/4 SE1/4, AND ALONG THE PRESENT CITY LIMITS LINE, TO THE NORTHWEST CORNER OF THE SE1/4 SE1/4 OF SAID SECTION 34; THENCE EASTERLY ALONG THE NORTH LINE OF THE SAID SE1/4 SE1/4 OF SECTION 34, AND ALONG THE PRESENT CITY LIMITS LINE, TO A POINT 200 FEET WEST OF THE NORTHEAST CORNER OF THE SAID SE1/4 SE1/4 OF SECTION 34; THENCE SOUTHERLY ALONG A LINE 200 FEET WEST OF AND PARALLEL TO THE EAST LINE OF THE SAID SE1/4 SE1/4 OF SECTION 34 TO A POINT ON THE SOUTH LINE OF SAID SECTION 34; THENCE WESTERLY ALONG SAID SOUTH LINE OF SECTION 34 TO A POINT ON THE NORTHERLY RIGHT-OF-WAY LINE OF KANIS ROAD; THENCE WESTERLY ALONG SAID NORTHERLY RIGHT-OF-WAY LINE OF KANIS ROAD TO A POINT WHERE THE SAID NORTHERLY RIGHT-OF-WAY LINE OF KANIS ROAD INTERSECTS THE WEST LINE OF THE E1/2 SW1/4 OF SAID SECTION 34; THENCE NORTHERLY ALONG THE WEST LINE OF THE SAID E1/2 SW1/4 OF SECTION 34 TO THE POINT OF BEGINNING.

AND

THE SW1/4 NW1/4 OF SECTION 34 IN T-2-N, R-14-W, PULASKI COUNTY, ARKANSAS.

AND ALL THAT PORTION OF SECTION 3, T-1-N, R-14-W, PULASKI COUNTY, ARKANSAS, LYING NORTH OF THE NORTHERLY RIGHT-OF-WAY LINE OF KANIS ROAD. LESS & EXCEPT THE EAST 370.23 FEET THEREOF.

ALL CONTAINING 180 ACRES, MORE OR LESS;

AND INCLUDING ALL ADJACENT PUBLIC STREET RIGHTS-OF-WAY.

FILED

DEC 05 2018

**Arkansas
Secretary of State**

ORDER APPROVING ANNEXATION AS TO FORM

On the ___ day of ____, 2018, the Court finds that said Petition is in proper legal form as defined in Ark. Code Ann. §14-40-609, that the Petition is complete and accurate, that the allegations contained in the Petition are true and correct, that the annexation will not create enclaves, that the limits of the territory to be annexed have been accurately shown on the map with the legal description shown thereon which map was filed with the Petition, that the Petition contains a schedule of services, that the prayer of the Petition is proper and should be granted and that all requirements of law for entry of an Order approving said Petition as to form have been met. Pursuant to the Court's discretionary authority provided in Ark. Code Ann. §14-40-609, the Court requires the City of Little Rock to annex adjacent public street rights-of-way, as set forth above and as depicted in the map filed with this order.

IT IS THEREFORE CONSIDERED, ORDERED AND ADJUDGED that the Petition, along with this Order, be forwarded to the City Board of the City of Little Rock, Arkansas for their consideration.

IT IS SO ORDERED this 4th day of May, 2018.



HONORABLE BARRY HYDE
PULASKI COUNTY JUDGE

Annexation to the City of Little Rock CI-2018-16
180 acres +/-

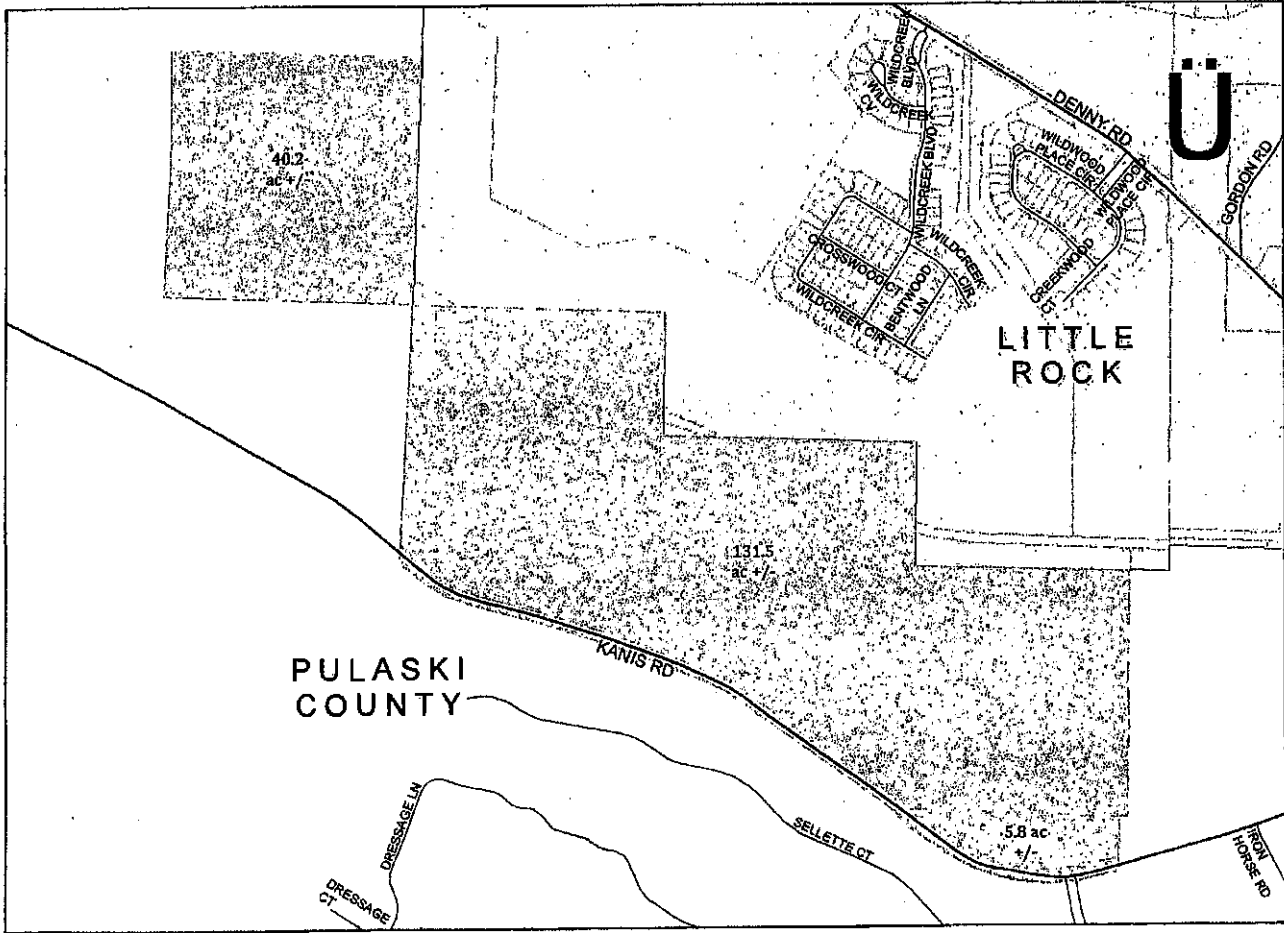

Date: 5/4/2018

FILED

DEC 05 2018

Arkansas
Secretary of State

A TRUE COPY CERTIFIED THIS

11/27/2018

LARRY CRANE
CIRCUIT COUNTY CLERK

BY: _____
DEPUTY CLERK

