



**ARKANSAS  
GIS OFFICE**

---

August 31, 2017

Mrs. Cynthia Fisher  
Special Projects Manager  
AR Secretary of State Legal Division

RE: City of Little Rock Historic Annexation Boundary Correction

Mrs. Fisher,

Thank you for working with our office to correct the boundaries for two historic annexations in Little Rock; ordinance 8859 from 1952 and ordinance 15,984 from 1990. This letter represents confirmation that you have properly coordinated with our office (Arkansas GIS Office) as specified in § 14-40-101 (Act 914 of 2015) of the 90<sup>th</sup> General Assembly.

Our office will wait completion of any additional steps necessary for the boundary change, which normally comes from the Arkansas Secretary of State Elections Division.

Thank you,

Jennifer Wheeler GIS Analyst  
/jjw

Attachments:  
GIS Office Map of Proposed Annexation  
Secretary of State Municipal Change Checklist



Historic Annex Boundary Correction: City of Little Rock - Ordinance 15,984 from 1990  
August 2017

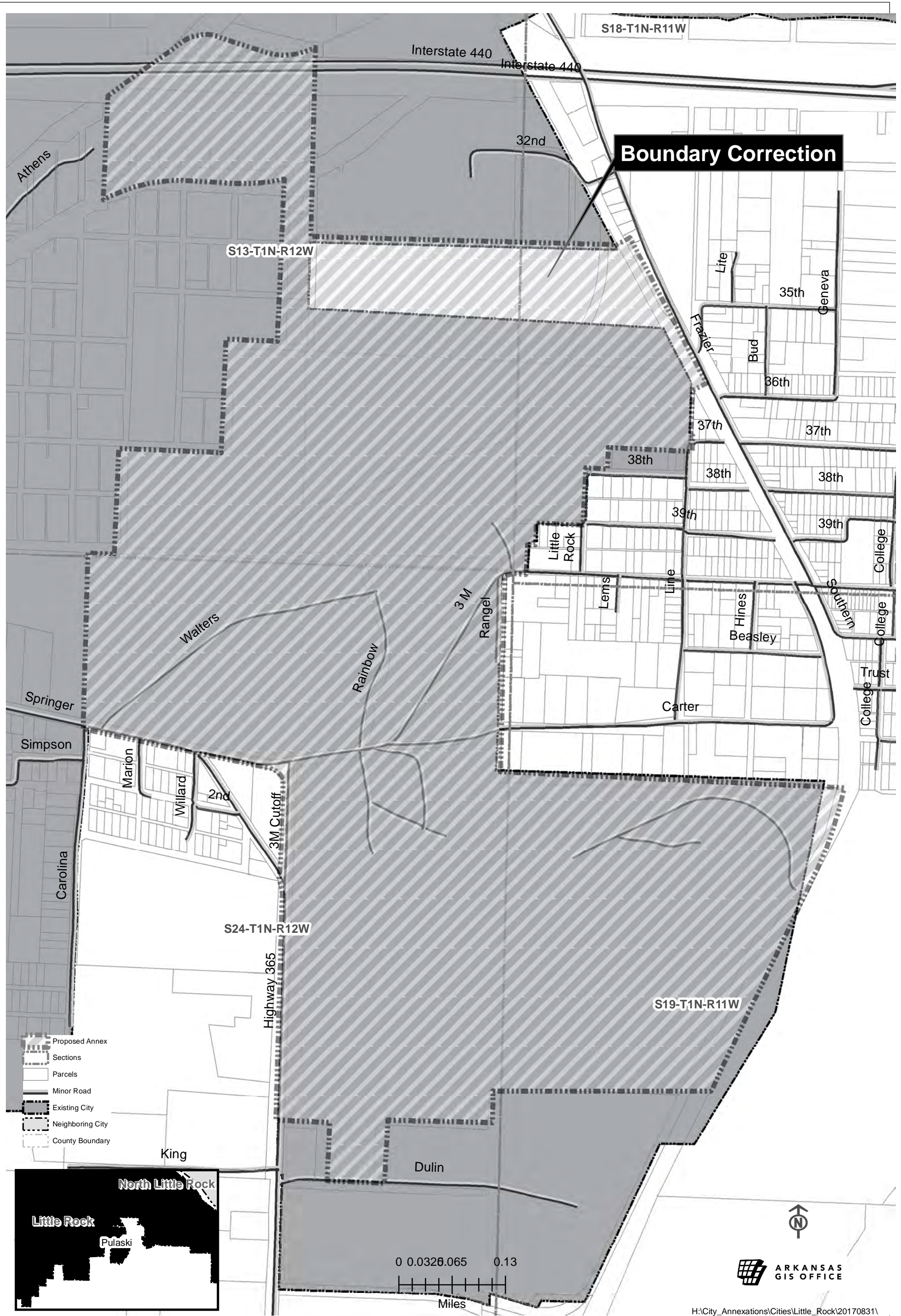



ORDINANCE NO. 15,984

AN ORDINANCE ACCEPTING THE ANNEXATION OF CERTAIN LANDS TO THE CITY OF LITTLE ROCK, ARKANSAS, AND MAKING SAME A PART OF THE CITY OF LITTLE ROCK, ARKANSAS.

WHEREAS, a petition was filed with the County Clerk of Pulaski County, Arkansas, by the owner of the hereinabove described lands, praying that said lands be annexed to and made a part of the City of Little Rock, Arkansas; and

WHEREAS, on November 6, 1990, the County Court of Pulaski County, Arkansas, found that the petition was signed by a majority of the owners in area and in number of the following described lands located in Pulaski County, Arkansas; that said lands are contiguous and adjoining the present corporate limits of the City of Little Rock, Arkansas; that an accurate plat or map of said lands had been filed with and made a part of said petition; that proper notice had been given for the time and in the manner prescribed by law, and that all things pertaining thereto had been done in the manner prescribed by law, and that said lands should be annexed to and made a part of the City of Little Rock, Arkansas, subject to the acceptance of same by the Board of Directors of said City at the proper time as provided by law; and

WHEREAS, the time fixed by law for appealing from said Order of Annexation made by the County Court has expired and no appeal has been taken from said Order;

- 2 -

NOW, THEREFORE, BE IT ORDAINED BY THE BOARD OF DIRECTORS  
OF THE CITY OF LITTLE ROCK, ARKANSAS:

Section 1. That the lands described as Tract "A" and  
Tract "B" attached hereto and incorporated herein by reference  
which are contiguous to and adjoining the City of Little Rock,  
Arkansas, be and the same are hereby accepted as part of and  
annexed to and made a part of the City of Little Rock.

Section 2. This Ordinance shall be in full force and  
effect from and after its passage.

PASSED: December 18, 1990

ATTEST:

Jane Czech  
CITY CLERK JANE CZECH

APPROVED:

Floyd G. Villines, III  
MAYOR FLOYD G. VILLINES, III

Minnesota Mining and Manufacturing Company  
 Petition to Annex Lands to the City of Little Rock, Arkansas

Tract "A"

A parcel of land lying within Pulaski County, Arkansas, and more particularly described as follows: Begin at a point at the intersection of the west line of the Southwest Quarter of the Northeast Quarter of Section 13, Township 1 North, Range 12 West, with the south bank of Fourche Creek, which point is on the present City Limits of the City of Little Rock, thence easterly along the south bank of Fourche Creek and the existing City Limits of the City of Little Rock to a point at the intersection of the south bank of Fourche Creek and the east line of said Southwest Quarter of the Northeast Quarter of Section 13, thence south along the east line of said quarter section and continuing along the west line of Block 1, Chamber of Commerce Addition to Little Rock to the southwest corner of said Block 1, thence east along the south line of Blocks 1, 2, 3, 4, 5, and 6 of Chamber of Commerce Addition to Little Rock to the west right-of-way line of Union Pacific Railroad, thence southeasterly along said right-of-way line to a point that is 25 feet more or less east and 400 feet more or less north of the northeast corner of Lot 24, Block 4, of Frisby Addition to Little Rock, thence south on a line parallel to and 25 feet more or less east of the east line of former Block 1 of Frisby Addition, now reduced to acreage and the east line of Block 4 of Frisby Addition a distance of 400 feet more or less to a point that is 25 feet more or less east of the northeast corner of Lot 24, Block 4 of Frisby Addition, thence west and along the north line of Lots 24, 23, 22, 21, 20, 19, 18, 17, 16, and 15 to the northwest corner of said Lot 15 of said Frisby Addition, thence south along the west line of said Lot 15 to the southwest corner thereof, thence west along the south line of what formerly was platted as Block 3 of Frisby Addition to a point on the east line of what formerly was platted as Block 6 of Frisby Addition, thence south along the east line of former Block 6, Frisby Addition, continuing along the east line of Lot 18, Block 6, Frisby Addition to the southeast corner of said Lot 18, thence west along the south line of Block 6 and former Block 6 of Frisby Addition to a point north of the east line of Lot 7, Block 7, Frisby Addition, thence south to the southeast corner of said Lot 7, thence west along the south line of said Lot 7 to the southwest corner thereof, thence south along the east line of Lot 11, Block 7, Frisby Addition, and continuing to a point on the south line of 3-M Road, being 150 feet more or less east of the west line of Section 19, Township 1 North, Range 11 West, thence westerly along the south line of 3-M Road to a point on the west line of said Section 19, thence south along the west line of said Section 19 to the northwest corner of the Southwest Quarter of the Northwest Quarter of said Section 19, thence north 89° 35' 31" east a distance of 2118.03 feet more or less to the west right-of-way line of Union Pacific Railroad, thence southerly along said west right-of-way line a distance of 2585.78 feet more or less to a point on the east line of the Northwest Quarter of the

-2-

Southwest Quarter of said Section 19, that is 398.2 feet more or less south of the southeast corner of the North Half of the Northwest Quarter of the Southwest Quarter of said Section 19, thence north 398.20 feet to the southeast corner of said North Half of the Northwest Quarter of the Southwest Quarter, thence westerly along the south line of said North Half of the Northwest Quarter of the Southwest Quarter to the southwest corner thereof, thence south along the west line of the Northwest Quarter of the Southwest Quarter a distance of 207.19 feet more or less to a point, thence south  $88^{\circ} 24' 49''$  a distance of 673.51 feet to a point, thence south  $00^{\circ} 04' 41''$  west a distance of 365.53 feet more or less to a point on the north line of Dulin Road, thence westerly along the north line of Dulin Road a distance of 367.98 feet to a point, thence north  $00^{\circ} 32' 26''$  west a distance of 336 feet to a point, thence south  $89^{\circ} 32' 11''$  west a distance of 287 feet to a point on the west line of the Northeast Quarter of the Southeast Quarter of Section 24, Township 1 North, Range 12 West and the east right-of-way line of State Highway #365, thence north along the west line of said Northeast Quarter of the Southeast Quarter and along the west line of the Southeast Quarter of the Northeast Quarter of said Section to the northwest corner of the Southeast Quarter of the Northeast Quarter of said Section, thence northwesterly along the north right-of-way line of State Highway #365 a distance of 1375 feet more or less to the existing City Limits of the City of Little Rock, which point is on the west line of the Northwest Quarter of the Northeast Quarter of Section 24, Township 1 North, Range 12 West, thence north along the west line of said Northwest Quarter of the Northeast Quarter and along the existing City Limits of the City of Little Rock to the southwest corner of Lot 7, Block 47 of Granite Park Addition to the City of Little Rock, thence east along the south line of said Lot 7 to the southeast corner thereof, thence north along the east line of said Block 47 to the southeast corner of Lot 7, Block 27 of Granite Park Addition, thence east along the south line of Blocks 53 and 64 of Granite Park Addition to the southeast corner of Block 64, thence north along the east line of said Block 64 and the east line of what formerly was platted as Block 63 of Granite Park Addition (now reduced to acreage) to the southeast corner of Block 62 of Granite Park Addition, thence east along the south line of Block 71 of Granite Park Addition to the southeast corner thereof, thence north along the east line of Blocks 71, 72 and former Block 73 of Granite Park Addition to a point on the south line of the Union Pacific Railroad right-of-way, thence westerly along the south line of said right-of-way to the point of intersection of said right-of-way line with the midline of Block 1 of Granite Park Addition, which point lies on the present City Limits of the City of Little Rock, thence north along the midline of said Block 1 and said midline extended to the point of beginning on the south bank of Fourche Creek, together with and including all adjacent and abutting streets, rights-of-way and railroad rights-of-way.

Minnesota Mining and Manufacturing Company  
Petition to Annex Lands to the City of Little Rock, Arkansas

Tract "B"

A parcel of land lying within Pulaski County, Arkansas, and more particularly described as follows: Begin at the intersection of the east right-of-way line of Missouri Pacific Railroad Company and the south boundary line of Interstate Highway I-30, which point is on the present City Limits of the City of Little Rock, Arkansas, thence south along said east right-of-way line to the south line of the Northwest Quarter of Section 22, Township 1 North, Range 12 West, thence east along said south line to the east line of said Northwest Quarter and said south line extended 50 feet more or less to a point, thence south to the southeast right-of-way line of Arkansas State Highway #367, thence northeast along said right-of-way line to the point of its intersection with the west line of Fairview Addition to the City of Little Rock, thence south along the west line of said Fairview Addition to the northwest corner of Block 15 of Fairview Addition, thence west along the north line of said Block 16 to the northwest corner thereof, thence south along the west line of said Block 16 to the southwest corner thereof, thence east along the south line of Blocks 16, 15, 14, and 13 of Fairview Addition to a point on the west line of the Southeast Quarter of the Southeast Quarter, Section 22, Township 1 North, Range 12 West, thence north along the said west line and continuing north on the west line of the Northeast Quarter, Southeast Quarter said Section 22 to a point, which is the northwest corner of the Northeast Quarter of the Southeast Quarter of Section 22, Township 1 North, Range 12 West, thence along the north line of said Northeast Quarter, Southeast Quarter to the northeast corner of the West Half of the Northeast Quarter of said Southeast Quarter, thence south along the east line of said West Half of the Northeast Quarter of said Southeast Quarter to the south line of the Northeast Quarter of the Southeast Quarter, thence east along said line to the east line of said Section 22, which point is on the present City Limits line of the City of Little Rock, thence south along said east line, Section 22, to the southeast corner thereof, thence west along the south line of Section 22 to the southwest corner of the Southeast Quarter of the Southeast Quarter of Section 22, said point also being the east line of the West Half, Northeast Quarter, Section 27, Township 1 North, Range 12 West, thence south along the east line of the West Half of the Northeast Quarter of Section 27, Township 1 North, Range 12 West to the southeast corner thereof, thence west along the south line of said West Half of the Northeast Quarter of Section 27 to the southwest corner thereof, thence south along the east line of the Northeast Quarter of the Southwest Quarter, Section 27 to the southeast corner thereof, thence west along the south line of said Northeast Quarter of the Southwest Quarter to the southwest

corner thereof, thence south along the east line of the Southwest Quarter, Southwest Quarter, Section 27 and the east line of the North Half of the Northwest Quarter of the Northwest Quarter of Section 34, Township 1 North, Range 12 West to the southeast corner of said North Half, Northwest Quarter, Northwest Quarter, thence west along the south line of said North Half, Northwest Quarter, Northwest Quarter to the southwest corner thereof, said point also being on the east line of the East Half, Northeast Quarter of Section 33, Township 1 North, Range 12 West, thence south along said east line of the East Half of the Northeast Quarter of Section 33, Township 1 North, Range 12 West to the south line of said Northeast Quarter, thence west along the south line of said Northeast Quarter to the southwest corner of the Southeast Quarter of the Northeast Quarter of Section 33 to the southwest corner thereof, thence north along the west line of said Southeast Quarter, Northeast Quarter to the northwest corner thereof, thence west along the south line of the Northwest Quarter of the Northeast Quarter of said Section 33 to the southwest corner thereof, thence north along the west line of said Northwest Quarter of the Northeast Quarter to the west right-of-way line of Arkansas State Highway #367, also known as Arch Street Pike, thence north along said west right-of-way line a distance of 850 feet more or less to a point on the south line extended east of Lot 39 of Stewart's Addition to the City of Little Rock, thence west along said line to the southwest corner of said Lot 39, which point is on the present City Limits of the City of Little Rock, thence north along the west line of said Lot 39 to the northwest corner of said lot, thence east along the north line of Lot 39 and the north line extended easterly to a point on the west right-of-way line of Arkansas State Highway #367, which point is 260.5 feet northerly on said west right-of-way line from the point of the intersection of said west right-of-way line with the south line of Lot 39 Stewart's Addition extended east to said west right-of-way line of Arkansas State Highway #367, thence north along said west right-of-way line a distance of 1700 feet more or less to a point, which point is 430 feet more or less north of the south line of the Northwest Quarter of the Southeast Quarter of Section 28, Township 1 North, Range 12 West, thence east from said point to the east line of the Northwest Quarter of the Southeast Quarter of Section 28, which point is 430 feet more or less north of the south line of said Northeast Quarter of the Southeast Quarter, thence north along the east line of said Northwest Quarter of the Southeast Quarter to the northeast corner thereof, thence west along the north line of said Northwest Quarter of the Southeast Quarter to the west right-of-way line of Missouri Pacific Railroad Company, which point is on the present City Limits of the City of Little Rock, thence west along said City Limits of the City of Little Rock line and the north right-of-way line of 65th Street to the



southwest corner of said Southeast Quarter, Northwest Quarter, which point is on the present City Limits of the City of Little Rock, thence north along the west line of said Southeast Quarter, Northwest Quarter, Section 28, and along the present City Limits of the City of Little Rock to the intersection of said west line with the east right-of-way line of Interstate Highway I-30, thence northerly and easterly along said east right-of-way line to the south line of the Southwest Quarter of the Northeast Quarter of Section 21, Township 1 North, Range 12 West, thence east along the south line of said Southwest Quarter, Northeast Quarter to the Southeast corner thereof, thence north along the east line thereof to its intersection with the east right-of-way line of Interstate Highway I-30, which point is on the present City Limits of the City of Little Rock, thence easterly and northerly along said right-of-way line of Interstate Highway I-30 to the east right-of-way line of Missouri Pacific Railroad Company, the point of beginning, together with and including all adjacent and abutting streets, rights-of-way and railroad rights-of-way.

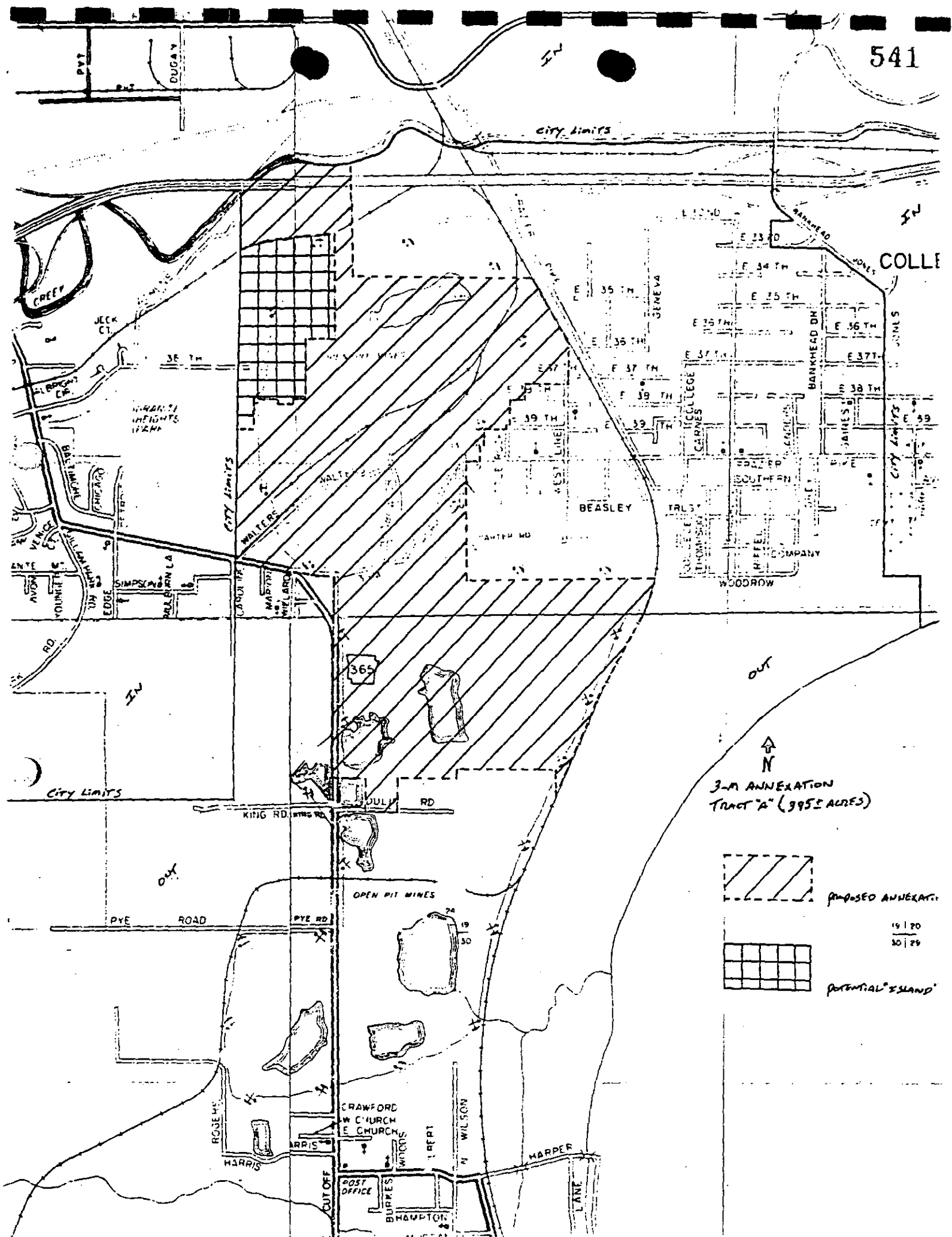

3-M ANNEXATION TRACT "A" (995± ACRES)

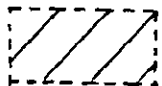

PROPOSED ANNEXATION

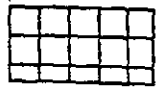

POTENTIAL ISLAND

COLLE

BEASLEY

365



N

3-M ANNEXATION

TRACT "A" (995± ACRES)

OPEN PIT MINES

CRAWFORD W CHURCH

E CHURCH

POST OFFICE

BURKES

HAMPTON

HARRIS

WILSON

HARPER LANE

WALTERS

KING RD

PYE ROAD

ROSEME

HARRIS

CUT OFF

WILSON

HARPER LANE

WALTERS

KING RD

PYE ROAD

ROSEME

HARRIS

CUT OFF

WILSON

HARPER LANE

WALTERS

KING RD

PYE ROAD

ROSEME

HARRIS

CUT OFF

WILSON

HARPER LANE

WALTERS

KING RD

PYE ROAD

ROSEME

HARRIS

CUT OFF

WILSON

HARPER LANE

WALTERS

KING RD

PYE ROAD

ROSEME

HARRIS

CUT OFF

WILSON

HARPER LANE

WALTERS

KING RD

PYE ROAD

ROSEME

HARRIS

CUT OFF

WILSON

HARPER LANE

WALTERS

KING RD

PYE ROAD

ROSEME

HARRIS

CUT OFF

WILSON

HARPER LANE

WALTERS

KING RD

PYE ROAD

ROSEME

HARRIS

CUT OFF

WILSON

HARPER LANE

WALTERS

KING RD

PYE ROAD

ROSEME

HARRIS

CUT OFF

WILSON

HARPER LANE

WALTERS

KING RD

PYE ROAD

ROSEME

HARRIS

CUT OFF

WILSON

HARPER LANE

WALTERS

KING RD

PYE ROAD

ROSEME

HARRIS

CUT OFF

WILSON

HARPER LANE

WALTERS

KING RD

PYE ROAD

ROSEME

HARRIS

CUT OFF

WILSON

HARPER LANE

WALTERS

KING RD

PYE ROAD

ROSEME

HARRIS

CUT OFF

WILSON

HARPER LANE

WALTERS

KING RD

PYE ROAD

ROSEME

HARRIS

CUT OFF

WILSON

HARPER LANE

WALTERS

KING RD

PYE ROAD

ROSEME

HARRIS

CUT OFF

WILSON

HARPER LANE

WALTERS

KING RD

PYE ROAD

ROSEME

HARRIS

CUT OFF

WILSON

HARPER LANE

WALTERS

KING RD

PYE ROAD

ROSEME

HARRIS

CUT OFF

WILSON

HARPER LANE

WALTERS

KING RD

PYE ROAD

ROSEME

HARRIS

CUT OFF

WILSON

HARPER LANE

WALTERS

KING RD

PYE ROAD

ROSEME

HARRIS

CUT OFF

WILSON

HARPER LANE

WALTERS

KING RD

PYE ROAD

ROSEME

HARRIS

CUT OFF

WILSON

HARPER LANE

WALTERS

KING RD

PYE ROAD

ROSEME

HARRIS

CUT OFF

WILSON

HARPER LANE

WALTERS

KING RD

PYE ROAD

ROSEME

HARRIS

CUT OFF

WILSON

HARPER LANE

WALTERS

KING RD

PYE ROAD

ROSEME

HARRIS

CUT OFF

WILSON

HARPER LANE

WALTERS

KING RD

PYE ROAD

ROSEME

HARRIS

CUT OFF

WILSON

HARPER LANE

WALTERS

KING RD

PYE ROAD

ROSEME

HARRIS

CUT OFF

WILSON

HARPER LANE

WALTERS

KING RD

PYE ROAD

ROSEME

HARRIS

CUT OFF

WILSON

HARPER LANE

WALTERS

KING RD

PYE ROAD

ROSEME

HARRIS

CUT OFF

WILSON

HARPER LANE

WALTERS

KING RD

PYE ROAD

ROSEME

HARRIS

CUT OFF

WILSON

HARPER LANE

WALTERS

KING RD

PYE ROAD

ROSEME

HARRIS

CUT OFF

WILSON

HARPER LANE

WALTERS

KING RD

PYE ROAD

ROSEME

HARRIS

CUT OFF

WILSON

HARPER LANE

WALTERS

KING RD

PYE ROAD

ROSEME

HARRIS

CUT OFF

WILSON

HARPER LANE

WALTERS

KING RD

PYE ROAD

ROSEME

HARRIS

CUT OFF

WILSON

HARPER LANE

WALTERS

KING RD

PYE ROAD

ROSEME

HARRIS

CUT OFF

WILSON

HARPER LANE

WALTERS

KING RD

PYE ROAD

ROSEME

HARRIS

CUT OFF

WILSON

HARPER LANE

WALTERS

KING RD

PYE ROAD

ROSEME

HARRIS

CUT OFF

WILSON

HARPER LANE

WALTERS

KING RD

PYE ROAD

ROSEME

HARRIS

CUT OFF

WILSON

HARPER LANE

WALTERS

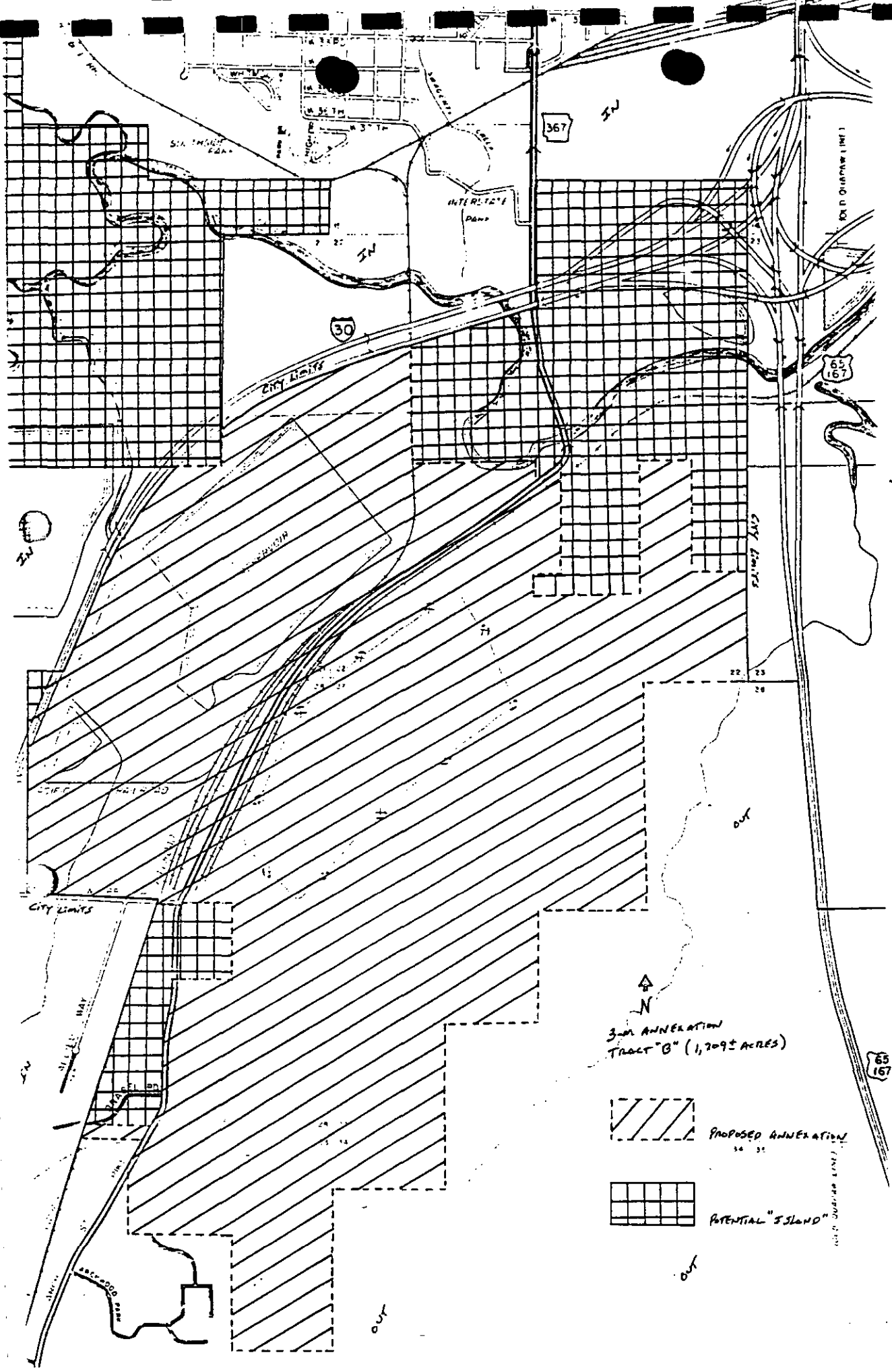

3rd ANNEXATION  
TRACT "B" (1,209± ACRES)

 PROPOSED ANNEXATION  
34 35

 POTENTIAL "ISLAND"  
36 37

OUT

OUT

OUT

CITY OF ST. LOUIS