



ARKANSAS SECRETARY OF STATE

MARK MARTIN

August 15, 2016

The Honorable Phyllis Rhymes
County and Probate Clerk Greene County
320 West Court St, Room 102
Paragould, AR 72450

Re: City of Marmaduke Annexation Ordinance 281

Dear Ms. Rhymes,

This letter acknowledges receipt and filing of the following notice of municipal boundary change by the Office of the Secretary of State:

Filing Type: Annexation pursuant to A.C.A § 14-40-602 (annexation by of a majority of the land owners)

Effective Date: June 17, 2016

County: Greene

City: Marmaduke

City Ordinance: 281

Dated: 05/17/2016

County Court Order: CO-2016-15

Dated: 03/22/2016

A file marked copy of the ordinance and exhibits submitted to our Office along with the GIS Office map are enclosed. By copy of this letter (and its enclosures), the Secretary of State hereby notifies the appropriate mapping authorities for Arkansas. Please retain these copies as official record of the filing of the municipal boundary change by the Arkansas Secretary of State.

If you have any questions or concerns regarding this pending filing please contact our office at 501-682-3401.

Sincerely,

A handwritten signature in cursive script that reads "Cynthia Fisher".

Cynthia Fisher
Special Projects Manager
Arkansas Secretary of State Legal Division
500 Woodlane St, Suite 256
Little Rock, AR 72201
501-682-3401

Cc: ✓ Arkansas Geographic Information Systems Office (w/ encl)
Arkansas Highway and Transportation Department Mapping Department (w/ encl)
UALR Institution for Economic Advancement (w/encl)
Tom-Tom (w/encl)
Hon. Steve Dixon, Mayor of Marmaduke

Room 256 State Capitol • Little Rock, Arkansas 72201-1094
501-682-1010 • Fax 501-682-3510
e-mail: arsos@sos.arkansas.gov • www.sos.arkansas.gov





Arkansas Secretary of State

Mark Martin

State Capitol 500 Woodlane Ave Suite 256 • Little Rock, AR 72201-1094

Municipal Boundary Change Form

County: Greene City/Town: Marmaduke

City Ordinance/Resolution No: 281 Date approved: _____

County Court Case No: CO2016-15 Date of Order: 03/16/2016

Type: Annexation by Petition of majority of Landowners A.C.A. §14-40-602

(List of municipal boundary changes with associated Arkansas Code sections reference on back)

Date Change Effective: June 17, 2016 Emergency clause: Yes No
For Circuit Court Challenge: Date Filed: _____ Upheld Overturned Other (attach explanation)

Initiating party:

All Landowners Majority Landowners Municipal Governing Body State Other _____

Supporting Documentation attached (check all that apply):

- File marked copy of City Ordinance/Resolution (not required for A.C.A § 14-40-1801)
- File marked copy of County Court Order (not required for A.C.A. § 14-40-501)
- Proof of Publication for all Legal Notices (Hearing, Election, City Ordinance/Resolution)
- Copy of Arkansas GIS approved printed map and certification letter
- File marked copy of Petition Part or File marked copy of the certified special election results (if applicable)
- File marked copy of Complaint and final Circuit Court Order (Court Challenge only)

Municipal Contact:

Name: Steve Dixon Title: Mayor

Street Address: 307 W. Mill St.

City: Marmaduke St: AR Zip code: 72443

City/County Official:

Signature: Phyllis Rhynes Title: County Clerk

Date: 6-27-16

(Complete one form for each ordinance/resolution and attach it as a cover page to the supporting document set. Submit the documents to Arkansas Secretary of State, 500 Woodlane Ave, Suite 256, Little Rock, AR 72201-1094)

Office of the Arkansas Secretary of State use only

FILED

AUG 15 2016

Arkansas
Secretary of State

Received by: Cynthia Fisher

FILED

AUG 15 2016

ORDINANCE NO. 281

AN ORDINANCE ACCEPTING THE ANNEXATION OF CERTAIN TERRITORY TO THE CITY OF MARMADUKE ARKANSAS, AND MAKING SAME A PART OF THE CITY OF MARMADUKE, AND ASSIGNING SAME TO WARDS.

Arkansas
Secretary of State

WHEREAS, a Petition was filed with the County Clerk of County, Arkansas, by the majority of the real estate owners of the hereinafter described territory praying that said territory be annexed to, and made a part of the City of Marmaduke, Arkansas; and,

WHEREAS, on March 22, 2016, the County Court of Greene County, Arkansas, found that the petition was signed by a majority of the real estate owners in said territory; that said territory was contiguous and adjoining the present corporate limits of the City of Marmaduke, Arkansas; that an accurate plat or map of said territory had been filed with and made a part of said petition; that proper notice had been given for the time and in the manner prescribed by law, and that all things pertaining thereto had been done in the manner prescribed by law, and that said lands and territory should be annexed to and made a part of the City of Marmaduke, Arkansas, subject to the acceptance of same by the City Council of said City at the proper time, as provided by law; and

WHEREAS, the time fixed by law for appealing from said order of annexation made by the County Court has expired and no appeal has been taken from said order. Now, therefore, be it ordained by the city council of the City of Marmaduke, Arkansas:

Section 1. That the following described lands and territory contiguous and adjoining the City of Marmaduke, Arkansas, be and the same is hereby accepted as part of and annexed to and made a part of the City of Marmaduke, Arkansas:

A part of 36 acres of land in the Southeast corner of South Half of the Northwest Quarter of Section 13, Township 18 North, Range 6 East, more particularly described as beginning at the center of said Section 13, and running thence North with the Quarter Section line 13 ½ chains to a stake; thence West 26 2/3 chains to a stake, thence South 13 ½ chains to a stake in the East and West Quarter Section line, thence East with said Quarter Section line 26 2/3 chains to the place of beginning, that part herein conveyed being described as follows: Beginning at a point of 550 feet East of the Southwest corner of said above described tract as a point of beginning, and running thence North 13 ½ chains to the North boundary line of said tract, thence East along said North line a distance of 250 feet; thence South 13 ½ chains to the South line of said tract; thence West along and with the South line a distance of 250 feet to the true point of beginning

That part of the South Half of the Northwest Quarter of Section 13, Township 18 North, Range 6 East described as follows: Beginning at the Southeast corner of said tract, run thence North 89 degrees 08 minutes West 527 feet to the true point of beginning, run thence North 89 degrees 08 minutes West 213 feet, run thence North 600 feet, run thence South 89 degrees 08 minutes East

213 feet, run thence South 600 feet to the true point of beginning, containing 3.0 acres, more or less

That part of the South Half of the Northwest Quarter of Section 13, Township 18 North, Range 6 East, more particularly described as follows: Beginning at the Southeast corner of said tract, run thence North 0 degrees 01 minutes East 908.7 feet, run thence North 89 degrees 36 minutes West 528.0 feet to the true point of beginning, run thence North 89 degrees 36 minutes West 432.0 feet, run thence South 304.0 feet, run thence East 432.0 feet, run thence North 301.0 feet to the true point of beginning, containing 3.0 acres, more or less, AND subject to any utility easements and any additional easements or rights-of-way associated with the television tower lease agreement of those lands lying South of the above described tract.

Also a 25-foot access easement, the centerline of which is described as follows: That part of the South Half of the Northwest Quarter of Section 13, Township 18 North, Range 6 East, more particularly described as follows: Beginning at the Southeast corner of said tract, run thence North 0 degrees 01 minutes East 854.6 feet to a point on the centerline of a proposed 25 foot drive for the true point of beginning, run thence North 89 degrees 36 minutes West along said centerline 527.9 feet to the East line of the above described tract.

That part of the South Half of the Northwest Quarter of Section 13, Township 18 North, Range 6 East, described as follows: Beginning at the Southeast corner of said tract, run thence North 89 degrees 08 minutes West 197 feet, to the true point of beginning, run thence North 89 degrees 08 minutes West 330 feet, run thence North 220 feet, run thence South 89 degrees 08 minutes East 330 feet, run thence South 220 feet to the true point of beginning, containing 1.68 acres, more or less

That part of the South Half of the Northwest Quarter of Section 13, Township 18 North, Range 6 East, described as follows: Beginning at the Southeast corner of said tract, run thence North 89 degrees 08 minutes West 197 feet, run thence North 220 feet, run thence North 89 degrees 08 minutes West 330 feet, run thence North 681 feet, run thence South 89 degrees 36 minutes East 528.0 feet, run thence South 908.7 feet to the true point of beginning, subject to any utility easements, and any easements for access between the other tracts located adjacent to said tract.

That part of the South Half of the Northwest Quarter of Section 13, Township 18 North, Range 6 East described as follows: Beginning at the Southeast corner of said tract, run thence North 89° 08' West 740.9 feet to the true point of beginning, run thence North 89° 08' West 219.0 feet, run thence North 596.8 feet, run thence East 219.0 feet, run thence South 600.1 feet to the true point of beginning, containing 3.0 acres, more or less.

The part of the Northwest Quarter of the Northeast Quarter of Section 13, Township 18 North, Range 6 East, described as follows, to-wit: Beginning at a point on the West Line of said tract 580 feet South of the Northwest corner of said tract, run thence East 112 feet, run thence South 200 feet, run thence West 112 feet, run thence North 200 feet to the point of beginning, containing .51 acres of land, more or less, and subject to all existing road rights of way and utility easements.

SECTION 2. That the above described territory shall be annexed to and made a part of Ward ~~III~~ of the City of Marmaduke, Arkansas and the same shall henceforth be a part of said ward as fully as existing parts of said ward.

SECTION 3. That the services listed in the schedule of services contained in the petition shall be extended to the annexed area within three [3] years after the date the annexation becomes final. The scheduled services contained in the petition are:

1. Water/Sewer
2. Police
3. Fire

The schedule of services shall be included in the annual written report required by ACA 14-40-2201 and 14-40-2202.

Passed and approved May 17th, 2016.

APPROVED:



Mayor Steve Dixon

Attest:



City Clerk

F I L E D

AUG 15 2016

**Arkansas
Secretary of State**

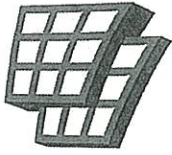

ARKANSAS
GIS OFFICE

April 22, 2016

Honorable Mayor Steve Dixon
P.O. Box 208
Marmaduke, AR 72443

RE: City of Marmaduke Annexation Coordination Requirement

Mayor Dixon,

Thank you for coordinating with our office as you seek to annex property into the City of Marmaduke, AR (County Court Order CO2016-15). This letter represents confirmation that you have properly coordinated with our office (Arkansas GIS Office) as specified in § 14-40-101 (Act 914 of 2015) of the 90th General Assembly.

Our office will wait completion of any additional steps necessary for the proposed boundary change, which normally comes from the Arkansas Secretary of State Elections Division after any appropriate filing by the County Clerk.

Thank you,

Richie Pierce, Sr. GIS Analyst
/rp

FILED

'AUG 15 2016

Ark
Secretary of State

Proposed Annex: City of Marmaduke
 April 2016

City: Marmaduke
 Mayor: Steve Dixon

Arkansas Code 14-40-101.

Before an entity undertakes an annexation, consolidation, or detachment, proceeding under this chapter, the entity shall coordinate with the Arkansas Geographic Information Systems Office for preparation of legal descriptions and digital mapping for the relevant annexation, consolidation, and detachment areas.

The map contained herein, is evidence, the entity has met requirements of Act 914 of 2015

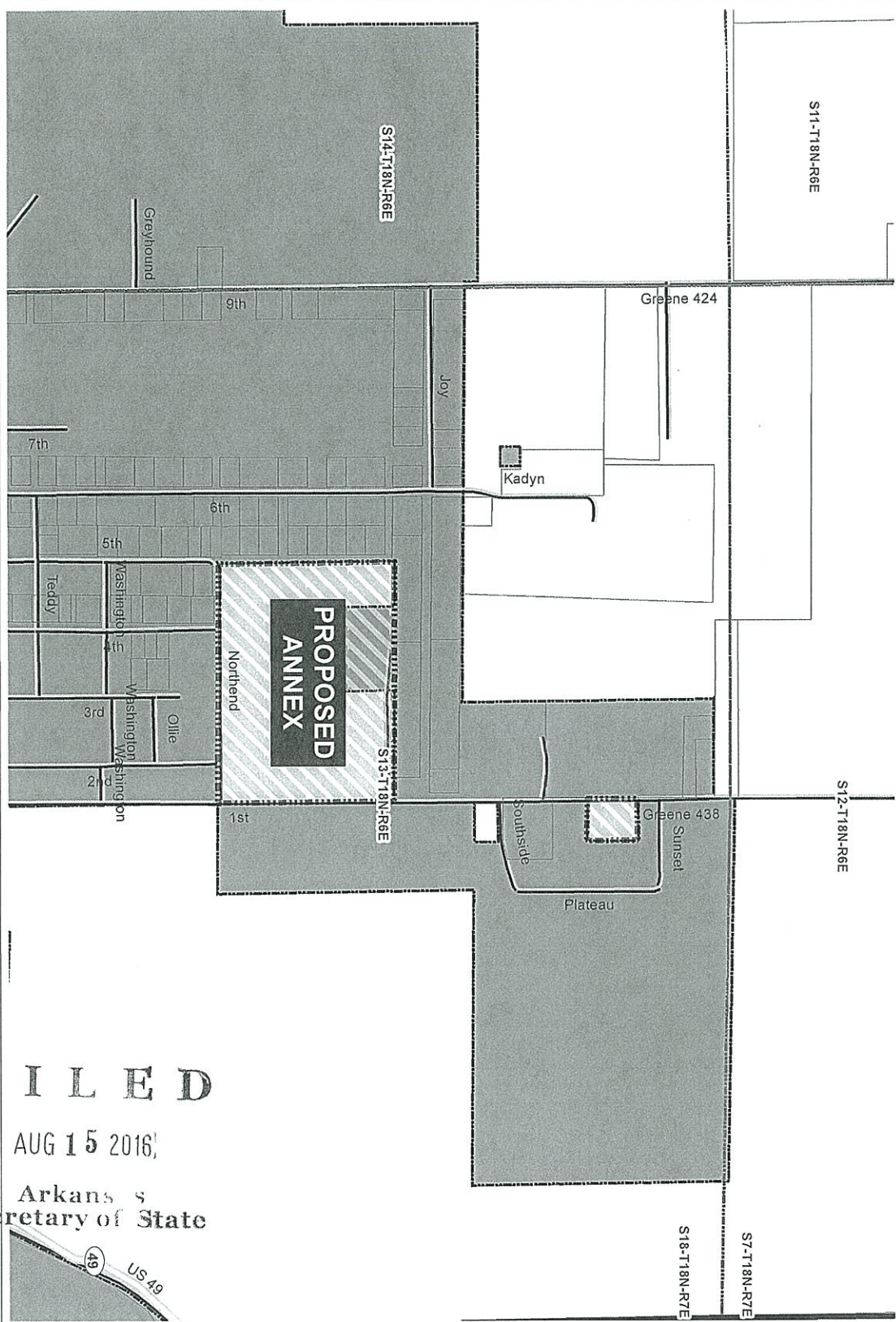

- Proposed Annex
- Watership-Range
- Sections
- Parcels
- Highway
- Main Road
- Existing City
- Highwaying City
- County Boundary



FILED
 AUG 15 2016
 Arkansas Secretary of State

