



August 29, 2013

## ARKANSAS SECRETARY OF STATE

# MARK MARTIN

The Honorable Larry Crane  
Pulaski County Clerk  
401 West Markham  
Little Rock, AR 72201

RE: Annexation

Dear Mr. Crane,

The following information has been recorded and filed in the office of the Secretary of State:

County: Pulaski

City: North Little Rock

Annexation:

Ordinance No. 8543 – Dated August 07, 2013

County Court No. 2013-0005 – Filed April 1, 2013

Plat

Ordinance No. 8544 – Dated August 07, 2013

County Court No. 2013-0001 – Filed March 21, 2013

Plat

Ordinance No. 8545 – Dated August 07, 2013

County Court No. 2013-0006 – Filed April 5, 2013

Plat

By copy of this letter, I am sending file marked copies of all of the information to the UALR Institute for Economic Advancement, Arkansas Highway Mapping Department, and TomTom. All others listed will only receive notification of the annexation by copy of this letter.

If you have any questions please do not hesitate to contact me at 1-800-482-1127 or 501-682-3451

Sincerely,

Shelley Roberts

Voter Services Representative  
Arkansas Secretary of State

CC: UALR Institute for Economic Advancement  
Arkansas Highway Mapping Department  
TomTom  
Arkansas Municipal League  
Diane Whitbey, North Little Rock City Clerk  
Shelby Johnson, State Geographical Information Officer



**FILED**

**AUG 12 2013**

**Arkansas  
Secretary of State**

IN THE COURT OF PULASKI COUNTY, ARKANSAS  
IN THE MATTER OF ANNEXING LANDS,  
COMMONLY DESCRIBED AS LANDS  
TO BE TITLED THE "UTILITY TRI STATE ANNEXATION",  
NORTH LITTLE ROCK, ARKANSAS.

**ORDER APPROVING ANNEXATION** FILED 05/15/13 09:35:11  
Larry Crane Pulaski Circuit Clerk

On the 14<sup>th</sup> of May, 2013 came onto be heard at a public hearing the Petition of the UTILITY TRI STATE ANNEXATION, for an Order annexing to the City of North Little Rock, which property is described in the Petition for Annexation, and based upon the Petition, the notice of the hearing published pursuant to law, from statements of council and from other evidence adduced, the Court finds that said Petition is in proper legal form, that the Notice of Hearing thereon was published for the time and in the manner required by law, that the allegations of the Petition are true, that the petitioners are majority owners of the property in the area sought to be annexed, that the limits of the territory to be annexed have been accurately shown on a map thereof made and filed with said Petition, that the prayer of the petition is proper and should be granted and that all requirements of law for entry of an Order granting the said Petition have been met.

IT IS THEREFORE CONSIDERED, ORDERED AND ADJUDGED that the following described territory be, and the same hereby is annexed to the City of North Little Rock, Arkansas, to wit:

UTILITY TRI STATE ANNEXATION

Legal Description:

Part of the East 1/2 of Section 23 and Part of the West 1/2 of Section 24, all in Township 2 North, Range 11 West, Pulaski County, Arkansas, more particularly described as follows:

Commencing at the NE corner of the NW 1/4 SW 1/4 of said Section 24; thence S 00°55' W along the East line thereof for 473.10 ft; thence S 82°48' W for 77.76 ft to the point of beginning; thence S 07° 22' E for 778.87 ft to a point on the Northerly right-of-way line of Interstate 40 frontage road; thence along said right-of-way following bearings and distances:

S 76° 55' W for 90.56 ft; thence S 82° 05' W for 149.39 ft; thence S 82° 47' W for 446.93 ft; thence S 82° 23' W for 716.78 ft; thence S 82° 37' W for 736.65 ft; thence N 07° 13' W for 10.00 ft; thence S 82° 37' W for 662.88 ft; thence S 07° 13' E for 10.00 ft; thence S 82° 37' W for 1181.43 ft;

Thence leaving the said Northerly right-of-way, N 31° 57' E for 975.89 ft; thence N 82° 01' E for 2063.58 ft; thence N 82° 01' E for 1300.73 ft to the point of beginning and containing 66.3 acres more or less.

It is therefore ordered this 14<sup>th</sup> of May, 2013.

  
PULASKI COUNTY JUDGE

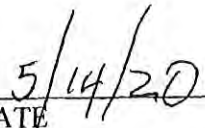
  
DATE



IN THE COUNTY COURT OF PULASKI COUNTY, ARKANSAS  
IN THE MATTER OF ANNEXING LANDS,  
COMMONLY DESCRIBED AS LANDS  
TO BE TITLED THE "UTILITY TRI STATE ANNEXATION",  
NORTH LITTLE ROCK, ARKANSAS.

CASE NO. \_\_\_\_\_

FILED 08/07/13 14:10:13  
Larry Crane Pulaski Circuit Clerk

**ORDER OF CONFIRMATION OF ANNEXATION**

On this day is presented to the Court a certified copy of Ordinance 8545, duly adopted by the City Council of the City of North Little Rock, Arkansas, on the 24<sup>th</sup> day of June, 2013 accepting as a part and parcel of the City of North Little Rock, Arkansas, in accordance with the Order of Annexation made and entered by this Court on the 14<sup>th</sup> day of May, 2013 the area described on Attachment "A", attached hereto and thus described in both the Order of this Court and said ordinance of the City Council of the City of North Little Rock, Arkansas, lying wholly within Pulaski County, Arkansas;

And it appearing to the Court that the statements in said ordinance are true and correct and that no person has given any notice or instituted any proceeding to prevent said annexation of said area of the City of North Little Rock, Arkansas;

It is, therefore, CONSIDERED, ORDERED AND ADJUDGED by this Court that the proceeding annexing the area hereinbefore identified to and making the same a part and parcel of the City of North Little Rock, Arkansas, be and the same is hereby in all things ratified and confirmed.

And the Clerk of this Court is hereby ordered and directed to make and duly certify one copy of the Plat of such annexed territory, one of this said Order of Annexation made and entered by this Court on the 14<sup>th</sup> day of May, 2013 and the said ordinance adopted by the City Council of the City of North Little Rock, Arkansas, and forward a copy of each, together with a certified copy of this Order, to the Secretary of the State, who shall file and preserve the same; and the Clerk of this Court shall forward one copy of the plat of such annexed territory and one copy of said Order of Annexation made and entered by this Court on the 14<sup>th</sup> day of May, 2013 to the Director of the Tax Division of the Arkansas Public Service Commission so that it may file and preserve the same and so that it may notify all utility companies having property in the City of North Little Rock, Arkansas, as provided by law in Arkansas Code Annotated Section 14-40-695 (b) (1); and the Clerk of this Court is further ordered and directed to forward a certified copy of said Order of Annexation made and entered by this Court on the 8th day of January, 2013 together with a certified copy of this order, to the City Clerk of the City of North Little Rock, Arkansas.

It is so ORDERED on this 6 day of August, 2013.

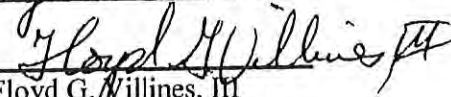
  
Floyd G. Willines, III  
County Judge

O-13-57

ORDINANCE NO. 8545 FILED 08/07/13 14:10:23  
Larry Crane Pulaski Circuit Clerk

**AN ORDINANCE ACCEPTING THE ANNEXATION OF LANDS COMMONLY DESCRIBED AS LANDS TO BE TITLED THE "UTILITY TRI STATE ANNEXATION" TO THE CITY OF NORTH LITTLE ROCK, ARKANSAS, AND MAKING UTILITY TRI STATE ANNEXATION A PART OF THE CITY OF NORTH LITTLE ROCK; DECLARING AN EMERGENCY; AND FOR OTHER PURPOSES.**

**FILED**

**AUG 12 2013**

**Arkansas  
Secretary of State**

WHEREAS, a petition (see Exhibits "A" and "B" attached hereto) was filed with the Circuit Clerk of Pulaski County, Arkansas, by a majority of the owners of the hereinafter described lands praying that said lands be annexed to and made a part of the City of North Little Rock, Arkansas; and

WHEREAS, on May 14, 2013, the County Court of Pulaski County, Arkansas (Notice of Public Hearing and Order approving Annexation recorded in Book 2013-0111 at Page 296 are attached hereto as Exhibits "C" and "D" respectively) found that the petition was signed by a majority of the owners in area and in number of the following-described lands located in Pulaski County, Arkansas; that said lands were contiguous and adjoining the present corporate limits of the City of North Little Rock, Arkansas; that an accurate plat or map of said lands had been filed with and made a part of said petition; that proper notice had been given for the time and in the manner prescribed by law and that all things pertaining thereto had been done in a manner prescribed by law, and that said lands should be annexed to and made a part of the City of North Little Rock, Arkansas, subject to the acceptance of same by the City Council of said City at the proper time as provided by law.

NOW, THEREFORE, BE IT ORDAINED BY THE CITY COUNCIL OF THE CITY OF NORTH LITTLE ROCK, ARKANSAS:

SECTION 1: That the following described lands contiguous to and adjoining the City of North Little Rock, Arkansas be, and the same are hereby, accepted as part of and annexed to and made a part of the City of North Little Rock (see map attached hereto as Exhibit "E"):

Part of the East ½ of Section 23 and Part of the West ½ of Section 24, all in Township 2 North, Range 11 West, Pulaski County, Arkansas, more particularly described as follows:

Commencing at the NE corner of the NW ¼ SW ¼ of said Section 24; thence S 00°55' W along the East line thereof for 473.10 ft; thence S 82°48' W for 77.76 ft to the point of beginning; thence S 07° 22' E for 778.87 ft to a point on the Northerly right-of-way line of Interstate 40



frontage road; thence along said right-of-way following bearings and distances:

S 76° 55' W for 90.56 ft; thence S 82° 05' W for 149.39 ft; thence S 82° 47' W for 446.93 ft; thence S 82° 23' W for 716.78 ft; thence S 82° 37' W for 736.65 ft; thence N 07° 13' W for 10.00 ft; thence S 82° 37' W for 662.88 ft; thence S 07° 13' E for 10.00 ft; thence S 82° 37' W for 1181.43 ft;

Thence leaving the said Northerly right-of-way, N 31° 57' E for 975.89 ft; thence 82° 01' E for 2063.58 ft; thence n 82° 01' E for 1300.73 ft to the point of beginning and containing 66.3 acres more or less.

SECTION 2: That all ordinances or parts or ordinances in conflict herewith are hereby repealed to the extent of the conflict.

SECTION 3: That the provisions of this Ordinance are hereby declared to be severable, and if any section, phrase or provision shall be declared or held invalid, such invalidity shall not affect the remainder of the sections, phrases or provisions.

SECTION 4: It is hereby found by the City Council of the City of North Little Rock, Arkansas that there is an immediate need to annex this property to the City in order that the proper growth of the City can be encouraged and in order that the City utilities, police protection and other services may be furnished to the residents therein, and that unnecessary delay of said annexation will cause undue hardship to the citizens of North Little Rock and the residents of the area to be annexed; THEREFORE, an emergency is declared to exist, and this Ordinance being immediately necessary for the preservation of the public peace, health and safety shall be in full force and effect immediately after its passage and approval.

PASSED:

6-24-13

APPROVED:

Joe A. Smith  
Mayor Joe A. Smith

SPONSOR:

Joe A. Smith  
Mayor Joe A. Smith

ATTEST:

Diane Whitbey  
Diane Whitbey, City Clerk

APPROVED AS TO FORM:

C. Jason Carter  
C. Jason Carter, City Attorney

PREPARED BY THE OFFICE OF THE CITY ATTORNEY/b

FILED	<u>1135</u>	A.M.	_____	P.M.
By	<u>Asst. City Atty Fleaming</u>			
DATE	<u>6-18-13</u>			
Diane Whitbey, City Clerk and Collector North Little Rock, Arkansas				
RECEIVED BY	<u>Whitbey</u>			

**FILED**

**AUG 12 2013**

**Arkansas  
Secretary of State**

IN THE COUNTY COURT OF PULASKI COUNTY, ARKANSAS

IN THE MATTER OF ANNEXING LANDS,  
COMMONLY DESCRIBED AS LANDS  
TO BE TITLED THE "UTILITY TRI STATE ANNEXATION",  
NORTH LITTLE ROCK, ARKANSAS.

CASE NO. 2013-0006

FILED 04/05/13 14:40:14  
Larry Crane Pulaski Circuit Clerk

**PETITION FOR ANNEXATION**

Come the Petitioners listed with Exhibit "A", individual petitions, attached hereto, incorporated by reference herein, and made a part hereof, as though set forth word for word, such Petitioners being a majority of the property owners of the subject real property described more particularly herein below, such real property being commonly referred to as lands north of Interstate 40 and along Diamond Drive and Eanes Road, to be titled the UTILITY TRI STATE ANNEXATION, property being contiguous to and adjoining the City of North Little Rock, Pulaski County, Arkansas, and petition that the following described real property and all abutting roadway rights-of-way be annexed to the City of North Little Rock, Pulaski County, Arkansas as follows:

**EXHIBIT "A"**

**UTILITY TRI STATE ANNEXATION**

**Legal Description:**

Part of the East ½ of Section 23 and Part of the West ½ of Section 24, all in Township 2 North, Range 11 West, Pulaski County, Arkansas, more particularly described as follows:

Commencing at the NE corner of the NW ¼ SW ¼ of said Section 24; thence S 00°55' W along the East line thereof for 473.10 ft; thence S 82°48' W for 77.76 ft to the point of beginning; thence S 07° 22' E for 778.87 ft to a point on the Northerly right-of-way line of Interstate 40 frontage road; thence along said right-of-way following bearings and distances:

S 76° 55' W for 90.56 ft; thence S 82° 05' W for 149.39 ft; thence S 82° 47' W for 446.93 ft; thence S 82° 23' W for 716.78 ft; thence S 82° 37' W for 736.65 ft; thence N 07° 13' W for 10.00 ft; thence S 82° 37' W for 662.88 ft; thence S 07° 13' E for 10.00 ft; thence S 82° 37' W for 1181.43 ft;

Thence leaving the said Northerly right-of-way, N 31° 57' E for 975.89 ft; thence 82° 01' E for 2063.58 ft; thence n 82° 01' E for 1300.73 ft to the point of beginning and containing 66.3 acres more or less.





An accurate map of the above described subject real property plainly and accurately evidencing the limits thereof is attached hereto, labeled Exhibit "B," and incorporated by reference herein and made a part hereof as though set forth word for word.

That Wade Dunlap, City Planner for the City of North Little Rock, is hereby named as the person authorized to act on behalf of the Petitioners, in matters concerning and relating to the annexation of the subject real property.

WHEREFORE, the petitioners request that the Pulaski County Court fix a time and place for the hearing on this Petition; that the subject real property be allowed to be annexed to the City of North Little Rock, Pulaski County, Arkansas; and for all other people and legal relief incident and necessary to the accomplishment of such purpose.

PETITIONERS (AS ATTACHED)

STATE OF ARKANSAS }  
COUNTY OF PULASKI } SS

I, Diane Whitbey, City Clerk and Collector  
for the City of North Little Rock, Arkansas, do hereby  
certify that the foregoing instrument is a true and correct  
copy of the original Ord 8545 Book No. 41  
filed in this office on the 24 day of June  
2013.

IN TESTIMONY WHEREOF, I have hereunto set my  
hand and affixed the seal of this office this 9<sup>th</sup> day of  
July, 2013.

Diane Whitbey, City Clerk & Collector

By: Ko Thomas





**Notice of Public Hearing on Petition for Annexation**

NOTICE is hereby given that on MAY 14TH, 2013 at 11:00AM there will be a public hearing in the office of the County Judge, 201 South Broadway, Pulaski County Administration Building, Little Rock, Arkansas 72201, of Pulaski County, Arkansas, of the petition for annexation to the City of North Little Rock, Arkansas, to wit:

**UTILITY TRI STATE ANNEXATION**

**Legal Description:**

Part of the East ½ of Section 23 and Part of the West ½ of Section 24, all in Township 2 North, Range 11 West, Pulaski County, Arkansas, more particularly described as follows:

Commencing at the NE corner of the NW ¼ SW ¼ of said Section 24; thence S 00°55' W along the East line thereof for 473.10 ft; thence S 82°48' W for 77.76 ft to the point of beginning; thence S 07° 22' E for 778.87 ft to a point on the Northerly right-of-way line of Interstate 40 frontage road; thence along said right-of-way following bearings and distances:

S 76° 55' W for 90.56 ft; thence S 82° 05' W for 149.39 ft; thence S 82° 47' W for 446.93 ft; thence S 82° 23' W for 716.78 ft; thence S 82° 37' W for 736.65 ft; thence N 07° 13' W for 10.00 ft; thence S 82° 37' W for 662.88 ft; thence S 07° 13' E for 10.00 ft; thence S 82° 37' W for 1181.43 ft;

Thence leaving the said Northerly right-of-way, N 31° 57' E for 975.89 ft; thence 82° 01' E for 2063.58 ft; thence n 82° 01' E for 1300.73 ft to the point of beginning and containing 66.3 acres more or less.

That said petition is signed by a majority of the property owners of the proposed acreage and being and constituting a majority of the real estate in said area proposed to be annexed and herein described.

A map of said area proposed to be annexed plainly and accurately showing the limits thereof is attached to said petition and Wade Dunlap is named as the person authorized to act on behalf of said petitioners.

All persons interested in contesting the annexation of said area hereinbefore described to the City of North Little Rock, Arkansas, should appear at the hearing at the time and place designated hereinbefore.

THIS the 23RD day of APRIL, 2013.

Wade Dunlap, agent for and acting on behalf of the petitioners.



IN THE COURT OF PULASKI COUNTY, ARKANSAS  
 IN THE MATTER OF ANNEXING LANDS,  
 COMMONLY DESCRIBED AS LANDS  
 TO BE TITLED THE "UTILITY TRI STATE ANNEXATION",  
 NORTH LITTLE ROCK, ARKANSAS.

**ORDER APPROVING ANNEXATION** FILED 05/15/13 09:35:11  
 Larry Crane Pulaski Circuit Clerk

On the 14<sup>th</sup> of May, 2013 came onto be heard at a public hearing the Petition of the UTILITY TRI STATE ANNEXATION, for an Order annexing to the City of North Little Rock, which property is described in the Petition for Annexation, and based upon the Petition, the notice of the hearing published pursuant to law, from statements of council and from other evidence adduced, the Court finds that said Petition is in proper legal form, that the Notice of Hearing thereon was published for the time and in the manner required by law, that the allegations of the Petition are true, that the petitioners are majority owners of the property in the area sought to be annexed, that the limits of the territory to be annexed have been accurately shown on a map thereof made and filed with said Petition, that the prayer of the petition is proper and should be granted and that all requirements of law for entry of an Order granting the said Petition have been met.

IT IS THEREFORE CONSIDERED, ORDERED AND ADJUDGED that the following described territory be, and the same hereby is annexed to the City of North Little Rock, Arkansas, to wit:

UTILITY TRI STATE ANNEXATION

Legal Description:

Part of the East ½ of Section 23 and Part of the West ½ of Section 24, all in Township 2 North, Range 11 West, Pulaski County, Arkansas, more particularly described as follows:

Commencing at the NE corner of the NW ¼ SW ¼ of said Section 24; thence S 00°55' W along the East line thereof for 473.10 ft; thence S 82°48' W for 77.76 ft to the point of beginning; thence S 07° 22' E for 778.87 ft to a point on the Northerly right-of-way line of Interstate 40 frontage road; thence along said right-of-way following bearings and distances:

S 76° 55' W for 90.56 ft; thence S 82° 05' W for 149.39 ft; thence S 82° 47' W for 446.93 ft; thence S 82° 23' W for 716.78 ft; thence S 82° 37' W for 736.65 ft; thence N 07° 13' W for 10.00 ft; thence S 82° 37' W for 662.88 ft; thence S 07° 13' E for 10.00 ft; thence S 82° 37' W for 1181.43 ft;

Thence leaving the said Northerly right-of-way, N 31° 57' E for 975.89 ft; thence N 82° 01' E for 2063.58 ft; thence N 82° 01' E for 1300.73 ft to the point of beginning and containing 66.3 acres more or less.

It is therefore ordered this 14<sup>th</sup> of May, 2013.

Buddy Williams  
 PULASKI COUNTY JUDGE

5/14/20  
 DATE





# Utility Tri State Annexation

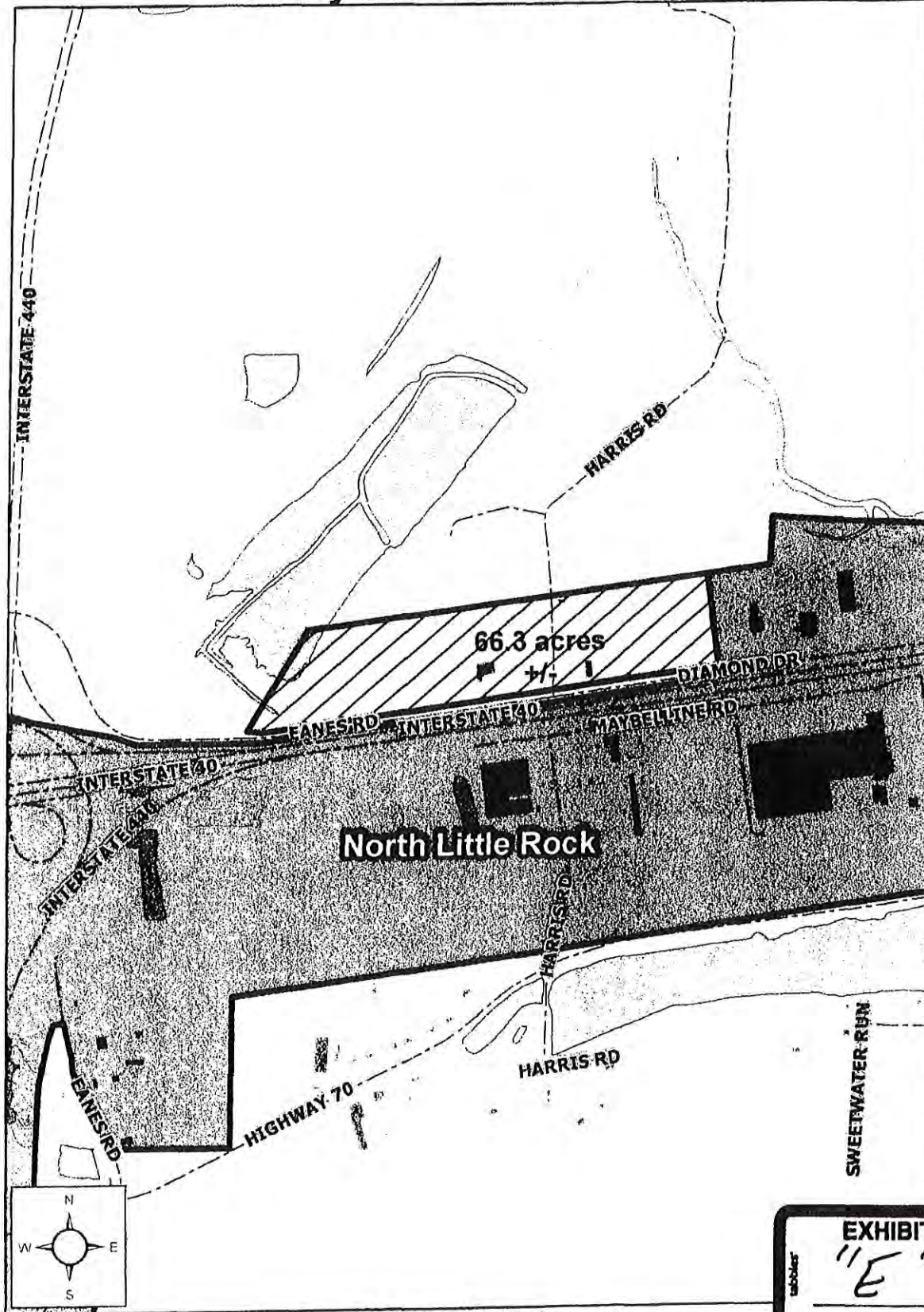

1 inch = 1,200 feet

This is not a legal survey:  
Property lines depicted are  
not to survey accuracy.

Date: 6/10/2013