



Arkansas Secretary of State

Mark Martin Arkansas Secretary of State, 500 Woodlane Ave, Little Rock, AR 72201-1094

Municipal Boundary Change Checklist

County: Benton City/Town: Pea Ridge

City Ordinance/Resolution No: 593 Date approved: 04/18/2017

County Court Case No: N/A Date Order Filed: _____

Type: Annexation of surrounded unincorporated area (island/doughnut holes) by ordinance A.C.A. §14-40-501

Date Change Effective: 04/18/2017 Set by: Municipal Ordinance Emergency Clause Other

For Circuit Court Challenge: Date Order Filed: _____ Upheld Overturned Other (attach explanation)

Initiating party:

All Landowners Majority Landowners Municipal Governing Body State Other _____

Supporting Documentation attached (check all that apply):

- File marked copy of City Ordinance/Resolution (not required for A.C.A § 14-40-1801)
- File marked copy of County Court Order (not required for A.C.A. § 14-40-501)
- Proof of Publication for all Legal Notices (Hearing, Election, City Ordinance/Resolution)
- Copy of Arkansas GIS approved printed map and certification letter
- File marked copy of Petition Part or File marked copy of the certified special election results (if applicable)
- File marked copy of Complaint and final Circuit Court Order (Court Challenge only)

Municipal Contact:

Name: Ms. Sandy Button Title: Pea Ridge City Clerk & Treasurer

Street Address: P.O. Box 10

City: Pea Ridge St: AR Zip code: 72751

City/County Official:

Signature: _____ Title: _____

Date: _____

Complete one form for each ordinance/resolution and attach it as a cover page to the supporting document set. Submit the documents to Arkansas Secretary of State, Atten: Municipal Boundary Filing, 500 Woodlane Ave, Little Rock, AR 72201-1094

Office of the Arkansas Secretary of State use only

Received by: Cynthia Fisher

F I L E D

MAY 11 2017

Arkansas
Secretary of State

BENTON COUNTY

STATE OF ARKANSAS

TENA O'BRIEN

COUNTY CLERK & VOTER REGISTRAR

215 EAST CENTRAL, SUITE 217
BENTONVILLE, AR 72712-5373

PROBATE COURT CLERK

COURTHOUSE, 102 N.E. "A" STREET
BENTONVILLE, AR 72712-5350

May 1, 2017

Honorable Mark Martin
Secretary of State
Room 256 State Capitol
Little Rock, AR 72201-1094

RECEIVED
MAY 05 2017
Arkansas
Secretary of State

RE: City of Pea Ridge Annexation Ordinance 593

Dear Secretary Martin:

Enclosed please find a certified copy of City of Pea Ridge Ordinance No. 593 accepting and annexing various unincorporated areas completely surrounded by the incorporated limits of the municipality of Pea Ridge, Arkansas adopted on April 18, 2017.

Please record these annexations on you records and acknowledge receipt of these documents.

Very truly yours,

Tena O'Brien

Tena O'Brien By: T. Underwood

COUNTY CLERK
(479) 271-1013
FAX (479) 271-1019

VOTER REGISTRAR
(479) 271-5704

BENTONVILLE
(479) 271-1013
FAX (479) 271-1019

SILAM SPRINGS
(479) 238-0120
FAX (479) 524-8534

PROBATE COURT CLERK
(479) 271-5727
FAX (479) 271-1712

ROGERS
(479) 636-3727
FAX (479) 636-4922
ARCHIVIST (479) 636-1037
FAX (479) 636-1053

FILED

ORDINANCE 593

2017 APR 24 PM 2:29

AN ORDINANCE ANNEXING CERTAIN LANDS THAT ARE COMPLETELY SURROUNDED BY THE INCORPORATED LIMITS OF THE CITY OF PEA RIDGE, DECLARING AN EMERGENCY; AND FOR OTHER PURPOSES

TELLER FORBEN
CLERK
BENTON COUNTY, AR

WHEREAS, A.C.A. 14-40-501 – 14-40-503 provides that unincorporated islands of land that have been completely surrounded by the incorporated limits of a municipality may be annexed by that municipality; and

WHEREAS, the City of Pea Ridge desires to annex certain lands more completely described below; and

WHEREAS, the council finds that the territory to be annexed is surrounded by the incorporated limits of the City of Pea Ridge; and

WHEREAS, the area to be annexed complies with the standards for lands qualifying for annexation which are set forth in A.C.A. 14-40-302 and 14-40-501; and

WHEREAS, the council further finds that the territory consists of lands that furnish the abode for a densely settled community or represent the actual growth of the municipality beyond its legal boundary; are held for sale or use as municipal lots or as suburban property; and are valuable by reason of their adaptability for prospective municipal uses.

WHEREAS, on January 25, 2017, a public hearing notice was published setting out the description of the territory proposed to be annexed; and all property owners within the area were notified by certified mail of their right to appear at the public hearing to present their views on the proposed annexation; and

WHEREAS, said public hearing was held on February 21, 2017, regarding this proposed annexation.

NOW, THEREFORE, BE IT ORDAINED BY THE CITY COUNCIL OF THE CITY OF PEA RIDGE, ARKANSAS:

SECTION 1. That the following described unincorporated lands, which are completely surrounded by the city limits of the City of Pea Ridge, are hereby annexed to the City of Pea Ridge: All unincorporated territory in the W ¼ of the SW ¼ SW ¼ of S36, T21N, R30 West, otherwise described as: Part of the SW ¼ SW ¼ of S36, T21N, R30W, beginning at the NW corner and extending eastward on the northern line of said SW ¼ SW ¼ a distance of 261 feet; thence south 1320 feet to Highway 72, which bounds said property on the south; thence west 261 feet to the western boundary of said property; thence north to the P.O.B., per the deed recorded on Book 2006 Page 25667, in the Benton County Circuit Clerk's Office.

FILED

MAY 11 2017

Arkansas
Secretary of State

2017 1473

FILED

2017 APR 24 PM 2: 29

MISS. TAYLOR
CO. & PROBATE CLERK
BENTON COUNTY, AR

SECTION 2. That the above described territory shall be annexed to and become a part of Ward # 2 of the City of Pea Ridge, and the same shall henceforth be a part of said ward as fully as existing parts of said ward.

SECTION 3. All necessary urban services, such as police and fire protection, solid waste collection and disposal, and maintenance of public streets shall be extended to the annexed area within a reasonable time.

SECTION 4. Because these areas are in need of all necessary urban services, such as police and fire protection, and this is necessary for the public peace, health, safety and welfare, an emergency is declared to exist. Therefore, this ordinance shall be in full force and effect from and after the date of its passage.

AND APPROVED THIS 18th DAY OF April, 2017.



[Handwritten Signature]
Mayor

[Handwritten Signature]
City Clerk

A

Exhibit A

Pea Ridge Annexation Island Annexation

FILED

2017 APR 24 PM 2:29

JOHN W. WHELAN
CO. & PROBATE CLERK
BENTON COUNTY, AR

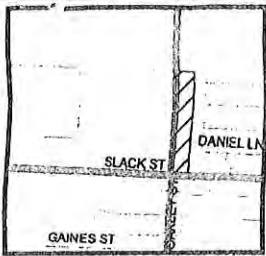

SITE VICINITY



Area to be Annexed

FILED

MAY 11 2017

Arkansas
Secretary of State

Disclaimer: This map was developed from the best available sources and constitutes a graphic representation of these data sources. No guarantee of accuracy is granted, nor is any responsibility for reliance thereon assumed. In no event shall the NWARPC or any other entity be liable for direct, indirect, incidental, consequential or special damages of any kind, including, but not limited to, loss of anticipated profits or benefits arising out of use of or reliance on the data. The NWARPC and/or any other entity are in no way responsible for or liable for any misrepresentation or re-use of this map. Distribution of this map is intended for information purposes only and should not be considered authoritative for engineering, legal and other site-specific uses.



2017 1475

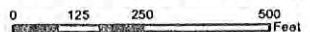

Map Features

- Area to be Annexed
- S-T-R
- QQ Sections
- Pea Ridge City Limits
- Roads



NWARPC_GIS-SJS
IslandAnnexation_121916.mxd
12/19/16

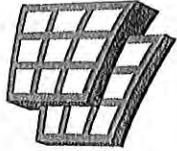

ARKANSAS
GIS OFFICE

May 8, 2017

Mrs. Cynthia Fisher
Special Projects Manager
AR Secretary of State

RE: City of Pea Ridge Annexation Coordination Requirement

Mrs. Fisher,

Thank you for coordinating with our office as you seek to annex property into the City of Pea Ridge, ordinance 593. This letter represents confirmation that you have properly coordinated with our office (Arkansas GIS Office) as specified in § 14-40-101 (Act 914 of 2015) of the 90th General Assembly.

Our office will wait completion of any additional steps necessary for the proposed boundary change, which normally comes from the Arkansas Secretary of State Elections Division after any appropriate filing by your County Clerk.

Thank you,

Jennifer Wheeler, GIS Analyst
/jjw

Attachments:
GIS Office Map of Proposed Annexation
Secretary of State Municipal Change Checklist

FILED

MAY 11 2017

Arkansas
Secretary of State

H:\City_Annexations\Cities\Pea_Ridge\20170508\Doc\20170508_PeaRidge_Ord593_Annexation_Coordination_Letter.docx

Proposed Annex: City of Pea Ridge
May 2017

City: Pea Ridge
Mayor: Jackie Crabtree

Arkansas Code 14-40-101.

Before an entity undertakes an annexation, consolidation, or detachment proceeding under this chapter, the entity shall coordinate with the Arkansas Geographic Information Systems Office for preparation of legal descriptions and digital mapping for the relevant annexation, consolidation, and detachment areas.

The map contained herein, is evidence, the entity has met requirements of Act 914 of 2015

- Proposed Annex
- Sections
- Parcels
- Highway
- Minor Road
- Existing City
- Neighboring City
- County Boundary

FILED

MAY 11 2017

Arkansas
Secretary of State

Miles



ARKANSAS
GIS OFFICE

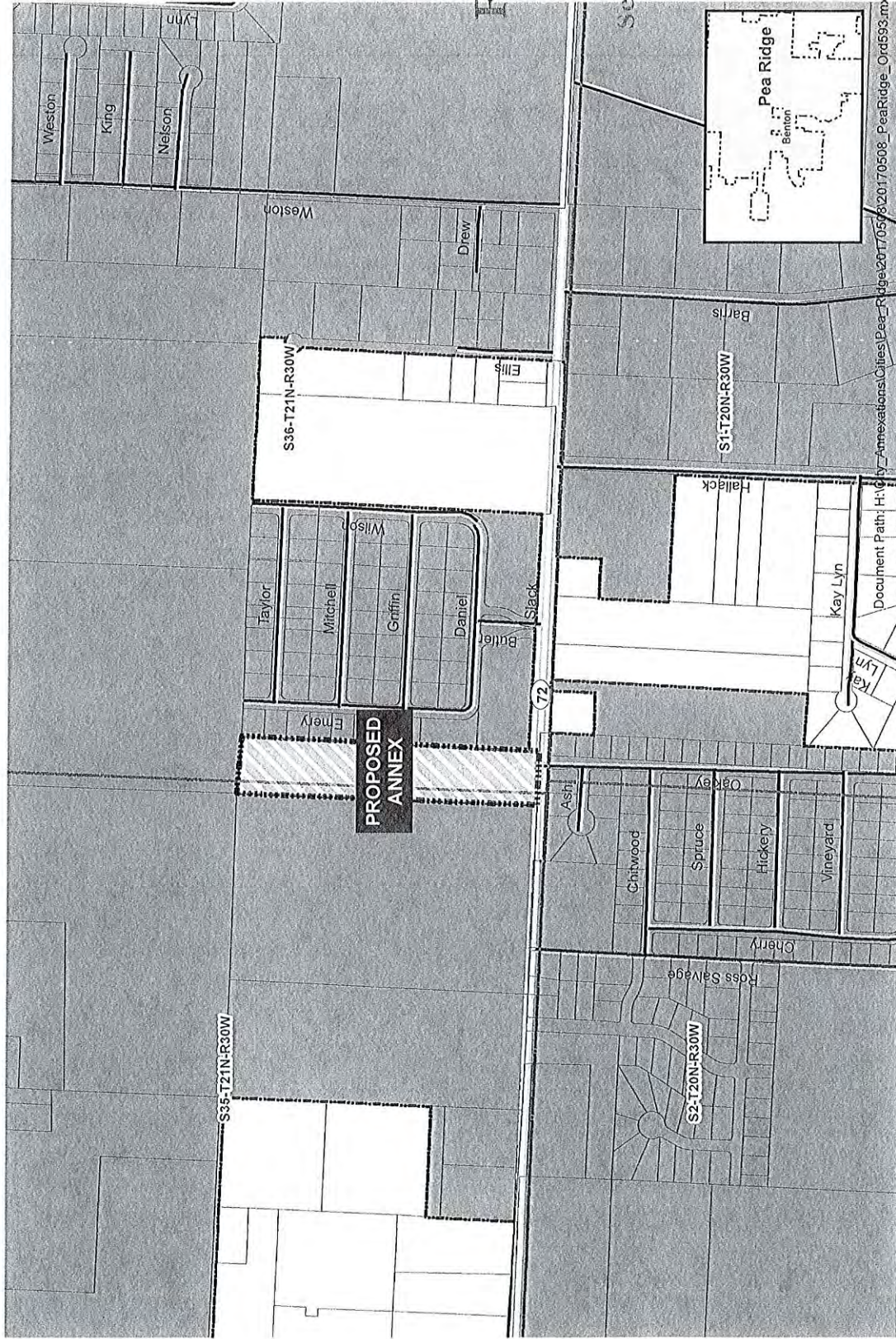

Document Path: H:\City\Annexations\Cities\Pea_Ridge\2017\0518\20170508_PeaRidge_Ord4593.mxd