



ARKANSAS SECRETARY OF STATE

MARK MARTIN

April 03, 2018

The Honorable Tena O'Brien
Benton County Clerk
215 East Central ST, Suite 217
Bentonville, AR 72712-5373

Re: City of Pea Ridge Annexation Ordinance 612

Dear Ms. O'Brien,

This letter acknowledges receipt and filing of the following notice of municipal boundary change by the Office of the Secretary of State:

Filing Type: Annexation pursuant to A.C.A § 14-40-609 (petition by 100% of the landowners)

Effective Date: 03/22/2018

County: Benton

City: Pea Ridge

City Ordinance: 612

Dated: 02/20/2018

County Court Order: CC-2018-01

Date Filed: 01/10/2018 Honorable Barry Moehring, Benton County Judge

A file marked copy of the ordinance, Court Order and exhibits submitted to our Office are enclosed. By copy of this letter (and its enclosures), the Secretary of State hereby notifies the appropriate mapping authorities for Arkansas. Please retain these copies as official record of the filing of the municipal boundary change by the Arkansas Secretary of State.

If you have any questions or concerns regarding this pending filing, please contact our office at 501-682-3401.

Sincerely,

Cynthia Fisher
Arkansas Secretary of State Legal Division
500 Woodlane St, Room 256
Little Rock, AR 72201
501-682-3401

cc: Arkansas Geographic Information Systems Office (w/ encl)
Arkansas Highway and Transportation Department Mapping Department (w/ encl)
Department of Finance and Administration (w/encl)
Arkansas Public Service Commission (w.encl)
UALR Institution for Economic Advancement (w/encl)
Tom-Tom (w/encl)
Hon. Jackie Crabtree, Mayor of Pea Ridge (w/encl)





Arkansas Secretary of State

Mark Martin Arkansas Secretary of State, 500 Woodlane Ave, Little Rock, AR 72201-1094

Municipal Boundary Change Checklist

County: Benton City/Town: Pea Ridge

City Ordinance/Resolution No: 612 Date approved: 02/20/2018

County Court Case No: CC 2018-01 Date Order Filed: 01/10/2018

Type: Annexation by Petition of all Landowners A.C.A §14-40-609

Date Change Effective: 03/22/2018 Set by: Municipal Ordinance Emergency Clause Default
(Required by Act 653 of 2017)

For Circuit Court Challenge: Date Order Filed: _____ Upheld Overturned Other *(attach explanation)*

Initiating party:

All Landowners Majority Landowners Municipal Governing Body State Other _____

Supporting Documentation attached *(check all that apply)*:

- File marked copy of City Ordinance/Resolution *(required)*
- File marked copy of County Court Order or certified annexation election results *(required except for island annexation)*
- Copy of Arkansas GIS Office approved printed map and certification letter *(required)*
- Proof of Publication for all Legal Notices *(include Hearing, Election, and City Ordinance/Resolution notices)*
- File marked copy of Petition Part *(if applicable)*
- File marked copy of Complaint and final Circuit Court Order *(Court Challenge only)*

Municipal Contact:

Name: Jackie Crabtree Title: Mayor

Street Address: PO Box 10

City: Pea Ridge St: AR Zip code: 72751

Complete one form per ordinance/resolution, attach it as a cover page to the supporting document set and submit to the County Clerk's Office within 45 days of the Effective Date as required by Act 655 of 2017

County Official:

Signature: Tiffany Underwood Title: Deputy County Clerk

Date: 3-8-18

Pursuant to Act 655 of 2017, County Officials must submit a file-marked copy of municipal boundary change documentation within 30 days of receipt to: Arkansas Secretary of State, Attn: Municipal Boundary Filing, 500 Woodlane Ave Suite 256, Little Rock, AR 72201-1094

Office of the Arkansas Secretary of State use only

Received by: Cynthia Fisher

FILED

APR 03 2018

Arkansas
Secretary of State

BENTON COUNTY

STATE OF ARKANSAS

TENA O'BRIEN

COUNTY CLERK & VOTER REGISTRAR
215 EAST CENTRAL, SUITE 217
BENTONVILLE, AR 72712-5373

March 7, 2018

PROBATE COURT CLERK
COURTHOUSE, 102 N.E. "A" STREET
BENTONVILLE, AR 72712-5350

Honorable Mark Martin
Secretary of State
Room 256 State Capitol
Little Rock, AR 72201-1094

RE: Robert and Tawnya Pierce
City of Pea Ridge Annexation
Benton County Court Case No. CC# 2018-01

Dear Secretary Martin:

In accordance with the law, I am enclosing a certified copy of each of the following:

1. Map (survey and vicinity map) of the affected area
2. Order Confirming Annexation entered on March 6, 2018
3. Ordinance No. 612 adopted on February 20, 2018, by the City of Pea Ridge

If you have any questions regarding this matter, please do not hesitate to call my office.

Sincerely,

Tena O'Brien

Tena O'Brien

By T. Underwood

TO/tku
Enclosures

cc: Roderick Grieve
Benton County Assessor

NW Arkansas Regional Planning Commission
1311 Clayton Street
Springdale, AR 72765

Benton County 9-1-1 Administration

COUNTY CLERK
(479) 271-1013
FAX (479) 271-1019

VOTER REGISTRAR

BENTONVILLE
(479) 271-1013
FAX (479) 271-1019

SILAM SPRINGS
FAX (479) 524-8534

PROBATE COURT CLERK
(479) 271-5727
FAX (479) 271-1712

ROGERS
(479) 636-3727
FAX (479) 636-4922
ARCHIVIST (479) 636-1037
FAX (479) 636-1053

FILED
2018 MAR -6 PM 12:08

TENA O'BRIEN
CO. & PROBATE CLERK
BENTON COUNTY, ARK

IN THE MATTER OF ANNEXING TO THE
CITY OF PEA RIDGE, ARKANSAS
CERTAIN TERRITORY CONTIGUOUS TO SAID
CITY OF PEA RIDGE, ARKANSAS

CC 2018-01

ORDER CONFIRMING ANNEXATION

Now on this day is presented to the Court the complete file for the annexation of certain land to the City of Pea Ridge, Benton County, Arkansas, under this file number, including specifically a copy of the plat of the annexed property and a copy of the resolution or ordinance of the governing body of the city or town accepting the property for annexation, and having reviewed the file and all things considered, the Court finds that all the requirements of § 14-40-609 of the Arkansas Code have been complied with and further that the annexation is in all respects proper, including if applicable, that the annexing city or town has included in the legal description included with its resolution or ordinance accepting the property for annexation certain dedicated public roads and rights of way abutting or traversing the property to be annexed if required by the Court's previous order entered in this file.

IT IS THEREFORE CONSIDERED AND ORDERED that the annexation of the above described lands to the City of Pea Ridge, Benton County, Arkansas, is hereby confirmed and that the same is and shall hence forth comprise a part of the City of PEA RIDGE, Benton County, Arkansas.

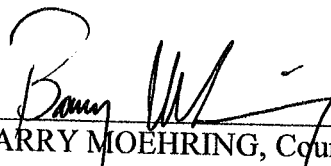

HON. BARRY MOEHRING, County Judge

Date 3/5/18

FILED

APR 03 2018

2018-0942

Arkansas
Secretary of State

2018 MAR #1 AM 9:15

ORDINANCE NO. 612

TENA O'BRIEN
CO. & PROBATE CLERK
BENTON COUNTY, ARK

AN ORDINANCE ACCEPTING THE ANNEXATION OF CERTAIN TERRITORY TO THE CITY OF PEA RIDGE; APPROVING THE SCHEDULE OF SERVICES TO BE EXTENDED TO SAID AREA; AND ASSIGNING SUCH TO WARDS

WHEREAS, a petition was filed, pursuant to A.C.A. 14-40-609, for the annexation of certain territory into the City of Pea Ridge, Arkansas; and

WHEREAS, the Benton County Assessor and the Benton County Clerk have (A) Verified the identity of the petitioner(s); (B) Verified that there are no property owners included in the petition that do not wish to have their property annexed; (C) Verified that the property or properties are contiguous with the city; (D) Verified that no enclaves will be created if the petition is accepted by the city; and presented the petition and their respective verifications to the Benton County Judge; and

WHEREAS, the County Judge has (A) Reviewed the petition and verifications for completeness and accuracy; (B) Determined that no enclaves will be created by the annexation; (C) Confirmed that the petition contains a schedule of services; and (D) Issued an order articulating these findings, and forwarded the petition and order to the contiguous City of Pea Ridge for consideration; and

WHEREAS, it is the desire of the Mayor and City Council of Pea Ridge that said territory be annexed.

NOW, THEREFORE, BE IT ORDAINED BY THE CITY COUNCIL OF THE CITY OF PEA RIDGE, ARKANSAS:

SECTION 1. That the following described territory, contiguous to the City of Pea Ridge, be and the same is hereby accepted as part of, and annexed to and made a part of the City of Pea Ridge, Arkansas to wit:

A PART OF THE NORTHWEST QUARTER OF THE NORTHWEST QUARTER OF SECTION 1, TOWNSHIP 20 NORTH, RANGE 30 WEST, BENTON COUNTY, ARKANSAS, AND ALSO A PART OF LOT 1, AND ALL OF LOT 2 IN BLOCK 6 OF OAK RIDGE WEST ADDITION, BEING MORE PARTICULARLY DESCRIBED AS FOLLOWS, TO-WIT: COMMENCING AT THE NORTHWEST CORNER OF SAID FORTY ACRE TRACT AND RUNNING THENCE S87°36'32"E 313.50', THENCE S02°32'28"W 37.32' TO THE SOUTH RIGHT-OF-WAY OF SLACK STREET (AR. HWY 72), THENCE ALONG SAID RIGHT-OF-WAY S87°36'32"E 220.05', TO AN EXISTING REBAR MARKING THE TRUE POINT OF BEGINNING, THENCE CONTINUING ALONG SAID RIGHT-OF-WAY THENCE S87°35'44"E 164.96' TO AN EXISTING REBAR, THENCE LEAVING SAID RIGHT-OF-WAY S02°39'52"W 1157.70' TO AN EXISTING REBAR, THENCE N87°36'40"W 164.97', THENCE N02°39'15"E 1157.75', TO THE POINT OF BEGINNING, CONTAINING 4.384 ACRES, MORE OR LESS. SUBJECT TO ALL EASEMENTS AND RIGHTS-OF-WAY OF RECORD.

SECTION 2. That the following schedule of services shall be extended to the area by the City of Pea Ridge within the statutorily required three (3) years after the date the

CITY OF PEA RIDGE
COUNTY OF BENTON
STATE OF ARKANSAS
I DO HEREBY CERTIFY THAT THIS IS A TRUE AND COMPLETE COPY OF THE ORIGINAL THAT IS KEPT ON FILE IN MY OFFICE OF THE PEA RIDGE CITY HALL

Tena O'Brien 2-22-18

FILED

APR 03 2018

Arkansas
Secretary of State

2018 0913

FILED

2018 MAR -1 AM 9:15

Annexation becomes final, as follows: Police Protection-Immediately; Fire Protection Immediately; Solid Waste Collection-Immediately/ Public Street Maintenance-Immediately; and Zoning and Code Enforcement-Immediately.

JOHN O'BRIEN
CO. & PROBATE CLERK
BENTON COUNTY, ARK

SECTION 3. That the above described territory shall be annexed to and made a part of Ward 2 Of the City of Pea Ridge, and the same shall henceforth be a part of said ward as fully as existing parts of said ward.

PASSED AND APPROVED THIS 20 DAY OF February, 2018.

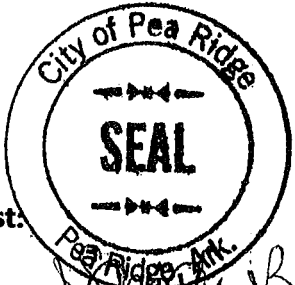

Attest:

Sandy Button

City Clerk

Sandy Button

Jackie Gabtree

MAYOR

Jackie Gabtree

FILED

2018 MAR 31 AM 9:15

TENA O'BRIEN
CO. & PROBATE CLERK
BENTON COUNTY, ARK

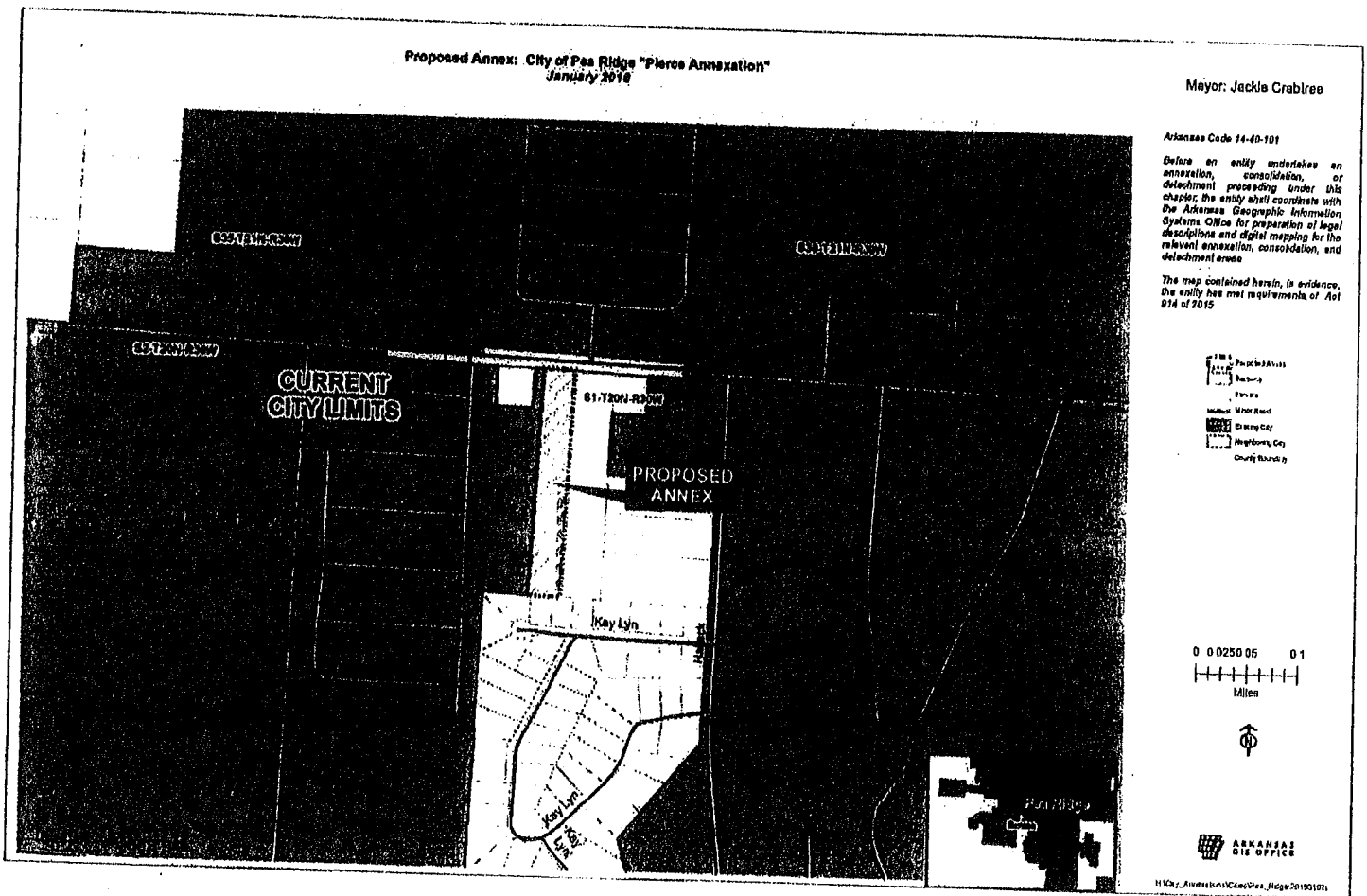

FILED

APR 03 2018

Arkansas
Secretary of State

2018 0915

CITY OF PEA RIDGE
COUNTY OF BENTON
STATE OF ARKANSAS

I DO HEREBY CERTIFY THAT THIS IS A TRUE AND
COMPLETE COPY OF THE ORIGINAL THAT IS KEPT
ON FILE IN MY OFFICE OF THE PEA RIDGE CITY
HALL.

Sandy Button 2-26-18
SIGNATURE

FILED

2018 JAN 10 PM 4:17

IN THE MATTER OF ANNEXING TO THE
CITY OF PEA RIDGE, ARKANSAS
CERTAIN TERRITORY CONTIGUOUS TO SAID
CITY OF PEA RIDGE, ARKANSAS

TENA O'BRIEN
CO. & PROBATE CLERK
BENTON COUNTY, ARK

COUNTY COURT ORDER NO. CC 2018-01

ORDER AUTHORIZING ANNEXATION PURSUANT TO ACA § 14-40-609

I, Barry Moehring, County Judge of Benton County, having reviewed the attached petition for annexation and verification of petition, hereby find that the petition:

- 1) is in writing;
- 2) contains an attestation signed before a notary or notaries by the property owner or owners of the relevant property or properties confirming their desire to be annexed;
- 3) contains an accurate description of the relevant property or properties;
- 4) contains a letter or title opinion from a certified abstractor or title company verifying that the petitioners are all owners of record of the relevant property or properties;
- 5) contains a letter or verification from a certified surveyor or engineer verifying that the relevant property or properties are contiguous with the annexing city or town and that no enclaves will be created if the property or properties are accepted by the city or town – additionally a copy of the letter from the State of Arkansas GIS office approving the legal description for the annexation was provided; and
- 6) includes a schedule of services of the annexing city or town that will be extended to the area within three (3) years after the date the annexation becomes final.

The County Clerk is directed to forward a copy of this order and the related Petition to the Mayor of the City of Pea Ridge.

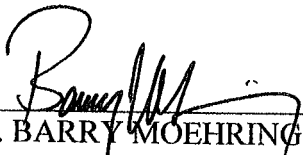

 HON. BARRY MOEHRING, County Judge

1-10-18

 Date



**ARKANSAS
GIS OFFICE**

FILED
2018 JAN -3 PM 12:00

TENA O'BRIEN
CO. & PROBATE CLERK
BENTON COUNTY, ARK

January 2, 2018

Mr. Dave Montgomery
Senior Vice-President
RE/MAX Real Estates Results
3103 SE Moberly Lane,
Bentonville, AR 72712

RE: City of Pea Ridge Annexation Coordination Requirement

Mr. Montgomery,

Thank you for coordinating with our office as you seek to annex property into the City of Pea Ridge, AR described as the "Pierce Annexation". This letter represents confirmation that you have properly coordinated with our office (Arkansas GIS Office) as specified in § 14-40-101 (Act 914 of 2015) of the 90th General Assembly.

Our office will wait completion of any additional steps necessary for the proposed boundary change, which normally comes from the Arkansas Secretary of State Elections Division after any appropriate filing by your County Clerk.

Thank you,

Jennifer Wheeler, GIS Analyst
/jjw

Attachments:
GIS Office Map of Proposed Annexation
Legal description
Secretary of State Municipal Change Checklist

FILED

APR 03 2018

Arkansas
Secretary of State

H:\City_Annexations\Cities\Pea_Ridge\20180102\Doc\20180102_PeaRidge_Annexation_Coordination_Letter.docx

FILED

2018 JAN -3 PM 12: 00

TENA O'BRIEN
CO. & PROBATE CLERK
BENTON COUNTY, ARK

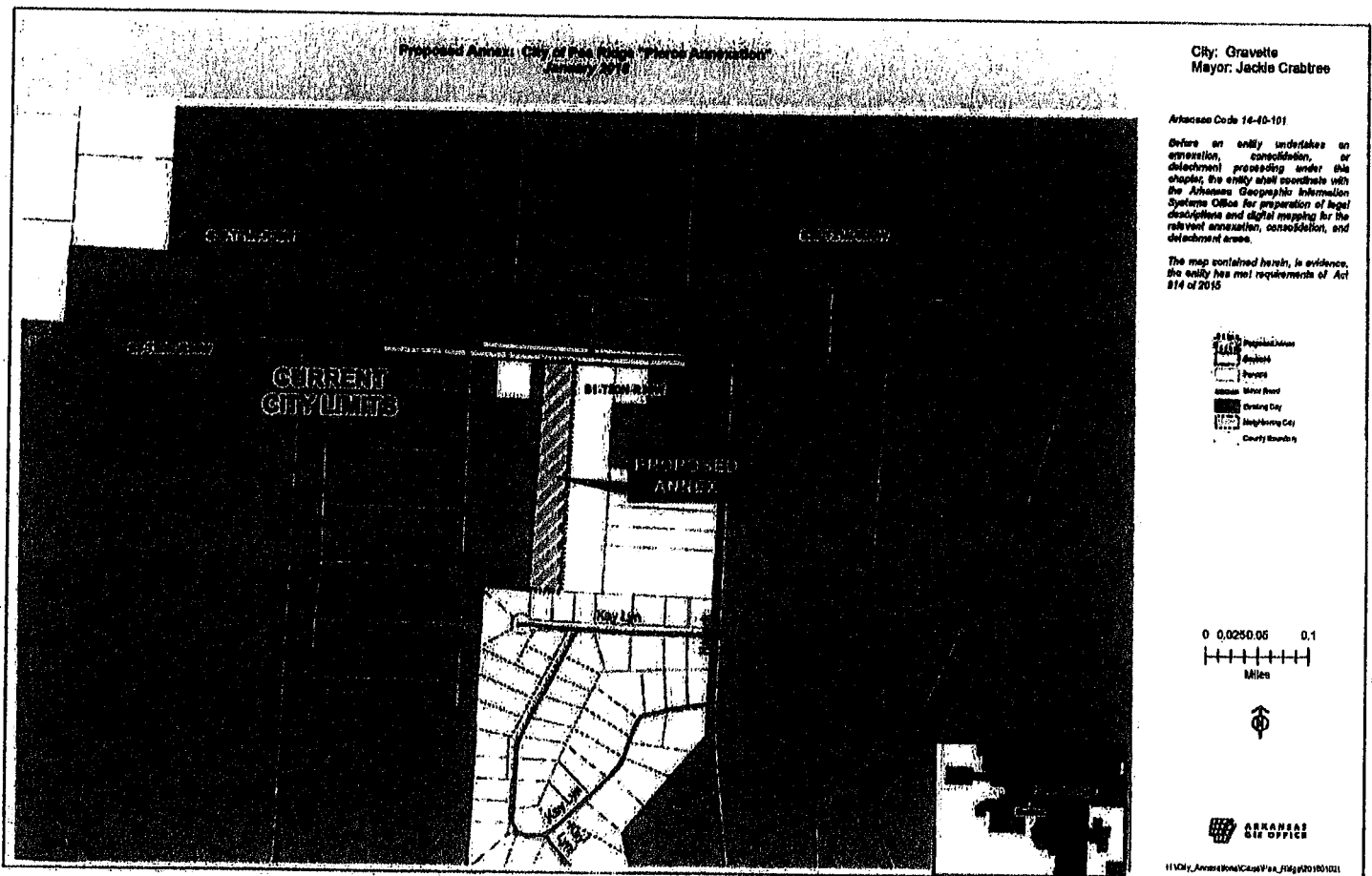

FILED

APR 03 2018

Arkansas
Secretary of State

FILED

2018 JAN 10 AM 9:43

IN THE MATTER OF ANNEXING TO THE
CITY OF PEA RIDGE, ARKANSAS
CERTAIN TERRITORY CONTIGUOUS TO SAID
CITY OF PEA RIDGE, ARKANSAS

TENA O'BRIEN
CO. & PROBATE CLERK
BENTON COUNTY, ARK

CC 2018-01

VERIFICATION OF PETITION FOR ANNEXATION PURSUANT TO ACA § 14-40-609

We, Tena O'Brien, County Clerk of Benton County, and Roderick Grieve, County Assessor of Benton County, attest as follows:

Our offices have received the attached petition seeking annexation. The petition has been reviewed and we hereby verify that the petition:

- (A) is in writing;
- (B) contains an attestation signed before a notary or notaries by the property owner or owners of the relevant property or properties confirming the desire to be annexed;
- (C) contains an accurate description of the relevant property or properties;
- (D) contains a letter or title opinion from a certified abstractor or title company verifying that the petitioners are all owners of record of the relevant property or properties;
- (E) contains a letter or verification from a certified surveyor or engineer verifying that the relevant property or properties are contiguous with the annexing city or town and that no enclaves will be created if the property or properties are accepted by the city or town; and
- (F) include a schedule of services of the annexing city or town that will be extended to the area within three (3) years after the date the annexation becomes final.



HON. TENA O'BRIEN, County Clerk

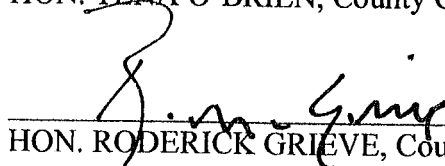

HON. RODERICK GRIEVE, County Assessor

FILED

2018 JAN 10 AM 9:35

TENA D'BRIEN
CO. & PROBATE CLERK
BENTON COUNTY, ARK

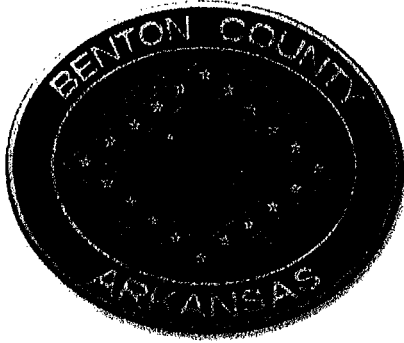

Date: January 5, 2018
Subject: Proposed Annexation Checklist
CC 2018-01 Pea Ridge, AR

- (A) is in writing;
- (B) contains an attestation signed before a notary or notaries by the property owner or owners of the relevant property or properties confirming the desire to be annexed;
- (C) contains an accurate description of the relevant property or properties;
- (D) contains a letter or title opinion from a certified abstractor or title company verifying that the petitioners are all owners of record of the relevant property or properties;
- (E) contains a letter or verification from a certified surveyor or engineer verifying that the relevant property or properties are contiguous with the annexing city or town and that no enclaves will be created if the property or properties are accepted by the city or town; and
- (F) include a schedule of services of the annexing city or town that will be extended to the area within three (3) years after the date the annexation becomes final.

NA [Additionally, we note that the legal description in (C) does not include in its description certain dedicated public roads and rights of way abutting or traversing the property to be annexed, the legal descriptions for which are included on the attached Exhibit "A"]

Please contact me if you have any questions.

A handwritten signature in black ink, appearing to read "Michael D. Million".

Michael D. Million
Manager – Mapping Dept.
Benton County Assessor's Office
Phone: 479-271-1037, ext. 7004
Email: michael.million@bentoncountyar.gov

EXHIBIT "A"

FILED

2018 JAN -3 PM 12: 00

CC 2018-01

TENA O'BRIEN
CO. & PROBATE CLERK
BENTON COUNTY, ARK

PETITION FOR ANNEXATION BY 100% OF THE OWNERS OF PROPERTY

To: The Mayor and (City) (Town) Council of the (City) (Town) of PEA RIDGE

The undersigned, being 100% of the owners of the property described herein, hereby petition(s) for the annexation of the following property to the (City) (Town) of PEA RIDGE:

(provide an accurate description of the property proposed to be annexed)

SEE EXHIBIT "B"

The following services will be extended to the described area by the (City) (Town) of PEA RIDGE within three (3) years after the date the annexation becomes final.:

(provide an accurate description of the services to be extended.)

POLICE, FIRE, EMS SERVICE, WATER, AND SEWER

I certify the statements herein are true and accurate to the best of my knowledge, information, and belief.

ROBERT PIERCE
Printed Name of Property Owner #1

TAWAYA PIERCE
Printed Name of Property Owner #2

[Signature]
Signature of Property Owner #1

[Signature]
Signature of Property Owner #2

ACKNOWLEDGMENT

State of Arkansas)
) ss.
County of Benton)

On this the 7 day of December, 2017, before me, the undersigned officer, personally appeared Robert Pierce, Tawaya Pierce, known to me to be the persons whose name is subscribed to the within instrument and acknowledged that it was executed for the purposes therein contained.

Amanda Keene Lang
NOTARY PUBLIC

My Commission Expires:

4-17-2021

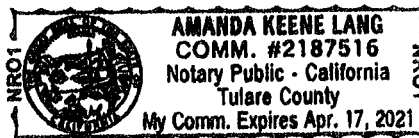

A signature line and acknowledgement is required for each property owner.

FILED

APR 03 2018

Arkansas
Secretary of State

FILED

2018 JAN -3 PM 12:00

TENA O'BRIEN
CO. & PROBATE CLERK
BENTON COUNTY, ARK

PIERCE ANNEXATION
EXHIBIT "B"

Part of the NW $\frac{1}{4}$ of the NW $\frac{1}{4}$ of Section 1, Township 20N, Range 30W in Benton County, Arkansas, and being more particularly described as follows:

Commencing at the NW Corner of the said NW $\frac{1}{4}$ of the NW $\frac{1}{4}$ of Section 1, Township 20N, Range 30W thence S 89° 51' E, 533.50'; Thence S 0° 18' W, 37.32' to the Point of Beginning.

Thence S 89° 49' 07" E, 165';

Thence S 0° 18' 00" W, 1157.67';

Thence West 165';

Thence N 0° 18' 00" E, 1158.18' to the point of beginning;

FILED

2018 JAN -3 PM 12:00

EXHIBIT "C"

TENA O'BRIEN
CO. & PROBATE CLERK
BENTON COUNTY, ARK

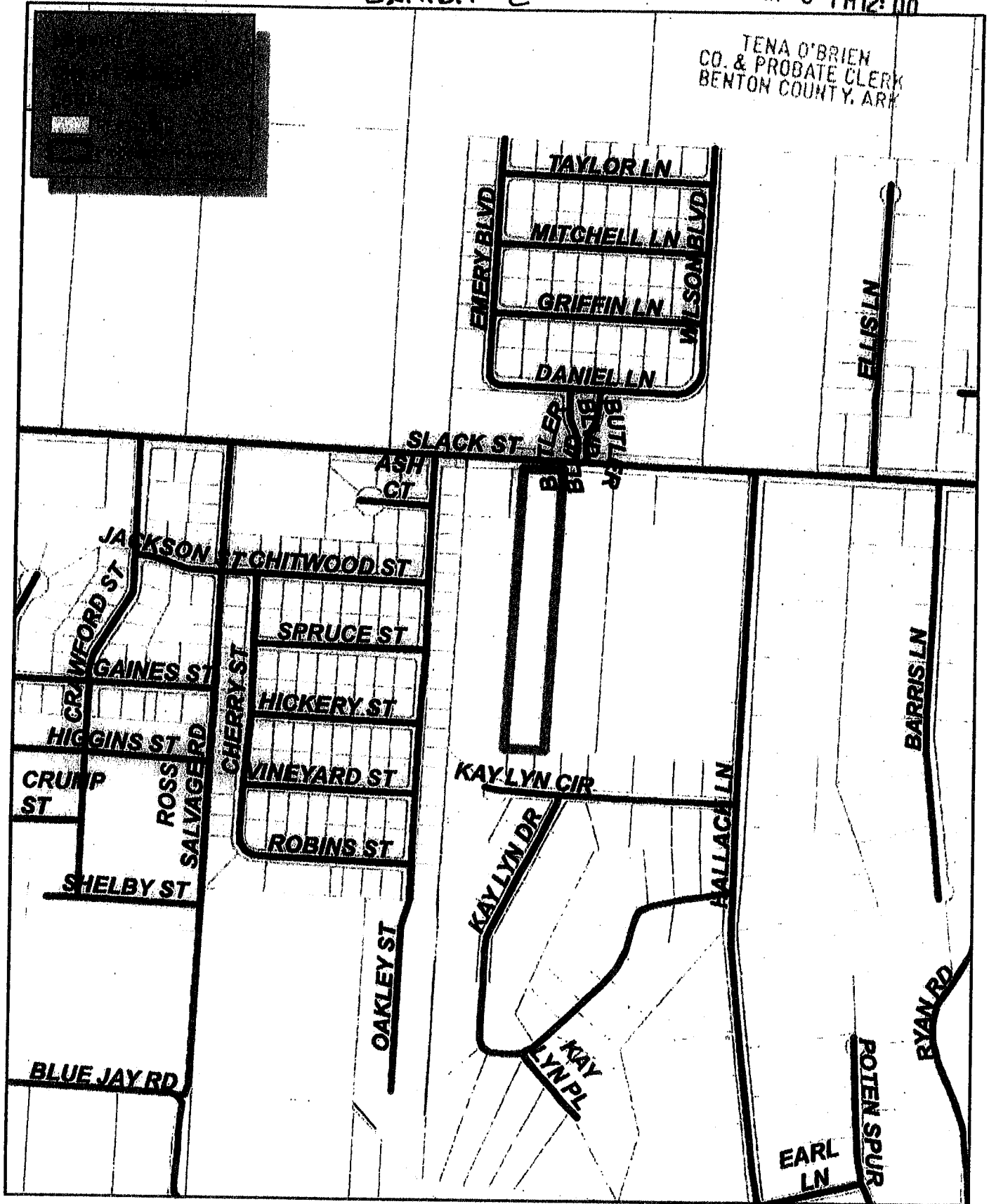

1 inch = 500 feet

Pierce Annexation



FILED

2018 JAN -3 PM 12:00

TENA O'BRIEN
CO. & PROBATE CLERK
BENTON COUNTY, ARK

EXHIBIT "D"



1450 E. Zion Road - Suite 7
Fayetteville, AR 72703

OWNERSHIP REPORT

File No. 17-5749

For the use and benefit of: **Robert Pierce and Tawnya Pierce**

The undersigned, having made a diligent search of the records of Benton County, Arkansas, through December 14, 2017 at 7:00 a.m., the last deed of record for the below-described land is a Warranty Deed executed by Joseph L. Rapier and Elizabeth Rapier, husband and wife to Robert Pierce and Tawnya Pierce, husband and wife on February 7, 2005 and recorded February 11, 2005 as Book/Page 2005-6850 of the real estate records of Benton County, Arkansas.

The land conveyed by the above-referenced deed is more particularly described as follows:

Part of the NW ¼ of the NW ¼ of Section 1, Township 20 North, Range 30 West in Benton County, Arkansas, and being part of Lots 2, 3 and 4 of Block 6, Oak Ridge West Addition and being more particularly described as follows: Commencing at the NW corner of the said NW ¼ of the NW ¼ thence South 89°51' East 533.50 feet; thence South 00°18' West 37.32 feet to the point of beginning; thence South 89°49'07" East 165.00 feet; South 00°18'00" West 1157.67 feet; thence West 165.00; thence North 00°18'00" East 1158.16 feet to the point of beginning.

This information reflects the most recent grantees of record for the above-described property during the period covered by the search. This information does not reflect any claims to title that are not a part of the property records for the county in which the property is located nor does it reflect possessory claims such as leases, easements and encroachments filed out the search dates. It does not disclose overlapping legal descriptions. By provided the information, City Title & Closing, LLC is not committing to issue a title insurance policy or any other insurance product. This is not a title opinion, and not title insurance agent or person other than a licensed Arkansas attorney may provide legal advice concerning the state of title to the land described herein.

City Title & Closing LLC
1450 E. Zion Road, Suite 7
Fayetteville, AR 72703
479-935-4177

By:
Jessica L. Wooten, Authorized Signatory
Agency License No. 382820
NPN Agent No. 9905477

****DISCLAIMER****

This report is being issued without any representation as to the status or validity of the title, and the Company assumes no liability by virtue of errors or omissions. Any liability of the Company shall not exceed the amount paid for the report.

(EXHIBIT "E")

FILED

2018 JAN -3 PM12:00

TENA O'BRIEN
CO. & PROBATE CLERK
BENTON COUNTY, AR



Bates & Associates, Inc.

Civil Engineering - Land Surveying - Landscape Architecture

7230 S. Pleasant Ridge Dr. Fayetteville, AR 72704

PH: 479-442-9350 * FAX: 479-521-9350

www.batesnwa.com

January 1, 2018

Property: 4,384 Acres P.N. 15-07028-000. A part of STR1-20-30
Location: 1211 Slack Street, Pea Ridge, AR
Owner: Robert and Tawnya Pierce

To Whom It May Concern:

The above described property is contiguous with the annexing City of Pea Ridge, Arkansas and no enclaves will be created if the property is accepted by the city. Services will be provided by the city of Pea Ridge, after the date the annexation becomes final by the city of Pea Ridge.

Respectfully,

Derrick Thomas, PLS



FILED

2018 JAN -3 PM 12:00

TENA O'BRIEN
CO. & PROBATE CLERK
BENTON COUNTY, ARK

January 3rd, 2018

Hon. Tena O'Brien, County Clerk
Benton County Administration Building
215 East Central
Bentonville, AR 72712

Re: Pierce Annexation

Dear Mrs. O'Brien:

This letter accompanies the voluntary annexation petition being filed today by me on behalf of the City of Pea Ridge. In addition to the petition, accompanying this letter, please find:

- 1) A copy of the Arkansas GIS Office approval of the legal description as provided for in § 14-40-101 of the Arkansas Code.
- 2) A original 100% owner signed/notarized voluntary annexation petition listed as "Exhibit A"
- 3) A legal description of the property intended to be annexed listed as "Exhibit B".
- 4) A vicinity map indicating the property to be annexed listed as "Exhibit C".
- 5) A title verification letter listed as "Exhibit D".
- 6) A letter from a certified professional surveyor indicating that the property is contiguous with the current city limits of Pea Ridge listed as "Exhibit E".

I am aware the County Judge has authority to require adjoining County road right-of-way be added to this annexation. My review indicates there is no adjoining County road right-of-way with respect to this proposed annexation.

Sincerely,



Dave Montgomery

FILED

2018 JAN -3 PM 12:00

TENA O'BRIEN
CO. & PROBATE CLERK
BENTON COUNTY, ARK

PIERCE ANNEXATION

Part of the NW ¼ of the NW ¼ of Section 1, Township 20N, Range 30W in Benton County, Arkansas, and being more particularly described as follows:

Commencing at the NW Corner of the said NW ¼ of the NW ¼ of Section 1, Township 20N, Range 30W thence S 89° 51' E, 533.50'; Thence S 0° 18' W, 37.32' to the Point of Beginning.

Thence S 89° 49' 07" E, 165';

Thence S 0° 18' 00" W, 1157.67';

Thence West 165';

Thence N 0° 18' 00" E, 1158.18' to the point of beginning;