

in state  
not in census

# State of Arkansas Secretary of State



**Charlie Daniels**  
Secretary of State

Business & Commercial Services	682-3409
Elections	682-5070
Building & Grounds	682-3407
Communications & Education	683-0057
State Capitol Police	682-5173
Business Office	682-8032
Information Technology	682-3411

June 23, 2006

The Honorable Linda Heritage  
Greene County Clerk  
320 West Court Street  
Paragould, AR 72450

Dear Ms. Heritage:

The Following Information has been recorded and filed in the Office of the Secretary of State:

Date: 06/23/2006      County: Greene      City: Paragould

Annexation:                      Ordinance No. - 06-20  
    Co. Order No - 2006-13  
    Plat                      - X  
    Election                      -  
    Island                      -

Incorporation:                  Ordinance No.              -  
    Co. Order No.              -  
    Plat                              -  
    Election                        -

Census Information: The following City or Town has been upgraded or reduced to:

1st Class City                      -  
 2nd Class City                      -  
 Incorporated Town                  -

I have forwarded this information to the Arkansas Municipal League and the Arkansas Highway and Transportation Department. If you have any further questions please do not hesitate to contact me at 1-800-482-1127 or 682-3526

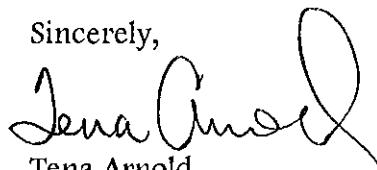
Sincerely,  
  
 Tena Arnold  
 Election Services Representative  
 Arkansas Secretary of State

STAFFORD.DECREE  
RFP/amm  
2/28/2006  
F#8597-5

CITY CLERK OF PARAGOULD  
FILED

2006 APR 20 P 3:50 IN THE COUNTY COURT OF  
GREENE COUNTY, ARKANSAS

FILED

2006 APR 19 P 3:50

LINDA HERITAGE

IN THE MATTER OF THE ANNEXATION TO THE  
CITY OF PARAGOULD, ARKANSAS, CERTAIN  
TERRITORY CONTIGUOUS TO THE CITY OF  
PARAGOULD, ARKANSAS

NO. CO-2006-13 BY \_\_\_\_\_ DC

DECREE OF ANNEXATION

On this regular day of a regular term of the County Court of Greene County, Arkansas, there is presented to the Court by Randy F. Philhours, of Branch, Thompson, Philhours & Warmath, agents for the petitioners, a petition for annexation of certain territory, hereinafter more particularly described to the City of Paragould, Arkansas, and the Court being fully advised of the facts and the law, do hereby find, judge and decree as follows:

The Court finds that the petition was filed more than thirty (30) days prior to this date and that in said petition Randy F. Philhours was selected by the petitioners to act on their behalf in filing and presenting the petition.

The Court also finds that the laws of the State of Arkansas have been complied with in presenting the Petition.

The Court further finds that the territory sought to be annexed was accurately described and that said territory is contiguous to the boundaries of the City of Paragould, Arkansas.

The Court further finds that attached to and make a part of said petition is an accurate map of the territory sought to be annexed to the City of Paragould, Arkansas.

The Court further finds that the prayer of the petition is right and proper.

THEREFORE, the Court does hereby ORDER, JUDGE and DECREE that the following described territory be and the same is hereby annexed to and made a part of the City of Paragould, Arkansas, to-wit:

FILED

APR 26 2006

BY CHARLIE DANIELS  
SECRETARY OF STATE

**TRACT I:**

Part of the Northwest Quarter of Section 23, Township 16 North, Range 5 East, being more particularly described as follows: Commence at the Northwest corner of said Section 23, thence North 89 degrees 25 minutes East 1810.95 feet to the point of beginning; thence continue North 89 degrees 25 minutes East 172.96 feet; thence South 0 degrees 3 minutes 1 second West 1321.93 feet; thence North 89 degrees 33 minutes 28 seconds East 659.69 feet; thence South 0 degrees 9 minutes 9 seconds West 1323.58 feet; thence South 89 degrees 41 minutes 59 seconds West 997.58 feet; thence North 0 degrees 3 minutes 18 seconds West 1657.0 feet; thence North 89 degrees 25 minutes East 171.77 feet; thence North 0 degrees 0 minutes 51 seconds East 985.34 feet to the point of beginning, containing 36.9 acres and subject to road right-of-way on the North side.

**TRACT II:**

Part of the Northwest Quarter of Section 23, Township 16 North, Range 5 East, being more particularly described as follows: Commence at the Northwest corner of said Section 23, thence North 89 degrees 25 minutes East 1666.53 feet to the point of beginning; thence continue North 89 degrees 25 minutes East 144.42 feet, thence South 0 degrees 0 minutes 51 seconds West 985.34 feet; thence South 89 degrees 25 minutes West 171.77 feet; thence North 0 degrees 3 minutes 18 seconds West 915.16 feet; thence North 89 degrees 25 minutes East 31.92 feet; thence North 2 degrees 50 minutes West 70.0 feet to the point of beginning, containing 3.85 acres and subject to road right of way on the North side.

**TRACT III.**

That part of the East Half of the Northeast Quarter of the Northwest Quarter of Section 23, Township 16 North, Range 5 East, described as follows: Beginning at the Northeast corner of said tract, run thence South 432 feet, run thence West 154 feet, run thence North 432 feet, run thence East 154 feet to the point of beginning, containing 1.53 acres, more or less, and subject to the use by the public of a County Road along the North end thereof.

The Court further orders that the original papers in this cause be delivered to the Clerk of Greene County, Arkansas, same to be properly recorded upon the records of Greene County, Arkansas and the Clerk, after properly recording and filing the original papers, prepare transcripts of same; that one of the certified transcripts be delivered to the City of Paragould, Arkansas, one copy to the Secretary of State and one copy to the Director of the Tax Division of the Arkansas Public Service Commission.

STAFFORD.DECREE  
RFP/amm  
2/28/2006  
F#8597-5

  
COUNTY JUDGE

Date entered: 4-12-06

PREPARED BY:

BRANCH, THOMPSON, PHILHOURS & WARMATH  
A Professional Association  
414 West Court Street  
Paragould, Arkansas 72450  
Telephone (870)239-9581

STATE OF ARKANSAS, } SS      **CERTIFICATE**  
County of Greene

I, LINDA HERITAGE, County and Probate Clerk in and for the State and County aforesaid, hereby certify that the, attached instrument is a true, correct and compared copy of the original Decree of Annexation was filed in this office on the 19th day of April, 2006 and same is found of record on page 311 of Record No. 31 of \_\_\_\_\_ County Court \_\_\_\_\_ Records of Greene County, Arkansas

IN TESTIMONY WHEREOF, I hereunto set my hand and affix the Seal of Court on this the 19th day of April, 2006

Seal      Linda Heritage      Clerk

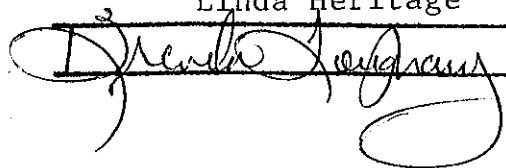
 D.C.

**FILED**

APR 06 2006

CHARLIE DANIELS  
SECRETARY OF STATE

BY \_\_\_\_\_

ORDINANCE  
RFP/amm  
5/5/2006  
F#130-2006

ORDINANCE NO. 06-20

**AN ORDINANCE ACCEPTING THE ANNEXATION OF CERTAIN TERRITORY TO THE CITY OF PARAGOULD, ARKANSAS, AND MAKING THE SAME A PART OF THE CITY OF PARAGOULD, ARKANSAS, ASSIGNING SAME TO A WARD, AMENDING ORDINANCE NO. 92-9, AS AMENDED, AND FOR OTHER PURPOSES.**

WHEREAS, a Petition was filed with the County Clerk of Greene County, Arkansas, by the real estate owners of the hereinafter described territory praying that said territory be annexed to and made a part of the City of Paragould, Arkansas; and

WHEREAS, on April 3, 2006 the County Court of Greene County, Arkansas, found the Petition represented a majority of the real estate owners in said territory; that said territory was contiguous and adjoining the present corporate limits of the City of Paragould, Arkansas; that an accurate Plat or map of said territory has been filed with and made a part of said Petition; that proper notice has been given for the time and in the manner prescribed by law, and that said lands and territory should be annexed to and made a part of the City of Paragould, Arkansas, subject to the acceptance of the same by the City Council of said city at the proper time as provided by law; and

WHEREAS, the time fixed by law for appealing the said Order of Annexation made by the Court has expired and no appeal has been taken from said Order.

**NOW, THEREFORE, BE IT ORDAINED BY THE CITY COUNCIL OF THE CITY OF PARAGOULD, ARKANSAS, AS FOLLOWS:**

**SECTION 1.:** That the following described lands and territory contiguous and adjoining the City of Paragould, Arkansas be and the same are hereby accepted as part of and annexed to and made a part of the City of Paragould, Arkansas:

**FILED**

MAY 05 2006

CHARLIE DANIELS  
SECRETARY OF STATE

BY \_\_\_\_\_

ORDINANCE  
RFP/amm  
5/5/2006  
F#130-2006

**FILED**

MAY 06 2006

CHARLIE DANIELS  
SECRETARY OF STATE

BY \_\_\_\_\_

**TRACT I.**

Part of the Northwest Quarter of Section 23, Township 16 North, Range 5 East, being more particularly described as follows: Commence at the Northwest corner of said Section 23, thence North 89 degrees 25 minutes East 1810.95 feet to the point of beginning; thence continue North 89 degrees 25 minutes East 172.96 feet; thence South 0 degrees 3 minutes 1 second West 1321.93 feet; thence North 89 degrees 33 minutes 28 seconds East 659.69 feet; thence South 0 degrees 9 minutes 9 seconds West 1323.58 feet; thence South 89 degrees 41 minutes 59 seconds West 997.58; thence North 0 degrees 3 minutes 18 seconds West 1657.0 feet; thence North 89 degrees 25 minutes East 171.77 feet; thence North 0 degrees 0 minutes 51 seconds East 985.34 feet to the point of beginning, containing 36.9 acres and subject to road right-of-way on the North side.

**TRACT II.**

Part of the Northwest Quarter of Section 23, Township 16 North, Range 5 East, being more particularly described as follows: Commence at the Northwest corner of said Section 23, thence North 89 degrees 25 minutes East 1666.53 feet to the point of beginning; thence continue North 89 degrees 25 minutes East 144.42 feet; thence South 0 degrees 0 minutes 51 seconds West 985.34 feet; thence South 89 degrees 25 minutes West 171.77 feet; thence North 0 degrees 3 minutes 18 seconds West 915.16 feet; thence North 89 degrees 25 minutes East 31.92 feet; thence North 2 degrees 50 minutes West 70.0 feet to the point of beginning, containing 3.85 acres and subject to road right-of-way on the North side.

**TRACT III.**

That part of the East Half of the Northeast Quarter of the Northwest Quarter of Section 23, Township 16 North, Range 5 East, described as follows: Beginning at the Northeast corner of said tract, run thence South 432 feet, run thence West 154 feet, run thence North 432 feet, run thence East 154 feet to the point of beginning, containing 1.53 acres, more or less, and subject to the use by the public of a County Road along the North end thereof.

**SECTION 2.:** That the above described territory shall be annexed to and made a part of Ward 1 of the City of Paragould, Arkansas, and the same shall henceforth be a

ORDINANCE  
RFP/amm  
5/5/2006  
F#130-2006

part of said Ward as fully existing parts of said Ward and be zoned R1 residential use classification.

PASSED AND APPROVED this 8th day of May, 2006.

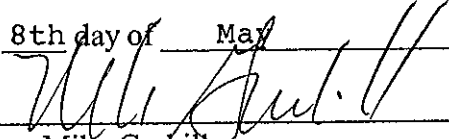
  
\_\_\_\_\_  
Mayor Mike Gaskill

ATTEST:

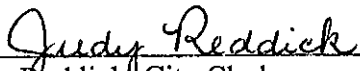
  
\_\_\_\_\_  
Judy Reddick, City Clerk

**CERTIFICATE**

STATE OF ARKANSAS  
COUNTY OF GREENE

I, Judy Reddick, City Clerk of the City of Paragould, Arkansas, do hereby certify that the attached instrument is a true, correct, and compared copy of the Original Ordinance No. 06-20, was filed in this Office on the 9th day of May, 2006, and same is found on record on page 285 of Ordinances 2004-, of the City of Paragould, Arkansas.

IN TESTIMONY WHEREOF, I hereunto set my hand and affix the Seal of City of Paragould, Arkansas, on this the 9th day of May, 2006.

  
\_\_\_\_\_  
City Clerk

crop hail-multi-peril  
farmowners-farm-liability

**COOK**

insurance agency, inc.

126 Linwood Dr. • Paragould, Ar. 72450

870-236-2057

**FILED**

JUN 23 2006

Jeff Boone

John Cook

CHARLIE DANIELS  
SECRETARY OF STATE

George E Cook  
Luke Cook

**TOWNSHIP 16N • RANGE 5E**

SEE PAGE 23

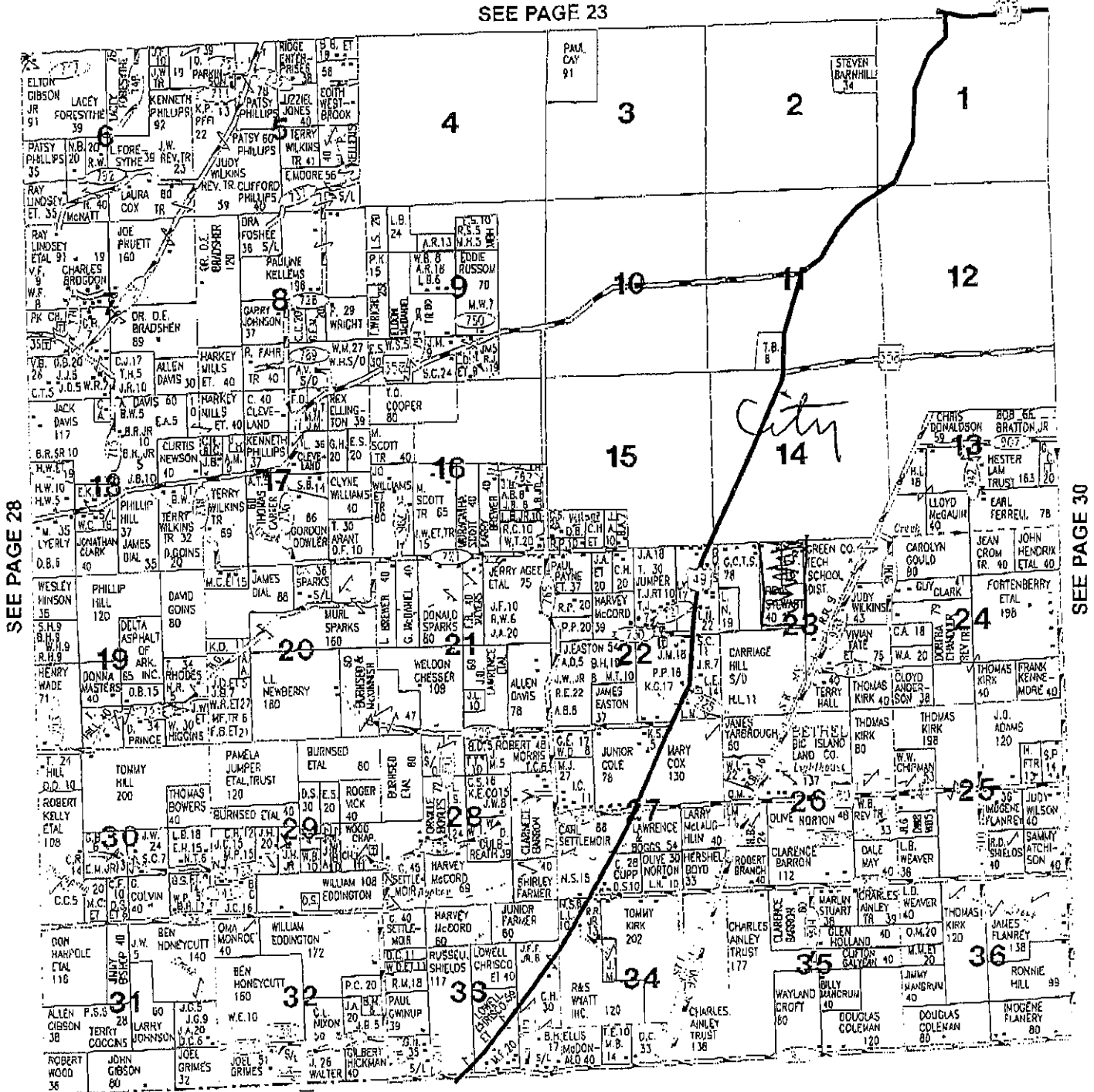

CRAIGHEAD COUNTY