



ARKANSAS SECRETARY OF STATE

MARK MARTIN

August 25, 2017

The Honorable Tena O'Brien
Benton County Clerk
215 E Central Ave, Suite 217
Bentonville, AR 72712-5304

Re: City of Siloam Springs Annexation of City-Owned Park

Dear Ms. O'Brien,

This letter acknowledges receipt and filing of the following notice of municipal boundary change by the Office of the Secretary of State:

Filing Type: Statutory Annexation Act 192 of 2017, see A.C.A § 14-40-204 (city-owned park)
Effective Date: 08/01/2017
County: Benton City: Siloam Springs
City Ordinance: N/A
Court Order No: N/A

A file marked copy of Act 192 of the Arkansas General Assembly of 2017 and exhibits submitted to our Office are enclosed. By copy of this letter (and its enclosures), the Secretary of State hereby notifies the appropriate mapping authorities for Arkansas. Please retain these copies as official record of the filing of the municipal boundary change by the Arkansas Secretary of State.

If you have any questions or concerns regarding this pending filing, please contact our office at 501-682-3401.

Sincerely,

A handwritten signature in cursive script that reads "Cynthia Fisher".

Cynthia Fisher
Arkansas Secretary of State Legal Division
500 Woodlane St, Room 256
Little Rock, AR 72201
501-682-3401

cc: Arkansas Geographic Information Systems Office (w/ encl)
Arkansas Highway and Transportation Department Mapping Department (w/ encl)
Department of Finance and Administration (w/encl)
Arkansas Public Service Commission (w.encl)
UALR Institution for Economic Advancement (w/encl)
Tom-Tom (w/encl)
Ms. Renea Ellis, Siloam Springs City Clerk





Arkansas Secretary of State

Mark Martin Arkansas Secretary of State, 500 Woodlane Ave, Little Rock, AR 72201-1094

Municipal Boundary Change Checklist

County: Benton City/Town: Siloam Springs

City Ordinance/Resolution No: N/A Date approved: _____

County Court Case No: N/A Date Order Filed: _____

Type: Annexation of City Park or Airport (automatic) A.C.A §14-40-204

Date Change Effective: 08/01/2017 Set by: Municipal Ordinance Emergency Clause Default
(Required by Act 653 of 2017)

For Circuit Court Challenge: Date Order Filed: _____ Upheld Overturned Other *(attach explanation)*

Initiating party:

All Landowners Majority Landowners Municipal Governing Body State Other _____

Supporting Documentation attached *(check all that apply):*

- File marked copy of City Ordinance/Resolution *(required)*
- File marked copy of County Court Order or certified annexation election results *(required except for island annexation)*
- Copy of Arkansas GIS Office approved printed map and certification letter *(required)*
- Proof of Publication for all Legal Notices *(include Hearing, Election, and City Ordinance/Resolution notices)*
- File marked copy of Petition Part *(if applicable)*
- File marked copy of Complaint and final Circuit Court Order *(Court Challenge only)*

Municipal Contact:

Name: Phillip R. Patterson Title: City Administrator

Street Address: 400 N. Broadway

City: Siloam Springs St: AR Zip code: 72761

Complete one form per ordinance/resolution, attach it as a cover page to the supporting document set and submit to the County Clerk's Office within 45 days of the Effective Date as required by Act 655 of 2017

County Official:

Signature: Hon. Tena O'Brien Title: Benton County Clerk

Date: _____

Pursuant to Act 655 of 2017, County Officials must submit a file-marked copy of municipal boundary change documentation within 30 days of receipt to: Arkansas Secretary of State, Attn: Municipal Boundary Filing, 500 Woodlane Ave Suite 256, Little Rock, AR 72201-1094

Office of the Arkansas Secretary of State use only

FILED

AUG 25 2017

Received by: _____

Arkansas
Secretary of State

Stricken language would be deleted from and underlined language would be added to present law.
Act 192 of the Regular Session

1 State of Arkansas
2 91st General Assembly
3 Regular Session, 2017

A Bill

HOUSE BILL 1199

4
5 By: Representative Lundstrum
6 By: Senator J. Hendren

For An Act To Be Entitled

7
8
9 AN ACT TO AMEND THE LAW CONCERNING ANNEXATION OF
10 CITY-OWNED PARKS AND AIRPORTS; AND FOR OTHER
11 PURPOSES.

Subtitle

12
13
14 TO AMEND THE LAW CONCERNING ANNEXATION OF
15 CITY-OWNED PARKS AND AIRPORTS.
16

17
18
19 BE IT ENACTED BY THE GENERAL ASSEMBLY OF THE STATE OF ARKANSAS:

20
21 SECTION 1. Arkansas Code § 14-40-204, concerning the annexation of
22 city-owned parks and airports, is amended to add an additional subsection to
23 read as follows:

24 (c) All city-owned parks with a minimum of thirty (30) acres and owned
25 by cities in this state having a population of not less than fifteen thousand
26 (15,000) and not more than eighteen thousand (18,000) and located in counties
27 having a population of not less than two hundred twenty thousand (220,000)
28 and not more than two hundred sixty thousand (260,000), according to the most
29 recent federal decennial census, are annexed to the cities owning the parks.
30

31
32 APPROVED: 02/17/2017

33
34
35
36
FILED
AUG 25 2017
Arkansas
Secretary of State



FILED

2017 JUL 17 PM 1:49



ARKANSAS
GIS OFFICE

TENA O'BRIEN
CO. & PROPRATE CLERK
BENTON COUNTY, ARK

March 2, 2017

Honorable Mark Turner
City of Siloam Springs
PO BOX 80
Siloam Springs AR 72761

RE: City of Siloam Springs Annexation Coordination Requirement

Honorable Mayor Turner,

Thank you for coordinating with our office as you seek to annex property into the City of Siloam Springs, by Legislative Act 192 of 2017. This letter and the maps attached represents confirmation that you have properly coordinated with our office (Arkansas GIS Office) as specified in § 14-40-101 (Act 914 of 2015) of the 90th General Assembly.

Our office will wait until the effective date of Act 192 of 2017 before publishing the boundary change. Although not required by Act 192, it may be advisable for the Siloam Springs City Clerk to file this letter, Map 1, and Map 2, along with a copy of the Act with the Benton County Clerk and the Arkansas Secretary of State Elections Division.

Thank you,

Shelby D Johnson, State Geographic Information Officer
/sdj

FILED

AUG 25 2017

Arkansas
Secretary of State

Attachments:

GIS Office Map of Annexations by Act 192 of 2017 MAP 1 and MAP 2
Secretary of State Municipal Change Checklist

H:\City_Annexations\Templates\Folder Structure\Doc\20170301_SiloamSprings_Annexation_Coordination_Letter.docx

ARKANSAS GIS OFFICE · 1 CAPITOL MALL SUITE 6D · LITTLE ROCK · ARKANSAS · 72201

PHONE (501) 682-2767 · www.gis.arkansas.gov · FAX (501) 682-6077

FILED

2017 JUL 17 PM 1:49

TERESA BROWN
CLERK & PROCLAMATION CLERK
BENTON COUNTY, ARK

MAP 1

Legislative Annexation: City Lake Park, Recorded in Book 223 Page 466 Benton County Circuit Clerk
Annexed to City of Siloam Springs by Act 192 of 2017

FILED

AUG 25 2017

Arkansas
Secretary of State

City: Siloam Springs
Mayor: Mark Turner

Arkansas Code 14-40-101.

Before an entity undertakes an annexation, consolidation, or detachment proceeding under this chapter, the entity shall coordinate with the Arkansas Geographic Information Systems Office for preparation of legal descriptions and digital mapping for the relevant annexation, consolidation, and detachment areas.

The map contained herein, is evidence, the entity has met requirements of Act 914 of 2015.

SECTION 1, Arkansas Code § 14-40-204, concerning the annexation of city-owned parks and airports, is amended to add an additional subsection to read as follows:

(c) All city-owned parks with a minimum of thirty (30) acres and owned by cities in this state having a population of not less than fifteen thousand (15,000) and not more than eighteen thousand (18,000) and located in counties having a population of not less than two hundred twenty thousand (220,000) and not more than two hundred sixty thousand (260,000), according to the most recent federal decennial census, are annexed to the cities owning the parks.

Siloam Springs
2010 Population
15,039
Benton County
2010 Population
221,339

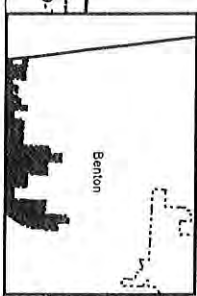
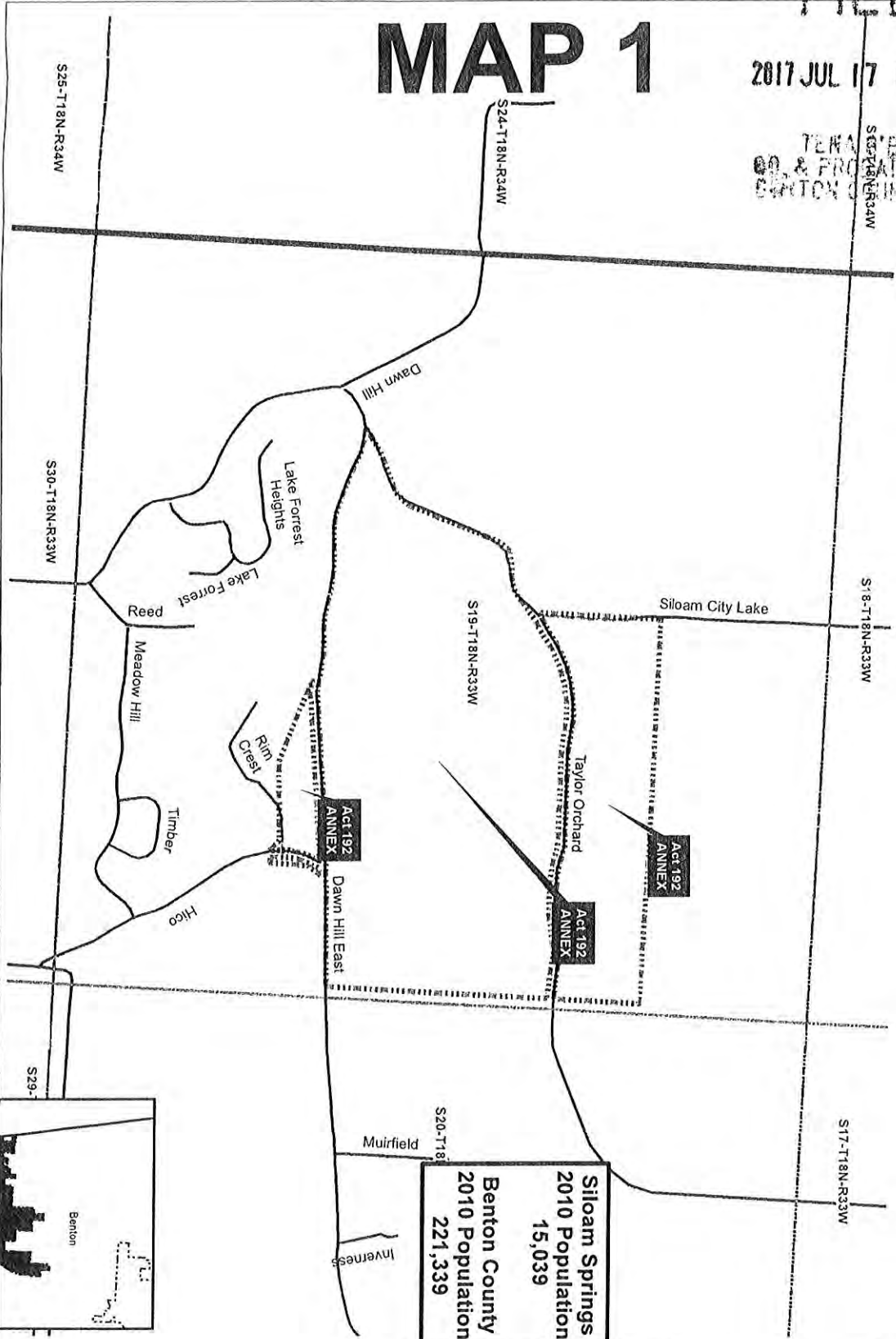

ARKANSAS
GIS OFFICE
H:\City_Annexations\Clarks\Silosm_Springs\301710227

FILED

MAP 2

2017 JUL 17 PM 1:49

ENA O'BRIEN
PROCLATE CLERK
SILVIA
SILVIA COUNTY, ARK

Legislative Annexation: Kayak Park, Recorded in Book 2013, Page 40422 Benton County Circuit Clerk
Annexed to City of Siloam Springs by Act 192 of 2017

FILED

AUG 25 2017

Arkansas
Secretary of State

City: Siloam Springs
Mayor: Mark Turner

Arkansas Code 14-40-101

Before an entity undertakes an annexation, consolidation, or detachment, proceeding under this chapter, the entity shall coordinate with the Arkansas Geographic Information Systems Office for preparation of legal descriptions and digital mapping for the relevant annexation, consolidation, and detachment areas.

The map contained herein, is evidence, the entity has met requirements of Act 514 of 2015.

SECTION 1, Arkansas Code § 14-40-204, concerning the annexation of city-owned parks and airports, is amended to add an additional subsection to read as follows:

**Siloam Springs
2010 Population
15,039**
**Benton County
2010 Population
221,339**

(c) All city-owned parks with a minimum of thirty (30) acres and owned by cities in this state having a population of not less than fifteen thousand (15,000) and not more than eighteen thousand (18,000) and located in counties having a population of not less than two hundred twenty thousand (220,000) and not more than two hundred sixty thousand (260,000), according to the most recent federal decennial census, are annexed to the cities owning the parks.

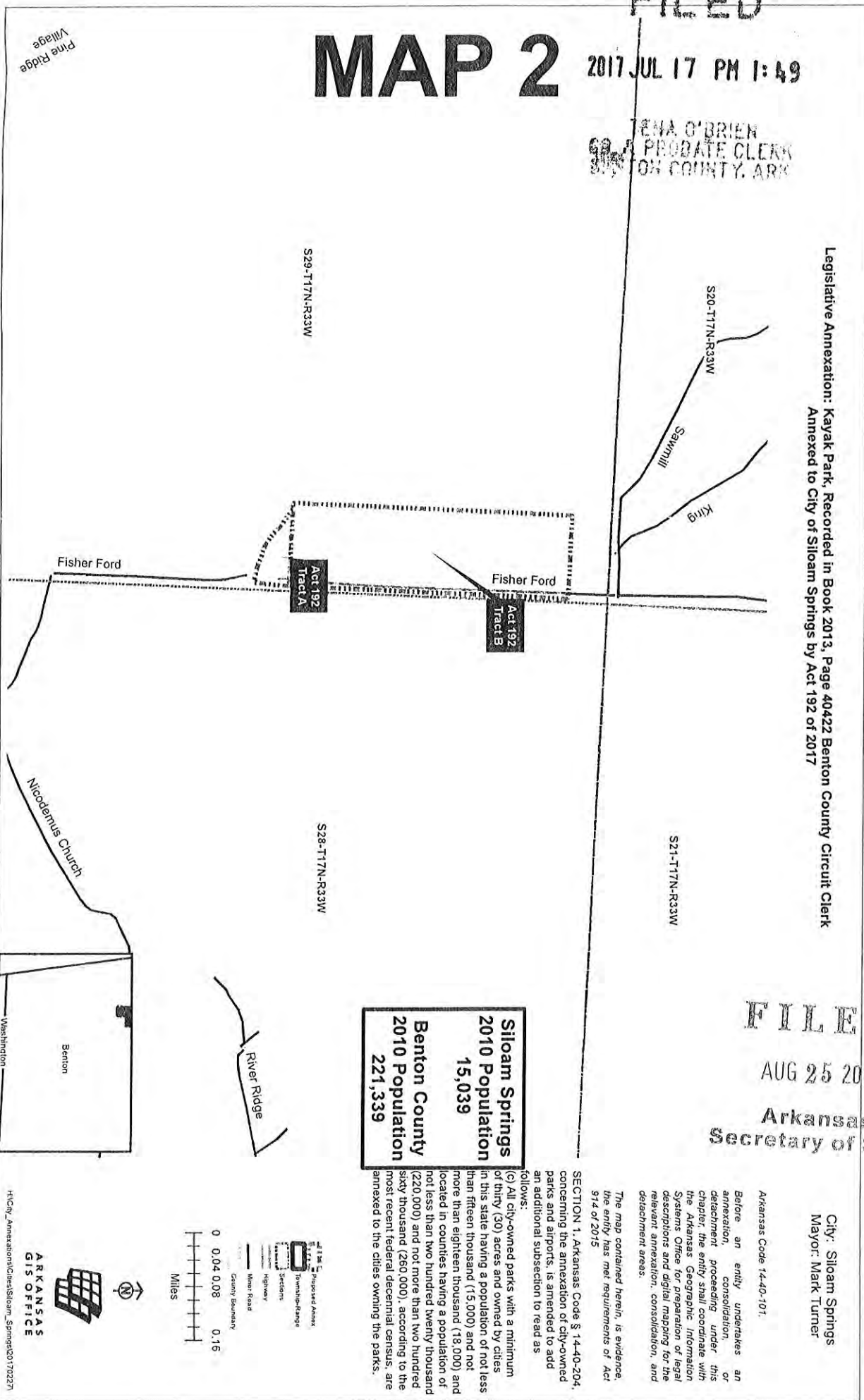

Pine Ridge
Village



ARKANSAS
GIS OFFICE

H:\City_Annexations\Cities\Siloam_Springs\020170227

FILED

2017 JUL 17 PM 1:49

Kayak Park Legal Description:

TENA O'BRIEN
CLERK & PROBATE CLERK
BENTON COUNTY, ARK.

As found in Deed Book 2013 at page 40422 of the Records of the Ex-Officio Recorder and Circuit Clerk's Office of Benton County, Arkansas; the following:

Tract A:

A Part of the East ½ of the East ½ of the South East ¼ of Section 29, Township 17 North, Range 33 West, Benton County, Arkansas, and being more particularly described as:

BEGINNING at the East ¼ Corner of Section 29;
Thence along the East line of said East ½ of the East ½ South 00°10'21" West 273.42 feet;
Thence North 83°14'24" West 106.89 feet;
Thence North 73°05'19" West 201.03 feet;
Thence North 57°57'05" West 105.63 feet;
Thence North 50°13'49" West 109.40 feet;
Thence North 63°33'59" West 31.35 feet;
Thence North 55°58'33" West 66.70 feet;
Thence North 61°16'35" West 34.64 feet;
Thence North 78°33'40" West 58.11 feet to the North line of said East ½ of the East ½;
Thence along said North line South 89°43'17" East 643.62 feet to THE POINT OF BEGINNING, containing 2.39 acres, more or less, and subject to all easements of record or fact.

LESS AND ACCEPT: All of that portion of the above-described property lying and being within 25 feet of the centerline of County roads.

Tract B:

Part of the East ½ of the East ½ of the North East ¼ of Section 29, Township 17 North, Range 33 West, Benton County, Arkansas, and being more particularly described as:

COMMENCING at the North East Corner of said Section 29;
Thence along the East line of said East ½ of the East ½ of the North East ¼ South 00°10'21" West 393.22 feet to THE POINT OF BEGINNING;
Thence continuing along said East line South 00°10'21" West 2256.79 feet to the South line of said East ½ of the East ½ of the North East ¼;
Thence along said South line North 89°43'17" West 660.85 feet to the West line of said East ½ of the East ½ of the North East ¼;
Thence along said West line North 00°05'24" East 2255.35 feet;
Thence South 89°50'47" East 664.10 feet to THE POINT OF BEGINNING, containing 34.31 acres, more or less, subject to an easement found at Deed Book 2013 at Page 48132 of the Records of the Ex-Officio Recorder and Circuit Clerk's Office of Benton County, Arkansas and subject to all other Easements of record or fact.

LESS AND ACCEPT: All of that portion of the above-described property lying and being within 25 feet of the centerline of County roads.

FILED

2017 JUL 17 PM 1:49

**TENA O'BRIEN
CO. & PROBATE CLERK
BENTON COUNTY, ARK**

**BOUNDARY LINE IS SECTION LINE AND
DOES NOT COINCIDE WITH THE CENTER
OF THE ROAD. THE RIGHT OF WAY IS 50
FEET CENTERED ON THE ROAD.
SEE PLAT RECORD 2011-238**

**TRACT "B" PER PLA
RECORD 2011-238
34.31 ACRES AND
DEED RECORD 2013-40422**

**EASEMENT TO BENTON COUNTY
PER DEED RECORD 2013-48132**

**TRACT "A" PER DEED
RECORD 2013-40422
2.39 ACRES**

FILED

2017 JUL 17 PM 1:49

City Lake Park Legal Description:

TENA O'BRIEN
CLERK & PROBATE CLERK
OF THE NORTH EAST DISTRICT OF ARK.

The South ½ of the North East 1/4; Part of the North ½ of the South East ¼; Part of the North East ¼ of the South West ¼ and Part of the South East ¼ of the North West 1/4; Section 19; Township 18 North; Range 33 West; Benton County, Arkansas; being more particularly described as follows:

BEGINNING at the North East Corner of the South West ¼ of said North East ¼ Section 19;
Thence South 86°35'30" East 1331.96 feet;
Thence South 03°06'35" West 2214.15 feet;
Thence North 89°56'13" West 746.87 feet;
Thence South 36°28'59" West 145.00 feet;
Thence South 04°43'52" West 271.33 feet;
Thence North 87°13'19" West 93.26 feet;
Thence North 42°50'40" West 85.64 feet;
Thence South 89°39'20" West 546.00 feet;
Thence North 67°35'40" West 653.00 feet;
Thence North 79°20'40" West 213.00 feet;
Thence North 85°20'40" West 291.00 feet;
Thence North 77°36'22" West 231.12 feet;
Thence North 88°13'08" West 156.70 feet;
Thence South 88°02'52" West 241.50 feet;
Thence North 66°56'08" West 482.93 feet;
Thence North 82°50'52" West 201.51 feet to the Centerline of Benton County Road # 484;
Thence following said Centerline North 65°34'43" East 47.75 feet;
Thence North 59°33'39" East 217.60 feet;
Thence North 68°18'02" East 311.79 feet;
Thence North 45°55'40" East 112.59 feet;
Thence North 21°52'36" East 546.74 feet;
Thence North 23°37'46" East 143.69 feet;
Thence North 41°29'31" East 77.28 feet;
Thence North 74°09'09" East 84.51 feet;
Thence North 88°00'33" East 147.09 feet;
Thence North 73°15'37" East 75.83 feet;
Thence North 48°05'08" East 80.87 feet;
Thence North 36°57'58" East 127.31 feet;
Thence leaving said Centerline North 03°13'00" East 873 feet;
Thence South 87°26'58" East 1314.87 feet to THE POINT OF BEGINNING, containing 169.28 acres more or less, and subject to Easements of record or fact.

LESS AND ACCEPT: All of that portion of the above-described property lying and being within 25 feet of the centerline of County roads.

FILED

2017 JUL 17 PM 1:49

TENA O'BRIEN
CO. & PROBATE CLERK
BENTON COUNTY, ARK

CENTURINE ROAD IS BOUNDARY
THIS AREA

DANN HILL ROAD

JAY ORCHARD ROAD

100 FOOT POWERLINE EASEMENT

