



## ARKANSAS SECRETARY OF STATE

**MARK MARTIN**

May 31, 2018

The Honorable Stephanie James  
Lincoln County Clerk  
300 South Drew St, Rm 101  
Star City, AR 71667

Re: City of Star City Annexation Ordinance 476-2018

Dear Ms. James,

This letter acknowledges receipt and filing of the following notice of municipal boundary change by the Office of the Secretary of State:

Filing Type: Annexation pursuant to A.C.A § 14-40-609 (petition by 100% of the landowners)

Effective Date: 03/12/ 2018 (emergency declared)

County: Lincoln

City: Star City

City Resolution: 476-2018

Dated: 03/12/2018

County Court Order: 40PR-17-50

Filed: 01/19/2018

Hon. Charles Capps, Lincoln County Judge

A file marked copy of the ordinance, court order and exhibits submitted to our Office are enclosed. By copy of this letter (and its enclosures), the Secretary of State hereby notifies the appropriate mapping authorities for Arkansas. Please retain these copies as official record of the filing of the municipal boundary change by the Arkansas Secretary of State.

.If you have any questions or concerns regarding this pending filing, please contact our office at 501-682-3401.

Sincerely,

A handwritten signature in cursive script that reads "Cynthia Fisher".

Cynthia Fisher  
Arkansas Secretary of State Legal Division  
500 Woodlane St, Room 256  
Little Rock, AR 72201  
501-682-3401

cc: Arkansas Geographic Information Systems Office (w/ encl)  
Arkansas Highway and Transportation Department Mapping Department (w/ encl)  
Department of Finance and Administration (w/encl)  
Arkansas Public Service Commission (w.encl)  
UALR Institution for Economic Advancement (w/encl)  
Tom-Tom (w/encl)  
Hon. Paul Carter, Mayor of Star City (w/encl)



# Arkansas Secretary of State

Mark Martin Arkansas Secretary of State, 500 Woodlane Ave, Little Rock, AR 72201-1094

## Municipal Boundary Change Checklist

County: Lincoln City/Town: Star City

City Ordinance/Resolution No: 476-2018 Date approved: 3/12/18

County Court Case No: 40 PR-17-50 Date Order Filed: 1/9/18

Type: Incorporation by direct petition of landowners  
(Choose from the list of Arkansas Code Sections located on the back)

Date Change Effective: 3-12-18 Set by:  Municipal Ordinance  Emergency Clause  Court  Default  
(Required by Act 655 of 2017)

For Circuit Court Challenge: Date Order Filed: \_\_\_\_\_  Upheld  Overturned  Other (attach explanation)

### Initiating party:

All Landowners  Majority Landowners  Municipal Governing Body  State  Other \_\_\_\_\_

### Supporting Documentation attached (check all that apply):

- File marked copy of City Ordinance/Resolution (required)
- File marked copy of County Court Order (required except for island annexation and annexation approved by election)
- Copy of Arkansas GIS approved printed map and certification letter (required)
- Proof of Publication for all Legal Notices (include Hearing, Election, and City Ordinance/Resolution notices)
- File marked copy of Petition Part or File marked copy of the certified special election results (if applicable)
- File marked copy of Complaint and final Circuit Court Order (Court Challenge only)

### Municipal Contact:

Name: Paul Carter Title: Mayor

Street Address: \_\_\_\_\_

City: Star City St: AR Zip code: 71664?

Complete one form per ordinance/resolution, attach it as a cover page to the supporting document set and submit to the County Clerk's Office within 45 days of the Effective Date as required by Act 655 of 2017

### County Official:

Signature: Stephanie Jones Title: County Clerk

Date: 4/2/18

Pursuant to Act 655 of 2017, County Officials must submit a file-marked copy of municipal boundary change documents within 30 days of receipt to: Arkansas Secretary of State, Attn: Municipal Boundary Filing, 500 Woodlane Ave Suite 256, Little Rock, AR 72201-1094

Office of the Arkansas Secretary of State use only

Received by: Cynthia Fisher

**FILED**  
MAY 31 2018  
Arkansas  
Secretary of State

**CITY OF STAR CITY**  
**ORDINANCE NO. 476-2018**

**AN ORDINANCE ASSIGNING TO WARD 3 OF THE**  
**CITY OF STAR CITY CERTAIN RECENTLY ANNEXED**  
**TERRITORY LYING ADJACENT THERETO; AND**  
**DECLARING AN EMERGENCY TO EXIST.**

Preamble. The County Court of Lincoln County, Arkansas, on January 10, 2018, ordered that the territory described in Section 1 below be annexed to and incorporated within the City of Star City. There being no complaint made in the manner prescribed by law to prevent such annexation within thirty (30) days after the making of said order of annexation by the Lincoln County Court, the proceeding before said Court was confirmed by a resolution duly adopted by the City Council of Star City on this 12<sup>th</sup> day of March, 2018; accepting the annexation of this territory. Upon the adoption of said resolution this territory was, in law, deemed and taken to be included in, and became a part of, the City of Star City, and the inhabitants thereof became in all respects citizens thereafter of this City.

NOW, THEREFORE, BE IT ORDAINED by the City Council of Star City, now in regular meeting duly constituted and convened, as follows:

Section 1. Description of Territory Affected. This ordinance affects the following described real property situated in Lincoln County, Arkansas:

Commencing at the Northwest Corner of the Northeast Quarter of the Southwest Quarter (NE  $\frac{1}{4}$  SW  $\frac{1}{4}$ ) of Section 16, Township 9 South, Range 7 West, and running thence South 306 feet; thence East 111 feet to the center of Roosevelt Road (formerly known as Sorrells Ferry Road); thence in a Northwesterly direction along and with the center of said road 91 feet to the POINT OF BEGINNING; thence West 348 feet; thence North 125 feet; thence East 347 feet to the center of said road; thence in a Southeasterly direction approximately 125 feet to the POINT OF BEGINNING, and containing 1 acre, more or less, and said land being located partially in the Northwest Quarter of the Southwest Quarter (NW  $\frac{1}{4}$  SW  $\frac{1}{4}$ ) and the Northeast Quarter of the Southwest Quarter (NE  $\frac{1}{4}$  SW  $\frac{1}{4}$ ) of said Section 16, Township 9 South, Range 7 West.

**F I L E D**

MAY 31 2018

Arkansas  
Secretary of State

All of said real property lies adjacent to Ward 3 of this City.

**Section 2. Assignment of Territory to Ward.** All of this recently annexed territory is hereby assigned to, attached to and incorporated in Ward 3 of the City of Star City, as the same is now or may hereafter be constituted.

**Section 3. Emergency.** An emergency is declared to exist; and this ordinance being necessary for the immediate preservation and protection of the public peace, health, welfare, and safety, shall take effect and be in force immediately from and after its adoption.

ADOPTED on this 12<sup>th</sup> day of March, 2018.

APPROVED: Paul C. Carter  
Paul C. Carter, Mayor

ATTEST:

Alicia Hawkins  
Alicia Hawkins, City Clerk Treasurer

## CERTIFICATE

The undersigned, City Recorder/Treasurer of Star City, Arkansas, hereby certifies that the foregoing pages are a true and perfect copy of Ordinance No.476-2018, passed at a regular council meeting of the City of Star City, Arkansas, held at city hall, on the 12<sup>th</sup> day of March, 2018, and that the ordinance given under my hand and seal this 12<sup>th</sup> day of March, 2018.

(SEAL)

  
City Recorder/Treasurer

IN THE COUNTY COURT OF LINCOLN COUNTY, ARKANSAS

IN THE MATTER OF THE  
ANNEXATION OF CERTAIN TERRITORY  
TO THE CITY OF STAR CITY, ARKANSAS

NO. 40PR-17-50

ORDER OF ANNEXATION

At 2:00 p.m. on the 9<sup>th</sup> day of January, 2018, there came on to be presented the petition of Scotty White and Tammy White praying for an Order of this Court annexing to the City of Star City the following described real property situated in Lincoln County, Arkansas, to-wit:

**Commencing at the Northwest Corner of the Northeast Quarter of the Southwest Quarter (NE ¼ SW ¼) of Section 16, Township 9 South, Range 7 West, and running thence South 306 feet; thence East 111 feet to the center of Roosevelt Road (formerly known as Sorrells Ferry Road); thence in a Northwesterly direction along and with the center of said road 91 feet to the POINT OF BEGINNING; thence West 348 feet; thence North 125 feet; thence East 347 feet to the center of said road; thence in a Southeasterly direction approximately 125 feet to the POINT OF BEGINNING, and containing 1 acre, more or less, and said land being located partially in the Northwest Quarter of the Southwest Quarter (NW ¼ SW ¼) and the Northeast Quarter of the Southwest Quarter (NE ¼ SW ¼) of said Section 16, Township 9 South, Range 7 West.**

After reviewing the Petition for completeness and accuracy, the Court finds as follows:

1. That no enclaves will be created by annexing the above-described real property;
2. That the requirement of a schedule of services is waived because the city already provides water and sewer services to the property;
3. That the real property herein above described is used and useful in urban purposes; that petitioners desire that this territory be annexed to the City of Star City; and that the prayer of the petitioner for annexation are right and proper, and should be by this Court granted.
4. That this Court has jurisdiction over this proceeding and over all the parties having an interest herein; that all things required to be done and all conditions required to exist, prerequisite to the valid rendition of this Order at this time, have been done and do exist, as in such cases by law prescribed.

FILED

FILED  
LINCOLN COUNTY

MAY 31 2018

JAN 10 2018

Secretary of State

COUNTY AND PROBATE CLERK  
BY \_\_\_\_\_

THEREFORE, it is by this Court considered, ordered and adjudged that the real property herein above particularly described is annexed to, and incorporated within the bounds of the City of Star City, Arkansas.

Rendered and ordered to be recorded on this 9 day of Jan., 2018.



---

CHARLES CAPPS,  
As Judge of the County Court of  
Lincoln County, Arkansas

IN THE COUNTY COURT OF LINCOLN COUNTY, ARKANSAS

IN THE MATTER OF THE  
ANNEXATION OF CERTAIN TERRITORY  
TO THE CITY OF STAR CITY, ARKANSAS

NO. 40PR-17-50

VERIFICATION

Pursuant to Arkansas Code Annotated §14-40-609, the Lincoln County Tax Assessor and the County Clerk verify the following:

1. That a Petition for Annexation was filed with the Lincoln County Clerk's office on October 6, 2017, with an Amended Petition filed October 18, 2017, and the identity of the Petitioners have been properly verified;
2. That Petitioners are 100% percent of the owners wishing to annex;
3. That the property is contiguous with the city; and
4. That no enclaves will be created if the petition is accepted by the city.

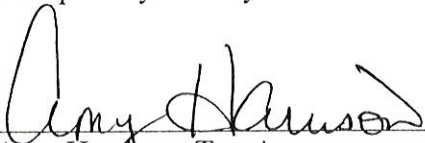
  
\_\_\_\_\_  
Amy Harrison, Tax Assessor

  
\_\_\_\_\_  
Stephanie James, County Clerk

**FILED**

**MAY 31 2018**

**Arkansas  
Secretary of State**

**FILED**  
LINCOLN COUNTY

**JAN 10 2018**

COUNTY AND PROBATE CLERK  
BY SS





ARKANSAS  
GIS OFFICE

October 19, 2017

Clint Todd, Attorney at Law  
220 W. Bradley  
Star City, AR 71667

RE: City of Star City Annexation Coordination Requirement

Mr Todd,

Thank you for coordinating with our office on behalf of petitioners, Mr. Scotty and Mrs. Tammy White, as they seek to annex property into the City of Star City, AR located in the NW ¼ of the SW ¼ AND NE ¼ of the SW ¼ of Section 16, Township 9 South, Range 7 West, Lincoln County Court Case Number 40PR17-50. This letter represents confirmation that you have properly coordinated with our office (Arkansas GIS Office) as specified in § 14-40-101 (Act 914 of 2015) of the 90<sup>th</sup> General Assembly.

Our office will wait completion of any additional steps necessary for the proposed boundary change, which normally comes from the Arkansas Secretary of State Elections Division after any appropriate filing by your County Clerk.

Thank you,

Shelby D Johnson, State Geographic Information Officer  
/sdj

Attachments:  
GIS Office Map of Proposed Annexation  
Secretary of State Municipal Change Checklist

**F I L E D**

**MAY 31 2018**

**Arkansas  
Secretary of State**

H:\City\_Annexations\Templates\Folder Structure\Doc\20171010\_StarCity\_Annexation\_Coordination\_Letter.docx

Proposed Annex: City of Star City  
October 2017

City: Star City  
Mayor: Paul Carter

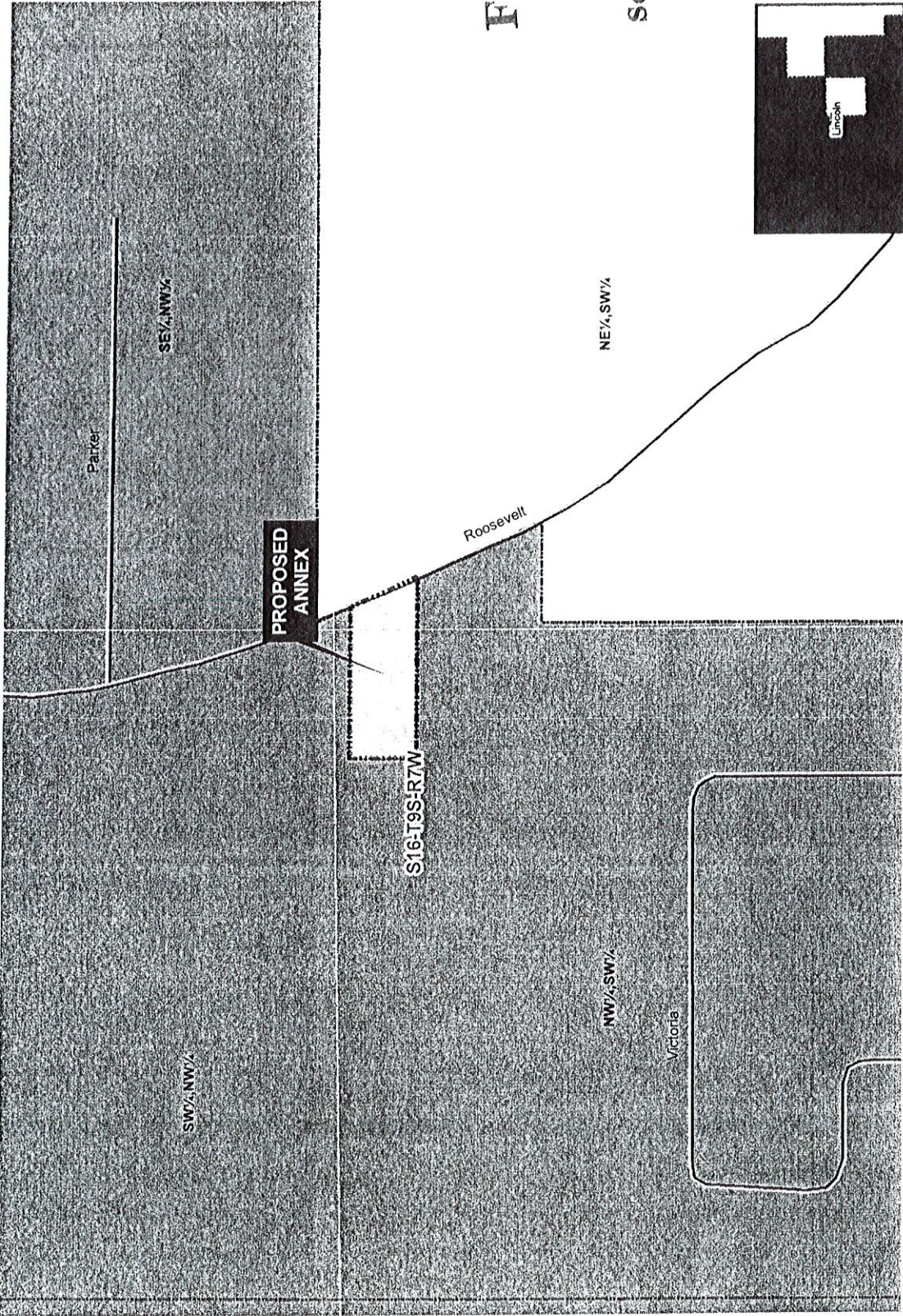

Arkansas Code 14-40-101.  
Before an entity undertakes an annexation, consolidation, or detachment proceeding under this chapter, the entity shall coordinate with the Arkansas Geographic Information Systems Office for preparation of legal descriptions and digital mapping for the relevant annexation, consolidation, and detachment areas.

The map contained herein, in evidence, the entity has met requirements of Act 914 of 2015

- Proposed Annex
- Sections
- Quarter-Quarter-Section
- Minor Road
- Existing City

FILED

MAY 31 2018

Arkansas  
Secretary of State



IN THE COUNTY COURT OF LINCOLN COUNTY, ARKANSAS

IN THE MATTER OF THE  
ANNEXATION OF CERTAIN TERRITORY  
TO THE CITY OF STAR CITY, ARKANSAS

NO. 40PR-17-50

AMENDED PETITION

We, the undersigned, pray that this Court render its Order annexing to the City of Star City, Arkansas (hereinafter designated the "City"), the following described real property situated in Lincoln County, Arkansas, to-wit:

**Commencing at the Northwest Corner of the Northeast Quarter of the Southwest Quarter (NE ¼ SW ¼) of Section 16, Township 9 South, Range 7 West, and running thence South 306 feet; thence East 111 feet to the center of Roosevelt Road (formerly known as Sorrells Ferry Road); thence in a Northwesterly direction along and with the center of said road 91 feet to the POINT OF BEGINNING; thence West 348 feet; thence North 125 feet; thence East 347 feet to the center of said road; thence in a Southeasterly direction approximately 125 feet to the POINT OF BEGINNING, and containing 1 acre, more or less, and said land being located partially in the Northwest Quarter of the Southwest Quarter (NW ¼ SW ¼) and the Northeast Quarter of the Southwest Quarter (NE ¼ SW ¼) of said Section 16, Township 9 South, Range 7 West.**

The above-described real property is contiguous to and adjoins the corporate limits of the City. A map representing this territory and its geographical relation to the City is hereto attached as Exhibit "A" and is hereby expressly referred to and made a part hereof.

Petitioners are the owners of the property described herein and desire that this territory be annexed to the City.

This territory is used and useful for urban purposes. It is the site of lands which have been developed for residential purposes.

The persons who will reside on this land participate in and substantially contribute to the social life and the civic activities of the City, and this annexation will enable adult residents of this territory to participate in the political affairs of this municipality.

**FILED**  
LINCOLN COUNTY

OCT 18 2017

COUNTY AND PROBATE CLERK  
BY

Buildings and other improvements to be located upon the property here affected represent the investment of many thousands of dollars and can be afforded the full benefits of adequate fire protection only by this annexation.

The persons who will be residing in this area attend the churches of Star City, contribute substantially to the City's economic welfare, and otherwise have a close bond with the City.

Petitioners hereby name Clint E. Todd, Attorney, of Star City, Arkansas, as the person authorized to act on their behalf.

WHEREFORE, the premises considered, your petitioners pray that the Court order a hearing upon this petition, fixing and giving notice of the time and place of such hearing in the manner provided by law; and that, upon the hearing thereof, the Court grant the annexation for which this petition prays.

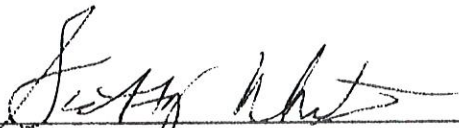
  
\_\_\_\_\_  
SCOTTY WHITE

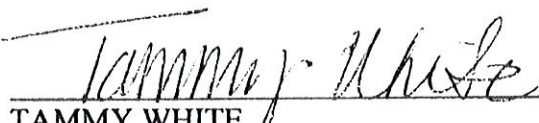
  
\_\_\_\_\_  
TAMMY WHITE

**COVER SHEET  
STATE OF ARKANSAS  
CIRCUIT COURT: PROBATE**

The probate reporting form and the information contained herein shall not be admissible as evidence in any court proceeding or replace or supplement the filing and service of pleadings, orders, or other papers as required by law or Supreme Court Rule. This form is required pursuant to Administrative Order Number 8. Instructions can be found at [www.courts.arkansas.gov](http://www.courts.arkansas.gov).

County: LINCOLN District: \_\_\_\_\_ Filing Date: 10/05/2017

Judge: \_\_\_\_\_ Division: \_\_\_\_\_ Case ID: 40PR-17-50

Type of case (choose one): (OP) Probate-Other ▼

In the Matter of: THE ANNEXATION OF CERTAIN TERRITORY TO THE CITY OF STAR CITY, ARK

Does this case involve the custody or support of minor children?  Yes  No

If yes, also file the completed Confidential Information Sheet.

Participant 1		Participant 2	
Participant Type	Petitioner	Participant Type	
Company/Last Name	WHITE	Company/Last Name	
Suffix		Suffix	
First Name	SCOTTY & TAMMY	First Name	
DLN/State ID/Contexte ID		DLN/State ID/Contexte ID	
Address	111 Deerfield Drive	Address	
City, State ZIP	Star City, AR 71667	City, State ZIP	
Phone		Phone	
Email		Email	
Self-represented	<input type="radio"/> Yes <input type="radio"/> No	Self-represented	<input type="radio"/> Yes <input type="radio"/> No
DOB		DOB	
Date of Death		Date of Death	
Interpreter needed?	<input type="radio"/> Yes: _____ <input checked="" type="radio"/> No other language: _____	Interpreter needed?	<input type="radio"/> Yes: _____ <input type="radio"/> No other language: _____

Attorney of Record: CLINT E. TODD Bar #: 2013048

Party representing: Petitioners Atty Email Address: \_\_\_\_\_

Related Case(s): Judge: \_\_\_\_\_ Case ID(s): \_\_\_\_\_

Manner of filing (choose one): (MFO) Original ▼

**FILED**  
LINCOLN COUNTY

OCT 06 2017

COUNTY AND PROBATE CLERK  
BY:  6/1/2017

IN THE COUNTY COURT OF LINCOLN COUNTY, ARKANSAS

IN THE MATTER OF THE  
ANNEXATION OF CERTAIN TERRITORY  
TO THE CITY OF STAR CITY, ARKANSAS

NO. 40 PR-17-50

ORDER SETTING HEARING

A petition having been filed herein for the annexation of certain property into the City of Star City, a hearing on said petition is hereby set for 10:00 a.m. on November 6<sup>th</sup>, 2017, in the courtroom of the Lincoln County Courthouse, Star City, Arkansas.

Rendered and ordered to be recorded on this 6<sup>th</sup> day of Oct., 2017.

Charles D. Capps  
COUNTY JUDGE

**FILED**  
LINCOLN COUNTY

OCT 06 2017

COUNTY AND PROBATE CLERK

BY gw

IN THE COUNTY COURT OF LINCOLN COUNTY, ARKANSAS

IN THE MATTER OF THE  
ANNEXATION OF CERTAIN TERRITORY  
TO THE CITY OF STAR CITY, ARKANSAS

NO. 40 PR-17-50

PETITION

We, the undersigned, pray that this Court render its Order annexing to the City of Star City, Arkansas (hereinafter designated the "City"), the following described real property situated in Lincoln County, Arkansas, to-wit:

**Commencing at the Northwest Corner of the Northeast Quarter of the Southwest Quarter (NE ¼ SW ¼) of Section 16, Township 9 South, Range 7 West, and running thence South 306 feet; thence East 111 feet to the center of Sorrells Ferry Road; thence in a Northwesterly direction along and with the center of said road 91 feet to the POINT OF BEGINNING; thence West 348 feet; thence North 125 feet; thence East 347 feet to the center of said road; thence in a Southeasterly direction approximately 125 feet to the POINT OF BEGINNING, and containing 1 acre, more or less, and said land being located partially in the Northwest Quarter of the Southwest Quarter (NW ¼ SW ¼) and the Northeast Quarter of the Southwest Quarter (NE ¼ SW ¼) of said Section 16, Township 9 South, Range 7 West.**

The above-described real property is contiguous to and adjoins the corporate limits of the City. A map representing this territory and its geographical relation to the City is hereto attached as Exhibit "A" and is hereby expressly referred to and made a part hereof.

Petitioners are the owners of the property described herein and desire that this territory be annexed to the City.

This territory is used and useful for urban purposes. It is the site of lands which have been developed for residential purposes.

The persons who will reside on this land participate in and substantially contribute to the social life and the civic activities of the City, and this annexation will enable adult residents of this territory to participate in the political affairs of this municipality.

Buildings and other improvements to be located upon the property here affected represent the investment of many thousands of dollars and can be afforded the full benefits of adequate fire protection only by this annexation.

**FILED**  
LINCOLN COUNTY

OCT 06 2017

COUNTY AND PROBATE CLERK  
BY AW

The persons who will be residing in this area attend the churches of Star City, contribute substantially to the City's economic welfare, and otherwise have a close bond with the City.

Petitioners hereby name Clint E. Todd, Attorney, of Star City, Arkansas, as the person authorized to act on their behalf.

WHEREFORE, the premises considered, your petitioners pray that the Court order a hearing upon this petition, fixing and giving notice of the time and place of such hearing in the manner provided by law; and that, upon the hearing thereof, the Court grant the annexation for which this petition prays.

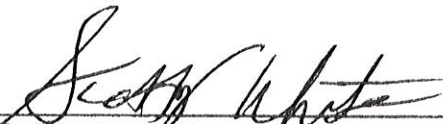
  
\_\_\_\_\_  
SCOTTY WHITE

  
\_\_\_\_\_  
TAMMY WHITE



# Township 9S - Range 7W

Copyright © 2016 Mapping Solutions

SEE PAGE 19

SEE PAGE 21

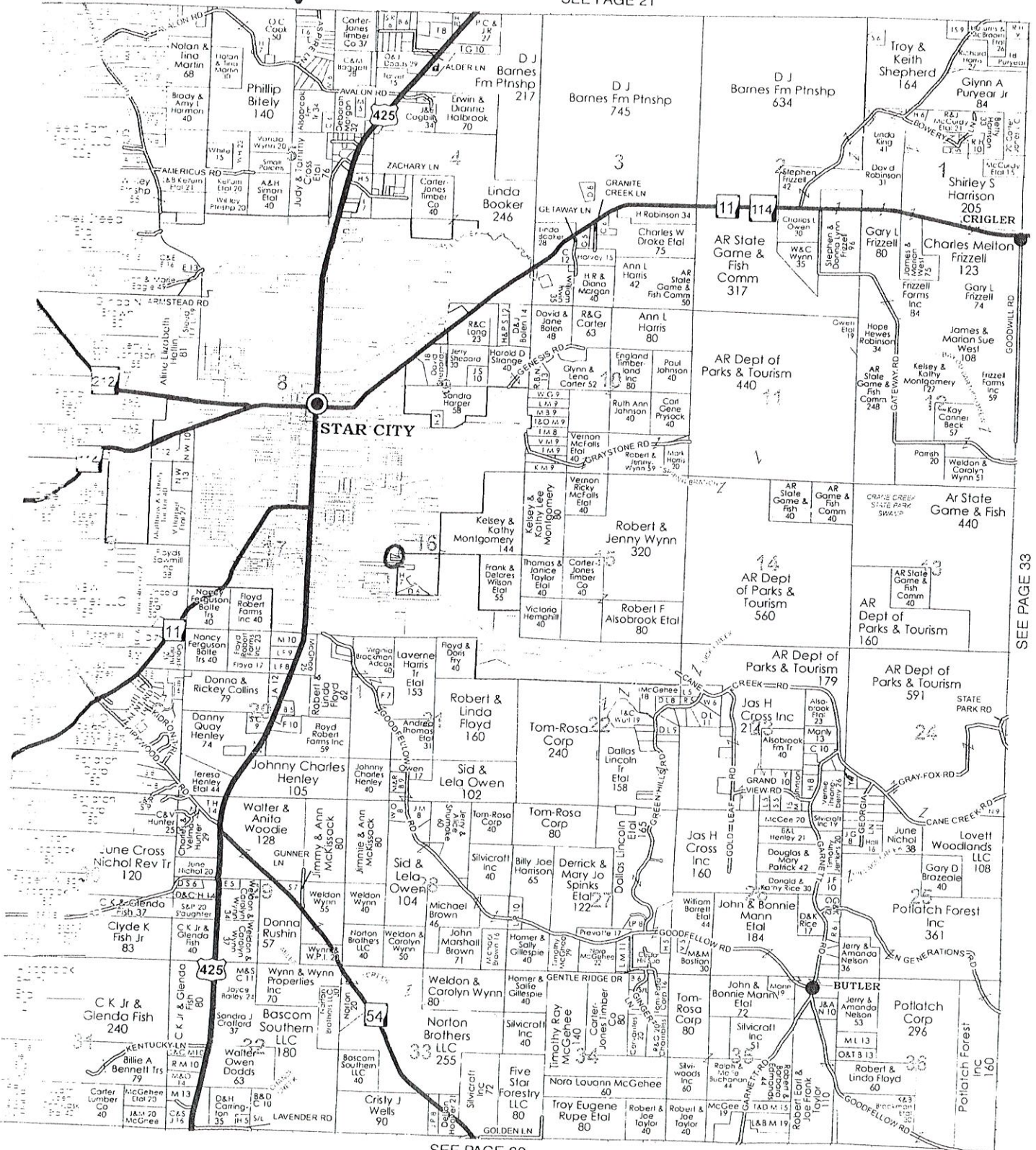

SEE PAGE 39

Exhibit "A"