



JOHN THURSTON
ARKANSAS SECRETARY OF STATE

November 18, 2020

The Hon. Betsy Harrell
Benton County Clerk
215 East Central, Suite 217
Bentonville, AR 72712-5373

Re: City of Siloam Springs Annexation Ordinance 20-24

Dear Ms. Harrell,

This letter acknowledges receipt and filing of the following notice of municipal boundary change by the Office of the Arkansas Secretary of State:

Filing Type: Annexation pursuant to A.C.A §14-40-501 (surrounded unincorporated area)

Effective Date: 10/23/2020

County: Benton

City: Siloam Springs

City Ordinance: 20-24

Dated: 9/15/2020

County Court Order: N/A

Date Filed: N/A

A file marked copy of the ordinance and exhibits submitted to our Office are enclosed. By copy of this letter (and its enclosures), the Secretary of State hereby notifies the appropriate mapping authorities for Arkansas. Please retain these copies as official record of the filing of the municipal change by the Arkansas Secretary of State.

If you have any questions or concerns regarding this filing, please do not hesitate to contact our Office at 501-683-3717.

Sincerely,

A handwritten signature in black ink, appearing to read "Shantell McGraw".

Shantell McGraw
Elections Division

cc: Arkansas Geographic Information Systems Office (w/encl)
Arkansas Department of Transportation Mapping Department (w/encl)
Department of Finance and Administration (w/encl)
Arkansas Public Service Commission (w/encl)
Arkansas Economic Development Institute (w/encl)
The Hon. John Mark Turner, Mayor of Siloam Springs (w/encl)
Mr. Phillip R. Patterson, Siloam Springs City Administrator (w/encl)



Arkansas Secretary of State

John Thurston Arkansas Secretary of State, 500 Woodlane Ave, Little Rock, AR 72201-1094

FILED

2020 SEP 17 PM 3:20

BERRY JOHNSON
CO. CLERK
BENTON COUNTY, AR

Municipal Boundary Change Checklist

Act 655 of 2017 and A.C.A. §14-40-103

County: Benton City/Town: Siloam Springs
City Ordinance/Resolution No: 20-24 Date approved: September 15, 2020
County Court Case No: Date Order Filed:
Type: §14-40-501

(Choose from the list of Arkansas Code Sections located on the back)

Date Change Effective: October 23, 2020 Set by: [X] Municipal Ordinance [] Emergency Clause [] Court [] Default
(Required by Act 655 of 2017)

For Circuit Court Challenge: Date Order Filed: [] Upheld [] Overturned [] Other (attach explanation)

Please indicate which ward(s) the territory will be assigned to: Ward 3

(See A.C.A § 14-40-203)

Initiating party:

[] All Landowners [] Majority Landowners [X] Municipal Governing Body [] State [] Other

Supporting Documentation attached (check all that apply):

- [X] File marked copy of City Ordinance/Resolution (required)
[] File marked copy of County Court Order or certified annexation election results (required except for A.C.A. §14-40-501)
[X] Copy of Arkansas GIS approved printed map and certification letter (required)
[X] Proof of Publication for all Legal Notices (include Hearing, Election, and City Ordinance/Resolution notices)
[] File marked copy of Petition Part (if applicable)
[] File marked copy of Complaint and final Circuit Court Order (Court Challenge only)

Municipal Contact:

Name: Phillip R. Patterson Title: City Administrator

Street Address: 400 N. Broadway

City: Siloam Springs St: AR Zip code: 72761

Complete one form per ordinance/resolution, attach it as a cover page to the supporting document set and submit to the County Clerk's Office within 45 days of the Effective Date as required by Act 655 of 2017

County Official:

Signature: [Signature] Title: Deputy County Clerk

Date: 10/01/20

Pursuant to Act 655 of 2017, County Officials must submit a file-marked copy of municipal boundary change documents within 30 days of receipt to: Arkansas Secretary of State, Attn: Municipal Boundary Filing, 500 Woodlane Ave Suite 256, Little Rock, AR 72201-1094

Office of the Arkansas Secretary of State use only

Received by: [Signature]

FILED

NOV 18 2020

Arkansas Secretary of State

FILED

2020 SEP 17 PM 3: 20

ORDINANCE NO. 20-24

DEBBY MARSELL
CO & PROBATE CLERK
BENTON COUNTY, AR

AN ORDINANCE ANNEXING CERTAIN LANDS THAT ARE COMPLETELY SURROUNDED BY THE INCORPORATED LIMITS OF THE CITY OF SILOAM SPRINGS; AND FOR OTHER PURPOSES

Whereas, A.C.A. §§14-40-501 through 14-40-504 provide that unincorporated islands of land that have been completely surrounded by the incorporated limits of a municipality may be annexed by that municipality; and

Whereas, the City of Siloam Springs desires to annex certain lands more completely described below; and

Whereas, the Board of Directors finds that the territory to be annexed is surrounded by the incorporated limits of the City of Siloam Springs; and

Whereas, the area to be annexed complies with the standards for lands qualifying for annexation which are set forth in A.C.A. §§14-40-302 and 14-40-501; and

Whereas, the Board further finds that the territory consists of lands that furnish the abode for a densely settled community or represent the actual growth of the municipality beyond its legal boundary; are held for sale or use as municipal lots or as suburban property; and are valuable by reason of their adaptability for prospective municipal uses; and

Whereas, on July 29, 2020, a public hearing notice was published setting out the description of the territory proposed to be annexed; and all property owners within the area were notified by certified mail of their right to appear at the public hearing to present their views on the proposed annexation; and

Whereas, said public hearing was held on August 18, 2020, regarding this proposed annexation.

NOW, THEREFORE, BE IT ORDAINED BY THE City Board of Directors of the City of Siloam Springs, Arkansas:

Section 1. That the following described unincorporated lands, which are completely surrounded by the city limits of the City of Siloam Springs, are hereby annexed, effective this date, to the City of Siloam Springs:

All unincorporated territory, completely surrounded by Siloam Springs City Limits, in the NW $\frac{1}{4}$ SE $\frac{1}{4}$, and in the eastern 100' of the NE $\frac{1}{4}$ SW $\frac{1}{4}$ of Section 4, Township 17 N, Range 33 W, in Benton County, Arkansas.

FILED

2020 SEP 17 PM 3:20

BE BY THE CITY CLERK
CO & RECORDS
BENTON COUNTY

Section 2. That the above-described territory shall be annexed to and become a part of Ward 9 of the City of Siloam Springs, Arkansas, and the same shall henceforth be a part of said ward as fully as existing parts of said ward.

Section 3. That the zoning map of the City (Municipal Code Section 102-21) is hereby amended to include within the I-1 zoning district the above described territory.

Section 4. All necessary urban services, such as police and fire protection, solid waste collection and disposal, and maintenance of public streets shall be extended to the annexed area within a reasonable time.

Section 5. Within forty-five (45) days of the effective date of this ordinance, the City Clerk shall provide written notice, along with complete documentation, to the County Clerk, who shall file such records with the Secretary of State as provided by law.

ORDAINED AND ENACTED this 15th day of September 2020.

APPROVED:

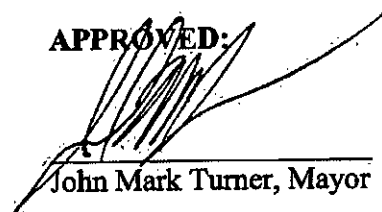
John Mark Turner, Mayor

ATTEST:

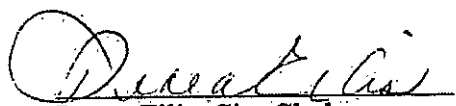
Renea Ellis, City Clerk

(SEAL)



FILED

2020 SEP 17 PM 3:20

SETEY W. WHEELER
CO. CLERK
SENIOR COUNTY, AR

CERTIFICATE

I, Renea Ellis, the duly appointed, qualified and acting City Clerk of Siloam Springs, Arkansas, do hereby certify that the above and foregoing Ordinance #20-24 is a true and correct copy of the Ordinance as the same appears in the records of said City, adopted at a regular meeting of the Board of Directors of Siloam Springs, held on the 15th day of September 2020, at which meeting a quorum of the Board of Directors was present, and said Ordinance was adopted by a vote of 7 ayes, 0 nays.

Witness my hand and seal as City Clerk of Siloam Springs on this 17th day of September 2020.

(SEAL)



Renea Ellis

Renea Ellis, City Clerk

FILED



**ARKANSAS
GIS OFFICE**

2020 SEP 17 PM 3:00
JENNIFER WHEELER
COUNTY CLERK
BENTON COUNTY, AR

Department of Transformation
and Shared Services
Governor Asa Hutchinson
Secretary Amy Fecher
Director Shelby Johnson

June 24, 2020

Mr. Ben Rhoads
Senior Planner - Community Development Department
City of Siloam Springs
410 N. Broadway St.
Siloam Springs, AR 72761

RE: City of Siloam Springs Annexation Coordination Requirement

Mr. Rhoads,

Thank you for coordinating with our office as you seek to annex property into the City of Siloam Springs, AR described as "Island E" and located in Section 4, Township 17 North, Range 33 West. This letter represents confirmation that you have properly coordinated with our office (Arkansas GIS Office) as specified in § 14-40-101 (Act 914 of 2015) of the 90th General Assembly.

Our office will wait completion of any additional steps necessary for the proposed boundary change, which normally comes from the Arkansas Secretary of State Elections Division after any appropriate filing by your County Clerk.

Thank you,

Jennifer Wheeler, GIS Analyst

- Attachments:
- GIS Office Map of Proposed Annexation
 - Legal Description
 - Secretary of State Municipal Change Checklist

H:\City_Annexations\Cities\Siloam_Springs\20200624\Doc\20200624_Siloam Springs_Annexation_Coordination_Letter_E.docx

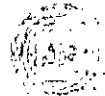

FILED
 2020 SEP 15 PM 3:20
 BEVERLY SELL
 CO. CLERK
 BENTON COUNTY, AR

Page 2 of 3

Proposed Annex "Island E", City of Siloam Springs
 June 2020

City: Siloam Springs
 Mayor: John Mark Turner

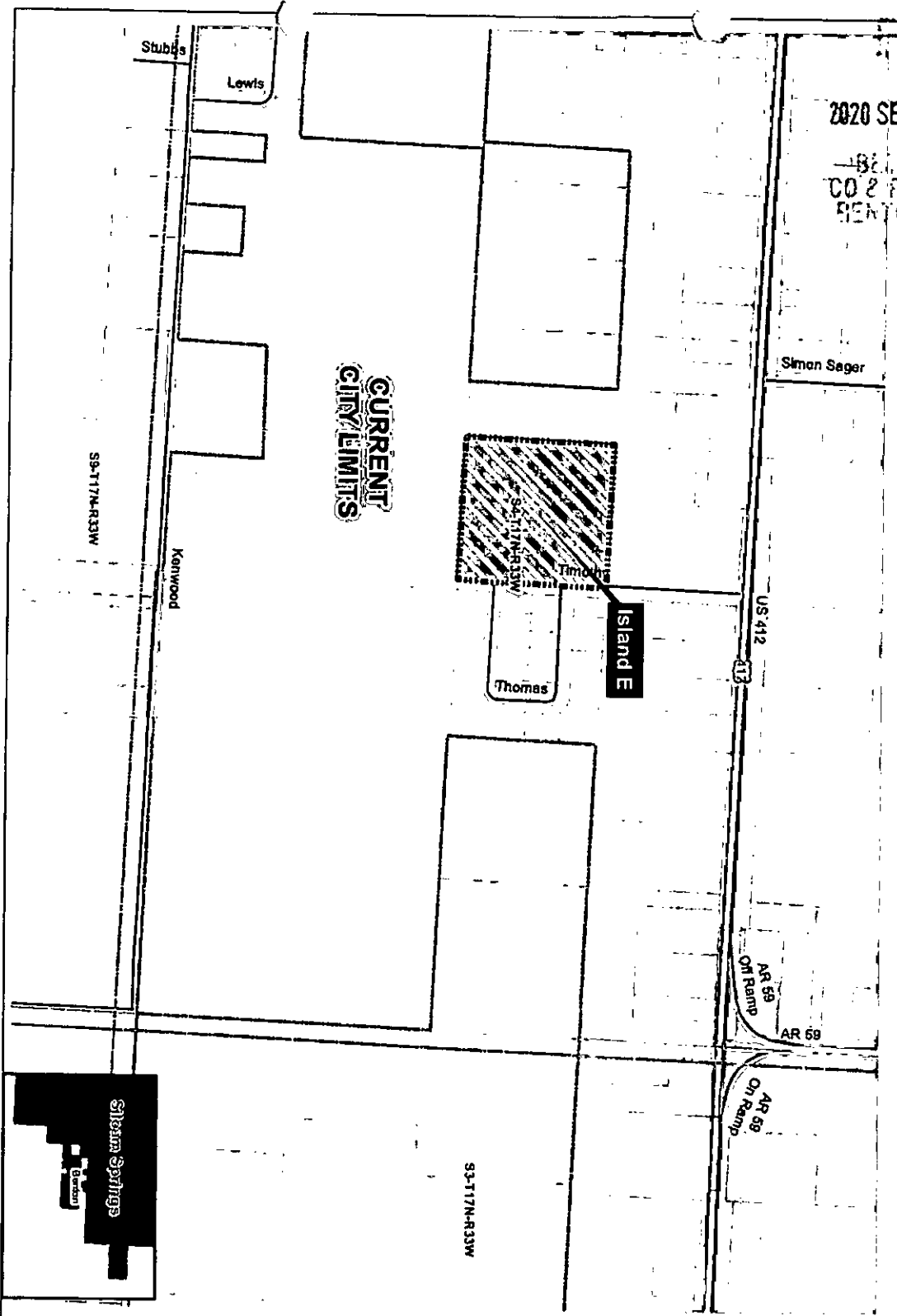

Arkansas Code 14-40-101.
 Before an entity undertakes an annexation, consolidation, or detachment proceeding under this chapter, the entity shall coordinate with the Arkansas Geographic Information Systems Office for preparation of legal descriptions and digital mapping for the relevant annexation, consolidation, and detachment areas.
 The map contained herein, is evidence. The entity has met requirements of Act 914 of 2015

- 1/4" = 100' Proposed Annex
- 1/4" = 100' Detachment
- 1/4" = 100' Consolidation
- 1/4" = 100' Highway
- 1/4" = 100' Water Road
- 1/4" = 100' State City

0 0.0250.05 0.1
 Miles

Arkansas GIS Center
 501.678.1111

FILED

2020 SEP 17 PM 3: 20

AFFIDAVIT OF PUBLICATION

I, Brittany Smith, solemnly swear that I am the Accounting Legal Clerk for the Northwest Arkansas Newspapers, LLC, and I do solemnly swear that the attached advertisement:

City of Siloam Springs
PH Proposed Annexation

was published in the following weekly paper(s):

- Bella Vista Weekly Vista
- Pea Ridge Times
- Siloam Springs Herald Leader
- Siloam Sunday (Section of Arkansas Democrat Gazette)
- Westside Eagle Observer

Of general and bona fide circulation in Benton County, Arkansas

Date(s) of Publication: July 29, 2020

Publication Charges: \$110.52

Brittany Smith
Brittany Smith

Subscribed and sworn to before me
This 29 day of July, 2020.

Catherine Stagg
Notary Public

My Commission Expires: 2/28/2025

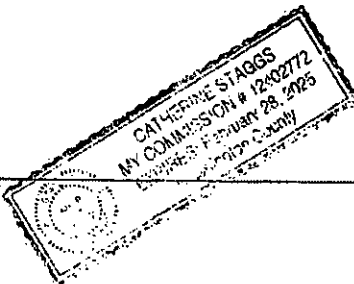

****NOTE****
Please do not pay from Affidavit.
Invoice will be sent.

PUBLIC NOTICE

The Siloam Springs Board of Directors will hold public hearings on August 18, 2020 at 6:30 PM in the board room at City Hall, 400 North Broadway to hear views regarding the proposed annexation of the following described lands, which are each completely surrounded by the city limits of Siloam Springs:

(A) All unincorporated territory in Lots 1 and 2 of Sycamore Heights Subdivision, recorded in Plat Book E, Page 103, in the office of the Benton County Circuit Clerk; same being all unincorporated territory in the SE 1/4 NW 1/4 NE 1/4 of S36, T18N, R34W, in Benton County, Arkansas.

(B) All unincorporated territory in the S 1/4 of the SE 1/4 SW 1/4 NW 1/4 of S33, T18N, R33W, in Benton County, Arkansas.

(C) All of parcels 18-12706-000 and 18-12690-000; same being all unincorporated territory, completely surrounded by Siloam Springs city limits, in the SW 1/4 of the SW 1/4 of S04-T17N-R33W, and also all of the unincorporated area, abutting the city limits, in the West 168 ft of the NE 1/4 of the SW 1/4 of said section, in Benton County Arkansas.

(D) All of parcels 18-12688-000 and 18-18906-000, same being all unincorporated territory, completely surrounded by Siloam Springs city limits, in the East 858 ft of NE 1/4 of the SW 1/4 of S04-T17N-R33W, in Benton County Arkansas.

(E) All unincorporated territory, completely surrounded by Siloam Springs City Limits, in the NW 1/4 SE 1/4, and in the eastern 100' of the NE 1/4 SW 1/4 of S4, T17N, R33W, in Benton County, Arkansas.

All affected property owners are hereby notified of their right to appear at the hearing and make their views known. A map showing the unincorporated islands is on file in the city clerk's office, and is being sent, along with this notice, to property owners within said areas.
75298720 July 29, 2020

BENTON COUNTY

STATE OF ARKANSAS

BETSY HARRELL

COUNTY CLERK & VOTER REGISTRAR

215 EAST CENTRAL, SUITE 217

BENTONVILLE, AR 72712-5373

479-271-1013

Fax: 479-271-1019

October 1, 2020

PROBATE COURT CLERK

COURTHOUSE, 102 N.E. "A" STREET

BENTONVILLE, AR 72712-5350

479-271-5727

FAX: 479-271-1712

Honorable John Thurston
Secretary of State
Room 256 State Capitol
Little Rock, AR 72201-1094

RE: City of Siloam Springs Annexation Ordinance 2020-24

Dear Secretary Thurston:

Enclosed please find a certified copy of the City of Siloam Springs Ordinance No. 2020-24 annexing completely surrounded territory to the City of Siloam Springs, Arkansas adopted on September 17, 2020.

Please record these annexations on you records and acknowledge receipt of these documents.

Very truly yours,

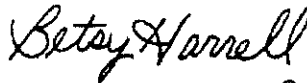

Betsy Harrell

By T. Underwood

BH/TKU
Enclosures

cc: Roderick Grieve
Benton County Assessor

NW Arkansas Regional Planning Commission
1311 Clayton Street
Springdale, AR 72765

Benton County 9-1-1 Administration

ROGERS OFFICE
2111 W. WALNUT
(479) 636-3727
FAX (479) 636-4922

ROGERS ARCHIVES
2111 W. WALNUT
(479) 636-1037
FAX (479) 636-1053

SILOAM SPRINGS OFFICE
707 S. LINCOLN
479-271-1013
FAX (479) 524-8534

RECEIVED

OCT 12 2020

Arkansas
Secretary of State