



# ARKANSAS SECRETARY OF STATE

## MARK MARTIN

January 04, 2017

The Honorable Tina Stowers  
Lawrence County Clerk  
P.O. Box 526  
Walnut Ridge, AR 72476

Re: City of Walnut Ridge Annexation Ordinance 648-01

Dear Mr. Holliday,

This letter acknowledges receipt and filing of the following notice of municipal boundary change by the Office of the Secretary of State:

Filing Type: Annexation by petition pursuant to A.C.A § 14-40-602 (petition by a majority of the landowners)  
Effective Date: unknown  
County: Lawrence City: Walnut Ridge  
City Ordinance: 648-01 Dated: 1/9/2001  
County Court Order: Unknown

File marked copies of the Ordinance and supporting documents submitted to our Office are enclosed. By copy of this letter (and its enclosures), the Secretary of State hereby notifies the appropriate mapping authorities for Arkansas. Please retain these copies as official record of the filing of the municipal boundary change by the Arkansas Secretary of State.

If you have any questions or concerns regarding this filing please contact our office at 501-682-3401.

Sincerely,

A handwritten signature in cursive script that reads "Cynthia Fisher".

Cynthia Fisher  
Arkansas Secretary of State Legal Division  
500 Woodlane St, Room 256  
Little Rock, AR 72201  
501-682-3401

cc: Arkansas Geographic Information Systems Office (w/ encl)  
Arkansas Highway and Transportation Department Mapping Department (w/ encl)  
UALR Institution for Economic Advancement (w/encl)  
Tom-Tom (w/encl)  
Ms. Sharon Henson, Walnut Ridge City Clerk and Trasurer





# Arkansas Secretary of State

**Mark Martin** Arkansas Secretary of State, 500 Woodlane Ave, Little Rock, AR 72201-1094

## Municipal Boundary Change Checklist

County: Lawrence City/Town: Walnut Ridge

City Ordinance/Resolution No: 648-01 Date approved: 01/09/2001

County Court Case No: \_\_\_\_\_ Date Order Filed: \_\_\_\_\_

Type: Annexation by Petition majority of Landowners A.C.A §14-40-602

Date Change Effective: \_\_\_\_\_ Emergency clause:  Yes  No

For Circuit Court Challenge: Date Filed: \_\_\_\_\_  Upheld  Overturned  Other (attach explanation)

### Initiating party:

All Landowners  Majority Landowners  Municipal Governing Body  State  Other \_\_\_\_\_

### Supporting Documentation attached (check all that apply):

- File marked copy of City Ordinance/Resolution (not required for A.C.A § 14-40-1801)
- File marked copy of County Court Order (not required for A.C.A. § 14-40-501)
- Proof of Publication for all Legal Notices (Hearing, Election, City Ordinance/Resolution)
- Copy of Arkansas GIS approved printed map and certification letter
- File marked copy of Petition Part or File marked copy of the certified special election results (if applicable)
- File marked copy of Complaint and final Circuit Court Order (Court Challenge only)

### Municipal Contact:

Name: Ms. Sharon Henson Title: Walnut Ridge City Clerk and Treasurer

Street Address: 300 West Main ST

City: Walnut Ridge St: AR Zip code: 72476

### City/County Official:

Signature: Hon. Tina Stower Title: Lawrence County Clerk

Date: 12/20/2016

Complete one form for each ordinance/resolution and attach it as a cover page to the supporting document set. Submit the documents to Arkansas Secretary of State, Atten: Municipal Boundary Filing, 500 Woodlane Ave, Little Rock, AR 72201-1094

Office of the Arkansas Secretary of State use only

Received by: Cynthia Fisher

**FILED**  
JAN 04 2017  
Arkansas  
Secretary of State



FILED  
LAWRENCE COUNTY

ORDINANCE NO. 648-01

2001 FEB -7 AM 8:22

AN ORDINANCE CONFIRMING THE ANNEXATION OF THE FOLLOWING  
DESCRIBED LANDS:

*648-01*  
LAWRENCE COUNTY

Tract No. 1:

All Lands lying within the perimeters of a boundary described as follows:

Beginning at a point at the northeast corner of Section 1, Township 16 North, Range 1 East, thence go southerly along the east section line of Section 1 and Section 12 to the southeast corner of Section 12, thence go westerly along the section line between Section 12 and Section 13, Section 11 and Section 14, and Section 10 and Section 15 to the southwest corner of the East Half of the Southwest Quarter of Section 10, which is the Hoxie City Limit, thence go northerly along the west line of said East half, Southwest Quarter, Section 10 (Hoxie City Limit Line) to the northwest corner of said East Half, Southwest Quarter, Section 10, thence go easterly along the North line of said East Half, Southwest Quarter, Section 10 (Hoxie City Limit Line) to the center of said Section 10, thence go northerly along the quarter section line between the Northeast Quarter and Northwest Quarter of said Section 10 (Hoxie City Limit Line) to the northwest corner of said Northeast Quarter, Section 10 (Hoxie City Limit Line), thence go easterly along the north section line of said Section 10 to the northeast corner of Section 10, thence go northerly along the west line of section 2, to the Northwest corner of said Section 2 (which is Walnut Ridge City Limit line), thence go easterly along the north section of said Section 2 and Section 1 to the northeast corner of said Section 1, which is the point of beginning, all being in Township 16 North, Range 1 East, Lawrence County, Arkansas. Also described as all of Section One (1); all of Section Two (2); the East half of the Southwest Quarter (E 1/2 SW 1/4) and the East Half (E 1/2) of Section Ten (10); all of Section Eleven (11) and all of Section Twelve (12), all said lands lying in Township Sixteen (16) North, Range One (1) East in Lawrence County, Arkansas.

**FILED**

JAN 04 2017

Arkansas  
Secretary of State

Tract No. 2:

BEGINNING AT THE EXTREME SOUTHWEST CORNER OF THE EXISTING CITY LIMIT WHICH POINT IS THE INTERSECTION OF THE NORTH RIGHT-OF-WAY OF JAY STREET AND THE NORTH-SOUTH 1/4 SECTION LINE OF SECTION 33, T-17-N, R-1-E, THENCE NORTHERLY ALONG SAID NORTH-SOUTH 1/4 SECTION LINE TO THE NORTH LINE OF SAID SECTION 33, THENCE EASTERLY ALONG SAID NOTRH SECTION LINE TO THE SOUTHWEST CORNER OF SECTION 27, THEN GO NORTHERLY ALONG THE WEST LINES OF SECTION 27, SECTION 22 TO THE NORTHWEST CORNER SECTION 22, THEN GO EASTERLY ALONG THE NORTH LINE OF SECTION 22 TO THE NORTHEAST CORNER OF SECTION 22 THEN GO NORTHERLY ALONG WEST SECTION LINE OF SECTION 14 TO THE NORTHWEST CORNER OF SECTION 14, THEN GO EASTERLY ALONG THE NORTH SECTION LINES OF SAID SECTION 14 AND SECTION 13 TO THE NORTHEAST CORNER OF SECTION 13, THEN GO SOUTHERLY ALONG THE EAST SECTION LINES OF SECTION 13, SECTION 24, SECTION 25, AND SECTION 36 TO THE SOUTHEAST CORNER SECTION 36, ALL BEING LOCATED IN T-17-N, R-1-E, THEN GO WESTERLY ALONG THE SOUTH SECTION LINE OF SECTION 36 AND SECTION 35 TO THE INTERSECTION OF THE NORTH RIGHT-OF-WAY LINE OR ARK HWY 91 TO THE EXISTING SOUTHEAST CITY LIMIT LINE OF THE CITY OF WALNUT RIDGE, WHICH IS THE END OF THE NEW CITY LIMIT BOUNDARY LINE.



Be it ordained by the City Council of Walnut Ridge, Arkansas:

1. The City Council of Walnut Ridge, Arkansas does hereby accept the following territory into the City of Walnut Ridge, Arkansas:

Tract No. 1:

All Lands lying within the perimeters of a boundary described as follows:

Beginning at a point at the northeast corner of Section 1, Township 16 North, Range 1 East, thence go southerly along the east section line of Section 1 and Section 12 to the southeast corner of Section 12, thence go westerly along the section line between Section 12 and Section 13, Section 11 and Section 14, and Section 10 and Section 15 to the southwest corner of the East Half of the Southwest Quarter of Section 10, which is the Hoxie City Limit, thence go northerly along the west line of said East half, Southwest Quarter, Section 10 (Hoxie City Limit Line) to the northwest corner of said East Half, Southwest Quarter, Section 10, thence go easterly along the North line of said East Half, Southwest Quarter, Section 10 (Hoxie City Limit Line) to the center of said Section 10, thence go northerly along the quarter section line between the Northeast Quarter and Northwest Quarter of said Section 10 (Hoxie City Limit Line) to the northwest corner of said Northeast Quarter, Section 10 (Hoxie City Limit Line), thence go easterly along the north section line of said Section 10 to the northeast corner of Section 10, thence go northerly along the west line of section 2, to the Northwest corner of said Section 2 (which is Walnut Ridge City Limit line), thence go easterly along the north section of said Section 2 and Section 1 to the northeast corner of said Section 1, which is the point of beginning, all being in Township 16 North, Range 1 East, Lawrence County, Arkansas. Also described as all of Section One (1); all of Section Two (2); the East half of the Southwest Quarter (E ½ SW 1/4) and the East Half (E ½) of Section Ten (10); all of Section Eleven (11) and all of Section Twelve (12), all said lands lying in Township Sixteen (16) North, Range One (1) East in Lawrence County, Arkansas.

Tract No. 2:

BEGINNING AT THE EXTREME SOUTHWEST CORNER OF THE EXISTING CITY LIMIT WHICH POINT IS THE INTERSECTION OF THE NORTH RIGHT-OF-WAY OF JAY STREET AND THE NORTH-SOUTH 1/4 SECTION LINE OF SECTION 33, T-17-N, R-1-E, THENCE NORTHERLY ALONG SAID NORTH-SOUTH 1/4 SECTION LINE TO THE NORTH LINE OF SAID SECTION 33, THENCE EASTERLY ALONG SAID NOTRH SECTION LINE TO THE SOUTHWEST CORNER OF SECTION 27, THEN GO NORTHERLY ALONG THE WEST LINES OF SECTION 27, SECTION 22 TO THE NORTHWEST CORNER SECTION 22, THEN GO EASTERLY ALONG THE NORTH LINE OF SECTION 22 TO THE NORTHEAST CORNER OF SECTION 22 THEN GO NORTHERLY ALONG WEST SECTION LINE OF SECTION 14 TO THE NORTHWEST CORNER OF SECTION 14, THEN GO EASTERLY ALONG THE NORTH SECTION LINES OF SAID SECTION 14 AND SECTION 13 TO THE NORTHEAST CORNER OF SECTION 13, THEN GO SOUTHERLY ALONG THE EAST SECTION LINES OF SECTION 13, SECTION 24, SECTION 25, AND SECTION 36 TO THE SOUTHEAST CORNER SECTION 36, ALL BEING LOCATED IN T-17-N, R-1-E, THEN GO WESTERLY ALONG THE SOUTH SECTION LINE OF SECTION 36 AND SECTION 35 TO THE INTERSECTION OF THE NORTH RIGHT-OF-WAY LINE OR ARK HWY 91 TO THE EXISTING SOUTHEAST CITY LIMIT LINE OF THE CITY OF WALNUT RIDGE, WHICH IS THE END OF THE NEW CITY LIMIT BOUNDARY LINE.

2. A copy of the plat of the annexed real estate is attached to this Ordinance. The County Clerk is hereby requested pursuant to A.C.A. 14-40-605 to forward a copy of this Ordinance along with a copy of the plat of the annexed territory and the Order of the County Court to the Secretary of State and also to the Director of the Tax Division of the Arkansas Public Service Commission.

DATED this 9<sup>th</sup> day of January, 2008.

  
Mayor

ATTEST:

  
Clerk



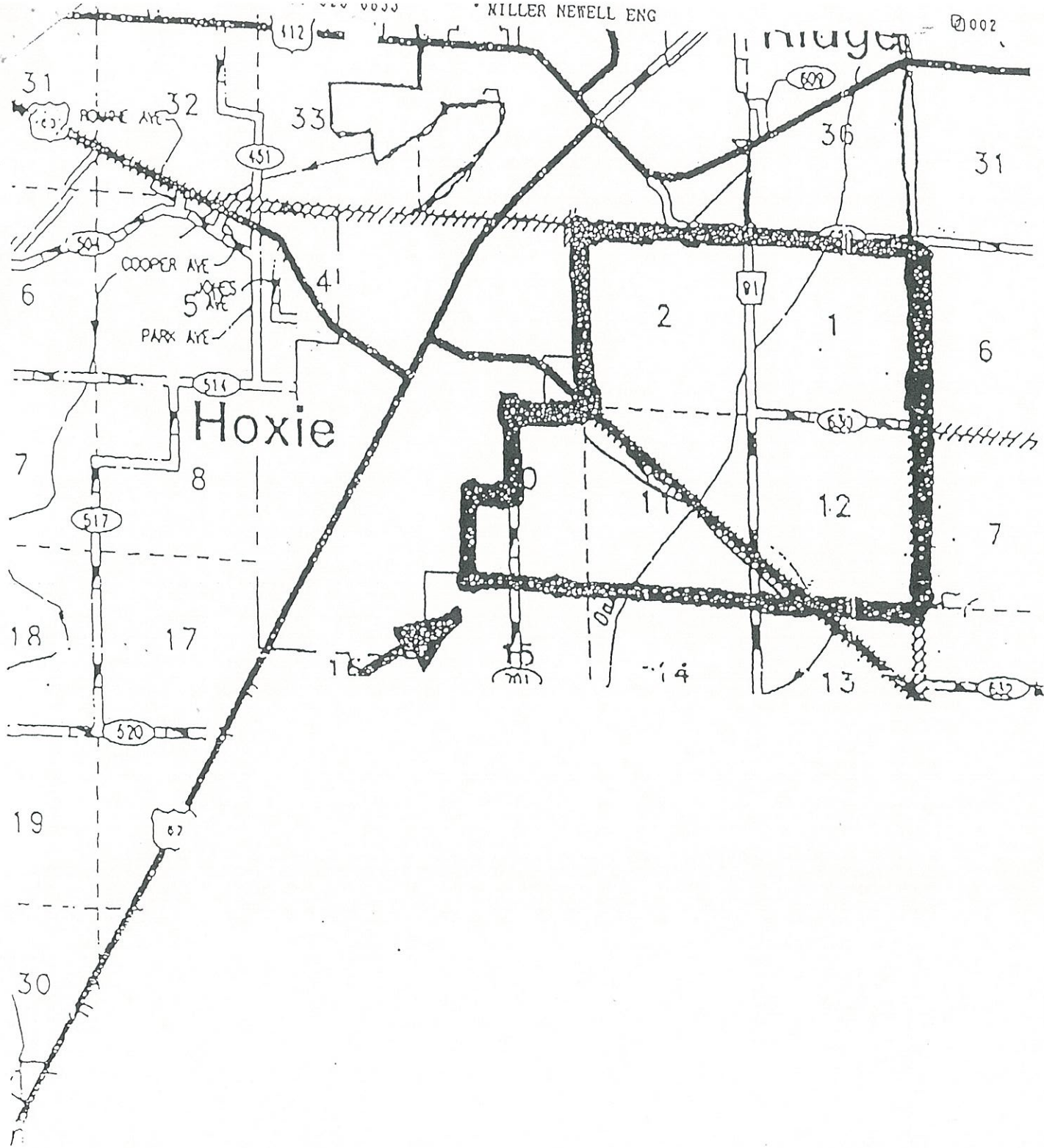

**FILED**  
 JAN 04 2017  
 Arkansas  
 Secretary of State



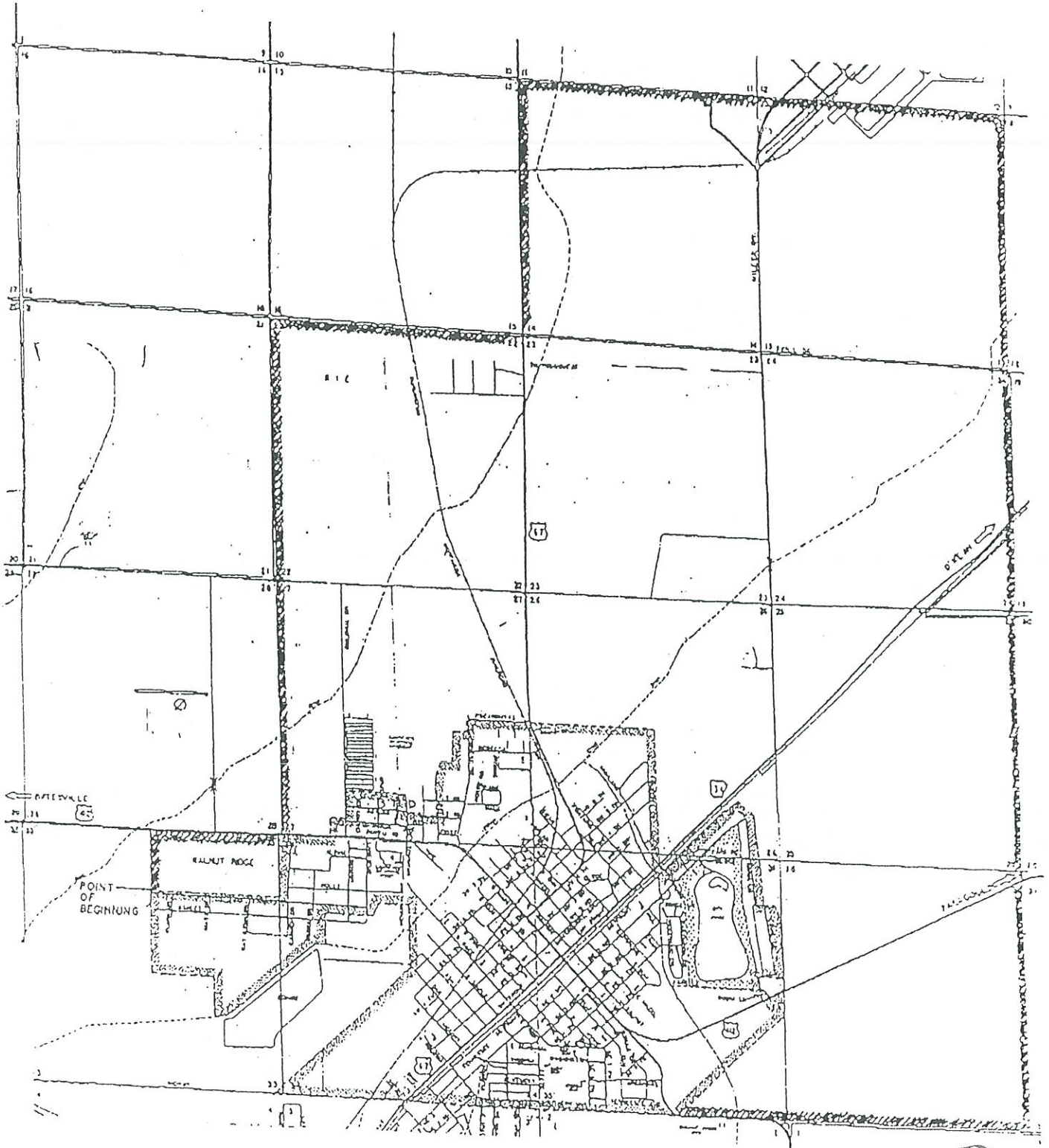

**FILED**

JAN 04 2017

Arkansas  
Secretary of State

.....  
**Lawrence County**

February 7, 2001

Reference: Annexation of Walnut Ridge

An ordinance confirming the annexation of lands within the city of Walnut Ridge was recently passed on January 9, 2001 by the Walnut Ridge city council. Therefore, the 9-1-1 coordinator and the county clerk are hereby, authorized to send you a change of address, due to voter registration and emergency 911 purposes. If you would like more information, or if you feel this is an error, please contact Walnut Ridge City Hall.

Karen Swartzlander  
Deputy Clerk

Peggy Miles  
9-1-1 Coordinator

**FILED**  
JAN 04 2017  
Arkansas  
Secretary of State